



Affordable. Reliable. Home Improvement.

MANUAL REEL

MODEL:HR-026-1

Technical Support and E-Warranty Certificate
www.vevor.com/support

VEVOR

Affordable. Reliable. Home Improvement.

MANUAL REEL

MODEL:HR-026-1

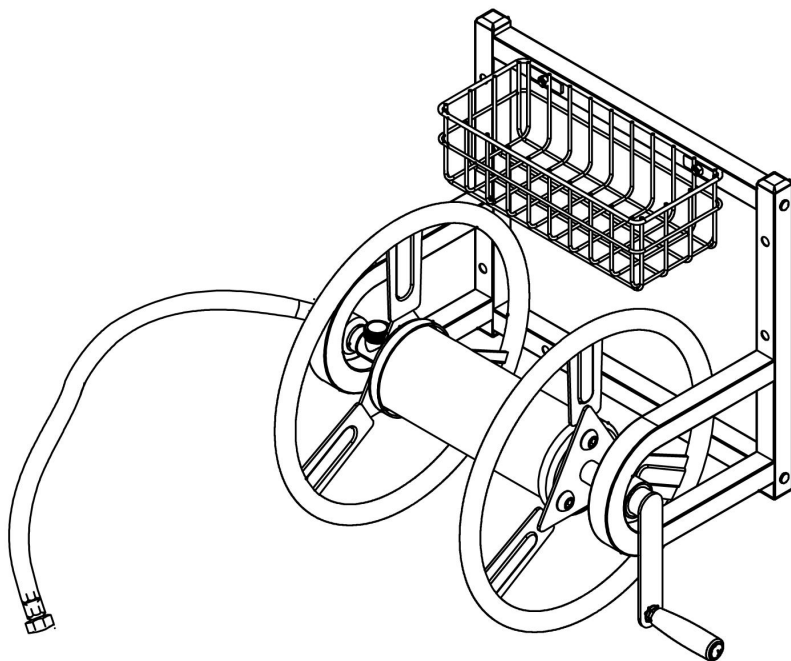

This is the original instruction, please read all manual instructions carefully before operating. VEVOR reserves a clear interpretation of our user manual. The appearance of the product shall be subject to the product you received. Please forgive us that we won't inform you again if there are any technology or software updates on our product.

PARTS LIST

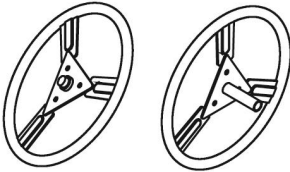

1 SPOOL ENDS (2)

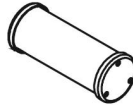

2 SPOOL RODS (1)

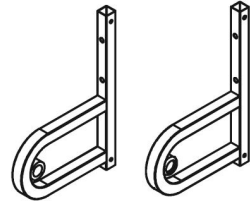

3 FRAME (2)

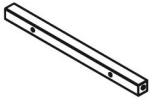

4 CROSS BAR (2)



5 CRANK HANDLE (1)

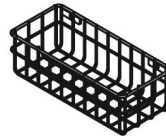

6 WIRE BASKET (1)



7 SPRING (1)

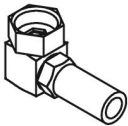

8 BRASS SWIVEL 3/4 (1)



9 BRASS TEE 3/4 (1)



10 RUBBER HANDLE W/BOLT (1)



11 SPACER WASHER (3)

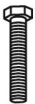

12 M8*40mm BOLTS (4)



13 M6*40mm BOLTS (2)



14 M6 LOCK NUTS (2)



15 M6*15mm BOLTS (6)



16 LEADER HOSE (1)



12mm

10mm

17 WRENCH (2)



Flat Washer (6)

Lock Washer (6)

Nuts (6)

18 M8*80mm Masonry Anchor Sleeve (6)

ASSEMBLY STEP

STEP:1

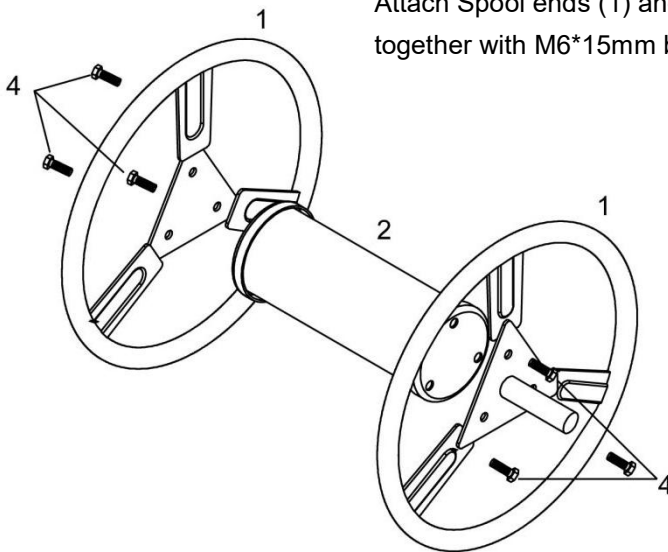

Attach Spool ends (1) and Spool rods (2) together with M6*15mm bolts(15)

STEP:2

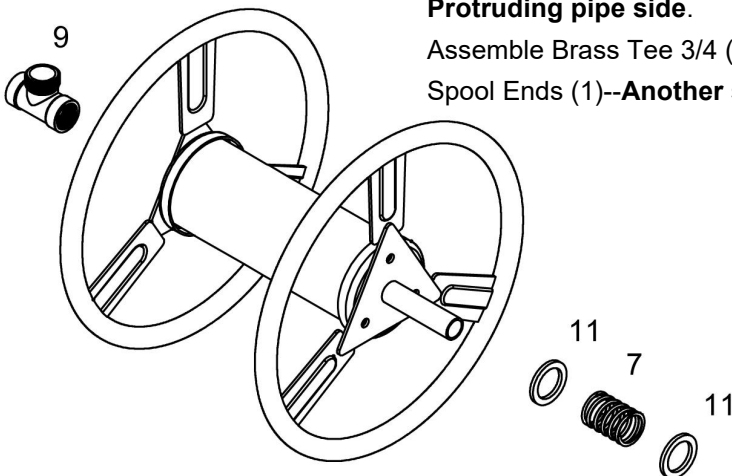

Firstly Assemble 1pc Spacer Washer(11), Secondly Spring(7) and thirdly another 1pc Spacer Washer(11) onto Spool Ends (1)--
Protruding pipe side.

Assemble Brass Tee 3/4 (9) to the other Spool Ends (1)--**Another side**

STEP:3

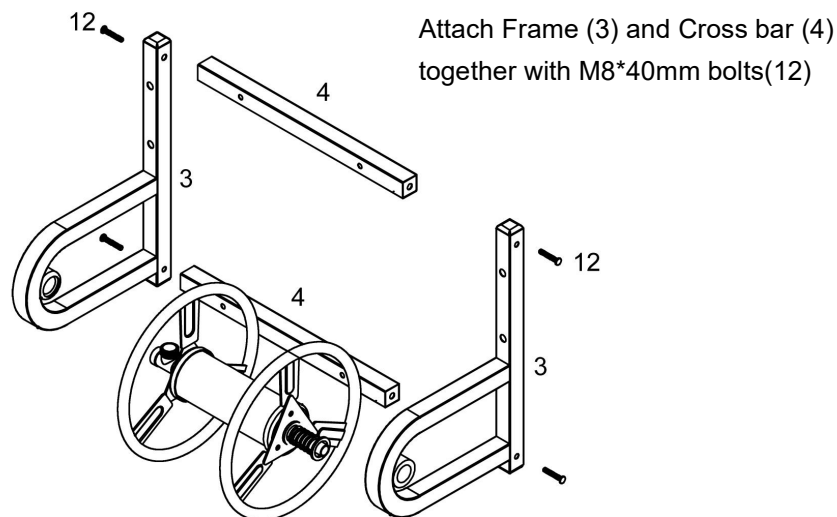

STEP:4

Assemble Spacer Washers (11) and Brass swivel 3/4 (8) and Frame(3) onto Brass Tee (9).

Assemble Crank Handle (5) onto Frame(3).

Attach Rubber Handle W/bolt(10) to Crank handle using handle bolt.

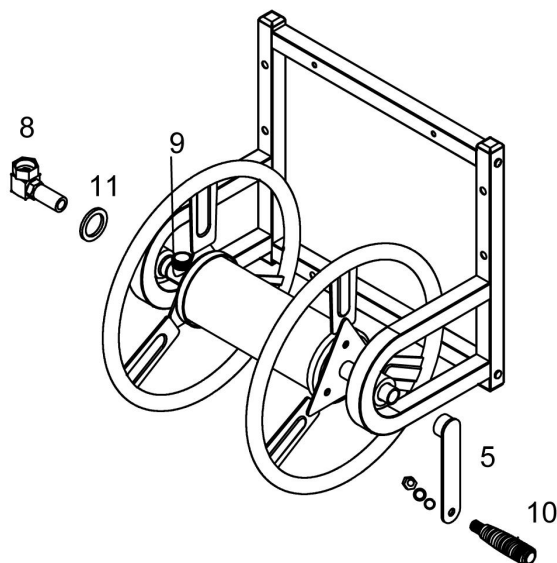

STEP:5

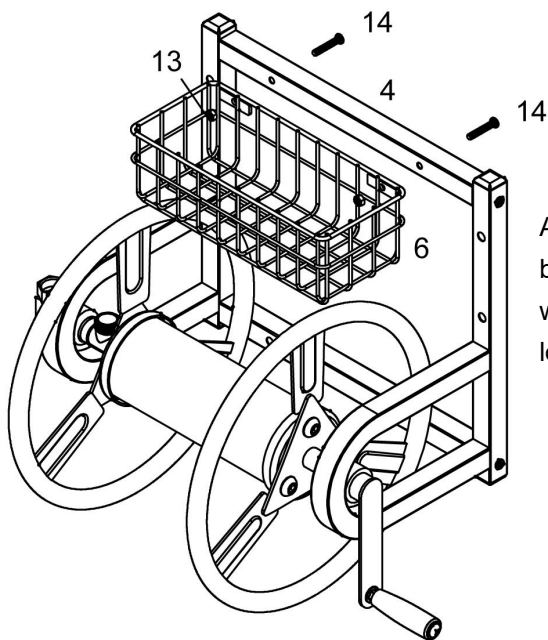

Attach Cross Bar (4) and Wire basket (6) together with M6*40mm bolts(13)and M6 lock nuts (14).

STEP:6

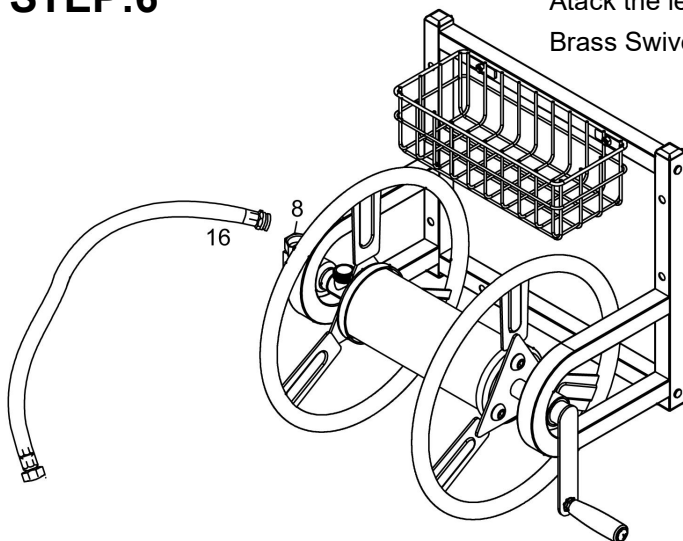

Attach the leader hose (16) to the Brass Swivel 3/4(8)

STEP:7

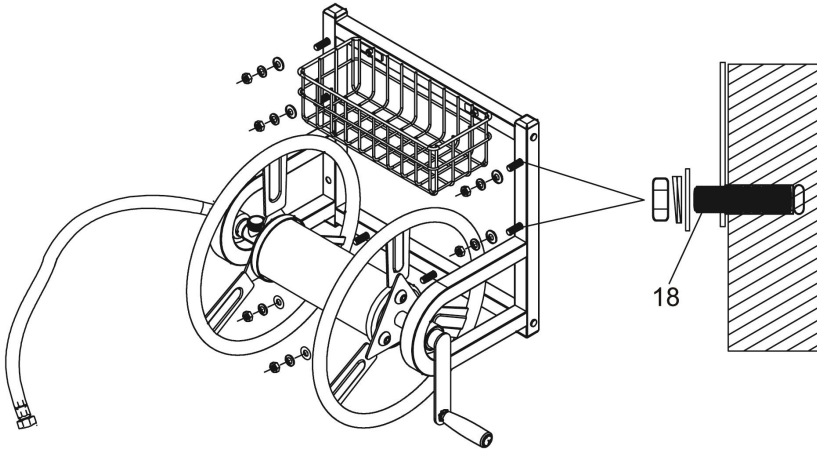

The distance between the installation holes is 110mm in length and 220mm in width. It is recommended to use power tools to install the expansion screws.

- 1.Position and hold your hose reel against the brick/masonry wall at a convenient height. Mark the position of each suspension hole on the wall. Remove the hose reel.
- 2.Using a hammer drill, drill holes 12.5mm in diameter and at the marked positions on the wall.
- 3.Insert the masonry wall anchors into the anchor sleeve. Next, insert the anchor and sleeve into the drilled holes until the steel sleeve is completely in the wall.
- 4.Place the hose reel on the masonry wall anchors.
- 5.Install a washer, lock washer, and nut over each wall anchor and tighten securely.

Note:

1. Water pipes may become hard and difficult to turn in winter. If the water pipes are too hard or too thick, it will affect the capacity of the hose - reel. It is recommended that users reduce the length of the coiled water pipe.

2. Pay attention to safety during the installation of expansion screws. Tighten the nuts. The length of the installation hole should be longer than that of the expansion screw for easy installation. Check the tightness of the screws before use.

Address: Shuangchenglu 803nong11hao1602A-1609shi, baoshanqu, shanghai 200000 CN.

EC REP: E-CrossStu GmbH.

Mainzer Landstr.69, 60329 Frankfurt am Main.

UK REP: YH CONSULTING LIMITED.

C/O YH Consulting Limited Office 147, Centurion House, London Road, Staines-upon-Thames, Surrey, TW18 4AX

Imported to AUS: SIHAO PTY LTD.

1 ROKEVA STREET EASTWOOD NSW 2122 Australia

Imported to USA: Sanven Technology Ltd.

Suite 250, 9166 Anaheim Place, Rancho Cucamonga, CA 91730



Technical Support and E-Warranty Certificate
www.vevor.com/support