



Panoramic Outdoor Cedar Saunas



Installation Guide

Contents

Installation and Assembly Information.....	3
Installation Precautions	3
Sauna Parts List.....	4
Required Tools.....	4
Installation and Assembly Procedure	5
Preparing for Installation.....	7
Sauna Installation	7
Installing the HUUM Drop 7 Heater.....	20
Adding Sauna Stones.....	21
Using the HUUM Drop 7 Heater.....	21
Sprinkling water on the Stones	22
Installing LED Light Strips	22
Warnings.....	23
Operating Cautions (revised)	23
Maintenance.....	24
Guarantees (correct?)	25
Electrical Specifications.....	26
Limited Residential Warranty	26

The unique tinted acrylic dome window in the Panoramic Outdoor Sauna provides immersive view-ability never experienced before in a sauna. The Panoramic Outdoor Sauna is a hand-made and unique work of art that elevates any home and backyard.

The Sauna is available in three styles; 4-person, 6-person, and 8-person.

The Panoramic Outdoor Sauna comes equipped with industry-leading and powerful Huum Drop electric heaters (at no extra charge) with an intuitive digital control panel.

Installation and Assembly Information

The table below shows the approximate external dimensions of the Sauna styles.

	4-Person	6-Person	8-Person
Diameter	5.9 ft	5.9 ft	5.9 ft
Length	5 ft	8.85 ft	10 ft

Installation Precautions

1. Provide enough access space to the wall plug and outlet so that the sauna can be easily unplugged if necessary.
2. Do not allow children inside the sauna while it is turned on.
3. Do not touch the heaters while your sauna is turned on, as they are very hot and may cause burns.
4. Keep all liquids away from the heating panels.
5. Place your sauna on a level surface that will not flood. The saunas are very heavy so a solid foundation is recommended. Luminar saunas are designed to be placed outside.
6. The sauna must be placed where there is never standing water, so building it directly over dirt or grass is not recommended. An elevated concrete or wood base if preferable. Not doing this may void your Warranty.
7. The infrared heaters will have trouble reaching optimal temperatures when the outside ambient temperature is 40⁰ F or lower. We recommend not using the sauna when the outside temperature is lower than 25⁰ F.
8. Any electrical service for your sauna must be performed by a qualified and licensed electrician with complete knowledge of local codes and regulations.
9. Please ensure your sauna plugs into a 220-240 V outlet with a GFCI, installed by a licensed electrician.
10. This product may cause excessive happiness - proceed with caution.

Sauna Parts List

- HUUM 7 Drop Heater
- HUUM Remote
- HUMM Temperature Sensor
- HUUM Main Module

Required Tools

- Hammer
- Square
- Level
- Drill
- Phillips drill bit set
- Socket wrench set
- Open-ended wrench set
- Lifting straps (optional)
- Ladder (optional)

Installation and Assembly Procedure

The graphic below shows an expanded view of the Sauna.

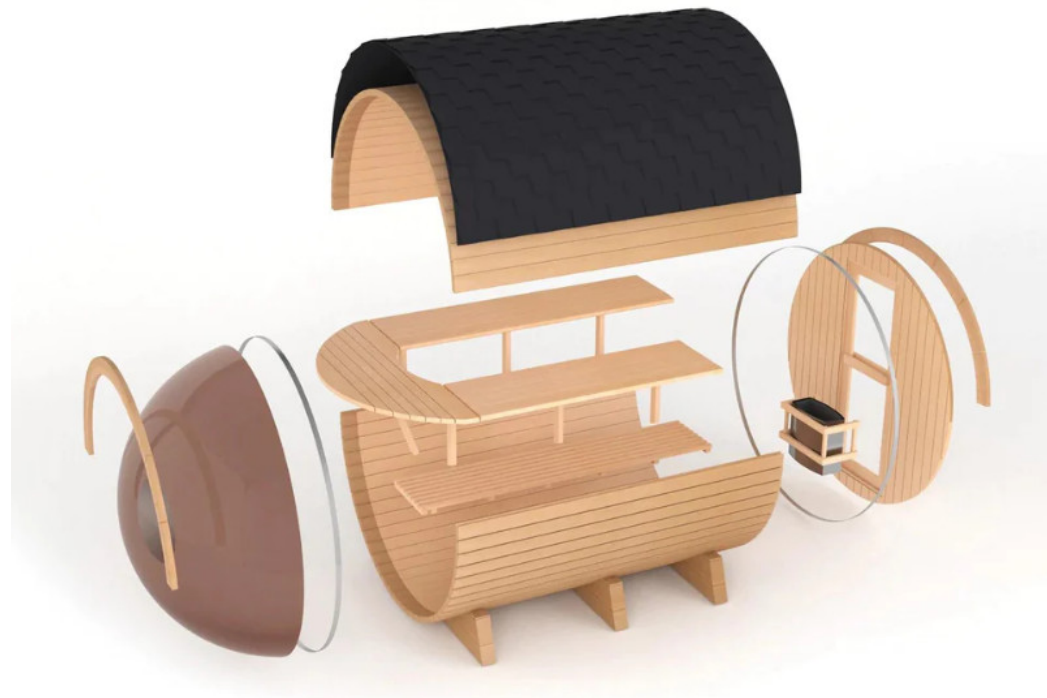

The following pictures are used for your reference. Don't worry if your sauna is slightly different from the pictures, just follow the steps.

These instructions for installation and use are intended for the owner or the person in charge of the sauna, as well as for the electrician in charge of the electrical installation of the heater. After completing the installation, the person in charge of the installation should give these instructions to the owner of the sauna or to the person in charge of its operation.

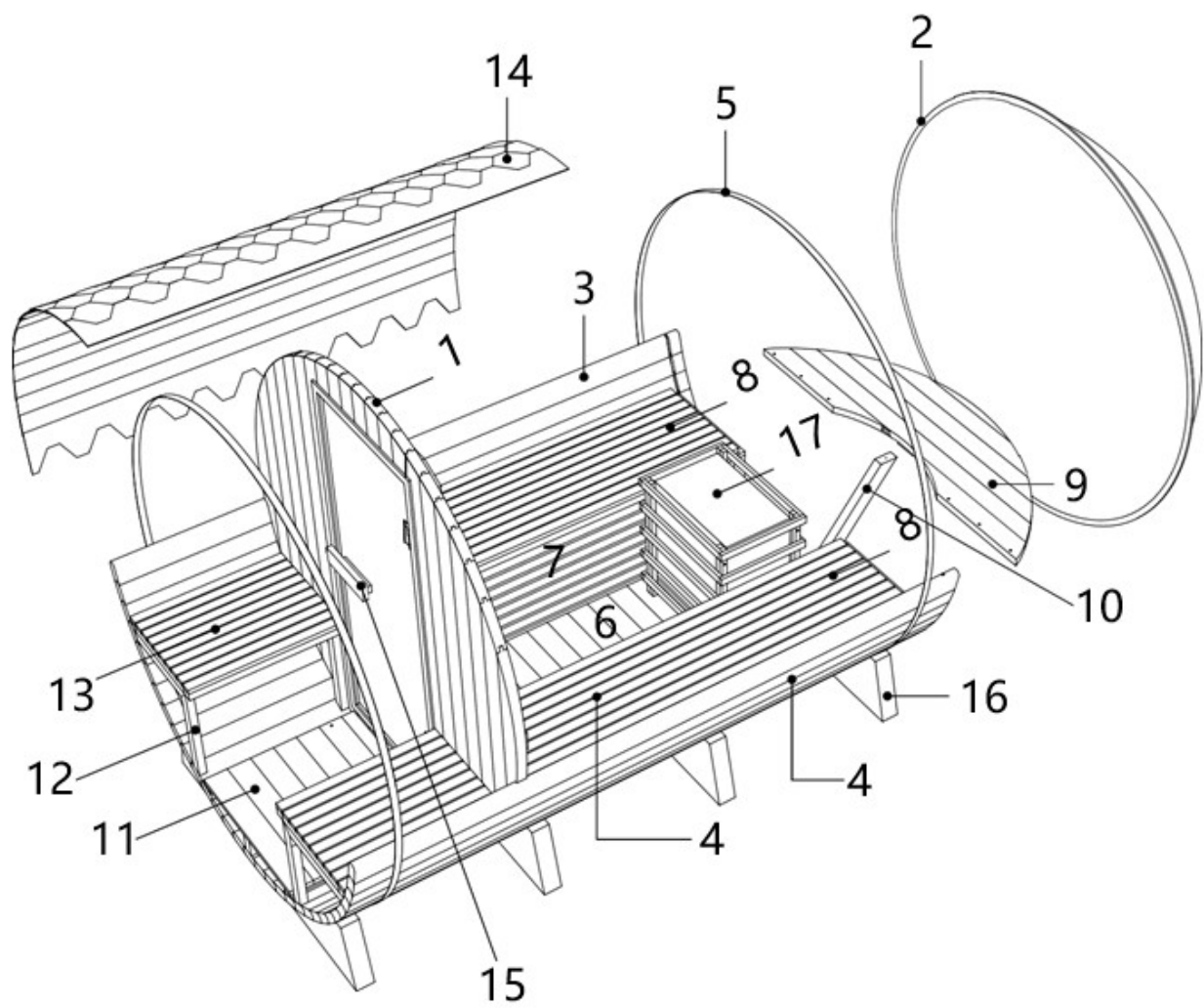

- | | | | |
|---------------------|------------------|----------------------------------|--------------------|
| 1 - Front Wall | 5 - Steel Band | 9 - Curved Seat | 13 - Porch Seat |
| 2 - Acrylic Window | 6 - Inside Floor | 10 - Plate | 14 - Waterproofing |
| 3 - Left Side Slat | 7 - Seat Riser | 11 - Support Slat | 15 - Door Handles |
| 4 - Right Side Slat | 8 - Bench | 12 - Porch Floor
plate Holder | 16 - Base |

Preparing for Installation

Check whether the total number of packages is correct and whether the appearance of the package is intact.

After removing the outer packaging, check whether the product components are complete and whether they are damaged.

Sauna Installation

There are 3 types of connections that can be used. The connection method varies from product to product model. There will be one or more connection methods mixed connection, in the connection process to ensure that the connection is strong.

Buckle connections



Hidden connections

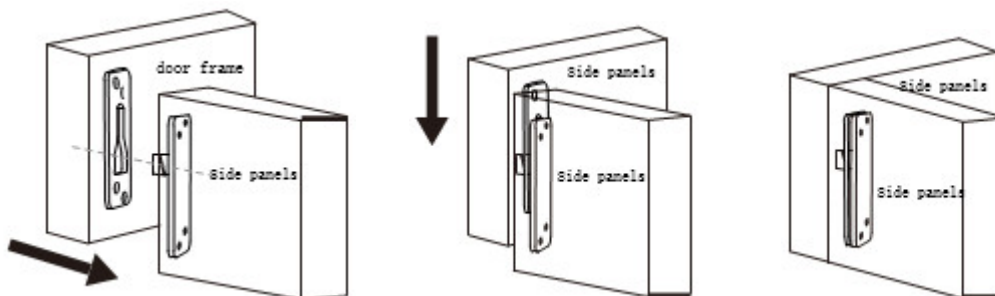

Screw connections



1. Place the Bases

Choose a location close to the electrical outlet.

Pay attention to the door opening direction to ensure no other objects will block the door when opening.

Place the underframe (Base) in the mounting position. We recommend not moving the sauna once it is placed to avoid damage to floors or other surfaces.

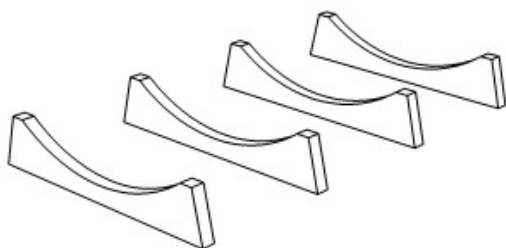

Note: The number of bases will depend on your model. The picture is shown as an example for reference.

2. Install a positioning plate for the bottom frame

Installation of the bottom frame positioning ribs will be the base for the sauna.

Use screws and the double-ended dowel slats to fix the position of the ribs, using as many screws as necessary.

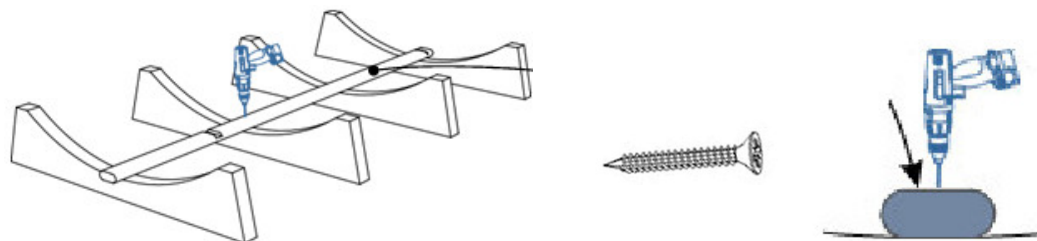

3. Install the left slats

Fasten the left slats to the bottom frame. Make each slat fit closely when placing the slat.

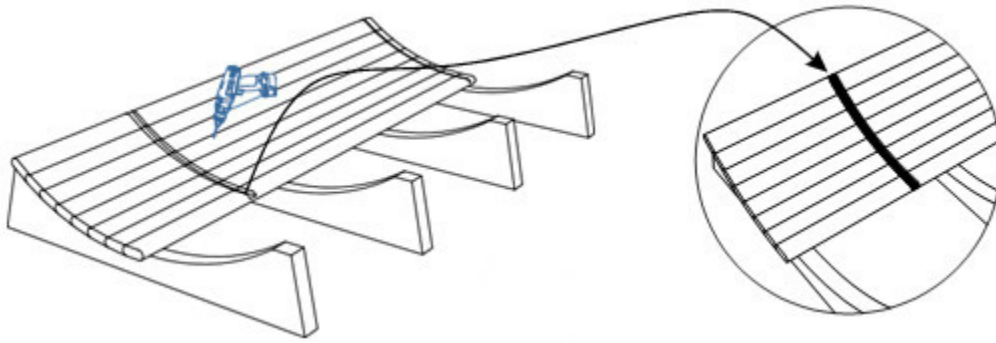

Align the slots. Pay attention to the direction of the slat (the convex edge of one slat fits into the concave edge of the next slat).

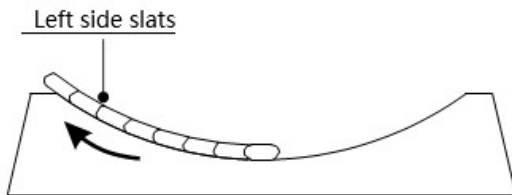

4. Install the right slats

Fasten the right slat to the bottom frame using screws. Make each slat fit tightly when placing the slat. Pay attention to the direction of the slats.

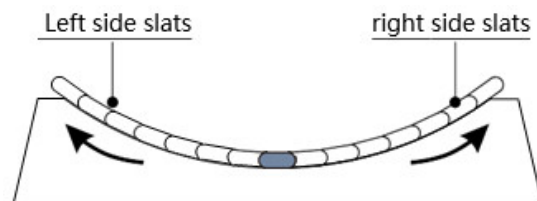
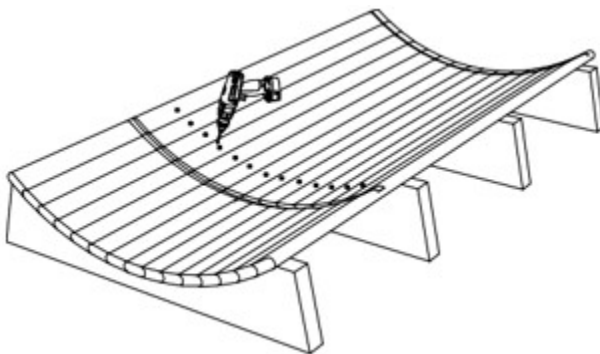

5. Place the front plate

Assemble the front board into a complete front board from three pieces, which are connected by screws.

Erect the front board into the groove of the bottom frame slats (this requires 2 helpers). Pay attention to the alignment of the slots. Arrange the helpers to support the front board to prevent collapse and damage.

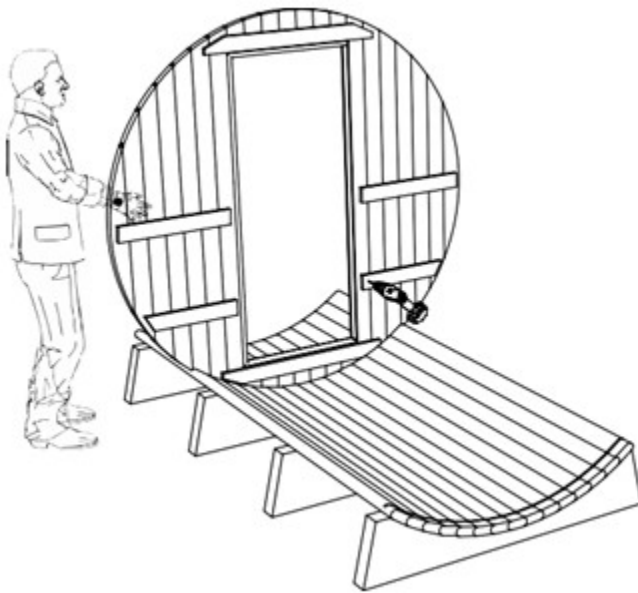

Align the front plate using the grooves in the slats.



Use a level to adjust the front panel so it is horizontal.

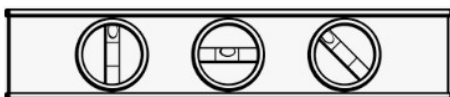

6. Place the top cover

Put the acrylic ball into the groove of the bottom frame slats. Position your helpers to hold the front plate and the acrylic ball to prevent collapse and injury.

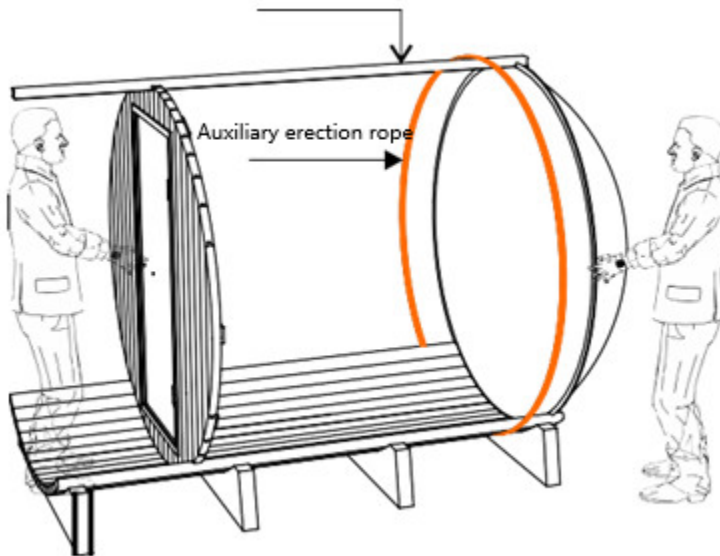

Lay a slat across the top of the front plate and the acrylic Ball for stability.

Attach the front board to the acrylic ball using one or more slats, then attach the slats using a rope on one side of the acrylic ball.

7. Install the right slats

Arrange the right slats upwards from the bottom frame. When installing the front panel, nail a screw to each slat to temporarily fix the slats to the acrylic ball using auxiliary installation straps (the screws are used to fix the slats and prevent the slats from falling down).

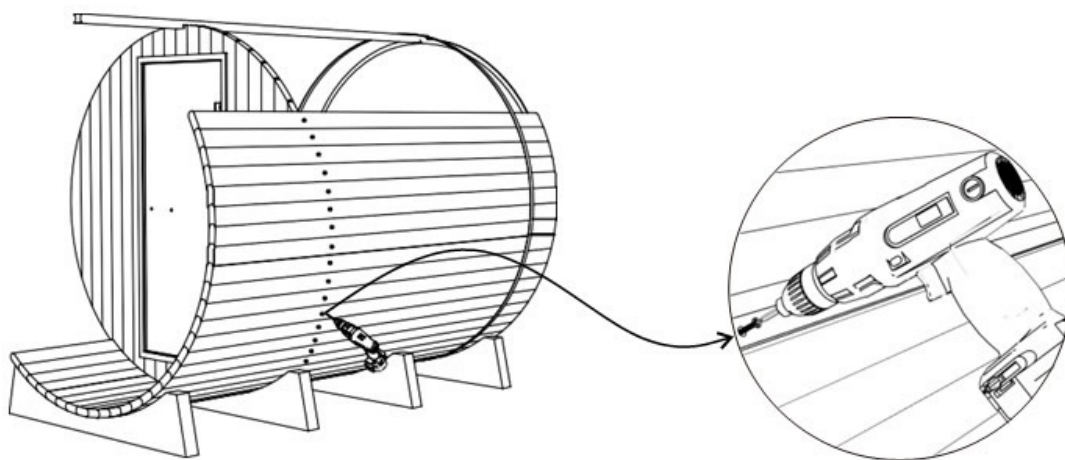

8. Install the left slats

Install the left slats in the same manner.

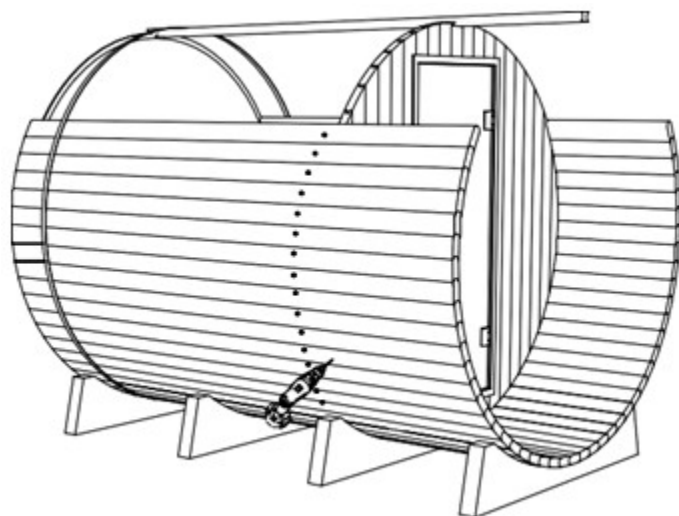

9. Install the left and right slats

Install the remaining left and right side slats.

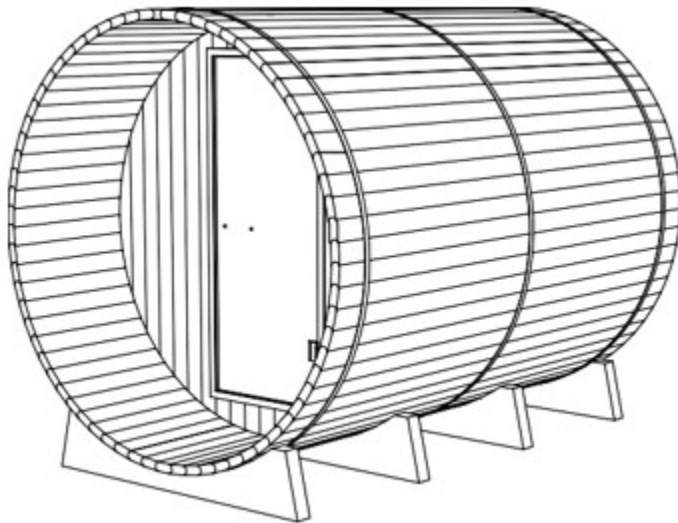

Note: The closing slats are composed of several slats of different thicknesses. Refer to the figure below. Select the appropriate thicknesses to compensate for the gap at the top of the sauna.

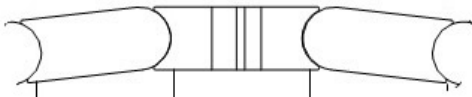

Install the steel belt to tighten the drum. The number of steel straps depends on the length of the model. Install the number of straps for your sauna model. Tighten the straps using an open-ended wrench.

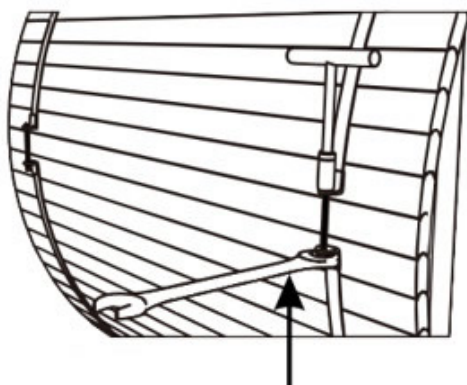

10. Install the L-shaped seat plate holder

Install the left and right L-shaped seat brackets. Align the positions of the brackets with the supports on the seat plate. Install the longest side of the L-shaped support upward, then secure the two ends using screws.

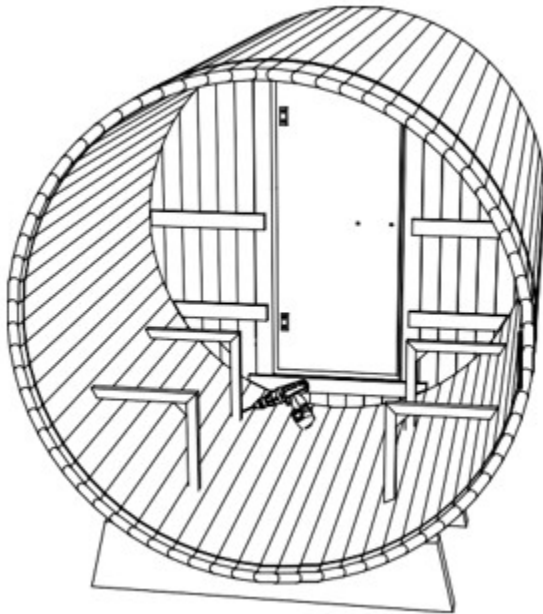

11. Install the arc seat plate support

The L-shaped bracket of the arc seat plate is unique, and the bracket of the left and right seat plate are different. Pay attention to this distinction. The two ends are fixed with screws.

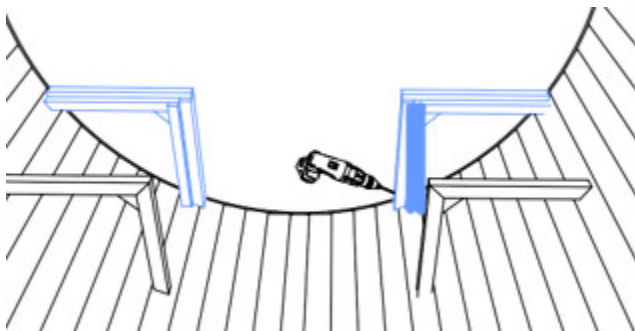

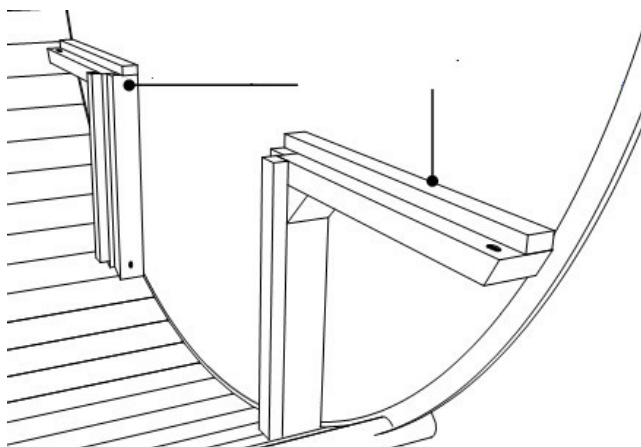

12. Install the foot panel and the left and right sitting riser

Install these parts, then fix them in place with screws.

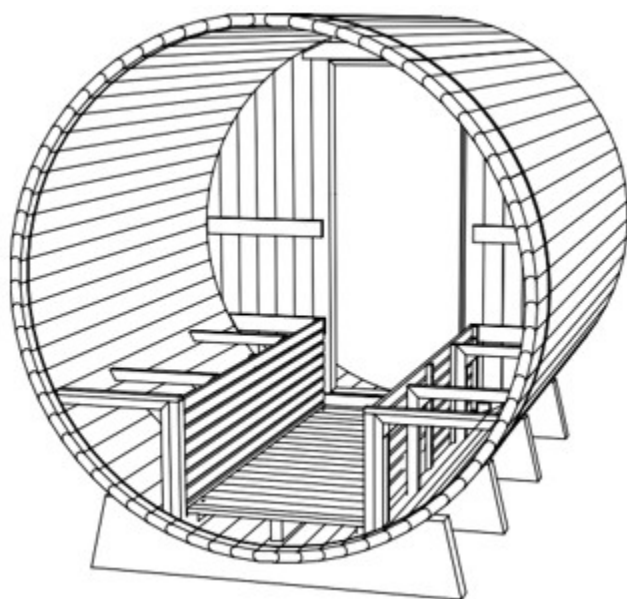

13. Install the left and right seat plates

Install those plates.

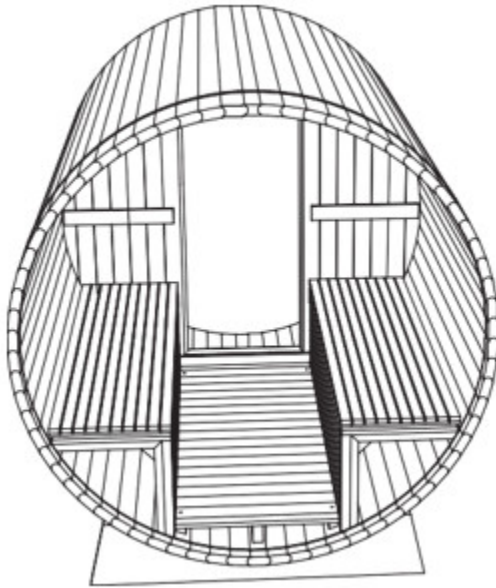

14. Install the arc seat plate

Align the circular arc seat plate with the left and right seat plate and fix it with screws.



Clamp the notched end of the support side of the arc seat plate to the foot pedal and fix it in place. Move the foot pedals and the support in the direction of the arrow so they are flush with the arc seat plate.

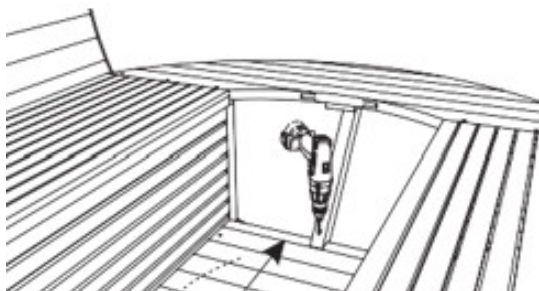

Move the foot pedal and the support side of the arc seat plate to the parallel point of the support side of the arc seat plate, Fix the support side in place with screws.

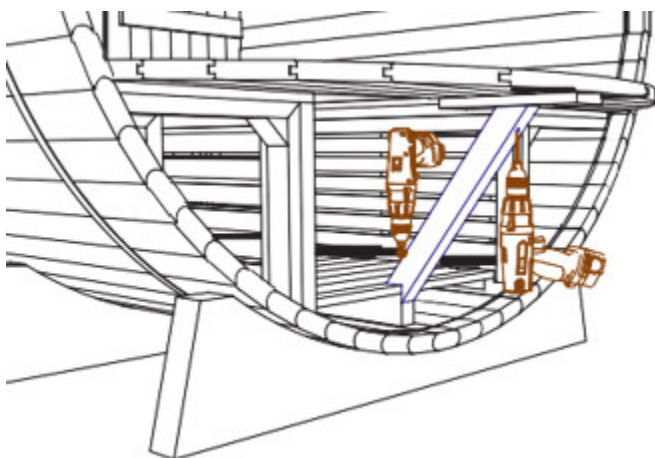

15. Install the eaves board and the eaves footboard

Install the eave plate L-bracket, eave footboard, and eave plate as shown in the figure. Fix the eave plate in place with screws. For a sauna without an eave plate (a sauna with a porch), skip this step.

Install a fixed-porch seat L-holder.

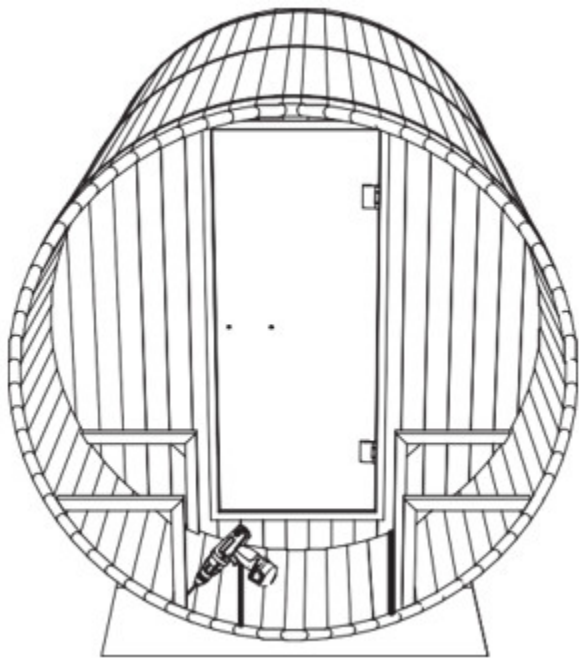

Install a fixed-porch seat L-holder and floor porch.

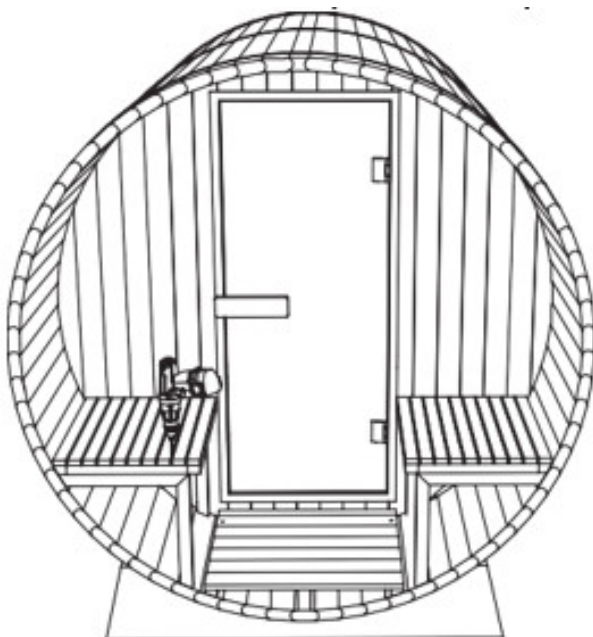

16. Install asphalt shingles

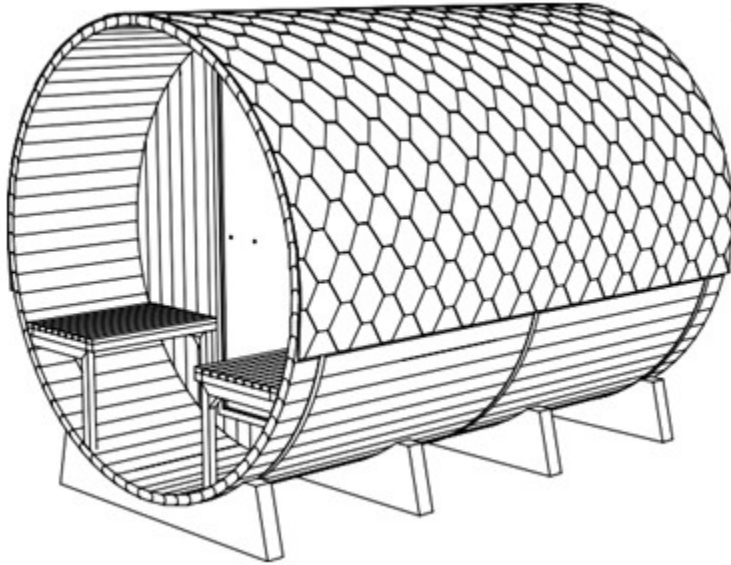

The height of the shingles from the ground should be 80 cm or less.

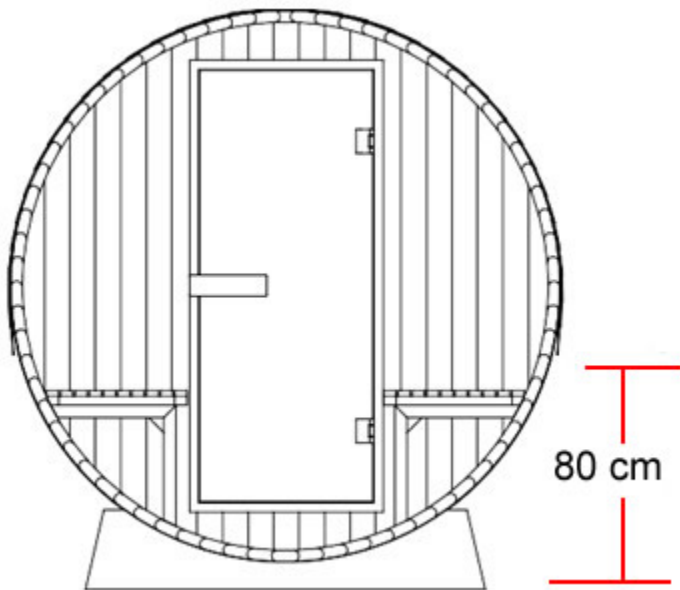

17. Install the door handle

Install the door handle according to the figure. The appearance of the outside and inside handles are different, but the same installation method. The M6x60 screws are installed from inside the sauna.

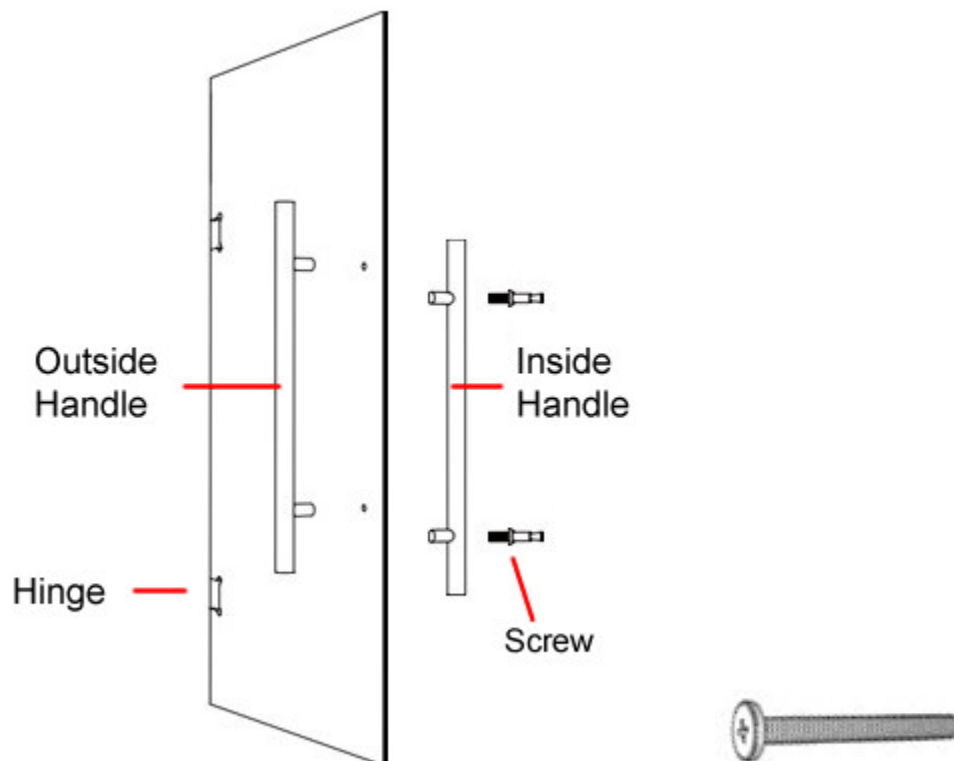

Installing the HUUM Drop 7 Heater

- Before installing the Heater confirm that the maximum amperage of the main circuit breaker is properly rated for the Heater.
- When positioning the heater, ensure that there is a safe clearance between flammable materials and the external surfaces of the heater.
- When choosing a suitable location, ensure that you can conveniently throw water on sauna stones when sitting on the sauna bench. The top layer of sauna stones should be at the level of your feet when you are sitting on the sauna bench.
- When installing the wall mount, take the full weight of the heater, 143 lb (65 kg) into consideration.

- Attach the heater to the wall mount and ensure that it is securely fixed to the wall. Use the Safety Railing with brackets, if supplied.
- Refer to the mounting instructions that came with the heater.

Adding Sauna Stones

- Sauna stones with a diameter of 2-4 in / 5-10cm are suitable. It is recommended to use round stones in HUUM sauna heaters. Round stones complement the design of the heaters and provide milder steam.
- Choose stones that are specifically meant for use in sauna heaters.
- The Heater requires 121 lb / 55 kg of sauna stones.
- Wash off dust from the stones before piling them into the heater.
- Do not drop stones into the heater.
- Do not wedge stones.
- Due to large variation in temperature, the sauna stones disintegrate in use. Rearrange the stones at least once a year or even more often if the sauna is in frequent use. At the same time, remove any pieces of stones from the bottom of the heater and replace any disintegrated stones with new ones. By doing this, the heating capability of the heater stays optimal, and the risk of overheating is avoided.

Using the HUUM Drop 7 Heater



HUUM Heater when cold



HUUM Heater when hot



Adding water

If the temperature of the sauna room becomes dangerously high, the overheat protector will permanently cut off the supply of the heater. The overheating protector can be reset

after the heater has cooled down. Prior to pressing the button, the cause of the fault must be found.

Sprinkling water on the Stones

The air in the sauna room becomes dry when warmed up. Therefore, it is necessary to throw water on the heated stones to reach a suitable level of humidity in the sauna. The effect of heat and steam on people varies – by experimenting, you can find the levels of temperature and humidity that suit you best.

CAUTION: If an excessive amount of water is poured on the stones, only part of it will evaporate and the rest may splash as boiling hot water on the bathers. Never throw water on the stones when there are people near the heater because hot steam may burn their skin.

Installing LED Light Strips

We've equipped your sauna room with LED light strips, which you can install yourself. We do not recommend installing light strips above the sauna heater, as this could increase the risk of damage. If the sauna heater is placed on the back wall, don't install the light strips on the back wall, rather place the light strips around the door. If the sauna heater is close to the door, then the light strips can be placed on the walls.

The light strip is operated with a remote control as shown below.

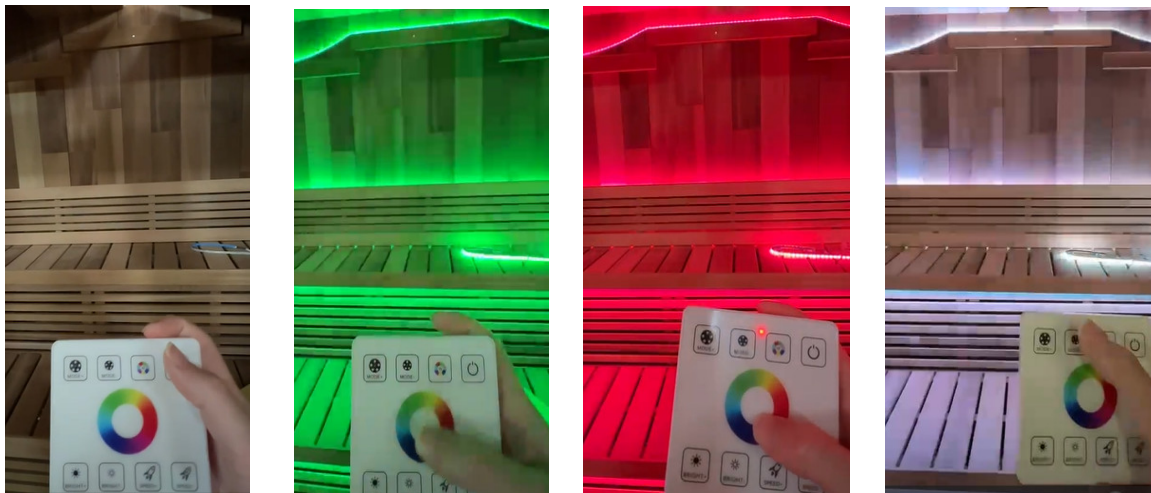

Warnings

- Staying in the hot sauna for long periods of time makes the body temperature rise, which may be dangerous.
- Keep away from the heater when it is hot. The stones and outer surface of the heater may burn your skin.
- Keep children away from the heater.
- Do not let young, handicapped or ill people bathe in the sauna on their own.
- Consult your doctor about any health-related limitations to bathing.
- Consult your child welfare clinic about taking little babies to the sauna.
- Be very careful when moving in the sauna, as the platform and floors may be slippery.
- Never go to a hot sauna if you have taken alcohol, strong medicines or narcotics.
- Never sleep in a hot sauna.
- Sea air and a humid climate may corrode the metal surfaces of the heater.
- Do not hang clothes to dry in the sauna, as this may cause a risk of fire. Excessive moisture content may also cause damage to the electrical equipment.

Operating Cautions (revised)

- Check all the circuitry and the plug connections carefully.
- Do not share the outlet with other electrical appliances to avoid danger.
- Do not use the sauna room if under the influence of alcohol, drugs or medications.
- Pregnant women or persons with poor health should consult their physicians before use.
- Minors should be supervised in order to prevent injury.
- **Hyperthermia Danger:** Prolonged exposure to hot air will induce hyperthermia. Hyperthermia occurs when the internal temperature of the body reaches a level several degrees above the normal body temperature of 98.6F (37C). While hyperthermia has many health benefits, it is important not to allow your body's core temperature to rise above 103F (39.5C). Symptoms of excessive hyperthermia include dizziness, lethargy, drowsiness, and fainting. The effects of excessive hyperthermia may include failure to perceive heat, failure to recognize

the need to exit, unawareness of impending hazard, fetal damage in pregnant women, physical inability to exit the sauna, and unconsciousness.

- Persons suffering from obesity or with a medical history of heart disease, low or high blood pressure, circulatory system problems, or diabetes should consult a physician prior to using the sauna.
- Persons using medications should consult a physician before using the sauna since some medications may induce drowsiness while others may affect heart rate, blood pressure, and circulation.
- Never sleep inside the sauna while the unit is in full operation.
- Do not use any type of cleaning agents on the interior of the sauna.
- If the power supply cord becomes damaged, it must immediately be replaced by the manufacturer or its agent or a similarly qualified person to avoid a hazard.
- Do not use the unit during an electrical storm, as there is a remote risk of shock.
- Altering or tampering of any electrical connections on the power supply will void the manufacturer's warranty.
- Dry your hands before handling electrical controls. Never unplug the power cord or adjust the controls with wet hands or when you have wet bare feet. The danger of electrical shock exists.
- Do not attempt any repair without consulting the manufacturer first. Unauthorized repair attempts will void the manufacturer's warranty.
- The sauna must use a GROUND FAULT CIRCUIT INTERRUPTER (GFCI) on the electrical circuit.

Maintenance

Before using your sauna for the first time, clean the inside of the sauna with a damp cloth. We recommend cleaning the inside of your sauna regularly to keep it looking and working its best.

Never use chemicals inside your sauna! They can damage the wood and you may breathe them in when the sauna heats up.

After you've used the sauna, wipe up and perspiration with a dry towel and leave the door open so the inside can dry out. At regular intervals give the interior a sweep or vacuum. If you notice stains from dirt or perspiration, use warm water and gently scrub the spots, or a low-pressure washer with a wide-pattern nozzle and spray the spots. You can also buff away stubborn stains and scuffs with a piece of fine-grit sandpaper.

Be sure to keep the sauna away from any moisture or weather elements due to the electrical components and the wood being untreated and unstained which can cause damage to your sauna.

Like any outdoor structure, mold can develop as a result of moisture getting trapped inside the sauna. This is especially true for saunas as the bathers will sweat, releasing additional moisture into the air which can be absorbed into the wood. The key to preventing mold from forming is to ensure the inside of the sauna is dry.

After you have finished each sauna session, leave the door fully open so that the wood can dry out. The flooring can be lifted and placed outside to dry faster. Before closing the door, wipe the side of the sauna (walls/roof, benches, flooring, etc.) with a dry towel or cloth to remove any remaining moisture. If you are using your sauna regularly (i.e., multiple times a week), this ventilation should largely prevent mold formation.

If you are not using your sauna regularly, run a dehumidifier and/or fan inside the sauna to keep air circulating (ensure you are emptying the dehumidifier water tank regularly). Also place desiccants (e.g., a commercial desiccant such Damp-Rid or non-commercial desiccant such as charcoal briquettes/kitty litter) on dishes and place them around the inside of the sauna.

If you are seeing mold in the sauna, this should be treated early before it has time to grow and take hold. Clean the affected area to remove the mold. The wood can be cleaned with soapy water, white vinegar, or sodium bicarbonate (baking soda). If you are unable to remove the mold with these solutions, try stronger cleaning agents (such as diluted bleach) or sanding the area with sandpaper. Any rags, etc. that come into contact with the mold must be disposed of. Proper protective equipment (safety goggles, breathing mask, etc.) must be worn when removing mold.

Guarantees

The guarantee period for heaters and control equipment used in saunas by families is two (2) years.

The guarantee period for heaters and control equipment used in saunas by building residents is one (1) year.

The guarantee does not cover any faults resulting from failure to comply with installation, use or maintenance instructions.

The guarantee does not cover any faults resulting from the use of stones not recommended by the heater manufacturer.

Electrical Specifications

Voltage, 50-60 Hz (dedicated circuit)	240 V
Current (amps)	40 A
Wattage	9600 W
Wiring	Hard-wired to a GFCI

A dedicated electrical outlet is required and should be installed with a GFCI by a licensed electrician. Failure to do this will void the warranty.

Limited Residential Warranty

THIS LIMITED RESIDENTIAL WARRANTY (THE “WARRANTY”) IS APPLICABLE ONLY TO SUN HOME PANORAMIC OUTDOOR 4-PERSON, 6-PERSON, AND 8-PERSON SAUNAS (THE “PRODUCT”).

THIS WARRANTY GIVES YOU SPECIFIC LEGAL RIGHTS AND YOU MAY ALSO HAVE OTHER RIGHTS, WHICH VARY FROM STATE TO STATE.

THE WARRANTY CAN ALSO BE FOUND ONLINE AT WWW.SUNHOMESAUNAS.COM/WARRANTY AND IN THE DOCUMENTATION WE PROVIDE WITH THE PRODUCT.

WE LIMIT THE DURATION AND REMEDIES OF ALL IMPLIED WARRANTIES, INCLUDING WITHOUT LIMITATION THE WARRANTIES OF MERCHANTABILITY AND FITNESS FOR A PARTICULAR PURPOSE TO THE DURATION OF THIS EXPRESS LIMITED WARRANTY.

SOME STATES DO NOT ALLOW LIMITATIONS ON HOW LONG AN IMPLIED WARRANTY LASTS, SO THE ABOVE LIMITATION MAY NOT APPLY TO YOU.

OUR RESPONSIBILITY FOR DEFECTIVE GOODS IS LIMITED TO REPLACEMENT OR REFUND AS DESCRIBED BELOW IN THIS WARRANTY STATEMENT.

WHO MAY USE THIS WARRANTY?

FISH & FISCHER, LLC doing business as SUN HOME SAUNAS located at 1804 Garnet Ave, #216, San Diego, CA 92109 (collectively referred to as “**Sun Home**,” “**us**,” “**we**,” or “**our**” as the context may require) extends this limited warranty only to the consumer who originally purchased the product (“**You**” or “**Your**” as the context may require). It does not extend to any subsequent owner or other transferee of the product. This Warranty is limited to customers in the United States and Canada.

WHAT DOES THIS WARRANTY COVER?

With respect to the Product, we warrant during the Warranty Period, as defined below: (a) that the cabinetry will maintain its structural integrity and (b) that factory-installed components (i.e., heater controls, power supply, electrical wiring, and audio system) will be free from defects in material or workmanship. This Warranty covers parts, but does not cover labor and/or service technicians.

WHAT DOES THIS WARRANTY NOT COVER?

This limited warranty does not cover any damage due to: (a) transportation; (b) storage; (c) improper use; (d) failure to follow the product instructions or to perform any preventive maintenance, including failure to maintain the Product on a flat, level, hardtop surface with adequate drainage and to keep the exterior free and clear from plants, trees, grasses, soil, and snow deposits; (e) modifications of any type for any reason (including modification to meet local codes); (f) unauthorized repair; (g) normal wear and tear; (h) cleaning, painting, staining or other use of abrasive or improper chemicals; (i) your or a third party’s negligence; (j) animals, including without limitation, termites and other wood-destroying insects or rodents; (k) connections supplied by the installer of the equipment, an electrician or a third party; (l) improper voltage supply; or (m) external causes such as accidents, abuse, or other actions or events beyond our reasonable control, including, but not limited to, acts of God such as lightning, floods, earthquakes, etc. Surface cracks are not considered defects in material or workmanship, as they are normal characteristics of all woods. This includes minor cracks due to wood expansion and contraction.

This Warranty becomes void if the Product has been subject to commercial use. For the purposes of this Warranty, “commercial use” shall mean any use that involves a fee, rate, charge, or other consideration, any use directly or indirectly in connection with a business, going concern, or undertaking intended for profit or pecuniary gain.

This Warranty becomes void if the Product has been subject to commercial use. For the purposes of this Warranty, “commercial use” shall mean any use that involves a fee, rate, charge, or other consideration, any use directly or indirectly in connection with a business, going concern, or undertaking intended for profit or pecuniary gain.

For Products placed outdoors, failure to utilize the water-resistant cover included with the Product as additional water protection for your Product, the included Roof Tie-Down Security System, or the included door latch apparatus will void your Warranty.

WHAT IS THE PERIOD OF COVERAGE?

This limited warranty starts on the date of your purchase and lasts for one year (the “**Warranty Period**”). The Warranty Period is not extended if we replace the product. We may change the availability of this limited warranty at our discretion, but any changes will not be retroactive.

Your sales receipt showing the date of purchase of the product is your proof of purchase. Any evidence of alteration, erasing or forgery of proof of purchase documents will be cause to void this Warranty. Products on which the serial number has been defaced or removed are not eligible for warranty service.

WHAT ARE YOUR REMEDIES UNDER THIS WARRANTY?

With respect to any defective product during the Warranty Period, we will, in our sole discretion, either: (a) replace such product (or the defective part) free of charge or (b) refund the purchase price of such product. Freight charges to and from you are your responsibility and are not covered under this Warranty. This includes freight charges for parts shipped to enable the services of the Product.

HOW DO YOU OBTAIN WARRANTY SERVICE?

To obtain warranty service, you must call 1-844-728-6200 or email our Customer Service Department at info@sunhomesaunas.com during the Warranty Period.

LIMITATION OF LIABILITY

THE REMEDIES DESCRIBED ABOVE ARE YOUR SOLE AND EXCLUSIVE REMEDIES AND OUR ENTIRE LIABILITY FOR ANY BREACH OF THIS LIMITED WARRANTY. OUR LIABILITY SHALL UNDER NO CIRCUMSTANCES EXCEED THE ACTUAL AMOUNT PAID BY YOU FOR THE DEFECTIVE PRODUCT, NOR SHALL WE UNDER ANY CIRCUMSTANCES BE LIABLE FOR ANY CONSEQUENTIAL, INCIDENTAL, SPECIAL OR PUNITIVE DAMAGES OR LOSSES, WHETHER DIRECT OR INDIRECT.

SOME STATES DO NOT ALLOW THE EXCLUSION OR LIMITATION OF INCIDENTAL OR CONSEQUENTIAL DAMAGES, SO THE ABOVE LIMITATION OR EXCLUSION MAY NOT APPLY TO YOU.

WHAT CAN YOU DO IN CASE OF A DISPUTE WITH US?

The following informal dispute resolution procedure is available to you if you believe that we have not performed our obligations under this limited warranty:

DISPUTE RESOLUTION AND BINDING ARBITRATION.

(a) **YOU AND SUN HOME ARE AGREEING TO GIVE UP ANY RIGHTS TO LITIGATE CLAIMS IN A COURT OR BEFORE A JURY, OR TO PARTICIPATE IN A CLASS ACTION OR REPRESENTATIVE ACTION WITH RESPECT TO A CLAIM. OTHER RIGHTS THAT YOU WOULD HAVE IF YOU WENT TO COURT MAY ALSO BE UNAVAILABLE OR MAY BE LIMITED IN ARBITRATION.**

ANY CLAIM, DISPUTE OR CONTROVERSY (WHETHER IN CONTRACT, TORT OR OTHERWISE, WHETHER PRE-EXISTING, PRESENT OR FUTURE, AND INCLUDING STATUTORY, CONSUMER PROTECTION, COMMON LAW, INTENTIONAL TORT, INJUNCTIVE AND EQUITABLE CLAIMS) BETWEEN YOU AND US ARISING FROM OR RELATING IN ANY WAY TO YOUR PURCHASE OF PRODUCTS THROUGH THE SITE, WILL BE RESOLVED EXCLUSIVELY AND FINALLY BY BINDING ARBITRATION.

(b) The arbitration will be administered by the American Arbitration Association ("**AAA**") in accordance with the Consumer Arbitration Rules (the "**AAA Rules**") then in effect, except as modified by this Section . (The AAA Rules are available at adr.org or by calling the AAA at 1-800-778-7879.) The Federal Arbitration Act will govern the interpretation and enforcement of this section.

The arbitrator will have exclusive authority to resolve any dispute relating to arbitrability and/or enforceability of this arbitration provision, including any unconscionability challenge or any other challenge that the arbitration provision or the Agreement is void, voidable or otherwise invalid. The arbitrator will be empowered to grant whatever relief would be available in court under law or in equity. Any award of the arbitrator(s) will be final and binding on each of the parties and may be entered as a judgment in any court of competent jurisdiction.

If you elect to file the arbitration, and this is a consumer-purpose transaction, you will pay the filing fee to the extent required by AAA's Consumer Arbitration Rules but not to exceed the cost of filing a lawsuit. Any amount above what it would cost you to file a lawsuit, we will pay. All other arbitration fees and expenses shall be allocated to us according to AAA rules. Except for the arbitration fees and expenses, each party shall pay its own costs and fees incurred (including attorneys' fees), unless the arbitrator allocates them differently in accordance with applicable law. This paragraph applies only if this is a consumer-purpose transaction.

The arbitration will be administered by the American Arbitration

(c) You may elect to pursue your claim in small-claims court rather than arbitration if you provide us with written notice of your intention to do so within 30 days of your purchase. The arbitration or small-claims court proceeding will be limited solely to your individual dispute or controversy.

(d) You agree to an arbitration on an individual basis. In any dispute, **NEITHER YOU NOR SUN HOME WILL BE ENTITLED TO JOIN OR CONSOLIDATE CLAIMS BY OR AGAINST OTHER CUSTOMERS IN COURT OR IN ARBITRATION OR OTHERWISE PARTICIPATE IN ANY CLAIM AS A CLASS REPRESENTATIVE, CLASS MEMBER OR IN A PRIVATE ATTORNEY GENERAL CAPACITY.** The arbitral tribunal may not consolidate more than one person's claims, and may not otherwise preside over any form of a representative or class proceeding. The arbitral tribunal has no power to consider the enforceability of this class arbitration waiver and any challenge to the class arbitration waiver may only be raised in a court of competent jurisdiction.

If any provision of this arbitration agreement is found unenforceable, the unenforceable provision will be severed, and the remaining arbitration terms will be enforced.