



Dear Pet Lover,

Thank you for choosing GuineaLoft™ Cheese House Single!

Need Help? Missing or Broken Parts? Email us:
GUINEALOFT@GMAIL.COM



Scan the QR Code to find How to Install video.

REMEMBER TO PEEL



Use a scratcher.



Scratch up an edge.

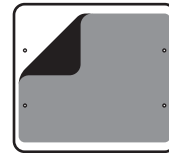

Peel off the unclear protection film.

PACKING LIST

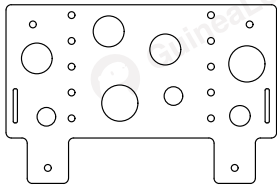

Back Panel x 1



Clear Front Panel x 1



Door Panels x 2

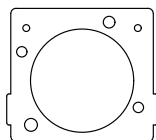

Side Panels x 2

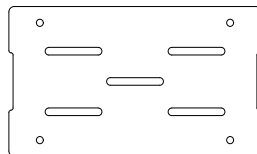

Bottom Panel x 1

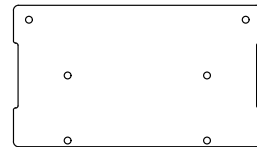

Top Panel x 1



L2 Brackets x 6



L3 Brackets x 2



H2 Hinges x 2

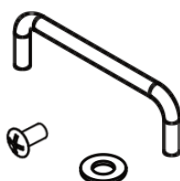

Bar Handle x 1
M6 12mm Screws x 2
M6 12mm Gaskets x 2



M5 6mm Thumb Screws x 2



M5 6mm Screws x 20

HOW TO INSTALL

1

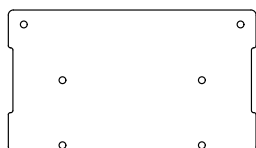

x 1

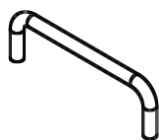

x 1



x 2



x 2

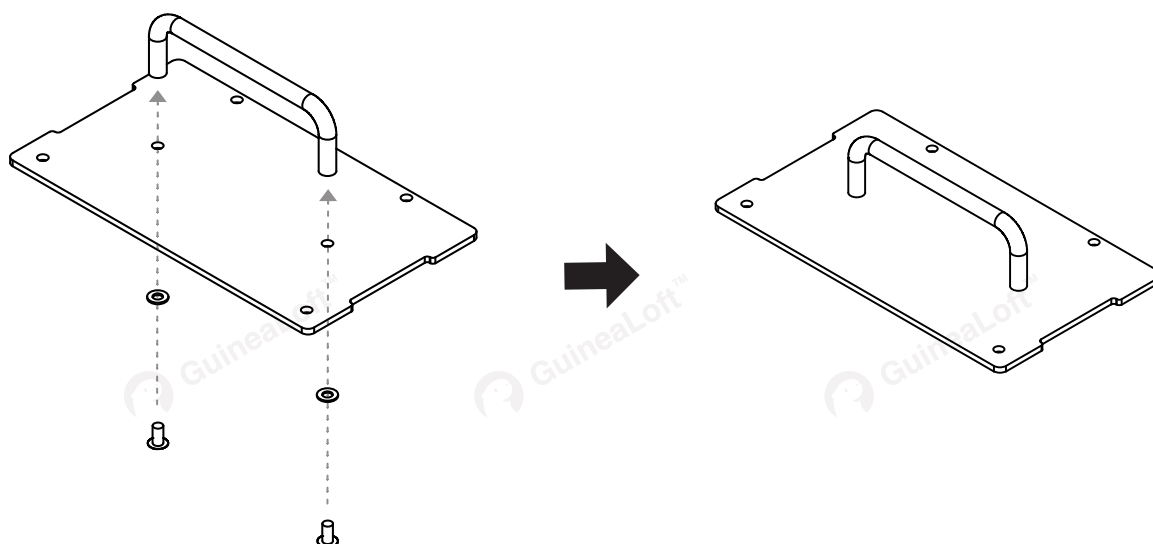

2

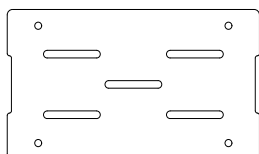

x 1



x 4



x 4

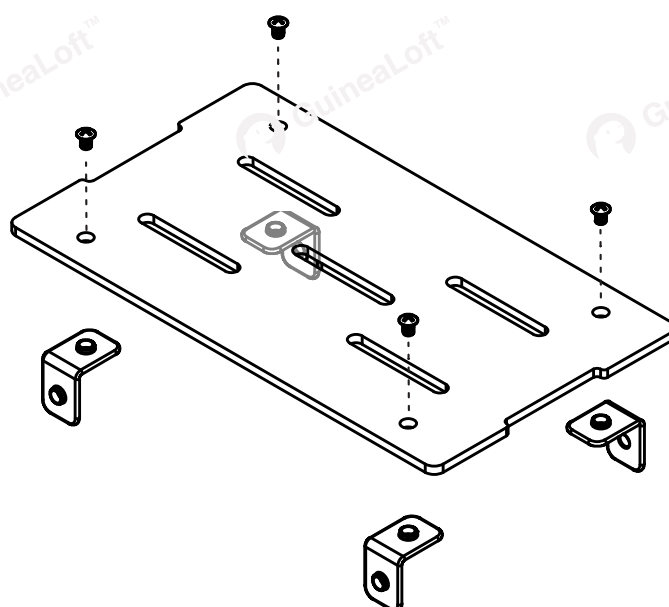

HOW TO INSTALL

3

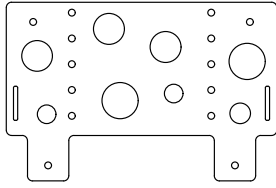

x 1



x 2



x 4

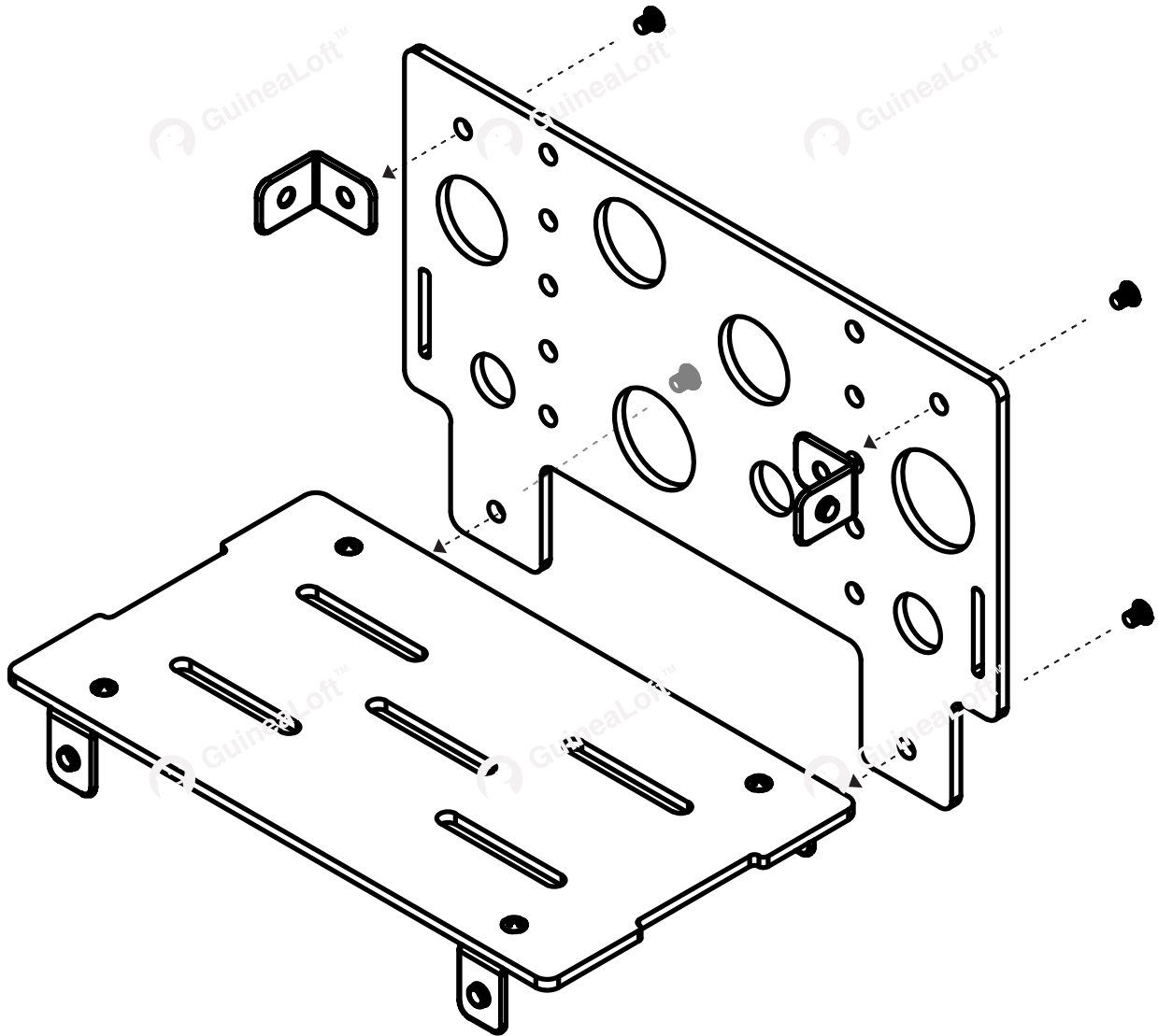

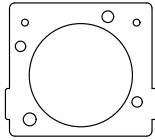

× 2



× 2



× 4

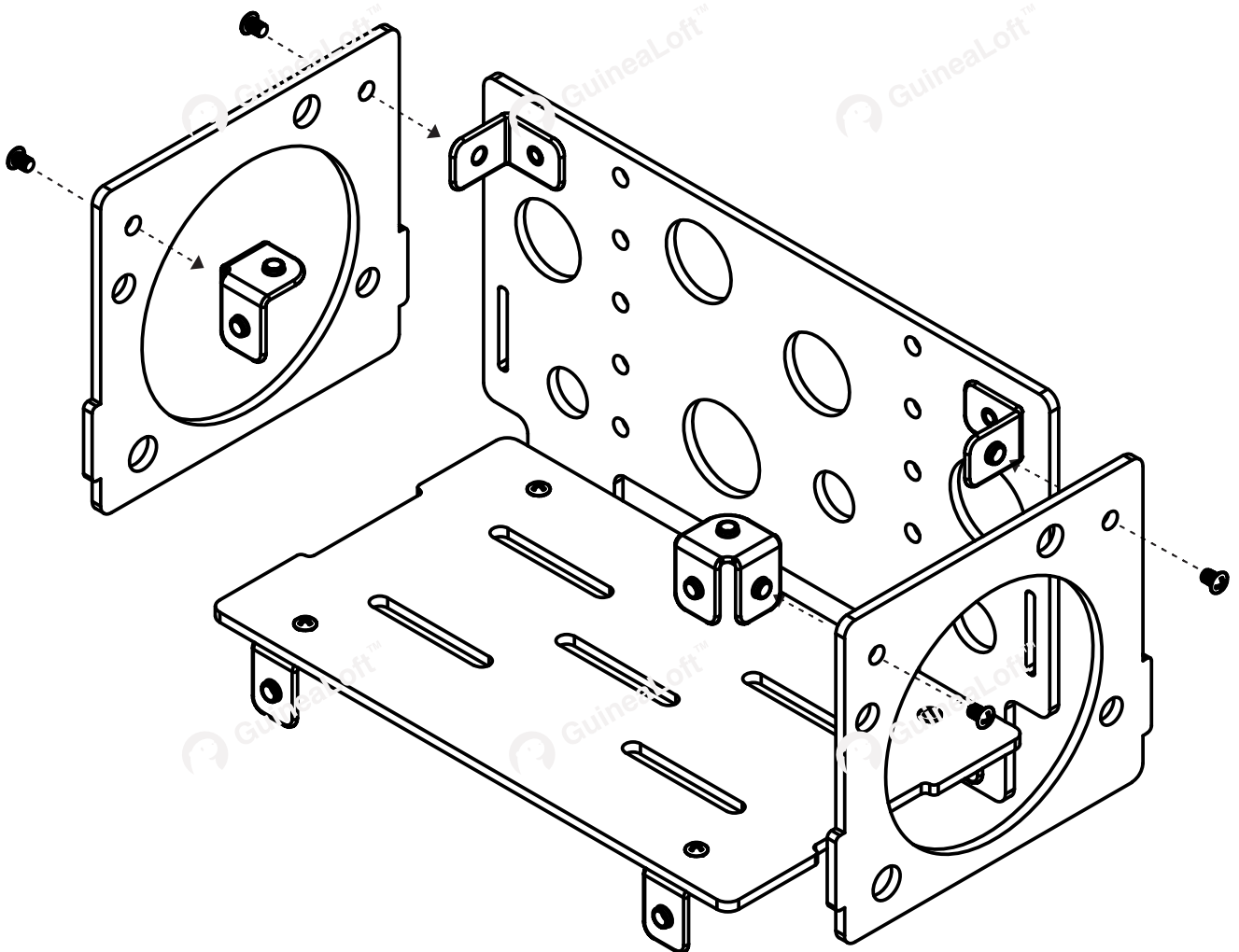

HOW TO INSTALL

5

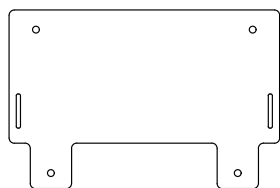

x 1



x 4

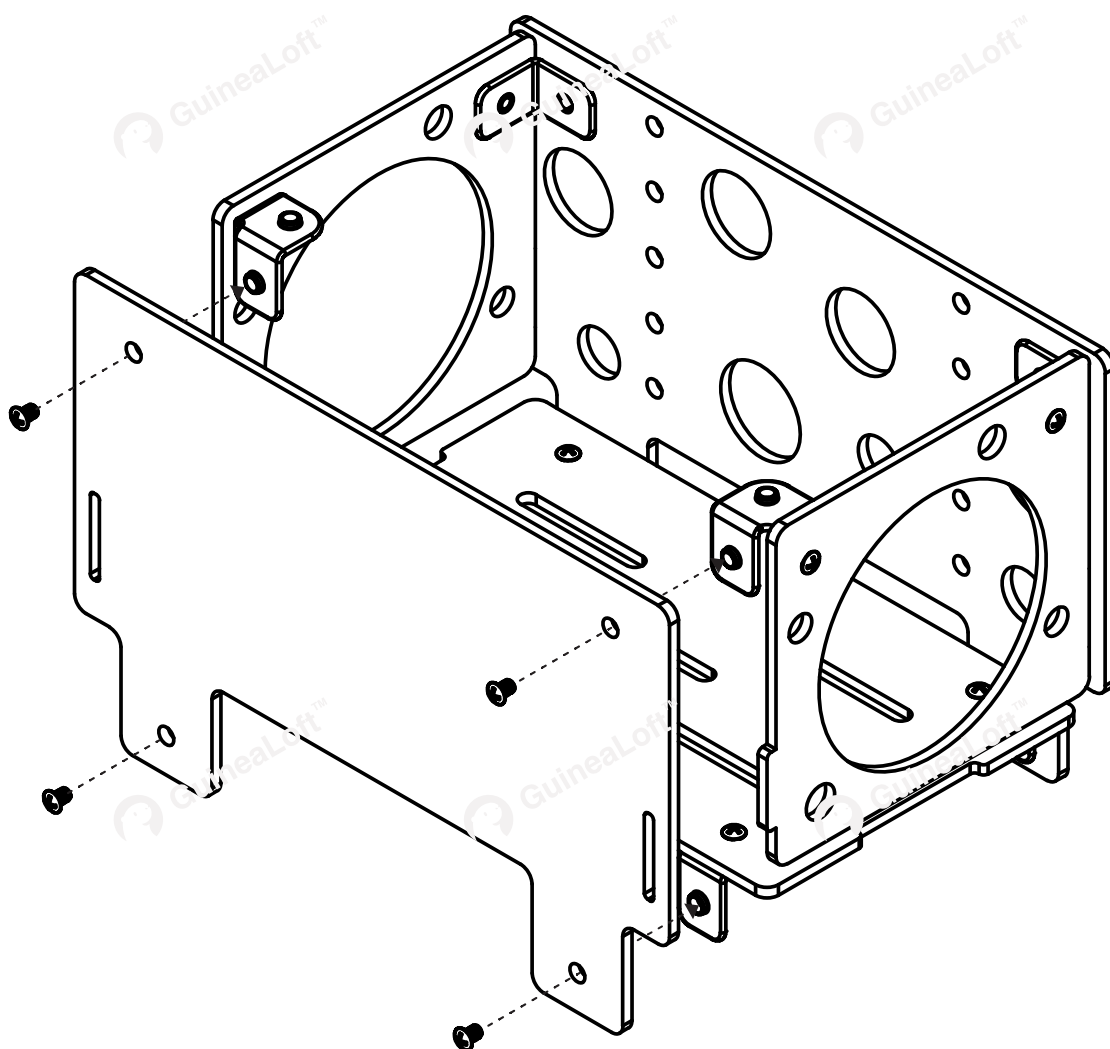

HOW TO INSTALL

6

1

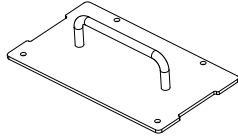

x 1



x 2



x 4

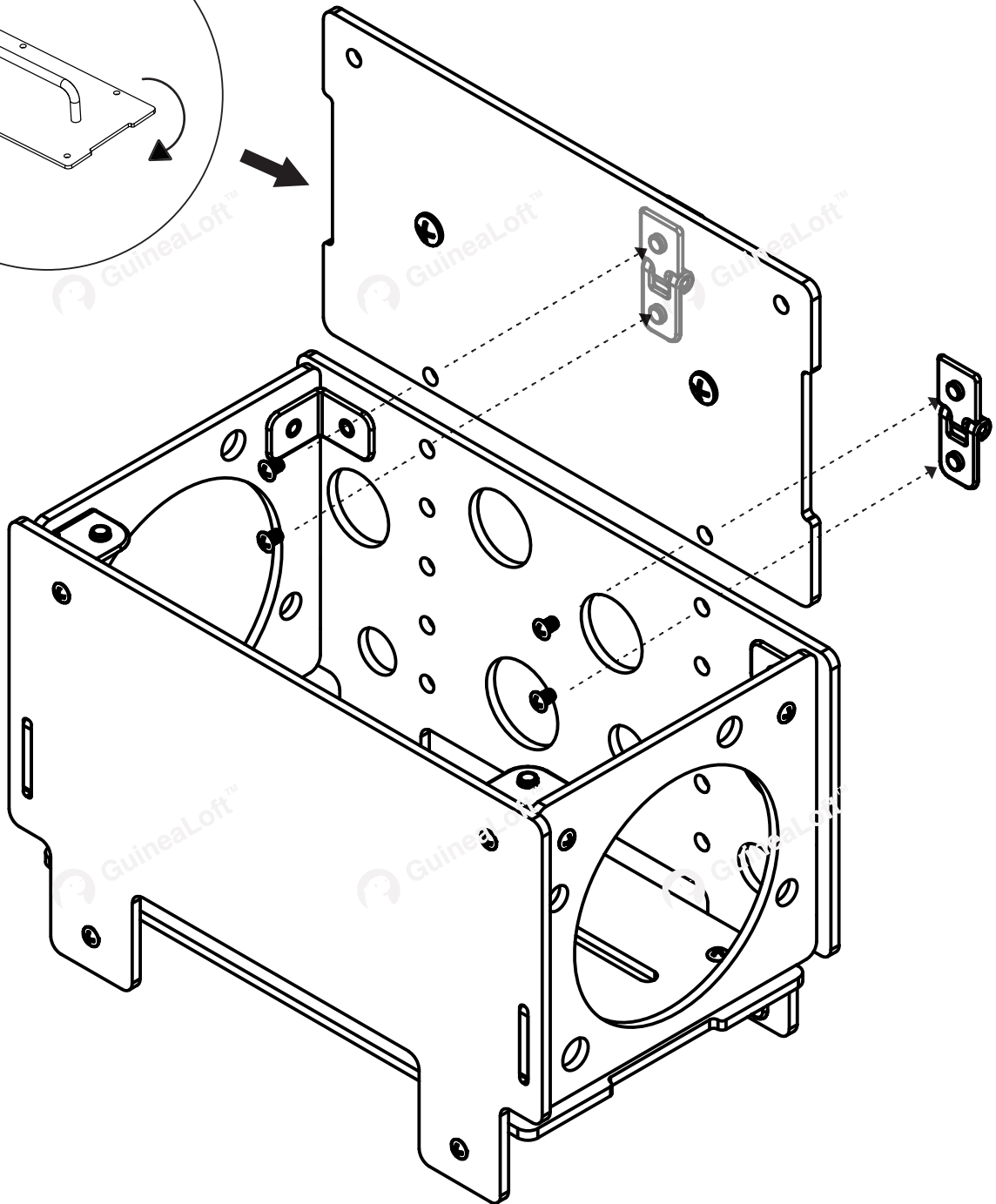
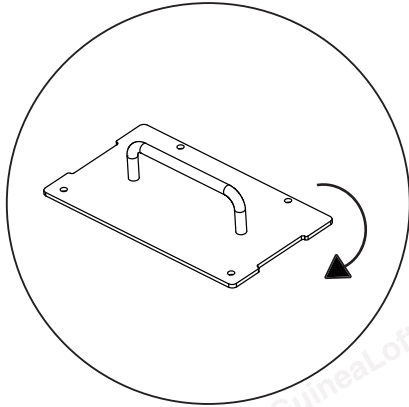

HOW TO INSTALL

7

