

WORKPRO

ORIGINAL SAFETY AND OPERATING INSTRUCTIONS 20V ELECTRIC DRAIN AUGER

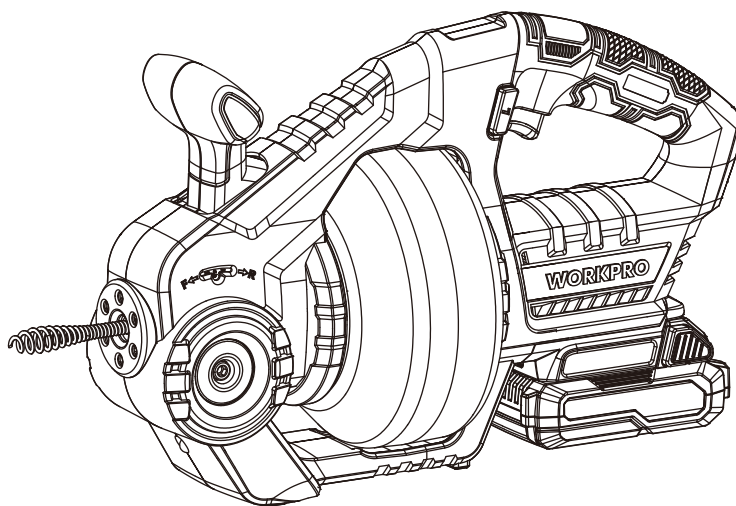

Thank you for buying a WORKPRO 20V Electric Drain Auger. Your new 20V Electric Drain Auger has been engineered and manufactured to WORKPRO's high standard for dependability, ease of operation, and operator safety. Properly cared for, it will give you years of rugged, trouble-free performance.



WARNING: To reduce the risk of injury, the user must read and understand the operator's manual.

SAVE THIS MANUAL FOR FUTURE REFERENCE



Distributed by
Hangzhou GreatStar Industrial Co., Ltd.
No.35 Jiuhuan Road, Jiubao Town,
Hangzhou 310019, China
www.greatstartools.com

Made in China

Fig. 1

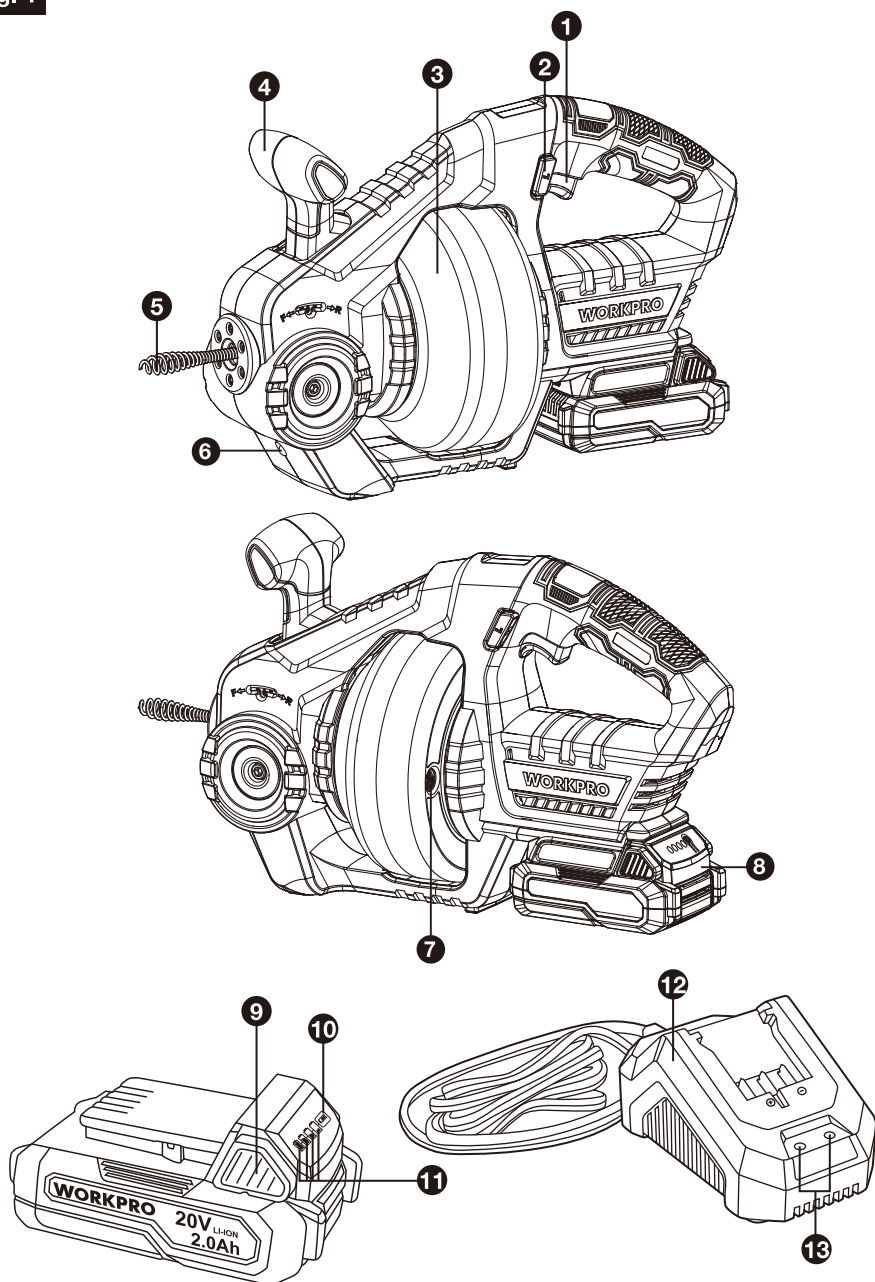

Introduction

You may use this product for the purposes listed below: Clearing obstructions from sinks and bathtubs.

The device is intended for use by adults. Never allow people who are not familiar with the instructions or children to use the machine. Local regulations may specify an age limit for the user.

This product is not intended for commercial use. Generally acknowledged accident prevention regulations and enclosed safety instructions must be observed.

Only perform work described in these instructions for use. Any other use is improper. The manufacturer will not assume responsibility for damage resulting from such use.

Danger!

When using the equipment, a few safety precautions must be observed to avoid injuries and damage. Please read the complete operating instructions and safety regulations with due care. Keep this manual in a safe place, so that the information is available at all times. If you give the equipment to any other person, hand over these operating instructions and safety regulations as well. We cannot accept any liability for damage or accidents which arise due to a failure to follow these instructions and the safety instructions.

1. General power tool safety warning

Warning!

Read all safety warnings, instructions, illustrations and specifications provided with this power tool. Failure to follow all instructions listed below may result in electric shock, fire and/or serious injury.

Save all warnings and instructions for future reference.

The term "power tool" in the warnings refers to your mains-operated (corded) power tool or battery-operated (cordless) power tool.

1) Work area safety

- **Keep work area clean and well lit.** Cluttered or dark areas invite accidents.
- **Do not operate power tools in explosive atmospheres, such as in the presence of flammable liquids, gases or dust.** Power tools create sparks which may ignite the dust or fumes.
- **Keep children and bystanders away while operating a power tool.** Distractions can cause you to lose control.

2) Electrical safety

- **Power tool plugs must match the outlet. Never modify the plug in any way.** Do not use any adapter plugs with earthed (grounded) power tools. Unmodified plugs and matching outlets will reduce risk of electric shock.
- **Avoid body contact with earthed or grounded surfaces, such as pipes, radiators, ranges and refrigerators.** There is an increased risk of electric shock if your body is earthed or grounded.
- **Do not expose power tools to rain or wet conditions.** Water entering a power tool will increase the risk of electric shock.
- **Do not abuse the cord. Never use the cord for carrying, pulling or unplugging the power tool.** Keep cord away from heat, oil, sharp edges or moving parts. Damaged or entangled cords increase the risk of electric shock.

- **When operating a power tool outdoors, use an extension cord suitable for outdoor use.** Use of a cord suitable for outdoor use reduces the risk of electric shock.
- **If operating a power tool in a damp location is unavoidable, use a residual current device (RCD) protected supply.** Use of an RCD reduces the risk of electric shock.

3) Personal safety

- **Stay alert, watch what you are doing and use common sense when operating a power tool.** Do not use a power tool while you are tired or under the influence of drugs, alcohol or medication. A moment of inattention while operating power tools may result in serious personal injury.
- **Use personal protective equipment. Always wear eye protection.** Protective equipment such as a dust mask, non-skid safety shoes, hard hat or hearing protection used for appropriate conditions will reduce personal injuries.
- **Prevent unintentional starting. Ensure the switch is in the off-position before connecting to power source and/or battery pack, picking up or carrying the tool.** Carrying power tools with your finger on the switch or energising power tools that have the switch on invites accidents.
- **Remove any adjusting key or wrench before turning the power tool on.** A wrench or a key left attached to a rotating part of the power tool may result in personal injury.
- **Do not overreach.** Keep proper footing and balance at all times. This enables better control of the power tool in unexpected situations.
- **Dress properly.** Do not wear loose clothing or jewellery. Keep your hair and clothing away from moving parts. Loose clothes, jewellery or long hair can be caught in moving parts.
- **If devices are provided for the connection of dust extraction and collection facilities, ensure these are connected and properly used.** Use of dust collection can reduce dust-related hazards.
- **Do not let familiarity gained from frequent use of tools allow you to become complacent and ignore tool safety principles.** A careless action can cause severe injury within a fraction of a second.

4) Power tool use and care

- **Do not force the power tool.** Use the correct power tool for your application. The correct power tool will do the job better and safer at the rate for which it was designed.
- **Do not use the power tool if the switch does not turn it on and off.** Any power tool that cannot be controlled with the switch is dangerous and must be repaired.

- **Disconnect the plug from the power source and/or remove the battery pack, if detachable, from the power tool before making any adjustments, changing accessories, or storing power tools.** Such preventive safety measures reduce the risk of starting the power tool accidentally.
- **Store idle power tools out of the reach of children and do not allow persons unfamiliar with the power tool or these instructions to operate the power tool.** Power tools are dangerous in the hands of untrained users.
- **Maintain power tools and accessories. Check for misalignment or binding of moving parts, breakage of parts and any other condition that may affect the power tool's operation.** If damaged, have the power tool repaired before use. Many accidents are caused by poorly maintained power tools.
- **Keep cutting tools sharp and clean.** Properly maintained cutting tools with sharp cutting edges are less likely to bind and are easier to control.
- **Use the power tool, accessories and tool bits etc.** In accordance with these instructions, taking into account the working conditions and the work to be performed. Use of the power tool for operations different from those intended could result in a hazardous situation.
- **Keep handles and grasping surfaces dry, clean and free from oil and grease.** Slippery handles and grasping surfaces do not allow for safe handling and control of the tool in unexpected situations.

5) Service

- Have your power tool serviced by a qualified repair person using only identical replacement parts. This will ensure that the safety of the power tool is maintained.

6) Battery tool use and care

- a. Ensure the switch is in the off position before inserting battery pack. Inserting the battery pack into power tools that have the switch on invites accidents.
- b. Recharge only with the charger specified by the manufacturer. A charger that is suitable for one type of battery pack may create a risk of fire when used with another battery pack.
- c. Use power tools only with specifically designated battery packs. Use of any other battery packs may create a risk of injury and fire.

- d. When battery pack is not in use, keep it away from other metal objects like paper clips, coins, keys, nails, screws, or other small metal objects that can make a connection from one terminal to another.
Shorting the battery terminals together may cause burns or a fire.
- e. Under abusive conditions, liquid may be ejected from the battery; avoid contact. If contact accidentally occurs, flush with water. If liquid contacts eyes, additionally seek medical help. Liquid ejected from the battery may cause irritation or burns.

ADDITIONAL SAFETY INSTRUCTIONS FOR THE CHARGER

Your WORKPRO tool with Lithium Ion batteries may only be charged with the specific designed WORKPRO Lithium Ion battery charger purchased with the tool.

IT IS DANGEROUS TO USE ANY OTHER BATTERY CHARGER TO CHARGE YOUR TOOL. Do not attempt to charge the battery pack with any other charger than the one supplied.

Before using the charger, read all the instructions, labels and cautionary markings on the charger and battery pack as well as the instructions on using the battery pack.

Do not use the charger if it has been subjected to a heavy knock, dropped or otherwise damaged in anyway. Take the charger to an authorised service centre for a check or repair.

Do not disassemble the charger. Opening or removing covers may expose you to dangerous voltages or other risks. Incorrect reassembly can cause electric shock when you use the tool or charger again. Take the charger to a power tool repair centre when service or repair is required.

 **DANGER.** If the battery pack is cracked or damaged in any other way, do not insert it in the charger.

Do not plug anything other than your WORKPRO tool into the charger, as other objects may touch dangerous voltage points or short out parts, which could result in fire or electric shock.

Do not place the tool or charger on an uneven surface, as a fall may cause serious damage.

Never place the tool or charger near or over a heat source such as a radiator or heater.

Do not operate the charger in a cabinet or other enclosure unless proper ventilation is provided.

Use the battery charger indoors only.

WARNING!

Do not allow any liquid to come into contact with the charger. There is a danger of electric shock. Do not position the tool or battery charger near water; for example, near a sink, wash bowl or toilet. Do not spill liquid of any kind on the tool or charger. Doing so may short out parts, causing damage to the product and creating the risk of fire or electric shock.

To reduce the risk of an electric shock, unplug the charger from the power supply before attempting to clean it. To clean tool or charger, wipe with a damp cloth. Use of any other cleaners is not recommended.

Do not place any object on to, or allow anything to rest on the charger.

Make sure that the charger cable is positioned where it will not be stepped on, tripped over or otherwise subjected to damage or stress. Keep the lead away from operating machinery.

Do not pull on the lead of the charger to disconnect it from the mains power socket.

Do not use an extension cord unless it is absolutely necessary. The use of an improper extension cord could cause the risk of fire, electric shock or electrocution.

Never attempt to connect two chargers together.

Do not charge batteries or use the tool and battery pack in locations where the temperature may be below 40°F(4°C) or exceed 104°F(40°C) such as alongside sheds or metal structures.

If you wish to charge a second battery pack, unplug the charger from the mains supply and leave it for at least 15 minutes. After this time you can charge a second battery pack.

ADDITIONAL SAFETY INSTRUCTIONS RELATED TO THE BATTERY PACK AND BATTERY SAFETY

Use only the WORKPRO batteries supplied with the WORKPRO Tool or WORKPRO-approved replacements.

Do not use the battery to power any device other than the WORKPRO tool it was sold with.

Charge the battery only with the WORKPRO charger supplied with the tool or WORKPRO-approved replacements and according to the instructions in the WORKPRO Instruction Manual.

Do not charge the battery in a place where static electricity is generated nor let the battery touch something that is statically charged.

The battery can be stored at temperatures between 40°F(4°C) and 104°F(40°C).

Never store or leave your lithium ion battery in temperatures over that recommended otherwise fire may occur.

DO NOT store the Lithium Ion battery anywhere that the temperature can easily reach higher temperatures than recommended -this includes garden type sheds, and Vehicles where the inside temperature can climb to dangerous levels in the direct sunlight and on high temperature days. **THINK BEFORE LEAVING YOUR LITHIUM ION BATTERY PACK IN STORAGE.**

The battery can be charged or operated at temperatures between 40°F(4°C) and 104°F(40°C). **NEVER CHARGE YOUR LITHIUM ION BATTERY BELOW OR ABOVE TEMPERATURES RECOMMENDED OTHERWISE FIRE OR SERIOUS DAMAGE TO THE BATTERY PACK MAY OCCUR.**

The most suitable temperatures to charge the battery pack are between 68°F(20°C) -77°F(25°C).

Always allow the battery pack to cool down after charging, do not place it in a hot environment such as a metal shed or open trailer left in the sun.

Take care where the tool is stored. Do not store in areas of corrosive fumes, or salt air or similar conditions. Try and store the tool in the packaging supplied with the tool.

Do not dispose of the battery in a fire or put the battery into a microwave oven, conventional oven, dryer, or high-pressure container. Under these conditions, the battery may explode.

Never attempt to open the battery pack, puncture the battery or subject the battery to strong physical shock.

If the plastic housing of the battery pack breaks open or cracks, immediately discontinue its use and do not recharge it. Ensure the battery pack clip is in good condition and will not allow the pack to fall free from the tool. If the clip is damaged or for any reason is not locking the pack in place, Do Not continue to use.

Stop using the battery if it exhibits abnormal heat, odour, colour, deformation, or is in an abnormal condition.

If you detect leakage or a foul odour, it is especially important to keep the battery away from fire. If battery liquid leaks onto your skin or clothes, wash well with clean water immediately. If liquid leaking from the battery gets into your eyes, do not rub your eyes. Rinse your eyes well (for at least 10 minutes) with clean water, and consult a doctor immediately.

Do not use a leaking battery.

Handle batteries with care to avoid shorting the battery with conducting materials, such as nails, screws, metal watch bands, rings, bracelets, and keys. The battery may overheat and could burn you.

After the battery has reached the end of its useful life, we recommend recycling the materials at your local municipal council recycling centre. DO NOT attempt to replace the battery cells in the battery pack, repair or modify any part of the battery pack assembly.

When recycling, make it nonconductive by applying insulating tape to the terminals located on the battery.

WHEN TO CHARGE THE BATTERY

New batteries are shipped in a low charged condition and should be fully charged before Use. The battery pack can be recharged at any time during use, provided the pack is not overheated.

If the battery pack starts to cut out due to low voltage, or previous tasks undertaken can no longer be performed, it is suggested to stop using the tool and recharge the battery.

For storage, it is suggested to recharge the battery between 50% and 75% charge.

Charge the device at least once in 3-6 months to preserve battery life span.

2. DRAIN AUGER SAFETY WARNINGS

- Always wear safety goggles or eye protection with side shields marked to comply with ANSI Z87.1 when assembling parts, operating the tool, or performing maintenance. Following this rule will reduce the risk of serious personal injury.
- Position the the drain auger within four inches of the drain or inlet being cleared. Operating the tool at greater distances can result in the cable twisting or binding.
- Avoid running the tool in reverse for extended periods of time as this can damage the cable.
- Never place your hand near the drum or the cable as it is rotating. Following this rule will reduce the risk of serious personal injury.
- Clogged drains may contain bacteria, cleaning solutions, or other potentially harmful substances. Always wear protective clothing, eye protection, and gloves while operating this tool to prevent these substances from contacting your skin and eyes.
- When removing the cable from a drain, remove it slowly to avoid "splash back". Use warm, soapy water to clean hands and other body parts that may have been exposed to potentially harmful substances.
- Carefully position the power cord during use. A power cord in your walking path can be a tripping hazard.
- Battery tools do not have to be plugged into an electrical outlet; therefore, they are always in operating condition. Be aware of possible hazards when not using your battery tool or when changing accessories. Following this rule will reduce the risk of electric shock, fire, or serious personal injury.

- Do not place battery tools or their batteries near fire or heat. This will reduce the risk of explosion and possibly injury.
- Do not crush, drop or damage battery pack. Do not use a battery pack or charger that has been dropped or received a sharp blow. A damaged battery is subject to explosion. Properly dispose of a dropped or damaged battery immediately.
- Batteries can explode in the presence of a source of ignition, such as a pilot light. To reduce the risk of serious personal injury, never use any cordless product in the presence of open flame. An exploded battery can propel debris and chemicals. If exposed, flush with water immediately.
- Do not charge battery tool in a damp or wet location. Do not use, store, or charge battery packs or products in locations where the temperature is less than 50°F or more than 100°F. Do not store outside or in vehicles.
- Under extreme usage or temperature conditions, battery leakage may occur. If liquid comes in contact with your skin, wash immediately with soap and water. If liquid gets into your eyes, flush them with clean water for at least 10 minutes, then seek immediate medical attention. Following this rule will reduce the risk of serious personal injury.
- Save these instructions. Refer to them frequently and use them to instruct others who may use this tool. If you loan someone this tool, loan them these instructions also.

3. Symbols

Danger notices and information are clearly marked throughout these instructions for use. The following symbols are used:



Hazard symbols with information on prevention of personal injury and property damage.



Precaution symbol with information on prevention of harm / damage.



Notice symbol with information on how to handle the device properly.



Double insulated for additional protection.



Do not expose to rain or water



Do not burn



Read these operating instructions well before you use the tool.



Protect the tool from the damp and never expose it to rain

These symbols identify the required personal protection equipment:



Wear safety goggles



Wear protective gloves

4. Know your product

- 1.Variable Speed Switch Trigger
- 2.Forward/Reverse Lever
- 3.Drum
- 4.Front Operating Handle
- 5.Cable
- 6.LED Work Light
- 7.Rear Drain Port
- 8.Battery Pack
- 9.Battery pack release button
- 10.Battery capacity indicator switch
- 11.Battery capacity indicator
- 12.Battery charger
- 13.Control light

5. TECHNICAL DATA

MODEL NO.	W125241A
20V Electric Drain Auger	
No Load Speed	0-560rpm
Cable Diameter	0.275in(7mm)
Cable Length	25ft (7.6m)
Minimum Pipe Size(diameter)	0.75in (19mm)
Maximum Pipe Size(diameter)	2in (51mm)
Bare Tool Weight	7.9lbs (3.6kg)
BATTERY CHARGER	
Rated voltage	120V~, 50-60 Hz
Rated power	70W
Charge voltage	20 V
Charge current	2.4 A
Protection class	□ / II
BATTERY PACK	
Battery pack type	Li-Ion
Rated voltage	Maximum 20 V Nominal 18 V
Capacity	2000 mAh
Charging time	60 min

6. ASSEMBLY

⚠ Warning:

Do not use this product if it is not completely assembled or if any parts appear to be missing or damaged. Use of a product that is not properly and completely assembled or with damaged or missing parts could result in serious personal injury.

⚠ Warning:

Do not attempt to modify this product or create accessories or attachments not recommended for use with this product. Any such alteration or modification is misuse and could result in a hazardous condition leading to possible serious personal injury.

7. OPERATION

1) Charging the battery pack (see FIG 2,3,4)

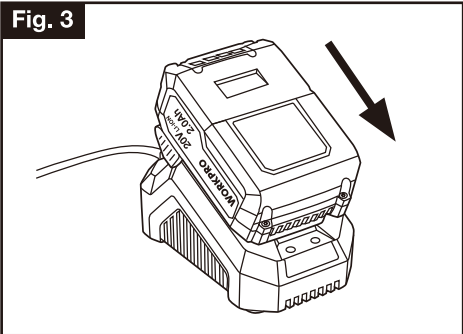
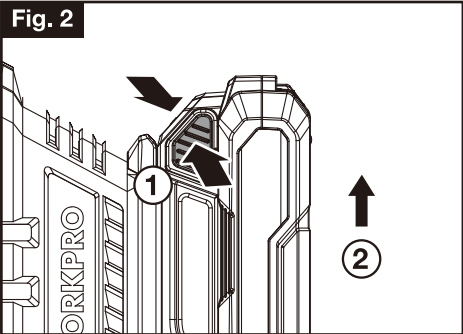
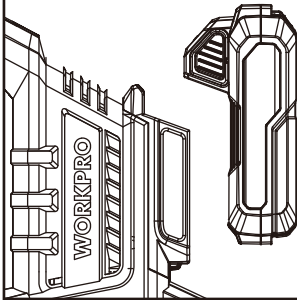

Fig. 4



CAUTION! Risk of injury! Comply with all safety instructions when handling rechargeable devices.



NOTICE! Risk of damage to the unit! Do not allow the battery pack to deep discharge.



NOTICE! Risk of damage to the unit! Do not press the On/Off switch after the device has deactivated automatically.



Note: The Li-Ion battery pack can be charged at any time without affecting the lifetime of the unit. Interrupting the charging process will not damage the battery pack.



Note: If the battery is fully loaded, the charger automatically switches over to the maintenance charge function. The battery can thus remain in the charger permanently.

The battery pack must be charged prior to the first start-up. (charging time: around 60 minutes.)

- Press in the battery pack release button and remove the battery from the device.
- Insert the battery pack into the charger .
- Plug the charger into the power supply.
The charging status is displayed by the control lights .(more information refer to Charger Indicator section)
- Slot the battery pack into the device and make sure it clicks into place correctly.

Battery Pack Fuel Gauge

Press the battery capacity indicator switch. The battery capacity indicator shows the charge status of the battery using 4 LEDs.

All 4 LEDs are lit:

The battery is fully charged.

3 or 2 or 1 LED(s) are lit:

The battery has an adequate remaining charge.

1 LED blinks:

The battery is empty, recharge the battery.

All LEDs blink:

The battery pack is too hot (e.g. due to direct sunshine or prolonged use) or too cold (below 32°F/0°C). Do not use or charge the battery pack. make sure the battery temperature to between 40°F(4°C) and 104°F(40°C).

2) Variable Speed Switch Trigger (Fig.5)

Fig. 5

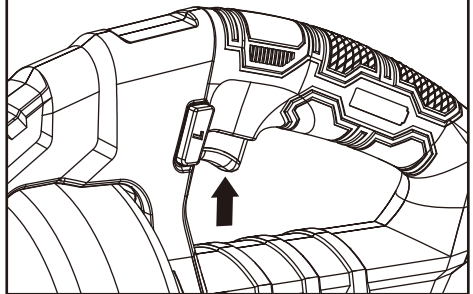

The variable speed switch trigger delivers higher speed with increased trigger pressure and lower speed with decreased trigger pressure.

To turn the tool ON, depress the switch trigger. To turn it OFF, release the switch trigger and allow the cable to come to a complete stop.

NOTE: Lock the switch trigger by placing the Direction Of Rotation Selector in center position.

3) LED Work Light (Fig.6)

When depress the switch trigger, the LED work light ON, when the switch trigger is released, the LED work light will be shutoff automatically in a few seconds.

Fig. 6

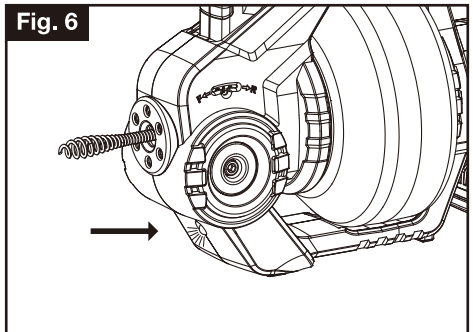

4) Direction Of Rotation Selector (Fig.7)

Position the direction of Forward/Reverse Lever to the left of the switch trigger (press the R) for clockwise rotation.

Position the direction of Forward/Reverse Lever to the right of the switch trigger (press the L) for counterclockwise rotation.

NOTICE:

To prevent gear damage, always allow the cable to come to a complete stop before changing the direction of rotation.

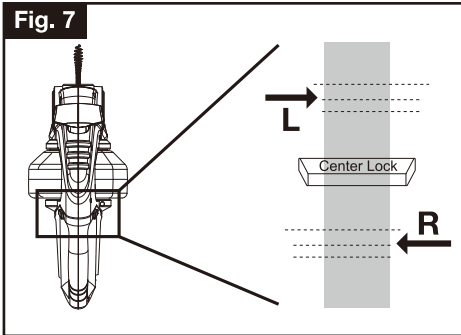

5) Advancing/Retracting The Cable (Fig.8)

To advance the cable manually:

Set the front operation handle on the position of "C".

Hold the tool body by one hand and advance the cable with the other.

To retract the cable, hold the tool body with one hand and pull the cable back with the other. (If set the front operation handle on the position of "C", using the switch trigger, the cable stops advance or retract, no matter in forward or reverse rotation.)

NOTE: Always wear gloves when advancing/retracting the cable manually.

To advance the cable using the switch trigger:

Place the direction of forward/reverse lever in forward position (press the R).

Set the front operation handle on the position of "F".

Squeeze and hold the switch trigger to advance the cable.

To retract the cable use the switch trigger:

Place the direction of forward/reverse lever in forward position (press the R).

Set the front operation handle on the position of "R".

Squeeze and hold the switch trigger to retract the cable.

If the cable is trapped in the pipe that is, it can not dredge or be retracted, press the forward/reverse level to "L", then set the front operation handle on the position of "F" to retract the cable. (Only use this setting when the cable is twisted, knotted or can not be retracted in the pipe etc.)

If set the front operation handle on the position of "C", using the switch trigger, the cable stops advance or retract, no matter in forward or reverse rotation.

NOTICE:

DO NOT advance or retract the cable using the switch trigger unless the cable is in a drain pipe.

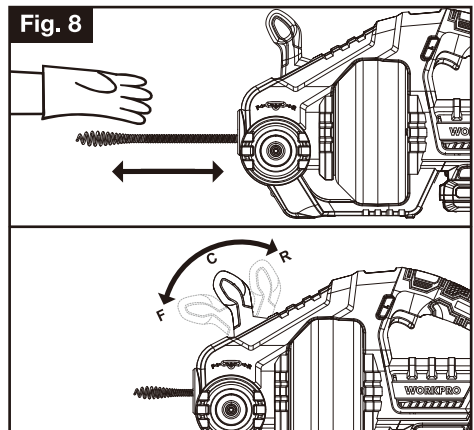

FEED AND DIRECTION CHART

ADVICE	FEED DIRECTION	ROTATION DIRECTION	CABLE
ADVANCE	F	R	ADVANCE / CLOCKWISE ROTATION
RETRACTING (cable is trapped)	F	L	RETRACTING/ CONTRAROTATE
RETRACTING	R	R	RETRACTING/ CLOCKWISE ROTATION
NOT RECOMMENDED	R	L	ADVANCE/ CONTRAROTATE
WINDING THE OBSTACLE	C	R	STOP ADVANCE OR RETRACT/ CLOCKWISE ROTATION
RELEASE THE OBSTACLE	C	L	STOP ADVANCE OR RETRACT/ CONTRAROTATE

6) Using the Drain Auger (Fig.9)

The drain auger can be used to clear obstructions from a variety of drains including sink, bathtub, and toilet drains.

NOTE: This product can be used to clear drain pipes with minimum diameters of 0.75 inch and maximum diameters of 2 inch.

To clear obstructions:

When removing an obstruction from a sink or a bathtub, it may be necessary to remove the stopper or overflow cover to gain access to the drain pipe. Toilet drains can be accessed directly through the base of the bowl.

Hold the drain auger within four inches of the drain or overflow, and manually feed the cable into the drain pipe.

NOTE: Advance the cable slowly at first. Advancing it too rapidly can result in twisting or binding.

After feeding about six inches of cable into the drain, you may begin advancing the cable using the switch trigger or continue advancing it manually.

The cable should advance freely through the drain pipe until it contacts the obstruction or is caught in a P-trap.

If the cable is caught in a P-trap, additional force or increased trigger pressure should be enough to advance it past the bend in the pipe.

If the cable has contacted an obstruction, there are two ways to remove it:

1. Advance the cable by squeezing the switch trigger. Hold the trigger for several seconds allowing the tip of the cable to bore into the obstruction. If the cable stop the rotating, release the switch trigger to avoid

kinking or damaging the cable. Then slowly retract the cable from the drain pipe.

2. Set the front operation handle in the position of "C", squeezing the switch trigger, the cable will rotate but not advance. Hold the switch trigger for several seconds allowing the obstruction to wrap around the cable. If the cable stop the rotating, release the switch trigger to avoid kinking or damaging the cable. Then slowly retract the cable and pull the obstruction through the drain.

Once the obstruction is cleared, attempt to flush your toilet or run water through your drain to confirm that the water is flowing freely. Meanwhile please be sure the cable is cleaned properly as described in the section of Cleaning the Drain Auger.

In case of obstruction or booked cornering of the cable, pull front operating handle back to "R" to retract for a certain distance, and then pull the operation handle forward to "F" to advance again. Repeatedly move forward and backward the operating handle to dredge the pipe and move through the corners.

Fig. 9

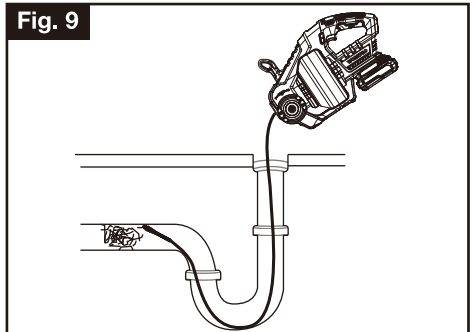

8. CLEANING AND MAINTENANCE

⚠ DANGER! Risk of injury! Before any maintenance or cleaning work:

- Remove the battery.
- Let the device cool down.

The drain auger should be cleaned after each use to prevent contamination and residue build up.

To drain the drum (Fig.10) :

- Remove the battery pack from the tool.
- Hold the tool at an angle and remove the drain port plug on the back of the drum with allen wrench.
- Allow any liquids inside the drum to pour down a drain or into a container approved for liquid waste.

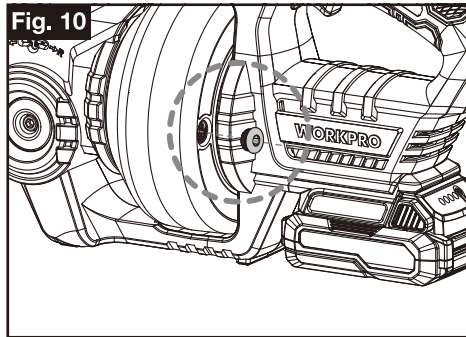

To clean the cable:

- Remove the battery pack from the tool.
- Using a clean cloth and warm soapy water, pull the cable out from the tool, cleaning it as it advances. Continue until the cable has been fully advanced and completely cleaned.
- Using a clean, dry cloth, pull the cable back into the tool, drying it as it retracts. Continue until the cable has been fully retracted.
- To ensure that no water entered the tool, drain the drum as described earlier.

NOTICE:

Do not advance or retract the cable using the switch trigger unless the cable is in a drain pipe.

General Maintenance

Avoid using solvents when cleaning plastic parts. Most plastics are susceptible to damage from various types of commercial solvents and may be damaged by their use. Use clean cloths to remove dirt, dust, oil, grease, etc.

How to Replace the Cable (Fig.11)

Please check if the battery pack is unplugged before replacing it. Drain auger provides a quick cable replacement device.

Fig. 11

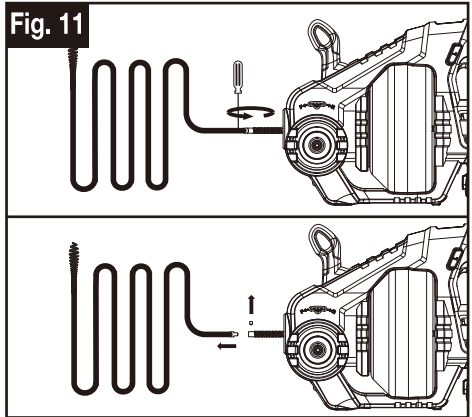

1. Place the front operating handle in the C position.
2. Take out the cable to expose the connector.
3. Unscrew the M4 screw with a screwdriver and remove the unwanted cable.
4. Insert the new cable into the connector, align the screw holes, and tighten the M4 screw again.
5. Push the cable manually to the inside of the drum.

⚠ WARNING: Do not start the tool to retract the cable, because the exposed cable can lead to unpredictable personal injury, tool damage, damage to indoor objects, fire, electric shock and other dangerous situations.

9. STORING AND TRANSPORT

Storage

- Store the device in a dry and dustproof location and out of reach of children.
- Remove the rechargeable battery from the device before storing the device.
- The optimum storage temperature for the battery and device is between 32°F/0°C and 104°F/40°C. Avoid extreme cold or heat during storage, so that the battery does not lose performance.
- Charge the device at least once in 3-6 months to preserve battery life span.

Transport

- Secure the appliance against slipping.
- If shipping, use the original packaging wherever possible.

10. CHARGER INDICATOR

Indicator Status		Explanations and Actions
Red LED	Green LED	
ON	OFF	Ready for use The charger is connected to the mains and is ready for use; there is no battery pack in the charger.
OFF	Quick Blink (2Hz)	Low-current charging As the battery pack voltage is under 15V, the charger is in gentle charging mode, the charging current is below 0.5A. This can maximum the life of the battery.
OFF	Slow Blink (1Hz)	High-current charging As the battery pack voltage is above 15V, the charger is in quick charge mode, the charging current is at 2.3-2.4A. Important! The actual charging times may vary slightly from the stated charging times depending on the existing battery charge.
OFF	ON	The battery is charged and ready for use. The battery is fully charged and ready to use.. Action: Take the battery pack out of the charger. Disconnect the charger from the mains supply.
Quick Blink (2Hz)	OFF	Fault Charging is no longer possible. The battery pack maybe defective. Action: Never charge a defective battery pack. Take the battery pack out of the charger.
Slow Blink (1Hz)	OFF	Temperature fault The battery pack is too hot (e.g., due to direct sunshine/prolonged use) or too cold (below 32°F / 0°C). Action: Remove the battery pack and keep it at room temperature (approx. 68°F / 20°C) for 3 Hours.

11. Disposal



Disposal of the appliance

A crossed-out wheeled bin icon means: Batteries and rechargeable batteries, electrical or electronic devices must not be disposed of with household waste. They may contain substances that are harmful to the environment and human health.

Consumers must dispose of waste electrical devices, spent portable batteries and rechargeable batteries separately from household waste at an official collection point to ensure that these items are processed correctly. Information on returning these items is available from the seller. Sellers are required to accept these items free of charge. Batteries and rechargeable batteries, which are not permanently installed in waste electrical devices, must be removed prior to disposal and must be disposed of separately. Lithium batteries and battery packs in all systems must only be returned to a collection point when discharged. Batteries must always be protected against short circuits by covering the poles with adhesive tape. All end users are responsible for deleting any personal data stored on waste devices prior to their disposal.



Disposal of an exhausted battery pack

To preserve natural resources, please recycle or dispose of the battery pack properly. This battery pack contains Li-ion batteries. Consult your local waste authority for information regarding available recycling and/or disposal options. Discharge your battery pack by operating your tool, then remove the battery pack from the tool housing and cover the battery pack connections with heavy-duty adhesive tape to prevent short circuit and energy discharge. Do not attempt to open or remove any of the components.



Disposal of the packaging

The packaging consists of cardboard and correspondingly marked plastics that can be recycled. Make these materials available for recycling.

WORKPRO