

RHINO
greenhouses *direct*

Technical drawing of a rectangular partition. The overall width is 3160 and the overall length is A. The partition is divided into a 'Rear end' and a 'Door end' by a 'Partition' wall. The 'Rear end' has a width of 28.00 and a length of 652. The 'Door end' has a width of 28.00 and a length of 961. The 'Partition' wall has a width of 32.00mm and a length of 928. The total length A is the sum of the rear end length (652), the partition length (928), and the door end length (961).

Section	Width	Length
Rear end	28.00	652
Partition	32.00mm	928
Door end	28.00	961
Total	3160	A

Please note, the dimensions (right) are only required if you have ordered a partition with your greenhouse.

Rhino Greenhouses Direct DO NOT RECOMMEND the use of hardcore [X], hogging [X] and shingle [X] as suitable base materials due to issues surrounding levelling and securing of greenhouse.

However if for example you decide on installing a concrete strip foundation, you must be sure to make allowances for fixing down through each anchor as shown below. Failing to make the concrete strip wide enough could result in the foundation cracking as you drill the anchors points.

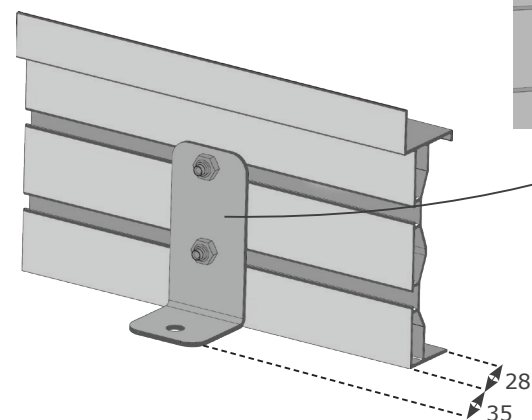
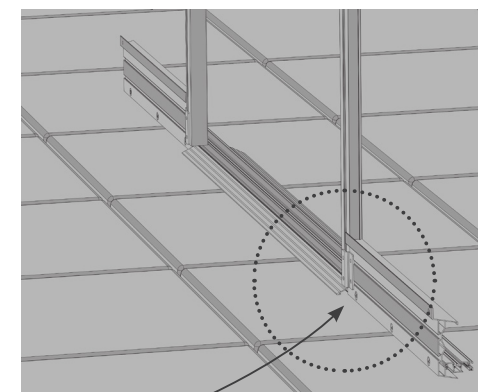
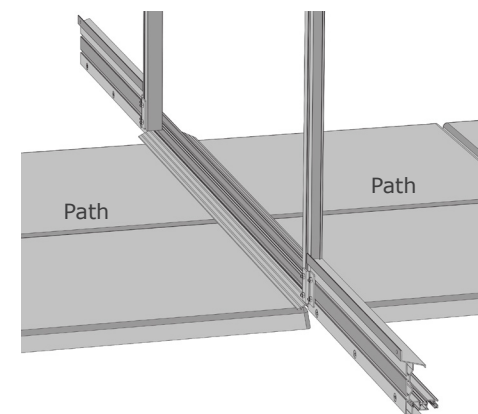

Please note:the actual sizes for our greenhouses are different from the headline sizes we list on our website. Please bear this in mind when preparing your base. You can find exact base dimensions in mm's below.

Brick Plinth Base plan

This Base plan must be adhered to allow the correct installation and subsequently allow for correct anchoring.

Once the base is built, position the greenhouse so that the Inside of the front door base is aligned flush with the inside row of bricks. The sides and rear base will finish flush with the

outside edge of the bricks. This will ensure that the Anchors can be fitted correctly. See below for full details.

Please note that on completion of your Rhino the internal ramp must be supported. The best way to achieve this is to install a path as shown.

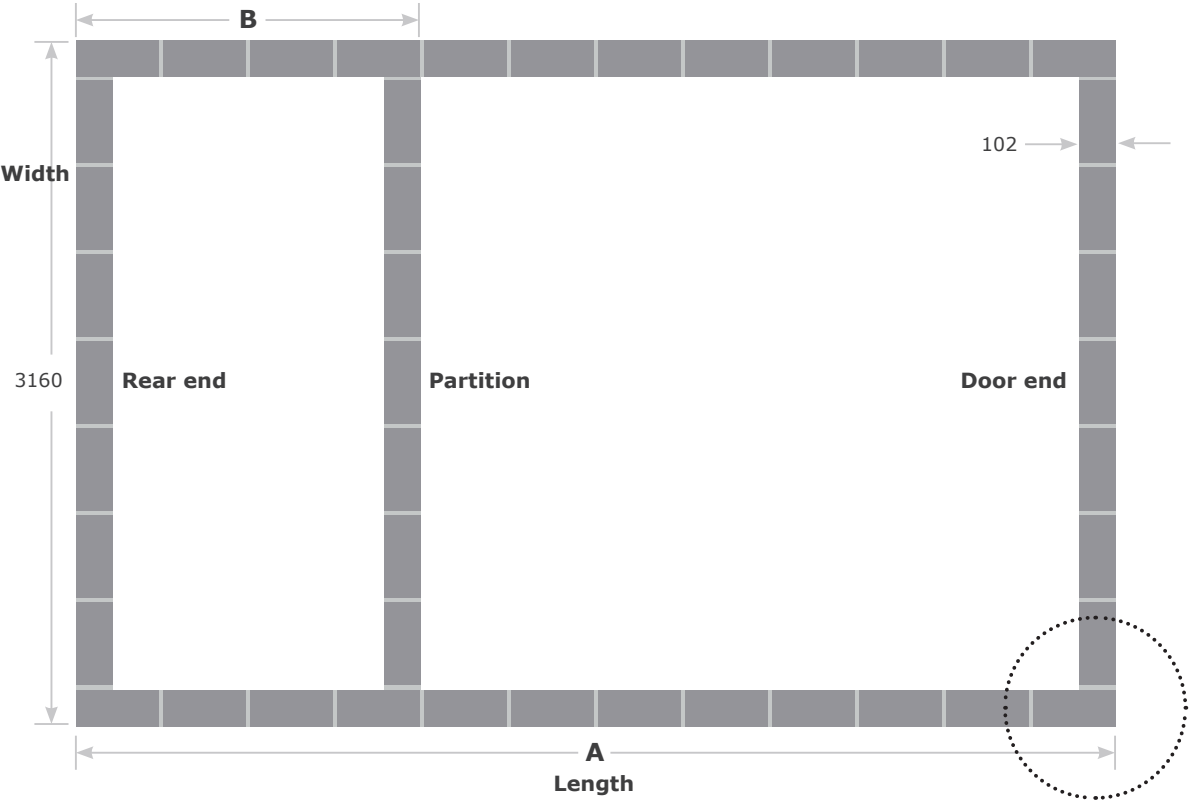

Nominal description		10'	12'	14'	16'	18'	20'
Exact Length mm	A	3195	3813	4431	5049	5667	6285

Nominal description		6'	8'	10'
Exact Partition mm	B	1929	2547	3165

Greenhouses Direct **RECOMMEND** solid and flat engineering bricks to get a good anchor point.

If opting for this type of installation, please contact the service desk on 0344 493 1929 to request 2x modified ground anchors.

