



FOODI™ POWER NUTRI™ DUO®

OWNER'S GUIDE



It's important to read this Owner's Guide prior to using your product for the first time.

Recipe book is not included.

IMPORTANT SAFEGUARDS

HOUSEHOLD USE ONLY • READ ALL INSTRUCTIONS BEFORE USE

| | |
|--|--|
| | Read and review Instructions for operation and use. |
| | Indicates the presence of a hazard that can cause personal injury, death or substantial property damage if the warning included with this symbol is ignored. |
| | For indoor and household use only. |

When using electrical appliances, basic safety precautions should always be followed, including the following:

⚠ WARNING

To reduce the risk of fire, electric shock, serious injury, death, or damage when using this appliance, follow these basic safety precautions.

General Precautions

- Read all instructions before using the appliance and accessories.
- Carefully observe and follow all warnings and cautions. This unit contains electrical components and moving parts that potentially present risk to the user.
- ALWAYS** exercise care when handling the Hybrid Edge® Blades Assembly. The blades are sharp. Handle carefully. **ONLY** press the Hybrid Edge Blades Assembly by the outer perimeter of the blade assembly base. Failure to use care when handling the blade assembly will result in a risk of laceration.
- Take your time and exercise care during unpacking and appliance setup. This appliance contains sharp blade blades that can cause injury if mishandled.
- Take necessary precautions to ensure you have all parts needed to properly and safely operate your appliance.
- Blades are sharp. Handle carefully.
- Unplug the appliance from the outlet when not in use, before assembling or disassembling parts, and before cleaning. To remove speed lever from the ready-to-run position, the outlet **NEVER** unplug by pressing and pulling the flexicord.
- Blades are sharp. Do not let any contact food. Follow warning instructions covered in this instruction manual.
- To protect against the risk of electric shock, **DO NOT** submerge the appliance or allow the power cord to contact any form of liquid.
- DO NOT** use this appliance outdoors. It is designed for indoor household use only.
- This appliance has important markings on the plug blade. The attachment plug or outlet socket (if plug is not double cord) is not suitable for replacement. If damaged, the appliance must be replaced.
- This appliance has a polarized plug (one prong is wider than the other). To reduce the risk of electric shock, this plug will fit in a two-prong outlet only one way. If the plug does not fit fully in the outlet, reverse the plug. If still does not fit, do not use a qualified electrician. **DO NOT** modify the plug in any way.
- DO NOT** spend any time with a damaged cord or plug, or if the appliance multi-line cord is equipped for damaged in any manner. This appliance has no user-serviceable parts. If damaged, contact a service center.
- Extension cords should **NOT** be used with this appliance.
- DO NOT** allow children to operate this appliance or use as a toy. Close supervision is necessary when any appliance is used near children.
- This appliance is **NOT** intended to be used by persons with reduced physical, sensory, or mental capabilities, or lack of experience and knowledge, unless they have been given supervision or instruction concerning use of the appliance by a person responsible for their safety.
- Before use, inspect the blade assembly for damage. If a blade is bent or damage is suspected, contact service center.
- DO NOT** attempt to sharpen blades.
- DO NOT** allow the unit or the cord to hang over the edges of tables or counters. The cord may become snagged and pull the appliance off the work surface.
- DO NOT** allow any part of the unit to contact hot surfaces including stoves and other heating appliances.

- ALWAYS** use the appliance on a dry and level surface.
- NEVER** place a blade assembly on the motor base without it first being attached to the cup.
- Keep hands, hair, and clothing out of the container when loading and operating.
- ONLY** use attachments and accessories that are provided with the product or are recommended by SharkNinja. The use of accessories not recommended or sold by SharkNinja may cause fire, electric shock, or injury.
- During operation and handling of the appliance, avoid contact with moving parts.
- DO NOT** operate the appliance with an empty container.
- DO NOT** fill containers past the **MAX FILL** or **MAX LIQUID** lines.
- DO NOT** microwave any containers or accessories provided with the appliance.
- DO NOT** perform grinding operations.
- Before operation, ensure all parts are removed from containers. Failure to remove contents can cause containers to shatter and potentially result in personal injury and property damage.
- NEVER** operate the appliance without lids and caps in place. **DO NOT** attempt to defeat the interlock mechanism. This will render the appliance inoperable and voided before operation.
- DO NOT** expose the containers and accessories to extreme temperature changes. They may experience damage.
- NEVER** leave the appliance unattended while in use.
- DO NOT** blend hot liquids. Doing so may result in pressure buildup and steam exposure that can pose a risk of the user being burned.
- If you find unmixed ingredients showing to the sides of the cup, stop the appliance, remove the blade assembly, and use a scraper to dislodge materials.
- DO NOT** attempt to remove the container and lids from the motor base while the blade assembly is still spinning. Allow the appliance to come to a complete stop before removing lid and container.
- Remove the Hybrid Edge® Blades Assembly from the Power Nutri™ Cup or Power Nutri Bowl upon completion of blending. **DO NOT** store ingredients before or after blending them in the cup with the blade assembly attached. Some foods may contain active ingredients or release gases that will expand if left in a sealed container, resulting in excess pressure buildup that can pose a risk of injury. For ingredient storage, in the cup, use only Sport Lid to cover. For ingredient storage in the bowl, use only Sport Lid or Storage Lid.

- If the appliance overheats, a thermal switch will activate and temporarily disable the motor. To resume, unplug the appliance and allow it to cool for approximately 15 minutes before using again.
- The maximum wattage rating for this appliance is based on the configuration of the Hybrid Edge Blades Assembly and Power Nutri Cup. Other configurations may draw less power or current.
- DO NOT** process any hard items without adding liquid to the Power Nutri Cup or Power Nutri Bowl. They are not intended for dry blending.
- To protect against risk of electrical shock, **DO NOT** immerse the motor base in water or other liquid. Unplug the unit before cleaning.

TECHNICAL SPECIFICATIONS
Voltage: 120V~60Hz

GETTING TO KNOW YOUR NINJA®

PARTS

- A Sport Lid
- B Power Nutri™ Cup
- C Storage Lid
- D Motor Base
- E Hybrid Edge® Blades Assembly
- F Motor Base (attached power cord not shown)

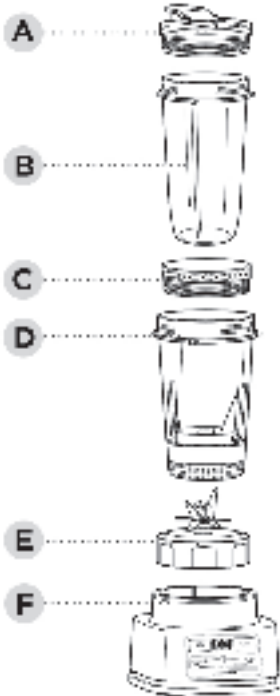

NOTE: The Hybrid Edge Blades Assembly is not compatible with other Ninja products.

NOTE: Number of cups, bowls and lids vary by model.

BEFORE FIRST USE

IMPORTANT: Review all warnings before proceeding.

NOTE: Handle the Hybrid Edge Blades Assembly by grasping around the perimeter of the blade assembly base.

NOTE: A dish rack must be BPA free and dishwasher safe. It is recommended that the containers, lids, and blade assembly be placed on the top rack of the dishwasher. Ensure blade assembly and lid are removed from the container before placing in the dishwasher. Exercise care when handling blade assembly.

- Remove all packaging materials from the unit. Exercise care when unpacking blade assembly, as the blades are sharp.
- Wash containers, lids and blade assembly in warm, soapy water using a dishwashing detergent with a handle to avoid direct contact with the blades. Exercise care when handling blade assembly, as the blades are sharp.
- Thoroughly rinse and air dry all parts.

GETTING TO KNOW THE POWER NUTRI BOWL



Powering through tough and frozen ingredients used to require a lot of stopping, scraping, and re-blending. But now, it's easier than ever to create thick and spoonable smoothie bowls, nut butters, and more. All you have to do is twist the Power Blade while blending to push ingredients down toward the blades like having a built-in tamper.

NOTE: Accessories may vary depending on the model. Refer to quick guide, if available. The images shown here are for illustrative purposes only and may be subject to change.

USING THE CONTROL PANEL

AUTO-IQ® PROGRAMS

Intelligent preset programs combine unique blending and pulsing patterns that do the work for you. Once a preset program is selected, it will start immediately and automatically stop when blending is complete. To stop blending before the end of the program, press the currently active button again.



AUTO-IQ PROGRAMS:

EXTRACT

Ideal for tough, leafy or fibrous whole fruits and vegetables, including the stems, seeds and skins.

SMOOTHIE

Combine your favorite fresh or frozen ingredients, liquids and powders to create smoothies and protein shakes.

SPREAD

Create anything from spreadable nut butters to easy dressing to the perfect hummus.

BOWL

Make thick, spoonable smoothie bowls, creamy frozen yogurt, and refreshing sorbets.

NOTE: The actual descriptions of control panel and their locations may vary depending on the model.

NOTE: For the best results when using the Power Nutri Bowl, use the Spoonable Auto-IQ Programs: EXTRACT and SPREAD.

MANUAL PROGRAMS:

NOTE: Manual programs cannot be used in conjunction with any Auto-IQ programs.

START/STOP

Press once to start continuous running up to 80 seconds; press again to stop. Can also be pressed to stop a running Auto-IQ program.

PULSE

One is greater control of pulsing and blending. Operates only when PL, SP is pressed. Use short presses for short pulses and longer presses for long pulses.

USING THE POWER NUTRI™ BOWL

- Plug in motor base and place on a clean, dry, level surface such as a countertop or table.
- Add liquid then ingredients to the Power Nutri Bowl. **DO NOT** add liquid past the **LIQUID FILL** line or ingredients past the **MAX FILL** line.
- Place the Hybrid Edge® Blades Assembly on the top of the bowl and turn clockwise to seal.



- Turn the bowl upside down and install the motor base by aligning the tabs on the bowl with the slots on the base. Then, rotate bowl clockwise until it clicks. Once locked in place, the program will commence and the unit will be ready for use.



NOTE: While processing, twist the Power Blade clockwise and counter-clockwise.

- Using an Auto-Off program, select the program that best suits your desired output. During the blending process, twist the Power Blade counterclockwise continuously. The sensor system will automatically stop at the end of the program. To stop the unit at any time, press the currently active program again.

SAVE THESE INSTRUCTIONS

USING THE POWER NUTRI™ BOWL - Cont.

5b Pressing START/STOP once the ingredients have reached your desired consistency, press START/STOP again, and wait for the unit to come to a complete stop. During the blending process, make sure to twist the Power Paddle counterclockwise continuously.

6 Remove the bowl from the motor base by turning it counterclockwise and then lifting up.

7 Remove the blade assembly by twisting counterclockwise. DO NOT store blended contents with the blade assembly attached. Only use the Flip-Lid or Storage Lid to cover. Exercise care when handling the blade assembly, as the blades are sharp.

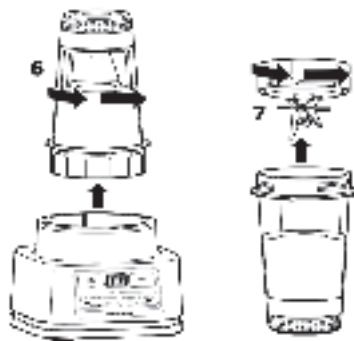

8 To enjoy on the go, place the Spout Lid or Storage Lid on the bowl and twist it clockwise until firmly sealed.

9 Unplug the unit when finished. Refer to the Care & Maintenance section for cleaning and storage instructions.

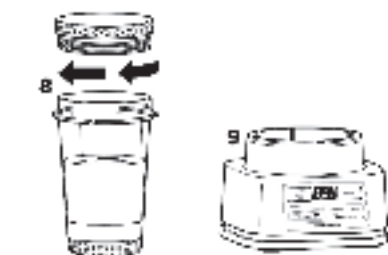

USING THE POWER NUTRI™ CUP

IMPORTANT: Review all warnings before proceeding.

1 Plug in motor base and place on a clean, dry, level surface such as a countertop or table.



2 Add ingredients to the Power Nutri™ Cup. DO NOT add ingredients past the MAX LIQUID line.



3 Place the Hybrid Edge™ Blade Assembly on the top of the cup and turn clockwise to seal.

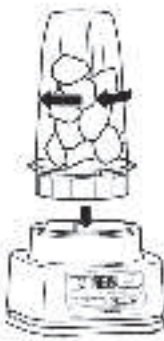

4 Turn the cup upside down and insert on the motor base by aligning the tabs on the cup with the slots on the base. Then, rotate cup clockwise until it clicks into place. Once in place, the programs will illuminate and the unit will be ready for use.

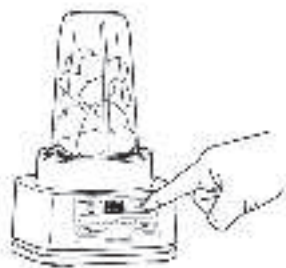

5a Pressing an Auto-iQ™ program, select the program that best suits your desired output. The sensor feature will automatically stop at the end of the program. To stop the unit at any time, press the pause/yellow program again.

5b Pressing START/STOP once the ingredients have reached your desired consistency, press START/STOP again, and wait for the unit to come to a complete stop.

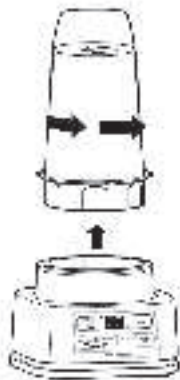

6 Remove the cup from the motor base by turning it counterclockwise and then lifting up.



7 Remove the blade assembly by twisting counterclockwise. DO NOT store blended contents with the blade assembly attached. Only use the Spout Lid or Storage Lid to cover. Exercise care when handling the blade assembly, as the blades are sharp.



8 To enjoy on the go, place the Spout Lid or Storage Lid on the cup and twist it clockwise until firmly sealed.



9 Unplug the unit when finished. Refer to the Care & Maintenance section for cleaning and storage instructions.

CARE & MAINTENANCE

CLEANING
Hand-Washing
Wash containers, lids, and blade assembly in warm, soapy water. Use a dishwashing utensil with handle to avoid direct contact with the blades. Exercise care when handling the blade assembly as the blades are sharp. Thoroughly rinse and dry all parts.

NOTE: The paddle in the Power Nutri™ Bowl is not removable.



For stuck-on ingredients, such as nut butter, rinse the bowl and blade assembly under warm water.
Next, fill the bowl with warm water up to the top of the paddle and add 1-2 small drops of dish soap.
Screw on the blade assembly and press BOWL twist the Power Paddle counterclockwise continuously until draining. Then, empty contents and rinse under warm water and wipe with a dishwashing towel, if needed.

Dishwasher
Containers, lids, and blade assembly are top rack dishwasher safe. ONLY ensure the blade assembly and its components are removed from the container before placing in the dishwasher.

Motor Base
Clean the unit before cleaning. Wipe motor base with a clean, damp cloth.

STORING
For cord storage, wrap cord with hook-and-loop fastener near the back of the motor base. DO NOT wrap the cord around the bottom of the base for storage.
DO NOT store blended or unblended ingredients in the cup or bowl with the blade assembly attached. Use only the spout lid or storage lid when storing blended or unblended ingredients in the containers.
DO NOT stack items on top of the containers. Store any remaining attachments alongside the unit in a storage where they will not be damaged or create a hazard.

RESETTING THE MOTOR THERMOSTAT
The unit features a unique safety system that prevents damage to the motor and drive system should you inadvertently overload it. If the unit is overloaded, the motor will be temporarily disabled. Should this occur, follow the reset procedure below:
1 Unplug the unit from the electrical outlet.
2 Allow the unit to cool for approximately 2 minutes.
3 Remove the blade assembly from the container, empty the container and reset any ingredients are jamming the blade assembly.
IMPORTANT: Ensure that maximum capacities are not exceeded. This is the most typical cause of appliance overload.

TROUBLESHOOTING GUIDE

- WARNING:** To reduce the risk of shock and unintended operation, unplug unit before troubleshooting.
- Control panel does not illuminate.**
- Make sure unit is plugged in. If the unit is powered on and no container is installed, the unit will display ---. The available programs will illuminate after placing a container on base and rotating it clockwise until it clicks into place.
- Control panel doesn't turn off.**
- Remove container from base by rotating it counterclockwise and lifting it up. The display will flash ---. Unplug the power cord from the outlet. If the unit remains plugged in, the display will time out after 5 minutes of inactivity. Press any button to wake the unit.
- Doesn't mix well; ingredients get stuck.**
- Using the Auto-iQ™ programs is the easiest way to achieve great results. The pulses and pauses allow the ingredients to settle toward the blade assembly. If ingredients are routinely getting stuck, adding some liquid will usually help.
 - When filling the cup, start with fresh fruit or veggies, then leafy greens or herbs. Next, add liquids or yogurt, then seeds, powders, or nut butters. Finally, add ice or frozen ingredients.
 - If using the Power Nutri™ Bowl, during the blending process twist the Power Paddle counterclockwise continuously to circulate ingredients.
- Unit moves on counter while blending.**
- Make sure the counter and base of the unit are clean and dry.
- Lid or Hybrid Edge™ Blades Assembly is hard to install on the container.**
- Set the container on a level surface. Carefully place the lid or blade assembly on the top of the container and align the threads of the hybrid edge assembly with the. Twist clockwise until you have a tight seal.
- Can't remove the paddle from the Power Nutri Bowl.**
- The paddle in the Power Nutri™ Bowl is not removable. For cleaning instructions, refer to the Care & Maintenance section.