

LITETRONICS®

Plug-in Bluetooth PIR Sensor with IR (SC010)

For use with:

- Light Panel (PT*S)

- Light Panel Retrofit (PRT*S)

- Strip Fixture (SFS*)

Installation Instructions

The SC010 plug-in PIR sensor enables wireless control of fixtures, or groups of fixtures, through the LiteSmart mobile app.



LiteSmart® offers complete control over your fixtures; includes occupancy sensing, daylight harvesting, dimming, grouping, time schedule programming and scene creation.

LiteSmart is available in the app store for download to either IOS or Android devices.



These Bluetooth control and switches offer control of your fixtures wirelessly.

Bluetooth Control and Switches – Available for purchase from Litetronics under parts # SCR054, BCS03 or BCS05.

* A detailed user guide for LiteSmart can be viewed or downloaded from www.litetronics.com/resources/downloads/litesmart-mobile-app-user-guide

PANEL INSTALLATION - PT*S

Installing the SC010 sensor is quick and simple.

- Before installation, **always turn off the power from main circuit first!**

- To remove sensor cover, use a flat screw driver at sensor COVER notch and gently pull out cover from frame (Figure 1).

Figure 1

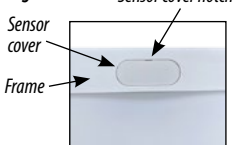

- Pull out wires with quick connector from frame and connect sensor (Figure 2).

Figure 2

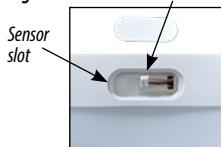

- Clip sensor into sensor slot and snap into frame (Figure 3).

Figure 3



- Restore power, your installation is complete.

STRIP FIXTURES INSTALLATION - SFS*

For strip fixture SFS* sensor installation, follow sensor box SFASB1 (sold separately) for instructions.

PANEL RETROFIT INSTALLATION - PRT*S

Installing the SC010 sensor is quick and simple.

- Before installation, **always turn off the power from main circuit first!**

- To remove sensor cover, on front of panel press on center of the cover, and gently push out cover until it clears the frame (Figure 1).

Figure 1

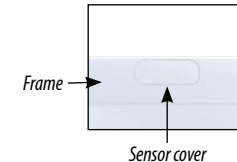

- Pull wires with quick connector from driver and connect sensor (Figure 2).

Figure 2

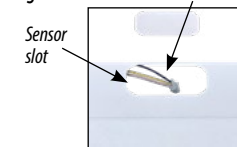

- Clip sensor into sensor slot and snap into frame (Figure 3).

Figure 3



- Restore power, your installation is complete.

For sensor coverage and default settings, see reverse side.

SENSOR COVERAGE

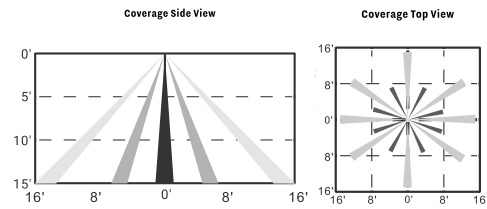

SENSOR DEFAULT SETTINGS

ON/OFF	1ST TIME DELAY	2ND TIME DELAY	DIM LEVEL %
On	20 minutes	1 minute	50%

This equipment has been tested and found to comply with the limits for a Class B digital device, pursuant to Part 15 of the FCC Rules. These limits are designed to provide reasonable protection against harmful interference in a residential installation. This equipment generates uses and can radiate radio frequency energy and, if not installed and used in accordance with the instructions, may cause harmful interference to radio communications. However, there is no guarantee that interference will not occur in a particular installation. If this equipment does cause harmful interference to radio or television reception, which can be determined by turning the equipment off and on, the user is encouraged to try to correct the interference by one or more of the following measures:

- Reorient or relocate the receiving antenna.
- Increase the separation between the equipment and receiver.
- Connect the equipment into an outlet on a circuit different from that to which the receiver is connected.
- Consult the dealer or an experienced radio/TV technician for help.

This device complies with part 15 of the FCC Rules. Operation is subject to the following two conditions:

- (1) This device may not cause harmful interference, and (2) this device must accept any interference received, including interference that may cause undesired operation.

Changes or modifications not expressly approved by the party responsible for compliance could void the user's authority to operate the equipment

*RF warning for Mobile device:

This equipment complies with FCC radiation exposure limits set forth for an uncontrolled environment. This equipment should be installed and operated with minimum distance 20cm between the radiator & your body.

Thank you for choosing

LITETRONICS®

6969 W. 73rd Street

Bedford Park, IL 60638

WWW.LITETRONICS.COM

CustomerService@Litetronics.com or 1-800-860-3392



The information and product specifications contained in these instructions are based upon data believed to be accurate at the time of printing. This information is subject to change without notice and without incurring liability. If you have questions regarding specific product details, please contact us at 800-860-3392 or via email at customerservice@litetronics.com. To check for an updated version of these instructions, please visit www.litetronics.com.