



Evolution **BO**

Features



- A** Innovative & Integrated UI for user friendly design
- B** Advanced two USB 3.0 ports for maximum data transfer speed
- C** Unique honeycomb & mesh hybrid intake design with rugged strong appearance
- D** Top access external 3.5" & 2.5" HDD/SSD for easy mobile data transfer
- E** Integrated fan speed controller for dual-way fan control (Total control:6pcs fans)
- F** Support for 7 fans : front 120mm fans x2 ; rear 120mm fan x1 ; top 120mm fans x2 ; bottom 120/140mm fan x1 ; left-side panel 140mm fan x1
- G** Support for longer high-end graphics cards (up to 305 mm)
- H** 8 PCI slots provides flexibility for multiple graphics cards solutions
- I** Screw-less mechanisms on 5.25" device
- J** Shockproof HDD trays design for 3.5" HDDs and compatible for 2.5" HDDs /SSDs
- K** Holes on the rear panel for water cooling solutions
- L** Retaining holes in the MB tray for easy accessing the backplate of the CPU cooler
- M** Cable routing holes on the MB tray for easy routing and hiding cables behind the MB tray
- N** Vented slot covers for better cooling performance
- O** Air filter for the front panel fan , power supply fan & side panel fan

Specifications

Case Type	Full Tower
Motherboard Type	Micro ATX / ATX
Dimensions	223(W)x514(H)x523(D)
Available color	Black
External 5.25" Drive Bays	6
External 3.5" Drive Bays	1 (Converted from 5.25" bay)
Internal 3.5" Drive Bays	4
Internal 2.5" HDD/SDD Trays	4 (Installed from 3.5" HDD trays)
External 3.5"& 2.5" Hot-swap Device	1
Expansion Slots	8
I/O Panel	USB 3.0 x 2, USB 2.0 x 2
	MIC x 1, Audio x 1
5.25" Screw-less Mechanism	6
Fan Speed Control System	Dual-way (Total control:6pcs fans)
Cooling System	Max installed : 7pcs fans
	Front
	Top
	Rear
	Bottom
	Left side
Bottom Fan Filter	1
Rear water cooling hole	2
Maximum VGA Length	305mm



Evolution

Case details



Top & Rear cover can install 3pcs 120mm fans for better airflow (Optional) and installation doesn't need the screws



Huge hole for easy accessing the backplate of the CPU cooler



Top access external 3.5" & 2.5" HDD/SSD for easy mobile data transfer



Integrated fan speed controller for dual-way fan control (Total control: 6pcs fans)



Holes for water cooling solution



8pcs Vented slot covers for better airflow



Support for longer high-end graphics cards (up to 305 mm)

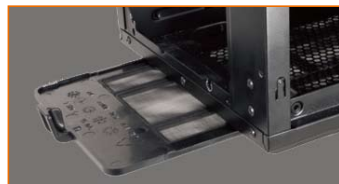

Air filter for the power supply fan & 120/140mm fan



Bottom cover can install 1pcs 120/140mm fan for better airflow (Optional)



Cable routing management for easy routing and hiding cables



Innovative & integrated UI for user friendly design



5.25" Screw-less devices



Front cover can install 2pcs 120mm fans for better airflow (Optional) and have air filters

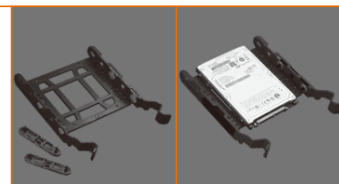

Shockproof HDD trays design for 3.5" HDDs and compatible for 2.5" HDDs / SSDs





Evolution

Cooling system



Support 7 fans for strong cooling performance

- A** Top : 120mm fans x 2 (Optional)
- B** Front : 120mm fans x 2 (Optional)
- C** Bottom : 120/140mm fan x 1 (Optional)
- D** Left side : 140mm fan x 1 (Optional)
- E** Rear : 120mm fan x 1 (Optional)

