

To install (For Hinged Doors):

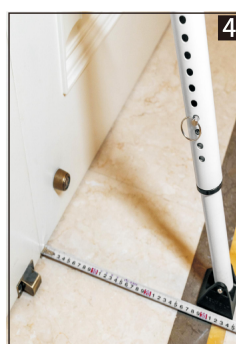

1. Measure distance from center of doorknob to floor to identify knob height.
2. Unfold door bar and position the yoke under doorknob. Ensure RB logo on bar and yoke are facing you. Failure to properly install will reduce performance.
3. Remove adjustment pins to adjust length of door bar. For optimum security, adjust top and bottom sections evenly. Re-insert pins to secure.
4. Position padded foot appropriate distance from door using chart below based on knob height.
5. With rubber pad flat on floor, lightly tap the front of the foot to tension the door bar.
6. With the door unlocked, pull to ensure the door bar is securely in place.

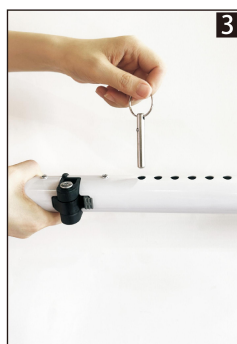

Do not place on loose rugs or floor mats.

Knob height (in)	28–31	31–36	36–41
Foot Distance from Door (in)	6–9	9–11	11–13