



INSTALLATION INSTRUCTIONS

Accessory
**PANNIER PANEL KIT
(ALUMINUM)**
P/N 08L80-MKT-D00

Application
NC750XA/XD

Publication No.
MII 17714
Issue Date
April 2021

Honda Dealer: Please give a copy of these instructions to your customer.

PARTS LIST

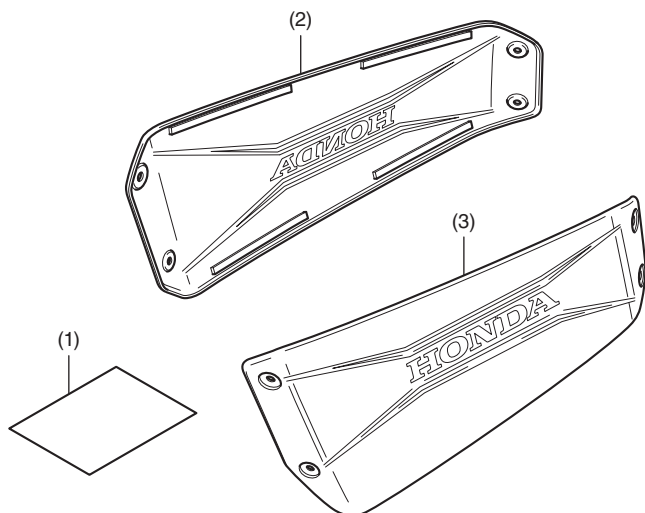

No.	Description	Qty
(1)	Installation instructions	1
(2)	Right pannier panel	1
(3)	Left pannier panel	1

PANNIER CASE Sold separately

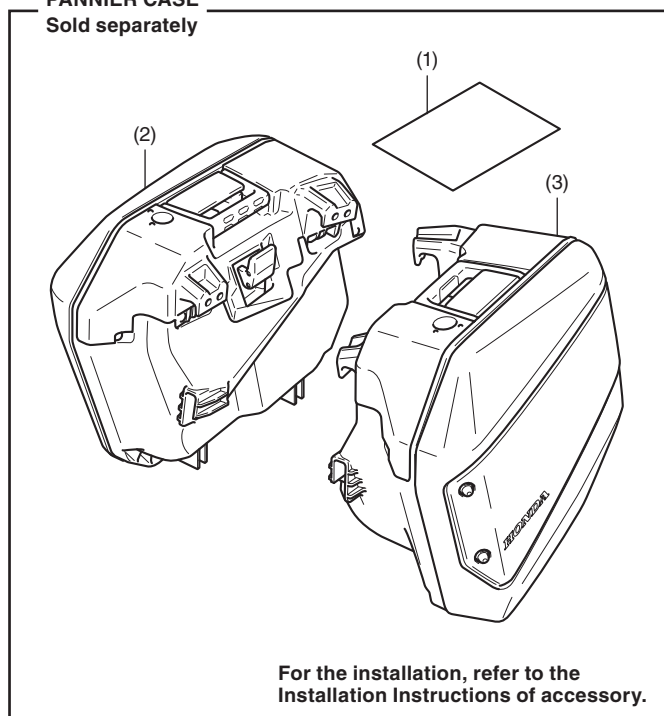

No.	Description	Qty
(1)	Installation instructions	1
(2)	Right pannier case	1
(3)	Left pannier case	1

TOOLS AND SUPPLIES REQUIRED

Hex wrench (3 mm)
Isopropyl alcohol
Shop towel
Torque wrench

TORQUE CHART

Tighten all screws, bolts, and nuts to their specified torque values. Refer to the Service Manual for the torque values of the removed parts.

Item	N-m	kgf-m	lbf-ft
Screw	4.2	0.4	3.1

INSTALLATION

NOTE:

- Heat the bonding surfaces with a hair dryer if the ambient air temperature is below 70°F (21°C).
- The adhesive reaches full strength in 72 hours. Wait at least 24 hours before riding your motorcycle.

- Open the left pannier case lid, then remove the parts as shown.

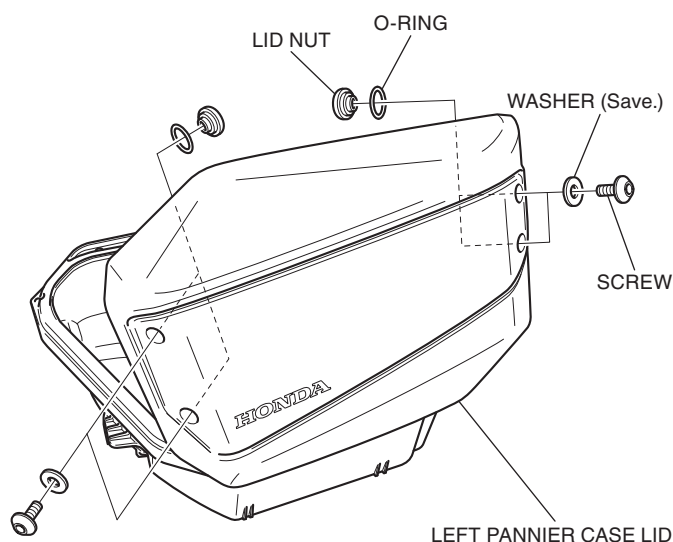

2. To maintain the adhesive strength of the double-sided tape, be sure to clean the surface of the indicated area with isopropyl alcohol.

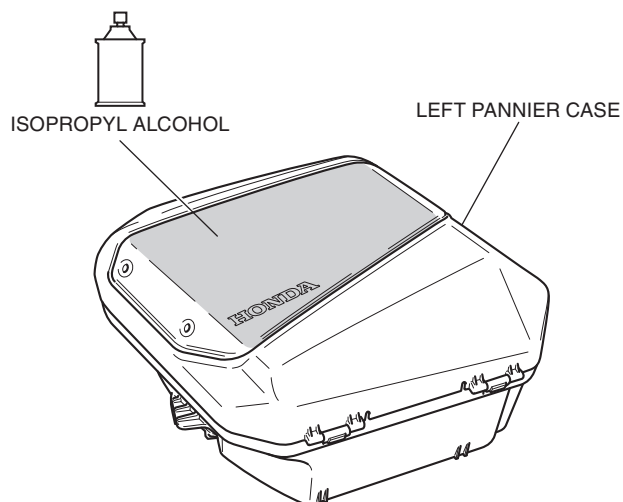

3. Peel off the adhesive backing on the left pannier panel as shown.

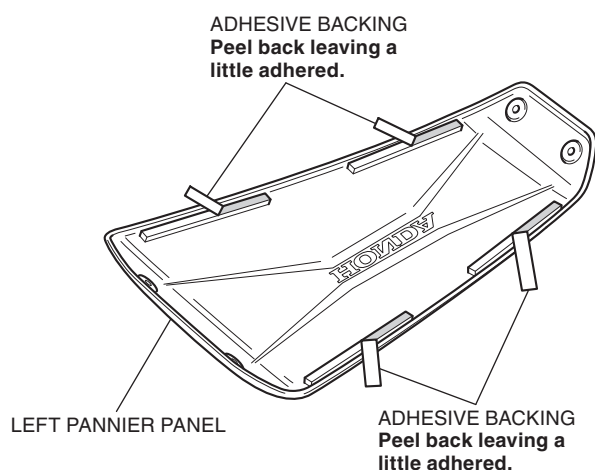

4. Attach the left pannier panel as shown.
 - **Align the left pannier panel with the shape of the left pannier case lid.**

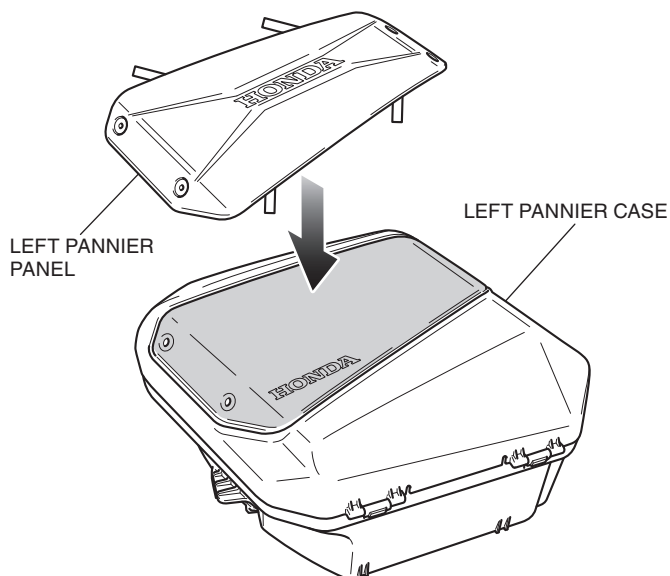

5. Temporarily set the screw and check that there is no misalignment.
 - **If there is a misalignment, start over from step 4.**

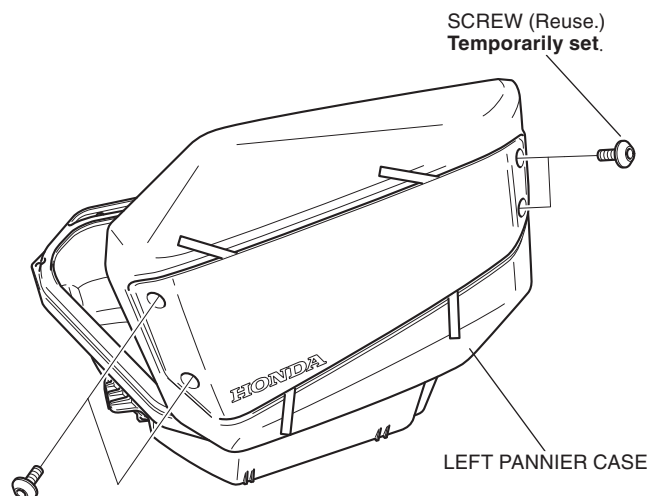

6. Remove the adhesive backings while pressing on the top box lid panel firmly with the palm.

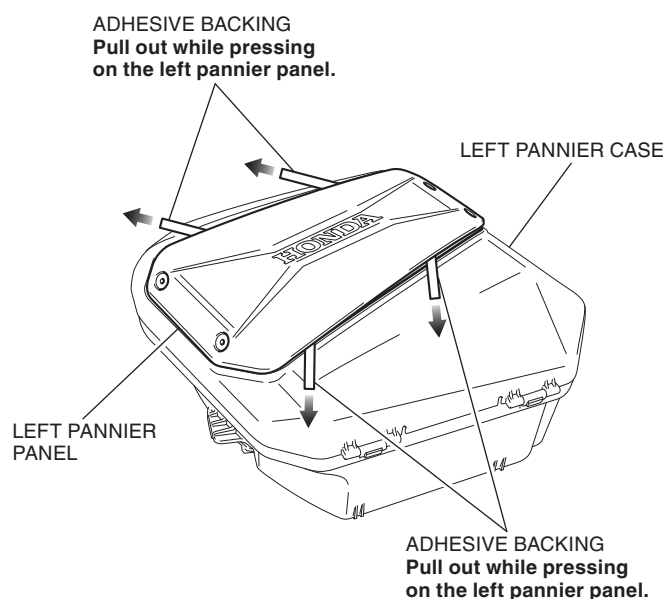

7. Applying adequate pressure of 5kgf (50N) to the attached pannier case panel.
- **Make sure to crimp with a force of 5 kgf (50 N).**

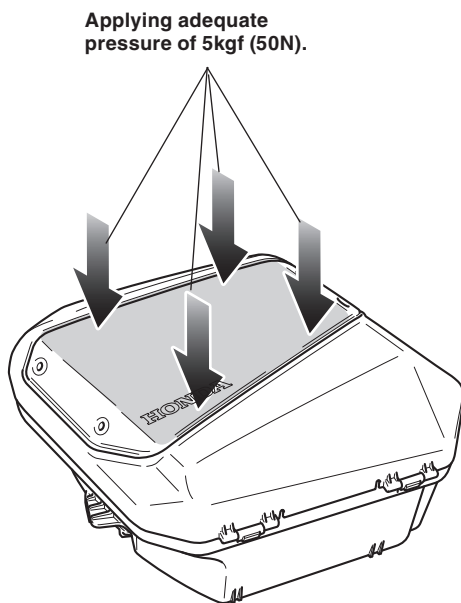

8. Leave the pannier case panel for 10 minutes to stabilize the fitting of the adhesive surface.

9. Install the parts as shown.

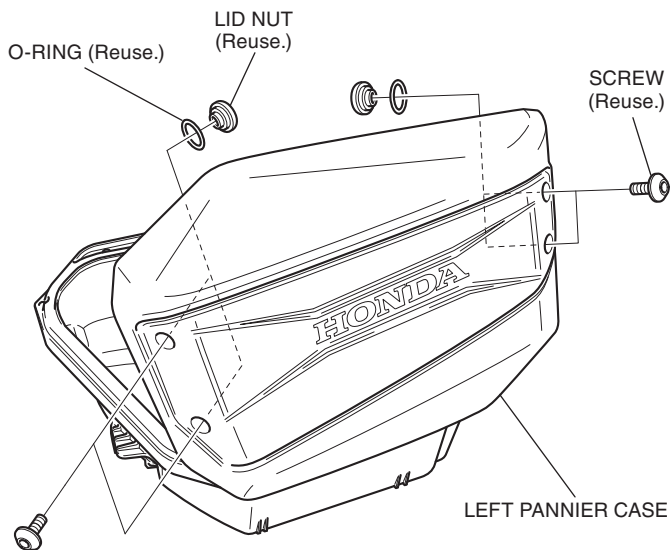

10. Install the right pannier panel in the same manner as the left side.