

- Please be careful when handling the parts.
- It is not our responsibility for any damage caused in use.
- Warning: Please make sure there is NO MicroSD inserted before assembling.
- 2.4G WiFi might be affected by the environment and
- USB 3.0, recommend use 5G WiFi or wired connect to network.

Step 1: Install heat sinks

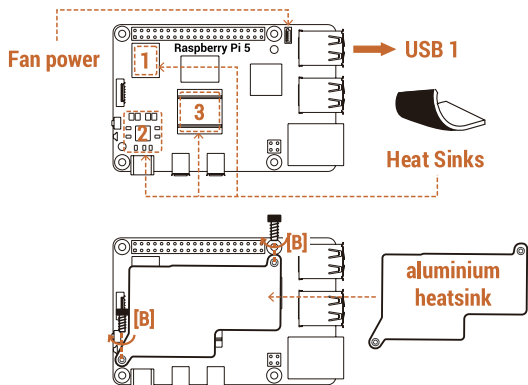

- [A] [PB 2.5 × 5] * 4
- [B] [PW 1.7 × 5] * 2
- [C] [PB 2 × 7] * 2
- [D] [PB 2 × 18] * 2

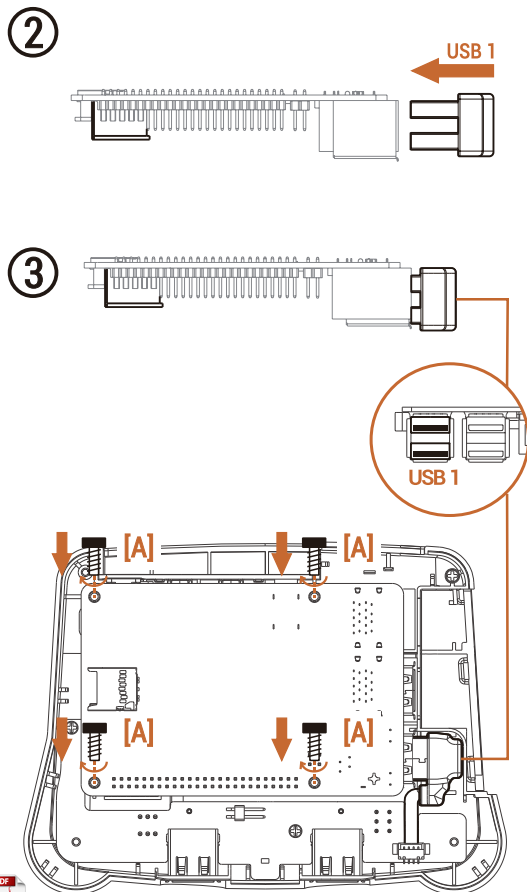

- [1] [12.5 × 9.9 × 1] * 1
- [2] [16.5 × 11.7 × 2] * 1
- [3] [19 × 19 × 1] * 1
- [Fan] [30 × 30 × 7] * 1
- [Screwdriver] * 1
- [aluminium heatsink] * 1

Step 2: Assemble

