

WELCOME!

LET'S GET STARTED, SEE MORE INSIDE.



DL-WME38 2 PACK



FOLLOW US ON FACEBOOK
TO GET THE LATEST UPDATES.

What's in the Package

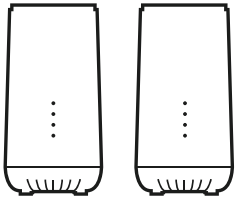

Router x2

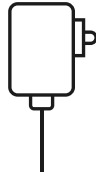

Power Adapter x2



Ethernet Cable



Start Guide

Product Overview

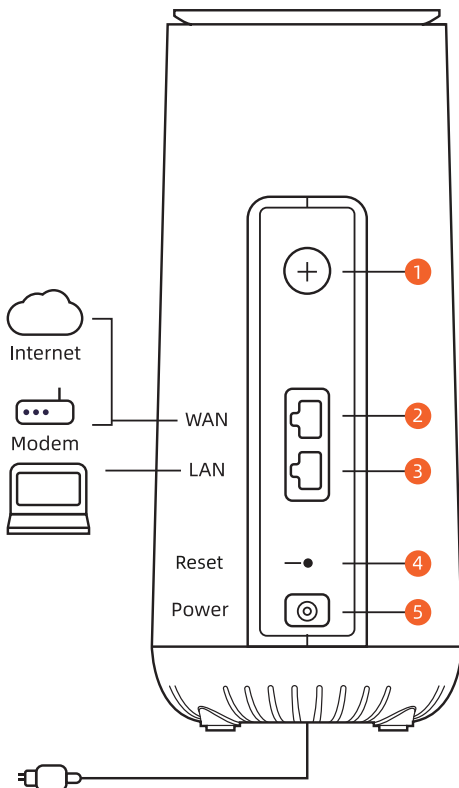

- 1 WPS Button
- 2 WAN/LAN Port
- 3 LAN Port
- 4 RESET Button
- 5 POWER Connector

- **WPS Button:**

WiFi Protected Setup Button. This enables the safe and password free way to setup WiFi connection of your WiFi device with WPS function.

- **WAN/LAN Port:**

Each of the units have this port, when the unit acts as Wifi router its WAN/LAN port must connected, to your existing modem with Ethernet cable for Internet access before setup; when the unit acts as Wifi point this port can provide additional Ethernet connection to your PC or other Ethernet connection devices after setup.

- **LAN Port:**

Provide the Ethernet connection to your device, or to have **Ethernet backhaul** between Wifi router and Wifi point by connecting their LAN ports with Ethernet cable.

- **RESET Button:**

It's for you to do hardware factory reset. With the unit powered on, directly press and hold the RESET button with a pin for approximately 7 to 10 seconds till the SYSTEM Led blinking. Release the reset button and wait for the device to reboot automatically to its factory default settings.

- **POWER Connector:**

Plug the adapter into POWER connector to power on and boot up the unit before setup.

Download DYNALINK APP

Before start the setup, your smart phone is required to enjoy the easy setup and MESH WiFi System management.

It is necessary to download DYNALINK APP and register or log in your Dynalink account in the APP.

You can scan the QR code to download the APP, or search DYNALINK APP in App Store or Google Play.



Before Setup

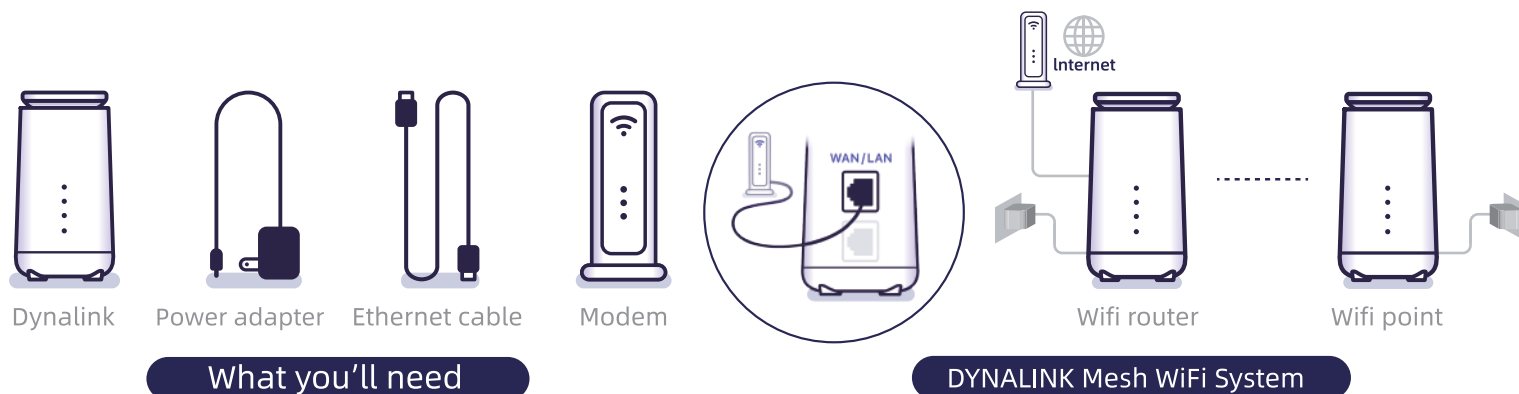

1. Pick either unit from DL-WME38 2 pack. It will be the Wifi router of the Mesh WiFi System. Power it on with the adapter in package.
2. Power off your modem and disconnect your older router from it.
3. Connect the WAN/LAN port of Wifi router with your modem using Ethernet cable and then power on your modem, make sure your modem working properly.
4. The other unit will be connected with Wifi router as Wifi point to form Mesh WiFi System in your home, **before then do not boot it up with Ethernet cable connection.**

1. Setup Wifi router

It is necessary to set up Wifi router first so to manage and form the Mesh WiFi System in your home.
Make sure you have read and prepared “Before Setup” on the other side of this QSG



- 1. After the preparation, your modem’s been powered off and on.
Modem connected to WAN/LAN port on Wifi router with Ethernet cable.
- 2. After Wifi router boots up, you will see the SYSTEM LED solid on with green light.
Once you power up the Wifi router, you are good to install APP and move to step 2.

2. Create or Log in Dynalink Account on APP

It is necessary to create Dynalink account to enjoy the APP function on your smart phone

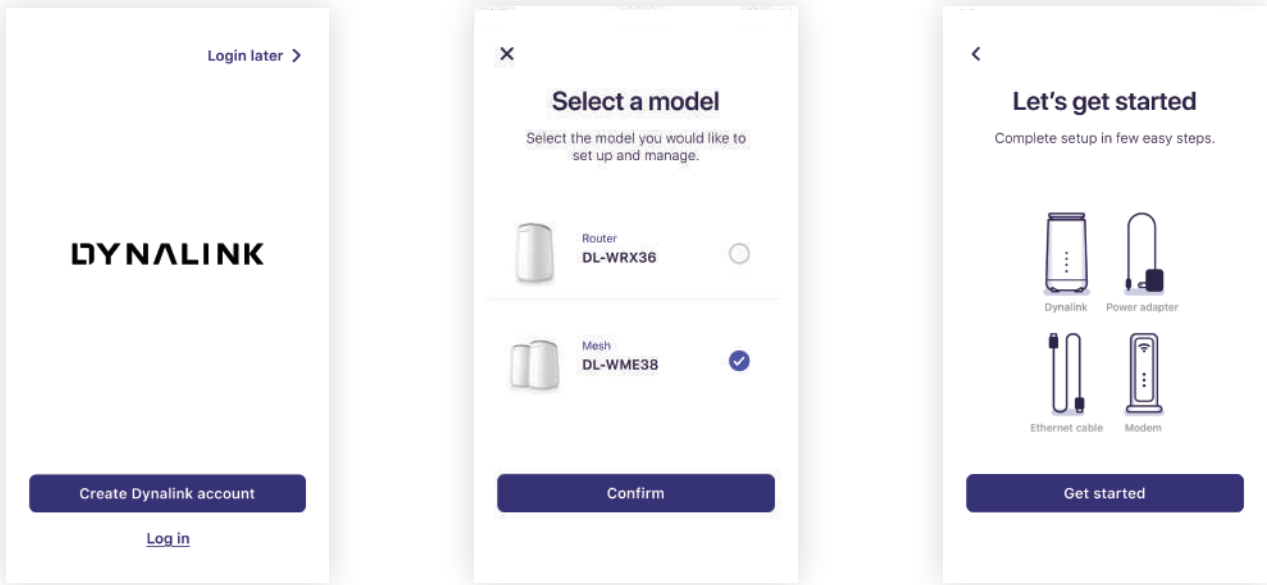

- 1. Open the downloaded DYNALINK APP with Internet/cellular connection on your phone
- 2. Depending on the status, there are 3 options to start with:
 - a. Press **<Create Dynalink account>** to register new account and to verify & activate your account.
 - b. If you have an existing Dynalink account, just press **<Log in>** to continue the setup steps in APP.
 - c. If your modem is not using DHCP to connect Internet, suggest pressing **<Login later>** to first set up the Wifi router network, but it is still required to login or create your Dynalink account once the setup completed.
- 3. Next, select model of DL-WME38, and APP will guide you step by step to set up Wifi router for your Mesh WiFi System.

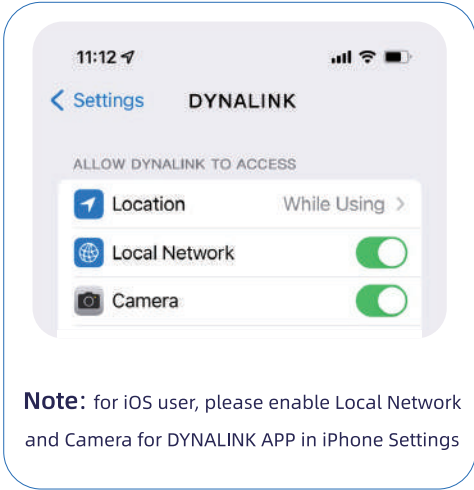

How Reset to Factory Default

- 1. If you need to change a Wifi router to Wifi point or vice versa. You need to perform a factory reset to the device first, the follow the steps in previous page for **< Set up Wifi router >** or **< Set up Wifi point >**
- 2.If you need to move one Wifi point to a different mesh network, you also need to do factory reset for the Wifi point first, then follow the steps in **< Set up Wifi point >** to add it to another mesh network

3. Setup Wifi point

After Wifi router setup and WiFi network created
Ensure no Ethernet cable connected to any port before the unit powered up; If already did, please do factory reset the unit first

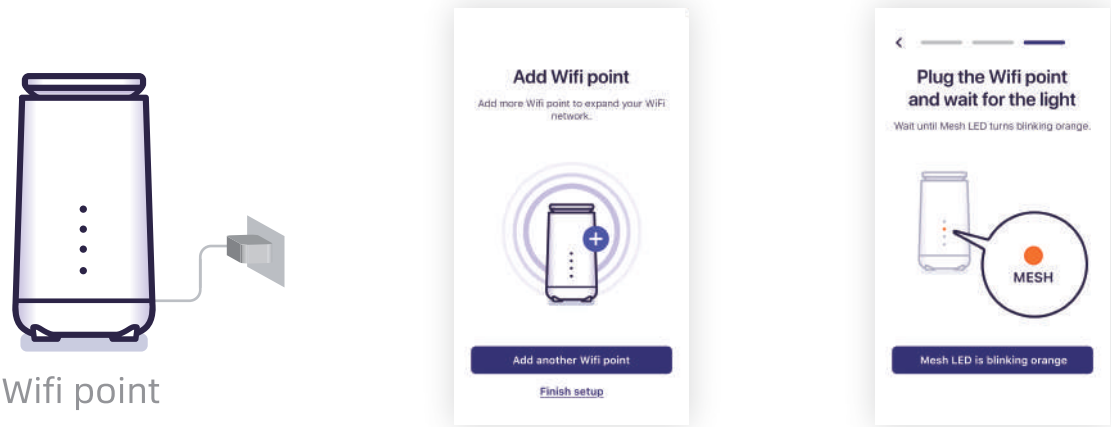

- 1. Place the other unit next to the Wifi router for setup
- 2. Power on the unit and open APP to add Wifi point to form the Mesh WiFi system
- 3. You will see the MESH LED blinking orange light on the Wifi point, this means the Wifi point is booted up and ready for the next steps
- 4. Follow the steps in APP

Relocation Wifi point for the Best Performance

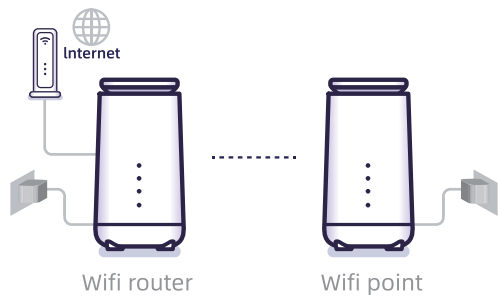

- 1. During setup, after you set the Wifi point location in app. Please wait for 30 seconds to power it off and place it at preferred location.
- 2. It may take some time for the units to prepare Mesh WiFi System and you will see the MESH LED on Wifi point in blinking green, once it’s done the MESH LED will show the signal quality as below:

● Good Signal ● Weak Signal ● No Signal

What’s LED lighting Telling you?

1. Wifi router Boot-up and Ready for APP Setup

*If the Internet LED is solid orange, means the router is not with Internet connection, it’s ok! Just run the set-up in APP, you can set further settings to get Internet connection.

2. Wifi router Setup Ready

Enjoy network

3. Wifi point Boot-up and Ready for adding into Mesh WiFi System

4. WiFi Mesh System Ready

*If on Wifi point you see MESH LED not lighting in green, check the section of “Relocation Wifi point for the Best Performance”

• What do the lights mean?

LED Name	Function	What does that mean? (on Wifi router)		Color Status	What does that mean? (on Wifi point)
WPS	WiFi Protected Setup with WiFi device	Searching and setting up WPS connection, timeout in 2 minutes		Blinking Every 0.5 sec	Searching and setting up WPS connection, timeout in 2 minutes
		WPS connection setup success, lighting solid green for 10 seconds, then lighting off		Green Solid for 10 sec	WPS connection setup success, lighting solid green for 10 seconds, then lighting off
		WPS pairing failure or timeout. Lighting become solid red for 10 seconds, then lighting off		Red Solid for 10 sec	WPS pairing failure or timeout. Lighting become solid red for 10 seconds, then lighting off
		WPS not in use		OFF	WPS not in use
Mesh	Mesh System			Blinking Every 2 sec	Waiting for pairing with Wifi router
		Pairing with Wifi point		Blinking Every 0.5 sec	Pairing with Wifi router; Preparing Mesh WiFi System
		Paired and connected with Wifi point		Green Solid	Paired and with good WiFi signal quality
				Orange Solid	Paired but WiFi signal quality is not good
				Red Solid for 10 sec	Pairing failed. Lighting 10 seconds, then goes off
		Paired but not connected with Wifi point		Red Solid	Paired but not connected with Wifi router
Internet	Internet Connection	Not paired with any Wifi point		OFF	
		With Internet connection		Green Solid	
		No Internet connection		Orange Solid	
System	Power on/Reboot	System is booting up		Blinking Every 1 sec	Unit is set as Wifi point or in default mode.
		Unit failure		Red Solid	System is booting up
		Power on Success		Green Solid	Unit failure
	Firmware Upgrade	Firmware upgrade in process, lighting blink in green till upgrade is done, then lighting will go off and unit starts rebooting		Blinking Every 0.5 sec	Power on Success
	Reset to Default	In reset process. Once done, lighting will go off and unit starts rebooting		Blinking Every 0.5 sec	Firmware upgrade in process, lighting blink in green till upgrade is done, then lighting will go off and unit starts rebooting
		In reset process. Once done, lighting will go off and unit starts rebooting		Blinking Every 0.5 sec	In reset process. Once done, lighting will go off and unit starts rebooting

Green Blink Green Fast Blink Green Solid Red Solid Orange Blink Orange Solid

Model:DL-WME38
Product name: AXE10200 Tri-band Mesh WiFi 6E System

REGULATION CONFORMITY:

This equipment complies with FCC 15B / FCC 15C / FCC 15E

REGULATORY COMPLIANCE NOTICES:

Class B Equipment

This equipment has been tested and found to comply with the limits for a Class B digital device, pursuant to Part 15 of the FCC Rules. These limits are designed to provide reasonable protection against harmful interference in a residential installation. This equipment generates, uses and can radiate radio frequency energy and, if not installed and used in accordance with the instructions, may cause harmful interference to radio communications. However, there is no guarantee that interference will not occur in a particular installation. If this equipment does cause harmful interference to radio or television reception, which can be determined by turning the equipment off and on, the user is encouraged to try to correct the interference by one or more of the following measures:

- Reorient or relocate the receiving antenna.
- Increase the separation between the equipment and receiver.
- Connect the equipment into an outlet on a circuit different from that to which the receiver is connected.
- Consult the dealer or an experienced radio/TV technician for help.

FCC Caution:

Any changes or modifications not expressly approved by the party responsible for compliance could void the user's authority to operate this equipment.

This device complies with Part 15 of the FCC Rules. Operation is subject to the following two conditions:

- (1) This device may not cause harmful interference, and
- (2) this device must accept any interference received, including interference that may cause undesired operation.

For product available in the USA/Canada market, only channel 1~11 can be operated. Selection of other channels is not possible.

The operation of this device is prohibited on oil platforms, cars, trains, boats, and aircraft, except that operation of this device is permitted in large aircraft while flying above 10,000 feet.

Operation of transmitters in the 5.925-7.125 GHz band is prohibited for control of or communications with unmanned aircraft systems.

This device is restricted for indoor use.

IMPORTANT NOTE:

FCC Radiation Exposure Statement:

This equipment complies with FCC radiation exposure limits set forth for an uncontrolled environment. This equipment should be installed and operated with minimum distance 25cm between the radiator & your body.

This Mesh WiFi System is With 1-year Hardware Limited Warranty
More info visit: <https://dynamlink.life/>

Need Help ?

✉ contactsupport_us@dynamlink.life



Call 1-833-338-4852
(Monday to Friday 8AM to 6PM CST)

ATTENTION AND DISCLAIMERS

Specifications are subject to change without notice. Dynalink is a registered trademark of Askey Computer Corp. Other brands and product names are trademarks or registered trademarks of their respective holders. Copyright © 2022, Dynalink. All rights reserved.

Maximum wireless signal rates are the physical rates derived from IEEE standard 802.22 specifications. Actual wireless data throughput and wireless coverage, and quantity of connected devices are not guaranteed and will be affected by a number of factors including but not limited to: the network conditions, WiFi client limitations, and environmental factors such as building materials, obstacles, volume and density of the traffic, the client location and the distance from router.

Clients required supporting WiFi 6 and 6E features including OFDMA, MU-MIMO, 1024-QAM, and BSS Coloring for the use of these features with the Mesh WiFi System.



Factory:1

Copyright © 2022, Dynalink. All rights reserved.

Manufacturer:
ASKEY Computer Corporation
10F, No. 119, JianKang RD., Zhonghe Dist., New Taipei City,
Taiwan

Made In Taiwan

1506-0HMH000