

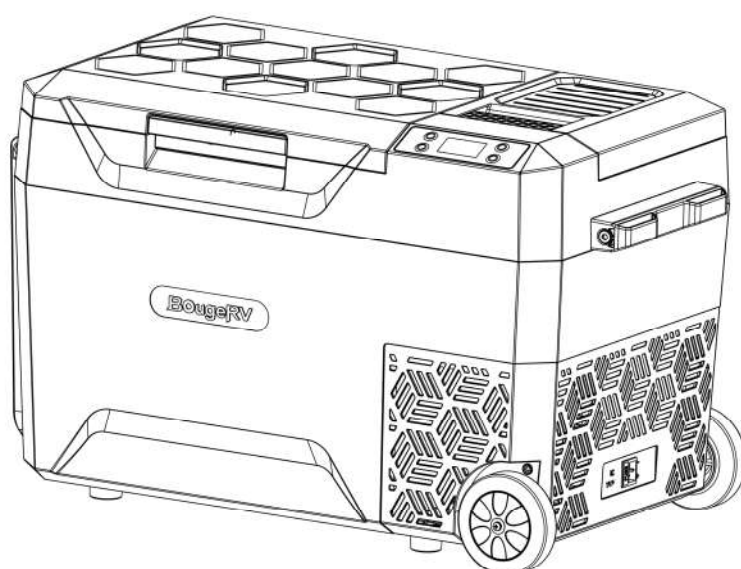

USER MANUAL

For Car Refrigerator



Model: CR03021
Capacity: 29L(31QT)

CRX2

Please read this operating manual carefully before using the device.

Keep it for future reference.

Contents

1 Package Contents	Page1
2 Safety Instructions	Page2
3 Preparation Before Use	Page3
4 Product Introduction	Page3
4.1 Product Features	Page3
4.2 Product Size	Page4
4.3 Product Structure	Page4
4.4 Battery Installation Steps	Page5
4.5 Partition Installation Steps	Page5
5 Operation Instructions	Page6
5.1 Power Supply	Page6
5.2 Turn On/Off	Page6
5.3 Temperature Setting	Page7
5.4 Battery Protection Setting(H/M/L Switch)	Page7
5.5 Temperature Unit Setting(°C/°F Switch)	Page8
5.6 Working Mode Setting(MAX/ECO Mode Switch)	Page8
5.7 Language Setting	Page9
5.8 Factory Reset	Page9
5.9 Refrigeration Prompt	Page9
5.10 Exit the Refrigeration Prompt	Page10
5.11 Memory Function	Page10
6 Car Battery Protection(H/M/L) Voltage Reference	Page11
7 Error Code Problems and Troubleshooting	Page13
8 Cleaning and Storage	Page15
9 Warranty and Maintenance	Page16
10 Specification	Page17

1 Package Contents

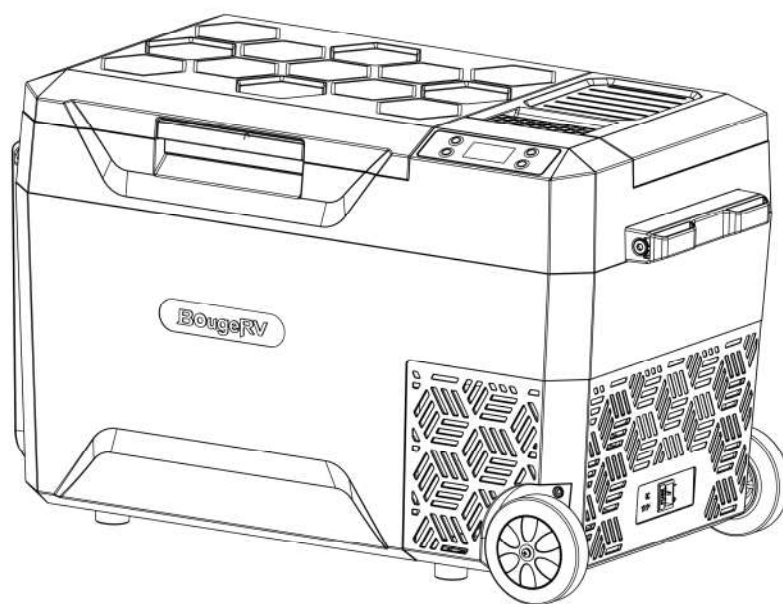

Portable Refrigerator



User Manual

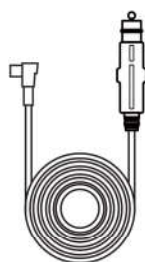

12/24V DC Power Cord



100~240V AC Adapter

2 Safety Instructions



WARNING! Failure to obey these warnings could result in malfunction of your device and possible injury to yourself and other users.

- Do not operate the device if it is visibly damaged.
- Do not block the gaps of the device with small items like pins, wires, etc.
- Do not expose the device to rain or immerse it in water.
- Do not place the device near open flames or other heat sources (heaters, direct sunlight, gas ovens etc.)
- Do not store explosive substances like spray cans with flammable propellants in the device.
- Before starting the device, ensure that the power supply line and the plug are dry.
- Check if the voltage specification on the nameplate matches the power supply voltage specification.
- Before starting the device, it must be left horizontal for more than 12 hours.
- Make sure that the device stays horizontal when it is running. The tilt angle must be less than 5° for a long time running and less than 45° for short time running.
- The refrigerator must be well-ventilated for heat dissipation and make sure to keep some space around it (Back Space 200mm, Side Space 100mm).
- The device may only be repaired by qualified personnel. Improper repairs can lead to safety hazards. If the power cable is damaged, it must be replaced by the manufacturer, customer service, or a similarly qualified person in order to prevent safety hazards.



NOTICE!

- The device can be used by children aged eight years and over, as well as by persons with reduced physical, sensory, or mental abilities or lack of experience and knowledge. However, they must be supervised during use or they must have been adequately taught how to use the fridge safely and have been made aware of the risks involved before using it.
- Children must be supervised to ensure that they do not play with the device.
- Disconnect the device or switch it off when you turn off the engine. Otherwise, you may discharge the battery.



CAUTION!

- Food is suggested to be stored in its original packaging or in suitable containers.
- Set a suitable temperature for food stored in the device.

3 Preparing Before Use

1. Unpack and take out the accessories, and let the refrigerator stand for 12 hours.
2. Before using it for the first time, clean the inside and outside of the car refrigerator with a damp cloth and wait until it is dry.
3. Place your refrigerator in a proper position which depends on your use scenario (car, truck, RV, camper, Van, Jeep, SUV, boat, home, etc.).
4. Based on your use scenario, choose the correct power cord (AC cord or DC cord) for the appropriate power supply. Please read the next part carefully for the details.

4 Product Introduction

4.1 Product Features

1. Multiple Application Scenarios

You can use the refrigerator in various vehicles such as SUVs, trucks, RVs, campers, Jeeps, vans, boats, etc. You can take it with you, during camping, tailgating, road trips, outdoor travels, off-road, and even at home.

2. Temperature Adjustment

· In normal mode: With a temperature range: $-4^{\circ}\text{F} \sim 68^{\circ}\text{F}$ ($-20^{\circ}\text{C} \sim 20^{\circ}\text{C}$), you can use it as Freezer or Fridge.

 **Note: The temperature setting of the R box (wheeled side box) must be higher than or equal to that of the L box (wheelless side box), otherwise, the temperature cannot be set independently.**

3. 3 Level Battery Protection Mode

The battery monitor will turn off the refrigerator as soon as the supply voltage falls below the set level.

4. 45dB Low Noise

The refrigerator features a low-noise design to ensure you have a good sleep after a long drive.

4.2 Product Size

Capacity: 31Quart/ 29L

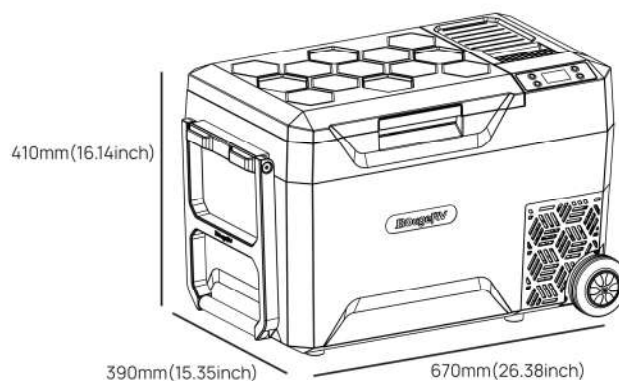

Dimensions:

Total Volume: 29L (without partition)

Left Box: 13L (with partition)

Right Box: 13L (with partition)

Refrigerator Size: 670×390×410mm

(26.38*15.35*16.14inch)

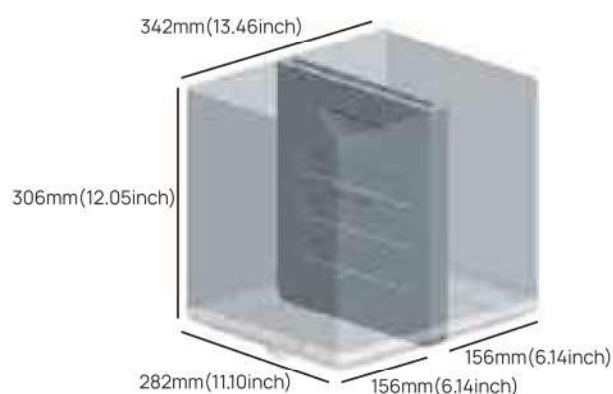

4.3 Product Structure

1. Ventilation Port
2. 12/24V Power Inlet
3. Door Hinge
4. Outer Handle
5. Control Panel
6. Safety Tie-down Point
7. Battery Compartment
8. Battery Cover
9. Sealed Rubber Ring
10. Refrigerator Compartment
11. Partition
12. Wheels
13. Long Handle

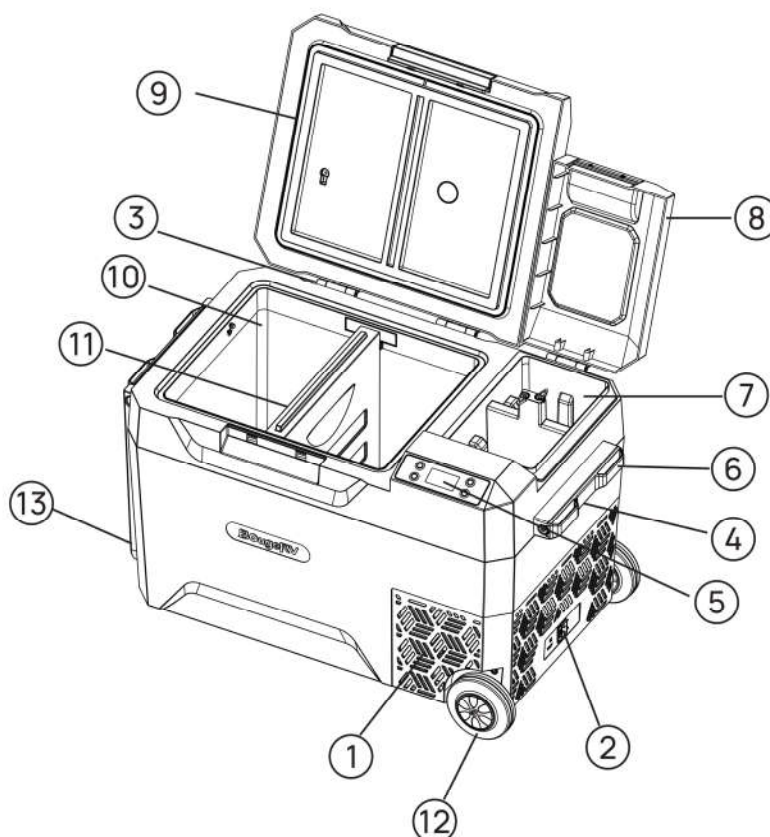

4.4 Battery Installation Steps

(Batteries not included, need to be purchased separately.)

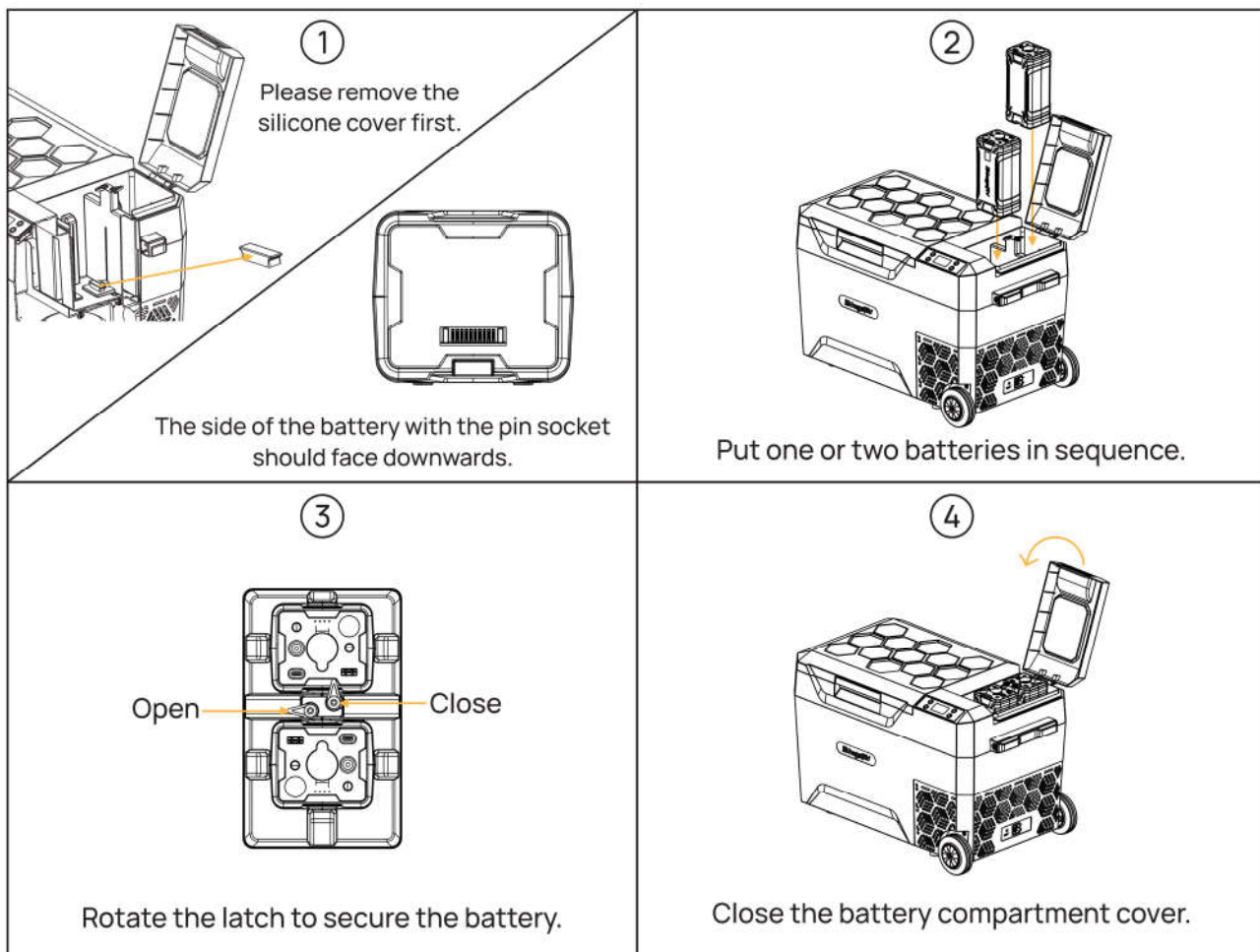

4.5 Partition Installation Steps

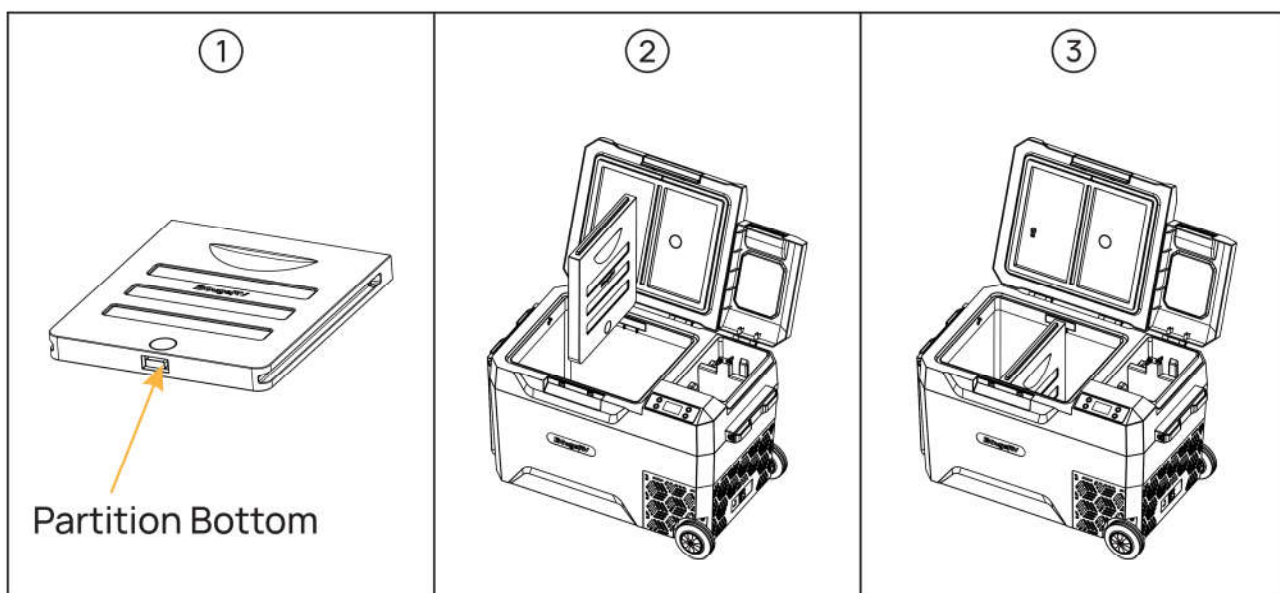

5 Operation Instruction

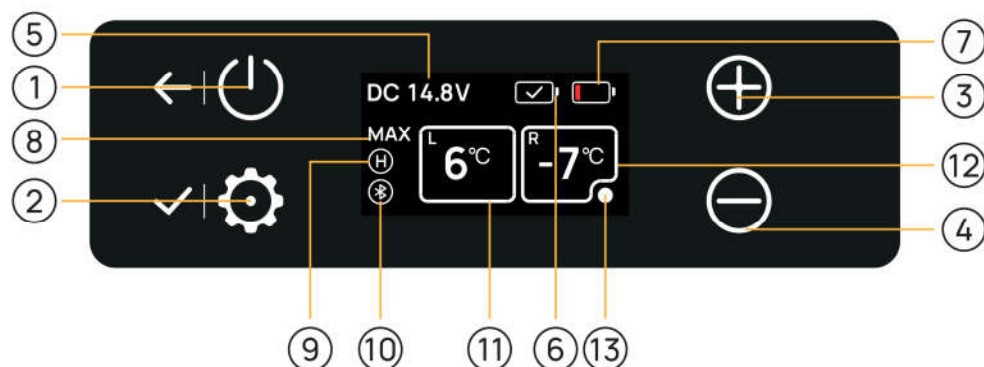

1. On/Off Button——“Return”
2. Setting Button——“Confirm”
3. Temp Increase Button——“Select Up”
4. Temp Decrease Button——“Select Down”
5. Voltage Display Area
6. First Battery Display Area
7. Second Battery Display Area
8. MAX/ECO Switching Display Area
9. Battery Protection Setting Display Area
10. Bluetooth Connection Display Area
11. Temperature Display Area(L Side)
12. Temperature Display Area(R Side)
13. Compressor Refrigeration Working Status (when the dot is on: the compressor refrigeration status is on/ when the dot is off: the compressor refrigeration status is off).

5.1 Power Supply

Connect to 12/24V DC power (use in car, truck, or power station, etc).

Connect to 100~240V AC power (use a home outlet or AC outlet of a power station, etc).

5.2 Turn On/Off

Press and hold the "  " button for 3 seconds to turn the refrigerator on.

5.3 Temperature Setting

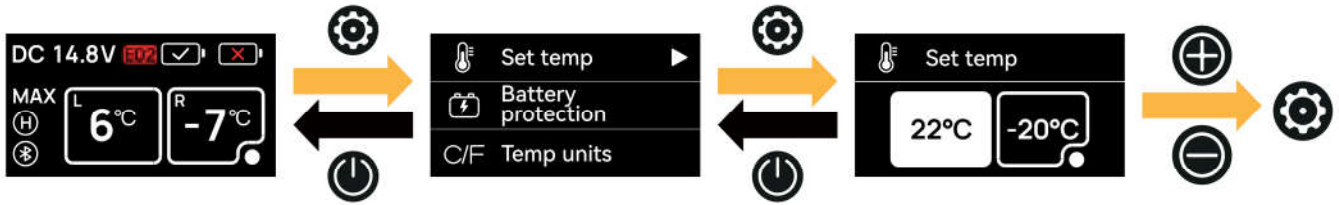

In the power-on state, when the LCD displays the real-time status, press the "⚙️" button to enter the function menu. Press "⊕" or "⊖" to switch the cursor to "Set temp", then press "⚙️" to enter the setting. Press "⊕" or "⊖" to select the box you want to set (the icon will light up), then press "⚙️" to enter the setting (the displayed temperature will flash). Press "⊕" or "⊖" to increase or decrease the set temperature, then press "⚙️" to save and exit the setting. If no operation is detected for 3 seconds, it will automatically return to the real-time status.

⚠️ Note: The temperature setting of the R box (wheeled side box) must be higher than or equal to that of the L box (wheelless side box), otherwise, the temperature cannot be set independently.

5.4 Battery Protection Setting (H/M/L Switch)

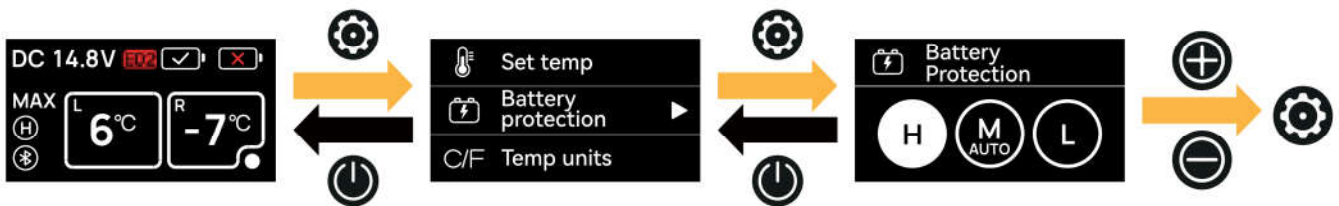

In the power-on state, when the LCD displays the real-time status, press the "⚙️" button to enter the function menu. Press "⊕" or "⊖" to switch the cursor to "Battery protection", then press the "⚙️" to enter the setting. Press "⊕" or "⊖" to select H/M/L, then press "⚙️" to save and exit the setting. If there is no operation detected within 3 seconds, the system will automatically return to real-time status.

5.5 Temperature Unit Setting (°C/°F Switch)

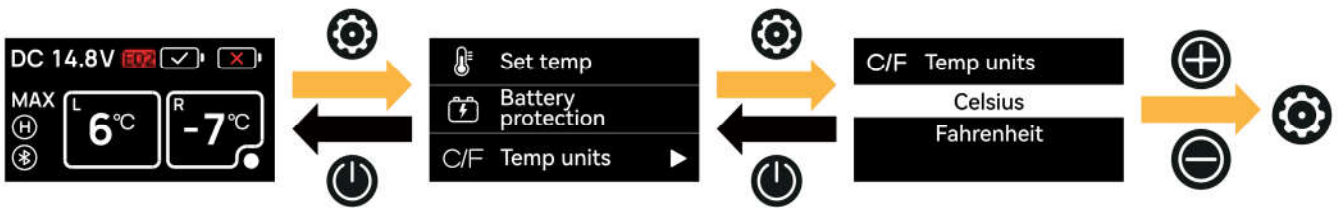

In the power-on state, when the LCD displays the real-time status, press the "⚙️" button to enter the function menu. Press "⏏️" or "⏏️" to switch the cursor to "Temp units", then press the "⚙️" to enter the setting. Press "⏏️" or "⏏️" to select "Celsius" or "Fahrenheit", then press the "⚙️" button to set it. If there is no operation detected within 3 seconds, the system will automatically return to the real-time status.

5.6 Working Mode Setting (MAX/ECO Mode Switch)

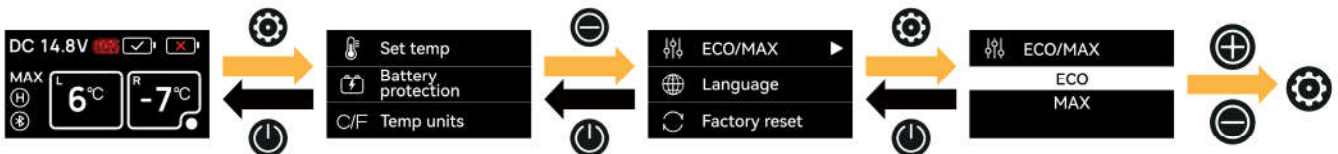

In the power-on state, when the LCD displays the real-time status, press the "⚙️" button to enter the function menu. Press "⏏️" or "⏏️" to switch the cursor to "ECO/MAX", then press the "⚙️" button to enter the setting. Press "⏏️" or "⏏️" to select the "ECO" or "MAX" mode, then press the "⚙️" button to set it. If there is no operation detected within 3 seconds, the system will automatically return to the real-time status.

5.7 Language Setting

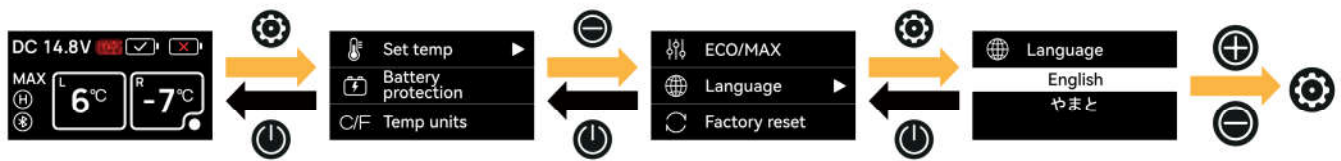

In the power-on state, when the LCD displays the real-time status, press the "⚙️" button to enter the function menu. Press "⏪" or "⏩" to switch the cursor to "Language", then press the "⚙️" to enter the setting. Press to select "English" or "Japanese" with "⏪" or "⏩"; then press "⚙️" to set it. If there is no operation detected within 3 seconds, the system will automatically return to the real-time status.

5.8 Factory Reset

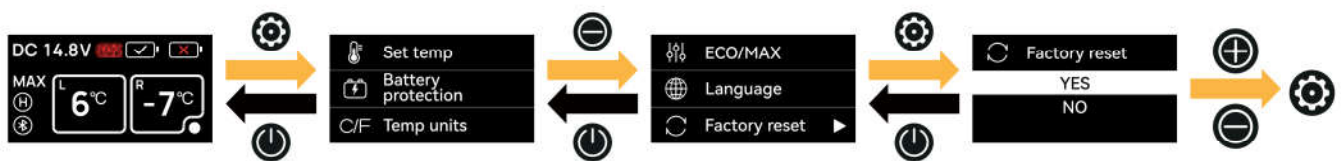

In the power-on state, when the LCD displays the real-time status, press the "⚙️" button to enter the function menu. Press "⏪" or "⏩" to switch the cursor to "Factory reset", then press the "⚙️" to enter the setting. Press "⏪" or "⏩" to select "YES" or "NO", then press "⚙️" to set it. If there is no operation detected within 3 seconds, the system will automatically return to real-time status.

5.9 Refrigeration Prompt

If no operation is detected within 30 seconds, it will automatically enter the cooling prompt status (standby mode).

5.10 Exit the Refrigeration Prompt

When the cooling prompt is displayed, press the "  " button to return to the real-time status.

5.11 Memory Function

The car refrigerator has a power-off memory function. When there is a power outage, it can automatically restore the previous working state (on/off status, working mode, etc.) when it is restarted, without the need to set it again.

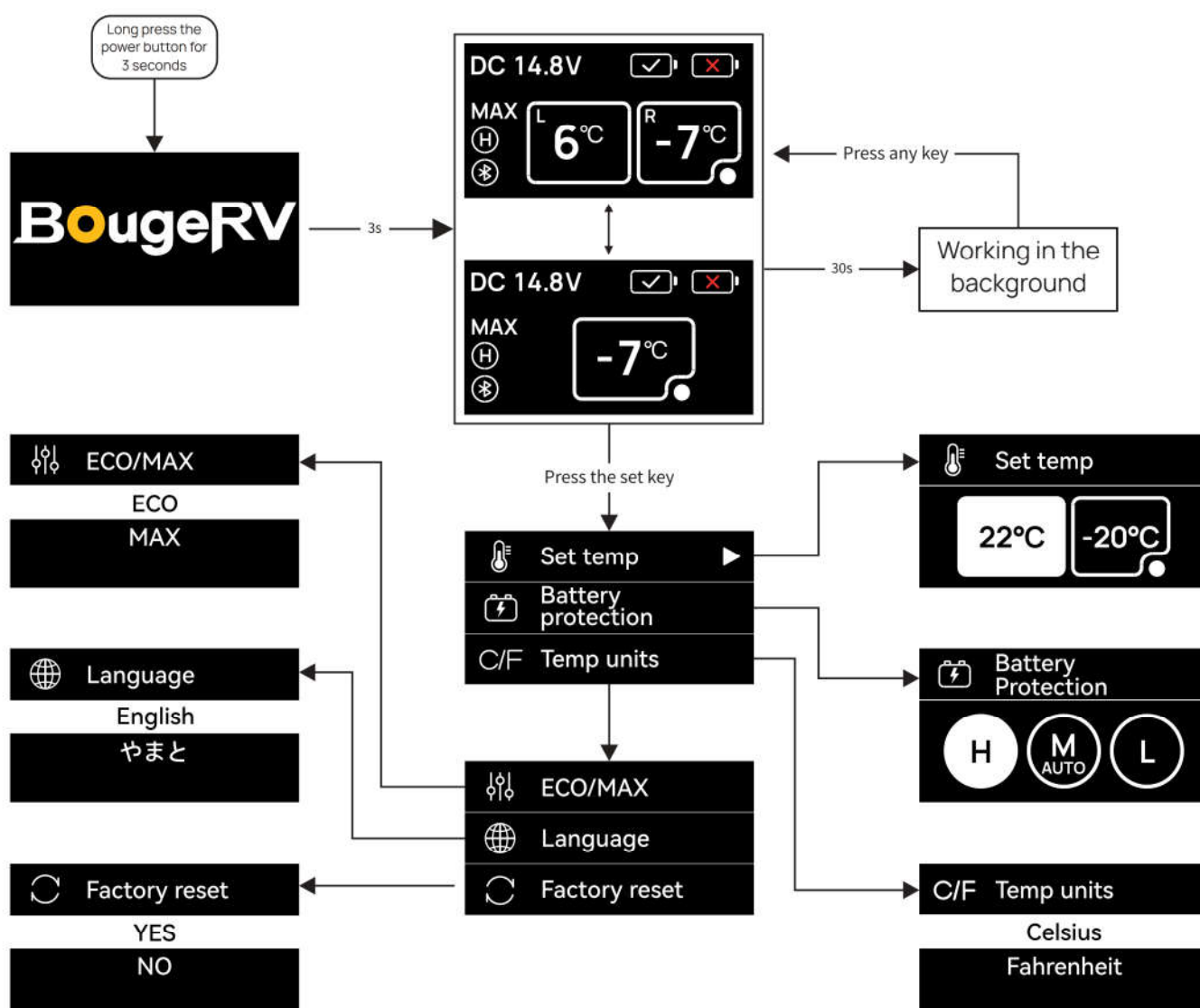

Panel display may show slight graphic changes due to version updates, but it does not affect the functionality of the product.

6 Car Battery Protection (H/M/L) Voltage Reference

The built-in ECO electronic control module can automatically monitor car battery voltage. The refrigerator will automatically shut off when the power consumption is excessive, thereby protecting the battery from depleting to a level that affects auto ignition.

When set to "High," the battery monitor will provide maximum protection for the battery, preventing the refrigerator from causing excessive discharge.

When set to "Low", the battery monitor will allow the refrigerator to use more of the battery energy.

Voltage	Factory Default Setting: High Level (Voltage Protection)		
	H (High) level	M (Medium) level	L (Low) level
12V	11.3V OFF, 12.5V ON	10.1V OFF, 11.4V ON	9.6V OFF, 10.9V ON
24V	24.6V OFF, 26V ON	22.3V OFF, 23.7V ON	21.3V OFF, 22.7V ON

FCC STATEMENT

This device complies with Part 15 of the FCC Rules. Operation is subject to the following two conditions:

- (1) This device may not cause harmful interference, and
- (2) This device must accept any interference received, including interference that may cause undesired operation.

Warning: Changes or modifications not expressly approved by the party responsible for compliance could void the user's authority to operate the equipment.

NOTE: This equipment has been tested and found to comply with the limits for a Class B

digital device, pursuant to Part 15 of the FCC Rules. These limits are designed to provide reasonable protection against harmful interference in a residential installation.

This equipment generates uses and can radiate radio frequency energy and, if not installed and used in accordance with the instructions, may cause harmful interference to radio communications. However, there is no guarantee that interference will not occur in a particular installation. If this equipment does cause harmful interference to radio or television reception, which can be determined by turning the equipment off and on, the user is encouraged to try to correct the interference by one or more of the following measures:

- Reorient or relocate the receiving antenna.
- Increase the separation between the equipment and receiver.
- Connect the equipment into an outlet on a circuit different from that to which the receiver is connected.
- Consult the dealer or an experienced radio/TV technician for help

FCC Radiation Exposure Statement

This equipment complies with FCC radiation exposure limits set forth for an uncontrolled environment. This equipment should be installed and operated with minimum distance 20cm between the radiator & your body

7 Error Code Explanations and Troubleshooting

If there is an unusual problem that cannot be resolved through simple fault analysis, please consult professional customer service with your order number for assistance:

If it was ordered from BougeRV Amazon Store, please contact:

service@bougerv.com.

If it was ordered from BougeRV Official Website, please contact:

support@bougerv.com.

📞 +1 (408) 656-8402 (9:00 AM - 6:00 PM CST, Mon-Fri)

Note: To help resolve the issue more efficiently, please include the following details in your email:

1. The order number.
2. Pictures or videos showing the problem, if possible.
3. How you connected the fridge and the power source used.
4. Any error codes displayed.
5. Your shipping address and phone number for part replacement.

Troubles	Causes and solutions
Car Refrigerator Does Not Work	<ul style="list-style-type: none">• Check if the power is connected properly (check if the plug is loose or if the positive and negative poles are reversed).• Check if the power switch on the operation panel is turned on.• Check if the cooling ventilation is normal.• Check if the fuse is blown.
Poor Cooling Performance	<ul style="list-style-type: none">• Check if the lid is closed properly.• Check if the door seal is damaged or deformed.• Check if there is poor ventilation around the fridge• Check if the temperature is set properly.
Abnormal Noise	<ul style="list-style-type: none">• The refrigerator is not placed on a flat level surface.• Check for vibrations in surrounding objects.• Parts in the refrigerator are loose or have fallen off.
Refrigerator Condensation	<ul style="list-style-type: none">• It is normal for slight condensation to form on the refrigerator surface when the air humidity exceeds 75%.

Explanations of Error Codes on the Display

Error Code	Error Description	Solution
E01	Fridge Battery Protection Function Triggered	<p>① Scenario One: The input voltage of the AC adapter is too low. Solution: Adjust the fridge battery protection level to "Medium" or "Low" (then wait for 3-5 mins to let the refrigerator reset itself). If it doesn't work, please replace it with a new AC adapter.</p> <p>② Scenario Two: The battery is low. Solution: Please recharge the battery.</p>
E02	Fan Overcurrent Cut-Off	If you confirm that the fan is malfunctioning, please replace it with a new fan.
E03	Compressor Motor Start Error	<p>Input voltage fault, the compressor starts up frequently. E3 appears when using the fridge in the car, please shut down the fridge for 5 minutes. If it still does not work after you restart it, then it is an E1 fault, please refer to the E1 troubleshooting and solution.</p> <p>When using the AC adapter to connect the refrigerator, if an E3 error occurs, please adjust the fridge battery protection level to "Medium" or "Low". If it doesn't work, please replace it with a new AC adapter.</p>
E04	Compressor Motor Speed Error	The compressor motor speed is too low. Please adjust the input voltage and reconnect the refrigerator to the power supply.
E05	Compressor Control Module Overheating Protection Cut-Off.	Shut down the fridge for 5 minutes. After that, check whether it is overheating due to a blockage around the vent of the compressor
E06	<p>① Incorrect Connection of the Thermistor (Open/Short Circuit)</p> <p>② Compressor and Fan Stop Working</p>	NTC open circuit or short circuit. Please restart and try again. If E6 continues to be displayed, please contact us.
E07	L Box Abnormal NTC Temperature	NTC is abnormal. Please restart and try again. If E7 continues to be displayed, please contact us.
E08	R Box Abnormal NTC Temperature	NTC is abnormal. Please restart and try again. If E8 continues to be displayed, please contact us.

8 Cleaning and Storage

▪ Cleaning

- Unplug the device first to avoid electric shock.
- Use a damp cloth to clean the device and dry it.
- Remove the cover and drain from the hole at the bottom of the device.
- Do not soak the device in water or wash it directly.
- Do not use abrasive cleaning agents as these can damage the device.

▪ Storage

If the device will not be in use for a long time, please follow these steps:

- Turn off the power and unplug the device.
- Remove all the items stored in the device.
- Remove the cover and drain from the hole, then wipe off excess water with a soft rag.
- Leave the lid slightly open to prevent odors from forming.
- Put the device in a cool and dry place.

▪ Defrosting

Humidity can form frost in the interior of the cooling device or on the evaporator, which will affect the cooling performance. Defrost the device regularly to avoid this.

- Switch off the device.
- Take out the contents of the device.
- Keep the lid open.
- Remove the cover and drain from the hole.
- Wipe off the defrosted water.



Never use hard or sharp tools to remove ice or to loosen objects which have frozen in place.

9 Warranty and Maintenance

Warranty

BougeRV PORTABLE REFRIGERATOR comes with a 2-year warranty that commences from the date of purchase on BougeRV Online Store or BougeRV Official Website, except in the following situations:

- Contrived damage.
- Damage caused by force majeure such as earthquake, conflagration, etc.
- Damage from inappropriate use or violating this instruction.
- Damage or malfunction caused by disassembling.

✓ 24-month limited warranty

🔧 Lifetime technical support

Customer Service

If you encounter any issues with operating the product, please contact us.

Amazon:

✉ service@bougerv.com

📞 +1 408 656 8402 (US)

9AM-6PM (CST) Monday-Friday

Closed on federal holiday

BougeRV Website:

✉ support@bougerv.com

📞 +1 408 656 8402 (US)

9AM-6PM (CST) Monday-Friday

Closed on federal holiday

VIP Service & Extra 1-year Warranty

1. Search "QR Code" on your FB
2. Scan the QR Code beside
3. Join "BougeRV Car Refrigerator Club"
4. You become a VIP and get a 3-year warranty



10 Specification

Model	CR03022
Rated Voltage	DC12/24V or AC100~240V 50/60HZ (using a dedicated adapter)
Rated Power	70W
Capacity	29L(31QT)
Noise	≤45dB
Temperature Range	-20~+20°C (-4~+68°F)
Climate Category	SN/N/ST/T
Refrigerant	R1234yf(45g)
Dimensions(L*W*H)	L×W×H=670×390×410mm(26.38*15.35*16.14inch)
Net Weight	18kg(39.68lb)

*Due to product improvement, the technical information might be different from the actual information, please refer to the rating label on the product.

▪ Disposal:

Place the packaging material in the appropriate recycling waste bins wherever possible.



If you want to eventually dispose of the product, ask your local recycling center or specialty distributor for details on how to do so in accordance with the applicable disposal regulations.

Explore more from BougeRV



@bougerv



@BougeRV



@BougeRV

