

MAXO<sub>2</sub><sup>®</sup>+ AE Industrial

# ∴ MaxO<sub>2</sub><sup>®</sup>+

OPERATING MANUAL &  
INSTRUCTIONS FOR USE







Maxtec  
2305 South 1070 West  
Salt Lake City, Utah 84119  
USA

TEL (800) 748.5355  
FAX (801) 973.6090  
email: sales@maxtec.com  
website: www.maxtec.com



QNET BV  
Kantstraat 19  
NL-5076 NP Haaren  
The Netherlands



## ✶ CLASSIFICATION

Protection against electric shock: . . . . . Internally powered equipment.  
Protection against water: . . . . . IPX1  
Mode of Operation: . . . . . Continuous  
Sterilization: . . . . . See section 7.0  
Flammable anesthetic mixture: . . . . . Not suitable for use in presence of a flammable anesthetic mixture



### Product Disposal Instructions:

The sensor, batteries, and circuit board are not suitable for regular trash disposal. Return sensor to Maxtec for proper disposal or dispose according to local guidelines. Follow local guidelines for disposal of other components.

## ✶ WARRANTY

Under normal operating conditions, Maxtec warrants the MAXO<sub>2</sub>+ Analyzer to be free from defects of workmanship or materials for a period of 2-years from the date of shipment from Maxtec, provided that the unit is properly operated and maintained in accordance with Maxtec's operating instructions. Based on Maxtec product evaluation, Maxtec's sole obligation under the foregoing warranty is limited to making replacements, repairs, or issuing credit for equipment found to be defective. This warranty extends only to the buyer purchasing the equipment directly from Maxtec or through Maxtec's designated distributors and agents as new equipment.

Maxtec warrants MAXO<sub>2</sub>+ oxygen sensor in the MAXO<sub>2</sub>+ Analyzer to be free from defects in material and workmanship for a period of 2-years from Maxtec's date of shipment in a MAXO<sub>2</sub>+ unit. Should a sensor fail prematurely, the replacement sensor is warranted for the remainder of the original sensor warranty period.

Routine maintenance items, such as batteries, are excluded from warranty. Maxtec and any other subsidiaries shall not be liable to the purchaser or other persons for incidental or consequential damages or equipment that has been subject to abuse, misuse, mis-application, alteration, negligence or accident.

**These warranties are exclusive and in lieu of all other warranties, expressed or implied, including warranty of merchantability and fitness for a particular purpose.**

## ⚠️ WARNINGS

**Indicates a potentially hazardous situation, if not avoided, could result in death or serious injury.**

- » **Improper use of this device can cause inaccurate oxygen readings which can lead to improper treatment, hypoxia or hyperoxia.** Follow the procedures outlined in this user manual.
- » Device specified for dry gas only.
- » Before use, all individuals who will be using the MAXO<sub>2</sub>+ must become thoroughly familiar with the information contained in this Operation Manual. Strict adherence to the operating instructions is necessary for safe, effective product performance.  
This product will perform only as designed if installed and operated in accordance with the manufacturer's operating instructions.
- » Use only genuine Maxtec accessories and replacement parts. Failure to do so may seriously impair the analyzer's performance. Repair of this equipment must be performed by a qualified service technician experienced in repair of portable hand held equipment.
- » Calibrate the MAXO<sub>2</sub>+ weekly when in operation, or if environmental conditions change significantly. (ie, Elevation, Temperature, Pressure, Humidity — refer to Section 3.0 of this manual).
- » Use of the MAXO<sub>2</sub>+ near devices that generate electrical fields may cause erratic readings.
- » If the MAXO<sub>2</sub>+ is ever exposed to liquids (from spills or immersion) or to any other physical abuse, turn the instrument OFF and then ON. This will allow the unit to go through its self test to assure everything is operating correctly.
- » Never autoclave, immerse or expose the MAXO<sub>2</sub>+ (including sensor) to high temperatures (>70°C). Never expose the device to pressure, irradiation vacuum, steam, or chemicals.
- » This device does not contain automatic barometric pressure compensation.
- » Although the sensor of this device has been tested with various gases including nitrous oxide, Halothane, Isoflurane, Enflurane, Sevoflurane and Desflurane and found to have acceptably low interference, the device in entirety (including electronics) is not suitable for use in the presence of a flammable anesthetic mixture with air or with oxygen or nitrous oxide. Only the threaded sensor face, flow diverter, and "T" adapter may be allowed to contact such a gas mixture.
- » NOT for use with inhalation agents. Operating the device in flammable or explosive atmospheres may result in fire or explosion.

**CAUTION:** Indicates a potentially hazardous situation, if not avoided, could result in minor or moderate injury and property damage.

- » Replace the batteries with recognized high quality AA Alkaline or Lithium batteries.
- ❌ **DO NOT** use rechargeable batteries.
- » If the unit is going to be stored (not in use for 1 month), we recommend that you remove the batteries to protect the unit from potential battery leakage.
- » The Maxtec MAX-250 oxygen sensor is a sealed device containing a mild acid electrolyte, lead (Pb), and lead acetate. Lead and lead acetate are hazardous waste constituents and should be disposed of properly, or returned to Maxtec for proper disposal or recovery.
- ❌ **DO NOT** use ethylene oxide sterilization.
- ❌ **DO NOT** immerse the sensor in any cleaning solution, autoclave or expose the sensor to high temperatures.
- » Dropping sensor can adversely affect its performance.
- » The device will assume a percent oxygen concentration when calibrating. Be sure to apply 100% oxygen, or ambient air concentration to the device during calibration or the device will not calibrate correctly.

**NOTE:** This product is latex free.

## ✶ TABLE OF CONTENTS

<b>Classification</b> .....	<b>I</b>
<b>Warranty</b> .....	<b>I</b>
<b>Warnings</b> .....	<b>II</b>
<b>1.0 SYSTEM OVERVIEW</b> .....	<b>1</b>
1.1 Base Unit Description .....	1
1.2 Symbol Guide .....	1
1.3 Component Identification .....	2
1.4 Component Description .....	2
1.5 MAX-250+ Oxygen Sensor .....	3
<b>2.0 OPERATING INSTRUCTIONS</b> .....	<b>3</b>
2.1 Getting Started .....	3
2.1.1 Protect Tape .....	3
2.1.2 Automatic Calibration .....	3
2.2 Calibrating the MAXO <sub>2</sub> + Oxygen Analyzer .....	4
2.2.1 In-line Calibration (Flow Diverter - Tee Adaptor) .....	4
2.2.2 Direct Flow Calibration (Barb) .....	5
<b>3.0 FACTORS INFLUENCING ACCURATE READINGS</b> .....	<b>5</b>
3.1 Elevation Changes .....	5
3.2 Temperature Effects .....	5
3.3 Pressure Effects .....	5
3.4 Humidity Effects .....	6
<b>4.0 CALIBRATION ERRORS AND ERROR CODES</b> .....	<b>6</b>
<b>5.0 CHANGING THE BATTERIES</b> .....	<b>7</b>
<b>6.0 CHANGING THE OXYGEN SENSOR</b> .....	<b>8</b>
6.1 MAXO <sub>2</sub> +AE Model .....	8
<b>7.0 CLEANING AND MAINTENANCE</b> .....	<b>8</b>
<b>8.0 SPECIFICATIONS</b> .....	<b>9</b>
8.1 Base Unit Specifications .....	9
8.2 Sensor Specifications .....	9
<b>9.0 MAXO<sub>2</sub>+ SPARE PARTS AND ACCESSORIES</b> .....	<b>9</b>
9.1 Included with your Unit .....	9
9.2 Standard Replacement Parts .....	10
9.3 Optional Accessories .....	10
9.3.1 Optional Adaptors .....	10
9.3.2 Mounting Options .....	10
9.3.3 Carrying Options .....	10



## ✶ 1.0 SYSTEM OVERVIEW

### 1.1 Base Unit Description

The MAXO<sub>2</sub>+ analyzer provides unparalleled performance and reliability due to an advanced design that includes the following features and operational benefits.

- » Extra-life oxygen sensor of approximately 1,500,000 O<sub>2</sub> percent hours (2-year warranty)
- » Durable, compact design that permits comfortable, hand-held operation and easy to clean
- » Operation using only two AA Alkaline batteries (2 x 1.5 Volts) for approximately 5000 hours of performance with continuous use. For extra extended long life, two AA Lithium batteries may be used.
- » Oxygen-specific, galvanic sensor that achieves 90% of final value in approximately 15 seconds at room temperature.
- » Large, easy-to-read, 3 1/2-digit LCD display for readings in the 0-100% range.
- » Simple operation and easy one-key calibration.
- » Self-diagnostic check of analog and microprocessor circuitry.
- » Low battery indication.
- » Calibration reminder timer that alerts the operator, using a calibration icon on the LCD display, to perform a unit calibration.

### 1.2 Symbol Guide

The following symbols and safety labels are found on the MAXO<sub>2</sub>+



Follow instructions for use.



Warning



Meets ETL standards



Do not throw away. Follow local guidelines for disposal.



Calibration required



Lot code/Batch code



Do Not



Federal law (USA) restricts this device to sale by or on the order of a physician.



On/off Button



Calibration Button



Low Battery



Percent



Manufacturer



Catalog Number



Serial Number



Drip Proof

### 1.3 Component Identification

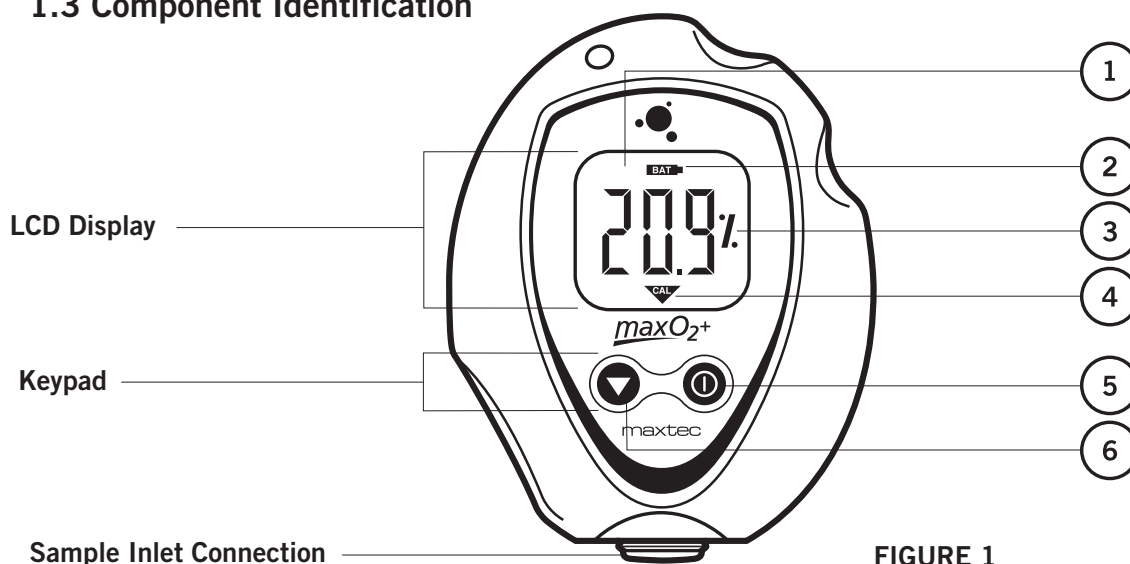

FIGURE 1

### 1.4 Component Description

#### **A** LCD Display

- ① **3 1/2-Digit Display** - The 3 1/2 digit liquid crystal display (LCD) provides direct readout of oxygen concentrations in the range of 0 – 105.0% (100.1% to 105.0% used for calibration determination purposes). The digits also display error codes and calibration codes as necessary.
- ② **Low Battery Indicator** **BAT** - The low battery indicator is located at the top of the display and is only activated when the voltage on the batteries is below a normal operating level.
- ③ **“%” symbol** - The “%” sign is located to the right of the concentration number and is present during normal operation.
- ④ **Calibration symbol** - **CAL** The calibration symbol is located at the bottom of the display and is timed to activate when a calibration is necessary.

#### **B** Keypad

- ⑤ **ON/OFF Key** - **⏻** This key is used to turn the device on or off.
- ⑥ **Calibration Key** - **⏵** This key is used to calibrate the device. Holding the key for more than three seconds will force the device to enter a calibration mode.

- C** **Sample Inlet Connection** - This is the port at which the device is connected to determine oxygen concentration.



## 1.5 MAX-250 Oxygen Sensor

The MAX-250+ oxygen sensor offers stability and extra life. The MAX-250+ is a galvanic, partial pressure sensor that is specific to oxygen. It consists of two electrodes (a cathode and an anode), a teflon membrane and an electrolyte. Oxygen diffuses through the teflon membrane and immediately reacts at a gold cathode. Concurrently, oxidation occurs electrochemically at the lead anode, generating an electrical current and providing a voltage output. Electrodes are immersed in a unique gelled weak acid electrolyte which is responsible for the sensors long life and motion insensitive characteristic. Since the sensor is specific to oxygen, the current generated is proportional to the amount of oxygen present in the sample gas. When no oxygen is present, there is no electrochemical reaction and therefore, negligible current is produced. In this sense, the sensor is self-zeroing.

## ✶ 2.0 OPERATING INSTRUCTIONS

### 2.1 Getting Started

#### 2.1.1 Protect Tape

Prior to turning on the unit, a protective film covering the threaded sensor face must be removed. After removing the film, wait approximately 20 minutes for the sensor to reach equilibrium.

#### 2.1.2 Automatic Calibration

After the unit is turned on it will automatically calibrate to room air. The display should be stable and reading 20.9%.

**CAUTION:** The device will assume a percent oxygen concentration when calibrating. Be sure to apply 100% oxygen, or ambient air concentration to the device during calibration or the device will not calibrate correctly.

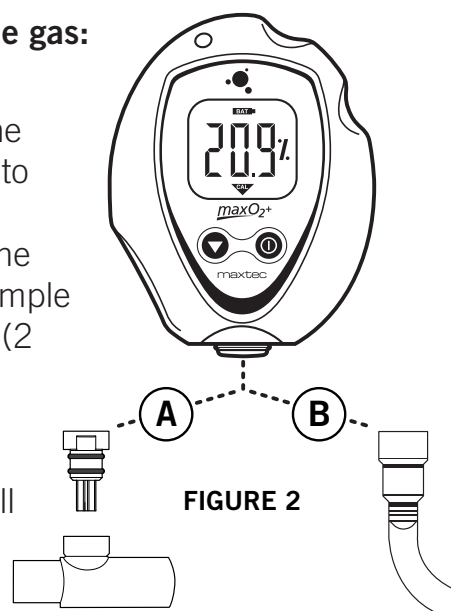

**To check the oxygen concentration of a sample gas:**  
(after the unit has been calibrated)

1. Connect the Tygon tubing to the bottom of the analyzer by threading the barbed adapter onto the oxygen sensor. (FIGURE 2, B)
2. Attach the other end of the sample hose to the sample gas source and initiate flow of the sample to the unit at a rate of 1-10 liters per minute (2 liters per minute is recommended).
3. Using the "ON/OFF" ⏻ key, make sure the unit is in the power "ON" mode.
4. Allow the oxygen reading to stabilize. This will normally take about 30 seconds or more.



## 2.2 Calibrating the MAXO<sub>2</sub>+ Oxygen Analyzer

**NOTE:** We recommend use of medical grade USP or >99% purity oxygen when calibrating the MAXO<sub>2</sub>+

The MAXO<sub>2</sub>+ Analyzer should be calibrated upon initial power-up. Thereafter, Maxtec recommends calibration on a weekly basis. To serve as a reminder, a one week timer is started with each new calibration. At the end of one week a reminder icon “” will appear on the bottom of the LCD. Calibration is recommended if the user is unsure when the last calibration procedure was performed, or if the measurement value is in question. Start calibration by pressing the  Calibration key for more than 3 seconds. The MAXO<sub>2</sub>+ will automatically detect if you are calibrating with 100% oxygen or 20.9% oxygen (normal air).



**⊘ DO NOT** attempt to calibrate to any other concentration.

**For ID testing, (or optimum accuracy) a new calibration is required when:**

- » The measured O<sub>2</sub> percentage in 100% O<sub>2</sub> is below 99.0% O<sub>2</sub>.
- » The measured O<sub>2</sub> percentage in 100% O<sub>2</sub> is above 101.0% O<sub>2</sub>.
- » The CAL reminder Icon is blinking at the bottom of the LCD.
- » If you are unsure about the displayed O<sub>2</sub> percentage (See Factors influencing accurate readings).



A simple calibration may be made with the sensor open to static at Ambient air. For optimum accuracy Maxtec recommends that the Sensor be placed in a closed loop circuit where gas flow is moving across the sensor in a controlled manner. Calibrate with the same type of circuit and flow that you will use in taking your readings.

### 2.2.1 In Line Calibration (Flow Diverter – Tee Adapter)

1. Attach the diverter to the MAXO<sub>2</sub>+ by threading it on to the bottom of the sensor.
2. Insert the MAXO<sub>2</sub>+ in the center position of the tee adapter. (FIGURE 2, A)
3. Attach an open-ended reservoir to the end of the tee adapter. Then start the calibration flow of oxygen at two liters per minute.
  - » Six to 10 inches of corrugated tubing works well as a reservoir. A calibration oxygen flow to the MAXO<sub>2</sub>+ of two liters per minute is recommended to minimize the possibility of obtaining a “false” calibration value.
4. Allow the oxygen to saturate the sensor. Although a stable value is usually observed within 30 seconds, allow at least two minutes to ensure that the sensor is completely saturated with the calibration gas.
5. If the MAXO<sub>2</sub>+ is not already turned on, do so now by pressing the analyzer “ON”  button.
6. Press the Cal  button on the MAXO<sub>2</sub>+ until you read the word CAL on the analyzer display. This can take approximately 3 seconds. The analyzer will now look for a stable sensor signal and a good reading. When obtained, the analyzer will display the calibration gas on the LCD.

**NOTE:** Analyzer will read “Cal Err St” if the sample gas has not stabilized.

### 2.2.2 Direct Flow Calibration (Barb)

1. Attach the Barbed Adapter to the MAXO<sub>2</sub>+ by threading it on to the bottom of the sensor.
2. Connect the Tygon tube to the barbed adapter. (FIGURE 2, B)
3. Attach the other end of the clear sampling tube to a source of oxygen with a known oxygen concentration value. Initiate flow of the calibration gas to the unit. Two liters per minute is recommended.
4. Allow the oxygen to saturate the sensor. Although a stable value is usually observed within 30 seconds, allow at least two minutes to ensure that the sensor is completely saturated with the calibration gas.
5. If the MAXO<sub>2</sub>+ is not already turned on, do so now by pressing the analyzer "ON"  button.
6. Press the Cal  button on the MAXO<sub>2</sub>+ until you read the word CAL on the analyzer display. This can take approximately 3 seconds. The analyzer will now look for a stable sensor signal and a good reading.  
When obtained, the analyzer will display the calibration gas on the LCD.

## ✶ 3.0 FACTORS INFLUENCING ACCURATE READINGS

### 3.1 Elevation/Pressure Changes

- » Changes in elevation result in a reading error of approximately 1% of reading per 250 feet.
- » In general, calibration of the instrument should be performed when elevation at which the product is being used changes by more than 500 feet.
- » This device does not automatically compensate for changes in barometric pressure or altitude. If the device is moved to a location of a different altitude, it must be recalibrated before use.

### 3.2 Temperature Effects

The MAXO<sub>2</sub>+ will hold calibration and read correctly within  $\pm 3\%$  when at thermal equilibrium within the operating temperature range. The device must be thermally stable when calibrated and allowed to thermally stabilize after experiencing temperature changes before readings are accurate. For these reasons, the following is recommended:

- » For best results, perform the calibration procedure at a temperature close to the temperature where analysis will occur.
- » Allow adequate time for the sensor to equilibrate to a new ambient temperature.

**CAUTION:** "CAL Err St" may result from a sensor that has not reached thermal equilibrium.

### 3.3 Pressure Effects

Readings from the MAXO<sub>2</sub>+ are proportional to the partial pressure of oxygen. The partial pressure is equal to the concentration times the absolute pressure. Thus, the readings are proportional to the concentration if the pressure is held constant. Therefore, the following are recommended:

- » Calibrate the MAXO<sub>2</sub>+ at the same pressure as the sample gas.
- » If sample gases flow through tubing, use the same apparatus and flow rates when calibrating as when measuring.

### 3.4 Humidity Effects

Humidity (non-condensing) has no effect on the performance of the MAXO<sub>2</sub>+ other than diluting the gas, as long as there is no condensation. Depending on the humidity, the gas may be diluted by as much as 4%, which proportionally reduces the oxygen concentration. The device responds to the actual oxygen concentration rather than the dry concentration. Environments where condensation may occur are to be avoided since moisture may obstruct passage of gas to the sensing surface, resulting in erroneous readings and slower response time. For this reason, the following is recommended:

» Avoid usage in environments greater than 95% relative humidity.

**HELPFUL HINT:** Dry sensor by lightly shaking moisture out, or flow a dry gas at two liters per minute across the sensor membrane.

## ✂ 4.0 CALIBRATION ERRORS AND ERROR CODES

The MAXO<sub>2</sub>+ analyzers have a self test feature built into the software to detect faulty calibrations, oxygen sensor failures, and low operating voltage. These are listed below, and include possible actions to take, if an error code occurs.

### **E02: No sensor attached**

**MAXO<sub>2</sub>+AE:** Disconnect and reconnect external sensor. Unit should perform an auto calibration, and should read 20.9%. If not, contact Maxtec Customer Service for possible sensor replacement or cable replacement.

### **E03: No valid calibration data available**

Make sure unit has reached thermal equilibrium. Press and hold the Calibration Button for three seconds to manually force a new calibration.

**E04: Battery below minimum operating voltage**  
Replace batteries.

### **CAL Err St: O<sub>2</sub> Sensor reading not stable**

Wait for displayed oxygen reading to stabilize, when calibrating the device at 100% oxygen.

Wait for unit to reach thermal equilibrium, (Please note that this can take up to one half hour, if the device is stored in temperatures outside the specified operating temperature range).

### **CAL Err lo: Sensor voltage too low**

Press and hold the Calibration Button for three seconds to manually force a new calibration. If unit repeats this error more than three times, contact Maxtec Customer Service for possible sensor replacement.

### **CAL Err hi: Sensor voltage too high**

Press and hold the Calibration Button for three seconds to manually force a new calibration. If unit repeats this error more than three times, contact Maxtec Customer Service for possible sensor replacement.

**CAL Err Bat:** Battery voltage too low to recalibrate.  
Replace batteries.

## ✶ 5.0 CHANGING THE BATTERIES

Batteries should be changed by service personnel.

- » Use only brand name batteries.
- » Replace with two AA batteries and insert per orientation marked on the device.

Should the batteries require changing, the device will indicate this in one of two ways:

- » The battery icon on the bottom of the display will begin to flash. This icon will continue to flash until the batteries are changed. The unit will continue to function normally for approx. 200 hours.
- » If the device detects a very low battery level, an error code of “E04” will be present on the display, and the unit will not function until the batteries are changed.

To change the batteries, begin by removing the three screws from the back of the device. A #1 Phillips screwdriver is required to remove these screws.

Once the screws are removed, gently separate the two halves of the device.

The batteries can now be replaced from the back half of the case. Be sure to orient the new batteries as indicated in the embossed polarity on the back case.

**NOTE:** If the batteries are installed incorrectly the batteries will not make contact and the device will not operate.

Carefully, bring the two halves of the case together while positioning the wires so they are not pinched between the two case halves. The gasket separating the halves will be captured on the back case half.

Reinsert the three screws and tighten until the screws are snug. (FIGURE 3)

The device will automatically perform a calibration and begin displaying % of oxygen.

**HELPFUL HINT:** If unit does not function, verify that the screws are tight to allow proper electrical connection.

**HELPFUL HINT:** Before closing the two case halves together, verify that the keyed slot on top of the coiled cable assembly is engaged on the small tab located on the back case. This is designed to position the assembly in the correct orientation and prevent it from rotating. Improper positioning could hinder the case halves from closing and prevent operation when tightening the screws.

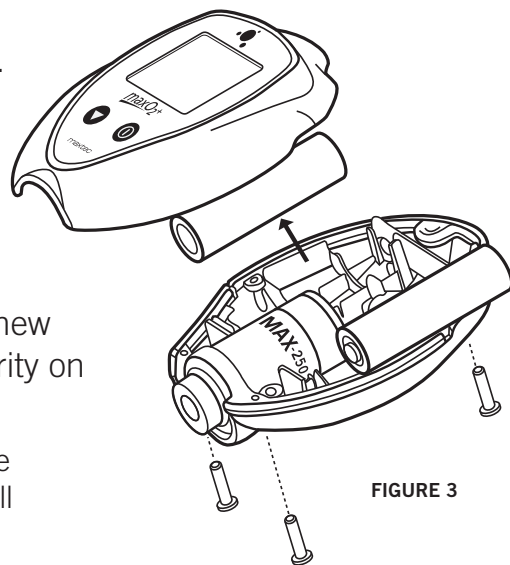

FIGURE 3

## ✶ 6.0 CHANGING THE OXYGEN SENSOR

### 6.1 MAXO<sub>2</sub>+AE Model

Should the oxygen sensor require changing, the device will indicate this by presenting “Cal Err lo” on the display.

Unthread the sensor from the cable by rotating the thumbscrew connector counterclockwise and pull the sensor from the connection.

Replace the new sensor by inserting the electrical plug from the coiled cord into the receptacle on the oxygen sensor. Rotate the thumbscrew clockwise until snug. The device will automatically perform a calibration and begin displaying % of oxygen.

## ✶ 7.0 CLEANING AND MAINTENANCE

Store the MAXO<sub>2</sub>+ analyzer in a temperature similar to its ambient environment of daily use.

The instruction given below describes the methods to clean and disinfect the instrument, sensor and its accessories (e.g. flow diverter, tee adapter):

### Instrument Cleaning:

- » When cleaning or disinfecting the exterior of the MAXO<sub>2</sub>+ analyzer, take appropriate care to prevent any solution from entering the instrument.
- ❌ **DO NOT** immerse unit in fluids.
- » The MAXO<sub>2</sub>+ analyzer surface may be cleaned using a mild detergent and a moist cloth.
- » The MAXO<sub>2</sub>+ analyzer is not intended for steam, ethylene oxide or radiation sterilization.

### Oxygen Sensor:

 **WARNING:** Never install the sensor in a location that will expose the sensor to patient's exhaled breath or secretions, unless you intend to dispose of the sensor, flow diverter and tee adapter after use.

- » Clean the sensor with a cloth moistened with isopropyl alcohol (65% alcohol/water solution).
- » Maxtec does not recommend use of spray disinfectants because they can contain salts, which can accumulate in the sensor membrane and impair readings.
- » The oxygen sensor is not intended for steam, ethylene oxide or radiation sterilization.

### Accessories

- » The flow diverter and tee adapter may be disinfected by washing them with isopropyl alcohol. The parts must be thoroughly dry before they are used.

## ✶ 8.0 SPECIFICATIONS

### 8.1 Base Unit Specifications

Measurement Range: . . . . . 0-100%  
Resolution: . . . . . 0.1%  
Accuracy and Linearity: . . . . . 1% of full scale at constant temperature, R.H. and pressure when calibrated at full scale  
Total Accuracy: . . . . . ±3% actual oxygen level over full operating temp range  
Response Time: . . . . . 90% of final value in approximately 15 seconds at 23°C  
Warm-up Time: . . . . . None required  
Operating Temperature: . . . . . 15°C - 40°C (59°F - 104°F)  
Storage Temperature: . . . . . -15°C - 50°C (5°F - 122°F)  
Atmospheric Pressure: . . . . . 800-1013 mBars  
Humidity: . . . . . 0-95% (non-condensing)  
Power Requirements: . . . . . 2, AA Alkaline batteries (2 x 1.5 Volts)  
Battery Life: . . . . . approximately 5000 hours with continuous use  
Low Battery Indication: . . . . . "BAT" icon displayed on LCD  
Sensor Type: . . . . . Maxtec MAX-250 series galvanic fuel cell  
Expected Sensor Life: . . . . . > 1,500,000 O<sub>2</sub> percent hours minimum  
(2-year in typical medical applications)  
Dimensions:  
A Model Dimensions: . . . . . 3.0"(W) x 4.0"(H) x 1.5"(D) [76mm x 102mm x 38mm]  
A Weight: . . . . . 0.4 lbs. (170g)  
AE Model Dimensions: . . . . . 3.0"(W) x 36.0"(H) x 1.5"(D) [76mm x 914mm x 38mm]  
Height includes external cable length (retracted)  
AE Weight: . . . . . 0.6 lbs. (285g)  
Drift of Measurement: . . . . . < +/-1% of full scale at constant temperature, pressure and humidity

### 8.2 Sensor Specifications

Type: . . . . . Galvanic fuel sensor (0-100%)  
Life: . . . . . 2-years in typical applications

## ✶ 9.0 MAXO<sub>2</sub>+ SPARE PARTS AND ACCESSORIES

### 9.1 Included With Your Unit

Part Number	Item
R217M72	User's Guide and Operating Instructions
RP76P06	Lanyard
R110P10-001	Flow Diverter
RP16P02	Blue Tee Adapter
R217P35	Dovetail Bracket



## 9.2 Standard Replacement Parts and Accessories

Part Number	Item
R125P03-004	MAX-250E Oxygen Sensor
R217P08	Gasket
RP06P25	#4-40 Pan Head Stainless Steel Screw
R217P16-001	Front Assembly (Includes Board & LCD)
R217P11-002	Back Assembly
R217P09-001	Overlay

## 9.3 Optional Accessories

### 9.3.1 Optional Adapters

<u>Part Number</u>	<u>Item</u>
RP16P02	Blue Tee Adapter
R103P90	Perfusion Tee Adapter
RP16P12	Long-Neck Tee Adapter
RP16P05	Pediatric Tee Adapter
RP16P10	MAX-Quick Connect
R207P17	Threaded Adapter with Tygon Tubing

### 9.3.2 Mounting Options (requires dovetail R217P23)

<u>Part Number</u>	<u>Item</u>
R206P75	Pole Clamp
R205P86	Wall Mount
R213P31	Swivel Mount
R100P10	Rail Mount

### 9.3.3 Carrying Options

<u>Part Number</u>	<u>Item</u>
R217P22	Belt Clip and Pin
R213P02	Zipper Carrying Case with Shoulder Strap
R213P56	Deluxe Carrying Case, Water Tight
R217P32	Soft Case, Tight Fit Carrying Case

**NOTE:** Repair of this equipment must be preformed by a qualified service technician experienced in repair of portable hand held medical equipment.

Equipment in need of repair shall be sent to:

Maxtec  
Customer Service Department  
2305 South 1070 West  
Salt Lake City, Ut 84119  
(Include RMA number issued by Customer Service)



