

Instruction Manual

Waterall LED Fountain



Warranty

Limited 1-Year Manufacturer Warranty

Manufacturer warranty covers:

- Parts that are deemed defective within 30 day will be shipped free of charge.
- Any warranty claim after 30 days, will require shipping to be paid by the customer.

Any visible damage due to the neglect, misuse, or abuse will void the limited warranty of the product.

What is included

Assembly instructions



A. Fountain Top



B. Fountain Base



C. Hose



D. LED



E. Auto Shut Off Pump

*Shuts off at 185°F



F. LED Cap



Connect hose to the LED



Connect LED to the fountain top



Connect the LED to short connection from pump



Connect hose to the pump

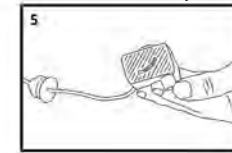

Flow adjustable by pump



Make sure longest connection is placed down hole, followed by rubber plug to keep the fountain from leaking.



Connect end of pump connection to adapter



Make sure the pump is fully submerged in water.

Option to Shut-Off LED

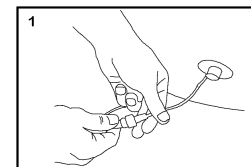

Disconnect the LED connection from the pump connection

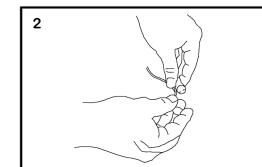

Make sure to put the LED cap to the pump connection

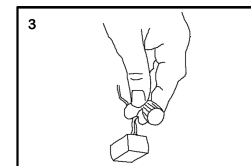

The cap should be twisted tightly to ensure it cannot get wet

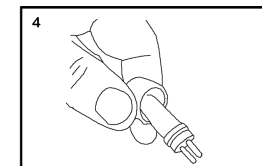

You can leave the prongs of the LED connection in the water