

# PENAOVER S0511 POWER BANK Instruction Manual

## 1. Component description

- ①. Mobile phone magnetic wireless charging
- ②. Watch magnetic wireless charging
- ③. Fast charge lamp
- ④. Wireless charging fast charging lamp
- ⑤. Battery Indicator light
- ⑥. Magnetic stand
- ⑦. Lanyard thread hole
- ⑧. Power on/off
- ⑨. Type-C In/output
- ⑩. Lightning Input

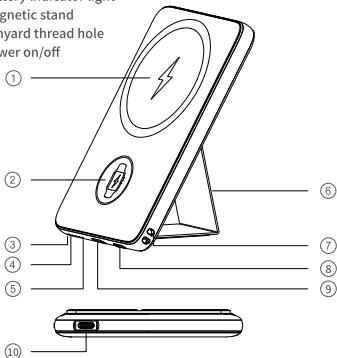

## 2. input charging

### Type-C/Lightning Input charge

Use the built-in Type-C charging cable or Lightning charging cable to connect to the input interface, and then start charging the mobile power supply. During the charging process, the corresponding power indicator flashes to charge the device. Four power indicators are steady on, charging is complete.

### Power bank discharge

Take out the mobile phone, iPad, Bluetooth headset and other electronic devices, and charge with the mobile power supply, the corresponding power indicator is steady on, which is normal discharge; The first power flash discharge (under voltage) indicates that the mobile power is about to run out of power.

### Power button description

Click the power button to display the current power, and double-click the button to turn off the power indication.

### Mobile phone wireless charging instructions

If the mobile phone supports wireless charging function, the mobile phone can be charged directly on the mobile phone wireless charging position (start voltage: 5.0±0.25V, wireless output power: 5W/7.5W/10W/15W Max)

### Watch wireless charge description

If the watch supports wireless charging function, the watch can be charged directly on the wireless charging position of the mobile power supply watch (startup voltage: 5.0±0.25V, wireless output power: 2.5W)

## 3. Battery light

The mobile power supply is equipped with a power display LED, which is convenient for you to control the remaining power of the mobile power supply and other functions. If the four lights are steady on, the power supply is sufficient. If the first light blinks or the power display light is not bright, the mobile power supply needs to be charged.

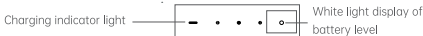

The battery level is displayed as four white lights. The fast charging lamp is green, the wireless charging lamp is blue, the wireless fast charging lamp is blue, and the green is on. Watch wireless charge white light steady on.

## 4. Specification parameters

Brand	PENAOVER
Name	Power Bank
Model number	S0511
Cell	Polymer cell
Battery capacity	5000mAh(19.25WhV3.85V)
Maximum output power	PD20W
Type-C Input	5V⚡3A, 9V⚡2.2A (±0.1)
Type-C Output	5V⚡3A, 9V⚡2.2A, 12V⚡1.66A (±0.1)
Lightning Input	5V⚡3A
Input interface	Type-C / Lightning
Output interface	Type-C
Wireless Charging Power	5W/7.5W/10W/15W
Watch Wireless Charging Power	2.5W
Material	ABS+PC
Product size	103.8*67.5*15.5mm
Weight	141g
Execution standard	GB/T 35590-2017

## 5. Power protection

### Short circuit protection

If the power output is short circuited, the power supply shall be able to protect automatically, and the power supply shall be able to resume operation after troubleshooting.

### Overvoltage protection

The mobile power supply has overcharge and discharge protection. The product output is provided with overvoltage protection, and the output voltage shall not exceed 5.6V. The input voltage range is 4.8V-5.6V, and the input has OVP and undervoltage protection functions.

### Overcharge protection

Use DC 5V/2A constant current and constant voltage source to connect the mobile power input terminal, charge to 100% power. After (saturation state), continue to load the mobile power supply for 8 hours, and the mobile power supply should not explode, fire, smoke or leak.

### Over discharge protection

The output terminal of mobile power supply shall be connected to 30 Ω load for 24 hours, and the mobile power supply shall not explode, fire or smoke or leakage. After troubleshooting, the power supply shall be able to resume operation.

## 6. Common problems and precautions

Common problem	Possible causes
What if the power supply can't be charged?	1. Confirm whether the indicator screen is on 2. Confirm whether the data cable and plug are in contact OK, replace it again and try again 3. Confirm the remaining power and use up the remaining power Recharging
The power bank supply is not fully charged	It is necessary to activate the cell for the first use, and use it for 2-3 times. See if it can be filled

## Matters needing attention

### iPhone Charging Instructions

The iPhone may heat up a bit while charging. To extend battery life, if the battery overheats, the software may limit charging when it reaches 80%. When the temperature drops, the iPhone charges again. Try moving your iPhone and power bank to a cooler location.

### Warn

Failure to follow safety instructions may result in fire, electric shock, ring damage or other injuries. High-quality power banks are used Lithium polymer battery, please use it with confidence.

Do not disassemble or pierce the power bank by yourself; do not expose the power bank to fire/high temperature or water; it is recommended to use a regular brand power adapter to charge it.

If you find that the mobile power supply is bulging or other bad phenomena or the charged devices bulging, please stop using the power supply.

This product is only suitable for safe use in areas with an altitude of 2000m and below, and is only suitable for safe use in non-tropical climate conditions.

CAUTION: Replacing a battery with the wrong type can result in an explosion hazard. Be sure to dispose of the used battery according to the instructions.

### Suggestions for scrapping power supply:

The power supply contains dangerous and useless materials, which need to be recycled/destroyed by qualified institutions. Contact your local office to ensure that the power supply is properly scrapped in accordance with the approved regulations.

## Packing list:

Power Bank×1    Manual×1    Blistering×1    Type-C to Type-C Charging Cable×1  
Lanyard box×1    SIM card ejector×1    Type-C to Lightning Charging Cable×1

## DIY decorative lanyard charging cable:

1. Remove the cable from the female end and thread the cable through the lanyard hole.

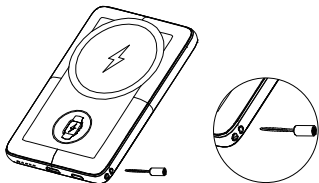

2. After threading the lanyard hole of the device, pick out the cable end with the included card needle. And put into nut head.

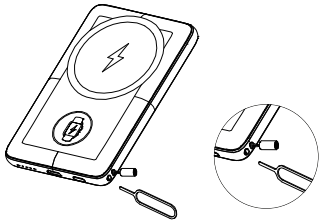

3. Take out the male end of the lashing cable, align it with the female end of the nut, and tighten it counterclockwise.

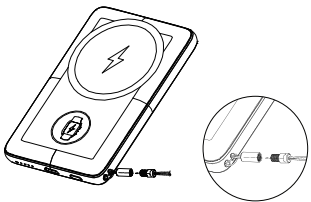

4. If you need to remove the decorative lanyard cable, unscrew the female screw cap and take out the decorative cable.

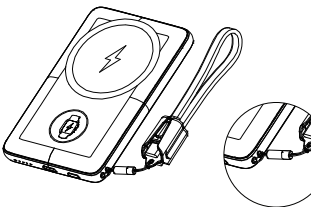

## FCC Statement

This device complies with Part 15 of the FCC Rules. Operation is subject to the following two conditions:  
(1) This device may not cause harmful interference.  
(2) This device must accept any interference received, including interference that may cause undesired operation.

2. Changes or modifications not expressly approved by the party responsible for compliance could void the user's authority to operate the equipment.

Note: This equipment has been tested and found to comply with the limits for a class B digital device, pursuant to Part 15 of the FCC Rules. These limits are designed to provide reasonable protection against harmful interference in a residential installation.

This equipment generates uses and can radiate radio frequency energy and, if not installed and used in accordance with the instructions, may cause harmful interference to radio communications. However, there is no guarantee that interference will not occur in a particular installation. If this equipment does cause harmful interference to radio or television reception, which can be determined by turning the equipment off and on, the user is encouraged to try to correct the interference by one or more of the following measures:

- Reorient or relocate the receiving antenna.
- Increase the separation between the equipment and receiver.
- Connect the equipment into an outlet on a circuit different from that to which the receiver is connected.
- Consult the dealer or an experienced radio/TV technician for help.

The device has been evaluated to meet general RF exposure requirement.

The device can be used in portable exposure condition without restriction.