

VGR[®]

V O Y A G E R

V-085 | PROFESSIONAL
HAIR TRIMMER

Manual Safety Instruction HAIR TRIMMER



V G R S U P E R T R I M[®]

Manual

Safety Instruction

V-085

ENGLISH -----	01
FRANÇAIS -----	06
ITALIANO -----	12
ESPAÑOL -----	17
PORTUGUÊS -----	22
DEUTSCH -----	28

GB ENGLISH

COMPONENTS OF HAIR TRIMMER

1. Precision blade
2. ON/OFF button
3. Protection cap
4. Cutting guide(1/2/3mm)
5. Cleaning brush
6. Oil
7. USB charging cable

SAFETY WARNINGS

This appliance may be used by children of more than 8 years of age, persons with physical, sensory or mental capabilities or inexperienced persons only if they have been previously trained in using it in a safe manner, and only if they have been informed of the dangers the product can cause.

Children may not play with the appliance. Children may not clean or carry out any maintenance on the appliance without adult supervision.

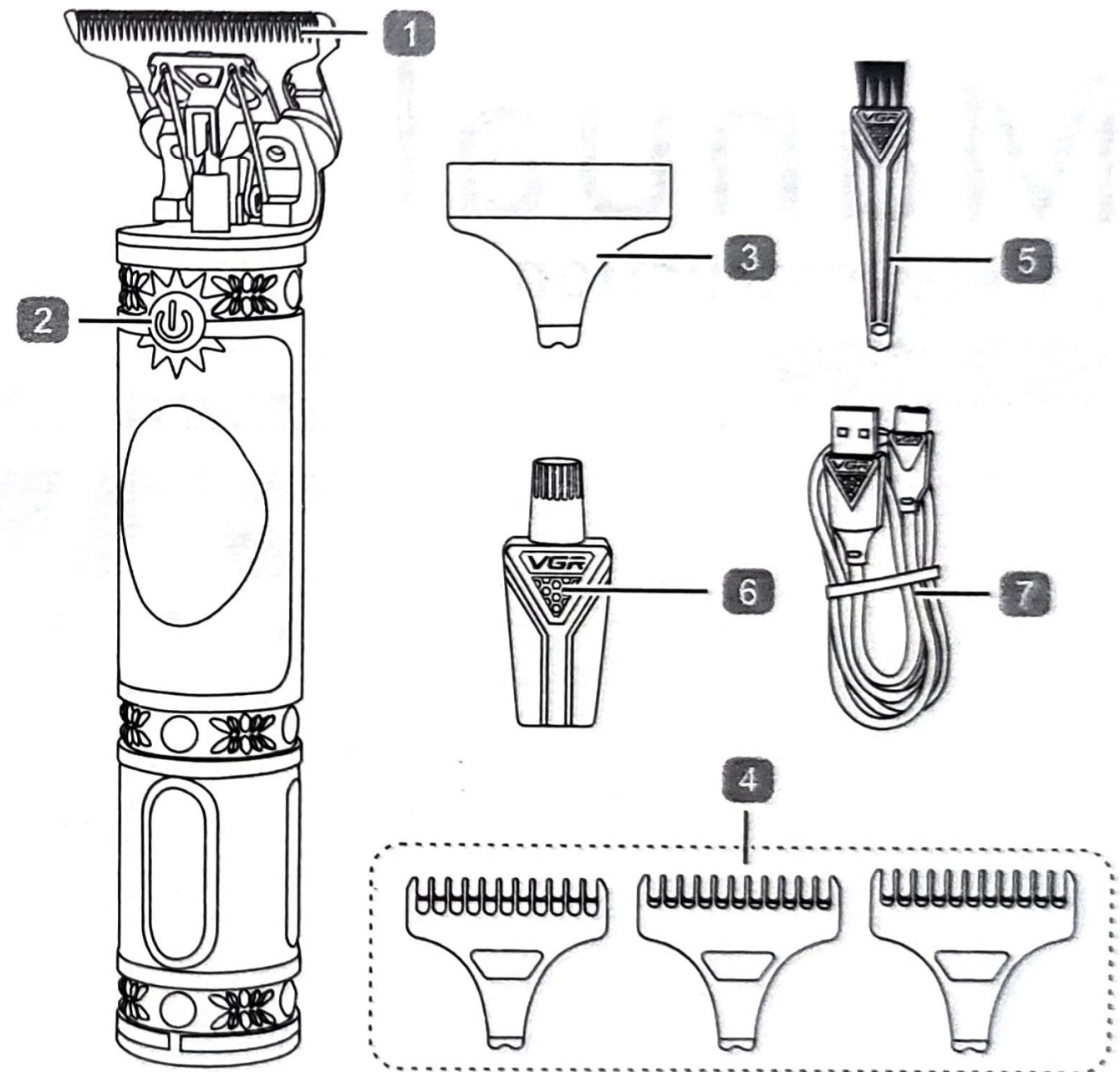

GENERAL SAFETY INSTRUCTIONS

It is advisable to save these instructions for a future use.

Always check the appliance before you use it. Do not use the appliance if it is damaged, as this may cause injury. Always replace a damaged part with one of the original type.

Do not open the appliance to replace the rechargeable battery.

This appliance is not washable. Never immerse the appliance in water and do not rinse it under the tap.

Never use compressed air, scouring pads, abrasive cleaning agents or aggressive liquids, such as petrol or acetone to clean the appliance.

IMPORTANT: This trimmer has a built-in rechargeable battery. Do not throw into fire, apply heat, or charge, use, or leave in a high temperature environment. The appliance should not be used on animals.

Note: This product is for cord and cordless use.

OIL BOTTLE

Keep out of reach of children. Do not swallow. Do not apply to eyes. Dispose of properly when empty.

CUTTING GUIDES

By use of the 3 cutting guides provided, you can adjust the length of the trim up to a maximum of 3 mm (with the guide comb inserted).

The cutting lengths are as follows: With guide combs: 1,2,3mm. The length of the cut is shown on the guide comb.

IMPORTANT: The device must always be turned off when inserting or removing a cutting guide.

Align the limit comb with the blade edge.
slightly forward push to mount it .disassemble the limit comb:
just pull hard the limit comb.

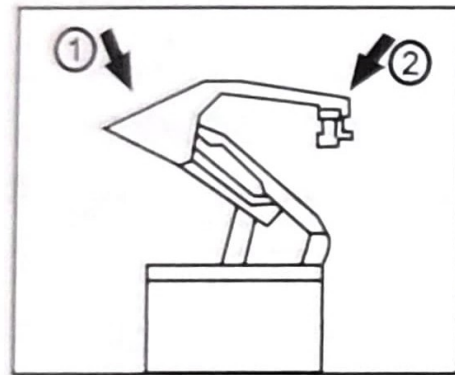

USB CHARGING

The hair trimmer is completely handy to carry and can be charged anywhere with the USB cable.

Comes with built-in battery, a full charging time 2.5 hours to offer around 300 minutes of running time USB cord Charge the device by connecting with the power bank or adapters(5V,1A), or computer.

The USB charging plug ensures that you can find the charging source conveniently, whether at home or on the travel.

Indicator light shows red when in charging.

CLEANING AND MAINTENANCE

Before starting cleaning the appliance, always switch it off and unplug it.

Clean the unit with a damp and soft cloth.

Never use detergents and solvents to clean the appliance.

After having used the appliance using the cleaning brush to clean the body of the device, In order to remove any hair from the cutting blade.

In order to grant a long and good performance to the appliance, it is advisable to clean and oil often the appliance.

Remove hair from the cutting blade using the cleaning brush, put 2 or 3 oil drops and allow the machine to run for several seconds so that the unit can lubricate properly.

Fit the protective cap after use; keep the device only with the fitted protective cap.

Noted: The cutting blade is fixed by screws.

TECHNICAL FEATURES

- ON/OFF button
- Complete charging time: 2.5 hours
- 300 minutes of continuous operation
- Power supply: 5V $\overline{\text{---}}$ 1A
- Battery: 1500mAh lithium battery

SYMBOL



This item is made in conformity with CE



DISPOSAL

The device (including its removable parts and accessories) must not be disposed of together with municipal waste at the end of its life, but in compliance with European Directive 2012/19/EC. Since it must be handled separately from household waste, either carry it to a separately-collected waste disposal centre for electrical and electronic appliances or give it back to the retailer on purchasing anew device with the same purpose. Any infringement will be severely prosecuted.

The built-in rechargeable battery contains substances that may pollute the environment. Always remove the battery before you discard and hand in the appliance at an official collection point. Dispose of the battery at an official collection point for batteries.

First unplug the product and let the motor run until the battery is completely empty.

Remove both side panels from the appliance with a screwdriver.

Lift the power unit out of the appliance.

Specifications and designs are based on the latest information available at the time of printing and subject to change without notice.