

Installation Tips



IMPORTANT

Refer to the 「step 1」 to learn the door is right handed or left handed.

Before tighten the interior assembly screws, test if it's able to move the thumb turn to lock/unlock. If not, please go back to 「step 2」 and reinstall.

If the direction of the slide switch is set incorrectly, it also can be changed in the DDLock App. (Settings > Door opening direction)

STEP1

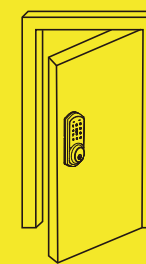

Door hinge
on the right

Right handed door



Door hinge
on the left

Left handed door

STEP2

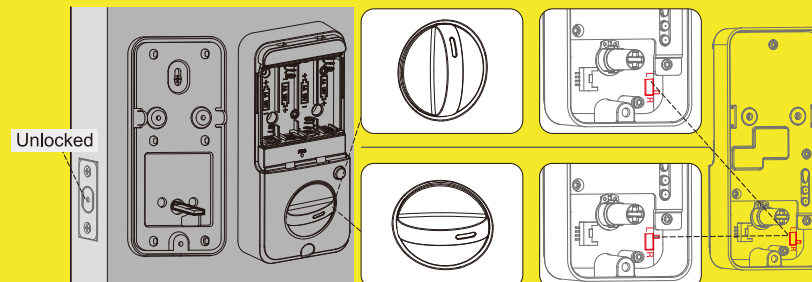

Right handed door

Move the slide switch to "R"
Turn the thumb turn to the Vertical position

Left handed door

Move the slide switch to "L"
Turn the thumb turn to the Horizontal position.