

YOGIN

**1.8L
ULTRASONIC
HUMIDIFIER**

HU18-02A
User Manual

CONTENTS

SAFETY INSTRUCTIONS 03

KNOWING YOUR HUMIDIFIER 05

USING YOUR HUMIDIFIER 11

CLEANING AND MAINTENANCE 13

TROUBLESHOOTING 15

01

SAFETY INSTRUCTIONS

Soothing Mist for
Sweet Dreams



DANGER

BEFORE USING THIS APPLIANCE READ ALL INSTRUCTIONS AND CAUTIONARY MARKINGS IN YOUR USER MANUAL AND ON THE APPLIANCE

**READ AND
SAVE THESE
INSTRUCTIONS**



DO NOT touch or hold the mains plug with wet hands.



DO NOT block or cover the nozzle while in operation.



DO NOT let children or pets play with this appliance.



Clean the water tank every three days.

INTENDED USE

- This appliance is not intended for use by people who have reduced physical, sensory or mental capabilities or lack knowledge to use this appliance unless they are given supervision or instruction by a responsible person.
- Use this appliance only for intended household purposes as described in this User Manual.

ELECTRICITY SAFETY

- To avoid fire hazard, NEVER put the cord under rugs, near heat registers, radiator, stoves or heaters.
- DO NOT use this appliance if the cord has been damaged to avoid fire or electric hazard.
- Keep the cord out of heavy traffic areas and where it will not be tripped over.
- Unplug the appliance during filling and cleaning.

RELATED TO USE

- Always place this appliance on a firm, flat and level surface to avoid dropping or tilt.
- Always place this appliance 2 feet (60 cm) above the floor, 12 inches (30 cm) away from the wall or wooden furniture.
- Be aware that high humidity levels may encourage the growth of biological organisms in the environment.
- DO NOT permit the area around the humidifier to become damp or wet. If dampness occurs, turn the output of the humidifier down. If the humidifier output volume cannot be turned down, use the humidifier intermittently. Do not allow absorbent materials, such as carpeting, curtains, drapes, or tablecloths, to become damp.
- DO NOT move this appliance while it is on.
- Never leave water in the reservoir when the appliance is not in use.
- DO NOT attempt to repair any parts on this appliance. Doing so will void your warranty. The inside of this appliance contains no user serviceable parts. All servicing should be performed by qualified personnel only.
- Empty and clean the humidifier before storage. Clean the humidifier before next use.
- Warning: Micro-organisms that may be present in the water or in the environment where the appliance is used or stored, can grow in the water reservoir and be blown in the air causing very serious health risks when the water is not renewed and the tank is not cleaned properly every 3 days.
- Empty the tank and refill every third day. Before refilling, clean it with fresh tap water or cleaning agents if required by the manufacturer. Remove any scale, deposits, or film that has formed on the sides of the tank or on interior surfaces, and wipe all surfaces dry.

SPECIFICATIONS

Model	HU18-02A
Input Voltage	DC24V \equiv 1A
Rated Power	22W
Water Tank Volume	1.8L
Mist Output	180 \pm 40ml/h
Working Time on a Full Tank	\geq 9h
Materials	PP
Product Size	245 \times 120 \times 169mm

02

KNOWING YOUR HUMIDIFIER

Soothing Mist for
Sweet Dreams

Packing List

- 1 x Humidifier
- 1 x Adapter
- 1 x Essential Oil Bottle
- 1 x User Manual

Product Diagram

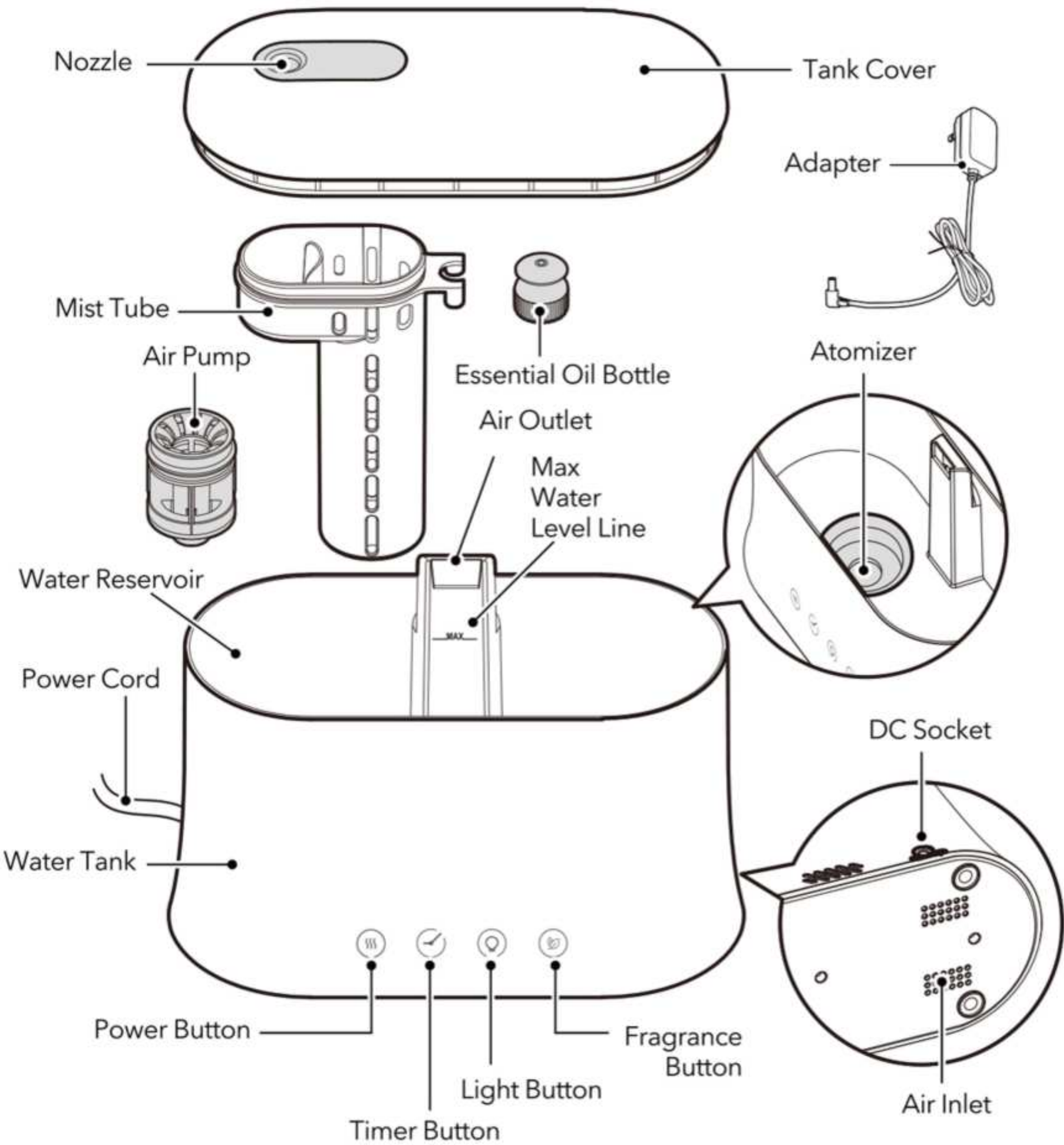

03

USING YOUR HUMIDIFIER

Soothing Mist for
Sweet Dreams

Control Panel



Power Button

- Tap repeatedly to select low(sleep mode)/medium/high mist levels.
- Long Press for 2s: Power Off.



Timer Button

- Tap repeatedly to cycle through 2h-4h-8h-Cancel Timer Setting.



Light Button

- Cycle gradient mode/Choose a single color.
- Long Press for 2s: The lights are turned off.



Fragrance Button

- Turn on the aroma diffuser mode with indicator light on.
- Turn off the aroma diffuser mode, the built-in cooling fan will stop working after 15s.

Getting Started



- DO NOT let water enter mist tube to avoid damaging this appliance.
- Twisting the nozzle can adjust the direction of mist.

1.

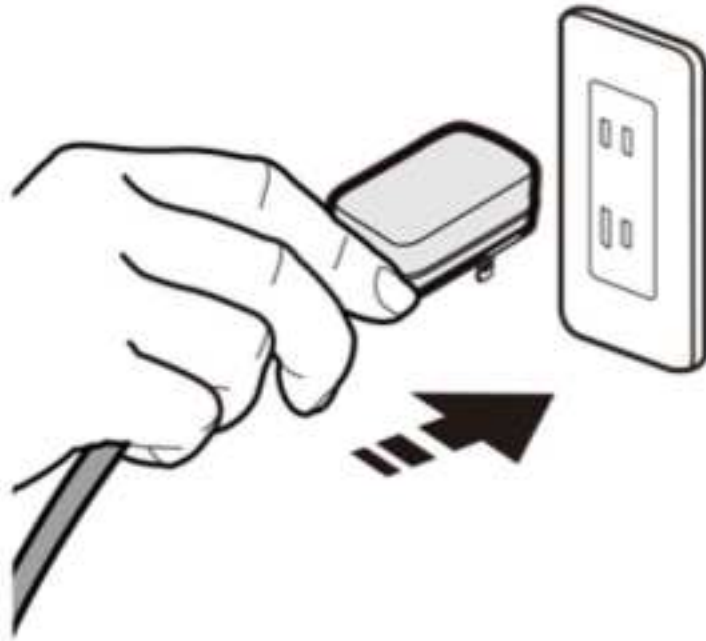

Connect this humidifier to a power source, it will enter standby mode.

2.

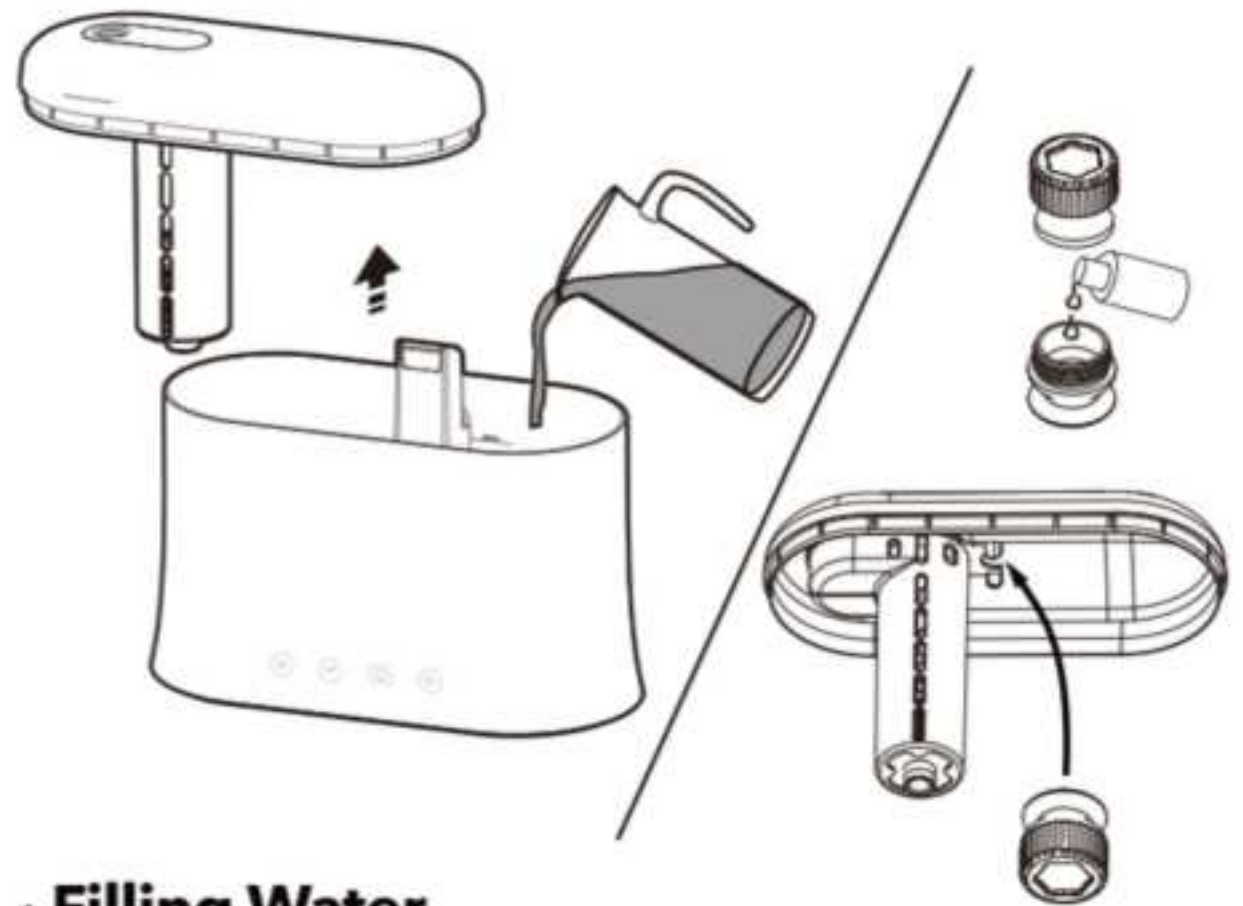

• Filling Water

Remove the cover, and fill in water no higher than the max water level line.

• Adding Essential Oil

Add 2ml essential oil into the bottle.

Install the bottle into the slot.

You can also add essential oil directly to the water tank.

Additional Functions



Low Water Protection

The humidifier will auto shut down because of insufficient water. After refilling, it will restart working.

GETTING THE MOST FROM HUMIDIFIER

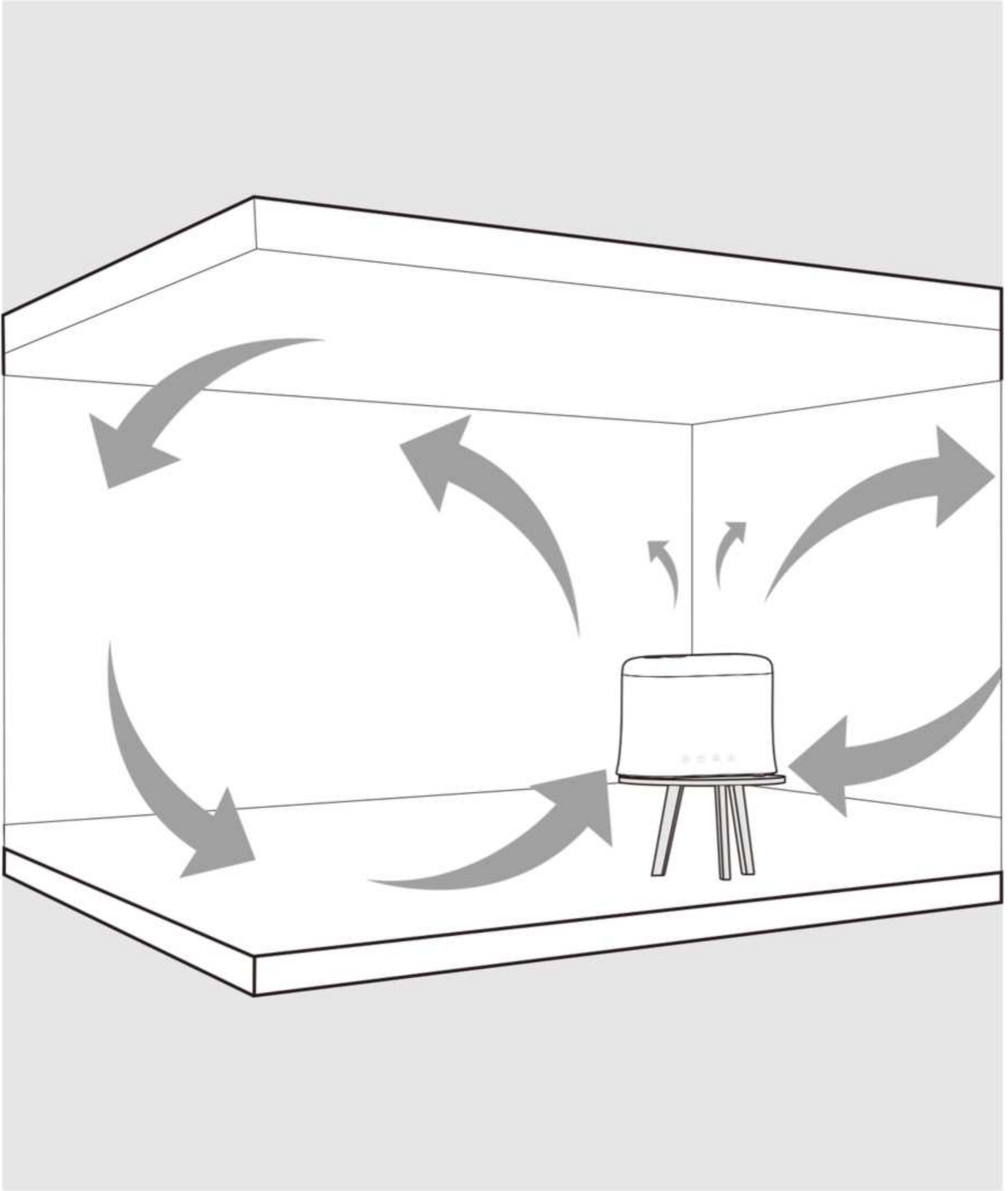

Tips: Closing doors and windows is conducive to reaching the desired humidity.

04

CLEANING AND MAINTENANCE

Soothing Mist for
Sweet Dreams



- Before cleaning, turn this humidifier off and unplug it.
- Do not let water splash into the air outlet.



- Remove the water tank and its cover to rinse under tap water.
- Fill some white vinegar or lemon water in the reservoir and let it sit for about 15 minutes, then descale with a cleaning brush.



- Wipe dry with a clean, soft cloth or paper towel.
- Store it in a cool, dry location when not in use for long.

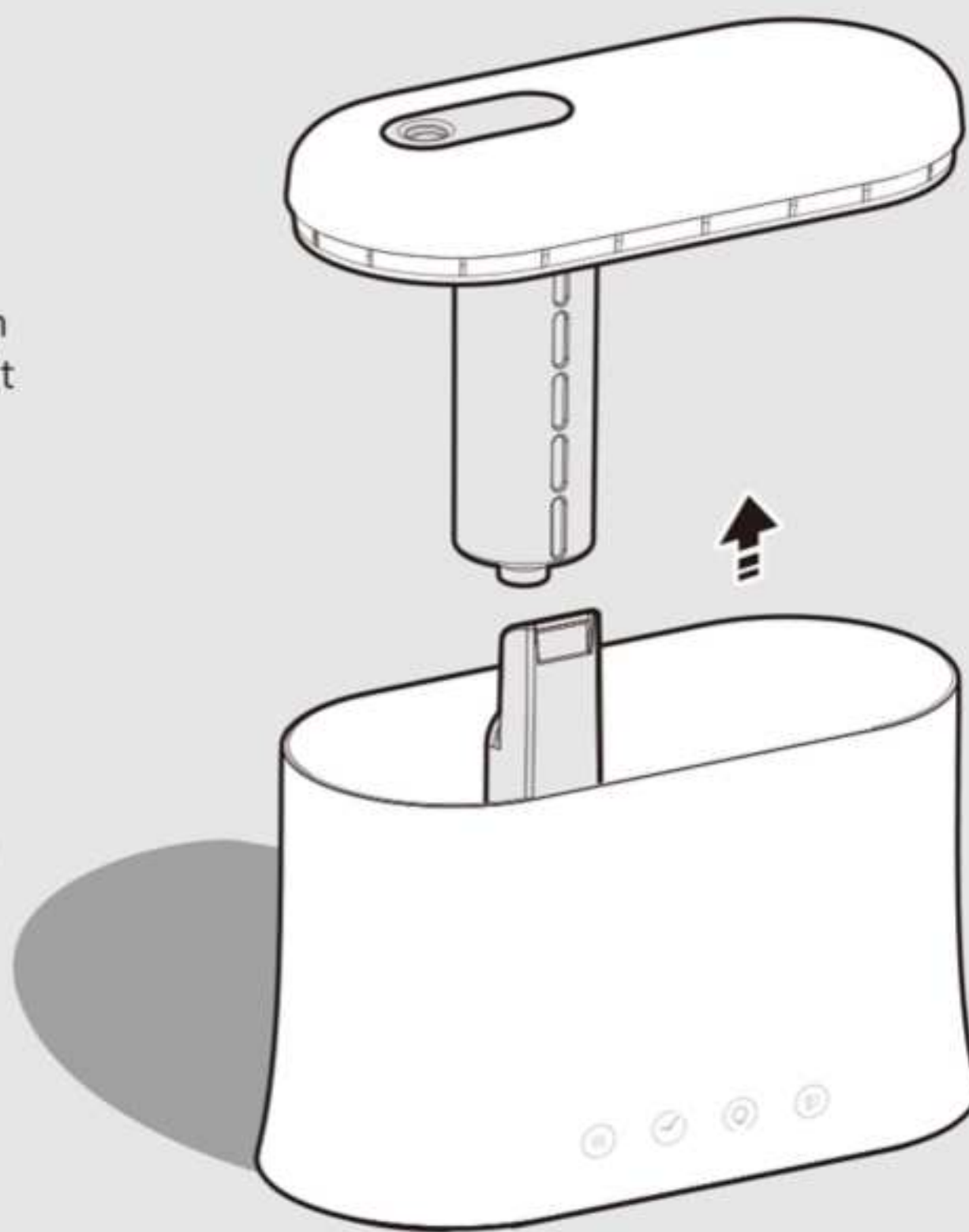

05

TROUBLE- SHOOTING

Soothing Mist for
Sweet Dreams

The humidifier does not work.

There is no air humidification.

There are some white deposits in the water tank.

The mist produces an unpleasant smell.

· This appliance will auto shut down if water is insufficient.

· Air inlet/outlet is blocked.
· Your room might have too much ventilation. Close doors and windows.

· They are scale. You need to descale this appliance regularly. Using purified or distilled water can help prevent the formation of scale.

· Change water regularly to avoid hard water deposits.
· Clean this appliance, and leave it at a shady and cool place for 12 hours with the cover detached.

The troubleshooting guide addresses the most common problems. If problems persist, feel free to contact the Customer Support at support@parisrhone.co.

FCC Compliance

This instrument complies with Part 18 of the FCC Rules. Operation is subject to the following two conditions:

- (1) this device may not cause harmful interference, and
- (2) this device must accept any interference received, including interference that may cause undesired operation.



WEEE Compliance

Correct Disposal of This Product (Waste Electrical & Electronic Equipment)
(Applicable in countries with separate collection systems)

This marking on the product, accessories or literature indicates that the product and its electronic accessories should not be disposed of with other household waste at the end of their working life. To prevent possible harm to the environment or human health from uncontrolled waste disposal, please separate these items from other types of waste and recycle them responsibly to promote the sustainable reuse of material resources. Household users should contact either the retailer where they purchased this product, or their local government office, for details of where and how they can take these items for environmentally safe recycling. Business users should contact their supplier and check the terms and conditions of the purchase contract. This product and its electronic accessories should not be mixed with other commercial wastes for disposal.

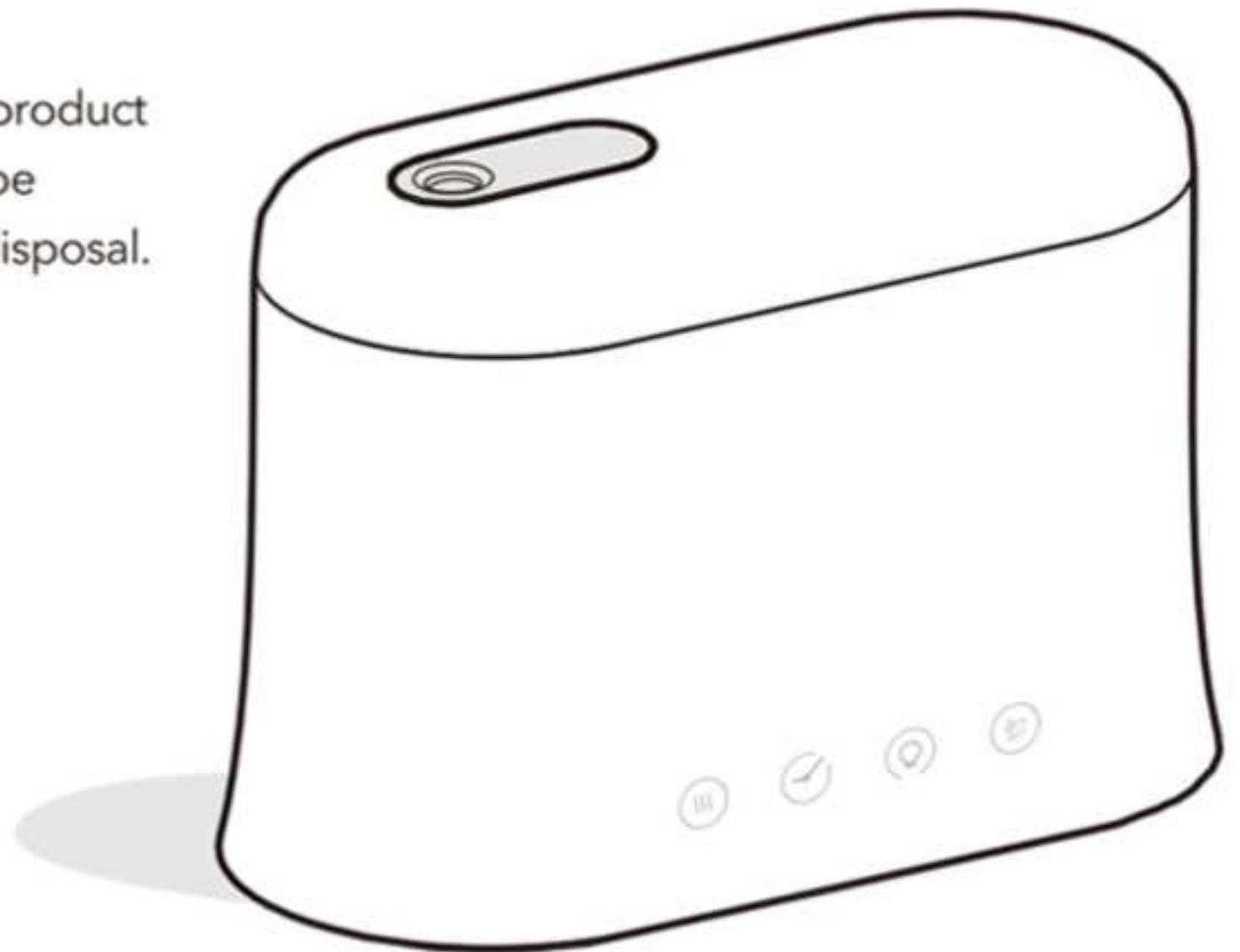



Manufacturer: GUANGDONG KEGAO ELECTRONICS CO., LTD
Address: No.39 East Science & Technology Ave, Zone A
Shishan Science & Technology Industrial Park, Nanhai
District, Foshan Guangdong Province



MADE IN CHINA

YOGIN