

INSTALLATION INSTRUCTION

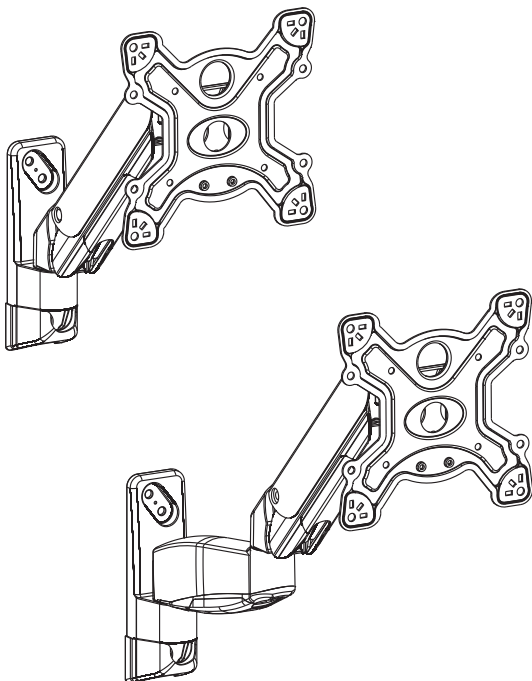

F400、F500

Flexi Full Motion Wall Mount

Fits most TV size: 42"~55"

Max Load: 20~55 lbs (9.0~25 kg)

VESA: 100x100~400x400mm



Flexi Full Motion Wall Mount

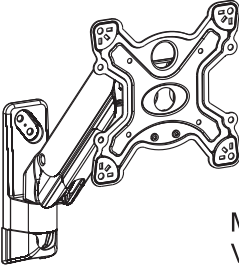

F400

Fits most TV size: 42"~55"
Max Load: 20~55 lbs (9~25kg)
VESA: 100x100~400 x 400mm

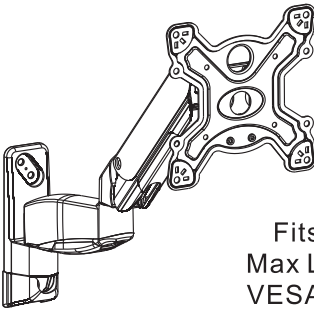

F500

Fits most TV size: 42"~55"
Max Load: 20~55 lbs (9~25kg)
VESA: 100x100~400 x 400mm

Severe personal injury and property damage can result from improper installation or assembly.

Read the following warning carefully before beginning.

- Products must be installed by professional or installer.
- If you do not understand the instructions or have any concerns or questions, please contact a qualified local installer.
- Do not install or assemble if the product or hardware is damaged or missing, if you require replacement parts, please contact your local distributor for assistance.
- This product fits most 42"-55" LCD / monitor; maximum weight of LCD / monitor: 25 kg / 55 lbs.
- Installer-friendly and straight forward.
- For safe installation, the wall you are mounting to must support minimum 3 times the weight of the total load (the mount, the monitor and all accessories weight).
- Do not use this product for other than the original designed.
- This product contains moving parts, please use with caution.
- When installing monitor, please do not damage electrical wiring or power source.
- Installation and routing of monitor cables on the monitor bracket must comply with electro-technical regulations.
- Importantly, mains- and data-cables must be secured against twisting and squeezing or shearing.
- The manufacturer will bear no responsibility to the wall / ceiling of mounting, or incidental or consequential damages arising thereof.
- The manufacturer disclaims any liability for the modifications, improper installation, or installation over the specified weight range. The manufacturer will not be liable for any damages arising out of the use of, or inability to use, the product.
- This product is designed for indoor use only, use of this product outdoor could lead to product failure and severe personal injury.
- ▲ This product contains a high pressure gas spring, fire and percussion prohibited. Also it is strictly prohibited to dismantle without professionals. Please return to the manufacturer or hand over to professional agencies if the product is abandoned. In order to ensure the performance of gas spring, full direction adjustment of the product arm is recommended several times per month.

www.nbavmount.com

We reserve the right to modify or alter instructions. No modification or alteration without formal notice

Symbols

	Tightening Direction		+ :Torque increased
	拧紧方向		定点恒力加大
	loosening Direction		- :Torque reduced
	拧松方向		定点恒力减小
	Phillips Screwdriver		By Hand
	螺丝起子		手工
	Open-End Wrench		Hex Wrench
	开口扳手		六角扳手
	Adjustment		Pencil
	调整		铅笔
OPT	Optional		Hand Drill
	可选		手电钻
	Remove		Star Wrench
	移开		安全扳手

Tools

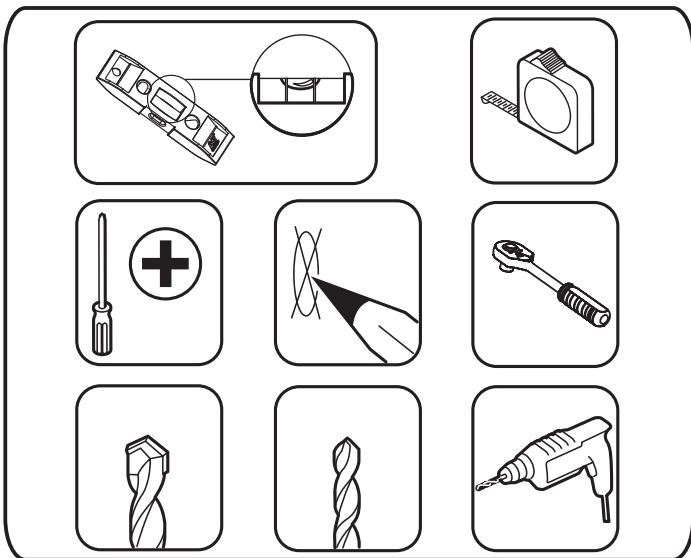





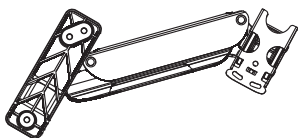

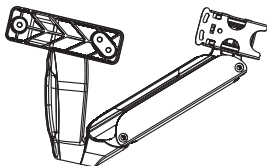
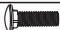
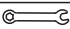

Part list

F400

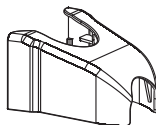

F500

A -  (M6x12)-4pcsF -  -1pcsA -  (M6) -4pcsG -  -1pcsB -  (M6x25)-4pcsH -  (M7x80)-3pcsC -  (M8x25)-4pcsH -  ($\Phi 16 \times \Phi 8.2 \times 1.5 \text{mm}$)-3pcsD -  ($\Phi 17 \times \Phi 8.2 \times 12 \text{mm}$)-4pcsI -  (UX10x60mm)-3pcsE -  ($\Phi 13.5 \times \Phi 6.2 \times 1.5 \text{mm}$)-2pcsJ -  (6mm) -1pcsE -  (M6x10)-2pcs

F400、F500 Installation Manual

Install flexi mount into masonry or solid concrete
or
Install flexi mount into wood stud.

A1、Install flexi mount into masonry or solid concrete

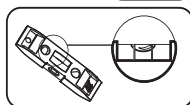
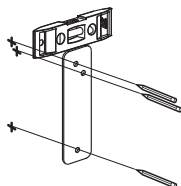
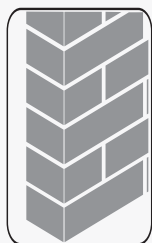
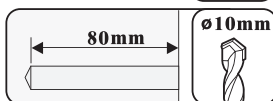
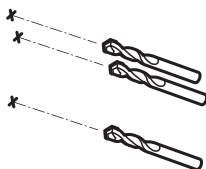
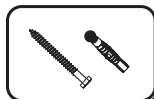
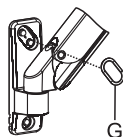
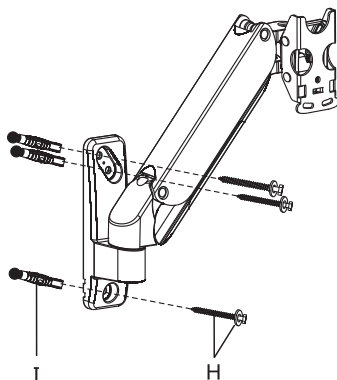
Step 1**Step 2****Step 3**

A2、Install flexi mount into wood stud

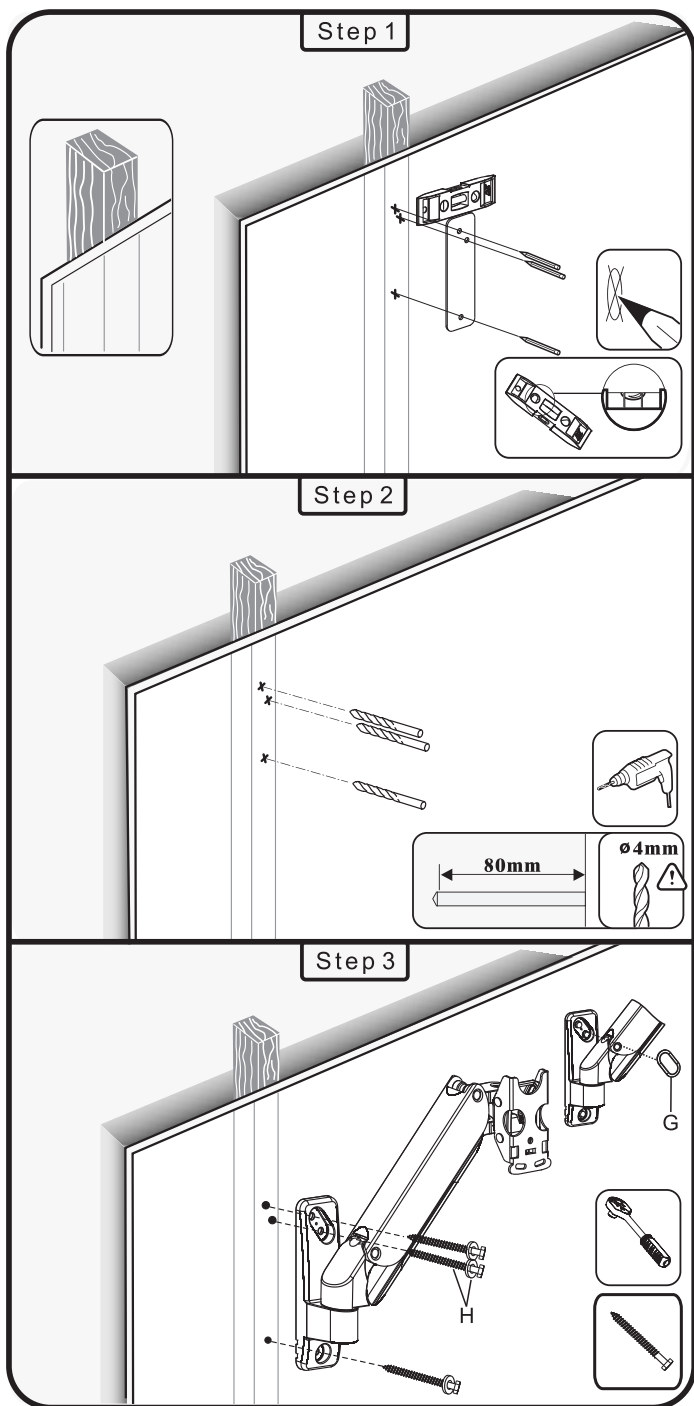

B、TV installation

VESA : 100x100, 200x100mm, 200x200mm

Step 1

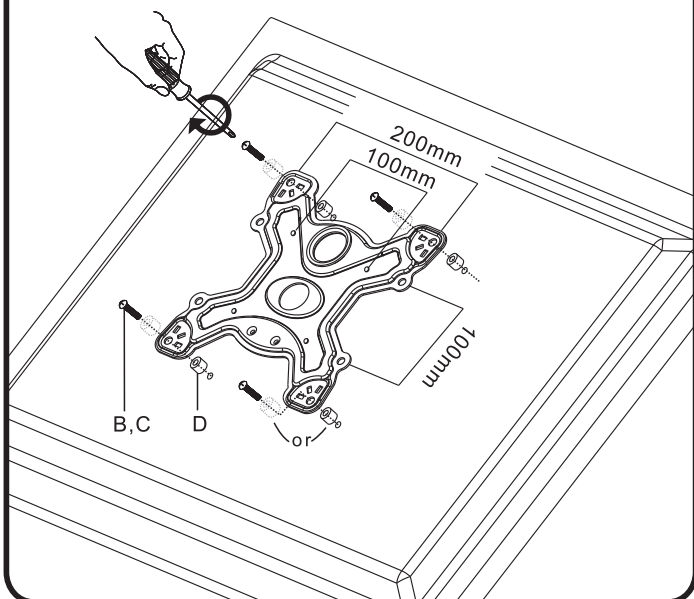

Step 2

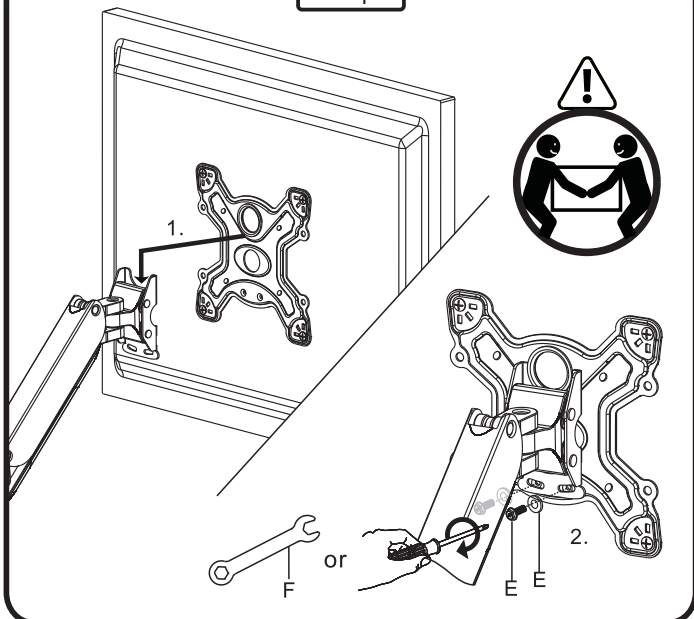

VESA : 300 × 200mm, 300 × 300mm, 400 × 200mm, 400 × 400mm

Step 1

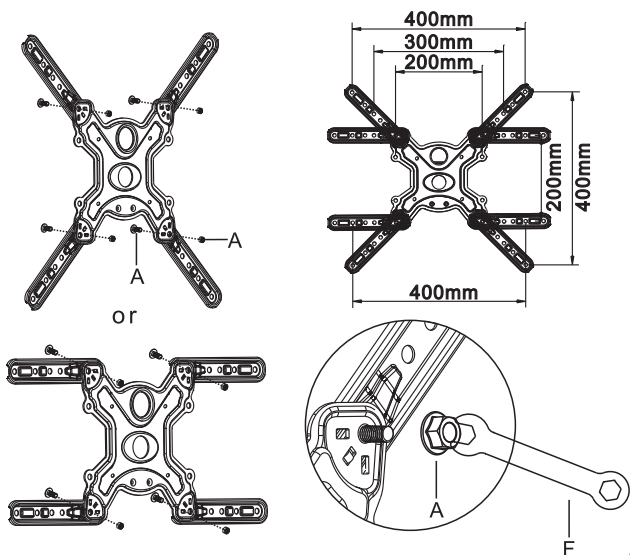

Step 2

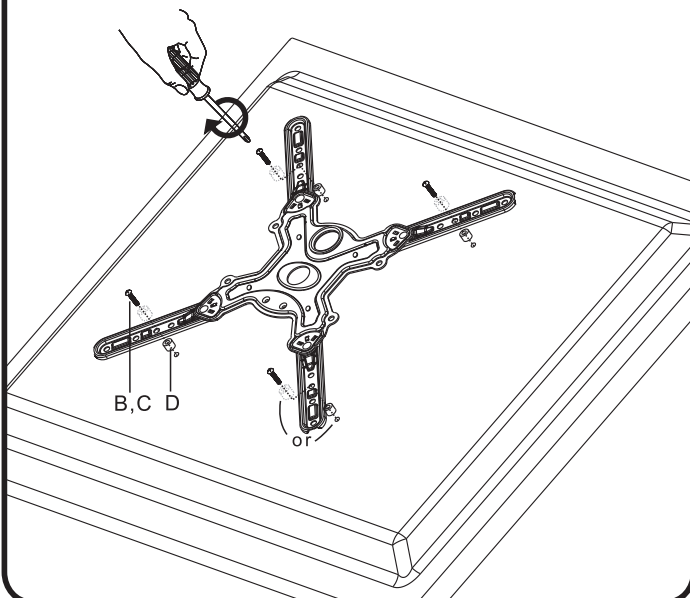

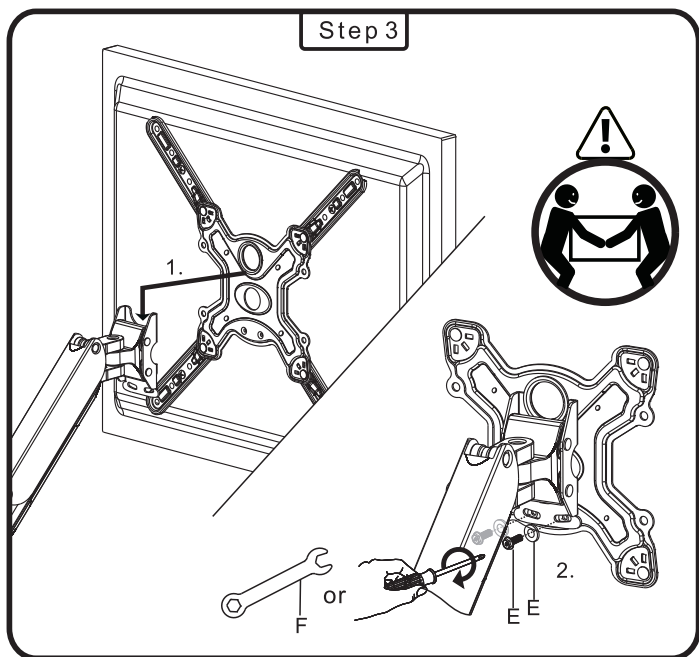

C、AV cables and wires routing

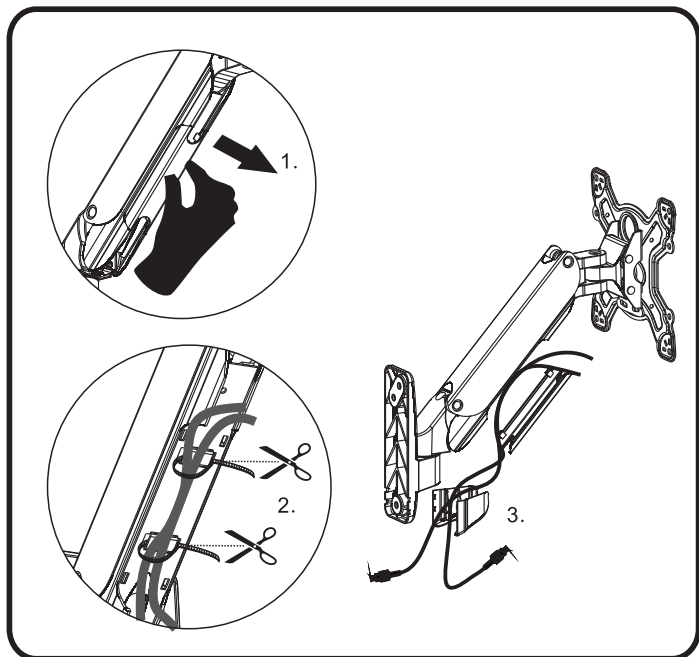

D、Setting static position

+ :Torque increased, - :Torque reduced.

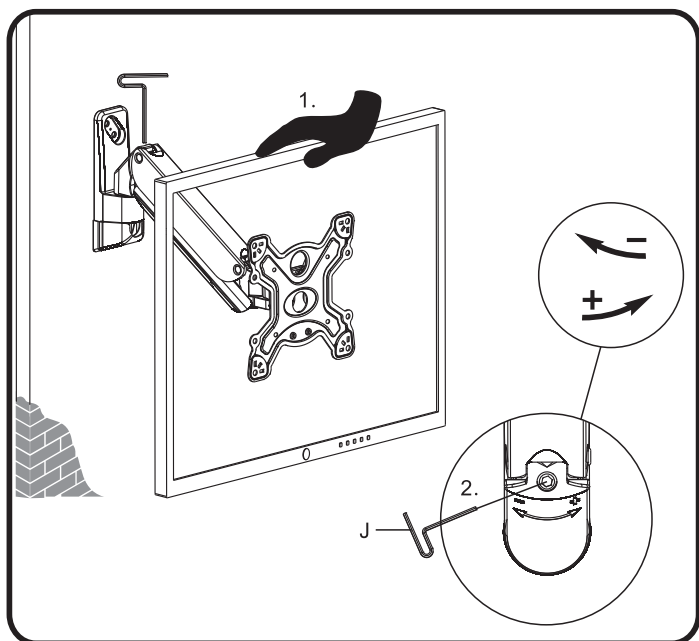

E、Setting tilt angle position

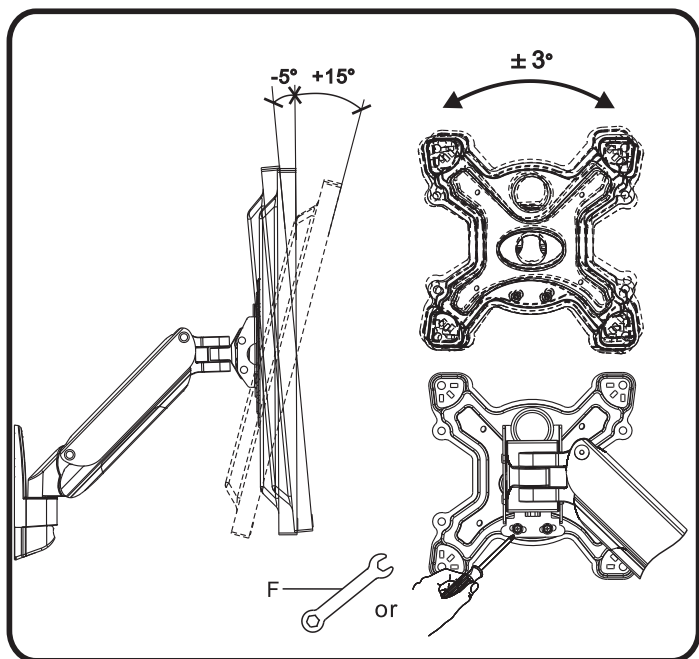

Full motion after full installation

F400

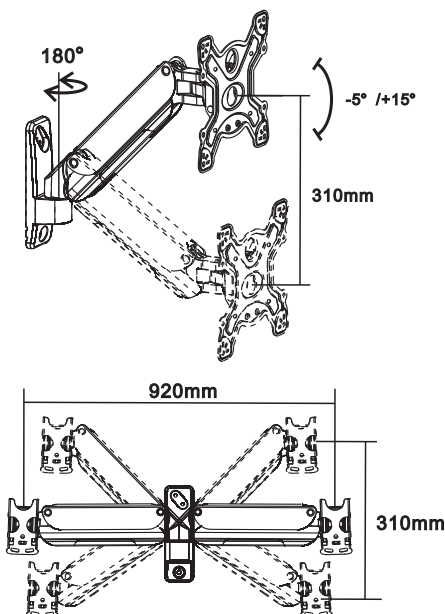

F500

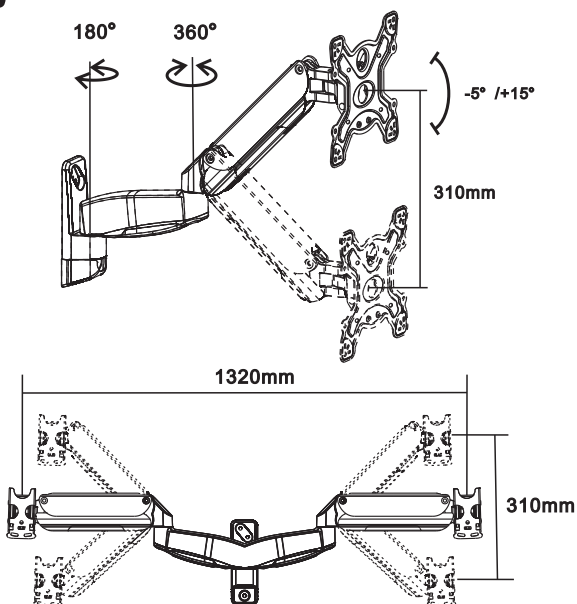

Warning!



www.nbavmount.com

Add: 58, South of Xinxing Road,
Economic Development Zone.
Kunshan City, Jiangsu Province, China.
215333.

TEL: 86-512-57971777
FAX: 86-512-57970776



悬臂型多功能支架安装说明

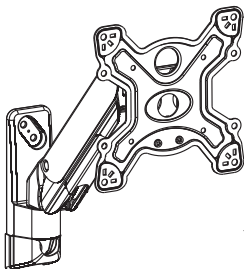

F400

适用于电视机:42"~55"
承重范围:20~55 lbs (9~25kg)
适合的VESA孔位:
100x100~400x400mm

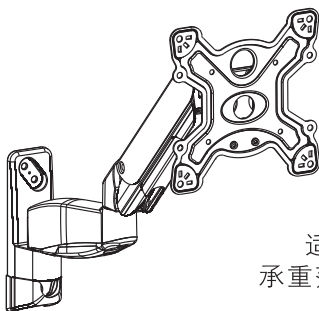

F500

适用于电视机:42"~55"
承重范围:20~55 lbs (9~25kg)
适合的VESA孔位:
100x100~400x400mm

警告! 如果组装或安装不当,这可能导致人员重伤、死亡或财产损毁。请您在组装或安装前,先仔细阅读下列警告信息。

- 必须由专业人员安装产品。
 - 如果您不理解说明或者遇到任何疑问或问题,请与具备资格的当地安装人员联系。
 - 如果产品或配件受损或缺失,请不要组装或安装。如果您需要替换零件或其他,请联络当地的经销商以获取帮助。
 - 此产品适用于42"-55"液晶显示器/等离子屏,最大承重不能超过25 kg / 55 lbs。
 - 此产品适用于墙面使用,其特点:方便、简洁、易拆卸。
 - 为确保安全安装,用于安装产品的墙壁能承受相当于总荷载的3倍重量(支架、显示器及其配件)。
 - 除了产品本身设计的用途外,请不要将此产品用于其他领域。
 - 此产品设计包含滑动部件,为了安全,请小心使用。
 - 当安装显示器时,请注意电源电线不要被损坏。
 - 安装和电线布线的监控显示器上的支架必须符合电技术法规。
 - 重要的是,电源和数据电缆必须设有防扭曲和压缩或剪切。
 - 厂商不对由于不负重荷或意外造成垂直墙壁的损坏负责。
 - 厂商在此声明,对于以下情况所造成的损毁或损伤不承担任何法律责任:对产品自行改造,或安装不当,或安装超过此产品所注明的最大承重,或使用不当,或因使用而造成此产品磨损或毁坏。
- ▲ 本产品内含高压气弹簧,因此在安装、使用过程中严禁火烤和敲击,没有专业人士的情况下,严禁私自拆解!若产品报废请寄回原厂或交于专业机构处理,为保证气弹簧的性能,建议您对本产品的手臂每月进行多次的全行程调节。

www.nbavmount.com

修改和变更的权利属于我公司,在没有我公司正式通知时,请不要修改和变更安装说明。







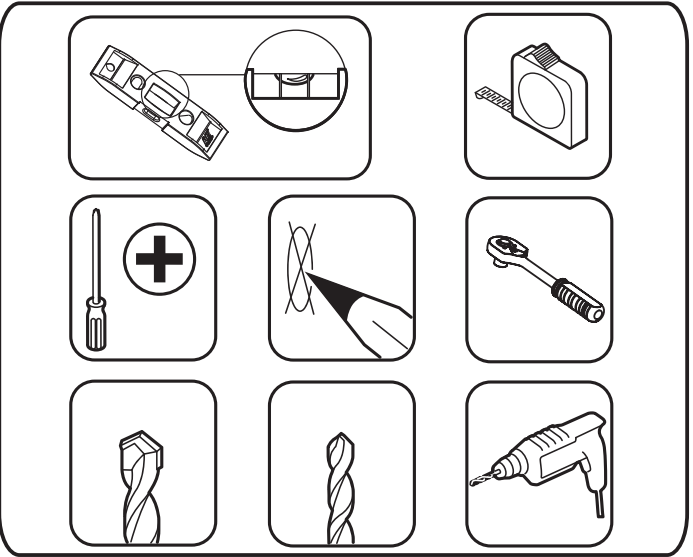



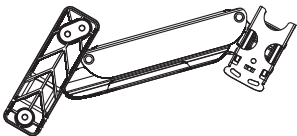
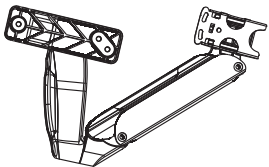





说明

	Tightening Direction		+:Torque increased
	拧紧方向		定点恒力加大
	loosening Direction		-:Torque reduced
	拧松方向		定点恒力减小
	Phillips Screwdriver		By Hand
	螺丝起子		手工
	Open-End Wrench		Hex Wrench
	开口扳手		六角扳手
	Adjustment		Pencil
	调整		铅笔
OPT	Optional		Hand Drill
	可选		手电钻
	Remove		Star Wrench
	移开		安全扳手

安装所需工具

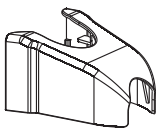

零件

F400		F500	
			
A -  (M6x12)-4pcs		F -  -1pcs	
A -  (M6) -4pcs		G -  -1pcs	
B -  (M6x25)-4pcs		H -  (M7x80)-3pcs	
C -  (M8x25)-4pcs		H -  ($\Phi 16 \times \Phi 8.2 \times 1.5 \text{mm}$)-3pcs	
D -  ($\Phi 17 \times \Phi 8.2 \times 12 \text{mm}$)-4pcs		I -  (UX10x60mm)-3pcs	
E -  ($\Phi 13.5 \times \Phi 6.2 \times 1.5 \text{mm}$)-2pcs		J -  (6mm) -1pcs	
E -  (M6x10)-2pcs			
			

**F400、F500
组装与安装说明**

支架安装方法分为：
A1: 砖墙、混凝土墙安装方法
A2: 木墙安装方法。



请根据您的实际情况选择安装！

A1、安装悬臂型显示器支架到砖墙、混凝土墙上

步骤 1

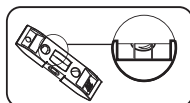
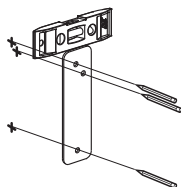
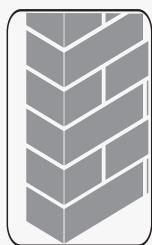

步骤 2

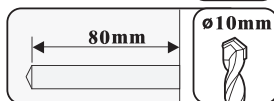
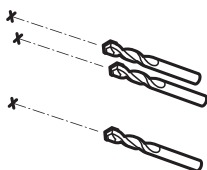

步骤 3

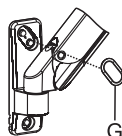
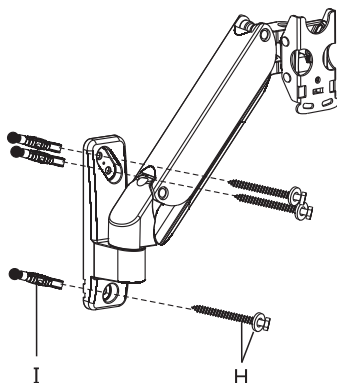

A2、安装悬臂型显示器支架到木墙上

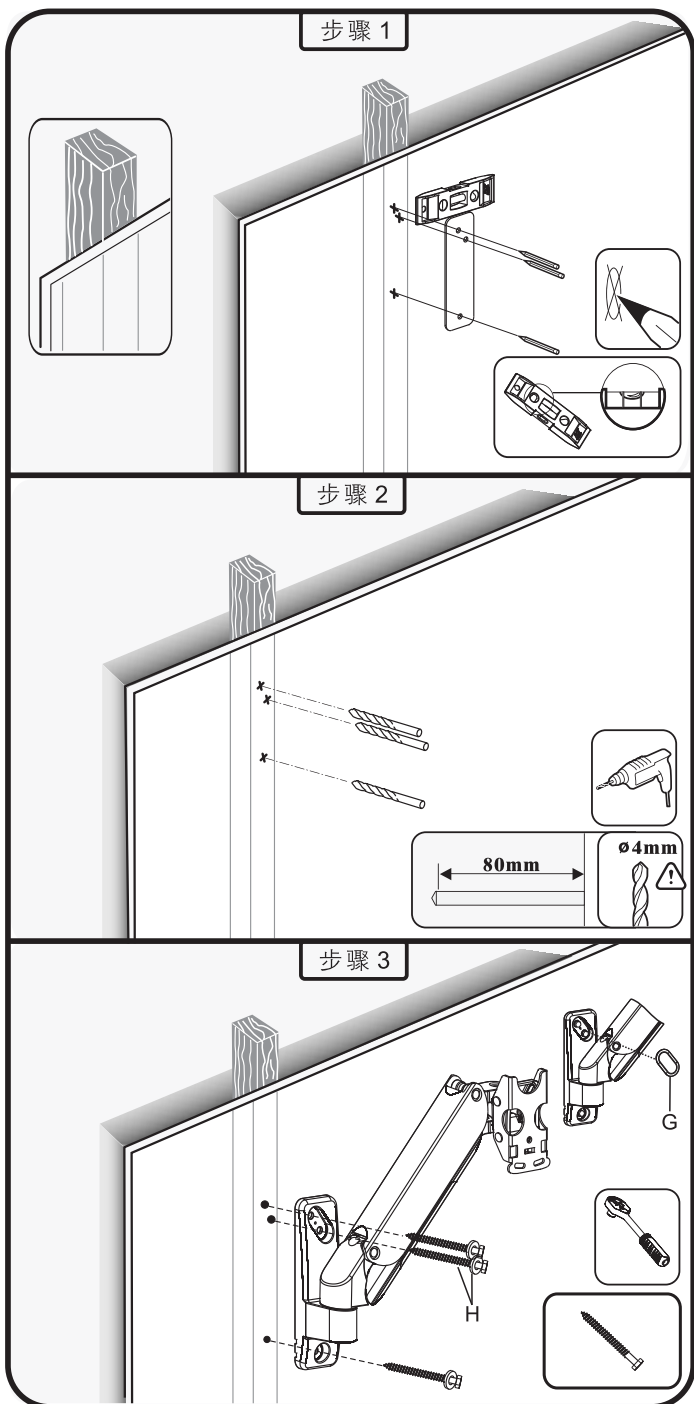

B、安装电视机到支架上

VESA孔位：100x100, 200x100mm, 200x200mm

步骤 1

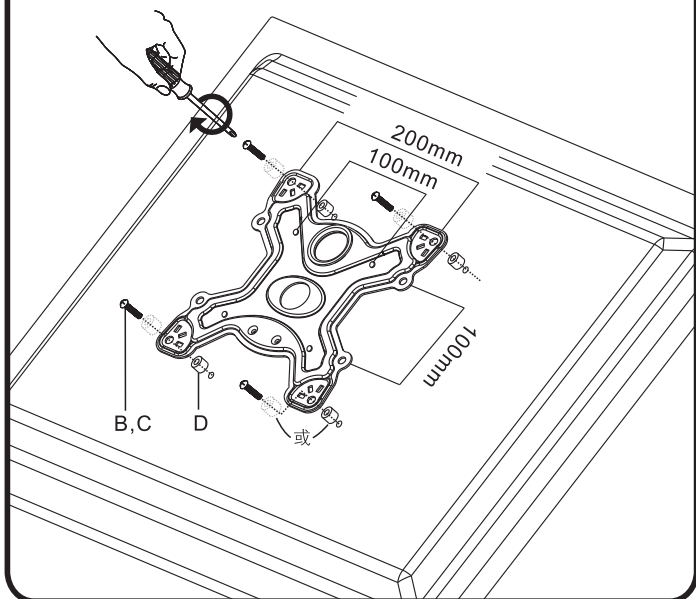

步骤 2

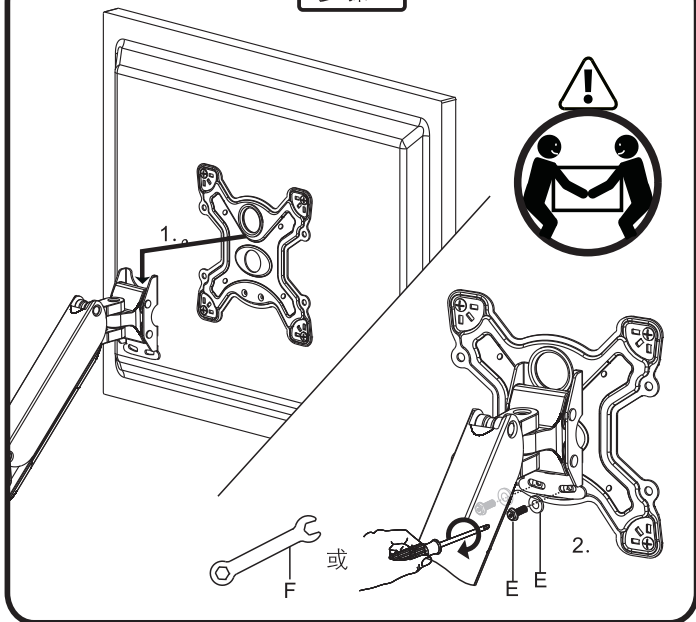

VESA孔位 : 300×200mm, 300×300mm, 400×200mm, 400×400mm

步骤 1

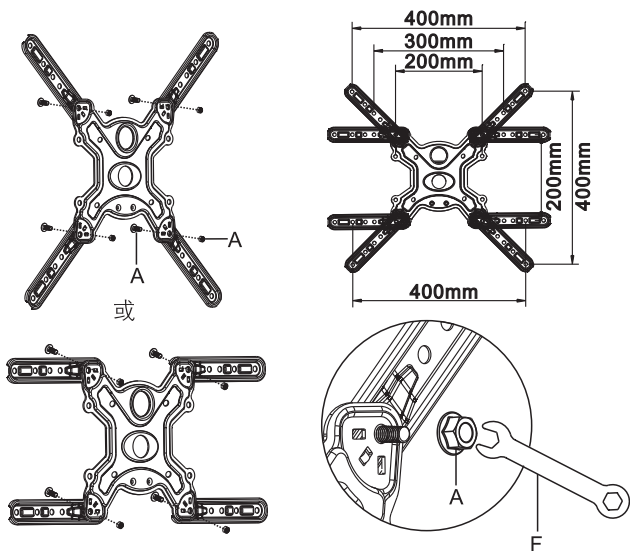

步骤 2

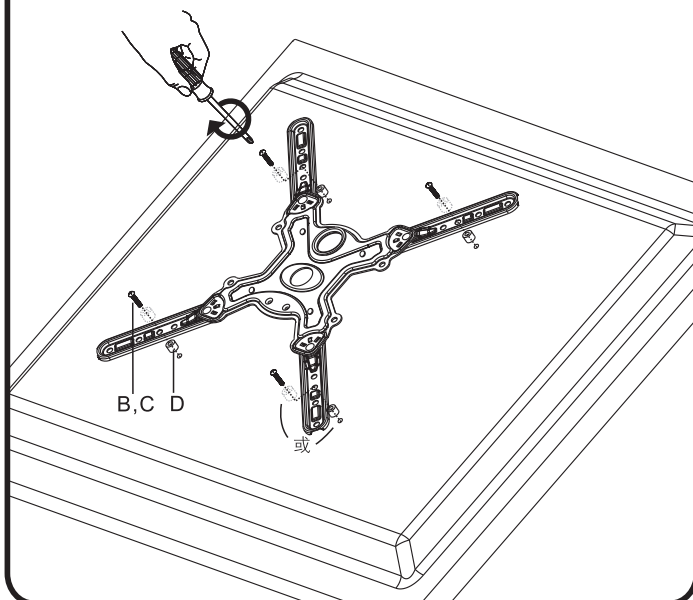

步骤 3

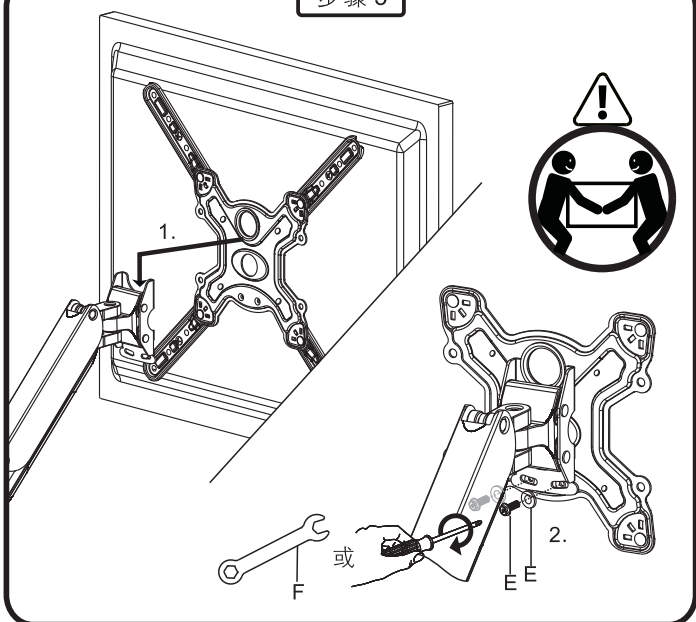

C、视听电线绕道管理

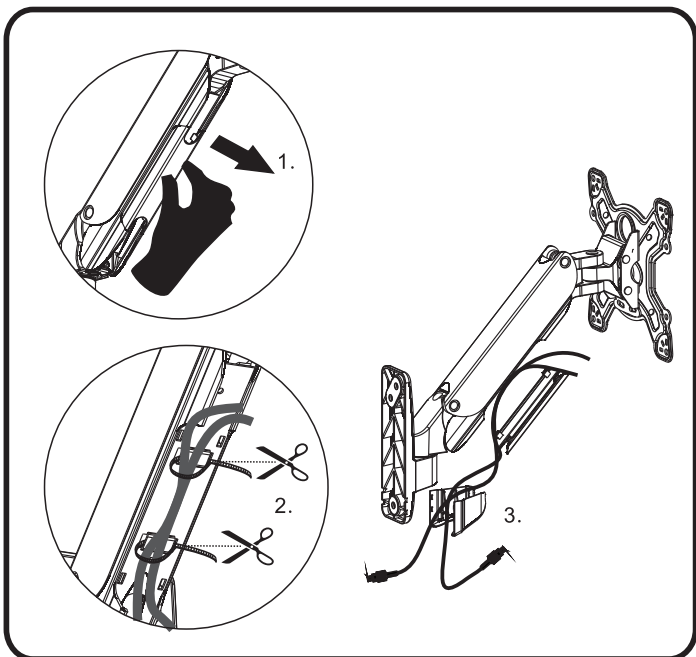

D、支架恒力定点调节

+ :将恒力加大, - :将恒力减小。

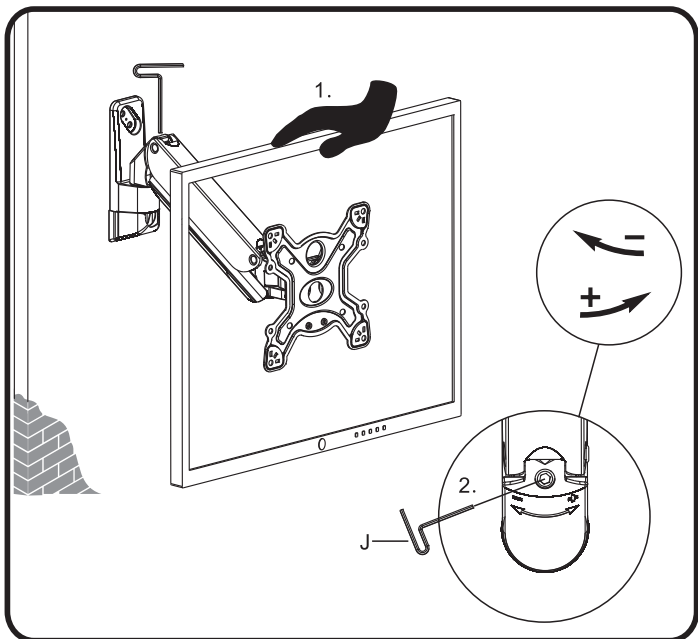

E、电视机倾斜角度和水平角度调节

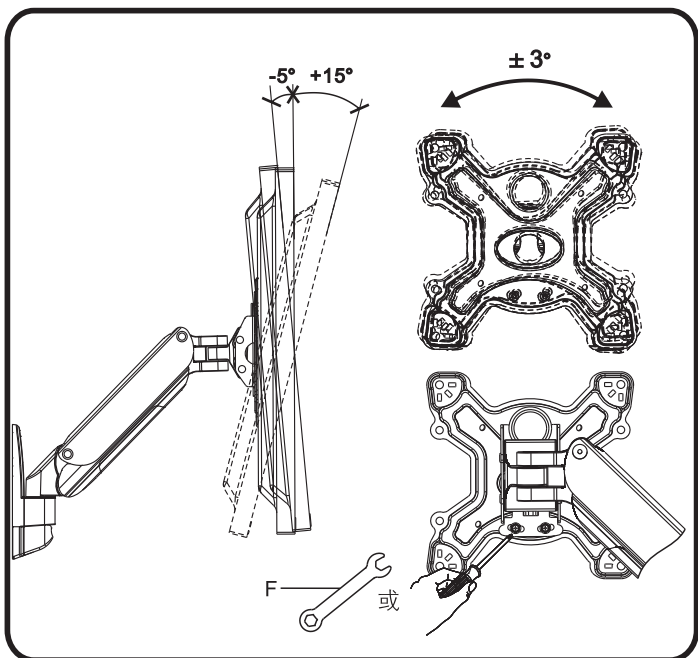

安装后整体支架可调动范围

F400

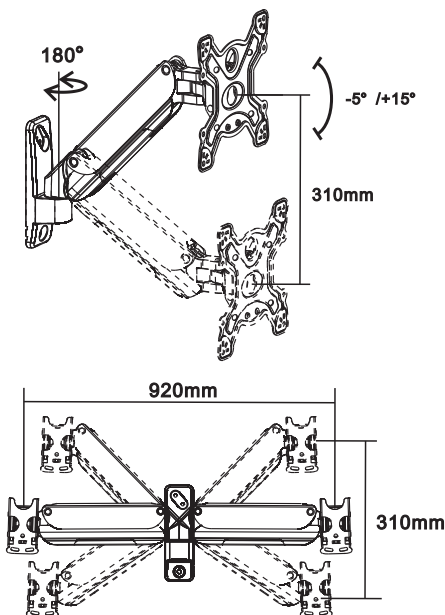

F500

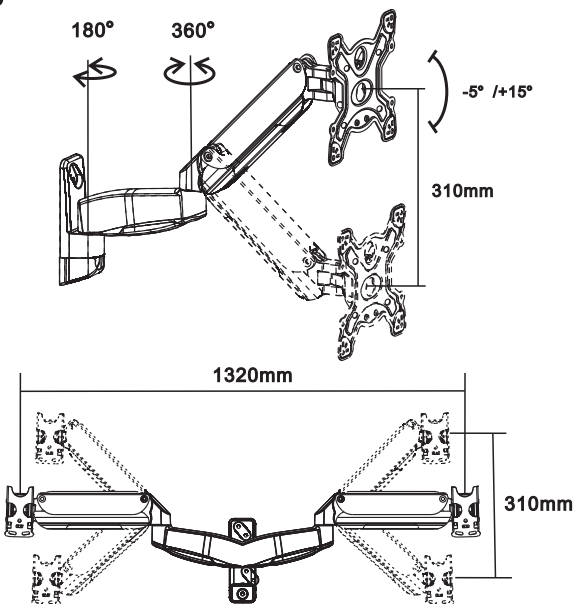

警告!



www.nbavmount.com

昆山泓杰电子有限公司
地址: 中国江苏省昆山市经济技术开发区
新星南路58号
邮编: 215333

TEL: 86-512-57971777
FAX: 86-512-57970776

TENSION ADJUSTMENT AFTER WALL MOUNT INSTALLATION



Do not adjust tension without putting on TV assembly

1. Ensure TV assembly has been put onto wall mount.
2. Read your TV packaging or manual to find out TV net weight.
3. Ensure TV net weight between 19.8-55 lbs(9-25kg).

Adjustment sign



**Clockwise to increase
tension(more weight)**

**Anti-clock reduce
tension(less weight)**