

尺寸：210\*297mm

### Introduction

This LED lighting fixture is consisted of high power LEDs , which is an environmental, energy-saving and the best solution of replacements for conventional Lightings. Various white colors configurations are available, such as cool white, warm white, natural white color.

### Features & Applications

- (1) extended-aluminium housing, 4mm toughened glass, IP65.
- (2) As a decorative product, could be widely used for sculptures, landmark buildings, stadiums, plazas, gardens, public parks and so on, especially used in virescence, the wall of highrises, landscapes etc.

### Technology Parameter

NO	Item	Parameter scope
1	Product	FLHL60
2	Operating voltage	AC120V-277V 50Hz/60Hz
3	Max power consumption	60W
4	Beam angle	120°
5	LED Color	RGB,Soft white to Daylight
6	Operating humidity	10-90%
7	IP Rating	IP66
8	Life time	>50000h
9	Projection distance	8-12m
10	Weight	1.43kg
11	Max projected area	9x10m <sup>2</sup>
12	Mounting height	6m-8m

Suitable for wet locations

### Installation Instruction(Only by an approve electrician)

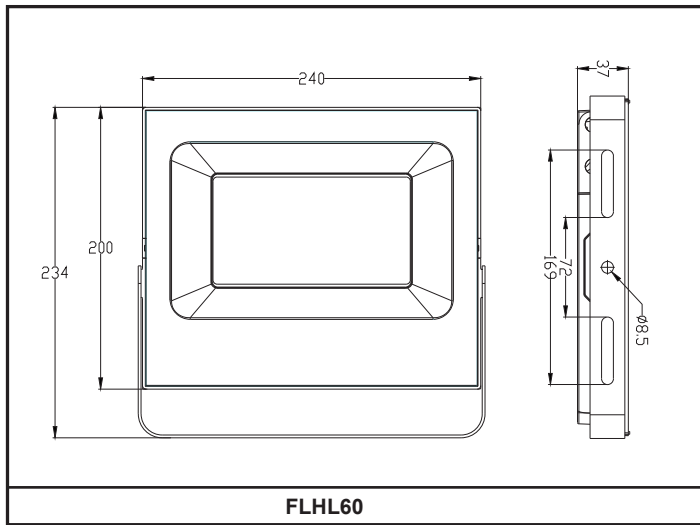

1. drill to install 2 units M8 stainless steel with 80MM between two holes expansion screws in proper position or on ground. (Customer need to provide the screws for himself)
  2. Penetrate the corresponding holes of the fitting through screws, set the gasket, screw the nuts, and then fix the light.
  3. Connect the lights in a sequence as per the signal connecting sketch map and take the waterproof measures.
  4. Get the power supply connected, and debug the programme. Adjust the angle of elevation as requested.
- 5.Fragile glass, handle with care. The non-artificial damage of glass,can be replaced

### Maintenances

1. In order to the life time of the product and more safe operation, please keep it clean, maintenance and preserve
2. While cleaning the lamp, please use the soft cloth with soap water and wring it, then try to sweep.
3. Don't use the volatile chemic liquid such as alcoholic, gasoline or pesticide to sweep, otherwise, easily damage the lamp, thereby affect the life time of it.

### Cautions

1. Make sure that the product is installed Before plug in
2. Please notice that don't use any objectives to cover the lamp.
3. Don't use the lamp under sealed environment.
4. Maintenance should only be done by a professional technician.
5. In case of any change to the product we retain the right to inform you in advance
6. The external flexible cable or cord of this luminaire cannot be replaced; if the cord is damaged, the luminaire shall be destroyed.
7. Terminal block not included. Installation may require advice from a qualified person.
8. The light source of this luminaire is not replaceable;when the light source reaches its end of life the whole luminaire shall be re-placed.
9. Terminal block to be used shall conform to EN 60998-2-1 or EN 60998-2-2; and shall be specified as following:
  - the type of terminal: screw/screwless;
  - number of terminals: 3 poles;
  - rated voltage: Min. 240 V;
  - rated connecting capacity: Min. 1,0mm<sup>2</sup>;
  - any necessary preparation of the ends of conductors: the length of exposed ends of conductors shall not more than 8 mm;- any fixing method: fixed inside the connecting box.

Notes: Do not dispose of electrical appliances as unsorted municipal waste, Use separate collection facilities. Contact you local - go vernment for Information regarding the collection systems available. If electrical appliances Are groundwater and get into the food chain, damaging your health and well-being.



## Smart Light User Manual

### Important Information

Please read and follow all precautions of the smart LED bulb before installing or replacing it, including the following contents.

### Announcement

Warning: not suitable for emergency lighting , having the risk of electric shock and burn.

1. Don't put the product in a metal box because of its wireless function, which avoids the signal shield.
2. Don't use the item under the abnormal circumstances such as chemistry, combustible gas, saturated salt fog and so on.
3. The item should be installed in a place where is non-shaking, non-oscillating, non-wind and non-rain so that there are no gas and dust in the medium, which can not corrode metal, destroy the insulation and explode it.
4. Please turn off the switch and wait the bulb to cool down before trying to replace it.
5. Do not install the Smart Bulb when your hands are wet or

### NO.1 Download and Install App

Use your phone to scan the QR code below or search "Smart Life" in application market to download and install the App.

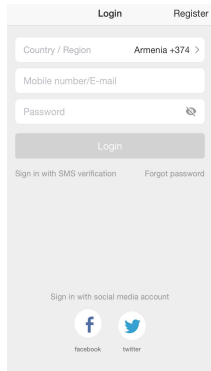

### NO.2 Register/Login/Request Password

#### 2.1 Register

If you don't have the account of Smart Life APP, register an account or sign in with cellphone number + verification code.

- 2.1.1 Tap "Register" in the upper right.

### NO.3 Add Device

#### 3.1 Add device

- 3.1.1 Go to the App, on "Devices(Prepare)", tap "+" in the upper right of this page. to add device, as shown in the picture.

- 3.1.3 Select the Wi-Fi, enter password and click "Confirm", as shown in the picture below.

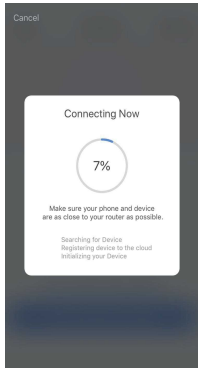
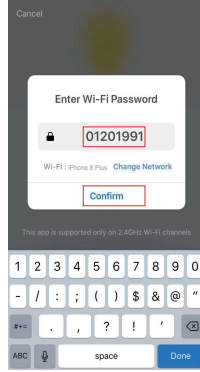

pic1

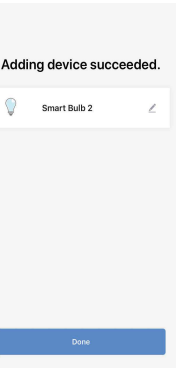

pic2

- 3.1.4 The App interface will go through the changes during the network configuration process as shown in the picture 1. Picture 2 shows the interface when the device is connected successfully.

6. Not suitable for standard in-wall dimmers. Be able to adjust light via the app only. The range of temperature circumstance is between -20℃ and +40℃, Humidity ≤ 95% RH.

### Hardware Specification

Material: Aluminum+Glass cover  
Housing Color: Black

### Software Specification

Connection: 2.4GHz Wi-Fi  
Light Appearance: 2700K - 6500K Soft White to Daylight  
Multicolor: Multiple Color Options(RGB)  
Dimmable (via app)

### Feature

1. Be able to change the color by voice control. (No Hub required, Amazon Alexa and Google Home or other assistant are sold separately).
2. The dimming light can be adjusted from warm white light to white light and color temperature is from 2700K to 6500K.
3. Multiple colors for your choices, adjust it to match your mood anytime. (adjust the color through smart phone APP).
4. Be able to control the LED bulb anywhere with the free APP in your tablet or smart phone (Android 9.0 or higher / iOS 10 or higher).

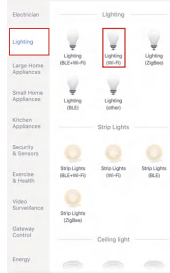
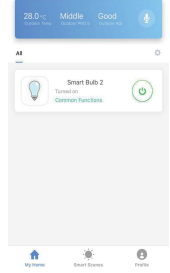

- 3.1.2 Please turn ON-OFF-ON-OFF-ON the lights make sure the device's indicator light quickly flashes, click "confirm light blinks rapidly" and go on to the next step.

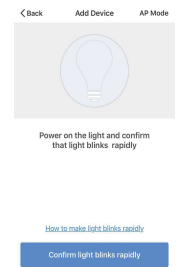

### NO.4 Control Device

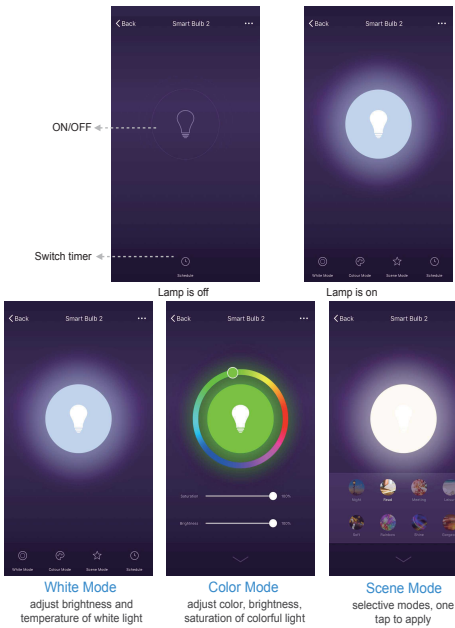

## FCC Warning

This device complies with part 15 of the FCC Rules. Operation is subject to the following two conditions: (1) This device may not cause harmful interference, and (2) this device must accept any interference received, including interference that may cause undesired operation.

Any Changes or modifications not expressly approved by the party responsible for compliance could void the user's authority to operate the equipment.

**Note:** This equipment has been tested and found to comply with the limits for a Class B digital device, pursuant to part 15 of the FCC Rules. These limits are designed to provide reasonable protection against harmful interference in a residential installation. This equipment generates uses and can radiate radio frequency energy and, if not installed and used in accordance with the instructions, may cause harmful interference to radio communications. However, there is no guarantee that interference will not occur in a particular installation. If this equipment does cause harmful interference to radio or television reception, which can be determined by turning the equipment off and on, the user is encouraged to try to correct the interference by one or more of the following measures:

- Reorient or relocate the receiving antenna.
- Increase the separation between the equipment and receiver.
- Connect the equipment into an outlet on a circuit different from that to which the receiver is connected.
- Consult the dealer or an experienced radio/TV technician for help.

This equipment complies with FCC radiation exposure limits set forth for an uncontrolled environment. This equipment should be installed and operated with minimum distance 20cm between the radiator & your body.