

300 Mbps Wireless N Router User Manual

Overview

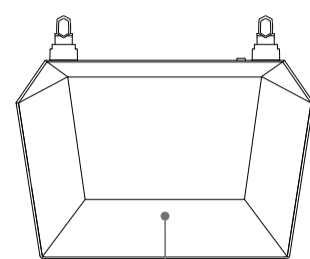

Number	Indicator	Description
01	Indicator status	Solid red: Power on, Internet is not connected. Solid green: Connected to the Internet.

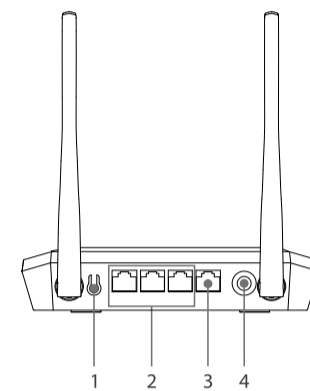

Number	Ports and Button	Description
01	Reset/WPS Button	Press the button for 1s to start the WPS process. Press and hold the button for 5s to reset the device.
02	LAN ports	Connects to wired devices such as computers and set top boxes.
03	WAN port	Connects to the Internet modem or Ethernet port.
04	Power port	Connects to the power supply.

Connect to Internet

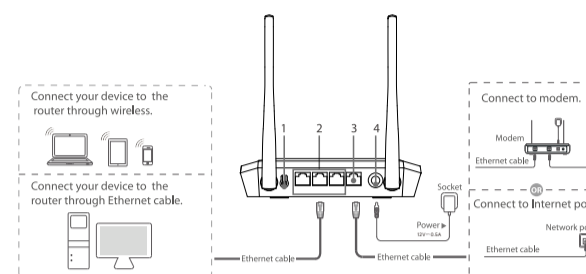

- Power off the modem.
- Connect the modem's LAN port with an Ethernet cable (RJ45) to the router's WAN port.
 - If your Internet connection is through an Ethernet cable directly from the wall, connect the other end of Ethernet cable to the router's WAN port.
 - Solid red: Power on, Internet is not connected.
 - Solid green: Connected to the Internet.
- Connect the power adapter to the router's DC-IN and turn it on.
- Plug in the modem's power adapter.

Set up the Network via a Web Browser

- Connect your smartphone or computer to the Wi-Fi name (SSID) displayed on the device label on the router.

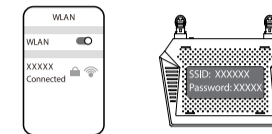

- Launch a web browser. Key in 192.168.10.1 in the address bar. Enter the default Username and Password on the label at the bottom of the router, then you can enter the router management page.



- Choose Internet Page, select WAN Type, click DHCP, and click Save.
 - If you do not know the Internet connection type, please consult your Internet Service Provider.



- Choose WiFi page. Change the SSID and Password to improve your W-Fi network security. Click Save to save the configuration.



FAQ

- Q1: What should I do if I can't access the router's management page?
- Reboot your router and try again
 - Check your Wi-Fi connection.
 - Use another Web browser such as Google Chrome.
 - Restart your device.
- Q2: What should I do if I can't access Internet?
- Reboot your modem and router, then try again.
 - Check the Internet is working. With an Ethernet cable connecting the modem to the computer directly.
- Q3: What can I do if I forget my wireless network password?
- If you have not changed the default wireless password, it can be found on the label at the back of the router.
 - Connect your computer to the router via an Ethernet cable. Log in to the web management page at IP Address: 192.168.10.1 and go to Install > Wireless to retrieve or reset your wireless password.
- Q4: What should I do if I forget my Web management page password?
- Check the Web password on the label at the bottom of the router.
 - When the router is power on, use a pin to press and hold the RESET button on the back until the LED blinks. Then the password will restore to the default that marked on the label.

封面

FCC Warning Statement

-FCC Radiation Exposure Statement: The antennas used for this transmitter must be installed to provide a separation distance of at least 20 cm from all persons and must not be co-located for operating in conjunction with any other antenna or transmitter.

-Changes or modifications not expressly approved by the party responsible for compliance could void the user's authority to operate the equipment.

-This equipment has been tested and found to comply with the limits for a Class B digital device, pursuant to Part 15 of the FCC Rules. These limits are designed to provide reasonable protection against harmful interference in a residential installation. This equipment generates uses and can radiate radio frequency energy and, if not installed and used in accordance with the instructions, may cause harmful interference to radio communications. However, there is no guarantee that interference will not occur in a particular installation. If this equipment does cause harmful interference to radio or television reception, which can be determined by turning the equipment off and on, the user is encouraged to try to correct the interference by one or more of the following measures:

- Reorient or relocate the receiving antenna.
- Increase the separation between the equipment and receiver.
- Connect the equipment into an outlet on a circuit different from that to which the receiver is connected.
- Consult the dealer or an experienced radio/TV technician for help.

-This device complies with part 15 of the FCC rules. Operation is subject to the following two conditions

- (1) this device may not cause harmful interference, and
- (2) this device must accept any interference received, including interference that may cause undesired operation.

QUALIFIED CERTIFICATE
QC PASS

Security Warning:

-Before using and operating the equipment, please read and follow the following precautions to ensure stable equipment performance and avoid dangerous or illegal situations.

-Please use and store this equipment and its accessories within the temperature range of 0 °C to 40 °C. When the temperature is too high or too low, it may cause equipment failure.

-During the use of the device, be sure to maintain a distance of at least 20 centimeters between the human body and the device antenna.

-Only accessories approved by the equipment manufacturer and compatible with this model of equipment can be used. If other types of accessories are used, it may violate the warranty terms of this device and relevant regulations of the country where the device is located, and may result in safety incidents. If you need to obtain approved accessories, please contact the authorized service center.

-The power socket should be installed near the equipment and easily accessible.

- When not using this device, please disconnect the power supply from the device and unplug the power plug from the power outlet.

-Please treat this device and its accessories as regular household waste.

-Please comply with local regulations regarding the handling of this device and its accessories, and support recycling actions.

Hazardous Substances Table

Part Name	Hazardous Substances or element									
	Pb	Hg	Cd	Cr(VI)	Br	PBBs	PBDEs	DBP	BBP	DEHP
PCBA	●	○	○	○	○	○	○	○	○	○
Cable assembly	○	○	○	○	○	○	○	○	○	○
Metal part	○	○	○	○	○	○	○	○	○	○

○ : It indicates that content of toxic and hazardous substance in all homogeneous material are less than specified limit by Directive2011/65/EU (RoHS)

● : It indicates that at least one content of toxic and hazardous substance in all homogeneous material is beyond specified limit by Directive2011/65/EU (RoHS)

This table shows the toxic and hazardous substance when manufacture this device, hazardous substance information is based on information from supplier as well as internal inspection. In some part, hazardous substance cannot be replaced with current technologies, but we are always doing its best to improve the quality of the product.

Quick Installation Guide

Without our official writ permission, no unit or individual shall be copied, reproduced, transcribed or translated in part or whole book. In any form or by any means (electronic, mechanical, printing, recording or other possible means) for the propagation of goods any commercial, profitable purposes.

Dbit is the registered trademark of Shenzhen Dbit Network Equipment Co., Ltd. Company. All other trademarks or registered trademarks mentioned in this document, by respective owners.

Product specifications and information mentioned in this manual are for reference on subject to updates without notice. Unless there are other special agreed, this manual is used only as a user guide. All statements, information, etc. are not constitute any form of guarantee.

Manufacturer: Shenzhen Dbit Network Equipment Co., Ltd
Address: 4002, Phase II, Qianhai Shimao Financial Center, No. 3040 Xinghai Avenue, Nanshan Street, Qianhai Shenzhen-Hong Kong Cooperation Zone, Shenzhen, China

Product images in the document are for reference only, subject to physical appearance.

Copyright©2015 Shenzhen Dbit Network Equipment Co., Ltd All rights reserved.