

UK, Ireland, Australia, New Zealand:

- **English (Original instructions)**

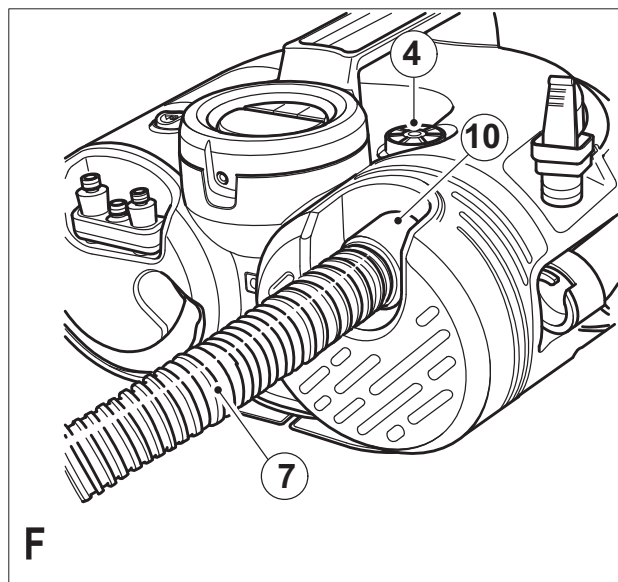

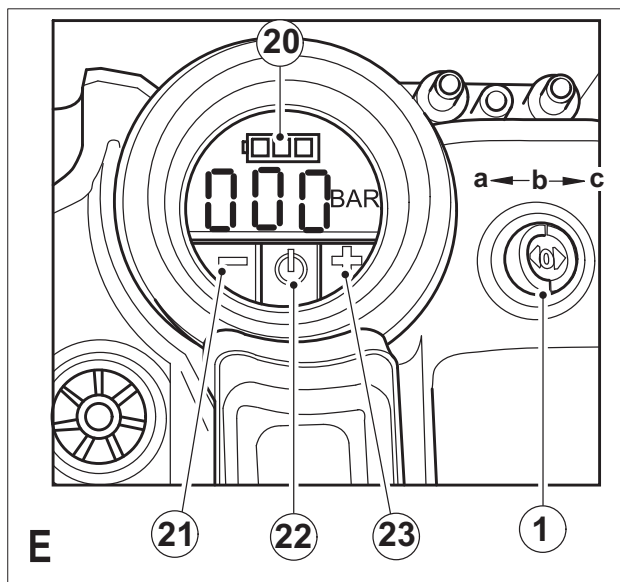
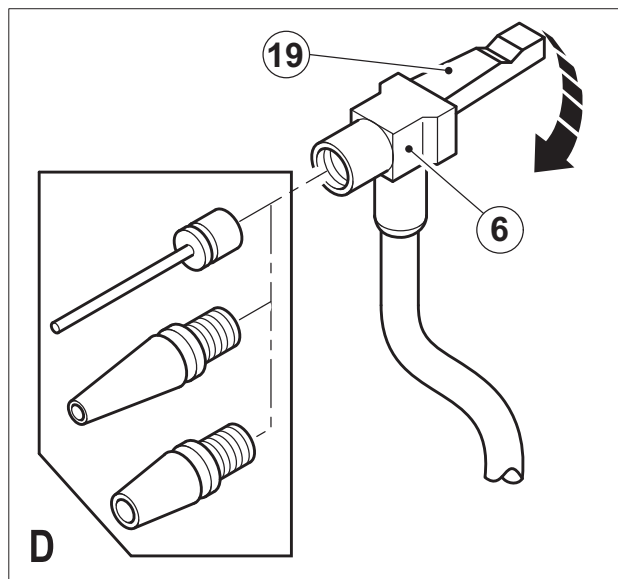
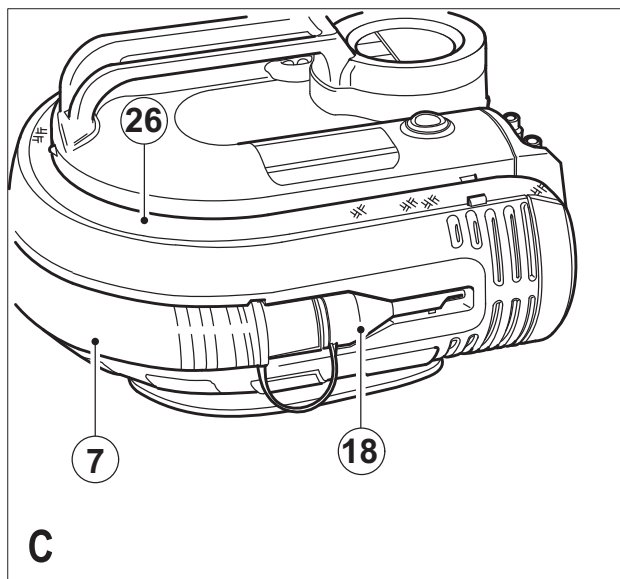
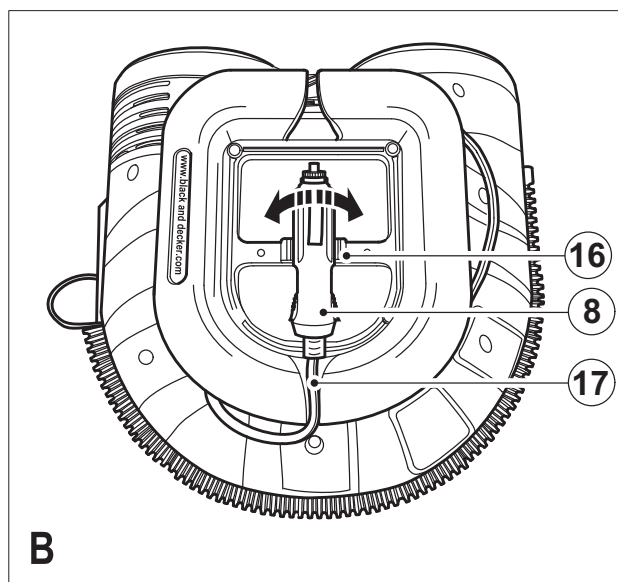
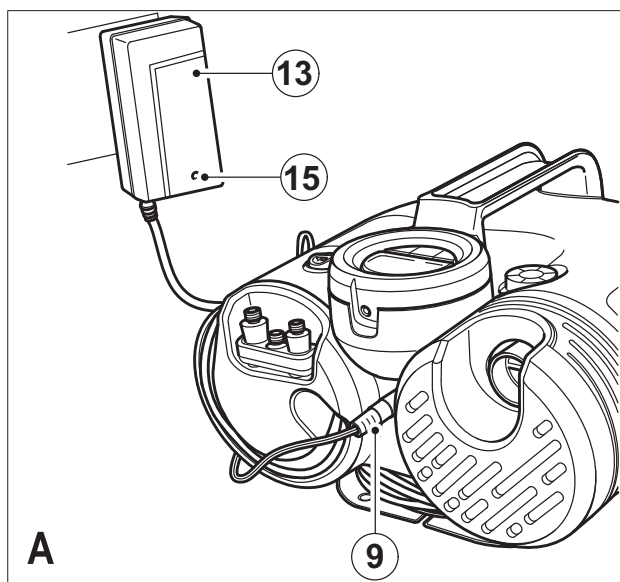
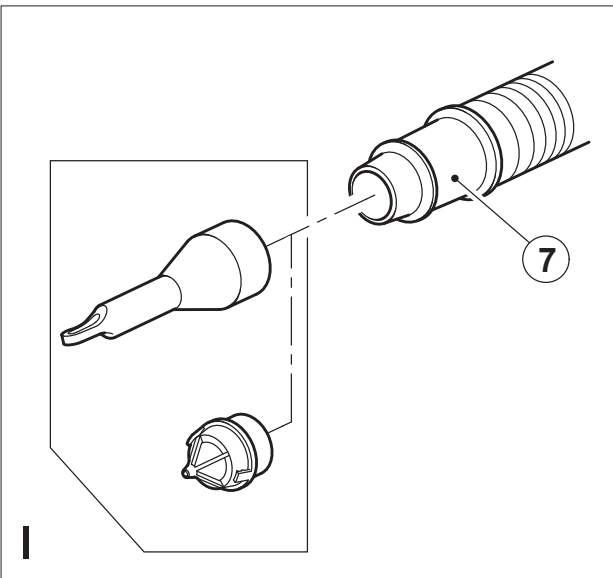
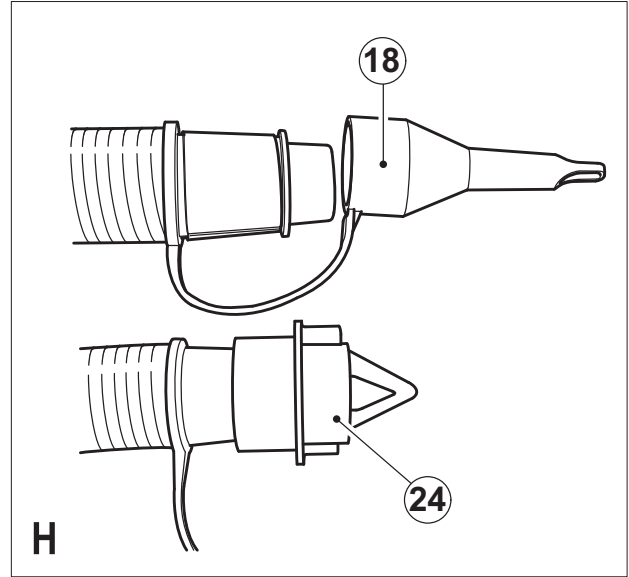
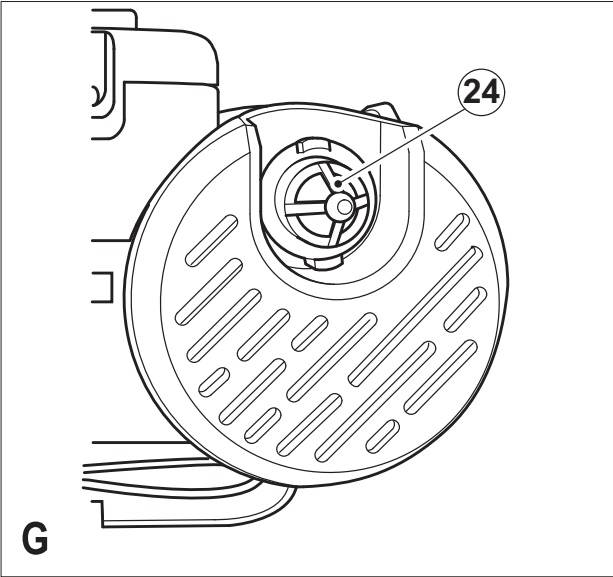

Intended use

Your Black & Decker inflation station is designed to be used cordless or, in most vehicles, from the standard 12 Vdc socket, to inflate car and bike tyres, balls, rafts, air mattresses and swimming pool floats etc. This product is intended for household, consumer use only.

Safety instructions

Warning! When using battery-powered appliances, basic safety precautions, including the following, should always be followed to reduce the risk of fire, electric shock, personal injury and material damage.

- ◆ Read all of this manual carefully before using the appliance.
- ◆ The intended use is described in this manual.
- ◆ The use of any accessory or attachment or the performance of any operation with this appliance other than those recommended in this instruction manual may present a risk of personal injury.
- ◆ Retain this manual for future reference.

Using your appliance

- ◆ Always take care when using the appliance.
- ◆ Do not immerse the appliance in water.
- ◆ Do not open the body casing. There are no user serviceable parts inside.
- ◆ Do not operate the appliance in explosive atmospheres, such as in the presence of flammable liquids, gases or dust.
- ◆ To reduce the risk of damage to plugs and cords never pull the cable to remove the plug from a socket.

After use

- ◆ When not in use, the appliance should be stored in a dry, well ventilated place out of the reach of children.
- ◆ Children should not have access to stored appliances.
- ◆ When the appliance is stored or transported in a vehicle it should be placed in the boot or restrained to prevent movement following sudden changes in speed or direction.
- ◆ The appliance should be protected from direct sunlight, heat and moisture.

Inspection and repairs

- ◆ Before use, check the appliance for damaged or defective parts. Check for breakage of parts, damage to switches and any other conditions that may affect its operation.
- ◆ Do not use the appliance if any part is damaged or defective.
- ◆ Have any damaged or defective parts repaired or replaced by an authorised repair agent.

- ◆ Never attempt to remove or replace any parts other than those specified in this manual.

Additional safety instructions for inflators

- ◆ For home and car use only. Inflate car and bike tyres, balls, swimming pool floats and more in and around the home.
- ◆ The compressed air from your inflator is not safe for breathing. Never inhale air from your inflator or from a breathing device connected to the inflator.
- ◆ Inflate items only to their manufacturer's recommendations. Exceeding the pressure rating could cause them to explode resulting in personal injury.
- ◆ Do not leave inflator running unattended. It could burst tyres or other items.
- ◆ Since the vibration produced by the inflator may cause it to "walk", do not operate on a high shelf or other surface. Operate at ground or bench level only.
- ◆ Do not modify or attempt to repair. Never drill into, weld, or make any modifications to the inflator or its attachments.
- ◆ Do not operate the inflator when the engine is running.
- ◆ Operate only with the accessories included or those rated for 160 PSI / 11.03 BAR / 1103 KPA. or higher. The use of any accessory not recommended for use with this tool could be hazardous.
- ◆ Do not play with the tool. High pressure air is dangerous. Do not direct air-flow at yourself or others.
- ◆ The inflator can become hot during use. Allow inflator to cool for 30 minutes before storing away.
- ◆ Never carry the inflator by the hose.
- ◆ Do not direct the nozzle or hose at animals or bystanders
- ◆ Store the inflator out of reach of small children.
- ◆ The gauge is intended as a guide only. Tyre pressures should be regularly checked with a certified gauge.
- ◆ Before use, check the power supply cord for signs of damage, ageing and wear.
- ◆ Do not use the appliance if the power supply cord or mains plug is damaged or defective (where applicable).

Safety of others

- ◆ This appliance is not intended for use by persons (including children) with reduced physical, sensory or mental capabilities, or lack of experience and knowledge, unless they have been given supervision or instruction concerning use of the appliance by a person responsible for their safety.
- ◆ Children should be supervised to ensure that they do not play with the appliance.

Additional safety instructions for batteries and chargers

Batteries

- ◆ Never attempt to open for any reason.
- ◆ Do not expose the battery to water.
- ◆ Do not expose the battery to heat.
- ◆ Do not store in locations where the temperature may exceed 40°C.
- ◆ Charge only at ambient temperatures between 10°C and 40°C.
- ◆ Charge only using the charger provided with the appliance/tool.
- ◆ When disposing of batteries, follow the instructions given in the section "Protecting the environment".
- ◆ Do not damage/deform the battery pack either by puncture or impact, as this may create a risk of injury and fire.
- ◆ Do not charge damaged batteries.
- ◆ Under extreme conditions, battery leakage may occur. When you notice liquid on the batteries carefully wipe the liquid off using a cloth. Avoid skin contact.
- ◆ In case of skin or eye contact, follow the instructions below.

Warning! The battery fluid may cause personal injury or damage to property. In case of skin contact, immediately rinse with water. If redness, pain or irritation occurs seek medical attention. In case of eye contact, rinse immediately with clean water and seek medical attention.

Chargers

Your charger has been designed for a specific voltage. Always check that the mains voltage corresponds to the voltage on the rating plate.

Warning! Never attempt to replace the charger unit with a regular mains plug.

- ◆ Use your Black & Decker charger only to charge the battery in the appliance/tool with which it was supplied. Other batteries could burst, causing personal injury and damage.
- ◆ Never attempt to charge non-rechargeable batteries.
- ◆ If the supply cord is damaged, it must be replaced by the manufacturer or an authorised Black & Decker Service Centre in order to avoid a hazard.
- ◆ Do not expose the charger to water.
- ◆ Do not open the charger.
- ◆ Do not probe the charger.
- ◆ The appliance/tool/battery must be placed in a well ventilated area when charging.

Electrical safety



Your charger is double insulated; therefore no earth wire is required. Always check that the mains voltage corresponds to the voltage on the rating plate.

- ◆ If the supply cord is damaged, it must be replaced by the manufacturer or an authorised Black & Decker Service Centre in order to avoid a hazard.
- ◆ Never attempt to replace the charger unit with a regular mains plug.

Labels on tools

The following symbols are shown on the tool:



Read the instruction manual before using the inflator.



Do not expose the appliance to rain or high humidity.



Before performing maintenance or cleaning on the appliance, unplug the supply cord.



Do not leave the inflator unattended.

Features

1. Main power switch
2. LCD
3. Handle
4. High-volume pump deflate connection
5. Air hose with universal valve adaptor
6. Universal valve adapter
7. High-volume hose
8. 12 Vdc vehicle connector
9. Charger jack plug
10. High-volume pump inflate connection
11. Jack plug socket
12. LED light
13. Charger
14. Accessory storage

Fig. A

15. Charging LED

Before use (fig. A)

The internal battery must be recharged for 4 to 5 hours using the AC charger (13) provided.

- ◆ Insert the jack plug (9) into the jack plug socket (11) on the front of the unit.

- ◆ Plug the AC charger (13) into the mains power supply.
- ◆ The LED (15) on the AC charger (13) will indicate the level of charging. Red, unit charging, Green, unit charged.
- ◆ When fully charged, remove the AC charger from the mains and remove the jack plug from the unit.

Note: Store your AC charger in a safe place for later use.

Use

Hose and cord storage (fig. B - D)

- ◆ Wrap the 12 Vdc cord (17) around the base of the unit and locate the 12 Vdc adapter (8) into its storage location (16) as shown in fig. B and then rotate through 90° to secure in place.
- ◆ The air hose (5) is located in a storage channel (26) around the top of the unit (fig. C), make sure the hose is snapped into the retaining clips and the lever (19) is in the up position (fig. D).
- ◆ The high-volume hose (7) is stored in a storage channel around the centre of the unit and snaps into position at both ends. The accessories (14) are stored on the front of the unit.

Fitting the accessories (fig. D, G - I)

Your inflator is supplied with the standard tapered nozzles and the needle inflator nozzle, these are stored on the front of the unit (14).

- ◆ To use the universal valve adaptor (6), make sure that the lever (19) is in the up position.
- ◆ Place the universal valve adapter (6) over the stem of the inflation needle or tapered nozzle (fig.D).
- ◆ Press the lever (19) on the universal valve adapter (6) down to lock it in place.
- ◆ Place the inflation needle or tapered nozzle into the item to be inflated.

Note: Always make sure that the lever is in the up position when not in use. Operate your inflator only with the universal valve adaptor or with the included nozzles.

Note: Make sure that the universal valve adapter is firmly locked in place before turning the inflator on.

Your inflator is supplied with a high volume adaptor (24). This is stored on the front of the unit (fig. G).

- ◆ To use the high volume adaptor (24), remove it from the high volume inflate connection (10).
- ◆ Remove the high volume hose (7) from the storage location.
- ◆ Remove the tapered nozzle (18) from the end of the high volume hose (7).
- ◆ Fit the high volume adaptor (24) to the end of the high volume hose (fig. H).

Many inflatables have an internal flap that prevents air loss during inflation, especially air mattresses. Unless this flap is displaced by the nozzle the inflatable will not inflate. Push the nozzle firmly into the valve to make sure that you push this flap out of the way.

Warning! Excessive air pressure may cause a hazardous risk of bursting or personal injury. Check the manufacturer's maximum pressure rating for items being inflated.

Note: If the pressure rating for the item being inflated is above 100 PSI / 6.89 BAR / 689 KPA, note that the maximum run time is 10 minutes, leave to rest for 20 minutes before re-use.

Operating the inflator (fig. E)

Warning! Do not operate the inflator when the car engine is running.

Note: Make sure that your 12 Vdc accessory socket is live. On some vehicles the accessory socket may only become live when the ignition key is in the accessory position.

To power the display from the 12 Vdc adapter:

- ◆ Always fully extend the 12 Vdc cord before each use.
- ◆ Connect the 12 Vdc adapter (8) into your vehicles 12 Vdc accessory socket.
- ◆ Switch the main power switch (1) to the inflate position (c) to power-up the LCD.

To power the LCD from the internal battery (cordless operation):

- ◆ Switch the main power switch (1) to the inflate position (c) to power up the LCD.

Warning! Do not leave the inflator running unattended. It could burst tyres or other items.

Setting the required pressure (fig.E)

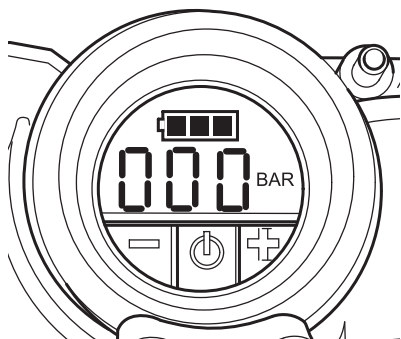

Note: The LCD will only display inflation pressures when the inflator is being used. Battery status will always be shown.



Needs charging.



Charging.



Fully charged.

Note: You must set the automatic shut-off feature before the unit will operate (inflation mode only).

- ◆ To switch between the different units (PSI, BAR or KPA), press - & + buttons (21, 23) together until the required units are displayed.
- ◆ Press and hold either of the - & + buttons (21, 23) for 3 seconds until the display flashes.
- ◆ While the display is flashing press the - or + buttons (21, 23) until the required pressure is displayed.
- ◆ After 3 seconds the display will flash and return to a reading of "0.0 PSI / 0.00 BAR / 0 KPA". This is normal.
- ◆ Connect the universal valve adaptor (6) and an accessory, if required, to the item to be inflated, making sure that the lever (19) of the valve adaptor is in the down position to lock it in place.

Note: Make sure that the universal valve adaptor is correctly fitted to the item to be inflated.

- ◆ To start the inflator press the power button (22) on the LCD.
- ◆ When the item to be inflated has reached the preset value the unit will automatically stop.

Note: You may notice the actual pressure reading may drop after a couple of seconds, this is normal.

- ◆ To stop the inflator at any time press the power button on (22) the LCD.
- ◆ Remove the valve adaptor or accessory from the inflated item and the 12 Vdc adapter (6) from your vehicle's 12 Vdc accessory socket.
- ◆ Turn the main power switch (1) to the off position (b).

Note: If the main power switch is turned off, all settings will be lost and will need to be re-entered following the instructions under the heading 'Setting the required pressure'. This is a safety feature to prevent the risk of items OVER INFLATING.

Using the inflator as a pressure gauge

- ◆ Switch the main power switch (1) to the inflate position (c fig. E).
- ◆ Connect the universal valve adaptor (6) to the item to be checked.
- ◆ The LCD will display the items pressure.
- ◆ After checking, turn the main power switch (1) off and return the air hose to the storage location.

Operating the high-volume pump

Note: Do not operate the pump when the vehicle's engine is running.

Note: Make sure that your 12 Vdc accessory socket is live. On some vehicles the accessory socket may only become live when the ignition key is in the accessory position.

To inflate using the high-volume pump (i.e air mattresses, rafts, swimming pool floats):

Note: The pump mode DOES NOT have an auto shut-off feature.

- ◆ Switch the main power switch(1) to the pump position (a, fig. E).
- ◆ Remove the high-volume hose (7) from the storage channel around the centre of the unit and connect it to the high-volume pump inflate connection (10) (fig. F).
- ◆ Insert the hose (with accessories if required) to the item to be inflated.
- ◆ To start the pump press the power switch (22) on the LCD.
- ◆ When the item is inflated as required or to stop the pump at any time press the power switch (22) on the LCD.
- ◆ Remove the hose from the item and store it on the unit.
- ◆ Turn the main power switch (1) to the off position (b fig. E).

To deflate using the high-volume pump (i.e air mattresses, rafts, swimming pool floats):

Note: The pump mode DOES NOT have an auto shut-off feature.

- ◆ Switch the main power switch (1) to the pump position (a fig. E).
- ◆ Remove the high-volume hose (7) from the storage channel around the centre of the unit and connect it to the high-volume pump deflate connection (4) (fig. F).
- ◆ Insert the hose (with accessories if required) into the item to be deflated.
- ◆ To start the pump press the power switch (22) on the LCD.

- ◆ When the item is deflated or to stop the pump at any time press the power switch (22) on the LCD.
- ◆ Remove the high-volume hose ((7) from the item and store it in the storage channel around the centre of the unit.
- ◆ Turn the main power switch (1) to the off position (b fig. E).

Operating the LED light

To switch on the LED light (12):

- ◆ Switch the main power switch (1) to the inflate (c fig. E) or the pump (a fig. E) position.
- ◆ Press either of the - or + buttons (21, 23) on the LCD (2) to turn the LED light (12) on.

To switch the LED light (12) off:

- ◆ Press either of the - or + buttons (21, 23) again.
- ◆ Turn the main power (1) switch to off.

Sleep mode to preserve battery life

The unit is fitted with a sleep mode function that will help prolong the life of the internal battery.

If the unit is left on and unused for more than two minutes the unit will switch into sleep mode.

- ◆ To power the unit again either switch the main power switch (1) on and off or press any button on the LCD (2).

Note: After sleep mode, all settings will be lost and will need to be re-entered following the instructions under the heading 'Setting the required pressure'.

Maintenance

Your Black & Decker corded/cordless appliance/tool has been designed to operate over a long period of time with a minimum of maintenance. Continuous satisfactory operation depends upon proper appliance/tool care and regular cleaning.

Warning! Before performing any maintenance on corded/cordless appliance/tool:

- ◆ Switch off and unplug the appliance/tool.
- ◆ Or switch off and remove the battery from the appliance/tool if the appliance/tool has a separate battery pack.
- ◆ Unplug the charger before cleaning it. Your charger does not require any maintenance apart from regular cleaning.
- ◆ Regularly clean the ventilation slots in your appliance/tool/charger using a soft brush or dry cloth.
- ◆ Regularly clean the housing using a damp cloth. Do not use any abrasive or solvent-based cleaner.
- ◆ Regularly open the chuck and tap it to remove any dust from the interior (when fitted).

Troubleshooting

Problem	Possible cause	Possible solution
Inflator will not operate.	Internal battery fault.	Recharge the battery.
	12 Vdc adapter not connected.	Connect the 12 Vdc adapter.
	Accessory socket not live.	Turn key to accessory position
	Main ON/OFF switch not in correct position.	Turn main switch to required position.
	No preset value set.	Set preset value.
Will not inflate.	The fuse in the 12 Vdc adapter is blown.	Replace the fuse with one of the same size and type (8A/250V).
	Cord or switch is damaged.	Have the cord or switch replaced at a Black & Decker Service Centre or Authorised Service Centre.
	Incorrect mode selected.	Select correct mode.
LCD not illuminated.	Unit in sleep mode.	Press any button on LCD or the main on/off switch.

Replacing the fuse in the vehicle dc accessory plug

- ◆ Remove the cap by turning it counter-clockwise.
- ◆ Remove the cap and centre pin.
- ◆ Remove the fuse.
- ◆ Fit a new fuse of the same type and size (8A/250V).
- ◆ Refit the cap and centre pin.
- ◆ Tighten the cap by turning clockwise onto the plug.

Protecting the environment



Separate collection. This product must not be disposed of with normal household waste.

Should you find one day that your Black & Decker product needs replacement, or if it is of no further use to you, do not dispose of it with household waste. Make this product available for separate collection.



Separate collection of used products and packaging allows materials to be recycled and used again. Re-use of recycled materials helps prevent environmental pollution and reduces the demand for raw materials.

Local regulations may provide for separate collection of electrical products from the household, at municipal waste sites or by the retailer when you purchase a new product.

Black & Decker provides a facility for the collection and recycling of Black & Decker products once they have reached the end of their working life. To take advantage of this service please return your product to any authorised repair agent who will collect them on our behalf.

You can check the location of your nearest authorised repair agent by contacting your local Black & Decker office at the address indicated in this manual. Alternatively, a list of authorised Black & Decker repair agents and full details of our after-sales service and contacts are available on the Internet at: **www.2helpU.com**.

Technical data

ASI500 H1	
Input voltage	Vdc 12
Input current	A 8
SLA (sealed led acid)	Ah 3.2
Pressure (max)	PSI / BAR / KPA 160 / 11.03 / 1103
Weight	kg 3.03

Charger	
Input	Vac 230
Output	Vdc 12
Output current	A 1

Guarantee

Black & Decker is confident of the quality of its products and offers an outstanding guarantee. This guarantee statement is in addition to and in no way prejudices your statutory rights. The guarantee is valid within the territories of the Member States of the European Union and the European Free Trade Area.

If a Black & Decker product becomes defective due to faulty materials, workmanship or lack of conformity, within 24 months from the date of purchase, Black & Decker guarantees to replace defective parts, repair products subjected to fair wear and tear or replace such products to make sure of the minimum inconvenience to the customer unless:

- ◆ The product has been used for trade, professional or hire purposes.
- ◆ The product has been subjected to misuse or neglect.
- ◆ The product has sustained damage through foreign objects, substances or accidents.
- ◆ Repairs have been attempted by persons other than authorised repair agents or Black & Decker service staff.

To claim on the guarantee, you will need to submit proof of purchase to the seller or an authorised repair agent. You can check the location of your nearest authorised repair agent by contacting your local Black & Decker office at the address indicated in this manual. Alternatively, a list of authorised Black & Decker repair agents and full details of our after-sales service and contacts are available on the Internet at:

www.2helpU.com

Please visit our website **www.blackanddecker.co.uk** to register your new Black & Decker product and to be kept up to date on new products and special offers. Further information on the Black & Decker brand and our range of products is available at **www.blackanddecker.co.uk**.

Partial support - Only parts shown available
Nur die aufgeführten teile sind lieferbar
Reparation partielle - Seules les pieces indiquees sont disponibles
Supporto parziale - Sono disponibili soltanto le parti evidenziate
Solo estan disponibles las peizas listadas
So se encontram disponiveis as pecas listadas
Gedeeltelijke ondersteuning - alleen de getoonde onderdelen
zijn beschikbaar

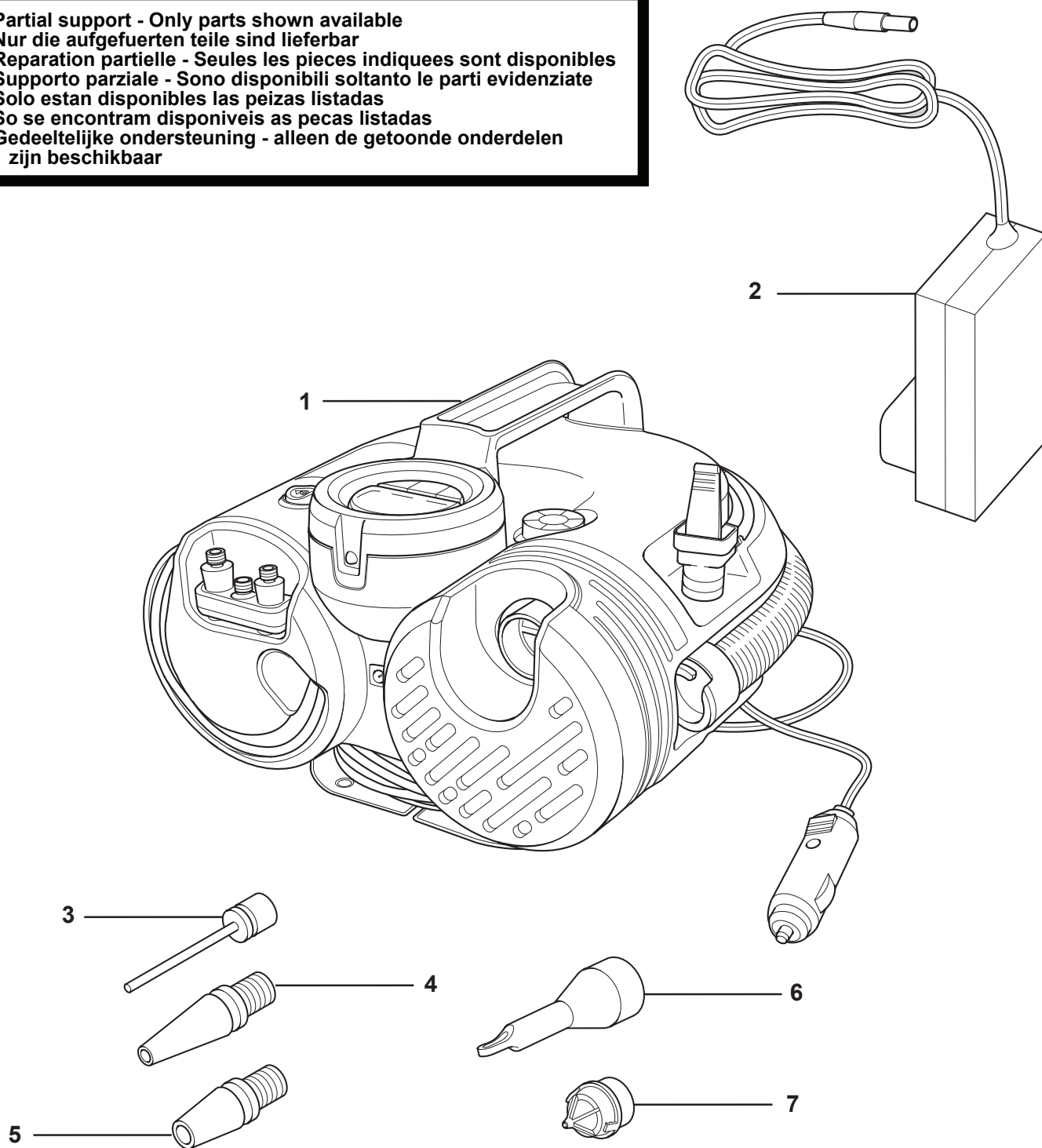

Australia

Black & Decker (Australia) Pty. Ltd.
20 Fletcher Road, Mooroolbark,
Victoria, 3138

Tel. 03-8720 5100
Fax 03-9727 5940

New Zealand

Black & Decker
5 Te Apunga Place
Mt Wellington
Auckland 1060

Tel. +64 9 259 1133
Fax +64 9 259 1122

United Kingdom

Black & Decker
210 Bath Road
Slough, Berkshire SL1 3YD

Tel. 01753 511234
Fax 01753 551155
Helpline 01753 574277