

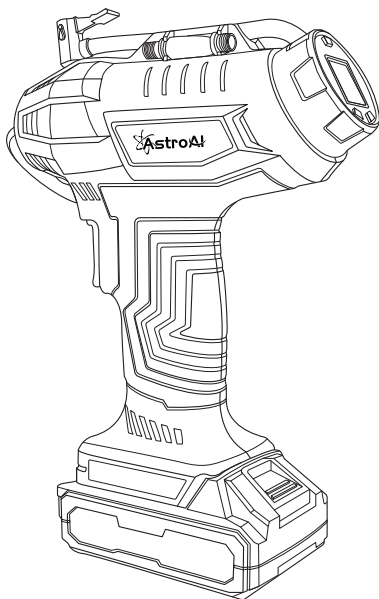

Portable Tire Inflator Air Compressor User Manual



Model : JY16P160 - 18

- V1.1 -

Thank you for purchasing Portable Tire Inflator Air Compressor from AstroAI. This Air Compressor is compatible with the Lithium battery pack and DC 12V power supply. This Portable Air Compressor can not only fulfill inflation for regular tires but also small inflatable objects. The Lithium battery pack is equipped with a 5V USB charge port, which can be used as a portable power supply to charge your electronic devices. The Air Compressor will automatically shut off when it reaches the pre-set pressure (please make sure the pressure you set is higher than the current pressure of your tire), and please note that your previous pre-set pressure value will be reserved for your next inflation, therefore it is vital to remember the value. For optimal performance and safety, please read and follow all of the instructions below before operating the device. Please keep this manual for future reference. We hope you enjoy your new Air Compressor!

Thank you again for choosing AstroAI, if you have any questions or concerns regarding your product, please contact us at support@astroai.com.

WARNING ///

- Please read the instructions carefully before use. Incorrect usage may damage the product.
- Please pay attention to electricity safety when using.
- Ensure the remaining battery of the Lithium battery pack can fulfill objects.
- Check the preset pressure value before use. The preset pressure value should match the object to be inflated.
- Please do not use this product in the rain or where there are any liquids.
- Keep out of reach of children, if there are children nearby make sure they are properly supervised.
- Keep the device away from fire, corrosive gases, liquids, and strong magnetic fields.
- Do not aim the nozzle at people or any part of a human body.
- Contains small accessories which are a choking hazard for young children.
- Risk of electric shock, do not use air compressor if it is damaged or if the wires are exposed.
- Do not use it on a 24V car power. Connect the air compressor to a 12V DC, 15A cigarette lighter. Use an AC to DC power converter if you want to use AC power.
- Avoid extended and continuous use. The optimum time for continuous use is 20 minutes.
- After extended use, let the air compressor rest for 10 minutes before using it again.
- Do not store the air compressor in high-temperatures or in a humid environment.
- When not in use, disconnect the air compressor from all power sources.
- Suitable for vehicles, SUVs, cars, motorcycles, bicycles, decorative balloons and other objects that need to be inflated, etc. Not suitable for RVs, trucks and other large size objects.

- Do not over-inflate tires. High pressure air can cause injury.
- Move the product by using the handle. Do not drag the air compressor by pulling the power cord or the hose.
- During use, do not touch any parts of the air compressor apart from the switch and handle. The air compressor gets hot during use and stays hot for some time after.
- Do not use chemical reagents to clean the air compressor. Only use mild soap and a cloth dipped in hot water to clean the plastic parts.
- The Lithium battery pack should be used in a clean, dry, well-ventilated place, please keep the air compressor away from fire, heat, and corrosive liquid.
- The Lithium battery pack should be charged in time after discharge, the discharge of the used battery may cause low battery or even battery damage, therefore you must use a suitable charger to charge in time.
- The Lithium battery pack is designed for emergency conditions only, it should not be used as a regular power supply.
- To avoid damage, please do not charge your electronic devices when the air compressor is pumping.

DIAGRAM

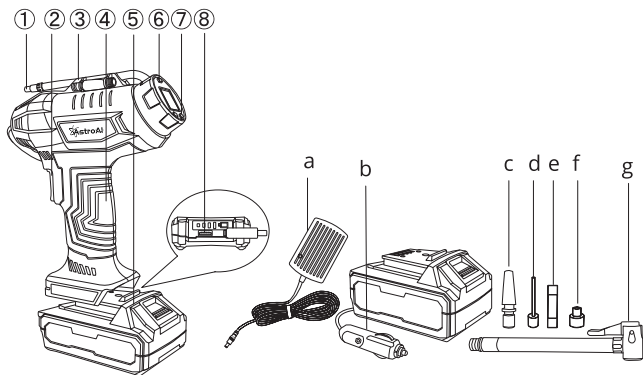

① Schrader rotation adapter

② Trigger

③ Inflatable hose storage

④ handing

⑤ 2.0AH Lithium battery pack

⑥ Unit/Power button

⑦ ' - 'button and ' + ' button

⑧ 5V USB Charge Port

a 1.8m Power Charger

b 12V DC Plug

c Tapered Adapter

d Needle Valve Adapter

e Replacement Fuse

f Valve Extender

g Extension hose coupling

OPERATION INSTRUCTIONS //

TWO TYPES OF POWER SUPPLY

- Start your vehicle's engine before use and firmly plug the air compressor into your car's 12V outlet.
- Insert the Lithium battery pack into the bottom of air compressor.

TIRE INFLATION

- Insert the Lithium battery pack into the air compressor after it is fully charged or plug the cigarette lighter into your car's 12V outlet.

- Press the Unit/Power button to start the air compressor after power on.

- Press Unit button to choose suitable unit.



- Use the '+' and '-' buttons to set the chosen pressure. Use the tire pressure guide on the inside of the driver's door for guidance. Make sure that the preset pressure is higher than the current pressure of your tire.

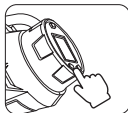

- Remove the valve cap from the valve stem of the tire, connect the quick connector or air nozzle to the valve stem. (Tips : for better sealing, when using the quick connector, align the valve stem, firmly press in, and flip the small lever.)

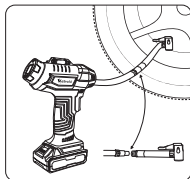

- Press the trigger button to start inflating, the air compressor automatically shuts off when the pre-set pressure value is reached.



- Long press the Unit button to turn off the air compressor after inflation. When not in use for a long time, please remove the Lithium battery pack on the bottom in case of any mistaken touch.

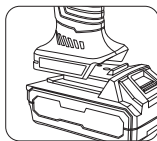

THE INSTALLMENT AND REMOVAL OF THE LITHIUM BATTERY PACK

- Push the battery through the battery slot to the left until it fits, the battery is successfully installed.



- Hold the handle and press the button above the battery to remove the battery.

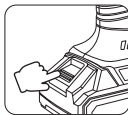

CHARGING METHOD OF THE LITHIUM BATTERY PACK

- Connect the power charger to the Round hole jack on the top of the Lithium battery pack, plug the power charger; when the LED lights up it means it is charging.

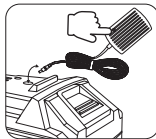

- Press the power button to know the remaining battery of the Lithium battery pack, the lights will be lit for seconds only.

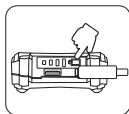

THE 5V POWER SUPPLY METHOD OF LITHIUM BATTERY PACK

- The Lithium battery pack is suitable for charging your low battery electronic devices (such as smartphones or i-pad). If the Lithium battery pack is short in power, please charge it as soon as possible instead of continuous use.

- Open the Silica gel charge port protector, insert the charger into the 5V USB charge port to charge your electronic devices.

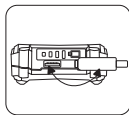

TROUBLESHOOTING //

I . AIR COMPRESSOR WILL NOT INFLATE

- Ensure the in-line fuse is securely inserted correctly; replace fuse if necessary.
- Check vehicle cigarette lighter fuse, it should be rated at 15A or higher.
- Ensure there is a strong connection with the power cord and 12V socket.
- The preset tire pressure lower than current tire pressure, increase the preset tire pressure to the manufacturer's recommended level.
- Ensure the Lithium battery pack is installed in the air compressor correctly.
- Ensure the Lithium battery pack is fully charged.
- Ensure the Trigger button is pressed.

II . AIR COMPRESSOR IS OPERATING ABNORMALLY

- The inflation nozzle is not connected properly to the tire's valve stem.
- The 12V socket is not connected securely.
- The preset tire pressure is lower than current tire pressure, increase the preset tire pressure to the manufacturer recommended level.
- Insufficient battery power, resulting in a dead battery during the process and stopping work.

III . AIR LEAKING THROUGH HOSE

- Ensure there is a firm connection between the air nozzle and the tire valve.

IV . SLOW INFLATION

- The inflation nozzle is not connected properly to the tire's valve stem.
- Excessive use will slow the inflation rate of the air compressor. Let cool for 10 minutes.

PRODUCT HIGHLIGHTS ///

- The power supply of the Lithium battery pack and DC 12V.
- Tire inflating function.
- Multi-purpose, not only suitable for vehicles, SUVs, cars, motorcycles, bicycles but also suitable for small size swim rings and basketballs.
- Power cut memory function will automatically record your last set.
- Automatic Shut off : The air compressor automatically shuts off when the pre-set pressure value is reached.
- LCD Digital Display : Provides accurate measurements. It is easy to operate, read and understand.
- Longer Power Cord : AC cord length 5.9 feet (1.8m)
DC cable length 9.84 feet (3m).
- Portable Design : Easy to carry and store in a car.
- Equipped with 5V 2.5A USB Charge Port.

SPECIFICATIONS ///

Working Voltage	DC 12V/18V Lithium battery pack
Maximum Power	150W

Inflating Speed	22 Liter/min
Maximum Working Pressure	160 PSI
Continuous Operating Time	20 minutes
Hose Length	19.7 in / 50 cm
Extension Hose Coupling	5.1 in /13 cm
Power Cable Length	DC 9.84 ft (3 m)
Power Charger Length	AC 5.9 ft (1.8m)
Battery Capacity	18V 2.0AH
Maximum voltage of the battery	20V
Dimensions	17 x 8 x 24 cm 6.7 x 3.2 x 9.5 in
USB Output Voltage	5V
USB Output Current	Maximum 2.5A

PACKAGE CONTENTS ///

- 1 x User Manual
- 1 x Inflation Needle
- 1 x Tapered Adapter

- 1 x Valve Extender
- 1 x Storage Bag
- 1 x Extension Hose Coupling
- 1 x 1.8m Power Charger
- 1 x Replacement Fuse
- 1 x 2.0AH Lithium Battery Pack
- 1 x AstroAI Portable Tire Inflator Air Compressor

2 YEAR WARRANTY, LIMITED WARRANTY FROM ASTROAI //

Each AstroAI Portable Air Compressor will be free from defects in material and workmanship. This warranty does not cover damage from neglect, misuse, contamination, alteration, accident, or abnormal conditions when operating or handling. This warranty covers the original purchaser only and is not transferable.

Questions or Concerns? We're happy to help!
support@astroai.com.



Web: www.astroai.com

E-mail: support@astroai.com