

# WORKPRO

## ORIGINAL SAFETY AND OPERATING INSTRUCTIONS 20V CORDLESS MINI CIRCULAR SAW

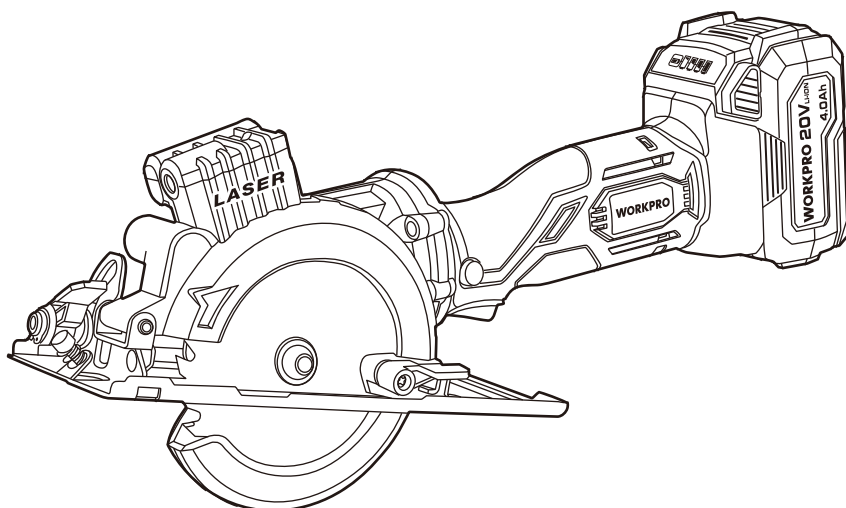

Thank you for buying a WORKPRO 20V CORDLESS MINI CIRCULAR SAW. Your new 20V CORDLESS MINI CIRCULAR SAW has been engineered and manufactured to WORKPRO's high standard for dependability, ease of operation, and operator safety. Properly cared for, it will give you years of rugged, trouble-free performance.



**WARNING:** To reduce the risk of injury, the user must read and understand the operator's manual.

**SAVE THIS MANUAL FOR FUTURE REFERENCE**



Distributed by  
Hangzhou GreatStar Industrial Co., Ltd.  
No.35 Jiuhuan Road, Jiubao Town,  
Hangzhou 310019, China  
[www.greatstartools.com](http://www.greatstartools.com)

Made in China

Fig. 1

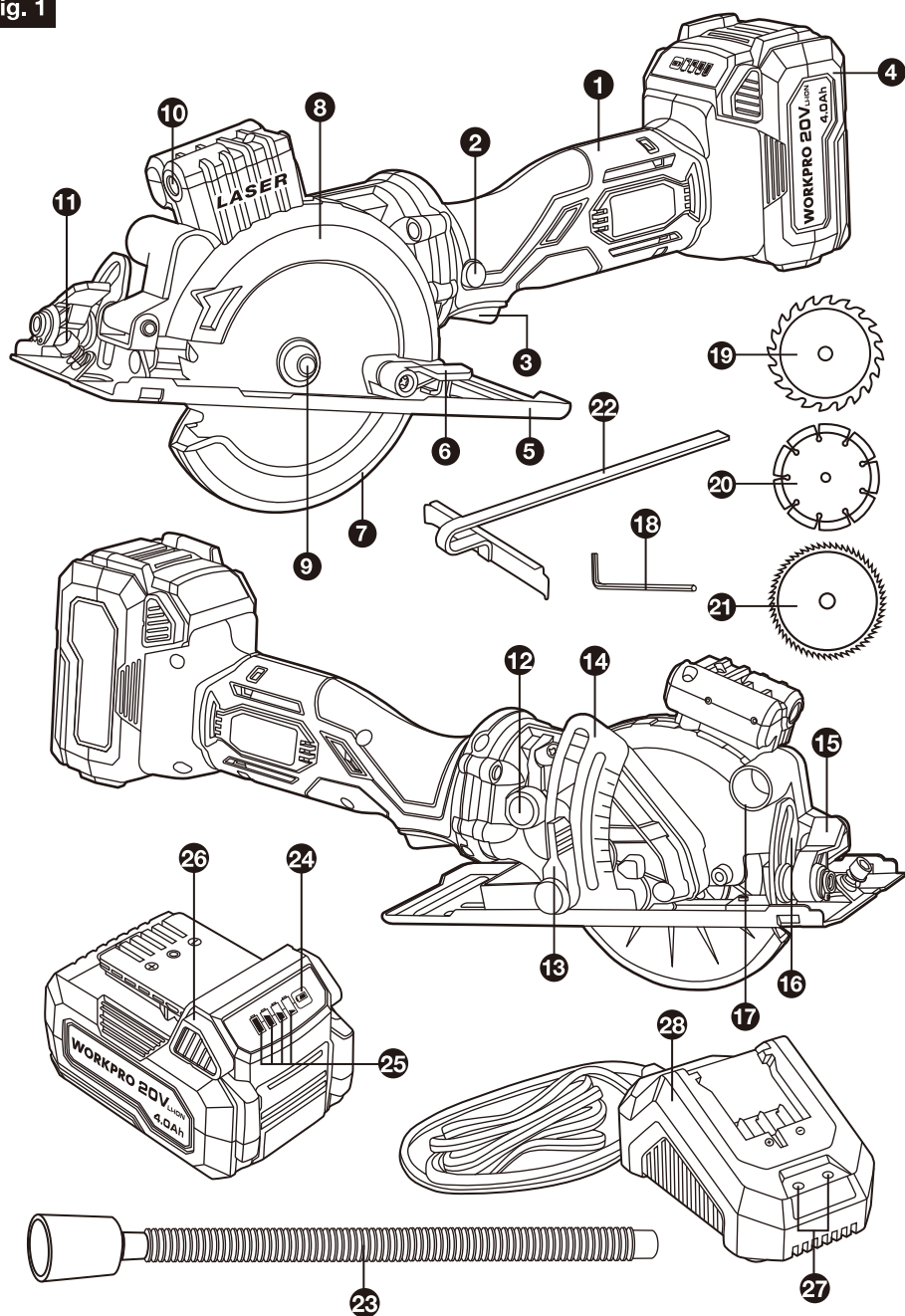

## Introduction

The device is designed for sawing wood, tiles, plastic, PVC and soft metals using the appropriate circular saw blades.

The device is intended for use by adults. Never allow people who are not familiar with the instructions or children to use the machine. Local regulations may specify an age limit for the user.

This product is not intended for commercial use. Generally acknowledged accident prevention regulations and enclosed safety instructions must be observed.

Only perform work described in these instructions for use. Any other use is improper. The manufacturer will not assume responsibility for damage resulting from such use.

 **WARNING:** Drilling, sawing, sanding or machining wood products can expose you to wood dust, a substance known to the State of California to cause cancer. Avoid inhaling wood dust or use a dust mask or other safeguards for personal protection. For more information go to [www.P65Warnings.ca.gov/wood](http://www.P65Warnings.ca.gov/wood).

## **Danger!**

When using the equipment, a few safety precautions must be observed to avoid injuries and damage. Please read the complete operating instructions and safety regulations with due care. Keep this manual in a safe place, so that the information is available at all times. If you give the equipment to any other person, hand over these operating instructions and safety regulations as well. We cannot accept any liability for damage or accidents which arise due to a failure to follow these instructions and the safety instructions.

## **1. General power tool safety warning**

### **Warning!**

**Read all safety warnings, instructions, illustrations and specifications provided with this power tool.** Failure to follow all instructions listed below may result in electric shock, fire and/or serious injury.

**Save all warnings and instructions for future reference.**

The term "power tool" in the warnings refers to your mains-operated (corded) power tool or battery-operated (cordless) power tool.

### **1) Work area safety**

- **Keep work area clean and well lit.** Cluttered or dark areas invite accidents.
- **Do not operate power tools in explosive atmospheres, such as in the presence of flammable liquids, gases or dust.** Power tools create sparks which may ignite the dust or fumes.
- **Keep children and bystanders away while operating a power tool.** Distractions can cause you to lose control.

### **2) Electrical safety**

- **Power tool plugs must match the outlet. Never modify the plug in any way.** Do not use any adapter plugs with earthed (grounded) power tools. Unmodified plugs and matching outlets will reduce risk of electric shock.
- **Avoid body contact with earthed or grounded surfaces, such as pipes, radiators, ranges and refrigerators.** There is an increased risk of electric shock if your body is earthed or grounded.
- **Do not expose power tools to rain or wet conditions.** Water entering a power tool will increase the risk of electric shock.
- **Do not abuse the cord. Never use the cord for carrying, pulling or unplugging the power tool.** Keep cord away from heat, oil, sharp edges or moving parts. Damaged or entangled cords increase the risk of electric shock.

- **When operating a power tool outdoors, use an extension cord suitable for outdoor use.** Use of a cord suitable for outdoor use reduces the risk of electric shock.
- **If operating a power tool in a damp location is unavoidable, use a residual current device (RCD) protected supply.** Use of an RCD reduces the risk of electric shock.

### **3) Personal safety**

- **Stay alert, watch what you are doing and use common sense when operating a power tool.** Do not use a power tool while you are tired or under the influence of drugs, alcohol or medication. A moment of inattention while operating power tools may result in serious personal injury.
- **Use personal protective equipment. Always wear eye protection.** Protective equipment such as a dust mask, non-skid safety shoes, hard hat or hearing protection used for appropriate conditions will reduce personal injuries.
- **Prevent unintentional starting. Ensure the switch is in the off-position before connecting to power source and/or battery pack, picking up or carrying the tool.** Carrying power tools with your finger on the switch or energising power tools that have the switch on invites accidents.
- **Remove any adjusting key or wrench before turning the power tool on.** A wrench or a key left attached to a rotating part of the power tool may result in personal injury.
- **Do not overreach.** Keep proper footing and balance at all times. This enables better control of the power tool in unexpected situations.
- **Dress properly.** Do not wear loose clothing or jewellery. Keep your hair and clothing away from moving parts. Loose clothes, jewellery or long hair can be caught in moving parts.
- **If devices are provided for the connection of dust extraction and collection facilities, ensure these are connected and properly used.** Use of dust collection can reduce dust-related hazards.
- **Do not let familiarity gained from frequent use of tools allow you to become complacent and ignore tool safety principles.** A careless action can cause severe injury within a fraction of a second.

### **4) Power tool use and care**

- **Do not force the power tool.** Use the correct power tool for your application. The correct power tool will do the job better and safer at the rate for which it was designed.
- **Do not use the power tool if the switch does not turn it on and off.** Any power tool that cannot be controlled with the switch is dangerous and must be repaired.

- **Disconnect the plug from the power source and/or remove the battery pack, if detachable, from the power tool before making any adjustments, changing accessories, or storing power tools.** Such preventive safety measures reduce the risk of starting the power tool accidentally.
- **Store idle power tools out of the reach of children and do not allow persons unfamiliar with the power tool or these instructions to operate the power tool.** Power tools are dangerous in the hands of untrained users.
- **Maintain power tools and accessories. Check for misalignment or binding of moving parts, breakage of parts and any other condition that may affect the power tool's operation.** If damaged, have the power tool repaired before use. Many accidents are caused by poorly maintained power tools.
- **Keep cutting tools sharp and clean.** Properly maintained cutting tools with sharp cutting edges are less likely to bind and are easier to control.
- **Use the power tool, accessories and tool bits etc.** In accordance with these instructions, taking into account the working conditions and the work to be performed. Use of the power tool for operations different from those intended could result in a hazardous situation.
- **Keep handles and grasping surfaces dry, clean and free from oil and grease.** Slippery handles and grasping surfaces do not allow for safe handling and control of the tool in unexpected situations.

## 5) Service

- Have your power tool serviced by a qualified repair person using only identical replacement parts. This will ensure that the safety of the power tool is maintained.

## 6) Battery tool use and care

- a. Ensure the switch is in the off position before inserting battery pack. Inserting the battery pack into power tools that have the switch on invites accidents.
- b. Recharge only with the charger specified by the manufacturer. A charger that is suitable for one type of battery pack may create a risk of fire when used with another battery pack.
- c. Use power tools only with specifically designated battery packs. Use of any other battery packs may create a risk of injury and fire.

- d. When battery pack is not in use, keep it away from other metal objects like paper clips, coins, keys, nails, screws, or other small metal objects that can make a connection from one terminal to another.  
Shorting the battery terminals together may cause burns or a fire.
- e. Under abusive conditions, liquid may be ejected from the battery; avoid contact. If contact accidentally occurs, flush with water. If liquid contacts eyes, additionally seek medical help. Liquid ejected from the battery may cause irritation or burns.

## ADDITIONAL SAFETY INSTRUCTIONS FOR THE CHARGER

Your WORKPRO tool with Lithium Ion batteries may only be charged with the specific designed WORKPRO Lithium Ion battery charger purchased with the tool.

**IT IS DANGEROUS TO USE ANY OTHER BATTERY CHARGER TO CHARGE YOUR TOOL.** Do not attempt to charge the battery pack with any other charger than the one supplied.

Before using the charger, read all the instructions, labels and cautionary markings on the charger and battery pack as well as the instructions on using the battery pack.

Do not use the charger if it has been subjected to a heavy knock, dropped or otherwise damaged in anyway. Take the charger to an authorised service centre for a check or repair.

Do not disassemble the charger. Opening or removing covers may expose you to dangerous voltages or other risks. Incorrect reassembly can cause electric shock when you use the tool or charger again. Take the charger to a power tool repair centre when service or repair is required.

 **DANGER.** If the battery pack is cracked or damaged in any other way, do not insert it in the charger.

Do not plug anything other than your WORKPRO tool into the charger, as other objects may touch dangerous voltage points or short out parts, which could result in fire or electric shock.

Do not place the tool or charger on an uneven surface, as a fall may cause serious damage.

Never place the tool or charger near or over a heat source such as a radiator or heater.

Do not operate the charger in a cabinet or other enclosure unless proper ventilation is provided.

Use the battery charger indoors only.

## **WARNING!**

Do not allow any liquid to come into contact with the charger. There is a danger of electric shock. Do not position the tool or battery charger near water; for example, near a sink, wash bowl or toilet. Do not spill liquid of any kind on the tool or charger. Doing so may short out parts, causing damage to the product and creating the risk of fire or electric shock.

To reduce the risk of an electric shock, unplug the charger from the power supply before attempting to clean it. To clean tool or charger, wipe with a damp cloth. Use of any other cleaners is not recommended.

Do not place any object on to, or allow anything to rest on the charger.

Make sure that the charger cable is positioned where it will not be stepped on, tripped over or otherwise subjected to damage or stress. Keep the lead away from operating machinery.

Do not pull on the lead of the charger to disconnect it from the mains power socket.

Do not use an extension cord unless it is absolutely necessary. The use of an improper extension cord could cause the risk of fire, electric shock or electrocution.

Never attempt to connect two chargers together.

Do not charge batteries or use the tool and battery pack in locations where the temperature may be below 40°F(4°C) or exceed 104°F(40°C) such as alongside sheds or metal structures.

If you wish to charge a second battery pack, unplug the charger from the mains supply and leave it for at least 15 minutes. After this time you can charge a second battery pack.

## **ADDITIONAL SAFETY INSTRUCTIONS RELATED TO THE BATTERY PACK AND BATTERY SAFETY**

Use only the WORKPRO batteries supplied with the WORKPRO Tool or WORKPRO-approved replacements.

Do not use the battery to power any device other than the WORKPRO tool it was sold with.

Charge the battery only with the WORKPRO charger supplied with the tool or WORKPRO-approved replacements and according to the instructions in the WORKPRO Instruction Manual.

Do not charge the battery in a place where static electricity is generated nor let the battery touch something that is statically charged.

The battery can be stored at temperatures between 40°F(4°C) and 104°F(40°C).

Never store or leave your lithium ion battery in temperatures over that recommended otherwise fire may occur.

DO NOT store the Lithium Ion battery anywhere that the temperature can easily reach higher temperatures than recommended -this includes garden type sheds, and Vehicles where the inside temperature can climb to dangerous levels in the direct sunlight and on high temperature days. **THINK BEFORE LEAVING YOUR LITHIUM ION BATTERY PACK IN STORAGE.**

The battery can be charged or operated at temperatures between 40°F(4°C) and 104°F(40°C). **NEVER CHARGE YOUR LITHIUM ION BATTERY BELOW OR ABOVE TEMPERATURES RECOMMENDED OTHERWISE FIRE OR SERIOUS DAMAGE TO THE BATTERY PACK MAY OCCUR.**

The most suitable temperatures to charge the battery pack are between 68°F(20°C) -77°F(25°C).

Always allow the battery pack to cool down after charging, do not place it in a hot environment such as a metal shed or open trailer left in the sun.

Take care where the tool is stored. Do not store in areas of corrosive fumes, or salt air or similar conditions. Try and store the tool in the packaging supplied with the tool.

Do not dispose of the battery in a fire or put the battery into a microwave oven, conventional oven, dryer, or high-pressure container. Under these conditions, the battery may explode.

Never attempt to open the battery pack, puncture the battery or subject the battery to strong physical shock.

If the plastic housing of the battery pack breaks open or cracks, immediately discontinue its use and do not recharge it. Ensure the battery pack clip is in good condition and will not allow the pack to fall free from the tool. If the clip is damaged or for any reason is not locking the pack in place, Do Not continue to use.

Stop using the battery if it exhibits abnormal heat, odour, colour, deformation, or is in an abnormal condition.

If you detect leakage or a foul odour, it is especially important to keep the battery away from fire. If battery liquid leaks onto your skin or clothes, wash well with clean water immediately. If liquid leaking from the battery gets into your eyes, do not rub your eyes. Rinse your eyes well (for at least 10 minutes) with clean water, and consult a doctor immediately.

Do not use a leaking battery.

Handle batteries with care to avoid shorting the battery with conducting materials, such as nails, screws, metal watch bands, rings, bracelets, and keys. The battery may overheat and could burn you.

After the battery has reached the end of its useful life, we recommend recycling the materials at your local municipal council recycling centre. DO NOT attempt to replace the battery cells in the battery pack, repair or modify any part of the battery pack assembly.

When recycling, make it nonconductive by applying insulating tape to the terminals located on the battery.

### **WHEN TO CHARGE THE BATTERY**

New batteries are shipped in a low charged condition and should be fully charged before Use. The battery pack can be recharged at any time during use, provided the pack is not overheated.

If the battery pack starts to cut out due to low voltage, or previous tasks undertaken can no longer be performed, it is suggested to stop using the tool and recharge the battery.

For storage, it is suggested to recharge the battery between 50% and 75% charge.

Charge the device at least once in 3-6 months to preserve battery life span.

## **2. 20V CORDLESS MINI CIRCULAR SAW WARNINGS**

**⚠ DANGER:** Keep hands away from cutting area and the blade. If both hands are holding the saw, they cannot be cut by the blade.

- Do not reach underneath the workpiece. The guard can not protect you from the blade below the workpiece.
  - Adjust the cutting depth to the thickness of the workpiece. Less than a full tooth of the blade teeth should be visible below the workpiece.
  - Never hold the workpiece in your hands or across your leg while cutting. Secure the workpiece to a stable platform. It is important to support the work properly to minimize body exposure, blade binding, or loss of control.
  - Hold the power tool by insulated gripping surfaces, when performing an operation where the cutting tool may contact hidden wiring. Contact with a "live" wire will also make exposed metal parts of the power tool "live" and could give the operator an electric shock.
  - When ripping, always use a rip fence or straight edge guide. This improves the accuracy of cut and reduces the chance of blade binding.
  - Always use blades with correct size and shape (diamond versus round) of arbour holes. Blades that do not match the mounting hardware of the saw will run off-centre, causing loss of control.
  - Never use damaged or incorrect blade washers or bolt. The blade washers and bolt were specially designed for your saw, for optimum performance and safety of operation.
- jammed or misaligned saw blade, causing an uncontrolled saw to lift up and out of the workpiece toward the operator;
- When the blade is pinched or jammed tightly by the kerf closing down, the blade stalls and the motor reaction drives the unit rapidly back toward the operator;
  - If the blade becomes twisted or misaligned in the cut, the teeth at the back edge of the blade can dig into the top surface of the wood causing the blade to climb out of the kerf and jump back toward the operator.
  - Kickback is the result of saw misuse and/or incorrect operating procedures or conditions and can be avoided by taking proper precautions as given below:
  - Maintain a firm grip with both hands on the saw and position your arms to resist kickback forces. Position your body to either side of the blade, but not in line with the blade. Kickback could cause the saw to jump backwards, but kickback forces can be controlled by the operator, if proper precautions are taken.
  - When blade is binding, or when interrupting a cut for any reason, release the trigger and hold the saw motionless in the material until the blade comes to a complete stop. Never attempt to remove the saw from the work or pull the saw backward while the blade is in motion or kickback may occur. Investigate and take corrective actions to eliminate the cause of blade binding.
  - When restarting a saw in the workpiece, centre the saw blade in the kerf and check that saw teeth are not engaged into the material. If a saw blade binds, it may walk up or kickback from the workpiece as the saw is restarted.
  - Support large panels to minimise the risk of blade pinching and kickback. Large panels tend to sag under their own weight. Supports must be placed under the panel on both sides, near the line of cut and near the edge of the panel.
  - Do not use dull or damaged blades. Unsharpened or improperly set blades produce narrow kerf causing excessive friction, blade binding and kickback.
  - Blade depth and bevel adjusting locking levers must be tight and secure before making cut. If blade adjustment shifts while cutting, it may cause binding and kickback.
  - Use extra caution when sawing into existing walls or other blind areas. The protruding blade may cut objects that can cause kickback.

### **KICKBACK CAUSES AND RELATED WARNINGS**

- Kickback is a sudden reaction to a pinched,

### **LOWER GUARD FUNCTION**

- Check lower guard for proper closing before each



use. Do not operate the saw if lower guard does not move freely and close instantly. Never clamp or tie the lower guard into the open position. If saw is accidentally dropped, lower guard may be bent. Raise the lower guard with the retracting handle and make sure it moves freely and does not touch the blade or any other part, in all angles and depths of cut.

- Check the operation of the lower guard spring. If the guard and the spring are not operating properly, they must be serviced before use. Lower guard may operate sluggishly due to damaged parts, gummy deposits, or a build-up of debris.
- The lower guard may be retracted manually only for special cuts such as “plunge cuts” and “compound cuts.” Raise the lower guard by retracting handle and as soon as blade enters the material, the lower guard must be released. For all other sawing, the lower guard should operate automatically.
- Always observe that the lower guard is covering the blade before placing saw down on bench or floor. An unprotected, coasting blade will cause the saw to walk backwards, cutting whatever is in its path. Be aware of the time it takes for the blade to stop after switch is released.

### ADDITIONAL SAFETY WARNINGS

- Use clamps or other practical way to secure and support the workpiece to a stable platform. Holding the work by hand or against your body is unstable and may lead to loss of control.
- Always wear eye protection with side shields marked to comply with ANSI Z87.1 when assembling parts, operating the tool, or performing maintenance. Following this rule will reduce the risk of serious personal injury.
- Protect your lungs. Wear a face or dust mask if the operation is dusty. Following this rule will reduce the risk of serious personal injury.
- Protect your hearing. Wear hearing protection during extended periods of operation. Following this rule will reduce the risk of serious personal injury.
- Battery tools do not have to be plugged into an electrical outlet; therefore, they are always in operating condition. Be aware of possible hazards when not using your battery tool or when changing accessories. Following this rule will reduce the risk of electric shock, fire, or serious personal injury.
- Do not place battery tools or their batteries near fire or heat. This will reduce the risk of explosion and possibly injury.
- Do not crush, drop or damage battery pack. Do not use a battery pack or charger that has been

dropped or received a sharp blow. A damaged battery is subject to explosion. Properly dispose of a dropped or damaged battery immediately.

- Batteries can explode in the presence of a source of ignition, such as a pilot light. To reduce the risk of serious personal injury, never use any cordless product in the presence of open flame. An exploded battery can propel debris and chemicals. If exposed, flush with water immediately.
- Do not charge battery tool in a damp or wet location. Do not use, store, or charge battery packs or products in locations where the temperature is less than 50°F or more than 100°F. Do not store outside or in vehicles.
- Under extreme usage or temperature conditions, battery leakage may occur. If liquid comes in contact with your skin, wash immediately with soap and water. If liquid gets into your eyes, flush them with clean water for at least 10 minutes, then seek immediate medical attention. Following this rule will reduce the risk of serious personal injury.
- Save these instructions. Refer to them frequently and use them to instruct others who may use this tool. If you loan someone this tool, loan them these instructions also.

### 3. Symbols

Danger notices and information are clearly marked throughout these instructions for use. The following symbols are used:



**Hazard** symbols with information on prevention of personal injury and property damage.



**Precaution** symbol with information on prevention of harm / damage.



**Notice** symbol with information on how to handle the device properly.



Double insulated for additional protection.



Do not expose to rain or water



Do not burn



Read these operating instructions well before you use the tool.



Protect the tool from the damp and never expose it to rain

These symbols identify the required personal protection equipment:



Wear safety goggles





Wear ear defenders



Wear safety shoes



Wear protective gloves



Wear close-fitting work clothes

## 4. Know your product

- 1.Main handle
- 2.Safety lock off switch
- 3.ON / OFF switch
- 4.Battery pack
- 5.Base plate
- 6.Saw blade retractable safety guard control knob
- 7.Saw blade retractable safety guard
- 8.Fixed upper guard
- 9.Hex nut
- 10.Laser
- 11.Parallel guide locking bolt
- 12.Spindle lock button
- 13.Depth locking knob
- 14.Cutting depth scale
15. Angle locking knob
16. Cutting angle scale
- 17.Dust extraction port
- 18.Hex key
- 19.TCT blade
- 20.Diamond blade
- 21.60T blade
- 22.Parallel guide
- 23.Dust tube
- 24.Battery capacity indicator switch
25. Battery capacity indicator
26. Battery pack release button
27. Control light
28. Battery charger

## 5. TECHNICAL DATA

<b>MODEL NO.</b>	<b>W125230A</b>
<b>20V CORDLESS MINI CIRCULAR SAW</b>	
No load speed	4500rpm
Blade size	4-1/2 inch(115mm)
Arbor size	3/8 inch (9.5mm)
Max. Cutting Depth	90°: 1-11/16inch(42.8mm)
	45°: 1-1/8 inch(28mm)
Bare tool weight	4.58 lbs (2.08Kg)

### BATTERY CHARGER

Rated voltage	120V~, 50-60 Hz
Rated power	70W
Charge voltage	20 V
Charge current	2.4 A
Protection class	□ / II

### BATTERY PACK

Battery pack type	Li-Ion
Rated voltage	Maximum 20 V
	Nominal 18 V
Capacity	4000 mAh
Charging time	2H

### NOTE:

- The declared vibration total value has been measured in accordance with a standard test method and may be used for comparing one tool with another.
- The declared vibration total value may also be used in a preliminary assessment of exposure.

### Warning:

- The vibration emission during actual use of the power tool can differ from the declared total values depending on the ways in which the tool is used.
- Be sure to identify safety measures to protect the operator that are based on an estimation of exposure in the actual conditions of use (taking account of all parts of the operating cycle such as the times when the tool is switched off and when it is running idle in addition to the trigger time).

## 6. ASSEMBLY

Only insert the rechargeable battery once the device is completely assembled. If the device is switched on accidentally, there is a danger of injury.

### 1) Changing blade (see FIG A,B,C)

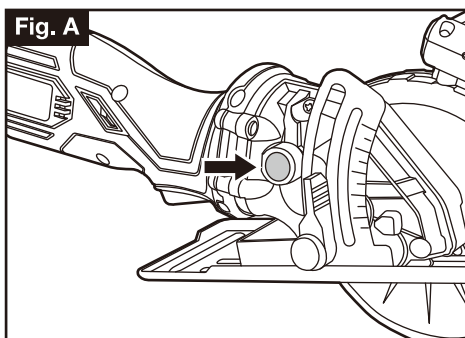

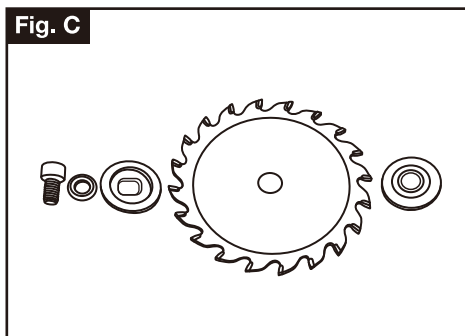
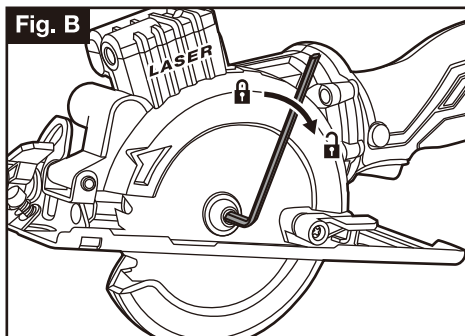

The mounting hole of blade must fit with the mounting flange.

Do not use reducers or adapters.

The direction-of-rotation arrow on blade and machine should be same.

Press the spindle-lock button in deep and hold it in this position continuously, insert the Hex key provided into the blade bolt, turn the spindle slightly with the free hand until it locks into position, remove the blade bolt, washer, outer flange and blade from spindle.

Put new blade between two parts of flange, place the washer and screw in position and then tighten blade bolt with hex key provided.

### **⚠ CAUTION!**

Never use blade whose diameter is larger than that indicated.

The maximum rotation speed of blade must be greater than the idling speed of the machine.

Blade teeth are very sharp and wear gloves. For best cutting results ensure you use a saw blade suited to the material and cut quality you need.

Check the blade regularly during use. If it has been jammed or is deformed, replace it!

## **2) Using the Parallel Guide(see FIG D,E)**

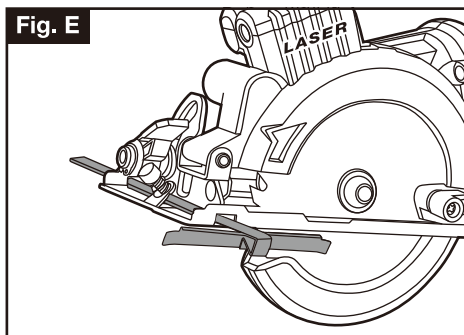
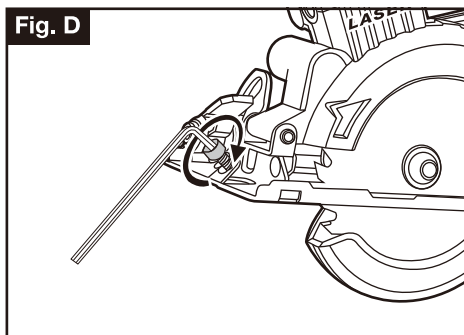

The parallel guide can be used for making cuts parallel to a work piece edge at a chosen distance.

To set the cutting width, slide the guide arm through the slot and rotate the knob to the required width.

Then lock the guide in place.

**⚠ NOTE:** If the distance between the side of the work piece and the cutting position is too wide, or the side of the work piece is not straight, firmly clamp a straight board to the work piece and use this as a guide.

## **3) Adjusting the cutting depth (see FIG F)**

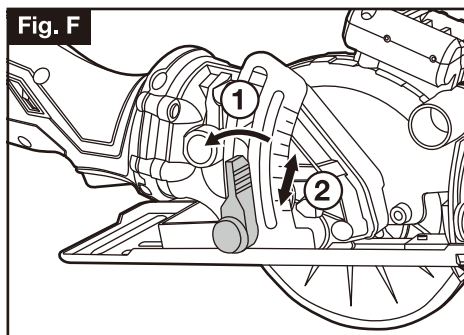

For optimal quality of cutting, the saw blade should not extend more than 3 mm below the workpiece.  
To adjust the cutting depth (0-42.8mm), please follow below steps:

- Loosen the depth locking knob by hand.
- Raise/lower the locking knob and set the blade to the required depth - as shown on the cutting depth scale.
- Tighten the depth locking knob.

**⚠ CAUTION!**

Always check the locking lever before working. A loose locking lever may cause serious injury.

**4) Adjusting the cutting angle (see FIG G)**

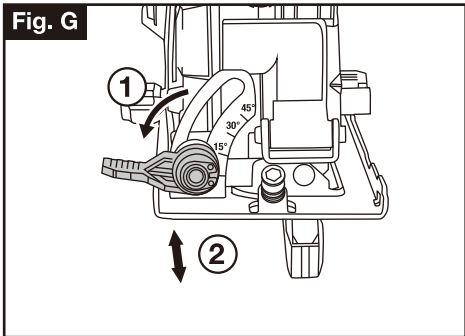

To adjust the cutting angle (0-45°), please follow below steps:

- Loosen the angle locking knob by hand.
- Raise/lower the locking knob and set the blade to the required angle as shown on the cutting angle scale.
- Tighten the angle locking knob.

**⚠ NOTE:** The location of the blade cut-line will change depending on the bevel angle that is being used. The blade cut-line location when cutting at 0 degrees or 45 degrees is marked with a notch on the front of the base plate.

The base plate must always be held firmly against the material being cut to reduce saw vibration, blade jumping, or blade breakage.

**5) Dust collecting (see FIG H)**

Use of dust collection can reduce dust-related hazards. To prevent personal injuries, make sure to connect a suitable vacuum cleaner to the dust extraction port by means of the dust collecting system adaptor.

To connect a dust collection system, fit the dust adaptor to the dust extraction port.

Connect the vacuum cleaner to the dust extraction port with adaptor. The dust will be collected by the vacuum.

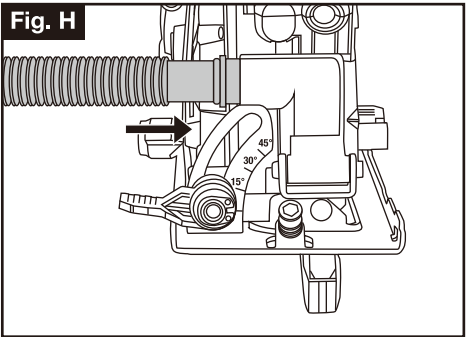

**7. OPERATION**



**1) Charging the battery pack (see FIG I,J,K)**

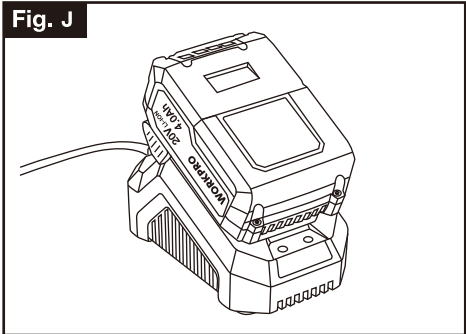
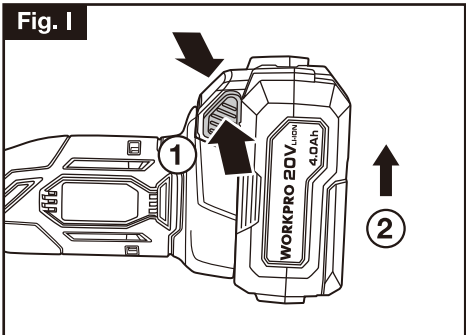

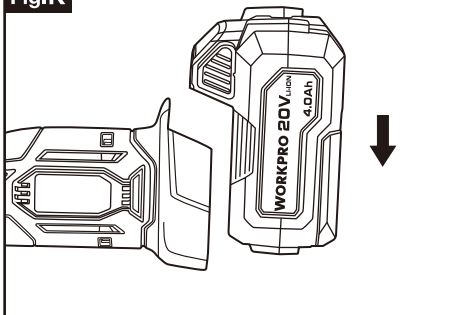
**Fig.K**

**CAUTION!** Risk of injury! Comply with all safety instructions when handling rechargeable devices.



**NOTICE!** Risk of damage to the unit! Do not allow the battery pack to deep discharge.



**NOTICE!** Risk of damage to the unit! Do not press the On/Off switch after the device has deactivated automatically.



**Note:** The Li-Ion battery pack can be charged at any time without affecting the lifetime of the unit. Interrupting the charging process will not damage the battery pack.



**Note:** If the battery is fully loaded, the charger automatically switches over to the maintenance charge function. The battery can thus remain in the charger permanently.

The battery pack must be charged prior to the first start-up.( charging time: around 120 minutes.)

- Press in the battery pack release button and remove the battery from the device.
  - Insert the battery pack into the charger .
  - Plug the charger into the power supply.
- The charging status is displayed by the control lights ,(more information refer to Charger Indicator section)
- Slot the battery pack into the device and make sure it clicks into place correctly.

### Battery Pack Fuel Gauge

Press the battery capacity indicator switch.The battery capacity indicator shows the charge status of the battery using 4 LEDs.

#### All 4 LEDs are lit:

The battery is fully charged.

#### 3 or 2 or 1 LED(s) are lit:

The battery has an adequate remaining charge.

#### 1 LED blinks:

The battery is empty, recharge the battery.

#### All LEDs blink:

The battery pack is too hot (e.g. due to direct sunshine or prolonged use) or too cold (below 32°F/0°C). Do not use or charge the battery pack,make sure the battery temperature to between 40°F(4°C) and 104°F(40°C).

### 2) ON/OFF Switch (see FIG L)

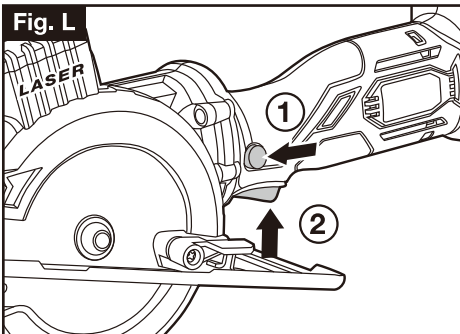

Check the correct function of the base plate before slotting the battery pack into the device.

- Choose a corresponding saw blade and check its condition and sharpness.
- Make sure you keep the ventilation slots clear when holding the tool.
- Press the safety lock switch and then press the ON / OFF switch and wait, until the saw blade has reached maximum speed,and slowly push the tool forward through the safely fixed workpiece.
- Make sure the base plate always rests evenly on the workpiece.
- To switch off the tool, release the ON / OFF switch.

#### ⚠ CAUTION!

Do not overheat the blade tips of the saw blade.

Always hold the machine by both hands.

Never start the machine with the blade in contact with the workpiece. Start cutting only after the motor reached its full speed. And always remove the machine from the workpiece before switching it off.

Always carry out a test run before starting work and after every tool change! Always ensure that the tools are in good condition, correctly mounted and able to turn freely. The trial run should be at last 30 sec.

### 3) Laser (see Fig.M)

Note: Laser light can cause severe eye damage. Never look directly into the laser beam. Do not point the

laser beam at other people or animals, either directly or through reflective surfaces.

The laser feature on your saw is powered by two LR44 1.5V button batteries (installed).

The Laser feature clearly shows you an extended cut-line, even over debris on the work piece.

- Turn it on with the laser light ON/Off switch right before cutting.
- Turn it off immediately after use to conserve battery and laser life.

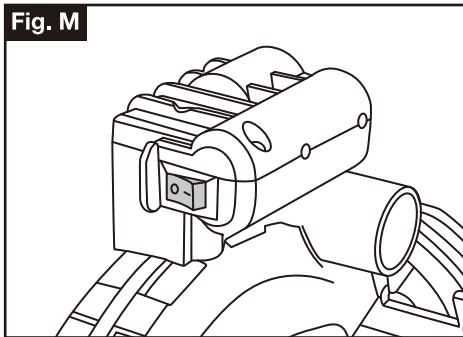

## 8.WORKING HINTS FOR YOUR TOOL

If your power tool becomes too hot, please turn off your mini circular saw several minutes to cool the motor. Avoid prolonged usage under strenuous cutting loads. Protect saw blades against impact and shock. Excessive feed significantly reduces the performance capability of the machine and reduces the service life of the saw blade. Sawing performance and cutting quality depend essentially on the condition and the tooth count of the saw blade. Therefore, use only sharp saw blades that are suited for the material to be worked.

Choice of blades: 24 teeth for general work, approx. 40 teeth for finer cuts, more than 40 teeth for very fine cuts into delicate surfaces, diamond for tile, cement board, etc.

## 9. CLEANING AND MAINTENANCE

**⚠ DANGER! Risk of injury!** Before any maintenance or cleaning work:

- Remove the battery.
- Let the device cool down.

### Cleaning

- Keep the ventilation holes and the motor housing of the device clean. Use a damp cloth or brush to do this. Do not use any cleaning agents or solvents. This could damage the device irreparably.
- Clean the saw blade holder with a brush or by blowing out with compressed air. To do this, remove the saw blade from the device.
- Try to clean resinous surfaces with a damp, lukewarm cloth that has been wrung out well. Make sure that no liquids can get into the interior of the housing!

### Maintenance

- Check the device before each use for obvious defects such as loose, worn or damaged parts.
- Check the covers and protective devices for damage and correct fit. Replace these if necessary.
- Replace a blunt or bent saw blade or one which has been damaged in some other way.

## 10. STORING AND TRANSPORT

### Storage

- Store the device in a dry and dustproof location and out of reach of children.
- Remove the rechargeable battery from the device before storing the device.
- The optimum storage temperature for the battery and device is between 32°F/0°C and 104°F/40°C. Avoid extreme cold or heat during storage, so that the battery does not lose performance.
- Charge the device at least once in 3-6 months to preserve battery life span.

### Transport

- Secure the appliance against slipping.
- If shipping, use the original packaging wherever possible.

## 11. CHARGER INDICATOR

Indicator Status		Explanations and Actions
Red LED	Green LED	
ON	OFF	<b>Ready for use</b> The charger is connected to the mains and is ready for use; there is no battery pack in the charger.
OFF	Quick Blink (2Hz)	<b>Low-current charging</b> As the battery pack voltage is under 15V, the charger is in gentle charging mode, the charging current is below 0,5A. This can maximum the life of the battery.
OFF	Slow Blink (1Hz)	<b>High-current charging</b> As the battery pack voltage is above 15V, the charger is in quick charge mode, the charging current is at 2,3-2,4A. <b>Important!</b> The actual charging times may vary slightly from the stated charging times depending on the existing battery charge.
OFF	ON	<b>The battery is charged and ready for use.</b> The battery is fully charged and ready to use.. <b>Action:</b> Take the battery pack out of the charger. Disconnect the charger from the mains supply.
Quick Blink (2Hz)	OFF	<b>Fault</b> Charging is no longer possible. The battery pack maybe defective. <b>Action:</b> Never charge a defective battery pack. Take the battery pack out of the charger.
Slow Blink (1Hz)	OFF	<b>Temperature fault</b> The battery pack is too hot (e.g. due to direct sunshine/prolonged use) or too cold (below 32°F / 0°C). <b>Action:</b> Remove the battery pack and keep it at room temperature (approx. 68°F / 20°C) for 3 Hours.

## 12. Disposal



### Disposal of the appliance

A crossed-out wheeled bin icon means: Batteries and rechargeable batteries, electrical or electronic devices must not be disposed of with household waste. They may contain substances that are harmful to the environment and human health.

Consumers must dispose of waste electrical devices, spent portable batteries and rechargeable batteries separately from household waste at an official collection point to ensure that these items are processed correctly. Information on returning these items is available from the seller. Sellers are required to accept these items free of charge. Batteries and rechargeable batteries, which are not permanently installed in waste electrical devices, must be removed prior to disposal and must be disposed of separately. Lithium batteries and battery packs in all systems must only be returned to a collection point when discharged. Batteries must always be protected against short circuits by covering the poles with adhesive tape. All end users are responsible for deleting any personal data stored on waste devices prior to their disposal.



### Disposal of an exhausted battery pack

To preserve natural resources, please recycle or dispose of the battery pack properly. This battery pack contains Li-ion batteries. Consult your local waste authority for information regarding available recycling and/or disposal options. Discharge your battery pack by operating your tool, then remove the battery pack from the tool housing and cover the battery pack connections with heavy-duty adhesive tape to prevent short circuit and energy discharge. Do not attempt to open or remove any of the components.



### Disposal of the packaging

The packaging consists of cardboard and correspondingly marked plastics that can be recycled. Make these materials available for recycling.



**WORKPRO**