

USE AND CLEANING INSTRUCTION



In order to keep the LED mirror look perfectly, we suggest using and cleaning the mirror regularly.

1. Please use in safe voltage range. (100V-240V).
2. Use electrical tape to wrap around the wires to prevent leakage.
3. Do not strike mirror glass with hard or pointed items.



Please obey the following procedure when you clean the mirror.

1. It is recommended that the product is cleaned with a soft, non abrasive cloth.
2. Do not use Irritating cleaning agents or abrasive materials on any type of finished surface. Please use the any following cleanser to remove the dirt.



Gentle liquid detergent.



Colorless cleanser.

★ Product Warranty

Manufacturer warranty for 1 year from date of purchase.



If you have any problem, please feel free to contact us on

sales@keonjinn.com



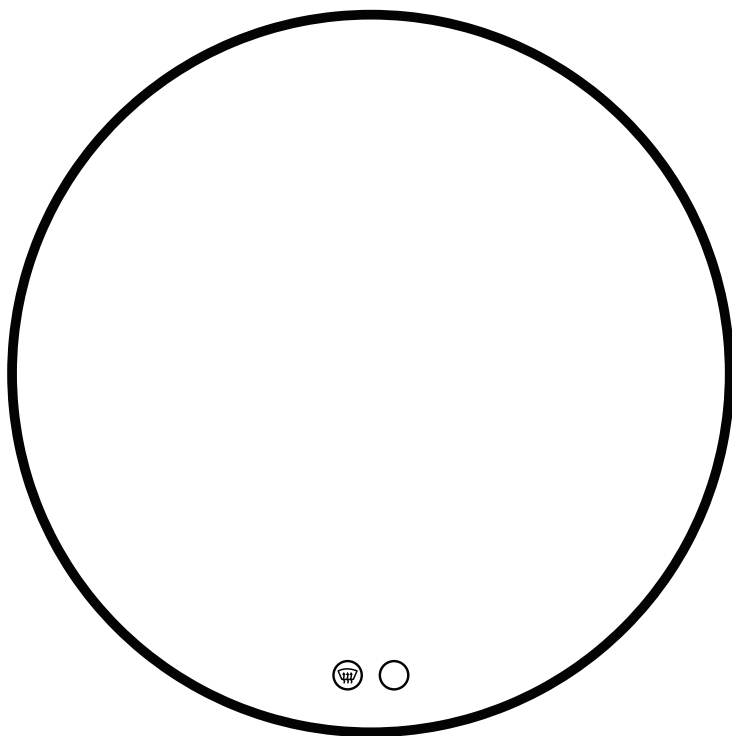

LED MIRROR

Installation Instructions

BEFORE INSTALLATION



Thank you very much for using Keonjinn products, in order to facilitate the use of Keonjinn products, please read this instruction carefully before you begin installation.

1. Important Safety Instructions:

- Please read all instructions carefully before assembling the item.
- Assembly by two or more adults is highly recommended.
- To connect the wires to electrical junction box, a qualified technician or electrician is highly recommended.
- Disconnect power before installing, adding or changing any components.
- Ensure that the fixing location is able to take the weight of the complete fitting. (solid stone / brick walls).
- To prevent injury, the mirror must be installed according to these instructions.

2. Pre-assembly:

- After opening the package, inspect the product immediately upon receipt for transit damage or missing parts.
- Keep the voltages between 100V and 240V. If the voltage exceeds 240V, please use transformer.
- You can connect the wires directly to your junction box or the plug.
- Do not remove the transparent silicone protector before completing the installation.

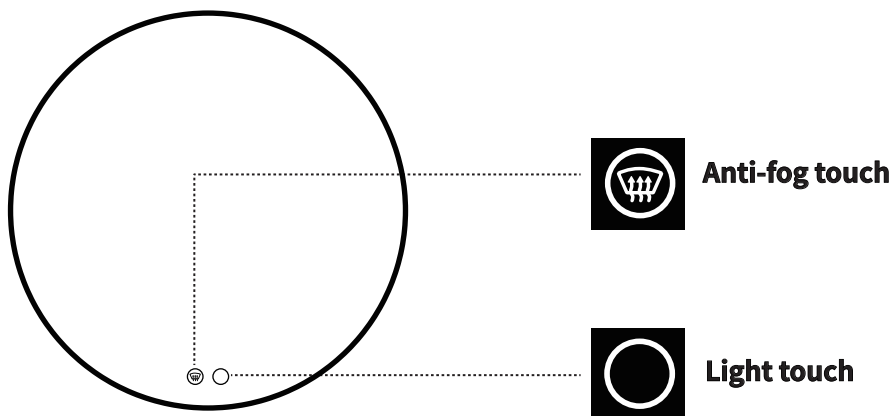

3. Before installation, please check to make sure the mirror is working properly :

After connecting the power, the two round buttons will turn white. At the moment the LED and anti-fog function are already turn on utomatically. If you don't need to use any one of them, just touch it to turn it off, then the button will be dimmed.

- ① The above button is the anti-fog switch.



When you are not using it, remember to turn off the switch to prevent wasting energy.

Anti-fog pad working principle: Anti-fog pad converts electric energy into heat energy efficiently, and transmits heat directly to the mirror surface to warm the mirror surface. The specific power is kept at a constant temperature, which effectively prevents water vapor from condensing on the surface of the mirror and acts as an anti-fog.

- ② The below button is the smart switch.



This switch can control the light brightness and color temperature switching. Keep holding it and the brightness will change. You could adjust the color of light according to your preference: the first touch is white light, the second touch is yellow light, and the third touch is natural light.

If no button is pressed within 15 seconds, pressing again will turn the light off immediately.

CONTACT US

Note: After opening the package, Please inspect the product immediately for damage in transit or missing parts. If there is any missing, Please contact us by (sales@keonjinn.com). or you can contact us at Amazon by following these steps:



- Open "Orders" at Amazon
 - Find the product you have purchased and open the product page
 - Click Sold by "Keonjinn" -Click"Ask a question"
 - Click "An order I have placed"
 - Click "Your product" -Click "Other" -Click "Troubleshooting"
- Then you can send us messages,we will reply within 24 hours.

PACKING LIST



Wall Anchors



Screws



Plug

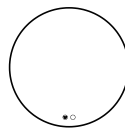

LED Mirror

INSTALLATION TOOLS



Level



Pencil



Hammer



Safety Goggles



Electric Drill

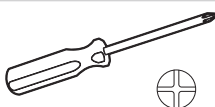

Phillips Screwdriver



Tape Measure

INSTALLATION OF LED MIRROR

Mounting point measurement

Mark the holes for the hanging board on the wall. Then use a spirit level to make sure the hole is on a straight horizontal line.

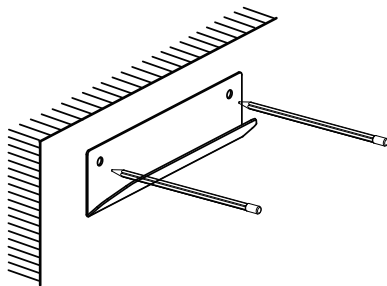

Drill pilot holes on the marked spots

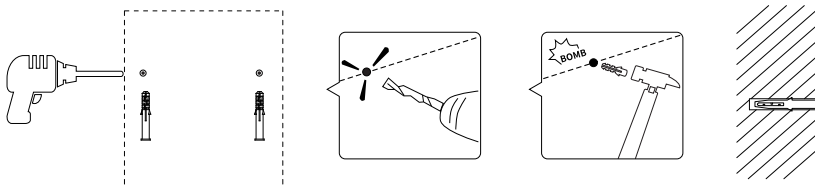

Drill holes where marked and insert anchors.

Insert the screw

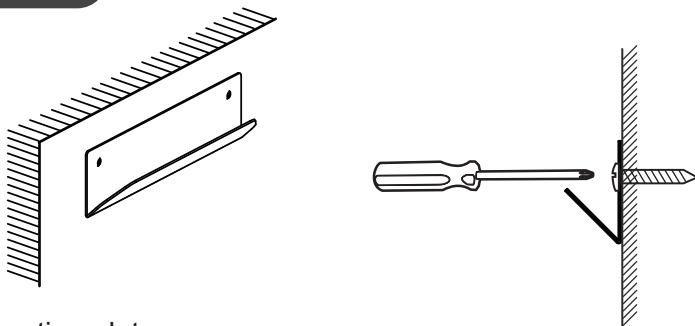

Screw the mounting plate.

Connect the power

There are three power wires behind the mirror, including the live wire (black), the neutral wire (white) and the ground wire (green). You can connect the wires to standard switched lighting circuit or plug.

If you want to connect power wires to plug (For test power only), you can refer to the steps:

- ① Remove the plug cover.
- ② Unscrew the screws on each of the plug's pins.
- ③ Insert the twisted copper wires into the holes in the pins.
- ④ Tighten the little screw on each of the plug's pins.
- ⑤ Make sure the wire is tightly clamped by the brake or clip.
- ⑥ Replace the cover of the plug.

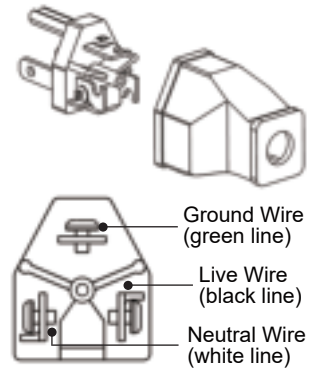

Other power connection methods are on the same principle.

Mount the mirror on the wall and ensure it is sturdy

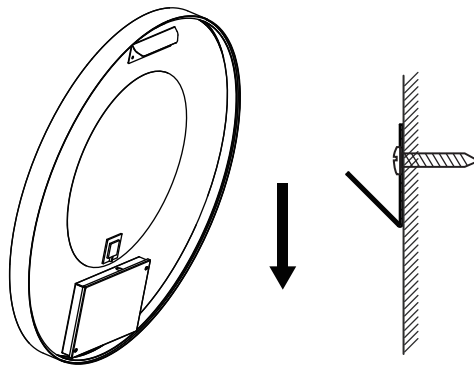

hang the mirror onto the board in wall.

PRODUCT SPECIFICATION

Dimension	Watts	Lumens
Φ24	24W	2130LM
Φ28	36W	2570LM
Φ32	36W	2943LM
Φ36	36W	3551LM
Φ40	36W	3820LM

PARAMETER	SPECIFICATION
Color Temperature	3000-6000K
Input Voltage	AC100-240V
Output Voltage	12V DC
CRI	≥90 Ra
Working Temperature	-20~50℃
Life Span	≥20000 hours
Anti-fog	Yes
Safety Compliance	ETL
IP Rate	IP44
Mirror Glass	5 mm
Wiring Method	Hardwired / Plug in
Switch	Touch Sensor Switch
Mounting Method	Wall Mount