

# USER MANUAL

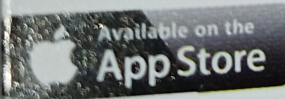

iSearching

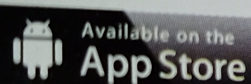
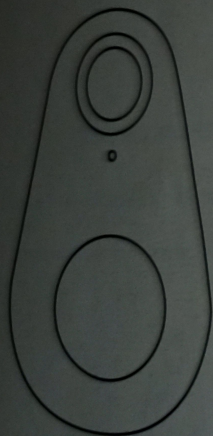

Apple, APP Store, iPhone, iPad and iPod touch are trademarks of Apple Inc.  
Google play is a trademark of Google Inc. All other trademarks are properties  
of their respective owners.

This guide is for your benefit to make sure you fully understand how to use the product.

This product is a Bluetooth wireless device running the 'iSearching' application. Before using it, you need to place the things that are easily lost with the product together. In the effective Bluetooth connection range (About 25meters/75ft no barrier), you can make the product beeps to find your things with your phone's app, you can double-click the product's button to cause your phone ring, and you can use the product to take photos. (With these features, you can find anything you want to find with ease. Such as, keys, bags, remote control, wallet, mobile phone...)

When the product is out of range with your phone's Bluetooth, the alert will be triggered in both of the product and your phone, and last lost location will be marked on the map in the 'iSearching' app. (To use this feature, you need to open '**Phone Alarm While Lost function**' in the setting. With these features, your belongings and mobile phone will be protected in a specified range. If you forget to take your belongings, you will be reminded with your phone's alert. If your phone is left behind, you will be reminded with the tracker's alert.)

In order to use the product, your device will need both of the following:

1. Bluetooth 5.2
2. IOS 8.0 and higher, Android 4.4 and higher.

## APP DOWNLOAD AND INSTALL

1. You can download the 'iSearching' APP from the APP Store.
2. You can download the 'iSearching' APP from the Google Play.

## POWER ON/OFF

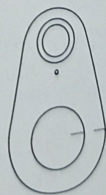

Power On:  
Hold down the tracker's function button for at least 3 seconds.  
You will hear two beeps, the tracker is now powered on.

Power Off:  
Hold down the tracker function button for at least 3 seconds.  
You will hear a long single beep. The tracker is now powered off.

## START APP

Open the app on your smart phone. Please take time to review the tutorial page. Please click the "Allow" of the notifications of the APP.

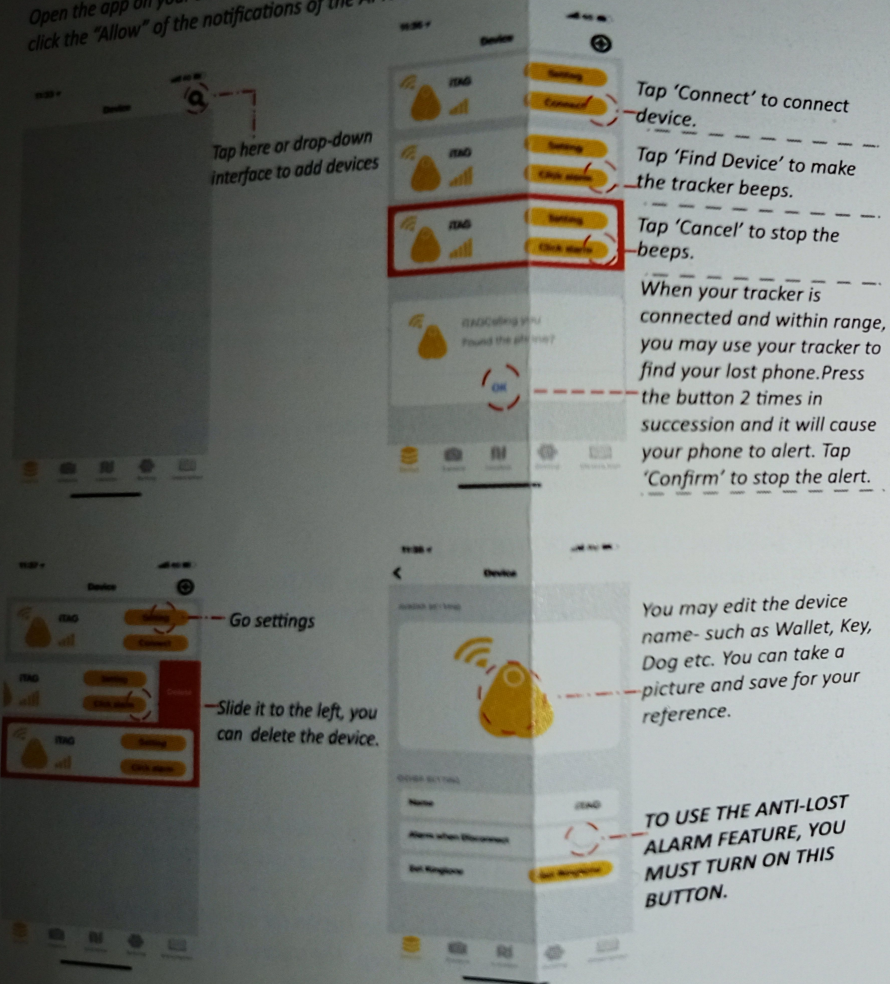

## SELFIE

Press 'Camera', the camera will show up. Press the connected tracker's button to take the photo, it works as a remote shutter. Switch the front and rear camera.

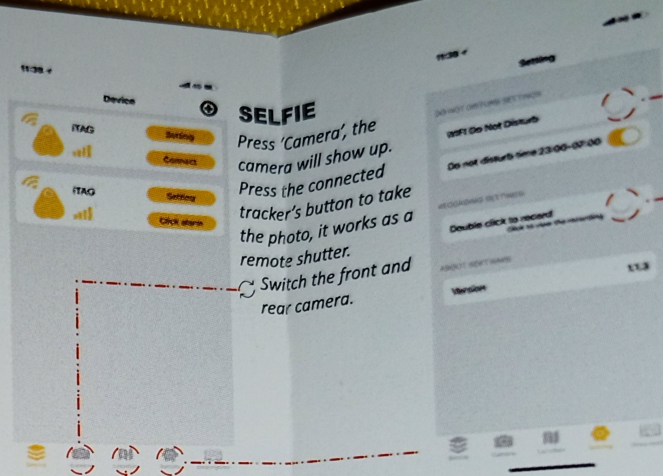

## LOCATION

**Location History:** When you park your car, press the tracker's button, it will mark your current location on the map. Press the location history you will find your vehicle.

**Lost History:** If you lost your tracker, you can find it in 'Lost History'. A pin-drop will be marked automatically on map and it will tell you the tracker's location. Just press 'Lost History' to find the record.

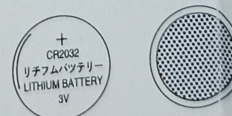

## BATTERY REPLACEMENT

Battery type: CR2032

The CR2032 is a standard sized battery and easy to purchase.

Open the case from the button of the device and replace the battery.

