

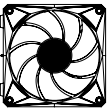

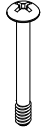



HURRICANE MAG 120
ARGB PWM MAGNETIC FAN

Quick Start Guide

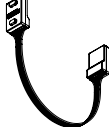
Package Content

					
Fan x4	6-32# Screw x12	M3 Screw x12	Short Screw x16	Fan-to Fan Extension Cable x1	Controller with Power Cable x1

Overview

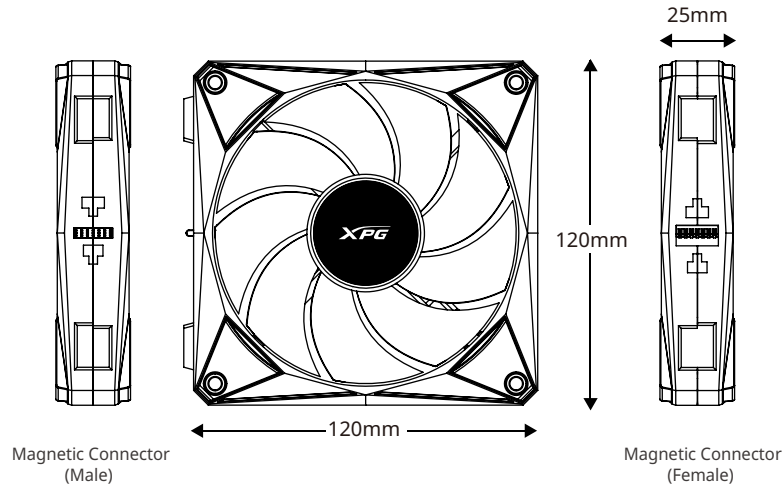

Controller with Power Cable

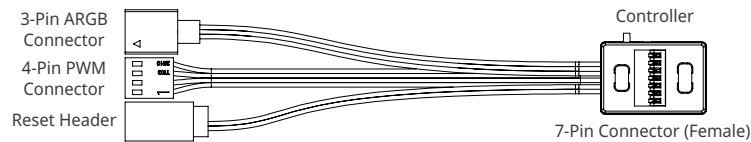

Fan-to-Fan Extension Cable

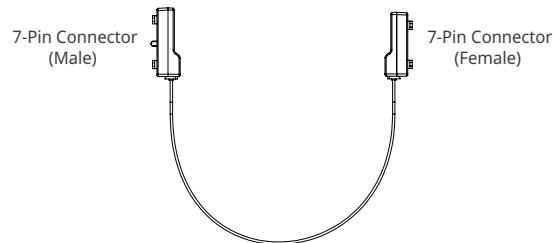

HURRICANE MAG 120
ARGB PWM MAGNETIC FAN

Quick Start Guide

Specification

Dimensions	120 x 120 x 25mm	
Bearing Type	Rifle Bearing	
LED Profiles	Addressable RGB LED	
Connector	4-Pin PWM	
Lighting Connector	5V 3-pin ARGB	
Fan Direction Mode	Standard (Counterclockwise)	Reverse (Clockwise)
Speed (RPM)	2000 RPM	2000 RPM
Maximum Air Flow	54.82 ± 10% CFM	49.27 ± 10% CFM
Maximum Static Pressure	2.74mm-H2O	3.29mm-H2O
Maximum Noise Level	23.36 dBA	31.36 dBA
Fan Rated Voltage	DC 12V	
LED Rated Voltage	DC 5V	
Operating Voltage	DC 7V~12V ± 5%	
Fan Starting Voltage	DC 7V	
Fan Rated Current	0.2A (Max)	
LED Rated Current	0.86A (Max)	
Fan Protection	Auto-Restart	
MTTF	160,000 Hours / 40°C	
Power Dissipation	1.56-2.4W	

Fan Installation

Magnetic fans

1. Connect the first fan in the chain to the fan controller. Align the fan's pin with the connector on the controller, then firmly push the controller up to secure the connection.
2. Link the magnetic connectors of the fans together. Make sure the connectors are oriented correctly.

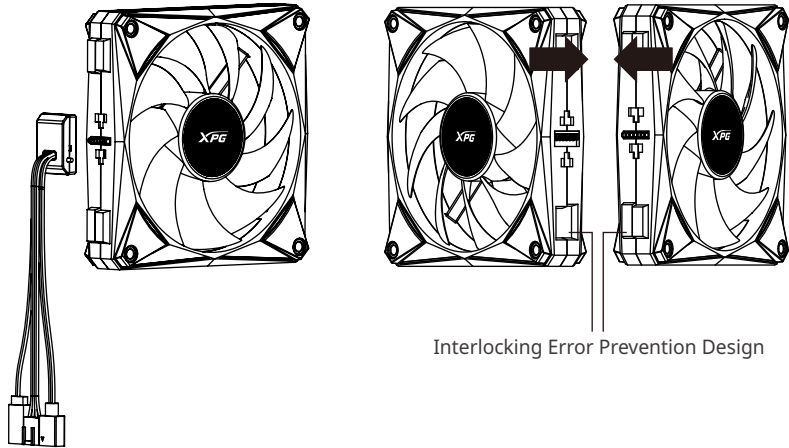

3. With an additional Fan-to-Fan extension cable, you can easily adjust your fan connection to suit any scenarios you want.

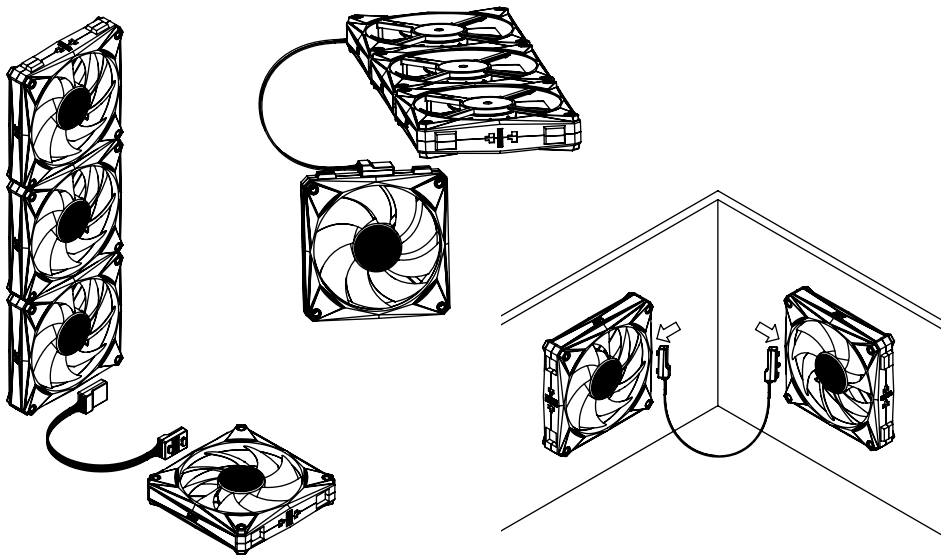

Cable Connection

1. Connect the 3-Pin ARGB connector to the motherboard's ARGB header.
2. Connect the 4-Pin PWM connector to the motherboard.
3. Connect the case's Reset Switch to the fan's Reset Header for easy controller switch (after connection, you can click the reset button to change fan direction).

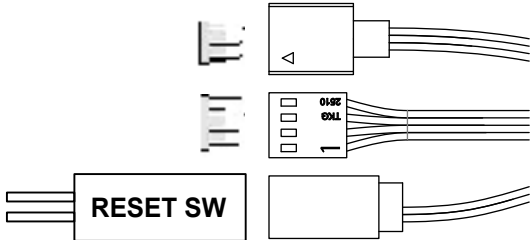

Controller

Connect the controller to your fans. Change the fan direction by pressing the switch. Wait a few seconds for the LED indicator to change to the next color.

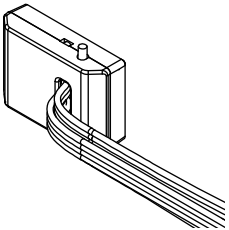

Switch LED Indicator	Description
Blue	Standard (Counterclockwise)
Red	Stop
Green	Reverse (Clockwise)

限用物質及其化學符號 Restricted substance and its chemical symbols						
部件名称	铅 Pb	汞 Hg	镉 Cd	六价铬 Cr (VI)	多溴联苯 PBB	多溴二苯醚 PBDE
扇框	○	○	○	○	○	○
扇叶	○	○	○	○	○	○
磁框	○	○	○	○	○	○
马达电子组件	○	○	○	○	○	○
轴承	○	○	○	○	○	○
润滑油	○	○	○	○	○	○
导线	○	○	○	○	○	○
本表格依据SJ/T 11364的规定编制。 ○：表示该有害物质在该部件所有均质材料中的含量在GB/T 26572规定的 限量要求以下。 ×：表示该有害物质至少在该部件的某一均质材料中的含量超出GB/T 26572规定的限量要求。 (×判定：包括 EU RoHS的豁免项目)						

Learn More

