

Realo Vintage Watch

EST. 2014

CONTENTS

•Names of parts	• • • • •	2
•How to use		
Quartz watch	• • • • •	3
Hand-winding watch	• • • • •	4
Automatic watch	• • • • •	5
Screw type crown	• • • • •	6
Cartier	• • • • •	7
•How to adjust the time and date		
Models without a calendar fast-forward function	• • • • •	8
Model with calendar fast forward function	• • • • •	9
•Precautions when Using the Watch	• • • • •	10

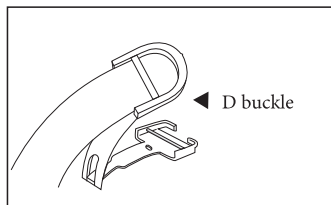
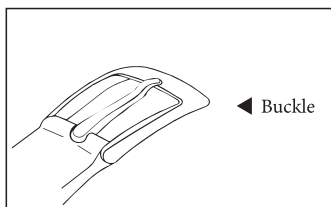
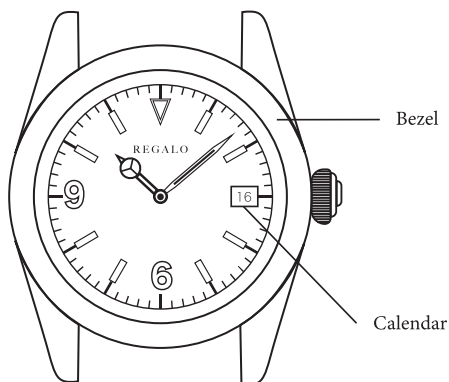
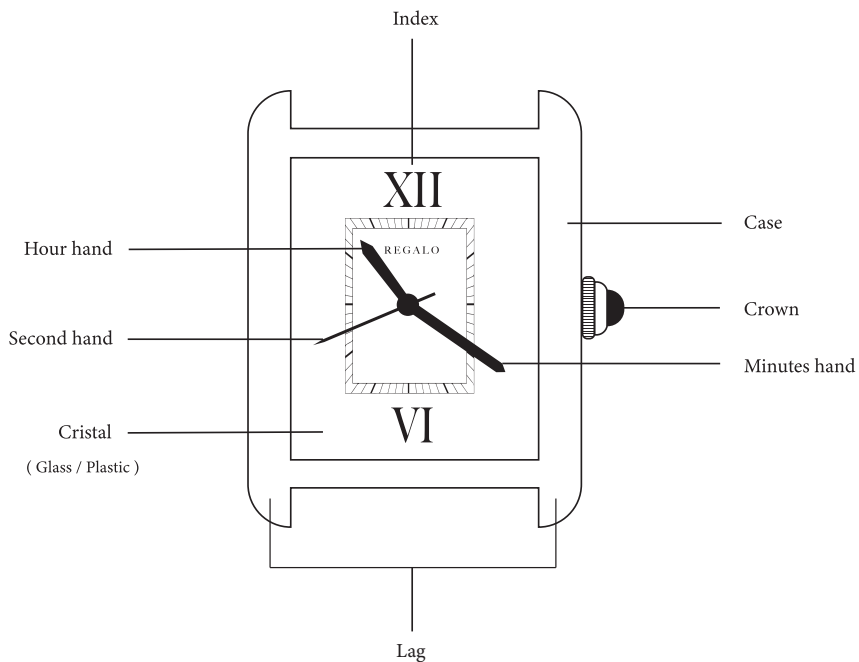

How to use

Quartz Watch(Battery-operated)

Since it runs on batteries, it stops when the battery runs out and it needs to be replaced each time. The battery life is about 1 to 2years depends on the models.

► How to adjust the time

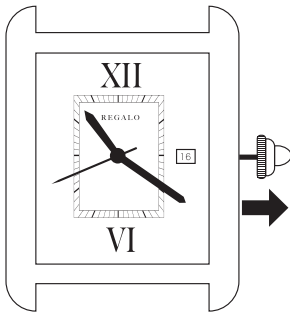

- Pull out the crown.

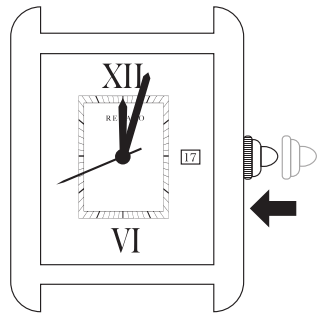

- Return the crown to its original position.

- Turn the crown and adjust the time.
(The hands turn in the direction of the watch.)

ATTENTION

- Vintage quartz watches have 1 minute difference per month, so you need to adjust the time each time.

If there is a significant time lag, maintenance is required.

- When the battery remains stopped, it may leak and cause the watch to malfunction. It may be impossible to repair the movement, so we recommend you to replace the battery as soon as possible when the battery runs out.

How to use

Hand-winding watch

Hand-winding watches are operated by the power of the unwinding spring after you wind it manually.

The hand-winding watches can be operated for 30 to 36 hours depend on the models.

► How to adjust the time

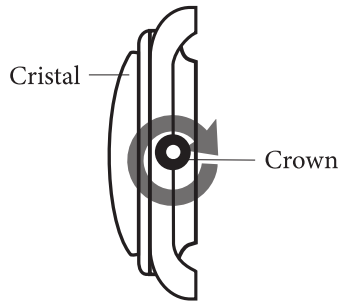
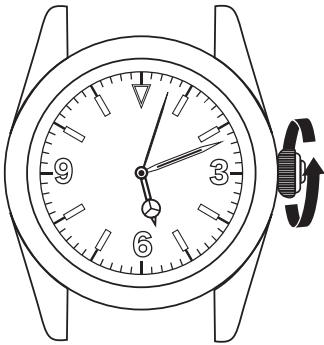

- Wind the crown about 25 ~ 30 times in the direction of the arrow.
(The number of times of winding depends on the model.)
- You can stop winding when the crown starts to become hard to turn.
- Adjust the time to pull out the crown.

ATTENTION

- Please be careful not to wind too hard as the spring may be cut.
 - Vintage hand-winding watches may cause 1-minute difference a day, so please adjust the time every time you wind.
- It may also stop or cause time difference when the winding is insufficient.
If there is a significant time lag, the maintenance is required.

How to use

Automatic watch

The arm movement automatically winds up the spring when wearing the watch. You need to wind up the spring by turning the crown before use.

► How to adjust the time

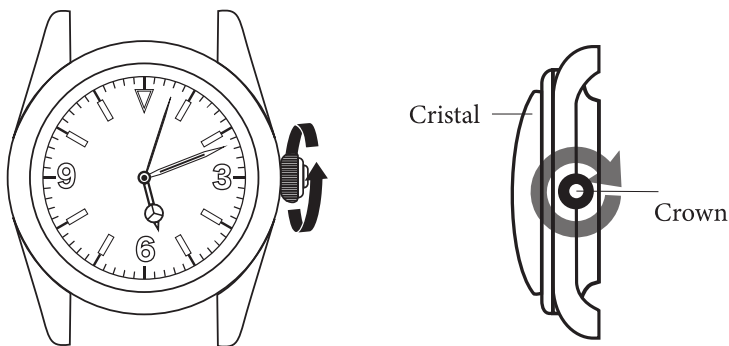

- Wind the crown about 20 to 30 times in the direction of the arrow.
(Unlike hand-winding watches, the spring does not stop even over winding.)
- Pull the crown and adjust the time.

ATTENTION

- Depending on the model, please roll the spring by swinging the watch.
 - Vintage automatic watches have a one-minute difference per day, so you need to adjust the time each time.
- It may also stop or cause time difference when the winding is insufficient.
If there is a significant time lag, the maintenance is required.

How to use

Screwed type crown

A screw type crown is installed to protect the airtightness inside the watch. This seals the watch to protect from water and dust.

► How to use a screw type crown

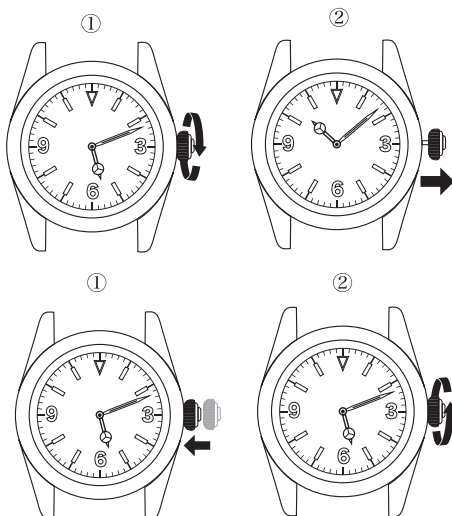

Unlike a normal crown, you need to turn it counterclockwise to unlock.

When you lock, push the crown while turning it towards 12 o'clock.
When you feel anything different or uncomfortable when pushing the crown, do not push it forcefully and loose it once before try again.

ATTENTION

If you forget to close the crown, moisture may enter inside.
Please lock the crown after adjusts the time since water may get inside when it stays unlocked.

How to use (Cartier)

The Must Series

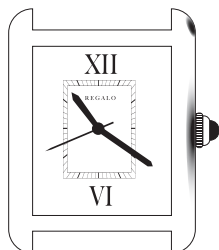

The Must Series has a silver case with a gold or rhodium coating. It may be darkened in use, which is peculiar to silver (sulfurization), but it is not rust.

ATTENTION

Gently rub with silicon cloth to remove only blackheads.
Recoating is also available. Please feel free to ask us.

D buckle

The Cartier D buckle looks so clean and beautiful, and it is also easy to adjust the length.

< Caution >When removing the buckle, push it up with your thumb.

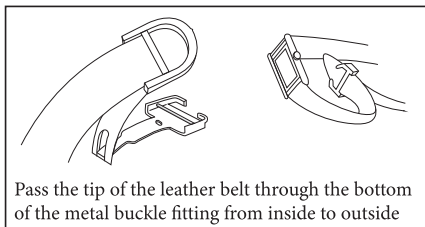

Pass the tip of the leather belt through the bottom of the metal buckle fitting from inside to outside

Fold it a little vertically.



Fold the belt back and fit it between 2 pins in the upper part on the buckle.



Adjust the length of the belt to the size of your wrist.

How to adjust the time and date

Models without a calendar fast-forward function

■ How to adjust the time

- Pull out the crown. (Unlock the screw type crown.)
Turn the crown and move the hands to adjust the time.
(Be sure to lock the screw type crown.)
- Return the crown to its original position.

How to adjust the time

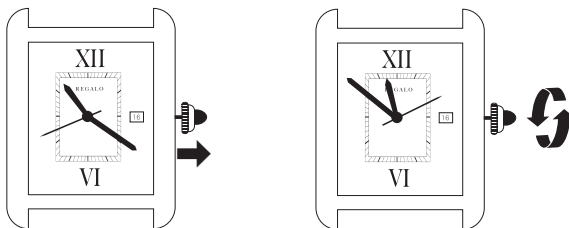

■ How to adjust the date

- Adjust the date by turning the hands 24 hours forward when it does not have a calendar fast-forward function.

How to adjust the date

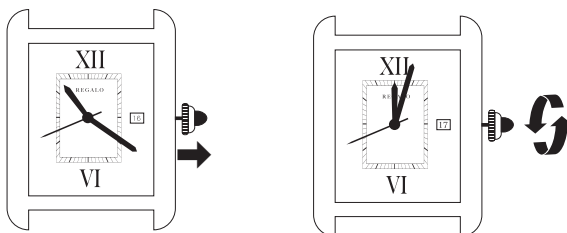

ATTENTION

Please do not wind the hands counterclockwise as this may cause a malfunction.
(The specifications may vary by models.)

How to adjust the time and date

Model with calendar fast forward function

■ How to adjust the time

- Pull the crown up to the second position.

Turn the crown and check if the date changes when the hour hand points at 12 o'clock.

When the date changes -> Midnight (0 o'clock)

When the date does not change -> Noon (12 o'clock)

- Adjust the time and return the crown to its original position.

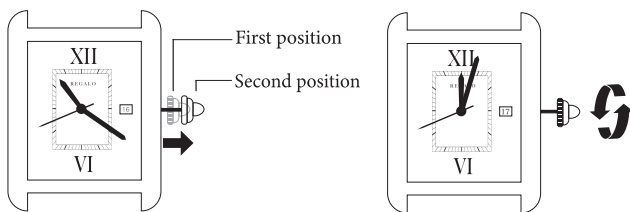

■ How to adjust the date

- Pull the crown to the first position.
- Turn the crown forwards or backwards to change the date.
The direction of rotation depends on the model.
- Return the crown to its original position.

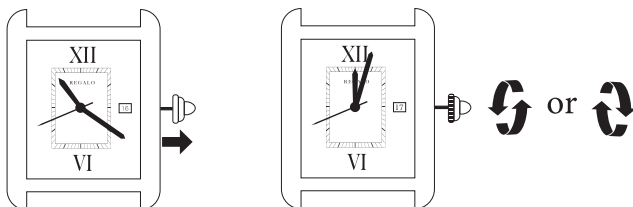

ATTENTION

Do not change the date while the hour hand is positioned between 8 o'clock PM and 4 AM.

This may lead to the malfunction of the date feed gear.



■ NG Time zone

Precautions when Using the Watch



Wristwatches are precision instruments.
Please avoid shocks since watches are precision machinery.
The shock due to falling or vibration by bicycles and motorcycles may cause damage or malfunction.

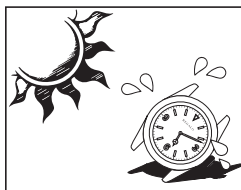

Please keep away from direct sunlight, high temperatures, and humidity.
Extreme temperature changes may cause malfunction.



Placing your watch near products that emit strong magnetism (mobile phones, tablets, PCs, handbags with magnets) can cause "magnetism" defects.
When the inside or outside of the watch gets magnetized, it may affect the accuracy or stop working.

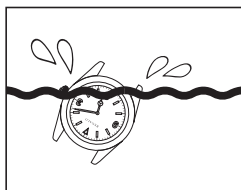

Waterproof function may be deteriorated due to aging.
Therefore, the waterproof function is not guaranteed.
Please avoid water or rain.

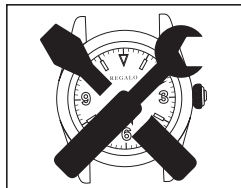

Even when a watch repair technician applied maintenance on the vintage watch, it does not always work for several years without problems.
Any malfunction may occur due to various factors.