

Z1200

Wi-Fi 5 Wireless Router

User Manual

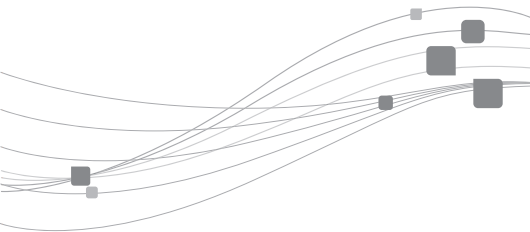

ZTE CORPORATION

Step 1 - Install the Device

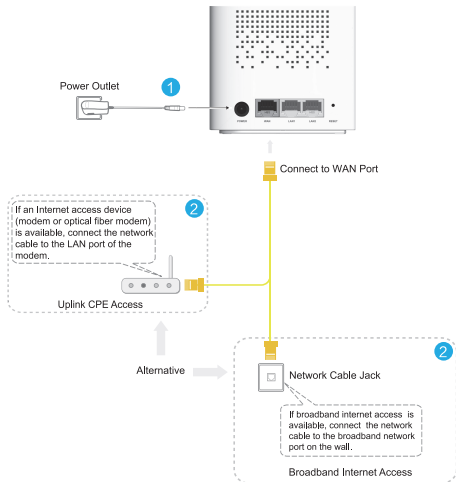

Step 2 - Add the router

- 1 Download and install **ZLife Lite**. For iOS, download **ZLife Lite** on **App Store**. For Android, download it on Google Play.



- 2 Tap **Add device**.

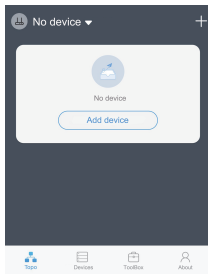

3 Tap Wi-Fi Router.

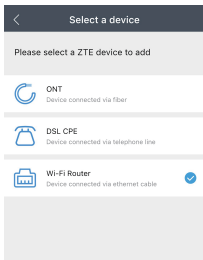

4 Connect the WAN port of the router to the broadband port. Tap **Next**.

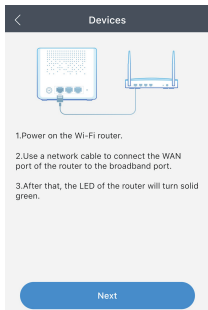

5

Scan the QR code found at the bottom of the router. If no QR code is present, enter your wireless account and password.

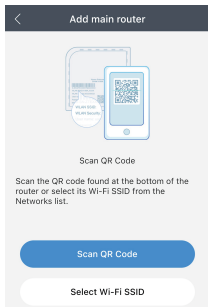

Note:

If the operating system of your mobile phone is Android, you must connect to Wi-Fi manually after scanning the QR code. If you do not want to enter the password manually, tap **copy the password**. This operation arises from Android rather than ZLife Lite because of Android security requirements.

- 6 After the router is added successfully, the Configure network screen is displayed. Tap Bind immediately. After the router is added successfully, the indicator is green and steady.

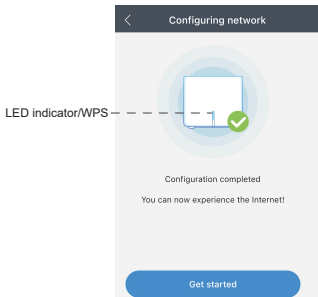

Note:

To perform more advanced configurations, go to the web page for router management. For the login address and the default username and password, see the label at the bottom of the router.

Step 3 - Set Up a Mesh Network



Note:

Step 3 is required only if you want to deploy multiple Z1200 routers.

Method 1: Use ZLife Lite app for connection

1. Make sure the router you have just configured is connected to the Internet.
2. After the new router is powered on, follow the instructions given by the app.
3. After the new router is connected to the existing router, the LED of the new router will turn solid blue.

Method 2: Use WPS key for connection

1. Make sure the router you have just configured is connected to the Internet.
2. Place a new router close to the existing router, and then power it on.
3. Press the WPS buttons on the routers until the LEDs blink green. The time between pressing the two WPS buttons should be less than 1 minute.
4. The pairing process may take up to 2 minutes. When pairing is complete, the LED of the new router will turn solid blue.
5. Now you can move your new router to your intended location.

Troubleshooting

The green indicator on the front panel is off after the device is powered on.

- The wireless network is not enabled and checking the configuration of wireless network .
- The indicator function is disabled.
- The uplink signal is weak in the Extender mode and checking the uplink connection.

The red indicator on the front panel is flashing after the device is powered on.

- The WAN link is not established.
- The Ethernet cable is not correctly connected to the WAN interface.
- Please contact the service provider for help.

Unable to connect to the network.

- Check that the Ethernet cable is correctly connected to the WAN interface and the Ethernet cable is correctly connected to the LAN interface.
- Check the indicator on the front panel is solid red or flashing red.

Restore the factory default settings.

After the power is on, use a needle to press the button for over 5 seconds to restore the default factory settings.

FAQ: How to use the Repeater mode?

Only the **Repeater** mode(used to extend the Wi-Fi signals of the existing router or optical modem) needs to be set on the Web interface. Other modes can be self-adaptive without this operation.

1. After the device is powered on, use a network cable to connect the network interface of the computer to the LAN interface of the device.
2. In the address bar of the d browser, enter 192.168.50.1, and press **Enter** to open the Web page.
3. Enter the username and password (initial username: admin, initial password: ZTE_Dipper), and click **Login**.
4. On the main page of the Z1200, select **Management & Diagnosis > Work Mode** to open the **Work Mode** page.

▼ Work Mode

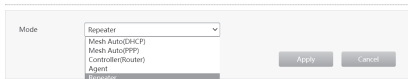

Mode	Repeater ▼	Apply	Cancel
	Mesh Auto(DHCP)		
	Mesh Auto(PPP)		
	Controller(Router)		
	Agent		
	Repeater		

5. Select **Repeater** from the **Mode** drop-down menu and click **Apply**.
6. Extended Wi-Fi.

- Use wired mode to extend Wi-Fi: Connect the LAN interface of the existing router or optical modem to the WAN interface of Z1200 with a network cable.
- Use wireless mode to extend Wi-Fi: The WPS key can be used for pairing. If the existing router or optical modem does not support the WPS key mode, perform the following operations:

- ① On the main page of the Z1200, select **Local Network > WLAN > WLAN Discovery > WLAN Discovery** to open the **WLAN Discovery** page.

- ② Click **Scan wireless network** to scan the Wi-Fi signal, select the wireless network you want to connect to, and enter the password to connect to the wireless network.

Scan wireless network

SSID Name	Encryption Type	Band	Channel	Signal strength	Choice
TIM-42779445	WPA2-PSK-AES	5GHz	108		▼

SSID Name: TIM-42779445

MAC Address: 52 : 48 : 1F : 8F : DA : 8D

Encryption Type: WPA2-PSK-AES

Password:

Join SS

7. After the device is networked, the device can be managed on the APP by following the operation of Step 2 and Step 3.

Manual No: SJ-20220322181146-007
Edition Time: 2022-10-09(R1.0)



Address: ZTE Plaza, Keji Road South, Hi-Tech
Industrial Park, Nanshan District,
Shenzhen, Guangdong, P.R.China
Postcode: 518057