

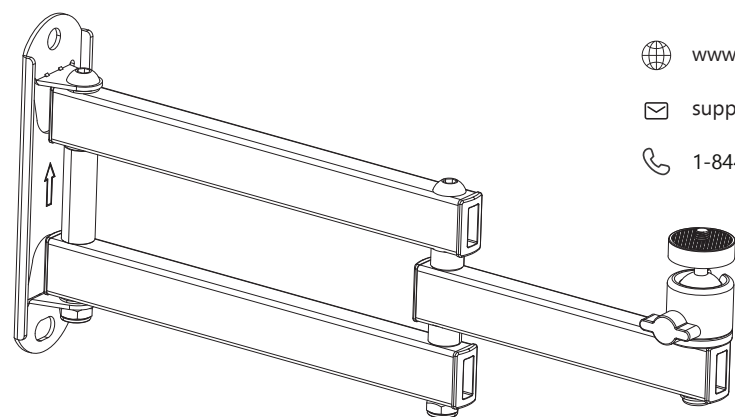

INSTALLATION MANUAL PROJECTOR MOUNT

1330LM-PM



www.walielectric.com
support@walielectric.com
1-844-SATTler (18447288537)

⚠ WARNING

If you do not understand these directions, or if you have any doubts about the safety of the installation, please call a qualified technician. Check carefully to make sure there are no missing or defective parts. Improper installation may cause damage or serious injury. Do not use this product for any purpose that is not explicitly specified in this manual. Do not exceed weight capacity. We cannot be liable for damage or injury caused by improper mounting, incorrect assembly or inappropriate use. DO NOT Mount on Drywall and/or vaulted ceiling.

⚠ TIPOVER WARNING

SERIOUS OR FATAL CRUSHING INJURIES CAN OCCUR FROM TIPOVER. TO HELP PREVENT TIPOVER:

- NEVER ALLOW CHILDREN TO CLIMB, STAND, HANG, OR PLAY ON ANY PART OF PROJECTOR MOUNT.
- USE TIPOVER RESTRAINT OR ANCHOR STAND TO WALL.
- DO NOT MOUNT ON DRYWALL AND/OR VAULTED CEILING.

USE OF TIPOVER RESTRAINTS MAY ONLY REDUCE, BUT NOT ELIMINATE RISK OF TIP OVER.

SMALL PARTS- NOT FOR CHILDREN UNDER 3 YEARS. ADULT SUPERVISION IS REQUIRED.

Supplied Parts List

Wall Plate & Articulating Arms
① (x1)

M6x35 Bolt & Washer
A (x1)

Lag Bolt
B (x2)

Concrete Anchor
C (x2)

Lag Bolt Washer
D (x2)

Lag Bolt Cover
E (x2)

Universal Head
F (x1)

Screw Adapter 1/4" to M4
G (x1)

Screw Adapter 1/4" to M6
H (x1)

CableTie
I (x3)

Tools Needed(Not Included)

Stud Finder

Bubble Level

Pencil

Electric Drill

Socket Wrench

Screwdriver

1 Wall Mounting

a.Wood Stud

Mark the position with Bubble Level & pencil on the wall.

2 Drill 3/16" (4.5mm) diameter x 2.6" (65mm) length holes at the marked position.

3.Attach the bracket to the wall and tighten using Lag Bolt **B** and Lag Bolt Washer **D** with a socket wrench or screwdriver

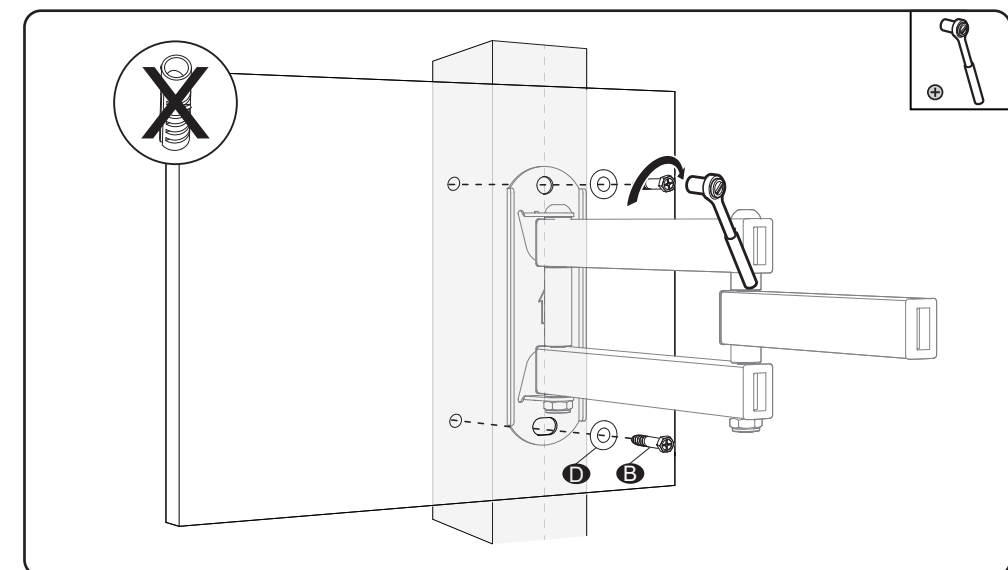
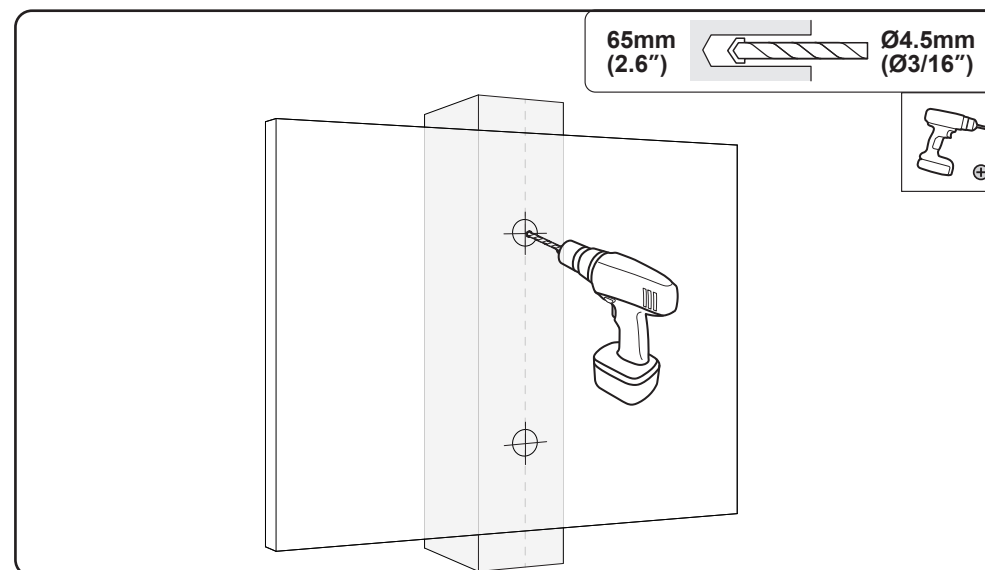
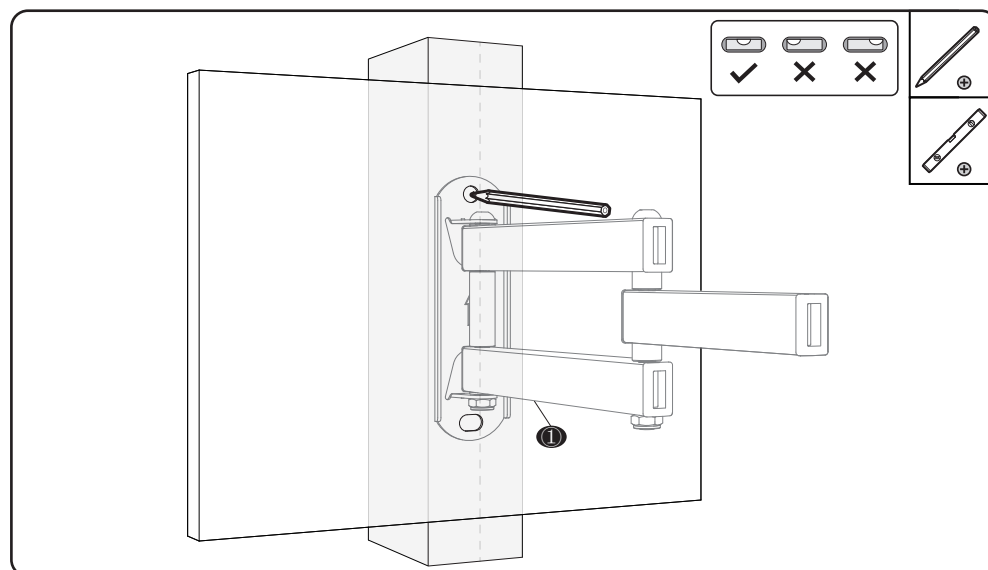

b. Concrete Wall

1. Mark the position with Bubble Level & pencil on the wall.

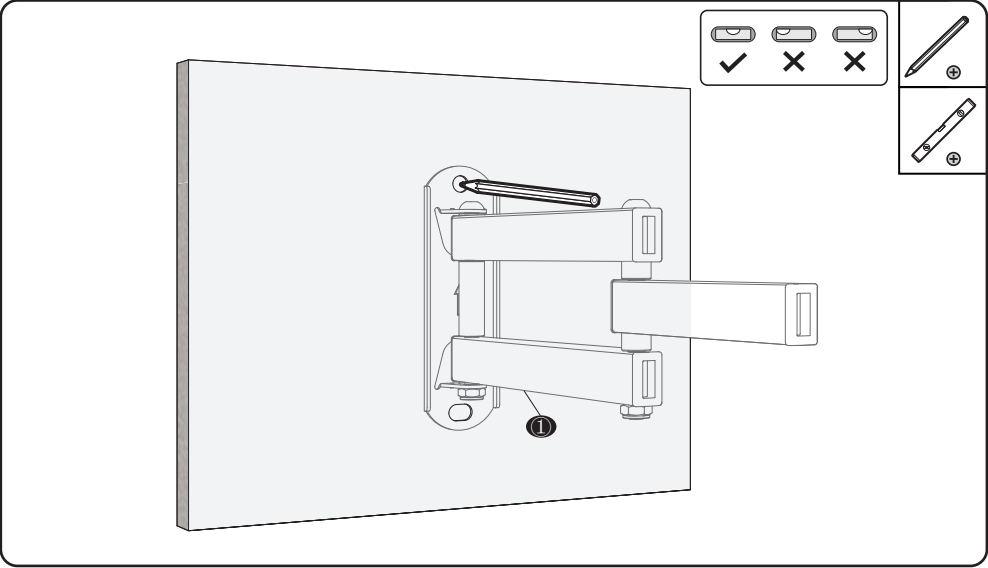

2

2.1 Attach Universal Head **F** to Wall Plate & Articulating Arms and tighten using M6x35 Bolt & Washer **A** with a screwdriver.

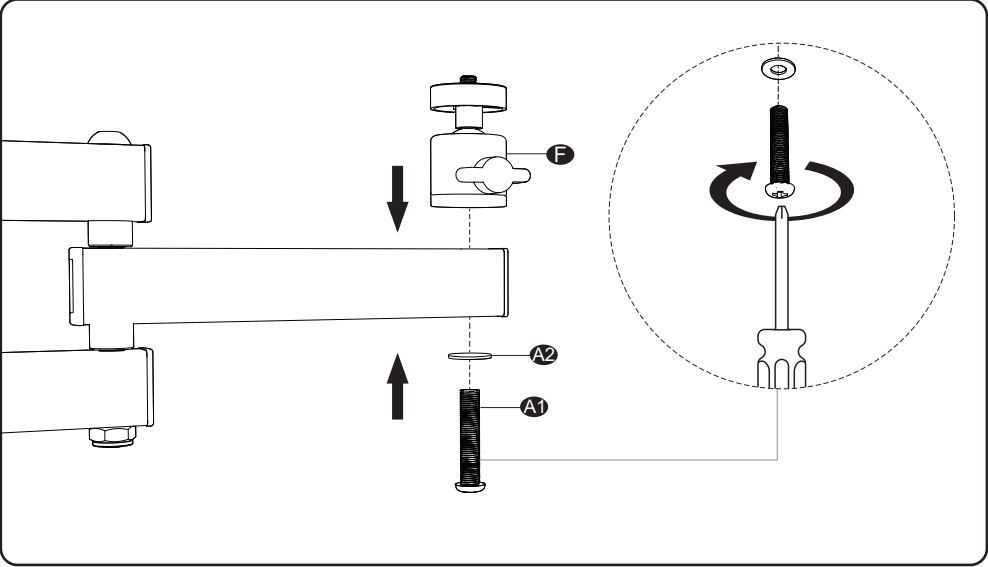

3.2a: Screw adapter required
Attach projector to the Spherical Universal Head **F** using Screw Adapter 1/4" to M4 **G** or Screw Adapter 1/4" to M6 **H**.

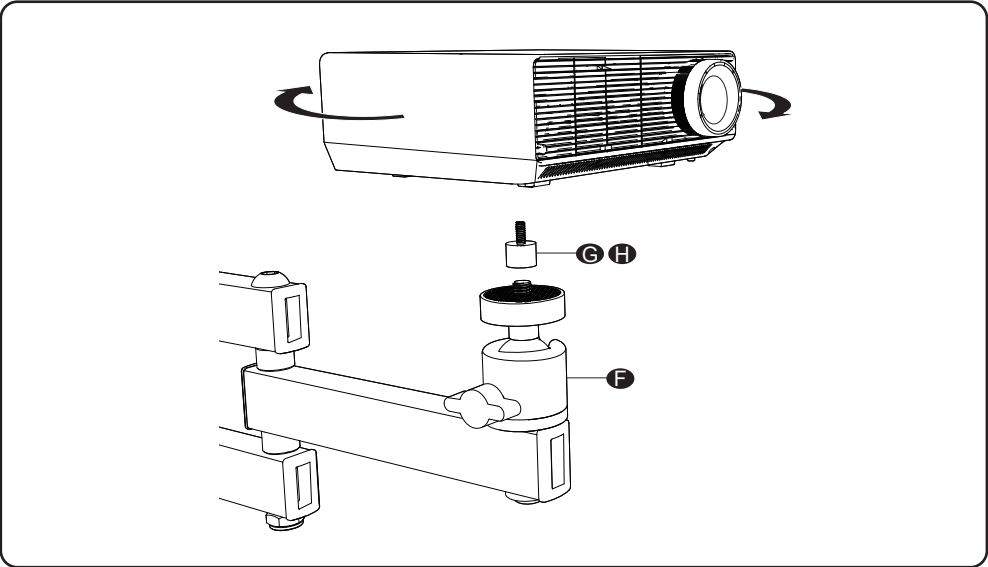

2 Drill 3/8" (10mm) diameter x 2.6" (65mm) length holes at the marked position.

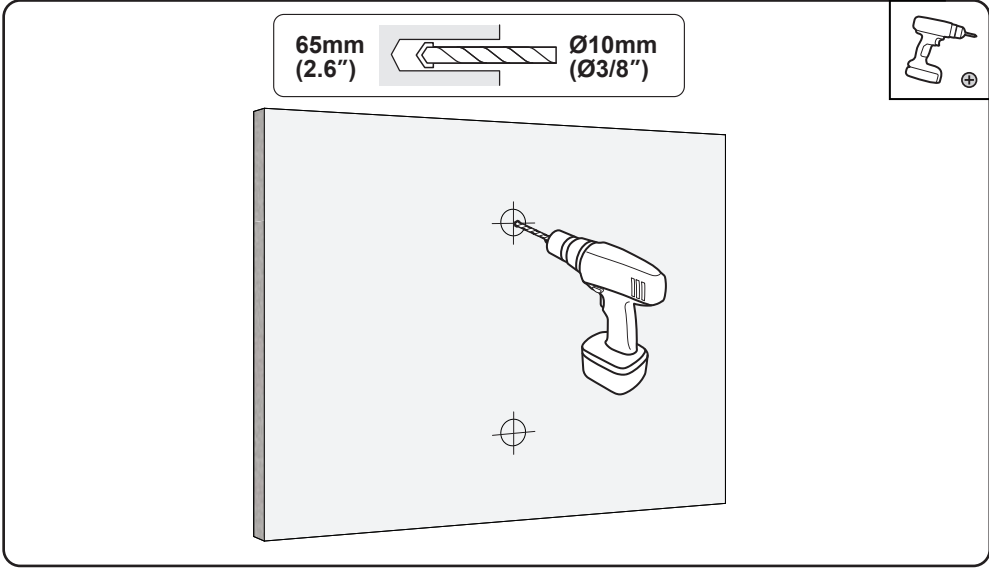

2.2 Adjust the desired angle and tighten the thumb screw **F1**.

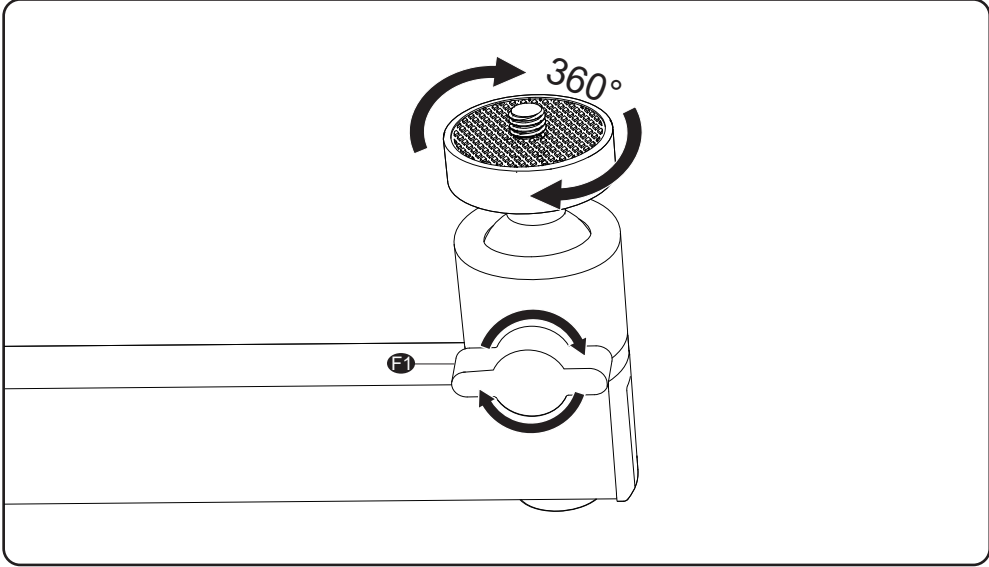

3.2b: No Screw Adapter Required
Attach projector to the Spherical Universal Head **F**.

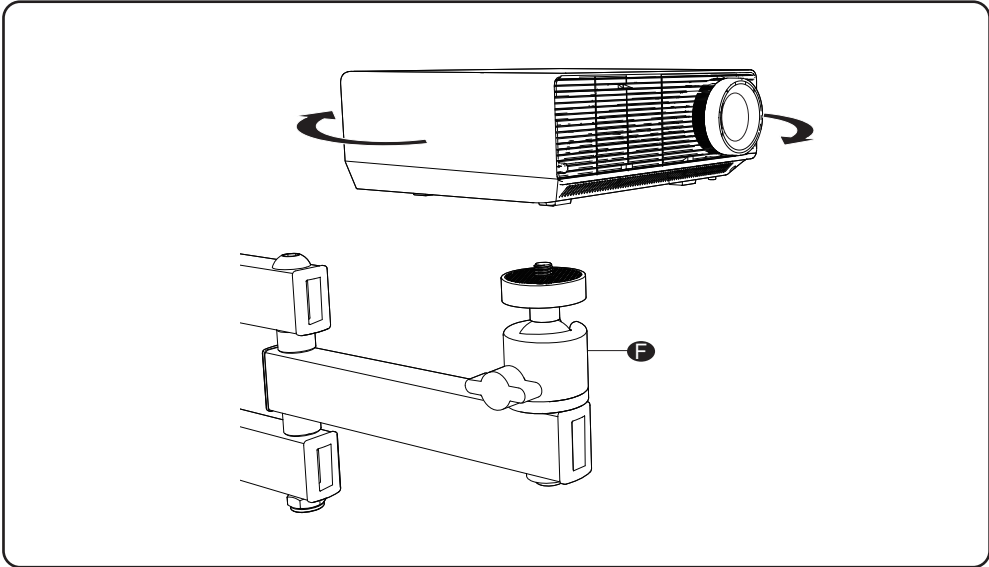

3. Insert the Concrete Anchor **C** into the mounting holes. Attach the bracket to the wall and tighten using Lag Bolt **B** and Lag Bolt Washer **D** with a socket wrench or screwdriver

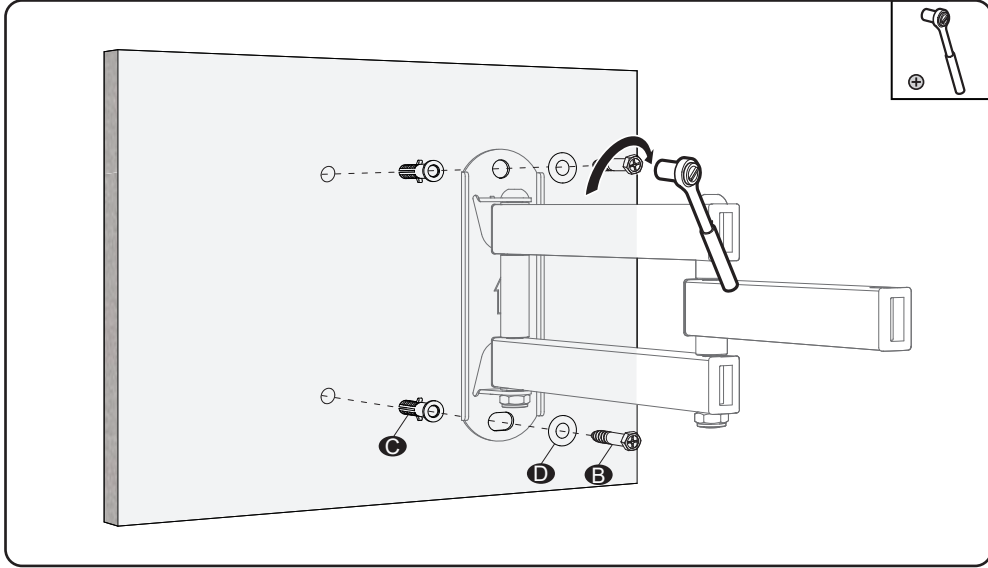

3

Select Projector Screws Adapter

3.1: Predetermine your projector's bolt type.

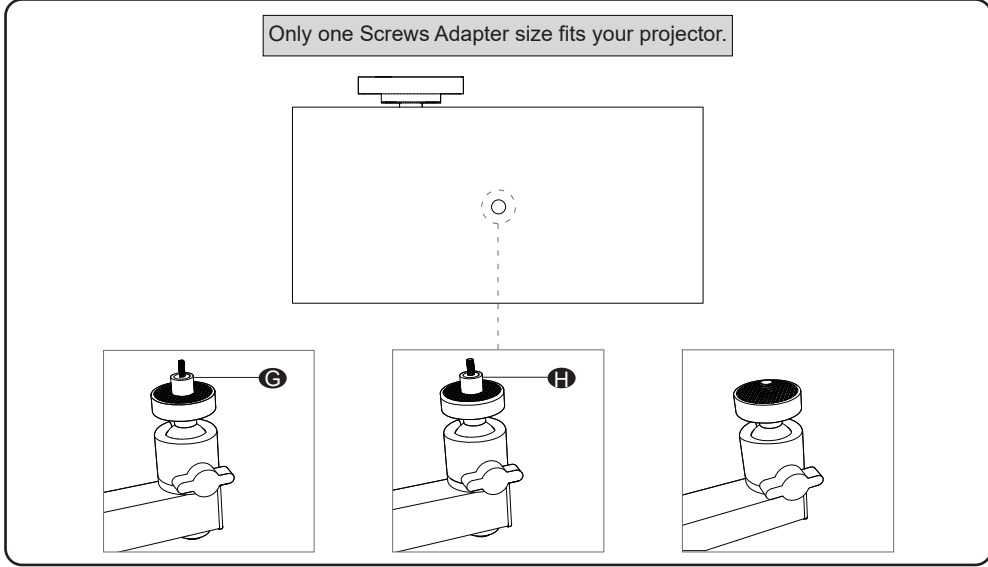

4

Attach the Bolt Cover

