

USB4 SLIM NVME ENCLOSURE

SKU: ST-EU4SNSS

1



To install the NVMe SSD, rotate the enclosure's bottom cover clockwise to unlock it and lift the cover.

The SSD accessories and connection cable are included. The cable can be stored inside.

2

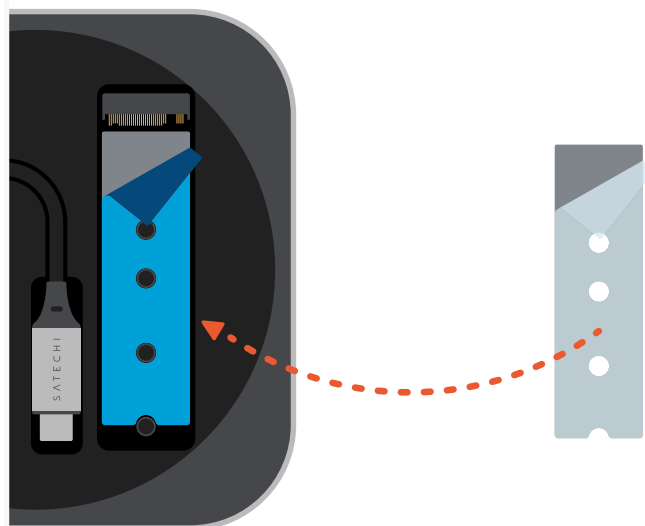

Before installing the SSD, be sure to apply the included thermal tape.

Remove the clear film and attach that side to the enclosure. Once attached, remove the blue film from the side that will contact the SSD.

3

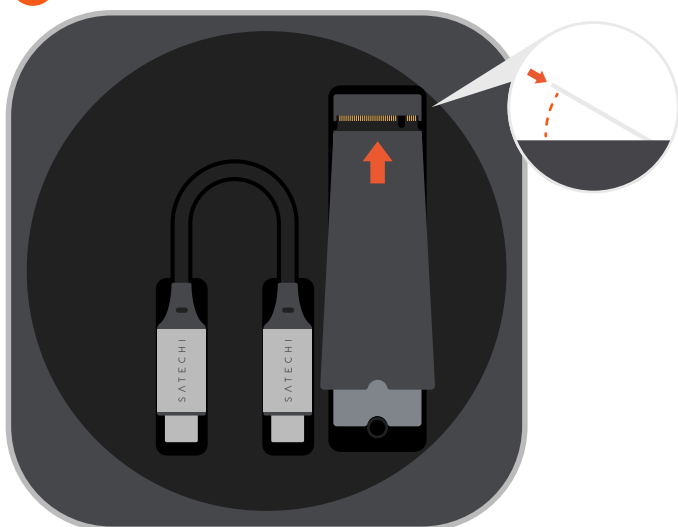

Insert the SSD (not included) at a slight angle and fully seat it in the PCIe slot.

The enclosure is **not** compatible with some double-sided SSDs or SSDs with pre-installed heatsinks.

4

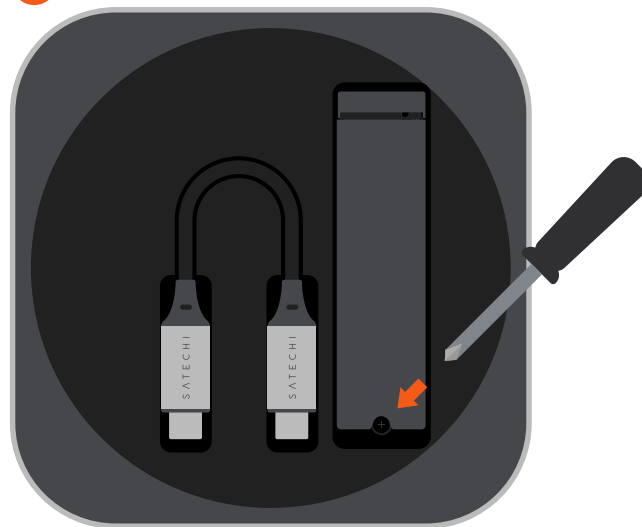

Secure the SSD using the included screw and screwdriver.

Tip: To prevent stripping the screw, do not over-tighten.

5

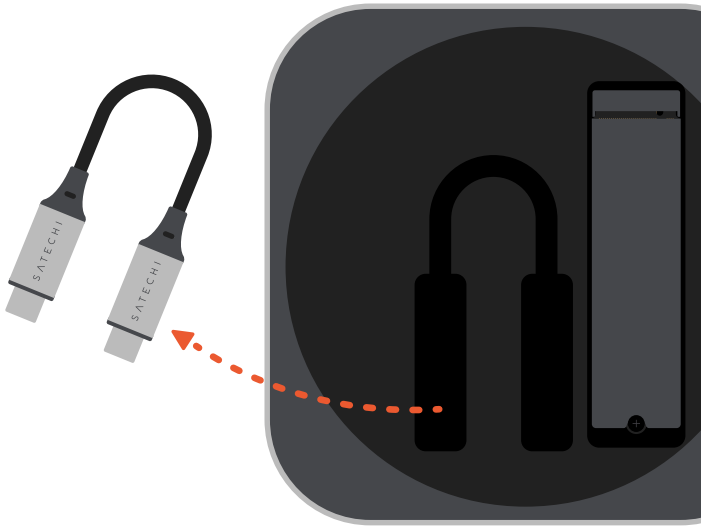

Remove the USB-C cable from the device.

6



Reattach the cover by turning it counterclockwise until the arrow aligns with the notch and it clicks into place.

7

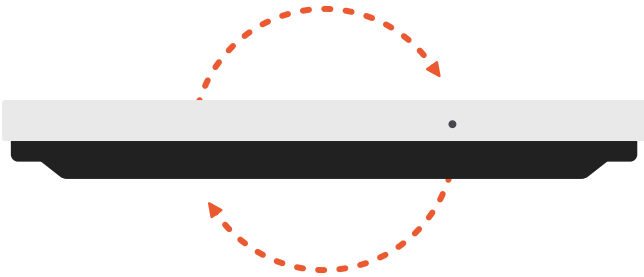

Flip the enclosure back over.

8

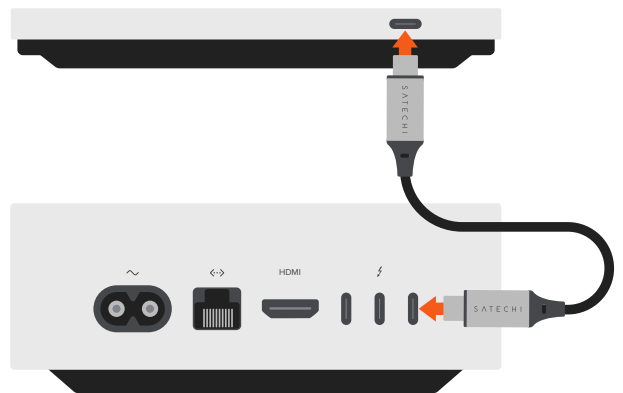

Connect the USB-C cable to the enclosure and then to your computer's USB-C port.

Up to 40Gbps theoretical transfer speeds with compatible NVMe M.2 drives and host devices.

If using a new NVMe drive, please ensure it is properly formatted to support your desired host device(s).