



**Affordable. Reliable. Home Improvement.**

## **CAR REFRIGERATOR USER MANUAL**

**MODEL:MCD60D1 MCD95D1**

Technical Support and E-Warranty Certificate  
[www.vevor.com/support](http://www.vevor.com/support)

## SMART CONTROL- FRIDGEAPP INSTRUCTIONS



### **APP Download and Installation:**

Android users can find the app on the Android market, and iPhone users can locate it on the App Store. or Download the app by scanning the QR code above using your mobile phone's QR code scanner.

### **Instruction:**

Log into the APP, with Bluetooth on, and click "Add Devices". The APP will search for available fridge, and enter the instruction display when it connects with your fridge.

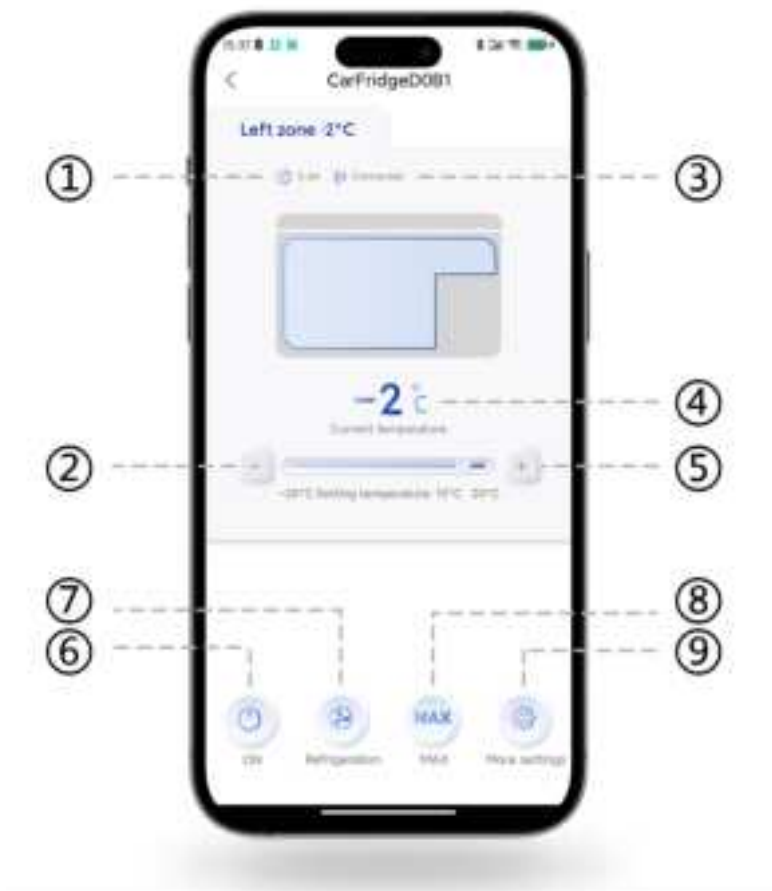

<p>①Current voltage</p> <p>②Temp down control</p> <p>③APP connected</p> <p>④Current temperature</p> <p>⑤Temp up control</p>	<p>⑥ON/OFF</p> <p>⑦Refrigeration mode</p> <p>⑧MAX/ECO mode</p> <p>⑨More settings</p>
---	--

# VEVOR

Affordable. Reliable. Home Improvement.

## *Car Refrigerator*

**MODEL:MCD60D1 MCD95D1**

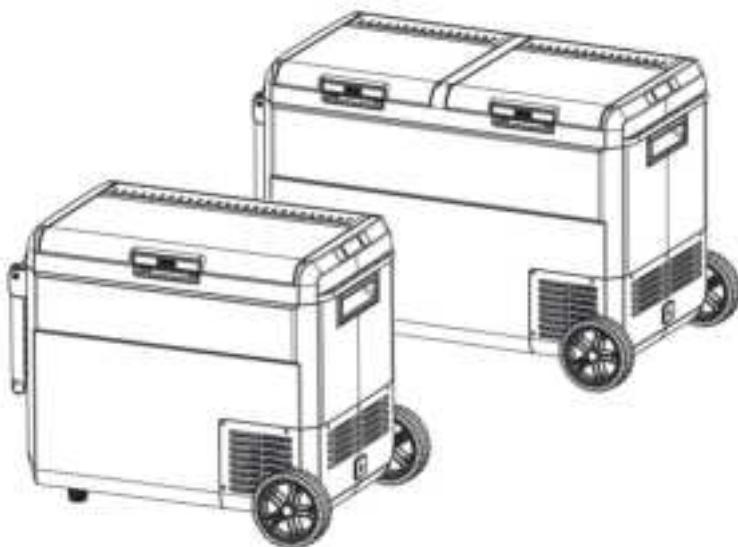

This is the original instruction, please read all manual instructions carefully before operating. VEVOR reserves a clear interpretation of our user manual. The appearance of the product shall be subject to the product you received. Please forgive us that we won't inform you again if there are any technology or software updates on our product.



**Warning-**To reduce the risk of injury, user must read instructions manual carefully.

## Attentions

**Before using the refrigerator, please read this manual carefully and keep it properly**

1. Before using the refrigerator, clean it inside and outside with a damp cloth.
2. Do not fill the refrigerator with corrosive liquids. Do not directly pour liquids into the refrigerator.
3. When the refrigerator is not used for a long time, please disconnect the power supply and keep it dry.
4. Regularly clean the inner chamber to prevent odor and bacteria and ensure food safety.
5. Shut down the refrigerator and battery before pulling by the trolley (If with battery).

## Parameter

Model	Dimensions (mm)	Capacity (L)	Rated power	Power Source	Temperature Range
MCD60D1	657x414x52 7	60	60W	DC12V/2 4V	-20℃~ +20℃
MCD95D1	852x464x55 5	95	70W		

## Connect the Power Supply

1. Find the DC power cord in the kit. Connect DC plug to the power outlet of the car refrigerator.
2. Well place the refrigerators in the car (back-up, seats...).
3. Lay out power cords per your car's interior space. Insert the cigarette lighter plug (one side of the power cord) into the car cigarette lighter hole.

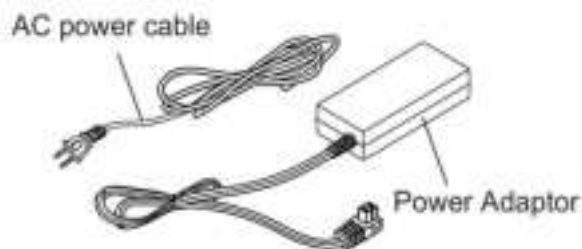

Adapter

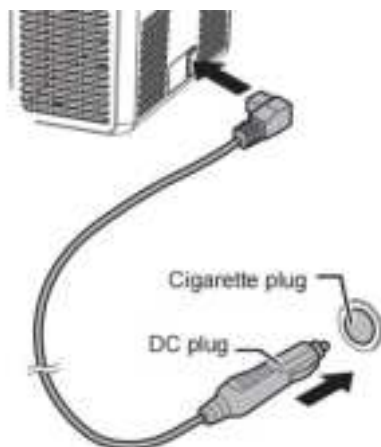

Connect the car cigarette lighter



DC 12/24V

Connect the car refrigerator

- 1.The refrigerator can be connected to more than one energy source.
- 2.The refrigerator can connect directly to the DC12V/24V power supply.
- 3.If the refrigerator is used an AC100-240V power supply, an AC adapter should be adopted.

## Main parts

### Component Diagram

MCD60D1 is a single box with only one drain hole

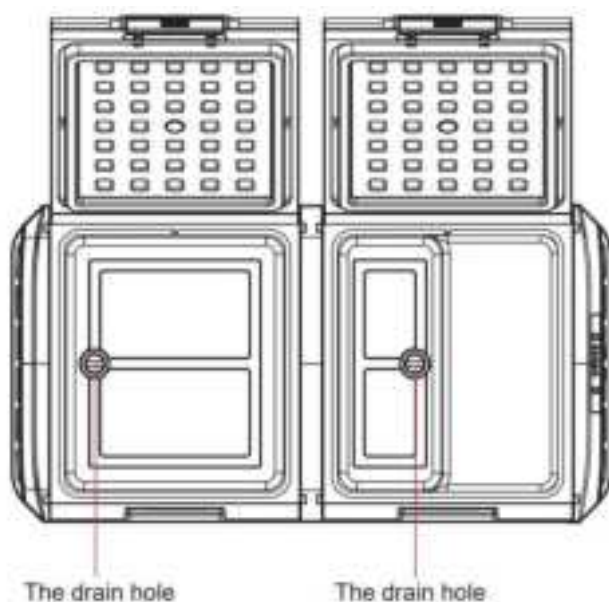
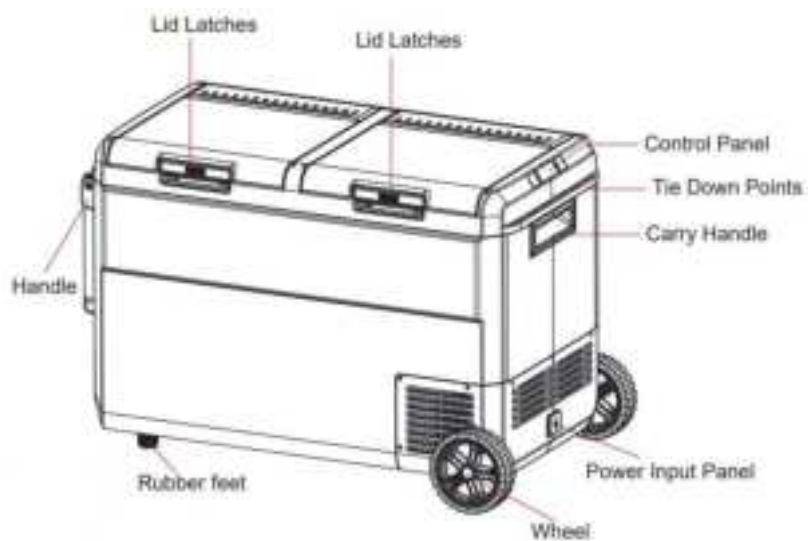

## Installation Instructions

- ① Shaft                      ② Flat Washer    ③ Sleeve Bearing    ④ Wheel  
⑤ Nut For Wheels    ⑥ Nut Cover    ⑦ Screw For Frame    ⑧ Spanner

### Wheel Installation:

1. Pass the ① shaft through the back of the unit.
2. As shown in Figure 1, place the ② flat washer, ③ sleeve bearing, and ④ wheel in sequence
3. Tighten the ⑤ nut with the ⑧ spanner, and cover it with the ⑥ nut cover.

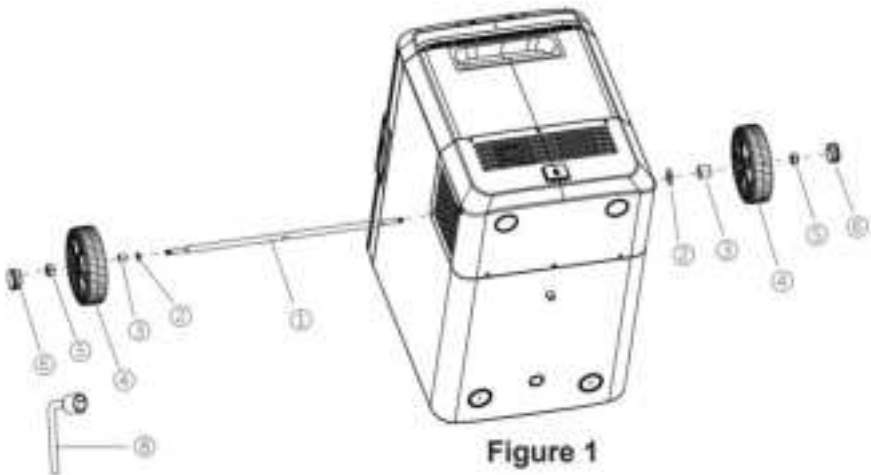

### Supporting Base Installation:



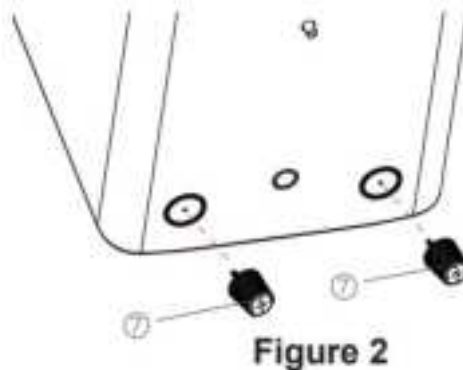







Install the foot on the bottom of the refrigerator.





## Function and operation



- **Power Supply:** connect to DC 12V/24V or AC 100-240V power (using dedicated adapter).
- **Power ON/OFF:** press  to switch ON/OFF.
- **Temperature Setting(MCD60D1):** press  or  for temperature setting(Hold down the  or  button to fast scroll.),the setting will be saved automatically after stopping operating for three seconds. Note:the temperature displayed is the current temperature of the compartment,it'll take a while to reach the set temperature.  
Temperature setting range:-20~20℃.
- **Temperature Setting(MCD95D1):**When the fridge is on, press the "" button once briefly, the left side display of digits "888" flash. Meanwhile, pressing the " or " button once will adjust the left box temperature down or up .
- When the left side display is flashing, short press the "" button once briefly, the right side display of digits "888" flash. Meanwhile, pressing the " or " button once will adjust the right box temperature down or up.

(Short pressing the "⚙️" button can adjust the temperature of the other box.

No operation will cause the display to flash for 5 seconds, then the double-box temperature setting will be saved and the display will get recover to normal.)

- Hold down the "➕" or "➖" button to fast scroll.
- In single-box mode, while the device is on, simply pressing the "➖" or "➕" button once will set the temperature down or up.
- In dual-box mode, the temperature difference between the two boxes should not exceed 25°C.

Temperature setting range:-20~20°C.

#### • **Setting Mode**

Long press the "⚙️" button for 2 seconds to enter Setting Menu, while the

display starts flashing, short press "⚙️" to select the desired function:

MAX/ECO mode — Battery Protection Mode — Fahrenheit/Celsius Switching.

- **Select MAX/ECO mode:** when the current operating mode start flashing, press the "➕" or "➖" button once to switch to the next or previous operating mode (cycling between modes without limit).

- The available operating modes are "ECO" and "MAX" (only the currently selected mode will be displayed). After switching modes, wait for 5 seconds before the switch to the new mode takes effect.

- The default mode at the factory is "MAX".

- **Battery Protection Mode:** when the current battery protection level start flashing, press the "➕" or "➖" button once to decrease or increase the protection level by one notch (cycling without upper or lower limits).

(\*Factory setting is M.)

• **Temperature Unit Setting:** Select Fahrenheit/Celsius Switching, when the current temperature unit font start flashing, press the "+" or "-" button once to toggle between Celsius " °C " and Fahrenheit " °F " once (cycling without upper or lower limits).

## Voltage Reference:

INPUT MODE	DC 12V		DC 24V	
	CUT OUT	CUT IN	CUT OUT	CUT IN
L	9.6V	10.9V	21.3V	22.7V
M	10.4V	11.7V	22.8V	24.2V
H	11.1V	12.4V	24.3V	25.7V

\*the voltage is theoretical value,there may be a deviation in different sceneries.

\*Due to the different output voltages between vehicles,H should be set when the product s connected to car power,and M or L should be set when it is connected to a portable battery or other back-up battery.

## Things to note

### Cleaning:

- Switch off and unplug the device first to avoid electric shock.
- Use wet cloth to clean the device and dry it.
- Do not soak the fridge in water and do not wash it directly.
- Do not use abrasive cleaning agents during cleaning as these can damage the device.

**Storage:** If the device will not be in use for a long time,please follow the instruction:

- Switch off and unplug the device.

- Take out all the items stored in the device.
- Wipe off excess water with a soft rag.
- Put the fridge in a cool and dry place.
- Leave the lid slightly open to prevent odors from forming.
- Recommended storage environment:

ambient temperature: 25°C, ambient humidity: ≤75%.

**Defrosting:** Humidity can form frost in the interior of the cooling device or on the evaporator. This reduces the cooling capacity. Defrost the device in goodtime to avoid this.

- Switch off and unplug the device first to avoid electric shock.
- Take out all the items stored in the device.
- Keep the lid open.
- Wipe off the defrosted water.



Never use hard or pointed tools to remove ice or to loosen objects which have frozen in place.

## Troubleshooting methods

**Advice:** If abnormal situations cannot be resolved through a simple fault analysis, please get in touch with professional customer service for assistance.

Issues	Cause/Suggestions
Refrigerator does not work	<ul style="list-style-type: none"> <li>• Check if the switch is on.</li> <li>• Check if the plug and socket are connected well</li> <li>• Check if the fuse has been burnt.</li> </ul> <p>Check if the power supply is malfunctioned</p> <ul style="list-style-type: none"> <li>• Switch on/off the fridge frequently may cause start delay of the compressor</li> </ul>

Refrigerator compartments are too warm	<ul style="list-style-type: none"> <li>• The door is opened frequently.</li> <li>• A large amount of warm or hot food was stored recently</li> <li>• The refrigerator has been disconnected for a long time</li> </ul>
Food is frozen	<ul style="list-style-type: none"> <li>• The temperature was set too low</li> </ul>
There is "water flow" noise from inside the refrigerator	<ul style="list-style-type: none"> <li>• It's a normal phenomenon, caused by the flow of refrigerant.</li> </ul>
There are water drops around the refrigerator casing or door gap	<ul style="list-style-type: none"> <li>• It's a normal phenomenon, the moisture will condense to water when it touches a cold surface of the refrigerator.</li> </ul>
The compressor is slightly noisy when starting	It's a normal phenomenon, the noise will be reduced after the compressor works stably
Code E1 displayed	<ul style="list-style-type: none"> <li>• Possible cause: low voltage to fridge.</li> </ul> <p>The DC voltage is under the protection setting and the battery protection mode is activated.</p>
Code E2 displayed	<ul style="list-style-type: none"> <li>• Possible cause: condenser fan is overloaded.</li> </ul> <p>Disconnect power to fridge for 5 minutes &amp; re-start. If the code shows again, contact manufacturer for service</p>
Code E3 displayed	<ul style="list-style-type: none"> <li>• Possible cause: the compressor starts too frequently</li> </ul> <p>Disconnect power to fridge for 5 minutes &amp; re-start. If the code shows again, contact manufacturer for service</p>

Code E4 displayed	<ul style="list-style-type: none"> <li>• Possible cause:compressor not kicking in</li> </ul> Disconnect power to fridge for 5 minutes &re-start. If the code shows again,contact manufacturer for service
Code E5 displayed	<ul style="list-style-type: none"> <li>• Possible cause:overheating of the compressor &amp;electronics</li> </ul> Disconnect power to fridge for 5 minutes &re-start. If the code shows again,contact manufacturer for service
Code E6 displayed	<ul style="list-style-type: none"> <li>• NTC failure (Open circuit or short circuit).</li> </ul> Contact manufacturer for service
Code E7 displayed	<ul style="list-style-type: none"> <li>• Communication failure between the display board and its module.</li> </ul> Contact after-sales service
Code E9 displayed	<ul style="list-style-type: none"> <li>• Abnormal phase current of compressor module</li> </ul> Ensure the air vents are unobstructed. Move fridge to cooler location. (Ambient temperature may be too high)

### Packing List

No.	Item	Qty	Remark
1	Refrigerator	1 set	
2	Cigarette wire	1 set	
3	Power adapter	1 set	
4	Manual	1 pcs	

## Use Suggestions

1. If equipped with a backup battery, you can maintain any temperature you set under any circumstances without worries.
2. When placing ice cream, please adjust the temperature to the lowest; it must be powered on for a long time.
3. Prevent the health problems of drinking bottled water caused by high temperatures.
4. Frozen food, rare seafood, and vehicle-mounted refrigerators let frozen fresh food accompany the journey.
5. Healthcare products, insulin, and imported drugs need to be refrigerated, and the precise temperature control of onboard refrigerators will escort health along the way.
6. The tea leaves are effectively kept fresh in the car refrigerator, and you can drink fresh and delicious tea anytime during the self-driving tour.
7. The best storage temperature of red wine is 10 °C - 18 °C (50 - 64.4 °F). The precise temperature control of the car refrigerator can effectively ensure the storage temperature of red wine.
8. The storage time of high-grade fruit in the car at high summer temperatures will be at least 2 hours. The storage time is shorter even if the air conditioner is turned on. Using a car refrigerator can effectively preserve high-grade fruit.
9. The coating of high-grade sunglasses will fall off under the high temperature in summer. The car refrigerator is an ideal place to place it.
10. High-grade cosmetics quickly deteriorate under high temperatures in the car. Carry cosmetics with the car; the car refrigerator will be your better choice.

## Safety Precautions



**WARNING!**

- Do not operate the appliance if it is visibly damaged.
- Do not block the gaps of the fridge with things like pin, wire, etc.
- Do not expose the appliance to rain or soak it in water.
- Do not place the appliance near naked flames or other heat sources (heaters, direct sunlight, gas ovens etc.)
- Do not store any explosive substances like spray cans with a flammable propellant.
- Ensure the supply cord is dry and not trapped or damaged. Do not locate multiple portable socket-outlets or portable power supplies at the rear of the appliance.
- Check the voltage specification on the type plate corresponds to that of the energy supply. The appliance is only to be used with the power supply unit provided with the appliance.
- Do not use electrical appliances inside the food storage compartments of the appliance, unless they are of the type recommended by the manufacturer.
- Once unpacked and before turning on, the appliance must be placed on a level surface for more than 6 hours.
- Make sure that the appliance stays horizontally when it is running. The tilt angle must be less than 5° for longtime running and be less than 45° for short time running.
- Keep the ventilation openings in the unit casing or in the built-in structure free of obstacles.
- Keep the appliance stable on the ground or in the car; Do not drain upside down.
- When positioning the appliance, ensure the supply cord is not trapped or damaged.
- Do not locate multiple portable socket-outlets or portable power supplies at the rear of the appliance.
- Risk of child entrapment. Before you throw away your old refrigerator or freezer:
  - \*Take off the doors.
  - \*Leave the shelves in place so that children may not easily climb inside.



- Do not use mechanical devices or other means to accelerate the defrosting process, other than those recommended by the manufacturer.



- :Risk of fire/flammable materials.

## **CAUTION!**

- Repairs may only be carried out by qualified personnel. Incorrect repair may cause danger. The lamp and supply cord must be replaced by the manufacturer or qualified persons.
- The installation of DC power in the boat must be handled by qualified electricians.
- Children shall not play with the appliance. Cleaning and user maintenance shall not be made by children without supervision.
- The appliance can be used by children aged from 8 years and above and persons with reduced physical, sensory or mental capabilities or lack of experience and knowledge if they've been given supervision or instruction concerning use of the device in a safe way and understand the hazards.

## **NOTICE!**

- Disconnect the power supply before each cleaning and maintenance and after every use.
- Do not use sharp tools to defrost; Do not damage the refrigerant circuit.
- Risk of child entrapment. Before you throw away your old refrigerator or freezer: take off the doors; leave the shelves in place so that children may not easily climb inside.
- Check if the cooling capacity of the appliance is suitable for storing the food or medicine. Food may only be stored in its original packaging or in suitable containers.
- If the appliance is left empty for long periods, switch off, defrost, clean, dry, and leave the door open to prevent mould developing within the appliance.
- The appliance is intended to be used in household and similar applications such as:

- Staff kitchen areas in shops,offices and other working environments;
- Camping,Farm houses and by clients in hotels,motels and other residential environments;
- Bed and breakfast type environments;
- Catering and similar non-retail applications.
- To avoid contamination of drink,please respect the following instructions:
- Opening the door for long periods can cause a significant increase of the temperature in the compartments of the appliance.
- Clean regularly surfaces that can come in contact with drink and accessible drainage systems.
- Store raw meat and fish in suitable containers in the refrigerator,so that it is not in contact with or drip onto other food;
- Store raw meat and fish in suitable containers in the refrigerator,so that it is not in contact with or drip onto other food.
- If the refrigerating appliance is left empty for long periods,switch off,defrost,clean,dry, and leave the door open to prevent mould developing within the appliance.



■ Please according to local regulations regarding disposal of the applian for its flammable refrigerant and blowing gas.

**WARNING:** This appliance contains flammable foaming agent cyclopentane:

- 1) Please avoid contact fire when you transport and use it.
- 2) Please ask a professional for servicing when the machine breaks down.
- 3) Please send it to your local appointed disposal station when you discard it.



**WARNING:** During use, service, and disposal of the appliance, please pay attention to a symbol similar to the left side, which is located on the rear of the appliance (rear panel or compressor) and with yellow or

orange color. It's a risk of fire warning symbol. There are flammable materials in refrigerant pipes and compressors. Please be far away fire source during use, service, and disposal.

### **FCC Information:**

**CAUTION:** Changes or modifications not expressly approved by the party responsible for compliance could void the user's authority to operate the equipment!

This device complies with Part 15 of the FCC Rules. Operation is subject to the following two conditions:

- 1) This product may cause harmful interference.
- 2) This product must accept any interference received, including interference that may cause undesired operation.

**WARNING:** Changes or modifications to this product not expressly approved by the party responsible for compliance could void the user's authority to operate the product.

**Note:** This product has been tested and found to comply with the limits for a Class B digital device pursuant to Part 15 of the FCC Rules, These limits are designed to provide reasonable protection against harmful interference in a residential installation.

This product generates, uses and can radiate radio frequency energy, and if not installed and used in accordance with the instructions, may cause harmful interference to radio communications. However, there is no guarantee that interference will not occur in a particular installation. If this product does cause harmful interference to radio or television reception, which can be determined by turning the product off and on, the user is encouraged to try to correct the interference by one or more of the following measures.

- Reorient or relocate the receiving antenna.
- Increase the distance between the product and receiver.
- Connect the product to an outlet on a circuit different from that to which the receiver is connected.
- Consult the dealer or an experienced radio/TV technician for assistance.



**Technical Support and E-Warranty Certificate**  
**[www.vevor.com/support](http://www.vevor.com/support)**