

Embrace the Freedom of Scalable Wireless Audio

VOCAL HUB

WIRELESS AUDIO SYSTEM



IPEVO

Have You Experienced The Frustration Of...

- 01 Dealing with time-consuming audio system installations and the wiring?
- 02 Struggling to be heard clearly, resulting in needing to raise participants' voice or constant movement to find the "sweet spot" near the audio device?

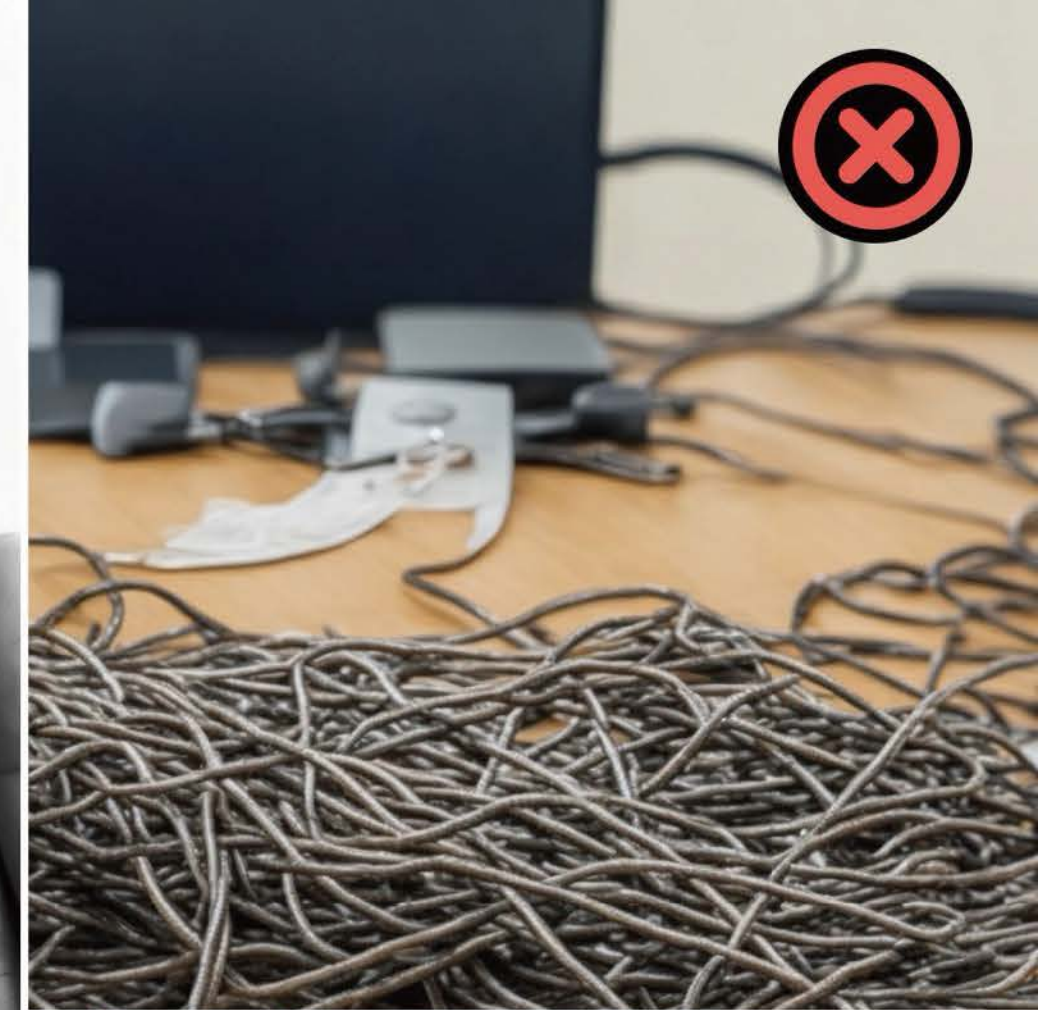

For Scattered Team Tables or Any Spaces without Any Media-Related Setup

Upgrade Your Boardroom: No Installation or Wiring Required

Transform Any Space Into a Hybrid Conferencing Hub
with Plug-and-Play Wireless Connectivity



Upgrade Any Space to 'Hybrid Conferencing Ready' with an Amazingly Efficient Approach in Minimal Time and Cost!

- 01** **No Pre-installation or Wiring Required. Go Wireless.**
- 02** **Unique:** You won't find anything similar anywhere else.
- 03** **Collaborate with Professional Channel Partners**

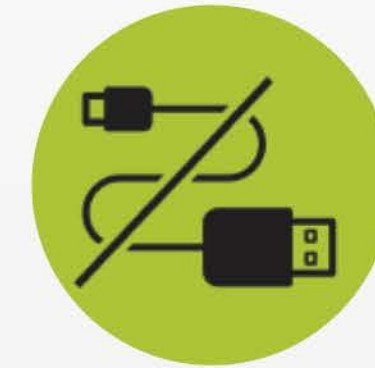

Convenient Wireless
Wireless Convenience with
40-hour Battery Time of
Speakerphone



Noise Reduction
World's First 2-way AI
Noise Reduction



Effortless Setup
Connect the HUB and Pair
the Bluetooth. Set up Can
be Done in 10 min



Unmatched Flexibility
Scalable And Fits Any
Meeting Room Design

IPEVO VOCAL HUB



Up to 50-Feet / 15M



IPEVO VOCAL



Seamless Sound & People-centric Audio

IPEVO VOCAL HUB Wireless Audio System **empowers your conference room (or Even Spaces Without Any Media Setup)** with seamless wireless audio. Let people hear and be heard well through its wireless and flexible design, offering excellent coverage.

No matter how the meeting is set up or where people are located, whether they are dispersed or grouped, everyone in the meeting can easily speak and hear. Simply pair up and rearrange to cover any space.

Say Goodbye to Audio Hassles in the Meeting Room!



Streamlined Setup

1. Simply plug in a VOCAL HUB via USB to your laptop running Microsoft Teams® or Zoom Rooms®.
2. Pair it with a VOCAL speakerphone (up to 6 units) , and your meeting is ready to begin.



Wide Coverage

Extend the reach in a flexible approach. Bluetooth wireless transmission, ensuring your audio is sent up to 50 feet with absolute confidence. Each VOCAL Speakerphone can capture and receive up to a 15-foot range.



Being Comfortable in Any Meeting, at Any Space

No pre-installation or wiring required. Go Wireless!

The IPEVO VOCAL HUB offers wireless and hassle-free deployment, making it suitable for various conference table setups. It ensures participants can enjoy comfortable meetings without the need to raise their voices or lean in close to the device.



Large Conference Rooms



Multi-purpose Rooms



U-shaped Meeting Rooms

The Revolutionary Wireless Conference Audio System

Adapted for Three Different User Scenarios:

Conference Room: No Construction Required!



A

New Conference Room Setup

Upgrade the Audio Coverage Wirelessly! Paired with your Camera/ Video Bar



B

Upgrade Existing System's Audio Wirelessly

Mobile Meeting – Connect and Expand the Audio Coverage on the Road or Any Space



C

Extend Audio Coverage For Mobile Devices

The Revolutionary Wireless Conference Audio System

Adapted for Three Different User Scenarios



New Conference Room Setup

Elevate your meetings with IPEVO's comprehensive solution, featuring 180 or 360-degree panoramic cameras (optional purchase), and expand the audio using the USB-connected VOCAL HUB, paired with up to six IPEVO VOCAL wireless Bluetooth speakerphones.

Benefits:

- (1) No Construction Required
- (2) Set up in 10 min
- (3) Bring Audio to People



The Revolutionary Wireless Conference Audio System

Adapted for Three Different User Scenarios



New Conference Room Setup

Capture Entire Meeting Spaces Instantly with a Plug-and-Play Panoramic Camera



360-degree

Immersive Conference Camera

Place the **TOTEM 360** in the center of your conference table.

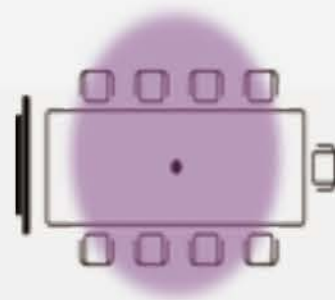

180-degree

Panoramic Conference Camera

Place the **TOTEM 180** at the front edge of the conference table or below the TV.

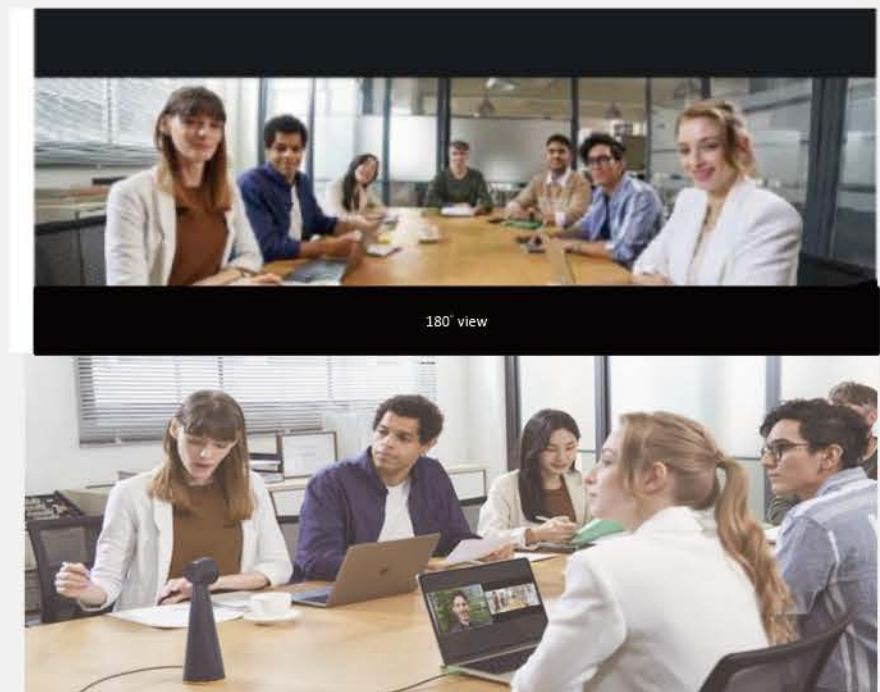
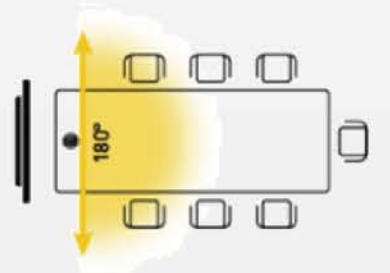

The Revolutionary Wireless Conference Audio System

Adapted for Three Different User Scenarios

A New Conference Room Setup

Utilize wireless conference audio systems to extend flexible coverage for your meeting spaces



IPEVO DUET | VOCAL DONGLE + 2 VOCAL



IPEVO QUARTET | VOCAL HUB + 4 VOCAL



IPEVO ENSEMBLE | VOCAL HUB + 6 VOCAL



The Revolutionary Wireless Conference Audio System

Adapted for Three Different User Scenarios

B Upgrade Existing System's Audio Wirelessly

Embrace enhanced flexibility and mobility with the wireless VOCAL HUB system, conquering dead zones for optimal sound capture. Upgrade with Line in / out of VOCAL HUB.



Benefits:

- (1) No Construction Required
- (2) Expand the Coverage by Wireless
- (3) Bring Audio to People

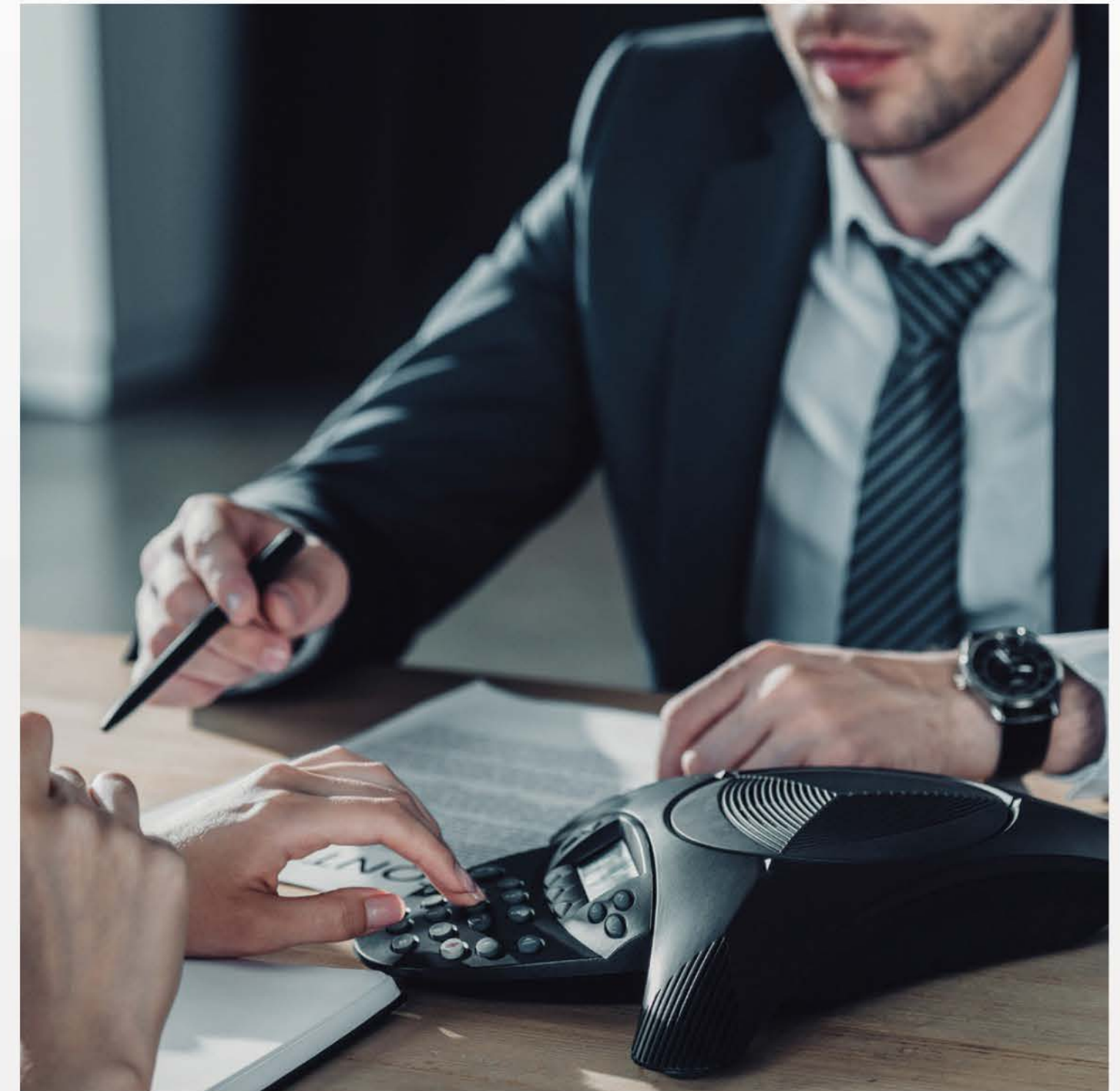

The Revolutionary Wireless Conference Audio System

Adapted for Three Different User Scenarios

C Extend Audio Coverage to Mobile Devices

Broaden the audio range of your mobile device (mobile phone) by connecting VOCAL HUB via Bluetooth.



Benefits:

- (1) Can Gather a Big Team on the Road
- (2) Expand the Mobile Device's Audio Coverage Wirelessly
- (3) Turn Any Space into a Conference Room, with 2-way Noise Reduction

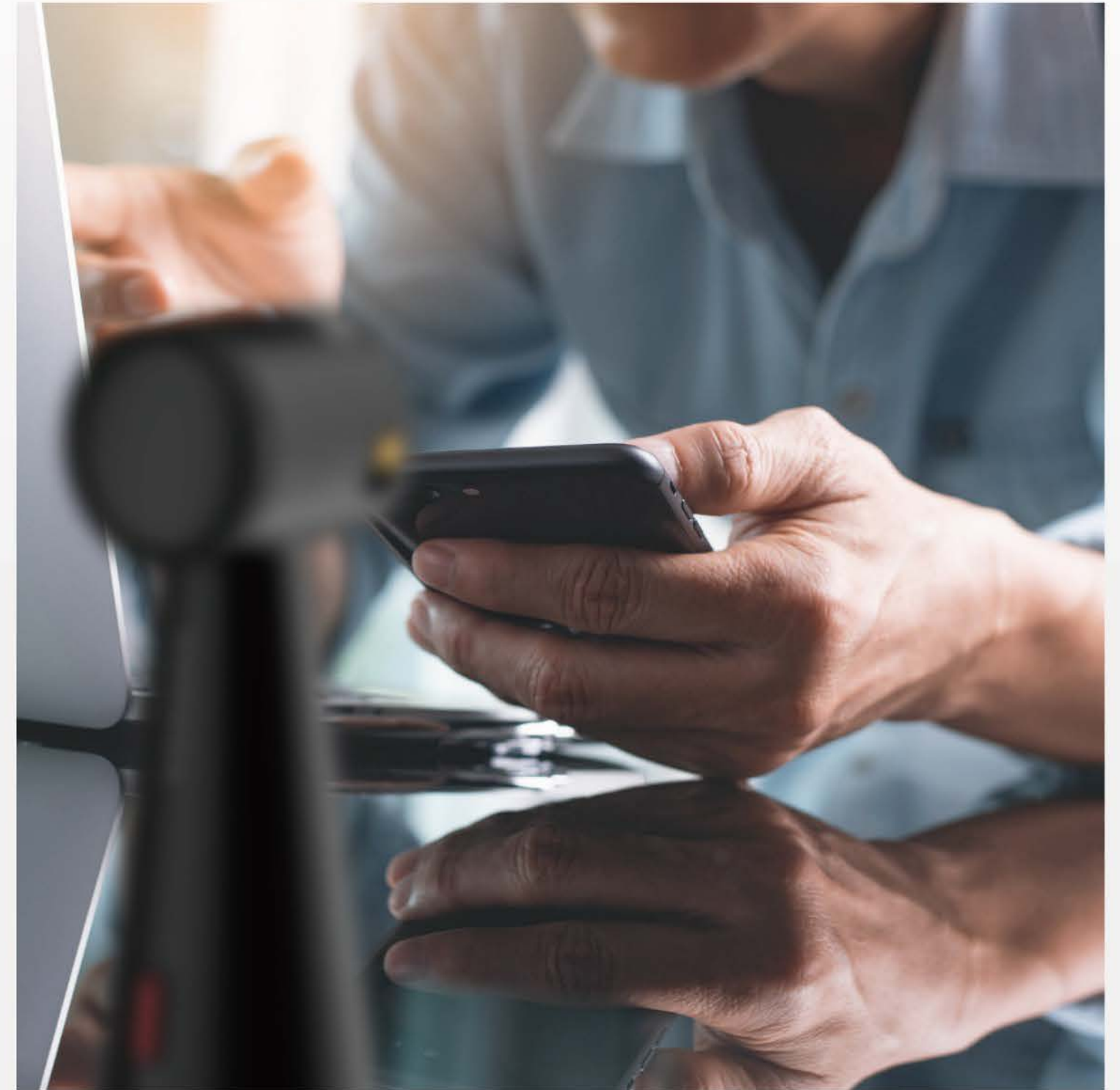

Connection Modes



USB Mode

Connect VOCAL HUB to your PC or laptop via USB.

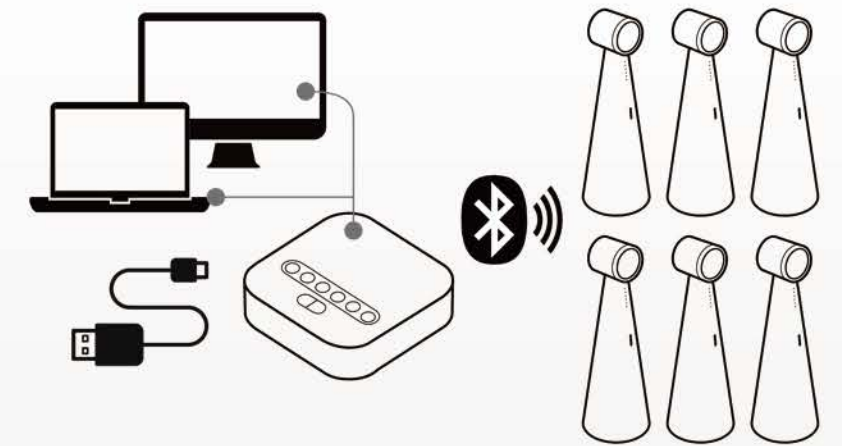

Bluetooth Mode

Connect VOCAL HUB to your PC, laptop, or mobile device such as mobile phones and tablets via Bluetooth.

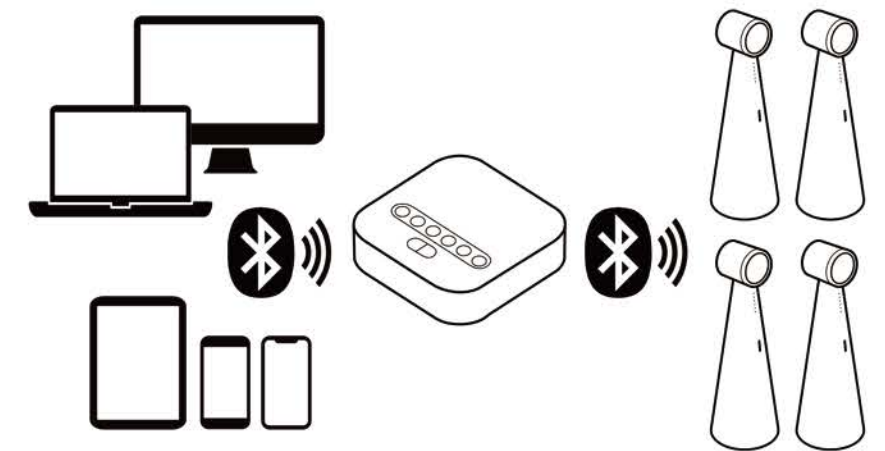

Line in / out Connection Mode

Connect VOCAL HUB to video equipment or audio systems equipped with 3.5mm line in / out connections.

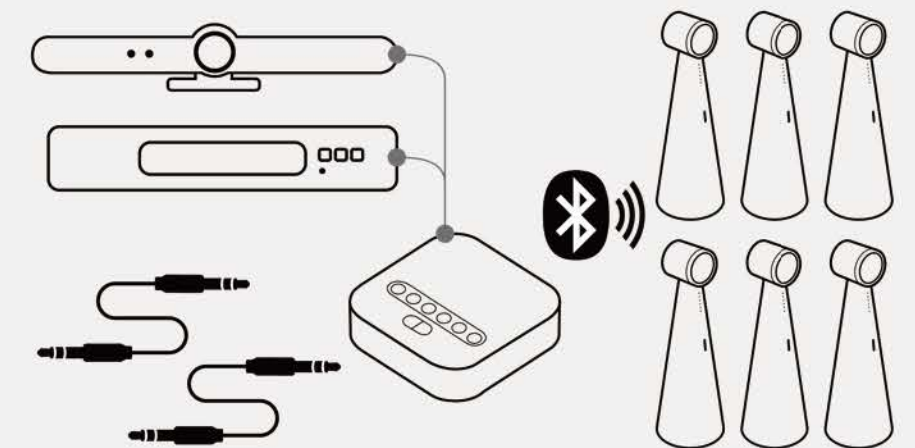

Specifications

IPEVO VOCAL HUB



Model	CDHB-01IP
Part Number	5-926-2-08-00
Size [L x W x H]	4.6" x 4.6" x 1.3" / 118 x 118 x 33 mm
Weight	0.33 lbs / 150 g
Color	Black
Operation Temperature	32°F to 140°F±35.6°F / 0°C to 60°C±2°C
Connectivity	USB,Bluetooth, 3.5 mm Line in / out
Bluetooth Range	Up to 49 ft / 15 m

Frequency	2,402 to 2,480 MHz
Audio Code	ADC SNR: 90 dB at 3.3 V, 85 dB at 1.8 V" DAC SNR: 100 dB at 3.3 V, 95 dB at 1.8 V"
Output Connectivity	USB Micro-B 2.0, Bluetooth 5.0
Compatibility	Mac, Windows, and Chromebook
Power Volt	DC 5 V±5% 500 mA
Built-in Features	<ul style="list-style-type: none">• Able to connect up to 6 IPEVO VOCAL speakerphones via Bluetooth• Easy installation: Bluetooth pairing and wall mount

*Features and specifications are subject to change without prior notice.

Specifications

IPEVO VOCAL



Model	CSCB-01IP
Part Number	5-907-2-08-00
Size [L x W x H]	2.8" x 2.8" x 9.5" / 72 x 72 x 242 mm
Weight	0.76 lbs / 345 g
Color	Black
Operation Temperature	32°F to 104°F / 0°C to 40°C
Bluetooth Range	Up to 98.4 ft / 30 m
Microphone Frequency Range	100 Hz to 8 KHz
Voice Pickup Range	16.40 ft / 5 m [with voice >65 dB]

Speaker Bandwidth [Speak Mode]	145 Hz to 20 KHz
Noise Reduction	Yes
Acoustic Echo Cancelation	Yes
Output Connectivity	USB Type C 2.0, Bluetooth 5.1
Battery Life	40 hrs when connected via Bluetooth at 50% speaker volume
Power Consumption	2.5 W 1 KHz@4.68 V: 326 mA
Built-in Features	<ul style="list-style-type: none">• 2-way AI noise reduction powered by IntelliGO• Omni-directional: 360° voice captureDirectional: 120° voice capture

*Features and specifications are subject to change without prior notice.

Specifications

IPEVO 2-VOCAL DONGLE



Model	CDDDB-01IP
Part number	5-927-2-08-00
Size (L x W x H)	2.12" x 0.55" x 0.39" / 54 x 14 x 10 mm
Weight	0.015 lbs / 7 g
Color	Black
Operation Temperature	32°F to 140°F/ 0 to 60°C±2°C
Connectivity	USB Type-A, Wireless
Wireless Range with VOCAL	up to 49.2 ft / 15 m
Wireless Bandwidth	2,400 to 2,483.5 MHz

Connectivity	USB Type-A, Wireless
Wireless Range with VOCAL	up to 49.2 ft / 15 m
Wireless Bandwidth	2,400 to 2,483.5 MHz
Compatibility	Mac, Windows, and Chromebook
Power Volt	DC 5 V±5% 100 mA
Built-in Features	<ul style="list-style-type: none">* Wireless connect 2 IPEVO VOCAL speakerphones* Plug and play: Automatically pair with saved settings* Wireless coverage over 49.2 ft [15 m]
Notice	For optimized audio quality, ensure a smooth network transmission and connect your computer to a power source.

*Features and specifications are subject to change without prior notice.

Package Contents

IPEVO ENSEMBLE

Part No. B-012-0-08-10

- IPEVO VOCAL HUB x 1
- 3.5mm audio cable (5.9 ft/1.8 m) x 2
- USB Micro-B to USB-A cable (5.9 ft/1.8 m) x 1
- IPEVO VOCAL x 6
- Quick Installation Guide x 1
- Carry Bag x 1
- USB charging station x 1



IPEVO QUARTET

Part No. B-013-0-08-10

- IPEVO VOCAL HUB x 1
- 3.5mm audio cable (5.9 ft/1.8 m) x 2
- USB Micro-B to USB-A cable (5.9 ft/1.8 m) x 1
- IPEVO VOCAL x 4
- Quick Installation Guide x 1
- Carry Bag x 1
- USB charging station x 1



IPEVO DUET

Part No. B-014-0-08-00

- IPEVO 2-VOCAL DONGLE x 1
- USB-A to C adapter x 1
- Pin x 1
- IPEVO VOCAL x 2
- Quick Installation Guide x 1

*For optimized audio quality, ensure a smooth network transmission and connect your computer to a power source.



*Features and specifications are subject to change without prior notice.

Now, Boost your Productivity with the Power of AI



Transcribe,
Translate,
Summarize Any
Conversation With AI

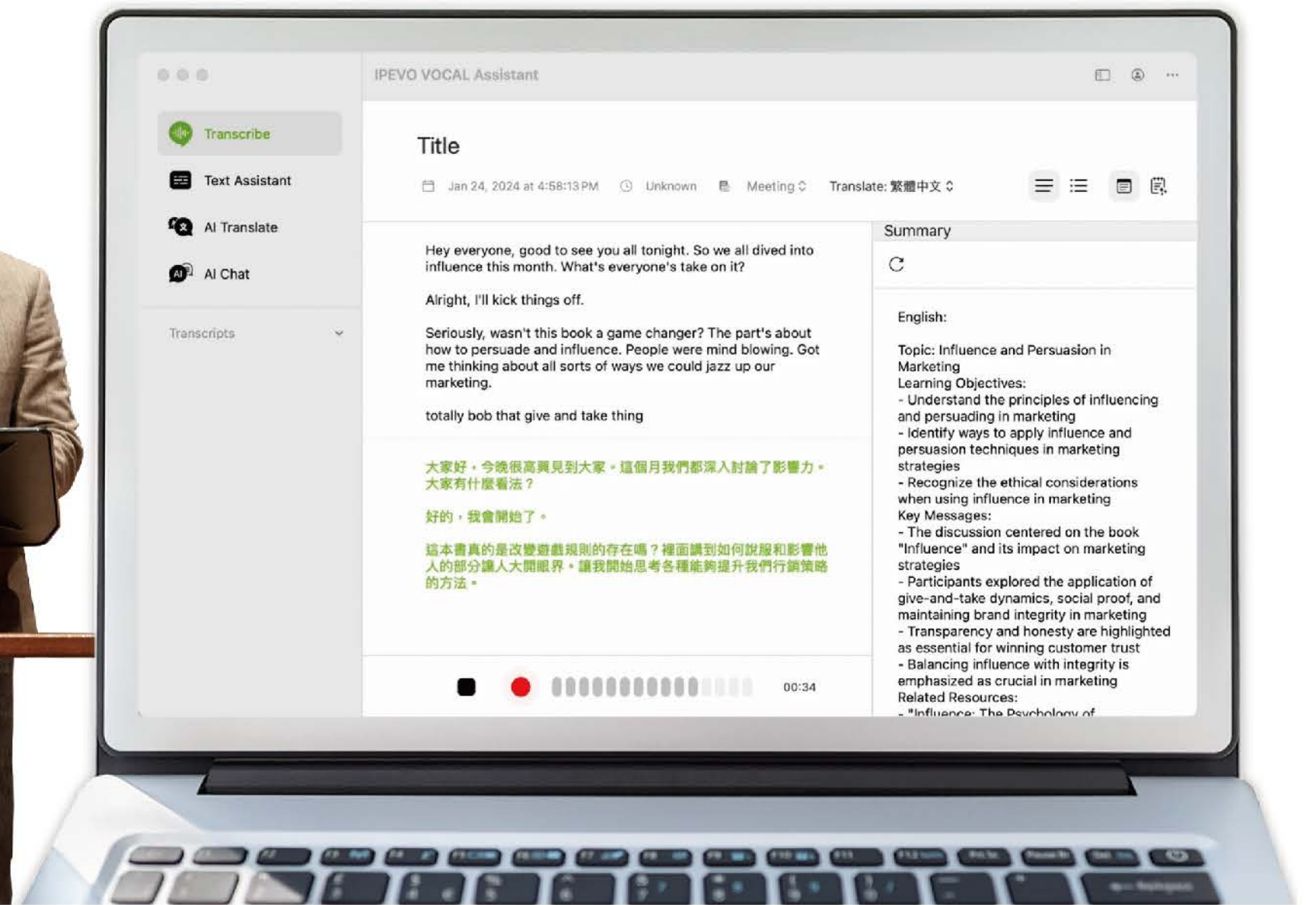

Transcribe



Text Assistant



AI Translate



AI Chat

*Features and specifications are subject to change without prior notice.

IPEVO

Thank You

Contact us: salesus@ipevo.com

Learn more: <https://us.ipevo.com/pages/vocal-hub>



Video: <https://www.youtube.com/watch?v=eONLEBZZTzA>