

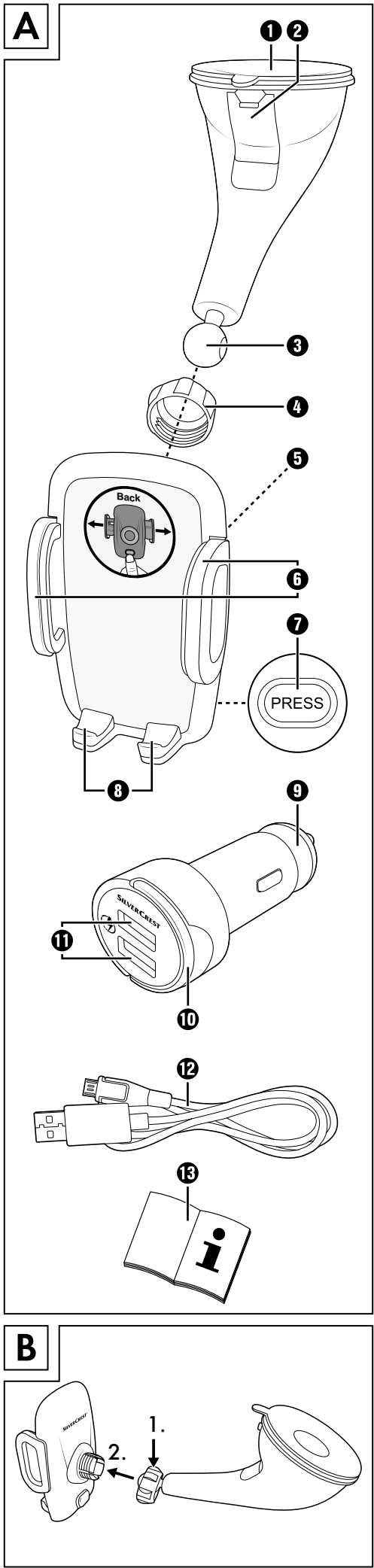

CAR SMARTPHONE MOUNT
SKHU 2 A1

GB IE NL
CAR SMARTPHONE MOUNT
Operating instructions and safety instructions



Introduction

■ Congratulations on the purchase of your new device.
You have selected a high-quality product. The operating instructions are part of this product. They contain important information about safety, usage and disposal. Before using the product, please familiarise yourself with all operating and safety instructions. Use the product only as described and for the range of applications specified. Retain these instructions for future reference. Please also pass these operating instructions on to any future owner.

Intended use

The car cradle is an information electronics device and is used for holding mobile phones (and other 5 V devices with a USB connection) in the car and charging them at the same time. The car USB adapter is only intended for vehicles with a cigarette lighter whose negative pole is connected to earth.

■ **Smart Fast Charge** Reduced charging times are made possible for compatible devices by the use of the Smart Fast Charge Technology. Compatible connected devices automatically receive the signal to draw the maximum available charging current.

Any other use is considered to be improper, and can result in damage and injuries. Claims of any kind for damage resulting from improper use or unauthorised modifications will not be considered. This product is for private use only, and is not intended for commercial use.

Notes on trademarks

USB® is a registered trademark of USB Implementers Forum, Inc.
The SilverCrest trademark and the retail name are the property of their respective owner.
All other names and products may be trademarks or registered trademarks of their respective owner.

Warnings and symbols used

■ **DANGER**
A warning notice at this hazard level indicates an imminently hazardous situation.
Failure to avoid this hazardous situation could result in serious injuries or even death.
▶ Follow the instructions in this warning notice to avoid the risk of death or serious injury.

■ **CAUTION**
A warning notice of this hazard level indicates a risk of property damage.
Failure to avoid this situation could result in property damage.
▶ Follow the instructions in this warning notice to prevent property damage.

■ **NOTE**
▶ A note provides additional information which will assist you in using the device.

■ **E24** The E marking is a test mark for the labelling of components requiring approval in motor vehicles and states that the necessary tests have been carried out and that an ECE component approval has been issued.

Safety information

- This device is not intended for use by people (including children) with reduced physical, sensory or mental abilities or for those without experience and/or knowledge, unless they are supervised by a person responsible for their safety or they have been instructed in its use.
- Children must be supervised to ensure that they do not play with the device.

■ **DANGER**
▶ Packaging materials (such as plastic film or rigid foam) may not be used as playthings.
There is a risk of suffocation!

- Check the device for visible external damage before use. Do not use a device that has been damaged or dropped.
- To avoid possible risks, arrange for damaged cables or connectors to be exchanged by an authorised specialist or the Customer Service Department.
- Never open the device, and never carry out any repairs yourself.
- Do not allow any liquids or moisture to get into the device.
- Never subject the device to extreme heat or humidity. This applies especially to storage in a car. High temperatures occur in the car interior and the glove compartment if the car is stationary for extended periods in hot weather with direct sunlight. Remove electrical and electronic devices from the vehicle.
- When fitting the cradle, ensure that it does not get in the way of steering, braking or the deployment of other vehicle systems (such as airbags) and does not restrict your field of view when driving.
- **DANGER** Do not place the car cradle in or near the airbag deployment area, as the cradle could be flung through the vehicle interior in the event of airbag deployment, which could cause serious injuries.
- Ensure that the cradle is not installed in a location in which you could come into contact with it in the event of an accident or collision.
- Please also pay attention to your mobile phone/equipment operating instructions.
- If you notice a burning smell or smoke coming from your device, disconnect it from the cigarette lighter immediately.
- **DANGER** Under no circumstances should the smoke be inhaled as this could be harmful to your health.
- Check regularly to ensure that the suction cup at the bottom end of the cradle is securely attached to the windscreen. This is especially important in areas where extreme outside temperature fluctuations occur.
- All of the applicable laws in your location must be observed. Your hands must always be free to operate the vehicle safely when you are driving. Traffic safety must always take priority whilst driving. Use this cradle only if no hazard is likely to occur in any driving situation.

Operating components

- 1 Suction cup
- 2 Suction cup locking lever
- 3 Ball joint
- 4 Screw ring
- 5 Ball joint socket
- 6 Car cradle fixer grips
- 7 **PRESS** button
- 8 Supports of the car cradle
- 9 Car USB adapter
- 10 Pull ring
- 11 USB connections
- 12 Charging cable (USB to micro-USB)
- 13 Operating instructions (symbol)

Technical details

Model	SKHU 2 A1
Input voltage/current	12–24 V \equiv (direct current), max. 1.2 A
Output voltage, current	5 V \equiv (direct current), max. 2.1 A*
Distance between cradle fixer grips	approx. 5.0–9.0 cm
Dimensions (cradle)	approx. 11.0 x 6.7 x 3.9 cm
Weight (cradle)	approx. 145 g
Dimensions (car USB adapter)	approx. 5.2 x 3.4 x 3.0 cm
Weight (car USB adapter)	approx. 22 g
Protection class (car USB adapter)	III/ \diamond (Protection through extra low voltage)
Operating temperature	15 °C to 40 °C
Storage temperature	0 °C to 55 °C
Relative humidity	\leq 75% (no condensation)

*When both USB connections 11 are being used simultaneously, the total power consumption of the connected devices may not exceed 2.1 A.

Notes on the EU Declaration of Conformity

■ **CE** This device complies with the basic requirements and other relevant provisions of the EMC Directive 2014/30/EU, UN Directive R10 and RoHS Directive 2011/65/EU.
The complete EU Declaration of Conformity is available from the importer.

Check package contents

Before using the device for the first time, check the package content to ensure that it is complete and free of visible damage (see fig. A). If any items are missing or damaged as a result of defective packaging or transportation, contact the service hotline (see section **Service**). Remove all parts from the packaging, and then remove all packaging material from the device.

- Car cradle with suction cup (consisting of two parts)
- Car USB adapter 9
- Charging cable (USB to micro-USB) 12
- These operating instructions 13

Handling and use

Fitting the car cradle

- ◆ Unscrew the screw ring ④ anticlockwise from the car cradle.
- ◆ Place the screw ring ④ over the ball joint ③ and press the ball joint ③ into the ball joint socket ⑤ (see fig. B).
- ◆ Screw the screw ring ④ clockwise onto the ball joint socket ⑤ until tight

Fitting the suction cup

Ensure that the surface to which you wish to attach the suction cup is clean, dry and free of grease. Ensure that the suction cup locking lever ② has been released.

- ◆ Press the suction cup ① firmly against the windscreen and push the suction cup locking lever ② upwards. This creates suction, and the suction cup ① is pulled tightly against the windscreen.
- ◆ You can use the 360° rotating ball joint ③ to adjust the car cradle horizontally and vertically to suit your requirements. Loosen the screw ring ④ slightly to make it easier to adjust the ball joint ③.
- ◆ To remove the suction cup ① from the windscreen, pull the suction cup locking lever ② downwards and lift the small tab on the edge of the suction cup.

Inserting your mobile phone into the car cradle

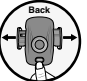
- ◆  Press the **PRESS** button ⑦ on the rear of the device and the fixer grips ⑥ of the car cradle automatically move outwards.
- ◆ Place your mobile phone on the supports ⑧ of the car cradle.
- ◆ Push the car cradle fixer grips ⑥ inwards until the mobile phone is held firmly in place.
- ◆ Press the **PRESS** button ⑦ to remove the mobile phone from the car cradle.

Charging the mobile phone

- ◆ Connect the car USB adapter ⑨ to your vehicle's on-board power supply (cigarette lighter). The white LED in the housing indicates that the car USB adapter ⑨ is ready for use. Depending on the vehicle type, it is possible that the ignition has to be switched on first.
- ◆ Connect the charging cable ⑫ to one of the USB connections ⑪ on the car USB adapter ⑨ and the mobile phone. Charging starts immediately and is indicated on the display of the mobile phone.
- ◆ After charging, remove the car USB adapter ⑨ from the cigarette lighter by pulling on the pull ring ⑩.

CAUTION

- ▶ In vehicles in which the cigarette lighter also works with the ignition switched off, the device must be disconnected from the cigarette lighter after use. Otherwise, the vehicle battery may be discharged over a long period of time, since the device also uses power when it is idle.

Troubleshooting

A connected device will not charge (the white LED in the housing does not light up).

- ◆ No connection to the car's cigarette lighter socket. Check the connection.
- ◆ Depending on the vehicle type, it is possible that the ignition has to be switched on first.

The white LED in the device housing goes out when a device is connected.

- ◆ The car USB adapter ⑨ is overloaded and will no longer charge attached devices. The internal over-current protection has been triggered. Disconnect all connected devices from the car USB adapter ⑨. The white LED lights up immediately and the charger is ready for use.

NOTE

- ▶ If you cannot solve the problem with the suggested solutions, please contact the Service Hotline (see section **Service**).

Cleaning and maintenance

CAUTION

- ▶ Always disconnect the device from the cigarette lighter during cleaning and when it is not being used.
- When necessary, clean the device with a soft cloth. Check the condition of the device at regular intervals. Do not continue to use the device if you notice any damage.

Storage when not in use

CAUTION

- ▶ The temperatures inside the vehicle can reach extreme values in summer and winter. Prevent heat damage: do not leave the device in the vehicle.
- Store the device somewhere clean, dry, free of dust and out of direct sunlight.

Disposal

Disposal of the device

 The symbol shown on the left of a crossed-out wheeled bin means that this device is subject to Directive 2012/19/EU. This directive states that this device may not be disposed of in normal household waste at the end of its useful life, but must be taken to a specially set-up collection point, recycling depot or disposal company.

This disposal is free of charge for the user. Protect the environment and dispose of this device properly.



You can obtain further information from your local disposal company or the city or local authority.

Disposal of packaging

 The packaging materials have been selected for their environmental compatibility and ease of disposal, and are therefore recyclable. Dispose of packaging materials that are no longer needed in accordance with applicable local regulations.

 Note the labelling on the packaging and separate the packaging material components for disposal if necessary. The packaging material is labelled with abbreviations (a) and numbers (b) with the following meanings:

- 1–7: Plastics,
- 20–22: Paper and cardboard,
- 80–98: Composites.

Kompernass Handels GmbH warranty

Dear Customer,

This appliance has a 3-year warranty valid from the date of purchase. If this product has any faults, you, the buyer, have certain statutory rights. Your statutory rights are not restricted in any way by the warranty described below.

Warranty conditions

The warranty period starts on the date of purchase. Please keep your receipt in a safe place. This will be required as proof of purchase.

If any material or manufacturing fault occurs within three years of the date of purchase of the product, we will either repair or replace the product for you or refund the purchase price (at our discretion). This warranty service requires that you present the defective appliance and the proof of purchase (receipt) within the three-year warranty period, along with a brief written description of the fault and of when it occurred.

If the defect is covered by the warranty, your product will either be repaired or replaced by us. The repair or replacement of a product does not signify the beginning of a new warranty period.

Warranty period and statutory claims for defects

The warranty period is not prolonged by repairs effected under the warranty. This also applies to replaced and repaired components. Any damage and defects present at the time of purchase must be reported immediately after unpacking. Repairs carried out after expiry of the warranty period shall be subject to a fee.

Scope of the warranty

This appliance has been manufactured in accordance with strict quality guidelines and inspected meticulously prior to delivery.

The warranty covers material faults or production faults. The warranty does not extend to product parts subject to normal wear and tear or to fragile parts which could be considered as consumable parts such as switches, batteries or parts made of glass.

The warranty does not apply if the product has been damaged, improperly used or improperly maintained. The directions in the operating instructions for the product regarding proper use of the product are to be strictly followed. Uses and actions that are discouraged in the operating instructions or which are warned against must be avoided.

This product is intended solely for private use and not for commercial purposes. The warranty shall be deemed void in cases of misuse or improper handling, use of force and modifications/repairs which have not been carried out by one of our authorised Service centres.

Warranty claim procedure

To ensure quick processing of your case, please observe the following instructions:

- Please have the till receipt and the item number (e.g. IAN 12345) available as proof of purchase.
- You will find the item number on the type plate on the product, an engraving on the product, on the front page of the operating instructions (below left) or on the sticker on the rear or bottom of the product.
- If functional or other defects occur, please contact the service department listed either by **telephone** or by **e-mail**.

- You can return a defective product to us free of charge to the service address that will be provided to you. Ensure that you enclose the proof of purchase (till receipt) and information about what the defect is and when it occurred.



You can download these instructions along with many other manuals, product videos and installation software at www.lidl-service.com.

This QR code will take you directly to the Lidl service page

(www.lidl-service.com) where you can open your operating instructions by entering the item number (IAN) 123456.

Service

GB Service Great Britain
Tel.: 0800 404 7657
E-Mail: kompernass@lidl.co.uk

IE Service Ireland
Tel.: 1890 930 034
(0,08 EUR/Min., (peak))
(0,06 EUR/Min., (off peak))
E-Mail: kompernass@lidl.ie

IAN 315073

Importer

Please note that the following address is not the service address. Please use the service address provided in the operating instructions.

KOMPERNASS HANDELS GMBH
BURGSTRASSE 21
DE-44867 BOCHUM
GERMANY
www.kompernass.com