

PR[↻]AIM SnapRig Professional Kit (RS274)

Assembly Manual



What's In The Box

Please inspect the contents of your shipped package to ensure you have received everything that is listed below.



15mm Baseplate with
Quick Release Plate



2 x 12" 15mm Aluminium Rods



1 x Top Plates



15mm Road Clamp Adapter



Dovetail Plate



1x L-Type Allen Keys (Sizes: 4mm)

All rights reserved.

No part of this document may be reproduced, stored in a retrieval system, or transmitted by any form or by any means, electronic, mechanical, photo-copying, recording, or otherwise, except as may be expressly permitted by the applicable copyright statutes or in writing by the Publisher.

SnapRig Kit Setup

- Loosen the knob of the Fluid head (Not Included).



- Then remove the quick-release plate by pushing the push-pin knob on the back of the fluid head (Not Included).



- Now attach the quick-release plate by aligning it with the dovetail plate, and then secure the assembly using the bolt with a screw driver.

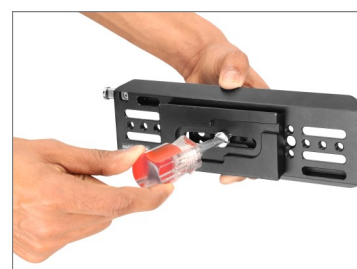

- Press the push-pin button of the fluid head and then slide and insert the dovetail plate.



- Properly tighten the knob of the Fluid head (Not Included).



Baseplate with Quick Release Plate

- Loosen the knob of the baseplate with quick-release Plate.



- Push the pin affixed to the dovetail plate, as shown in the image.



- Then slide and insert the baseplate and secure it by tightening its knob.



- Baseplate has now been properly attached to the dovetail plate.



- Loosen both the knobs of the baseplate.



- Then insert the Aluminum rod into the baseplate.



- Similarly, follow the same procedure for attaching another Aluminum Rod to Baseplate.

NOTE: The baseplate mounts securely to an ARRI-standard dovetail plate, with safety latches on each end to secure your gear. It easily attaches to a tripod or fluid head via 1/4"-20 and 3/8"-16 mounting threads on the dovetail plate.

- Now push the press button of the baseplate and remove the quick-release plate. Attach the quick-release plate to the base of the camera. Mount the FX6 camera (Not Included) by sliding it over the baseplate.



- The camera mounts onto the quick-release plate that further mounts the camera onto the 15mm LWS baseplate.

Compatible Camera :

Sony FX6 cinema camera



**YOUR PROAIM SNAPRIG PROFESSIONAL KIT
ALL DRESSED UP AND READY TO GO!**



(SHOWN WITH OPTIONAL ACCESSORIES)

Warranty: We offer one year warranty for our products from date of purchase. Within this period of time, we will repair it without charge for labor or parts. Warranty doesn't cover transportation costs nor does it cover a product subjected to misuse or accidental damage. Warranty repairs are subjected to inspection and evaluation by us.

Liability: We are not liable for damage caused by products that we do not supply or from mishandling in transit, accident, misuse, neglect, lack of care of the product, or service by anyone other than our company.

Contact Us: In case of any kind of dissatisfaction, please Contact us immediately and we promise our utmost support and care until you use our product.