

---

## RV RANGE 3-BURNER COOKTOP

MODEL (LIPPERT PN)

FGH3Z23-BL (NA) FGH3Z23-SS(NA) FGH3Z25-BL(2021123561)

FGH3Z25-SS (NA) FGHWCLDA-BL (2021123893)

FGHWCLDA-SS (2021123926)

---

## TROUBLESHOOTING AND SERVICE MANUAL

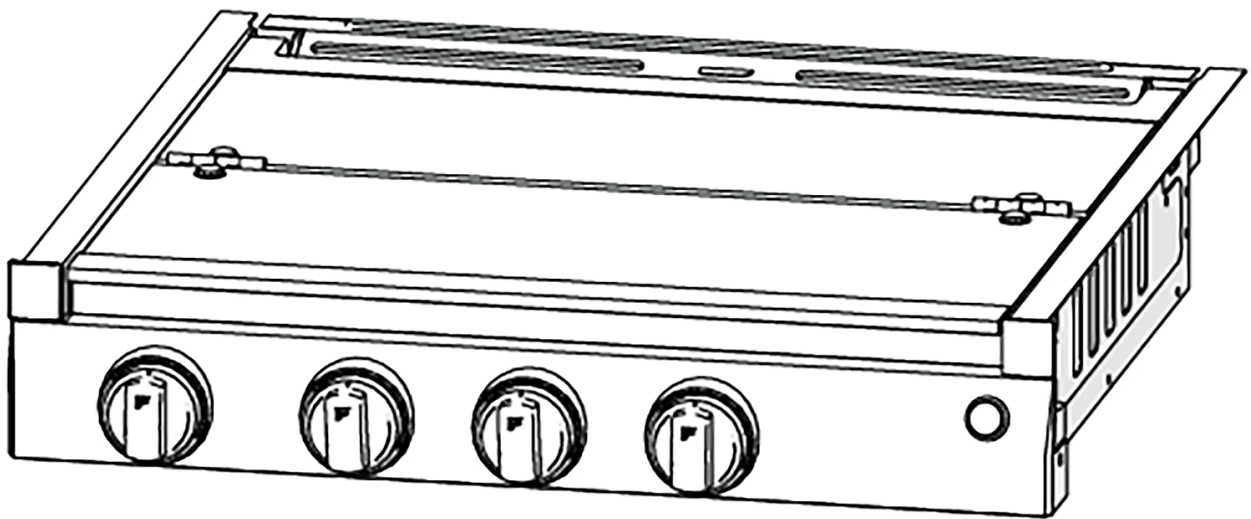

\* Picture shown here is for reference only.

This manual contains the product's basic information, safety, maintenance, replaceable parts, fault diagnosis and basic troubleshooting procedures.

# TABLE OF CONTENTS

Introduction .....	2
Safety .....	2
Safety Precautions .....	3
What to do if you smell gas: .....	3
Safety Instructions .....	3
Pressure Check .....	4
Gas Leak Check .....	5
Cleaning and Maintenance .....	5
Replacable Parts List .....	6
Troubleshooting .....	7
Specifications .....	8
Introduction .....	

This document provides an overview on replaceable parts for Furrion® RV Range 3-Burner Cooktop, as well as basic troubleshooting and service information.

**NOTE:** Images used in this document are for reference only when assembling, installing and/or operating this product. Actual appearance of provided and/or purchased parts and assemblies may differ. For more detailed operation, including general safety instructions, warnings and cautions, see Instruction Manual at: <https://lci-support-doc.s3.amazonaws.com/Furrion/ccd-0005573.pdf> or scan this QR code:



## Safety

Read and understand all instructions before installing or operating this product. Adhere to all safety labels.

This manual provides general instructions. Many variables can change the circumstances of the instructions, i.e., the degree of difficulty, operation and ability of the individual performing the instructions. This manual cannot begin to plot out instructions for every possibility, but provides the general instructions, as necessary, for effectively interfacing with the device, product or system. Failure to correctly follow the provided instructions may result in death, serious personal injury, severe product and/or property damage, including voiding of the Lippert limited warranty.

### **WARNING**

The "WARNING" symbol above is a sign that a procedure has a safety risk involved and may cause death or serious personal injury if not performed safely and within the parameters set forth in this manual.

### **WARNING**

Failure to follow instructions provided in this manual may result in death, serious personal injury and/or severe product and property damage, including voiding of the component warranty.

### **CAUTION**

The "CAUTION" symbol above is a sign that a safety risk is involved and may cause personal injury and/or product or property damage if not safely adhered to and within the parameters set forth in this manual.

## CAUTION

**Always wear eye protection when performing service, maintenance or installation procedures. Other safety equipment to consider would be hearing protection, gloves and possibly a full face shield, depending on the nature of the task.**

## Safety Precautions

### WARNING

**If the information in this manual is not followed exactly, a fire or explosion may result causing property damage, personal injury or death.**

Do NOT store or use gasoline or other flammable vapors or liquids near this or any appliance.

### What to do if you smell gas:

- Do NOT try and light any appliance.
- Do NOT touch any electrical switch.
- Do NOT use any phone in your recreational vehicle.
- Clear the recreational vehicle of all occupants.
- Turn off gas supply tank valve(s) or main gas supply.
- From a safe distance from the gas smell, immediately call your gas supplier for instructions.
- If you cannot reach your gas supplier, call the fire department.
- Have a gas system checked and leakage source corrected by a qualified installer, service agency, manufacturer of dealer or the gas supplier.

Follow all instructions before using this appliance to prevent the potential risk of fire, electric shock, personal injury or damage to the appliance as a result of improper usage of the appliance. Use appliance only for it's intended purpose as described in this guide.

If an external electrical source is utilized, the appliance must be electrically grounded in accordance with state or other codes or, in the absence of such codes, with the National Electrical Code (AN51/NFPA70). Do not attempt to adjust, repair, service, or replace any part of your appliance unless it is specifically recommended in this guide. Other services should be referred to a qualified service technician.

Warning and important safety instructions appearing in this guide are not meant to cover all possible conditions and situations that may occur. Common sense, caution, and care must be exercised when installing, maintaining, or operating the appliance. Always contact the manufacturer about problems or conditions you do not understand.

## Safety Instructions

To reduce risk of tipping of the appliance from abnormal usage or by excessive loading of the cooktop.

- Your appliance should be installed by a qualified technician in accordance with state and local laws.
- Never modify or alter the construction of a cooktop by removing leveling legs, panels, anti-tip brackets/screws, or any other part of the product.

Do NOT store items of interest to children in the cabinets above a cooktop. Children climbing on the cooktop to reach items could be seriously injured.

### WARNING

**NEVER use this appliance as a space heater to warm a room. Doing so may result in carbon monoxide poisoning and overheating the oven.**

## ⚠ WARNING

**NEVER cover rear vent on cooktop, or internal cavity holes.**

- The appliance and its individual shutoff valve must be disconnected from the gas supply piping system during any pressure testing of that system at test pressures in excess of 1/2psi (3.5 kPa).
- The appliance must be isolated from the gas supply piping system by closing its individual manual shutoff valve during any pressure testing of the gas supply piping system at test pressures equal to or less than 1/2psi (3.5 kPa).

### Pressure Check

1. Turn LP gas off to the appliance.
2. Remove the Screw with the sealing gasket from the pressure test port on the range. (Fig. 1)

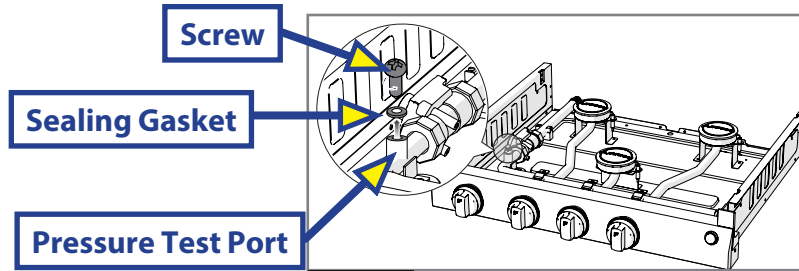

Fig. 1

3. Using the rubber tube from the pressure check measuring device, slide the rubber tube down over the gas pressure test port. The rubber tube should seal around the pressure test port on the range.
4. Turn on the LP gas to the appliance.
5. The pressure gauge tester should measure between 10" WC to 13.8" WC. (Fig. 2)

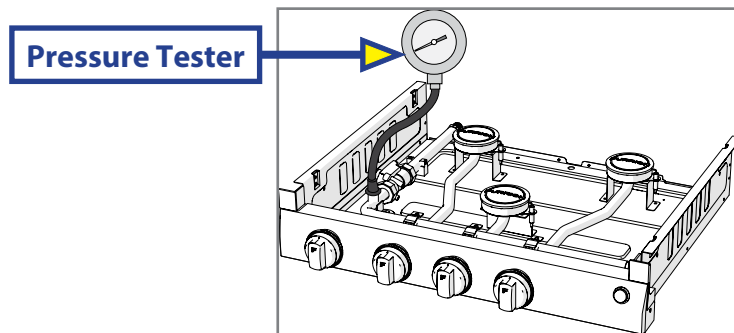

Fig. 2

6. Turn off the LP gas to the appliance.
7. Remove the rubber tube of the pressure check measuring device.
8. Replace the screw with the gasket from step 2. Before replacing the screw, inspect the rubber gasket seal for any signs of damage. Replace seal if damaged.
9. Tighten the screw to 1.3 Nm to 1.7 Nm.

**NOTE:** Ensure the product is gas leak checked after the pressure check test is completed by also testing the pressure check port screw. If any leaks are detected around the pressure check port screw and gasket, a new one can be purchased. Call Furrion support for a replacement.

## Gas Leak Check

Always perform a leak test for possible leaks according to the manufacturer's instructions before any operation. Pressure/Leak test using 11-13.8 WC pressure.

### **WARNING**

**Extinguish all open flames. NEVER Leak test when smoking. Do not use the oven until connection has been leak tested and does not leak.**

1. Make sure all control knobs are turned to OFF position.
2. Apply a gas leak detection liquid such as soapy water to the connections.
3. Gas leaks will be detected with the presence of bubbles.
4. To stop the leak, tighten the loose joint, or replace the faulty part with a replacement part recommended by dealer.

### **WARNING**

**Gas leaks may occur in your system and result in a dangerous situation. Gas leaks may not be detected by smell alone. Gas suppliers recommend you purchase and install a UL approved gas detector. Install and use accordance with the manufacturer's instructions.**

## Cleaning and Maintenance

- Make sure all controls are OFF and the range or cooktop is cool before cleaning.
- Do NOT use oven cleaners, bleach, steel wool or rust removers on the cooktop or burner grates. Only use nonabrasive pads.
- Do NOT obstruct the flow of combustion and ventilation air.
- Keep appliance area clean of combustible materials, gasoline and other flammable vapors and liquids.
- Never use a wire brush or metallic item for cleaning burner ports or orifices. Brush may "shed" bristles that may lodge in the orifice or burner ports and cause a fire or explosion.
- Use warm soapy water only to clean the burner grates, cooktops, painted surfaces, porcelain surfaces, stainless steel surfaces and plastic items on your range or cooktop. Do not use gritty or acid-type cleaners.
- Do NOT allow foods containing acids (such as lemon or tomato juice, or vinger) to remain on porcelain or painted surfaces. Acids may remove the glossy finish. Wipe up egg spills when cooktop is cool.
- Do NOT wash warm porcelain surfaces. Allow these areas to cool before cleaning. You could burn yourself, or the porcelain could crack.
- Pitting and discoloration will result if spills are allowed to remain for any length of time on stainless steel.
- Do NOT allow spillovers to remain on the burner caps. The caps could become permanently stained.
- When cleaning around the burners, use care to prevent damage to the electrode (if so equipped). If a sponge or cloth should catch the metal igniter electrode, it could damage or break the electrode. If this occurs, the burner will not light.

Replacable Parts List

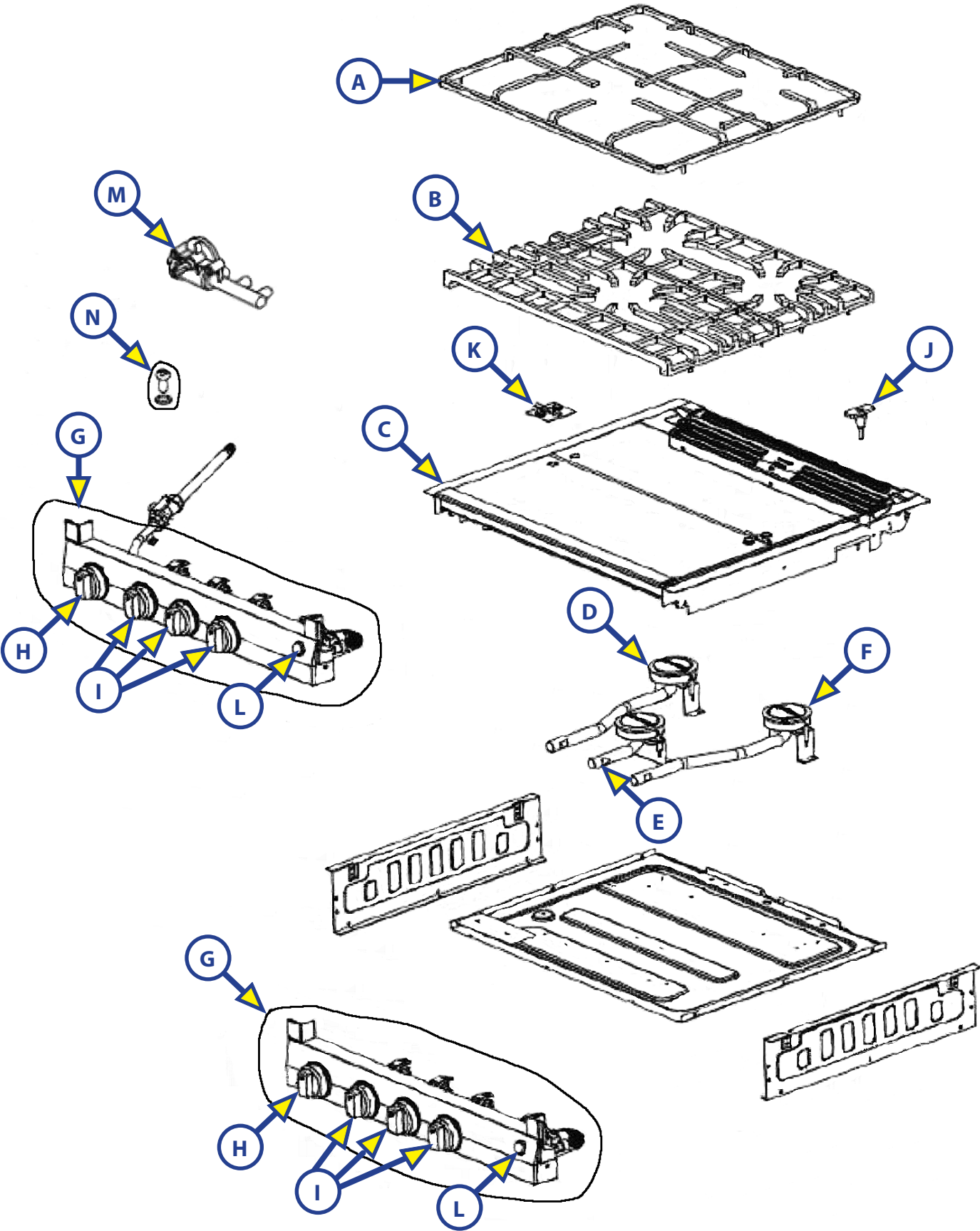



Callout	Part #	Description	Model
A	<a href="#">2021124428</a>	Wired Grate^	All
B	<a href="#">2021123565</a>	Diecast Grate^	All
C	<a href="#">2021124174</a>	Top-Tray Module	All
D	<a href="#">2021124193</a>	Left Burner Module	All
E	<a href="#">2021124286</a>	Middle Burner Module	All
F	<a href="#">2021124140</a>	Right Burner Module	All
G	<a href="#">2021124480</a>	Front Panel Module (Stainless Steel) (All Knobs Included)	FGHWCLDA-SS
	2021149669	Front Panel Module (Black) (All Knobs Included)	FGHWCLDA-BL
H	<a href="#">2021124228</a>	Ignition Knob assembly (including ignition knob and LED PCBA)	All
I	2021124467	Range Knob Assembly (including Range Knob and LED PCBA)	All
J	<a href="#">2021124303</a>	Cooktop Grill Holding Gasket*	All
K	<a href="#">2021124283</a>	Glass Cover Middle Hinge Module* (2 Hinges per set)	All
L	2021149653	Light Switch (Black)	FGHWCLDA-BL/SS
M	<a href="#">2024004473</a>	Ignitor for 3-Burner Cooktop	All
N	<a href="#">2021124505</a>	Gas Pressure Inspection Screw + Rubber O-Ring	All

^A – Wired grill is default to be sold with FGH3Z25-BL/SS and FGHWCLDA-BL/SS. But A & B are interchangeable.

^B - Die cast grill is default to be sold with FGH3Z23-BL/SS. But A & B are interchangeable.

\*J – Each cooktop needs 8pcs of cooktop grill holding gasket.

\*K – Each cooktop needs 2pcs of Glass cover middle hinge module.

## Troubleshooting

Trouble/Symtom	Cause/Solution
Surface burners do not light or burn evenly	Surface control knob has not been fully rotated to the LIGHT position.
	Check to see if gas valve is open. If not, open it.
	Burners are clogged. Make sure burner is off. Use a small wire toothbrush or needle to clean burner slots.
	Low gas level in tank. Refill or replace gas tank,
Surface burner flame burns half way around	There is moisture on the burner. With burner off, dry burner completely.
	Burner ports or slots are clogged. With the burner off clean ports with a small-gauge wire or needle to clean ports or slots.
	Moisture is present after cleaning. Lightly fan the flame and allow burner to operate until flame is full. Dry the burners thoroughly.
Surface burner flame is yellow or orange instead of blue	Debris may be present in gas line. Let burner run for a few minutes to see if flame changes to blue.
	Humid air in home, sometimes caused by running a humidifier, may cause flames to burn yellow.
	In coastal areas a slightly orange flame is unavoidable due to salt air.

Specifications

BTU/HR	Left and Right Burner: 6500 BTU Front Burner: 8000 BTU
Fuel/Power	Propane
Inlet Pressure	10" WC Min to 13.8" WC Max
Power input	12V DC <2 Amp

This appliance conforms with the directives: ANSI Z21.57a-(2012) Rec / CAN1-1.16-M79 (R2016)



This page is intentionally left blank.



## FURRION®

Furrion, LLC (Furrion) are wholly owned subsidiaries of Lippert Components, Inc. (Lippert)  
Furrion, LLC (Furrion) sont des filiales en propriété exclusive de Lippert Components, Inc. (Lippert)  
Furrion, LLC: 52567 Independence Ct., Elkhart, IN, 46514

Furrion Innovation Center & Institute of Technology  
Centre d'innovation et institut de technologie Furrion  
22244 Innovation Drive, Elkhart, IN 46514-5514, USA  
Toll free/Numéro gratuit/Línea telefónica gratuita: 1-800-789-3341  
Email/Courriel/Correo electrónico: customerservice@lci1.com

©2007-2025 Furrion, LLC. All rights reserved.

©2007-2025 Furrion, LLC. Tous droits réservés.

For Patent Info: [www.Lippert.com/patents](http://www.Lippert.com/patents)

Pour des informations sur les brevets: [www.Lippert.com/patents](http://www.Lippert.com/patents)

[SUPPORT.LCI1.COM/FURRION](http://SUPPORT.LCI1.COM/FURRION)



The contents of this manual are proprietary and copyright protected by Lippert. Lippert prohibits the copying or dissemination of portions of this manual unless prior written consent from an authorized Lippert representative has been provided.

Any unauthorized use shall void any applicable warranty.

The information contained in this manual is subject to change without notice and at the sole discretion of Lippert. Revised editions are available for free download from [lippert.com](http://lippert.com).

Please recycle all obsolete materials.

Les renseignements contenus dans le présent manuel peuvent seulement être distribués sous forme de document complet, à moins de recevoir l'approbation explicite de Lippert Components pour distribuer des parties individuelles. Tous les renseignements contenus dans le présent manuel peuvent être modifiés sans préavis. Les éditions révisées pourront être téléchargées gratuitement sur le site [lci1.com](http://lci1.com). Ces renseignements sont considérés comme étant factuels jusqu'à ce qu'une version révisée les rende désuets.

Veuillez recycler tout le matériel désuet.

For all concerns or questions, please contact Lippert.

Communiquer avec Lippert Components si vous avez des questions ou des préoccupations.

Ph: 432-LIPPERT (432-547-7378) | Web: [lippert.com](http://lippert.com) | Email: [customerservice@lci1.com](mailto:customerservice@lci1.com)