

About K400 Plus

Wireless Touch Keyboard K400 Plus is a full size keyboard layout and touchpad in a compact size.

Incurve keys are ideal for touch typists and the soft key stroke makes this a quiet keyboard.

The full size touchpad gives you the familiar scroll and navigation gestures. With the left- and right-click buttons below the touchpad and the volume control buttons above, control is at your fingertips.

For two-hand control, typically used by those who like to use their thumbs to navigate, a left mouse-click button is located on the upper left side of the keyboard—navigate with your right hand, select with your left.

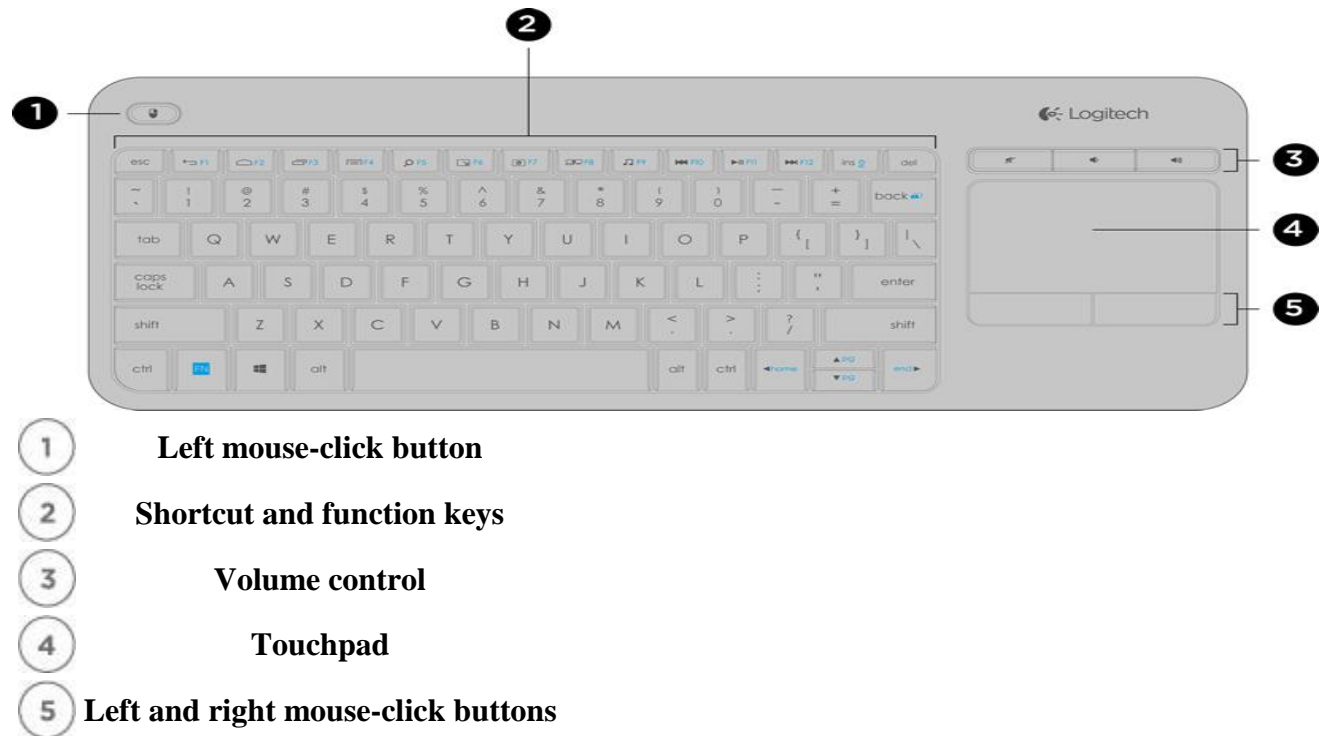

Connect

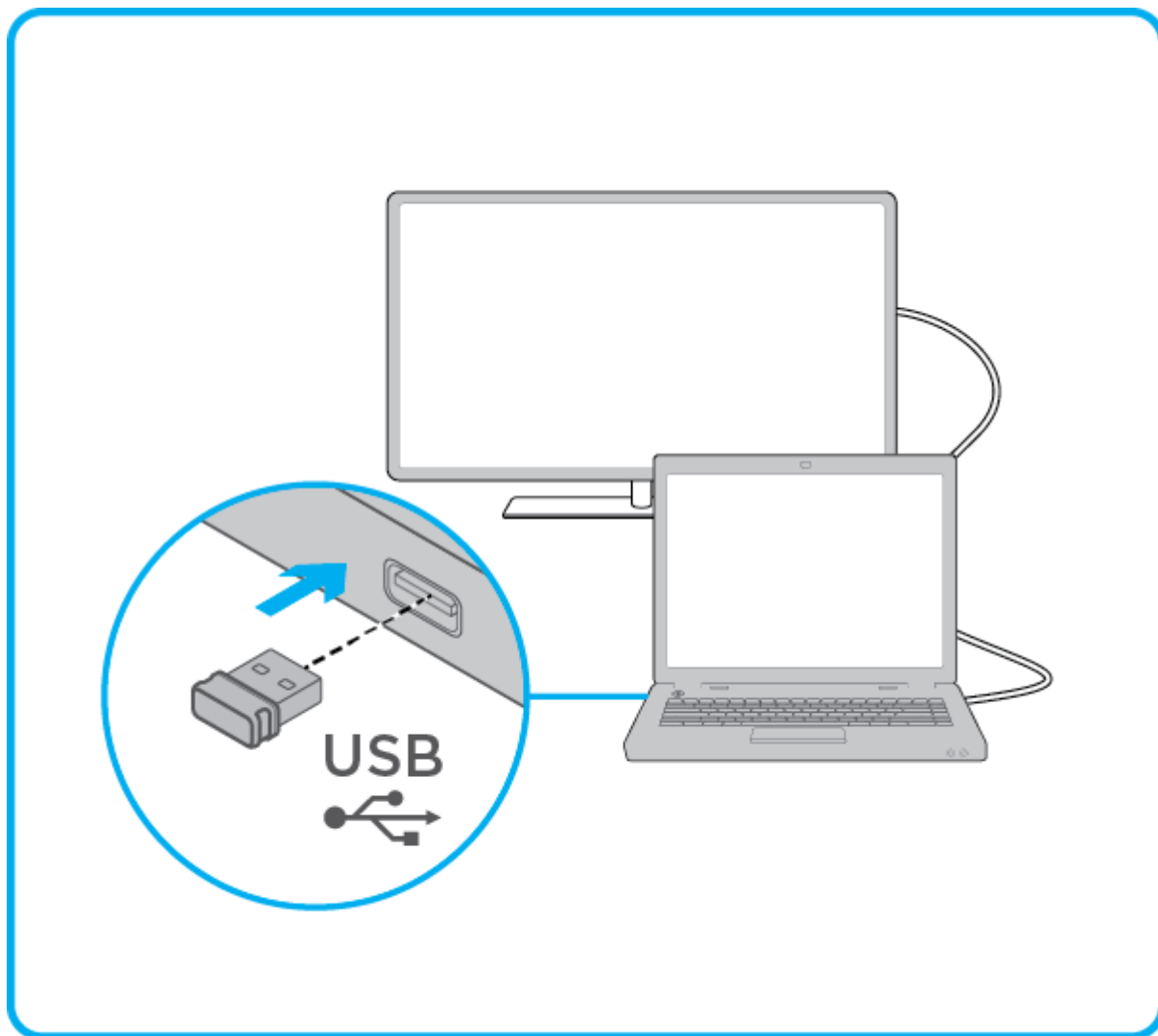

Step 1: Insert the Unifying receiver into a USB port on your computer.

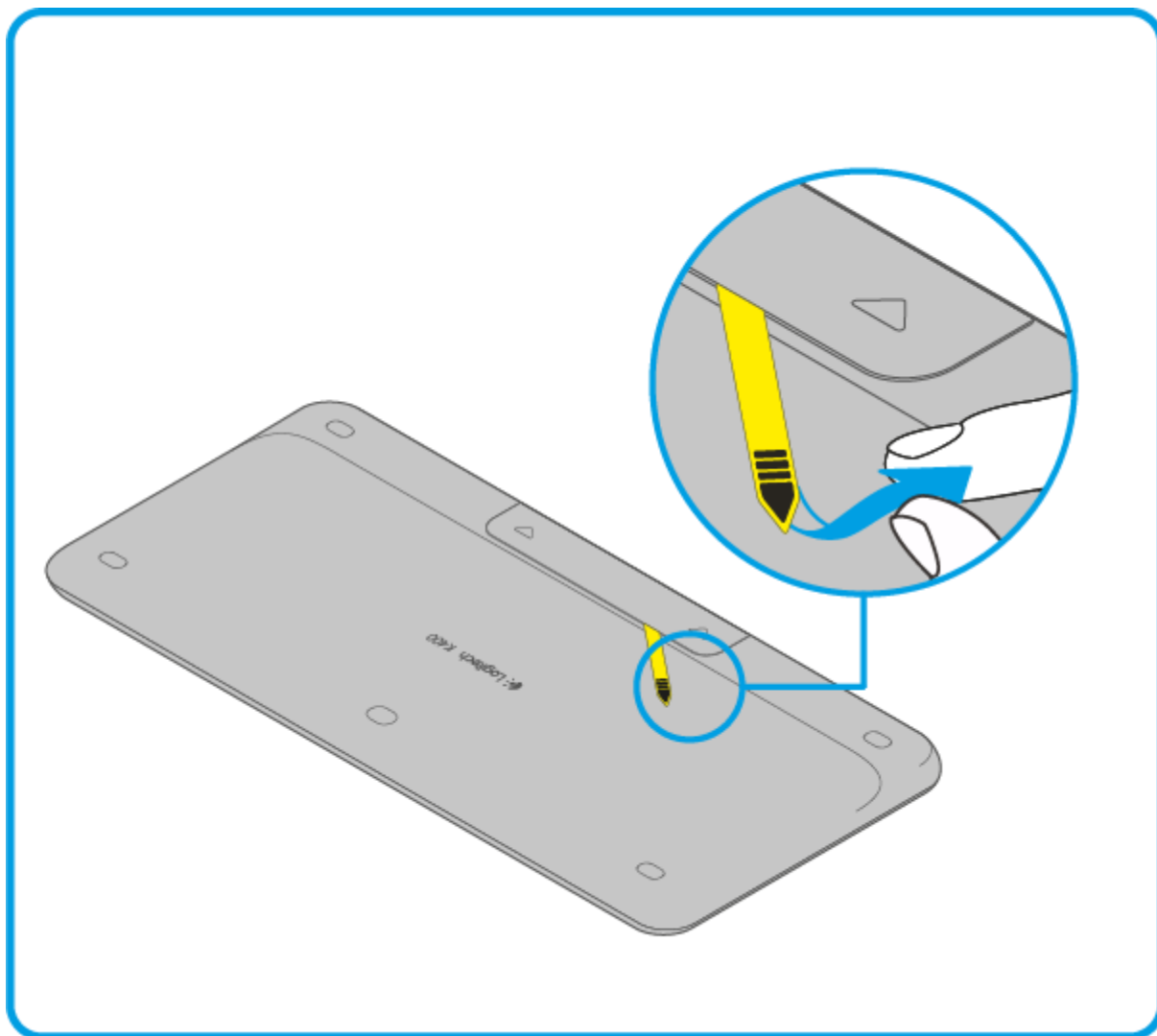

Step 2: Pull to remove the yellow battery tab.

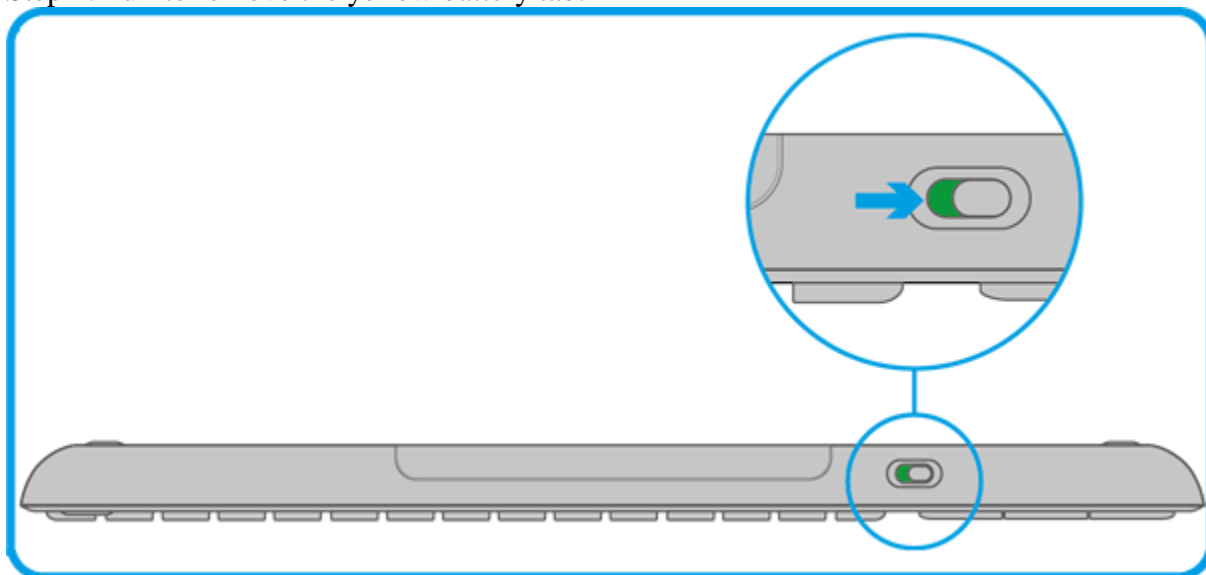











Note: Make sure that your keyboard switch is in the ON position. The ON/OFF switch is located at the top of the keyboard.

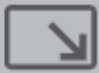

Your keyboard is ready to use.



Shortcut Keys

Shortcut and function keys streamline navigation, media control and keyboard functions.

Key	Shortcut/Function
 F1	Back
 F2	Home
 F3	Switch application
 F4	Menu
 F5	Search

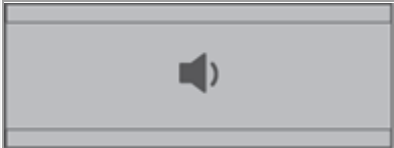
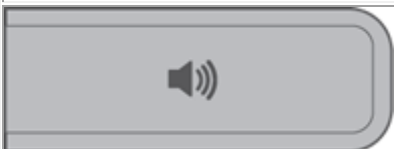
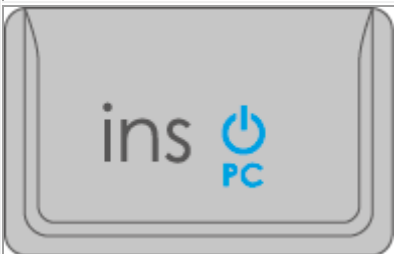
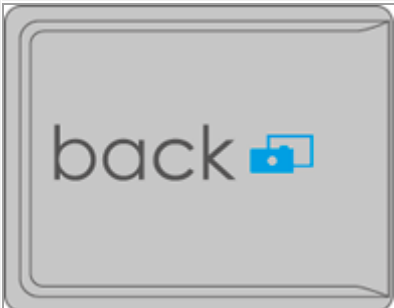
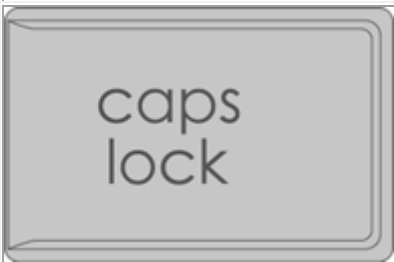
 F6	Show/hide desktop
 F7	Maximise window
 F8	Switch screen
 F9	Media
 F10	Previous track
 F11	Play/Pause

	Next track
	Mute
	Volume down
	Volume up
	Fn + ins: PC sleep
	Fn + backspace: Print screen
	Fn + caps lock: Scroll lock

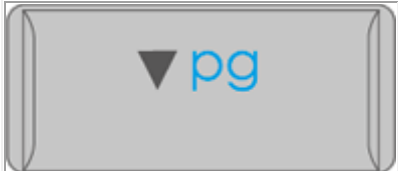
	Fn + left arrow:Home
	Fn + right arrow:End
	Fn + up arrow:Page up
	Fn + down arrow:Page down

F1-F12 keys: To activate F1, simply press on Fn+ back

K400 Plus Extras

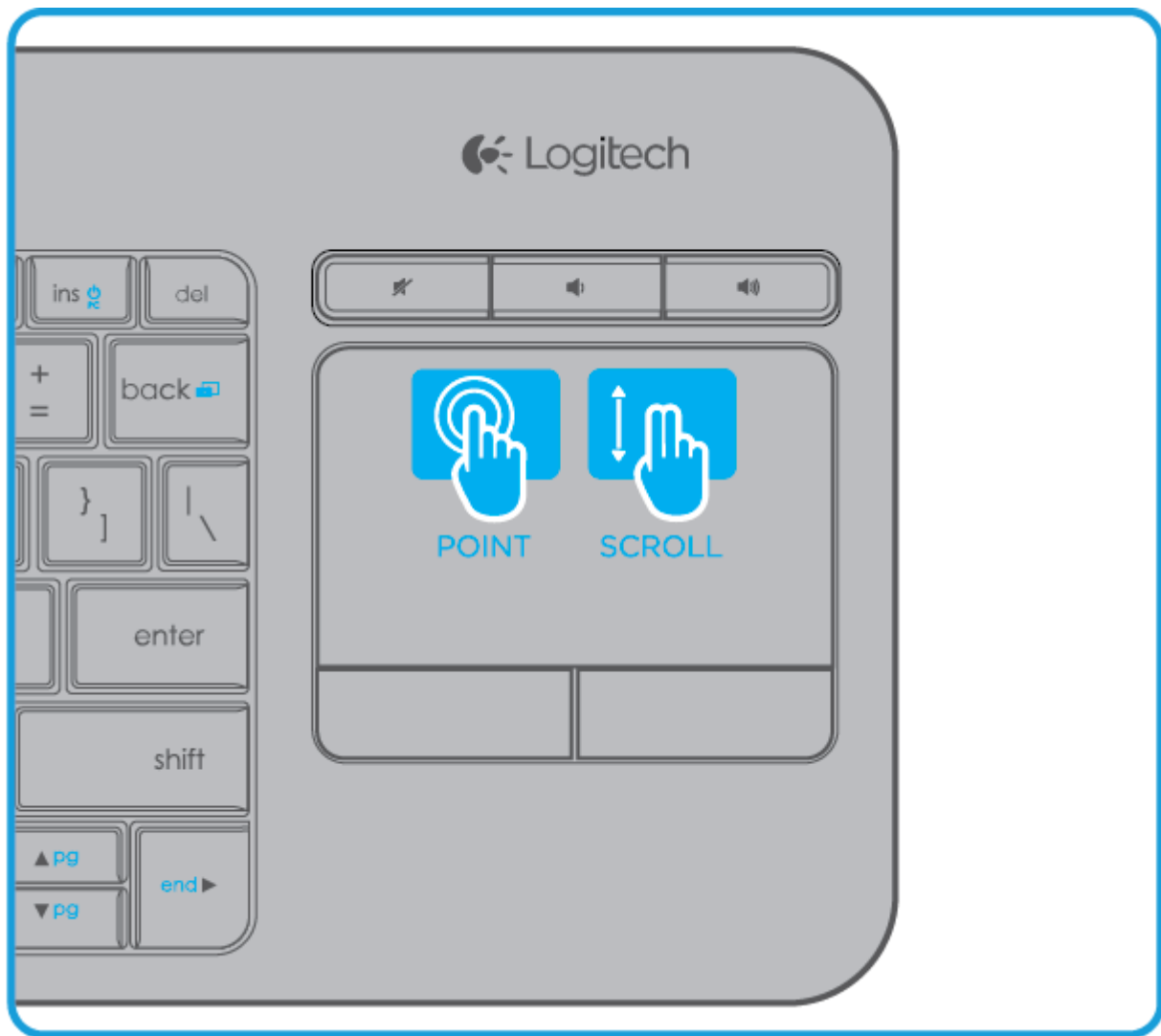

Touch tap

Press the Fn key and the left mouse button to toggle between touch tap disable and enabled.

You can also press the left mouse click button at the top-left of the keyboard to perform a click or comfortable two-handed navigation.

You can also tap the touchpad surface to perform a click.

Scrolling

Scroll with two fingers, up or down.

You can also press the Fn key and slide one finger anywhere on the touchpad simultaneously to scroll for comfortable two-handed navigation.

Receiver storage

When you are not using K400 Plus, store the Receiver in the battery compartment so that you never lose it.

Logitech Options

K400 Plus is a plug and play keyboard loaded with features right out of the box. If you like customization and loads of feature, then Logitech Options software was designed for you.

Download and install Options software to do the following:

- Modify the speed of the cursor and adjust scrolling
- Review tutorial videos on gestures
- Create custom shortcut keys
- Disable and enable keys—Caps Lock, Insert, Windows Start, and more.
- Show Caps Lock notice and low-battery warning

Many other features are available.

Support

Compatible Computers

K400 Plus keyboard works with both desktop and laptop computers and is compatible with the following operating systems.

- Windows® 7 and later
- Chrome OS™
- Android™ 5.0.2 and later

Keyboard functionality, such as Hot Keys and Touchpad Gestures, may differ depending on the operating system.

A quick check of your system settings will tell you if your device is compatible with K400 Plus.