



beyerdynamic

DT 880 PRO

STUDIO HEADPHONES

User Manual | Bedienungsanleitung | Mode d'emploi
Instrucciones de use | Manuale d'uso | Bruksanvisning
Gebruiksaanwijzing | Руководство по эксплуатации
사용 설명서 | 取扱説明書 | 使用说明书

EN DE FR ES IT SV NL RU KO JA ZH

CONTENTS

Safety instructions. 3

Design features. 3

Application. 3

Maintenance 3

How to change the ear pads 4

How to change the headband pad. 4

Versions 5

Supplied accessories. 5

Accessories and Replacement parts 5

Service 5

Disposal 5

Technical Specifications. 5

Thank you for selecting the DT 880 PRO dynamic studio headphones.

Please take some time to read carefully through this information before using the product.

ENJOY THE SOUND!

Your beyerdynamic PRO Team

SAFETY INSTRUCTIONS

Risk of injury



- ▶ We would like to point out that excessively high volumes and long listening times may cause hearing damage. Hearing defects always constitute an irreversible impairment of hearing ability. If you suffer from tinnitus, do not use headphones or reduce the volume.
- ▶ According to regulations to protect employees against damages caused by noise and vibrations, please follow these instructions:
85 dB SPL for max. 8 hours
88 dB SPL for max. 4 hours
91 dB SPL for max. 2 hours
94 dB SPL for max. 1 hour
97 dB SPL for max. 30 minutes
100 dB SPL for max. 15 minutes
- ▶ When connecting the headphones, please ensure that the volume is turned down to minimum. Adjust the volume after putting on the headphones.

Danger to life



- ▶ Headphones drastically reduce perception of external sounds. Using headphones in road traffic can be potentially dangerous. The user's hearing must not be impaired to the extent that it causes road safety risks. Please also make sure that you do not use the headphones in traffic, especially within an area of potentially dangerous machines and tools.
- ▶ Furthermore, avoid using headphones in situations where hearing must not be affected, especially when crossing a railway crossing or at a construction site.

Liability / intended use

- ▶ Do not use the product for any application which is not described in this product information.
- ▶ beyerdynamic is not liable for improper use of the product and its accessories.

DESIGN FEATURES

The DT 880 PRO is a semi-open dynamic headphone and provides a very linear sound as well as an excellent sound location. Due to the semi-open design ambient sound is attenuated, but can be still perceived.

APPLICATION

- ▶ The DT 880 PRO was designed for critical music and sound monitoring in an open environment especially for acoustic and classical music.
- ▶ The transducers are fitted to adjustable yokes which should be positioned to fully enclose the ear. This will provide the optimum ear/speaker position for accurate sound monitoring.
- ▶ The cord is terminated with a high-quality gold plated mini-jack and a 1/4" stereo jack adapter.
- ▶ **Caution:**
Connect the jack connector of the headphone cable to a headphone socket only! If you connect the headphones to any other jack socket, the headphones could be damaged.

MAINTENANCE

- ▶ As with any equipment which will be used in close proximity to sensitive areas of the body, it is essential that the ear pads and headband are kept clean. Use a damp cloth for cleaning using warm water only taking care not to allow any water drops into the ear cups or transducers.
- ▶ If necessary, you can carefully remove the ear pads and headband pad and clean them with mild soapy water.
- ▶ **WARNING: Never** use any solvent cleaning agents! Furthermore, the pads must be completely dry before they are attached to the headphone again.
- ▶ **WARNING: Never** use a **vacuum cleaner** for cleaning the headphones, as this may cause irreparable damage.
- ▶ Should it become necessary to replace the ear pads or the headband pad, refer to "Replacement parts and Accessories". You can easily do this yourself.
- ▶ If other components have to be replaced, please contact your local beyerdynamic representative.

HOW TO CHANGE THE EAR PADS

- ▶ To remove the ear pads, carefully pull them away from the earphone shell using your fingertips.

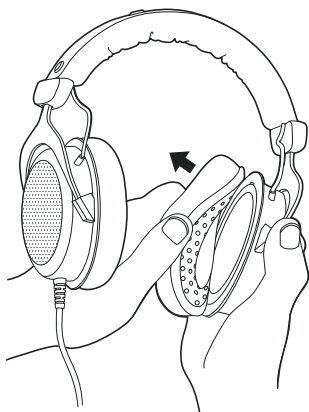

- ▶ To attach the ear pad, carefully pull the lip over the edge of the housing.

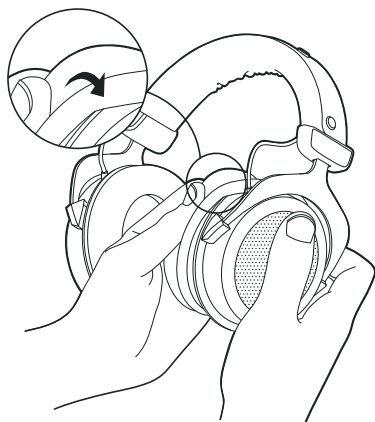

- ▶ Turn the attached ear pad a few times, as indicated by the arrow.

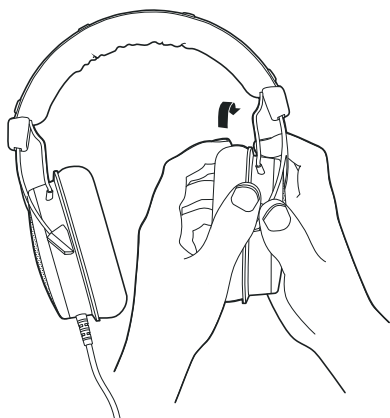

HOW TO CHANGE THE HEADBAND PAD

- ▶ To remove the headband pad, carefully unbutton the headband pad.

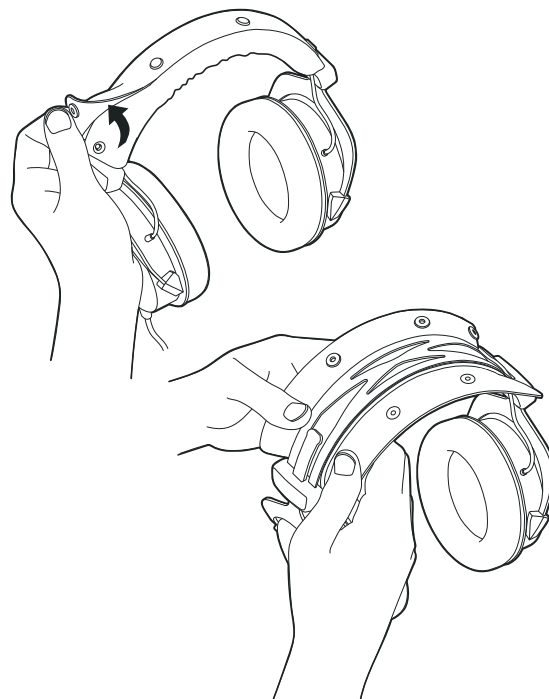

- ▶ To attach the headband pad, place it around the headband and the connecting cable and fasten the buttons.

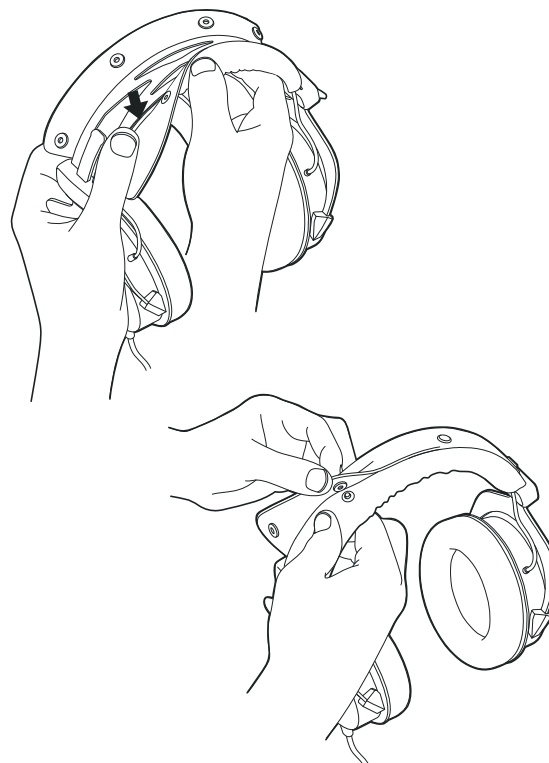

VERSIONS

- ▶ Available versions can be found at:
www.beyerdynamic.com

SUPPLIED ACCESSORIES

- ▶ 1 x 1/4" (6.35 mm) jack adapter
- ▶ 1 x Drawstring bag

ACCESSORIES AND REPLACEMENT PARTS

- ▶ Accessories and replacement equipment can be found at: www.beyerdynamic.com
- ▶ If you have technical problems while using the headphones or need further guidance, please visit our FAQ website at: support.beyerdynamic.com

SERVICE

- ▶ If you require service, please contact qualified service personnel or directly:

beyerdynamic Service- und Logistik Center
E-mail: service@beyerdynamic.de
- ▶ Dismantling the headphone yourself will invalidate the guarantee.

DISPOSAL

- ▶ At the end of its operating life this product may not be disposed of along with normal household waste. Please take it to a designated recycling point for electric and electronic appliances.
- ▶ This is indicated by the symbol on the product, the operating instructions or the packaging.



TECHNICAL SPECIFICATIONS

Transducer type	Dynamic
Operating principle	Semi-open
Frequency response	5 - 35,000 Hz
Nominal impedance	250 Ω
Nominal SPL	96 dB
T.H.D.	< 0.2%
Power handling capacity	100 mW
Sound coupling to the ear	Circumaural
Nominal headband pressure	3.5 N
Weight (without cable)	295 g
Length and type of cable	3 m / coiled cable
Connection	Gold plated stereo jack plug (3.5 mm) and 1/4" adapter (6.35 mm)

(all specifications acc. to EN 60 268-7)