



PLEASE NOTE:

All acrylic parts have protective film applied on both sides.

Some pieces appear with slightly translucent film, this will need to be removed before assembly.

Ensure all engraved lines face outwards.

INSTRUCTIONS FOR: Wicked Brick IKEA Billy Bookcase Window Front

These instructions cover the basic directions for the majority of our display case products.

More specific details will be found on your chosen products website listing.

Parts list:



1 - PRT1

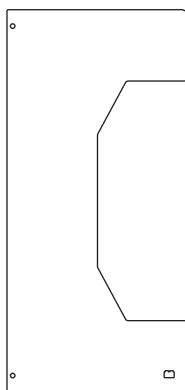

2 - PRT2



4 - PRT4

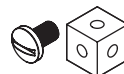

5 - CPT3 (2x packs)

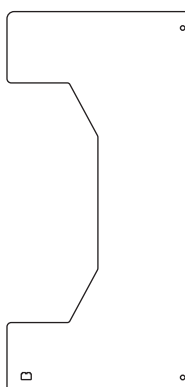

3 - PRT3

INSTRUCTIONS FOR: Wicked Brick IKEA Billy Bookcase Window Front

These instructions cover the basic directions for the majority of our display case products.
More specific details will be found on your chosen products website listing.

A

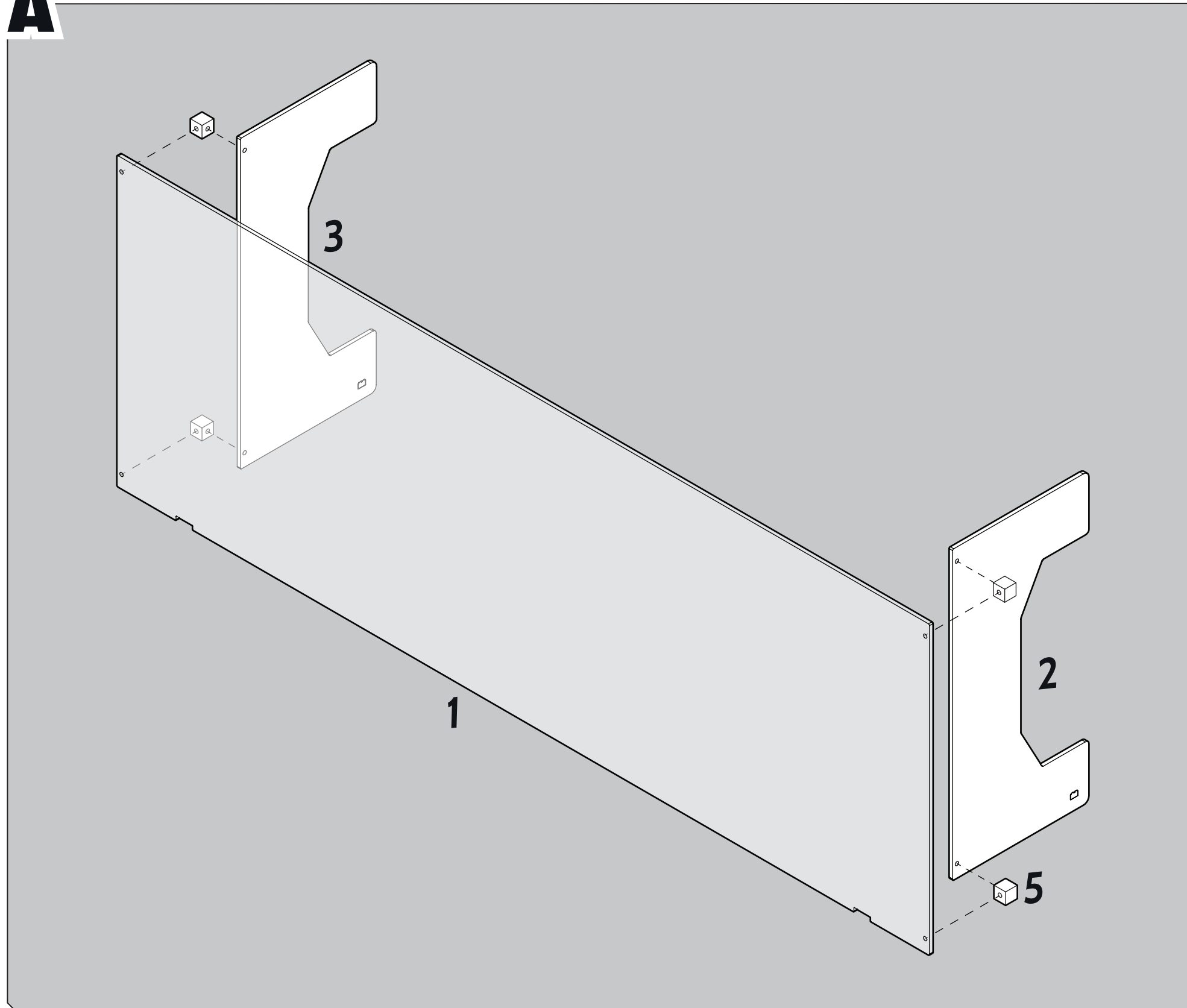

B

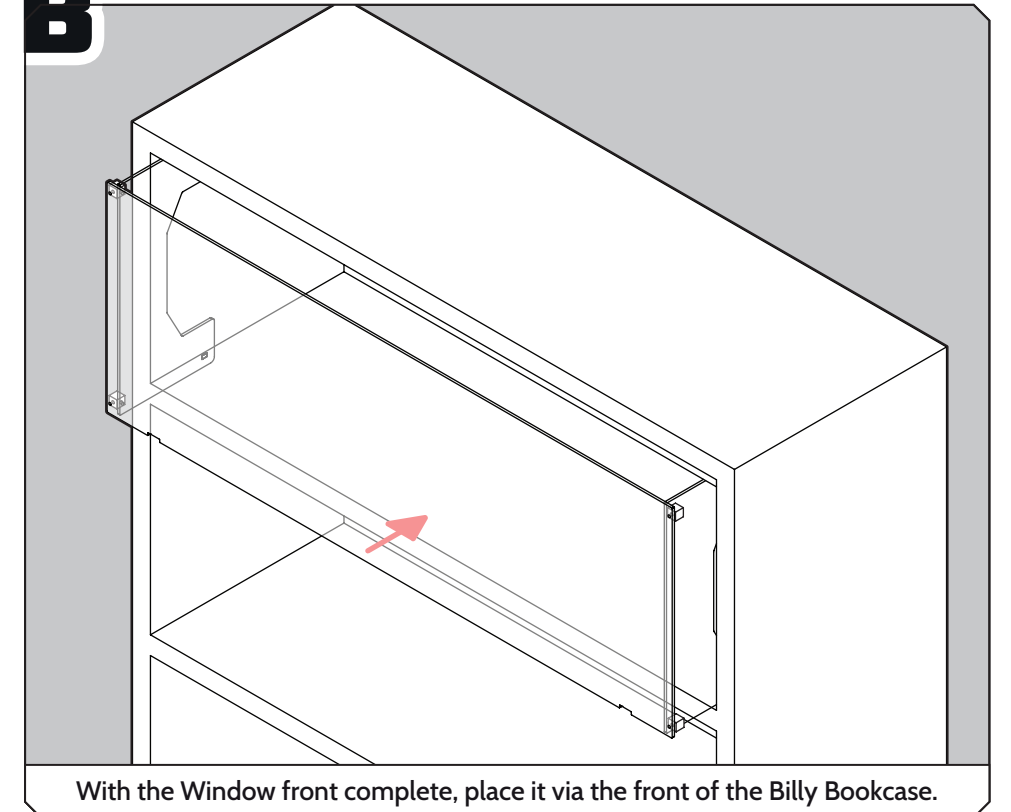

C

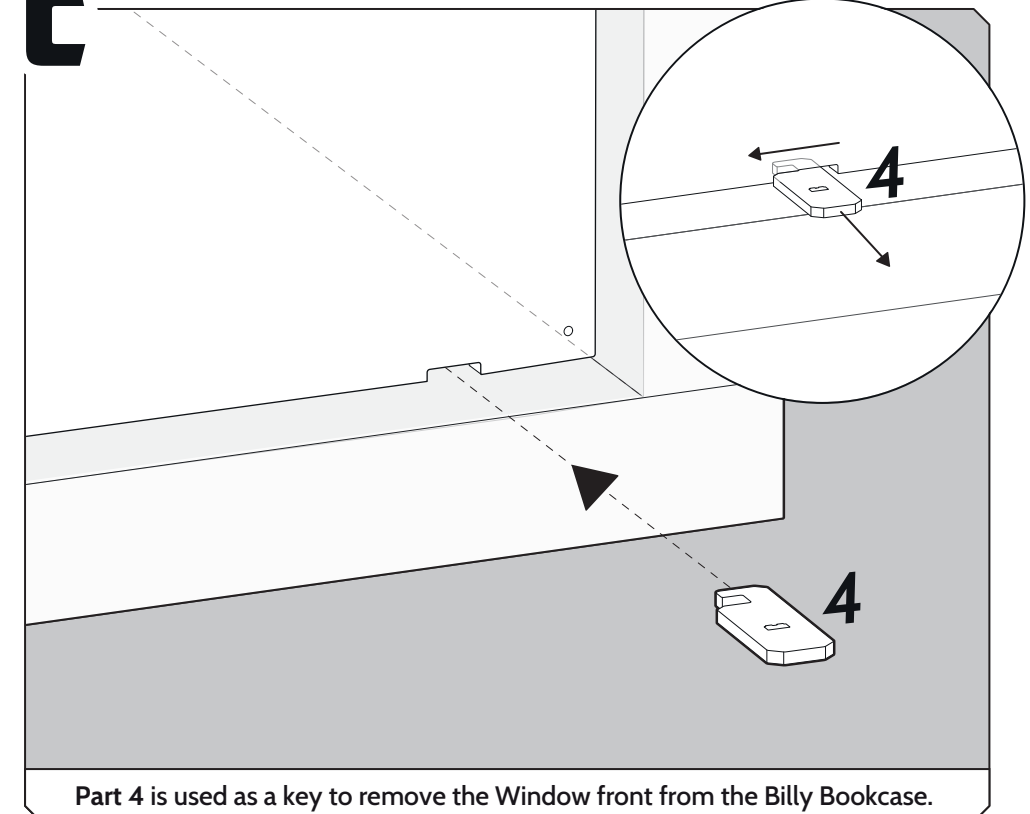

INSTRUCTIONS FOR: Wicked Brick IKEA Billy Bookcase Window Front

These instructions cover the basic directions for the majority of our display case products.
More specific details will be found on your chosen products website listing.

(Compatible with the top and bottom halves of the Billy bookcase)

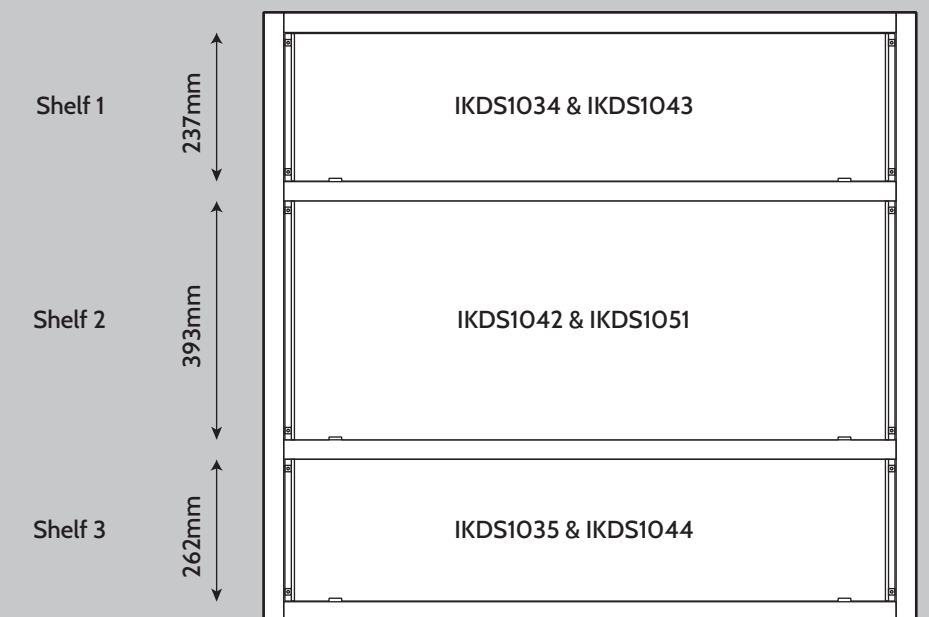
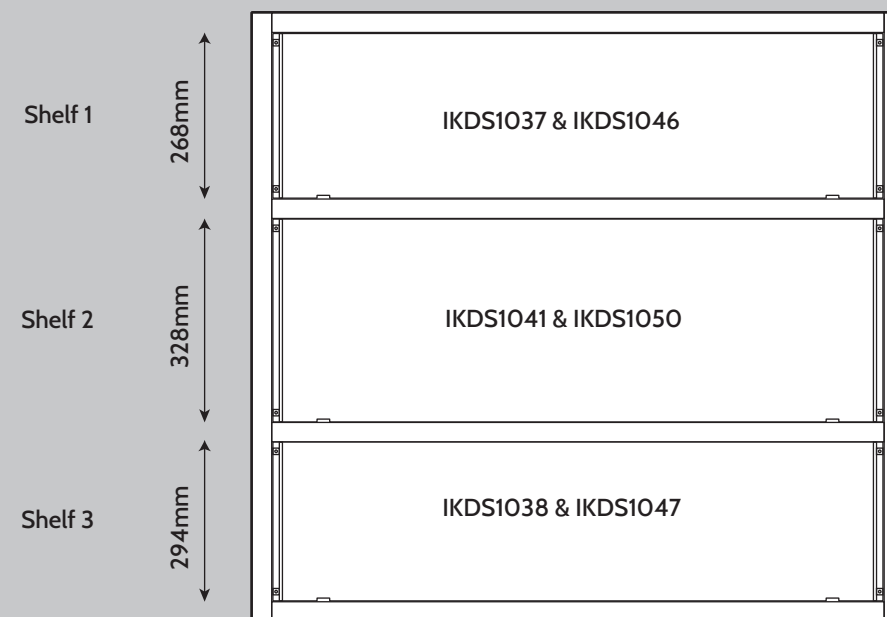
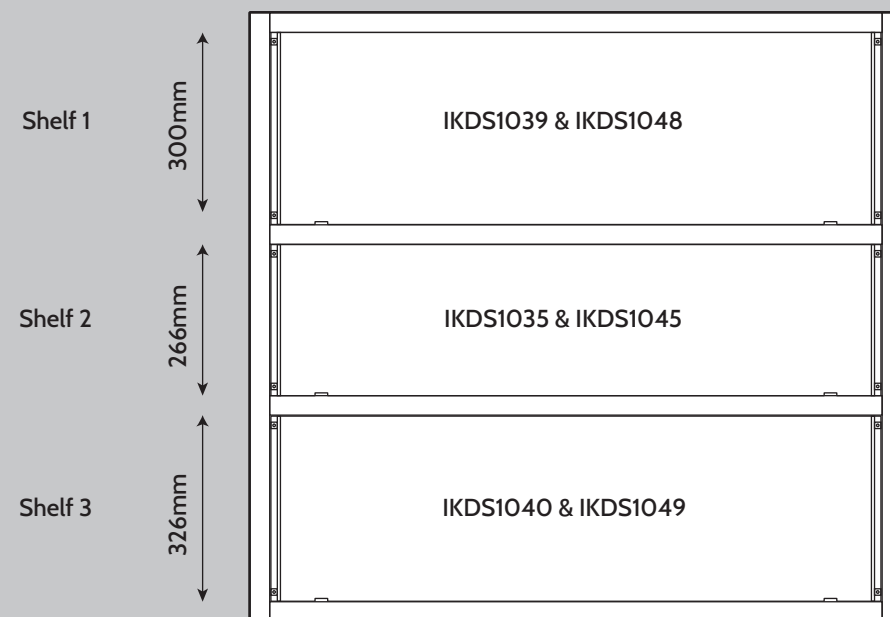

(Compatible with the top and bottom halves of the Billy bookcase)

