

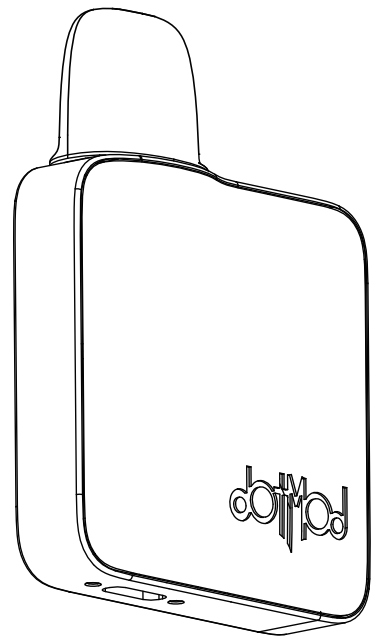

## dotPod Nano

### User Manual



## Nicotine safety

### WARNING:

Sale to or use of this product by minors is strictly prohibited.

### RECOMMENDED USE

This product is intended for use as an electronic cigarette to receive nicotine or other dosages for your personal requirements. Do not drink the e-liquid and avoid direct contact with your skin or eyes.

### STORAGE AND DISPOSAL

Keep the container tightly closed and in an upright position. Store e-liquids in a cool, dark, & dry place. Keep out of the reach and sight of children and animals. Dispose of unused e-liquid according to local regulations.

### CONTRAINDICATIONS

If you suffer from any of the following conditions, talk to your doctor or pharmacist before using this product: heart, throat or lung disease; kidney or liver disease; stomach ulcer or inflammation of the stomach or esophagus; an overactive thyroid gland or pheochromocytoma; diabetes.

### SPECIFIC RISK GROUPS

This product is not recommended for use by pregnant or lactating women.

### POSSIBLE ADVERSE EFFECTS

New users of electronic cigarettes may experience dry throat, dry cough, mild pain or irritation of the mouth or respiratory tract. If the symptoms become severe or last for more than 48 hours, please see a general practitioner and report the incidences by following the information given in "Reporting Adverse Effects." Possible nicotine withdrawal adverse effects, irritability or aggression, feeling low, anxiety, restlessness, poor concentration, increased appetite or weight gain, urges to smoke (craving), nighttime awakening or sleep disturbance, lowering of heart rate.

## Nicotine safety

### ADDICTIVENESS AND TOXICITY

This product contains Nicotine which is a highly addictive substance and is thus not recommended for use by non-smokers. No other ingredient of this product is known to be addictive. This product contains Nicotine which may produce toxic effects if consumed orally, especially in infants and children. Please DO NOT drink e-liquid. In case it is consumed, please take your e-liquid bottle with you and see a general practitioner immediately. In case of contact with skin, rinse immediately with cold running water for at least 15 minutes.

### REPORTING ADVERSE EFFECTS

If you experience any side effects as a result of using this product, please help us by informing us about it so that we can continue to improve the safety of our products. Visit: <https://dotmod.com/pages/health-safety> to fill out our Safety concerns form. Alternately, you can also report your symptoms directly to MHRA using the Yellow Card Portal available at <https://yellow-card.mhra.gov.uk/yellowcards/tobacoreportmediator/> 88 Wood St. London, EC2V 7RS United Kingdom



**PROPOSITION 65 WARNING:** This product can expose you to chemicals including Nicotine, which is known to the State of California to cause cancer and birth defects or other reproductive harm. For more information go to [www.P65Warnings.ca.gov](http://www.P65Warnings.ca.gov)

## Battery safety

### WARNING:

Lithium-ion batteries are volatile and may explode or burn if charged, used, transported, stored, or disposed of improperly.

- Keep battery away from high heat, direct sunlight, cold temperatures, humidity, water, and metal or anywhere else where it may be exposed to metals.

- Do not tamper with battery or disassemble the device.

- Inspect battery for wear or damage before each use. Do not use if worn or damaged.

- Charge battery with provided charging cable only. Do not charge in your car.

- Do not overcharge or exceed charging amperage.

- Do not leave this device unattended while charging, do not leave it while charging overnight, or unattended in your vehicle.

- If the device gets too hot, stop charging the device and allow it to cool down.

- Always use a surge protector when charging battery.

- If you witness the battery starting to balloon, swell, smoke, or become very hot: immediately discontinue use, turn off the device, place it on a non-flammable surface in a well-ventilated area away from people and pets.

- Always have a fire extinguisher handy in the event of a fire.

- Do not throw batteries into a fire. Please recycle or dispose of according to local law.

- Keep batteries away from children and pets. Should a child/pet swallow or chew on a battery, immediately consult a physician and/or call your local poison control center.

- Failure to follow warnings may result in electric shock, fire, burns, property damage, or bodily injury.

- Charging is for indoor use only

- The recommended ambient temperature is -10°C to 40°C

- The temperature of the main body of the machine should be kept within the range of 0°C to 40°C when charging.

- Charge the device by a UL Listed USB wall charger

\*\*\*dotmod, Inc. is not responsible for any damage or injury resulting from improper use, charging, transport, storage, and/or maintenance of this device.\*\*\*

## Know your dotPod Nano

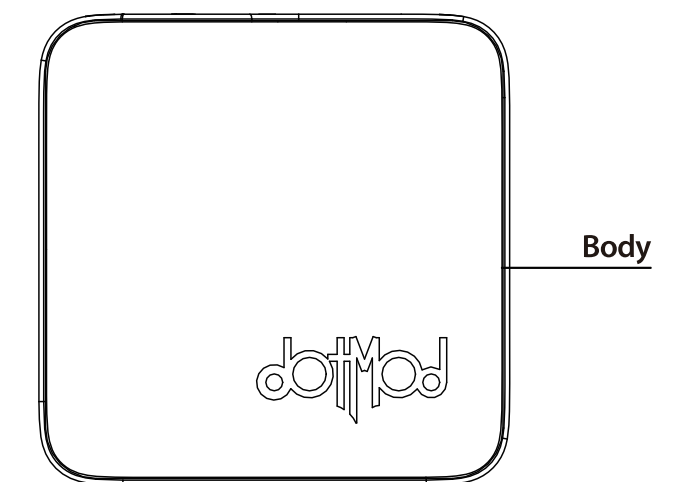
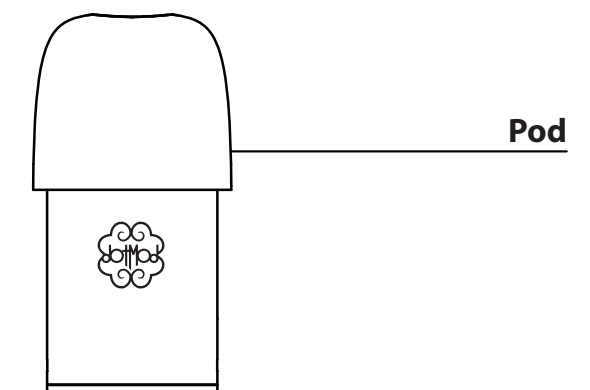

## Filling the pod

- 1 Remove the magnetic pod by gently pulling it out of the device

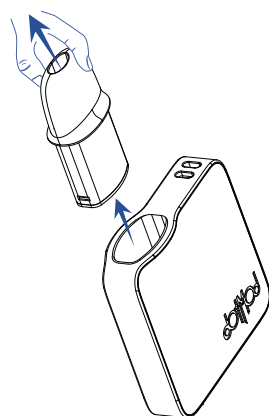

- 2 Find the fill hole located under the silicone cover

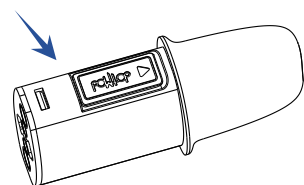

- 3 Open the silicone fill hole cover, and fill the pod. Do not overfill

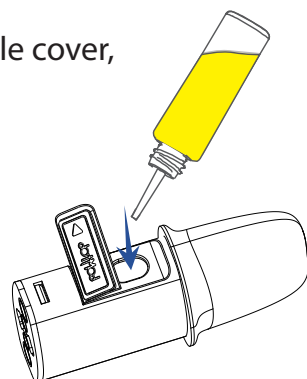

## Battery status and indicator lights

Green ●	61%-100% charge(3.85V-4.20V)
Blue ●	21%-60% charge(3.55V-3.85V)
Red ●	1%-20% charge(3.00V-3.55V)

### Red lights



PCB board over temperature protection



Low voltage detection: battery power is too low, red light flashes eight times.

### White lights



Loading/removing atomizer: white light flashes once



Short circuit protection



Open circuit protection

### Green lights



During the charging process: when the battery voltage reaches 4.20V, the green light will turn solid for one minute, indicating that it is fully charged

### Cyan lights



Time out: The device times out after ten seconds, stopping output immediately. The cyan light flashes three times quickly.

## Power levels

	1.0Ω	0.8Ω	0.6Ω	1.25-2.0Ω
AUTO	14W	16W	18W	10W
<0.49Ω/ >2.0Ω				
Not within the operational resistance range				

## Protection features

1. **Short circuit protection:**  
The white light flashes twice rapidly.
2. **Open circuit protection:**  
The white light flashes rapidly three times.
3. **Resistance protection:**  
The pod resistance is not between the selected values. If the pod resistance value is not between the selected resistance value, it cannot output.
4. **PCB board over temperature protection:**  
PCB board temperature exceeds +75 °C, can not output. A single red light flashes quickly five times.
5. **Battery protection:**  
Overcharge protection, overdischarge protection, overcurrent protection, short circuit protection.

**Note:** This device has pass through charging capabilities.

## Customer Service

Our Customer Service Department is happy to help!

We encourage you to reach out to us at:

[customerservice@dotmod.com](mailto:customerservice@dotmod.com)

with any questions or concerns regarding your device.

Customer Service Department hours:

Monday - Friday  
9:00 AM PST - 5:00 PM PST



## dotPod Nano

### User Manual

