

# Kaadas

Q9

## User Manual

[www.kaadasgroup.com](http://www.kaadasgroup.com)

Shenzhen Kaadas Intelligent Technology Co.; Ltd  
reserves all rights for the final interpretation to this user manual.

All design and specifications are subject to change without notice.

**Cautions:**

This section contains important information to ensure the user's safety and prevent potential damage to property. Please, read this section carefully and use the product accordingly.

# Contents

## 1 Important information

Security

Warning

Disposal of old products and batteries

## 2 Installing your smart lock

Product content

Lock explosive view

Before installing

Change latch bolt direction

Installation steps

## 3 Know your smart lock

Front panel

Back panel

## 4 Set up your smart lock

Before setting

Access into master mode

User settings

System settings

Network configuration

Installation settings

## 5 Use your smart lock

Outdoor unlocking

Mechanical key unlocking

Electronic unlocking/locking

Quickly open the handle to unlock

Indoor anti-lock

Silent mode

Remote doorbell

## 6 Other functions

Restore factory Settings

Emergency power supply

Battery replacement method

# 1 Important information

## Security

- ◆ Please read and understand all instructions before using this smart lock. Damage caused by failure to comply with the instructions is not covered by the warranty.
- ◆ It is recommended to use the accessories and fittings specified by our company.
- ◆ Use only the batteries provided with this product.
- ◆ Do not forcibly disassemble the product as this may cause an alarm or damage the product.
- ◆ Do not scratch the finger vein sensor with sharp objects, as this may cause permanent damage.
- ◆ Do not expose the product to corrosive substances that could damage the protective layer of the finger vein sensor.
- ◆ Do not hang objects on the handle/grip, as this may affect the normal use of the door lock.
- ◆ To clean the product, please use a cleaning cloth.
- ◆ Do not disassemble the battery while the device is in operation.
- ◆ Please choose a professional engineer to install the door lock and follow our installation standard, do not disassemble and install it by yourself.
- ◆ After the door lock installation and commissioning, please modify the default management password set by the factory at the first time and keep the mechanical key properly, do not easily disclose the password information.
- ◆ After the door lock triggers low battery alarm, please replace all the batteries in time and ensure the correct installation.

## Warning

- ◆ Do not put the battery near the fire source to avoid explosion.
  - ◆ Do not use an emergency power source that does not meet safety regulations to power this product.
  - ◆ Do not use metal to short-circuit the two poles of the battery leads to avoid an explosion.
  - ◆ Ensure that a Kaadas or Kaadas-authorized service center or professional repair person performs the replacement.
  - ◆ Use of accessories or parts made by other manufacturers, or not specifically recommended by Kaadas, may void your warranty.
- 

## Disposal of used products and batteries

- ◆ Please inform yourself about the local collection system for sorting electronic products.
- ◆ Please follow local regulations and do not dispose of used batteries in the general household garbage.
- ◆ Please dispose of old batteries properly to help avoid potential negative impacts on the environment and human health.
- ◆ Batteries should not be disposed of with regular household garbage.



## 2 Installing your smart lock

### Product content

This Product content is for reference only, everything is subject to the contents of the physical package.

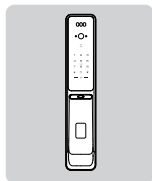

Front panel  
(with rubber gasket)

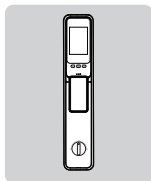

Back panel  
(with rubber gasket)

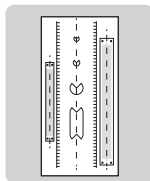

Drilling template

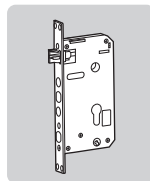

Mortise

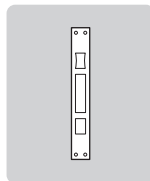

Strike Plate  
Assembly

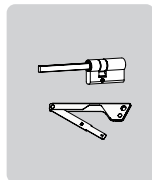

Mechanical key  
& lock cylinder

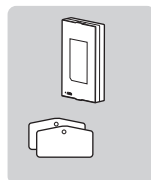

Lithium Battery &  
User Card



Screw pack



User Manual

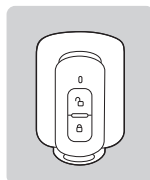

Product Content

## Lock explosive view

This lock explosive view is helpful to learn lock's structure.

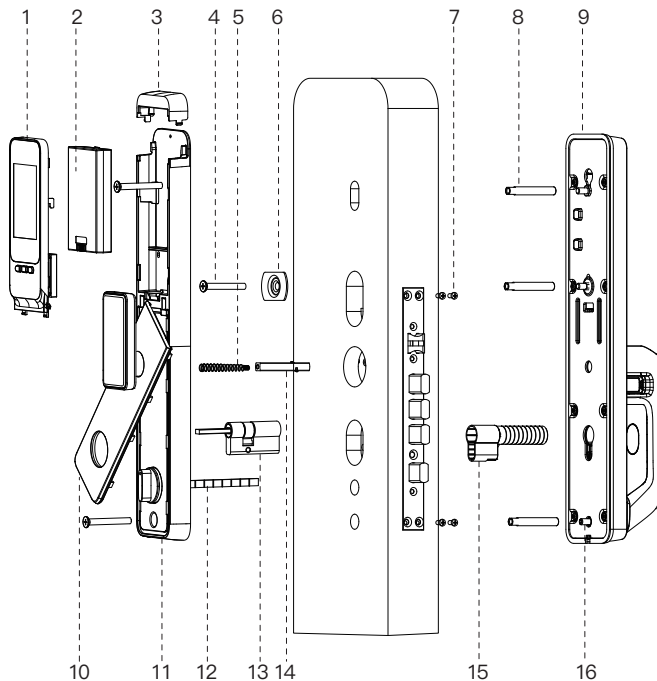

- 1、 Battery cover
- 2、 Battery
- 3、 Back panel top cover
- 4、 M6 cross slot countersunk head screws(3pcs)
- 5、 Tower spring
- 6、 Fixed plate (Install the two lower screws without installing the fixing plate)
- 7、 M4 cross recessed countersunk head screws (4 pcs. )
- 8、 M6 solenoid tube (3 pieces )
- 9、 Front panel components
- 10、 Plastic rear panel lower cover
- 11、 Back panel components
- 12、 Iron knob pick
- 13、 Lock cylinder
- 14、 Square shaft
- 15、 Plastic cylinder protector
- 16、 M6 hexagon socket set screw (1 piece)

## Before installing

Determine the position of the smart lock on the door before installing.

On the left side of the door

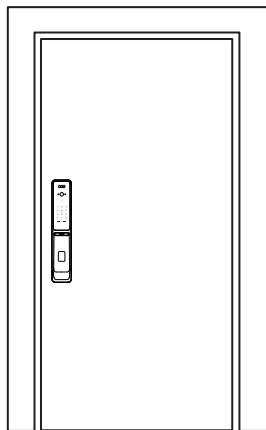

On the right side of the door

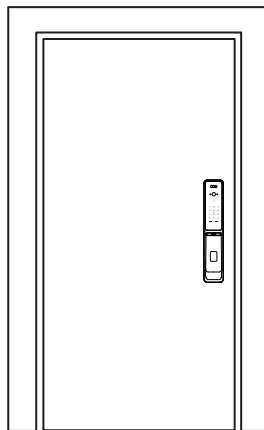

## Change latch bolt direction

2、 Rotate the oblique tongue 180° in the direction of the arrow.

1、 Toggle the reversing paddle in the direction of the arrow.

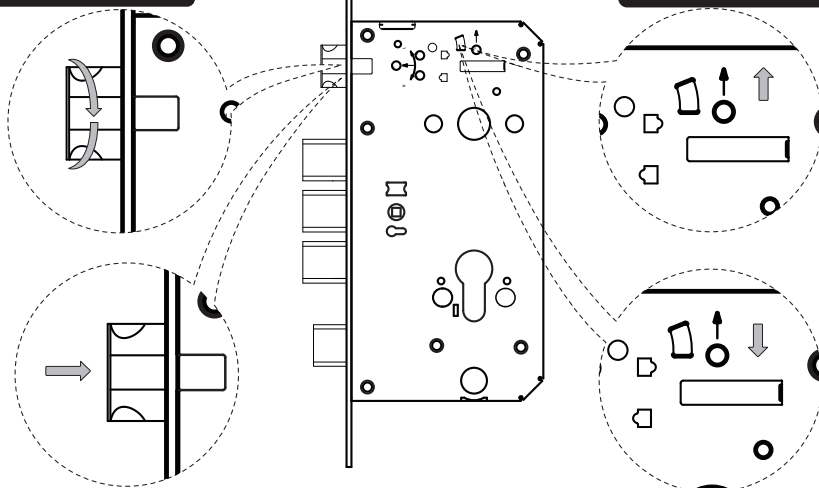

3、 Press in the oblique tongue in the direction of the arrow.

4、 Toggle the reversing paddle in the direction of the arrow.

## Installation steps

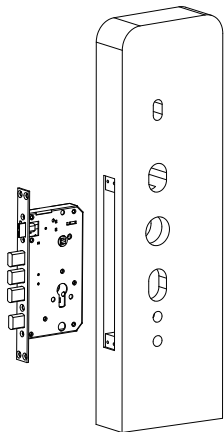

Drill holes on the door according to the hole template, put the lock body into the door frame.

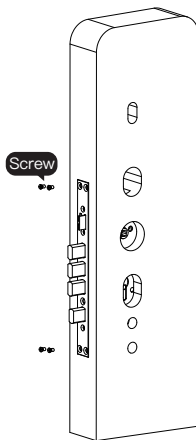

Tighten the four fixing screws on the lock body .

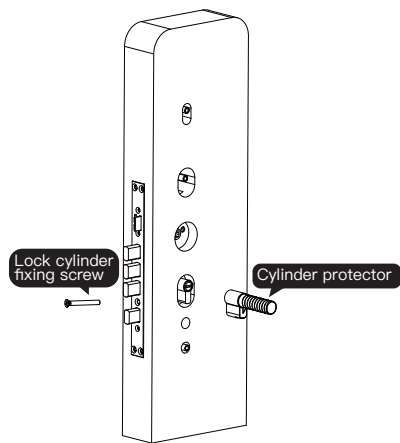

Install the lock cylinder and cylinder protector (the lock cylinder is installed lower than the door surface).

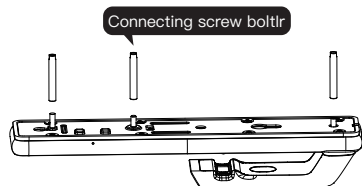

Install the connecting tube into the corresponding position as shown in the figure and lock it.

⚠ Note: The top connecting screw bolt can be selected according to the actual situation.

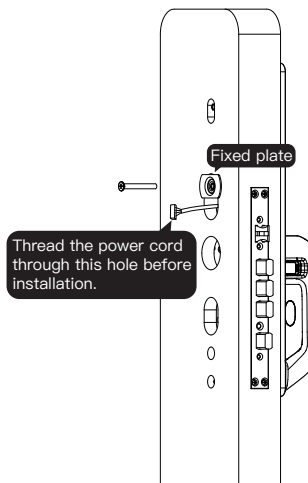

Pass the connecting cable through the cable opening above the door, with the front panel facing. Insert the lock core hole of the front plate, lock the fixing plate, and make the outside The board fits snugly to the outside of the door.

⚠ Note: Without the top screws, the mounting plate can be left in place.

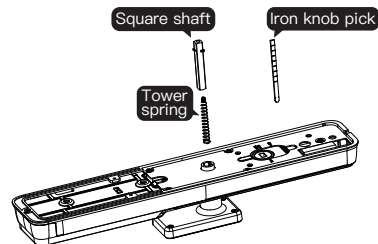

Assemble the rear panel components and install the solid limit tapping square steel, pagoda spring, and iron knob pick.

⚠ Note: Iron knob toggle wrenches to desired length.

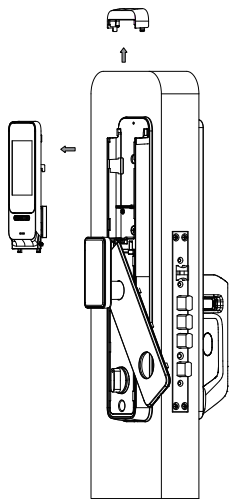

Snap off the plastic rear panel cover and battery cover assembly and rear panel trim.

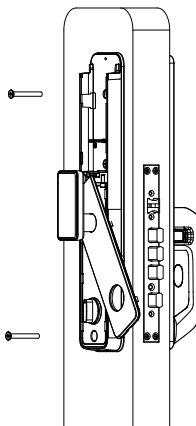

Install the rear panel assembly and tighten the corresponding screws.

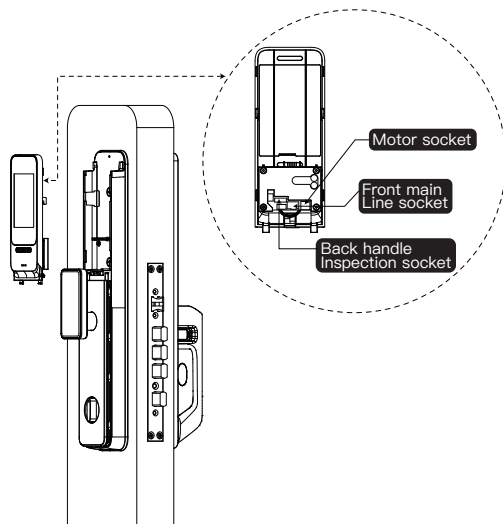

Insert the corresponding wire into the corresponding socket .

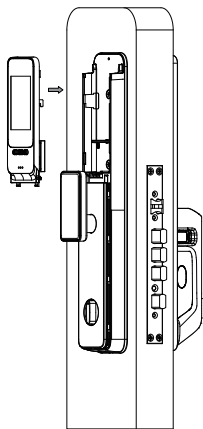

Snap on the battery cover assembly and plastic back panel lower cover.

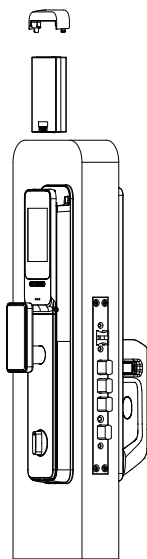

Snap on the battery and plastic back panel top cover.

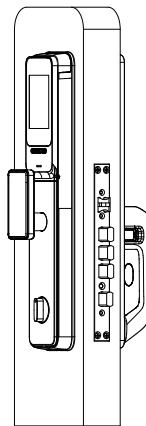

Assembly completed.

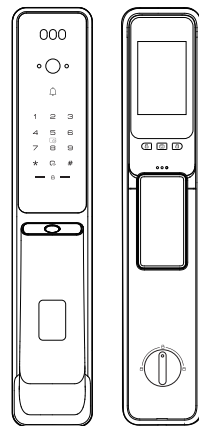

Push and pull the inner and outer handles and mechanical key to check whether all components are connected properly.



### 3 Get to know your smart lock

#### Front panel

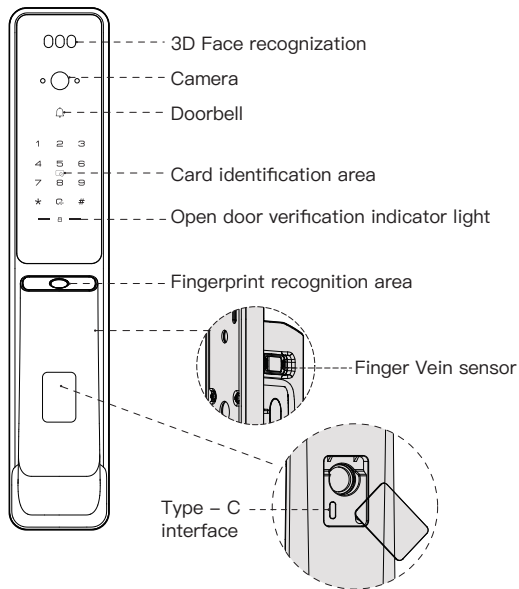

#### Back panel

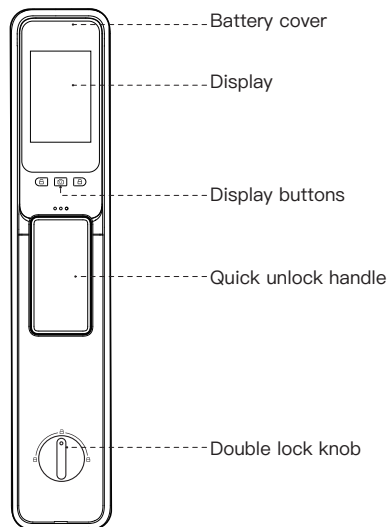

⚠ Note : This schematic diagram is for illustrative purposes only, please refer to the actual product.

## 4 Set up your smart lock

### 4.1 Before setting

Default master PIN code is 12345678, you need to change the master PIN code before you can perform other operations

#### The operation of modifying the master PIN code for the first time:

1. Wake up touchscreen keypad with palm.
2. Press [\*] twice, input master PIN code, and press[#] confirm.
3. Voice prompt: PIN code is too simple, change master PIN code, end with pound key.

**⚠ Note:** In the initial state, you need to modify the administrator password to perform other operations.

	Security mode	Normal mode
Master PIN code	Security mode supports master password participation authentication / Master passwords can verify to unlock in Security mode,	Initial state master password: 12345678
Password	One-time passwords are forbidden	One-time passwords can be used
User fingerprint	Support	Support
User finger vein	Support	Support
User face	Support	Support
User card	Support	Support
Enter management pattern square Law	By entering the admin password Manage finger veins by typing Manage fingerprints by typing  Avoid setting and managing finger veins and fingerprints to be the same as user finger veins and fingerprints	By entering the admin password Manage finger veins by typing Manage fingerprints by typing

**⚠** Before setting the security mode, you must first enter more than two users; double verification: user password. Dummy passwords are supported both before and after the code (the user password and dummy password together do not exceed 20 digits) .

### 4.2 Access into master mode

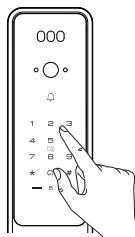

1. Wake up touchscreen keypad with palm;
2. Press the [\*] twice, input master PIN code, and press[#] confirm;
3. Voice prompt: Master mode, for user settings, press 1, for system settings, press 2, connecting settings, press 4; installation settings, press 5.

### 4.3 User settings

#### Add a normal user:

When adding a user, the door lock automatically recognizes and adds password, fingerprint, finger vein, and card. The user can directly add the corresponding key type.

in master mode:



Press 1 to enter the user settings, then press 1 to enter the addition of ordinary users, follow the voice prompts to enter the fingerprint or finger vein or enter the password or swipe the card until the voice prompts: Added successfully.

**⚠ Note:** When inputting and verifying, fingers need to touch the raised contacts at both ends of the finger vein module.

## Add a one-time temporary password:

in master mode:



Press 1 to enter the user settings, and then press 2 to add a one-time temporary password.

The voice prompts you to enter a new temporary password and ends with the # key until the voice prompts: Added successfully.

-----

## Add face

in master mode:



Press 1 to enter the user settings, and then press 3 to enter the adding face. Follow the voice prompt: Please face the door lock camera until the voice prompt: Added successfully.

-----

## Add (modify ) master fingerprint

in master mode:



Press 1 to enter user settings, then press 4 to enter adding (modifying) fingerprint management, according to the language. The voice prompts you to enter the new management fingerprint until the voice prompts: Added successfully.

## Add (modify) master finger vein

in master mode:



Press 1 to enter the user settings, and then press 5 to enter the add (modify) master finger vein. Follow the voice prompts to enter the new management finger vein until the voice prompts: Added successfully.

**Note:** When inputting and verifying, fingers need to touch the raised contacts at both ends of the finger vein module.

-----

## Modify master password

in master mode:



Press 1 to enter the user settings, then press 6 to enter the management password modification, enter the new management password according to the voice prompts and end with the # key, until the voice prompts: Setting successful.

## Delete users

in master mode:



Press 1 to enter user settings, then press 7 to enter user deletion, then press 1 to delete a single password , enter the password according to the voice prompts or enter a two-digit number and end with the # key until the voice prompts: Deletion successful .



Press 1 to enter the user settings, then press 7 to enter the user deletion, and then press 2 to delete a single fingerprint . Press the fingerprint according to the voice prompts or enter a two-digit number and end with the # key until the voice prompts: Deletion successful.



Press 1 to enter the user settings, then press 7 to enter the user deletion, and then press 3 to delete a single finger vein. Press the finger vein according to the voice prompts or enter a two-digit number and end with the # key. Until the voice prompt: Deletion successful .



Press 1 to enter user settings, then press 7 to enter user deletion, and then press 4 to delete a single card . Follow the voice prompts to swipe the card or enter the number and end with the # key until the voice prompts : Deletion successful.



Press 1 to enter user settings, then press 7 to enter user deletion, and then press 5 to delete a single face. Please verify the face or enter the number and end with the # key until the voice prompts: Deletion successful.



Press 1 to enter user settings, press 7 again to delete users, press 6 again to delete all users , then press 1 to delete all passwords, voice prompt: deletion successful, password library is empty.



Press 1 to enter the user settings, then press 7 to enter the deletion of users, then press 6 to delete all users , and then press 2 to delete all fingerprints. Voice prompt: Deletion successful, fingerprint database is empty.



Press 1 to enter the user settings, then press 7 to enter the delete user, and then press 6 to delete all users. User, press 3 again to delete all finger veins. Voice prompt: Deletion successful, finger vein database is empty .



Press 1 to enter the user settings, then press 7 to enter the delete user, and then press the 6 to delete all users. account, and then press 4 to delete all cards. Voice prompt: Deletion successful, card library is empty.



Press 1 to enter the user settings, then press 7 to enter the delete user, and then press 6 to delete all users. account, and then press 5 to delete all faces. Voice prompt: Deletion successful, face database is empty.

---

## 4.4 System settings

### Voice settings

in master mode:



Press 2 to enter the system settings, and then press 1 to enter the voice settings.

Press 1 to set to high volume mode;

Press 2 to set to low volume mode;

Press 3 to set it to silent mode, and there will be no voice prompts in the entire system .

#### Note:

In addition to the alarm sound and operation management menu.

## Language settings

in master mode:



Press 2 to enter the system settings, and then press 2 to enter the language settings.

Press 1 to change to Chinese;  
Press 2 to change to English;  
Press 3 to switch to Russian;  
Press 4 to switch to Kazakh.

-----

## Energy saving settings

in master mode:



Press 2 to enter the system settings, and then press 3 to enter the energy saving settings:  
Press 1 to turn off (turn on) the video function, and the voice prompts: Setup successful;  
Press 2 to turn off (turn on) the face recognition function , voice prompt: Setup successful ;  
Press 3 to enter sensor settings: press 1 to set high sensitivity, press 2 to set low sensitivity Sensitivity, press 3 to set the sensor off, voice prompt: Setup successful.

## Turn on /off dual verification

in master mode:



Press 2 to enter the system settings, then press 4 to turn on (or turn off) two-factor authentication, and the voice prompt Display : Setup successful.

-----

## Turn on /off automatic mode

in master mode:



Press 2 to enter the system settings, then press 5 to turn on (or turn off) the automatic mode, and the voice prompt Display : Setup successful.

## 4.5 Network configuration

### Connect to the network

in master mode:



Press 4 to enter the network configuration settings, and then press 1 to join the network. The lock end voice prompts: The network distribution state has been entered.

Press 4 to enter the distribution network settings, and then press 2 to exit the network. The lock end voice prompts: Exiting the network successfully.

Network Configuration In the mobile application market, search for “Tuya Smart,” download and install it. After logging in, follow the instructions in the app to add devices for network configuration.

#### Note:

The door lock currently only supports connecting to WiFi routers with 2.4G frequency band (the 5G frequency band is not supported), please confirm Ensure that the visible distance between the router and the door lock does not exceed 10 meter , otherwise it will affect the signal connection effect.

### Remote control pairing and unpairing

in master mode:



Press 4 to enter network settings, then press 3 to enter remote control pairing status. The door lock will broadcast "Already in pairing status". At this time, press the unlock button on the remote control to pair the remote control. Press 4 to enter the network settings, then press 4 to enter the remote control unpairing status. The door lock will broadcast "Unpairing status has been entered". At this time, press the unlock button of the remote control that needs to be unpaired to release the pairing with the remote control. After the un pairing is successful, the door lock will broadcast "Unpairing successful".

Press 4 to enter the network settings, then press 5 to unpair all remote controls. When unpairing, the door lock will broadcast "Unpairing, please wait". After the unpairing is successful, the door lock will broadcast "Unpairing successful".

## Set door lock quick linkage

in master mode:



On the first lock, press 4 to enter the network settings, and then press 3 to enter the remote control pairing state. The first lock will serve as the linkage execution device.

On the second lock, press 4 to enter the network settings, and then press 3 to enter the remote control pairing state. When the second lock is unlocked, the first lock can be controlled to unlock at the same time.

---

## Release door lock quick linkage

in master mode:



Enter the master mode on the second lock, press 4 to enter the network settings, then press 4 to enter the remote control unpairing status.

Then enter the master mode on the first lock, press 4 to enter the network settings, then press 4 to enter the remote control unpairing status.

This will release the linkage between the two door locks, and the first lock will not be unlocked when the second lock is unlocked.

Press 4 on any door lock to enter the network settings, then press 5 to unpair all remote controls, which will unlink all remote controls and door locks.



## 4.6 Installation settings

### Door opening direction setting

in master mode:



Press 5 to enter the installation settings, then press 1 to enter the door opening direction setting, and then press 1 to lock On the left side of the door, there is a voice prompt on the lock end: Setup successful.

Press 5 to enter the installation settings, then press 1 to enter the door opening direction setting, and then press 2 to lock On the right side of the door, the lock end voice prompts: Setup successful.

---

### Lockpicking force settings

in master mode:



Press 5 to enter the installation settings, then press 2 to enter the unlocking force setting, and then press 1 to high twist Power, lock end voice prompt: Setting successful.

Press 5 to enter the installation settings, then press 2 to enter the unlocking force setting, and then press 2 to twist Power, lock end voice prompt: Setting successful.

Press 5 to enter the installation settings, then press 2 to enter the unlocking force setting, and then press 3 to lower the torque. Power, lock end voice prompt: Setting successful.

---

### Latch tongue rebound time setting

in master mode:



Press 5 to enter the installation settings , then press 3 to enter the latch rebound time setting, and then enter the latch The tongue rebound time is 2~9 seconds, and the lock end voice prompts: X seconds set successfully.

---

### Automatic lock time setting

in master mode:



Press 5 to enter the installation settings, then press 4 to enter the automatic lock time setting, and then enter the automatic The automatic locking time is 10~90 seconds, and the lock end voice prompts: X seconds set successfully.

## 5 How to use your smart lock

### Outdoor unlocking (common mode)

#### Password unlocking

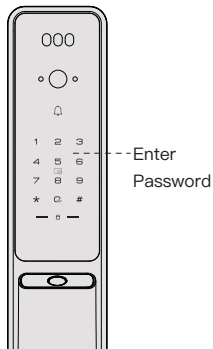

Touch the numeric keyboard area to call Wake up the system; on the numeric keypad area input has been added password, press # key to confirm; The sound prompts that the door has been opened. Push or pull the handle to open the door.

#### Fingerprint

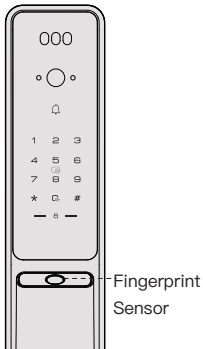

Place the added fingerprint in the fingerprint recognition area. Voice announcement door opened, push or pull handle to open door.

#### Finger Vein Unlocking

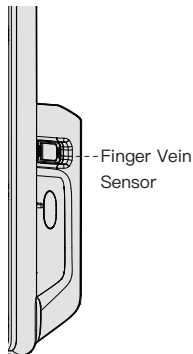

Place the added finger on the finger vein sensor. Push or pull the handle to open the door.

#### 3D face unlocking

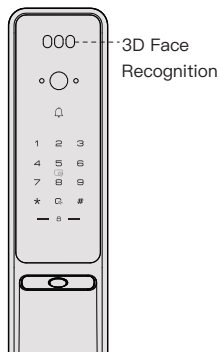

When the user approaches the door lock, the door lock automatically starts face recognition, and the recognition is confirmed successfully; the voice prompts that the door has been opened, and the door is opened by pushing or pulling the handle.

#### NFC unlocking

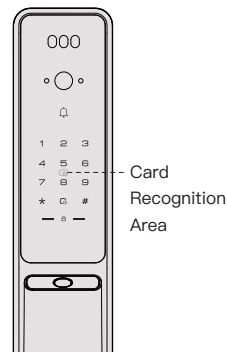

Place the added card in the card recognition area. Voice prompts that the door has been opened, push or pull the handle to open the door.

**Green:** When the indicator light is green, it means the verification is successful and the lock can be unlocked;  
**Red:** When the indicator light is red, it means a verification error or an alarm is generated.

**Note:** When incorrect passwords/fingerprints/finger veins/cards are entered five times in a short period of time, all functions of the smart lock will be locked for 100 seconds.

## Mechanical key unlocking

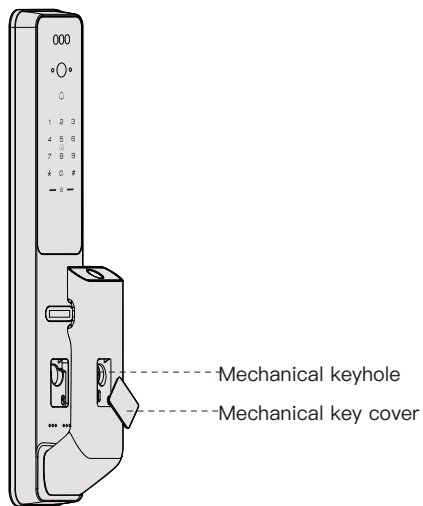

in the event of an emergency such as forgotten password, battery drain, or system failure, The spare mechanical key can be used to open the lock .

Insert the mechanical key and turn it 180° to push or pull the door to unlock.

If the lock is on the left side of the door, turn the mechanical key clockwise,

If the lock is on the right side of the door, turn the mechanical key counterclockwise.

## Electronic unlocking/locking

1. Click the lock button ( CLOSE ) to close the lock
2. Click the unlock button ( OPEN ) to unlock

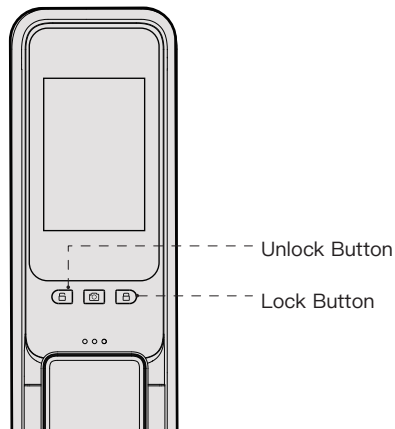

## Quickly open the handle to unlock

Turn the quick-opening handle 45° to open the door.

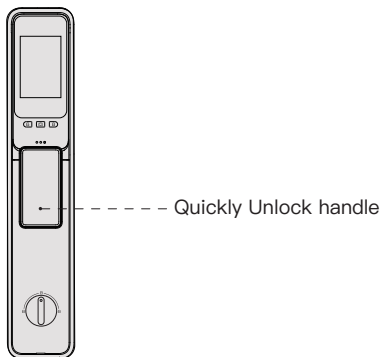

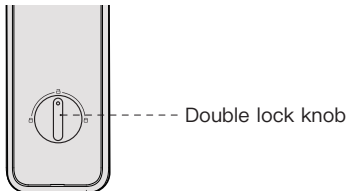

## Indoor anti-lock

Hold the knob under the rear panel , push it in gently and rotate it at the same time. The indoor anti-lock can be opened /closed.



## Silent mode

When the system is in voice mode, after waking up the door lock outdoors, press and hold  to enter silent mode.

When the system is in silent mode, after waking up the door lock outdoors, press and hold  to switch to voice mode.

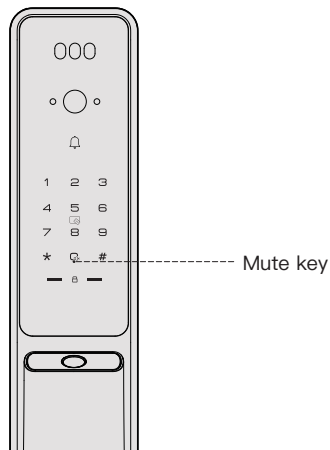

## Remote doorbell ( door viewer )

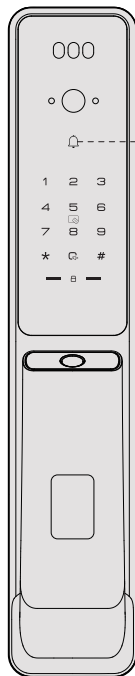

Press the doorbell button and the lock will sound ding-dong indoor. At the same time, the door lock sends a doorbell message to the associated App, click on the pushed doorbell message that opens the cell phone App, at this time the cell phone terminal and the door lock can be remote visual intercom, and the video process can be remotely opened the door with one key. After opening the door, the door lock will capture the beginning of a video and retain it.

### Note:

When using this function, please pay attention to the safety complete. Make sure the situation outside the door is safe complete, you can open the door.

## 6 Other functions

### Restore factory settings

If you accidentally forget the management password, you can press and hold the left and right buttons on the rear panel display of the door lock for 5 seconds to change the voice prompt: " Please press the # button to continue restoring factory settings." Press the # button to confirm, the system will restore factory settings.

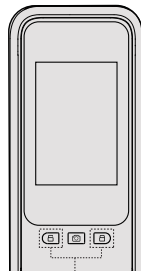

Press and hold the left and right buttons for 5 seconds

### Note:

After restoring to factory settings , all previously set door opening passwords/fingerprints/finger veins/cards The pictures /faces will be cleared, and the management password will be restored to the default 12345678. After initialization, the management password will be forced to be changed.

## Emergency power supply

When the battery voltage is insufficient to open the door from the outside, you can use a 5V rechargeable battery as an emergency power source to power up the door lock through the Type-C connector, and after opening the door lock, please replace the battery immediately.

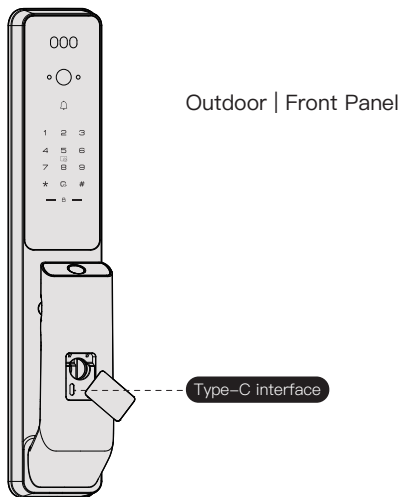

### Note:

When the battery power is too low, the system will prompt you with a voice every time it wakes up. Indicates low battery, please replace the battery; please replace the battery in time at this time.

## Battery replacement method

When the system voice prompts: "Battery is low, please replace the battery", you need to Charge the battery .

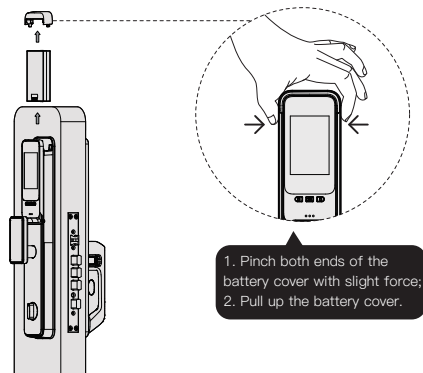



## Shenzhen Kaadas Intelligent Technology Co.,Ltd.

ADD: Floor 11, Building B2, Phase 2, Creative City, Xiandong Road, Xili Community, Xili Street, Nanshan District, Shenzhen, Guangdong, 518000. China