

CLEANING

CAUTION: never use any abrasive, corrosive or scouring cleaning agents. Such agents might damage the truck.

- You may clean the folding hand truck with a damp cloth. Allow it to dry afterwards.

TECHNICAL DATA

Dimensions when folded down 39.37(h) x 15.35(d) x 15.55(w) in
Dimensions when folded up 25(h) x 2.28(d) x 15.24(w) in
Dimension of loading area 15.24 x 10.63 in
Weight 6.56 lb
Maximum load-bearing capacity 154 lbs

WARNING

This product is not a toy. Do not allow children to play with or near this item. Do not exceed weight capacity. **Be aware of dynamic loading!**

Sudden load movement may briefly create excess load causing product failure. Use as intended only. Inspect before every use; do not use if parts are loose or damaged.



Thank you for choosing Mount-It!

Visit us at www.mount-it.com for product registration and warranty information.

Our US based customer service team is standing by to answer any questions you have about your Mount-It! product.

Available by phone **Monday - Friday from 5:00am to 5:00pm** PST.

Chat live with an agent on our website!



support@mount-it.com



(855) 915-2666



www.mount-it.com

MOUNT-IT!

User Manual
SKU: MI-901

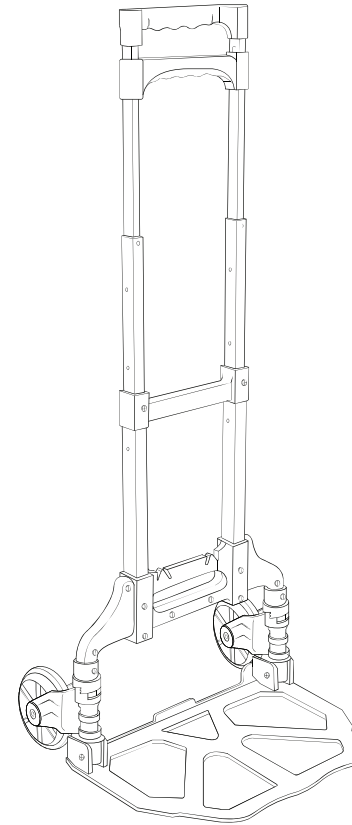

FOLDING HAND TRUCK



HAVE QUESTIONS?

Monday - Friday from 5:00am - 5:00pm PST



support@mount-it.com



(855) 915-2666



www.mount-it.com

Thank you for purchasing our product. We hope you enjoy the folding hand truck.

Please always keep these operating instructions within easy reach. Observe all operating and safety instructions. If you ever sell or share this truck with others, also hand over these operating instructions since they are an integral part of the product.

INSTRUCTIONS FOR YOUR SAFETY

Please read these safety instructions carefully before you use the product for the first time!

- Dispose of unused packaging material or store it in a place inaccessible for children. There is a risk of suffocation!
- Before using this product, make sure that you understand all instructions in order to avoid accidents.
- Operate the folding hand truck only if you feel absolutely fit and healthy.
- Do not overload the folding hand truck!
- Avoid tilting the truck when loaded to prevent it from tipping over.
- Secure the load on the folding hand truck.
- Always move the folding hand truck over obstacles at right angles, i.e. with the wheels on both sides in contact with the ground.
- The folding hand truck is not suited for markedly spiral or spacesaving staircases and is totally unsuited for open stairways.
- Park the folding hand truck on level and firm surfaces and additionally secure the truck against rolling away.
- Before using the folding hand truck, check all parts and safeguards for proper and tight fit. Never use the truck when damaged.
- Persons with limited physical, sensory or mental capabilities must not use the folding hand truck.
- Never allow children to operate the folding hand truck. The truck is not a toy.
- Do not use the folding hand truck on sandy soil or other soft, loose surfaces.
- The folding hand truck is not suited for carrying people or animals.
- Always store the folding hand truck in a dry and well-ventilated place.
- The construction of the folding hand truck must not be altered.
- Use only spare parts and accessories supplied or approved by us.

INTENDED USE

The folding hand truck is intended for private use only and must not be used for industrial or commercial purposes.

Please note that improper use will lead to the forfeiture of liability claims.

PACKAGE CONTENTS

(A) Hand Truck

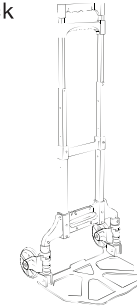

(B) Bungee Cord

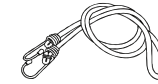

Missing Parts?

Call us at (855) 925-5668 and we will ship replacement parts free of charge.

LOADING

- Always load heavy objects first.
- Observe the maximum load-bearing capacity indicated in the technical data section.
- Always ensure that you stand securely and wear sturdy and slip-resistant shoes.

FOLDING DOWN

Figure A

To unfold the hand truck, grab the end of the nose plate with one hand and the handle or body of the hand truck with the other. Pull the nose plate down and away from the center of the hand truck until it is fully lowered, and the wheels will fold away from the body to be perpendicular to the hand truck body.

Figure B

The hand truck comes with a dual handle. Release the handle from its locked position by squeezing the lower handle against the higher handle, then pull both handles up until the desired height is reached. Note: There are multiple height settings for the handle, and you may need to hold down the lower handle or press it in again to reach the full extension.

Figure A

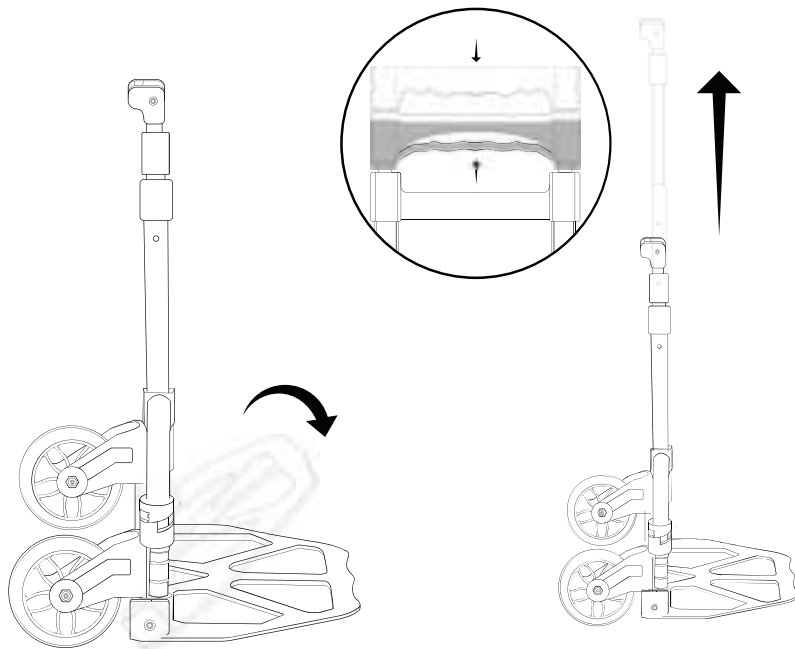

FOLDING UP

Figure C

To fold the hand truck for storage or transport begin by lowering the handle to the lowest position. It can be lowered by squeezing the lower handle against the higher handle, then lower it until it has reached the lowest setting.

Figure D

Fold the nose plate up by grabbing the end of the nose plate with one hand and the handle or body of the hand truck with the other. Pull the nose plate up and toward the center of the hand truck until it has fully raised and parallel to the handle. Ensure the wheels are fully folded back against the hand truck.

Figure C

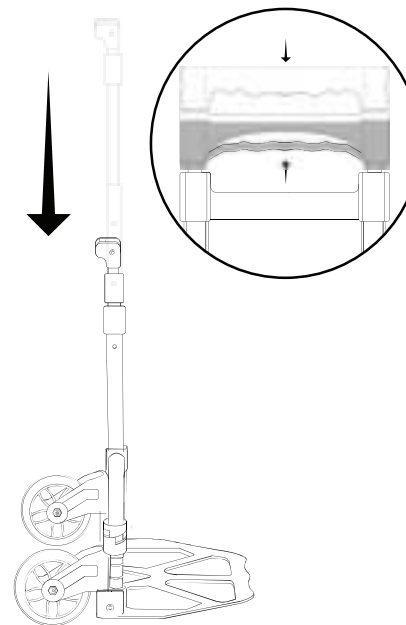

Figure D

