

Series 8, heat pump dryer, 9 kg WQB246C9GB

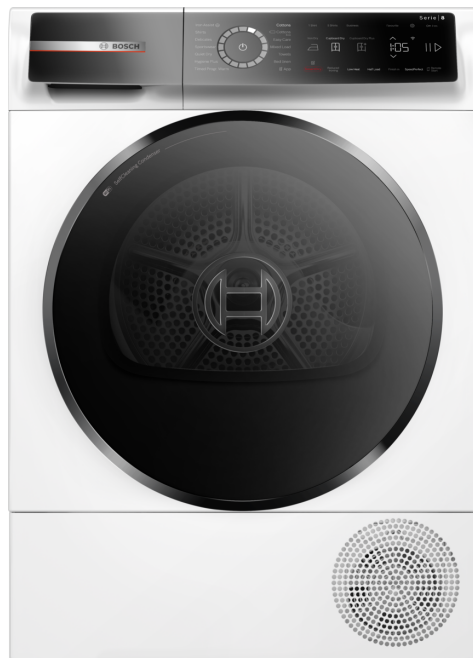

A+++



- **AutoDry:** gently dries laundry to precisely the degree of dryness you want.
- **Automatic condenser cleaning** guarantees a high drying performance with constantly low energy consumption of A+++.
- **Smart Dry:** automatically selects the best drying program based on the last washing cycle.
- **Home Connect:** home appliances with smart connectivity for an easier everyday life.
- **Climate friendly dryer with the most environmental friendly agent (R290).**

Built-in / Free-standing: Free-standing
Removable top: No
Door hinge: Right reversible
Color / Material body: White
Length electrical supply cord: 179.5 cm
Height of removable worktop: 0 mm
Dimensions: 842 x 598 x 613 mm
Net weight: 55.2 kg
Drum volume: 112 l
Fluorinated greenhouse gases: No
Type of refrigerant: R290
Hermetically sealed equipment: Yes
Connection rating: 600 W
Fuse protection: 10 A
Voltage: 220-240 V
Frequency: 50 Hz
Drying process: automatic
Loading capacity: 9.0 kg
Energy efficiency rating: A+++
Energy consumption electric dryer, full load - NEW (2010/30/EC): 1.44 kWh
Standard cotton programme time at full load: 260 min
Energy consumption electric dryer, partial load - NEW (2010/30/EC): 0.80 kWh
Standard cotton programme time at partial load: 156 min
Weighted annual energy consumption, electric dryer - NEW (2010/30/EC): 174.0 kWh/annum
Power consumption in off-mode - NEW (2010/30/EC): 0.30 W
Power consumption in left-on mode - NEW (2010/30/EC): 0.30 W
Duration of the left-on mode - NEW (2012/30/EC): 15 min
Weighted programme time: 201 min
Condensation efficiency class - NEW (2010/30/EC): A
Average condensation efficiency full load (%): 91 %
Average condensation efficiency partial load (%): 91 %
Weighted condensation efficiency for the standard cotton programme at full and partial load: 91 %

WMZ20600 Wool in basket - accessory
WTZ27500 Stacking kit with pull-out shelf
WTZ27510 Stacking kit
WTZPW20D Platform with pull-out, dryer, cubic



Series 8, heat pump dryer, 9 kg WQB246C9GB

engine power and consumption

Programmes

- standard programmes: cotton, easy care
- Special programmes: App, Cotton, Bed linens, shirts/blouses, Cotton Eco, Delicates, Towels, Hygiene, Iron Assist/smartFinish, Mixed Load, Silent Dry, Sportswear, Synthetic, Timed Program Warm

options

- Anti crease cycle 120 min at the end of the programme
- Touch control buttons: 1 shirt, 5 shirts, basic setup, Iron dry, Business, Cupboard dry, Cupboard dry+, end time delay, Half load, Child lock, less ironing, myFavorite, Power button, Remote Start, Low Heat, smartDry/IntelligentDry, Start / Reload / Pause, speedPerfect/varioSpeed, 24 h end time delay

comfort and safety

- selfCleaning Condenser
- AutoDry technology
- Sensitive Drying System: Big Stainless steel drum with textile care structure, soft design paddles
- AntiVibration Design: more stability and quietness
- Drum interior light: LED
- Drain Set
- Child-proof lock
- Buzzer to indicate the end of cycle
- Door hinge: right-hand, door hinge: reversible
- Metal door closing hook

Technical Information

- Slide-under height of 85cm
- Dimensions (H x W): 84.2 cm x 59.8 cm
- Appliance depth: 61.3 cm
- Appliance depth incl. door: 66.2 cm
- Appliance depth with open door: 110.5 cm
- Heat pump technology with eco-friendly cooling agent R290

Series 8, heat pump dryer, 9 kg
WQB246C9GB

Measurements in mm

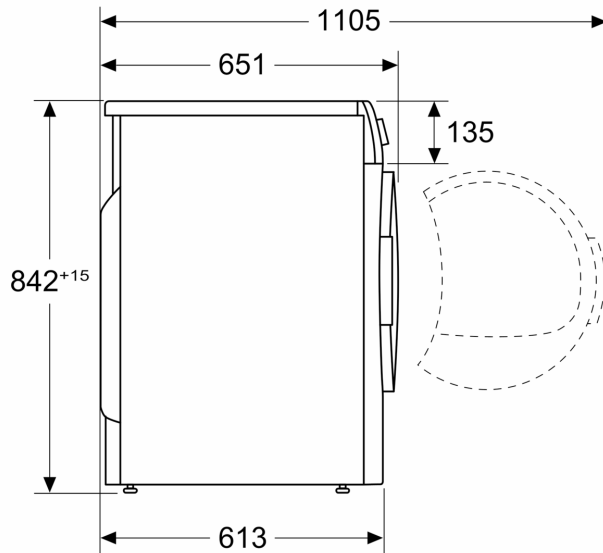

Measurements in mm

