

benayim

**USER
MANUAL**

SNAP AND GO

Specifications

Product Name	Magnetic Wireless Car Charger
Model	AEN.003
Input	5V/2A 、9V/2A 、12V/1.5A
Output	5W、7.5W、10W、15W (MAX)
Charging Distance	<5mm
Working Temperature	14°F-86°F (-10°C-30°C)
Cable Length	3.28feet (MAX) (100cm)
Dimension	3.07 x 2.32 x 4.57 inches
Connect Type	Type-C
Package List	Magnetic Wireless Charger x 1 Transparent Sticker x 2 Cleaning Wipe x 2 Metal Ring x 2 User Manual x 1

The parameters above are derived from the laboratory of AENAYRIM. The actual parameters may differ from product to product or from other factors. All images shown here are for reference only.

Overview

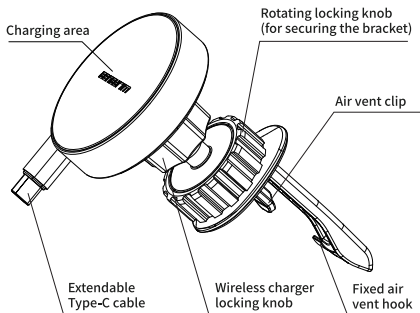

Fittings Included



Cleaning Wipe x 2

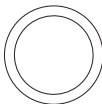

Metal Ring x 2



Transparent Sticker x 2

Installation Instructions

Wireless
Charger



Locking Knob



Car Mount



1 - Insert the locking knob



2 - Connect to the charger



3 - Secure the knob

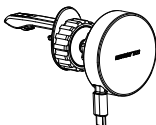

4 - Finished product

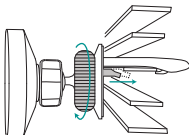

5 - Twist the locking knob and the clip will stretch out and lock the air vent

Operating Instructions

The charger shall be used under the following 3 usage conditions:

- ① Use without a magnetic ring: iPhone X/ newer series phones

The phone will be automatically attached to the charger.

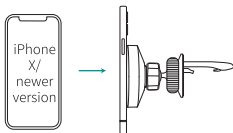

- ② Use without a magnetic ring: iPhone X/ newer series with Magsafe cases

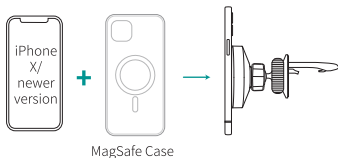

- ③ Use with magnetic ring: iPhone X/ newer series with non-magnetic case

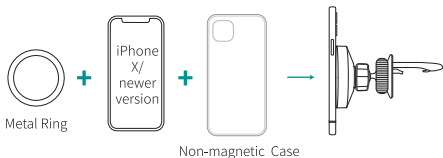

Assembling the Magnetic Ring

There are two ways to paste the magnetic ring.

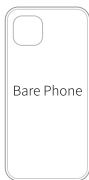

Bare Phone

or



Phone
+
Phone Case

Stick on the back of
the phone (need to stick the
transparent sticker)

Stick on the back of
the phone case (no need to stick
the transparent sticker)

Instructions(with the transparent sticker)

1). Use a cleaning wipe to clean the back of the phone(or phone case)

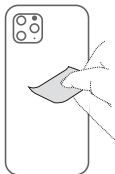

If use a phone case,
INSTALL the magnetic ring
OUTSIDE of the phone case

2). Remove the cover of the transparent sticker, put it at the center of the back of your phone or phone case

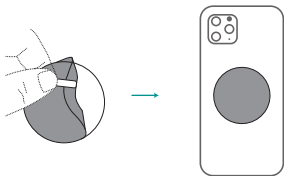

3). Tear off the paper of the magnetic ring and paste it onto the sticker, and the installation is completed.

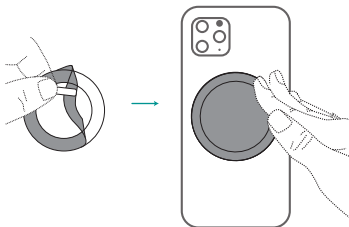

Note: After pasting the magnetic ring, please wait for 24 hours. Then this magnetic wireless car charger will hold your phone firmly.



Product Structural Features

1. This product is a car mount with a built-in high-speed wireless charger. It supports the use of the iPhone X and higher.
2. The rear fixed screw and expandable clamp design are compatible with air vent blades ranging from 3mm to 30mm, ensuring broad compatibility.
3. It features built-in foreign object detection and temperature sensing chips for automatic overheat protection and foreign object detection.
4. The magnet utilizes N52 neodymium iron boron, providing strong and stable magnetic attraction.
5. Crafted from aluminum alloy, the product boasts a sleek and compact design with smooth and effortless extension.

Attentions

1. Avoid dropping.
2. Do not install while driving.
3. Do not install the car mount in places that interfere with the air bag or driving.
4. Please keep this product away from any magnetic items; otherwise, demagnetization might happen.
5. Keep the car mount away from children.
6. Make sure the wireless charger's main unit and components are assembled correctly and the wireless charger's rear fixing hook is securely attached to the outlet.
7. Connect the wireless charger to the car or the car charger's TYPE-C port; place devices with wireless charging capabilities in the designated area for automatic charging.
8. This wireless charger has a sensing distance of less than or equal to 5mm. It won't function properly if the sensing distance exceeds 5mm or if foreign objects interfere with it.
9. Verify that the wireless charger is properly connected and that your device supports wireless charging and is compatible with this product.

Warranty Clause

The warranty for the product is for a period of 12 months from the original date of purchase.

The warranty applies only to the original consumer purchaser of the product (the "Consumer") and is not assignable or transferable to any subsequent consumer.

The warranty does not apply if the product has not been used in accordance with the instructions or in its normal and customary manner.

This device complies with part 15 of the FCC Rules. Operation is subject to the following two conditions: (1) This device may not cause harmful interference, and (2) this device must accept any interference received, including interference that may cause undesired operation.

Any Changes or modifications not expressly approved by the party responsible for compliance could void the user's authority to operate the equipment.

Note: This equipment has been tested and found to comply with the limits for a Class B digital device, pursuant to part 15 of the FCC Rules. These limits are designed to provide reasonable protection against harmful interference in a residential installation. This equipment generates uses and can radiate radio frequency energy and, if not installed and used in accordance with the instructions, may cause harmful interference to radio communications. However, there is no guarantee that interference will not occur in a particular installation. If this equipment does cause harmful interference to radio or television reception, which can be determined by turning the equipment off and on, the user is encouraged to try to correct the interference by one or more of the following measures:

- Reorient or relocate the receiving antenna.
- Increase the separation between the equipment and receiver.
- Connect the equipment into an outlet on a circuit different from that to which the receiver is connected.
- Consult the dealer or an experienced radio/TV technician for help.

This equipment complies with FCC radiation exposure limits set forth for an uncontrolled environment. This equipment should be installed and operated with minimum distance 20cm between the radiator & your body.