



Smart AI Recognition Bird Feeder

Product manual

Customer Support: service@isyoung.com

CONTENT

Warm tips.....	1
What's in the box.....	2
Specifications for bird feeder.....	3
Introduction for bird feeder.....	4
Introduction for camera.....	5
Indicator light.....	6
How to connect to the APP.....	7-11
APP interface introduction.....	12
Top cover installation.....	13
How to install.....	14-17
How to charge the camera.....	17

WARM TIPS

- 1.Keep the bird feeder and all accessories out of reach of children and pets.
- 2.Make sure the camera has been fully charged for the first time.
- 3.Please do not expose the camera lens to sunlight directly .
- 4.Please do not soak the bird feeder in water.
- 5.Please use 2.4 GHz WI-FI to connect the application.
- 6.Please stay away from the strong light when pairing.
- 7.Please keep the bord feeder within the range of WI-FI signal.

WHAT'S IN THE BOX

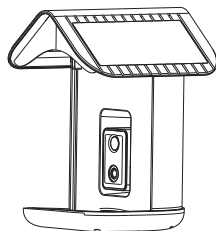

Bird feeder

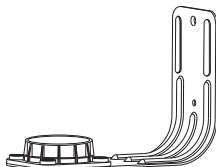

Bird feeder bracket

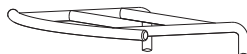

Perch



Drill Sticker

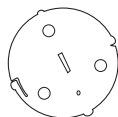

Bracket
connector

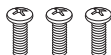

Screw*3

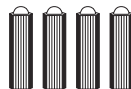

Green screws
spacers *4



Screw for
bracket *4



Pin



Waterproof
rubber



Screw for
perch*2

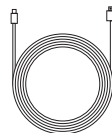

Charging cable

SPECIFICATIONS FOR BIRD FEEDER

Product Model	BF11
Charging	Solar panel and USB cable
Battery	5200 mAh Rechargeable Lithium-Ion Battery
Resolution	2.0MegaPixels Photos and 1080P HD Live Stream Video
Operating Temperature	-5°F to 120°F (-20.5°C to 48.5°C)
Wireless Type	WiFi 2.4GHz
Field of View	Diagonal: 130°, Horizontal: 94°, Vertical: 40°
Dimension	L7.64 * W8.46 * H12.40 inches (19.4 * 21.5 * 31.5cm)
Power Supply	DC 5V2A
Power Consumption	2W(Max.)
Battery Life	4-6 years
Night Visual Range	8m(Max)
Anti-flicker	50HZ /60HZ

SOLAR PANEL SPECIFICATION

IPCE	19%
Working Voltage (Vmp)	5V±5%
Working Current (Imp)	400mA±5%
Open Circuit Voltage (VOC)	7.2V±5%
Short-Circuit Current (ISC)	480mA±5%

INTRODUCTION FOR BIRD FEEDER

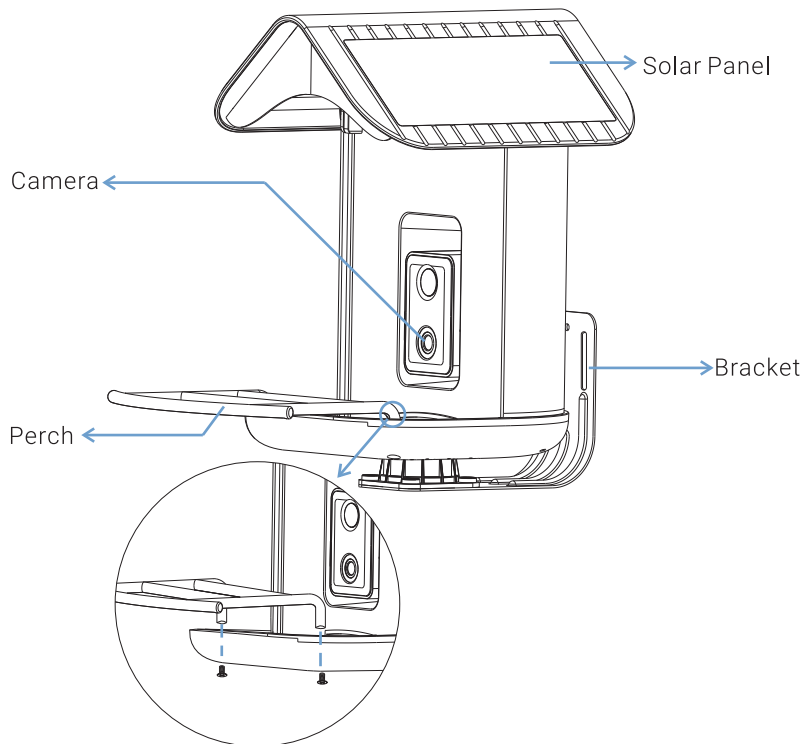

INTRODUCTION FOR CAMERA

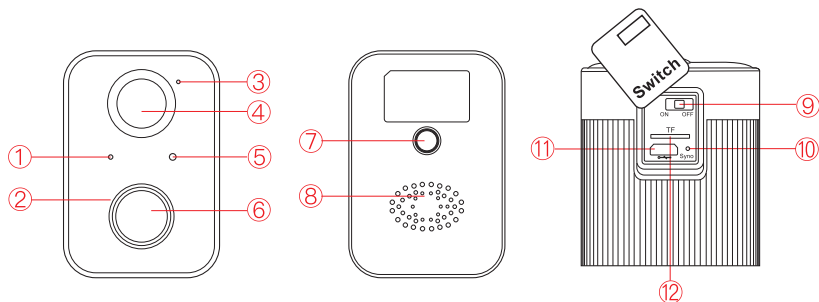

① Indicator Light

② Infrared LED

③ Microphone

④ Motion sensor

⑤ Light sensor

⑥ Lens

⑦ Mounting hole

⑧ Speaker

⑨ Power ON/OFF

⑩ Sync/Reset

⑪ Charging port

⑫ TF card slot (Capacity expansion 128G)

INDICATOR LIGHT

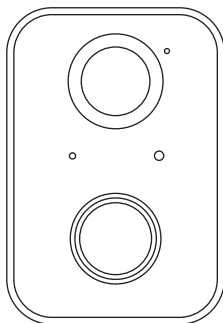

- 1.Camera turn on: Red light always ON.
- 2.Pairing mode: Red light fast blinking.
- 3.Network connecting: Green light fast blinking.
- 4.Network connected: Green light always ON.
- 5.Abnormal status : Red light slow blinking.(Need to reset)
- 6.During firmware update: Yellow light always ON.
- 7.Charging status: White light always ON during charging and OFF after fully charged.

HOW TO CONNECT TO THE APP



Download or scan the QR code and install the Bird Lover App for either IOS or Android. Once downloaded, the APP will prompt you to register your device. Enter your phone number or email address which one makes you feel comfortable and select the country you live in. You will receive the registration code. Input the registration code, then create a password.

1. Turn on the camera power and you will see the indicator light flashing quickly and hear a sound.

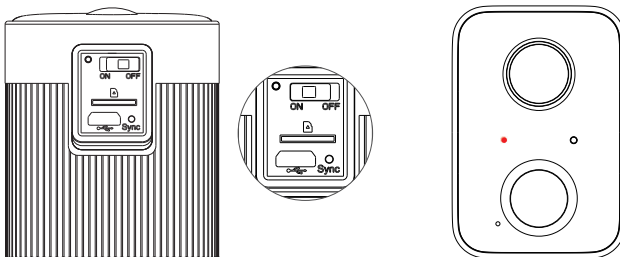

2. Open the App and follow the steps below to start the connection.

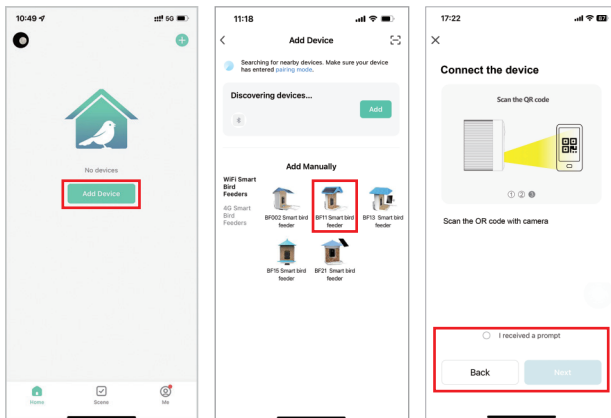

3.You need to enter the right Wi-Fi password for the first-time connection.

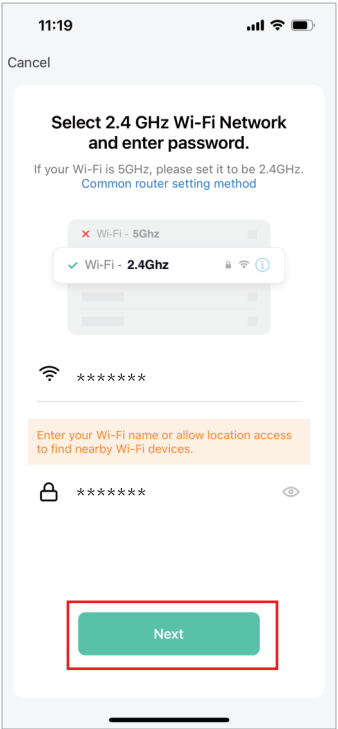

4. Scan the QR code with the camera. You will hear a prompt sound after a successful scanning.

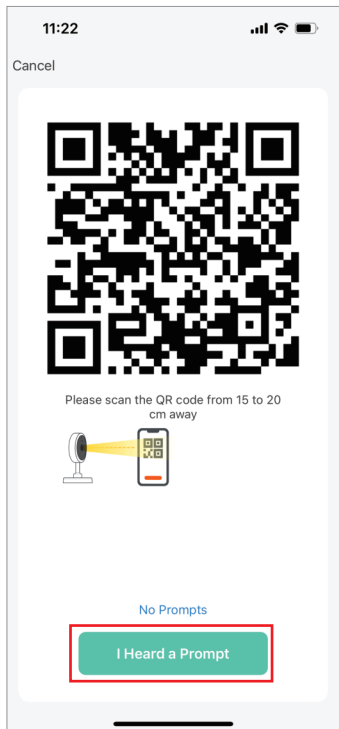

NOTE: The QR code needs to be aimed at the camera below

5.Wait for the connection to complete, then click"Done".

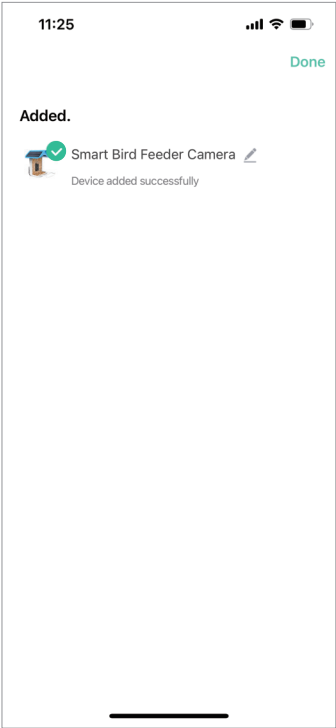
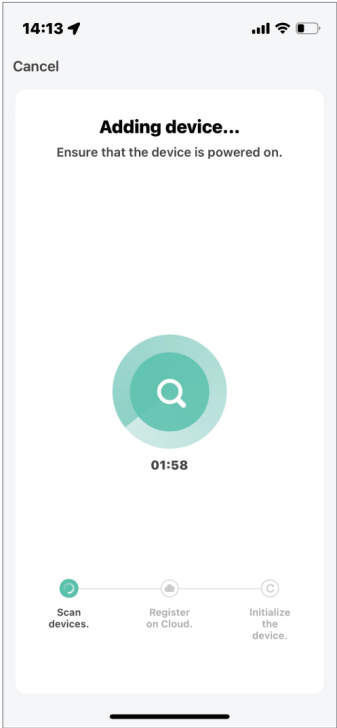

APP INTERFACE INTRODUCTION

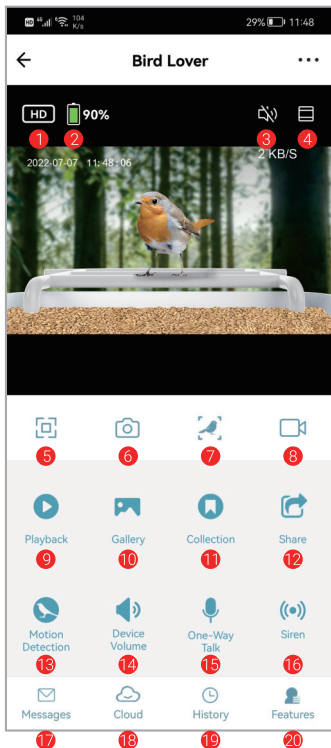

1. Quality adjustment: you can choose HD or SD
2. Battery Remaining Capacity
3. Voice switch
4. Zoom in the screen for camera
5. Screen horizontal and vertical adjustment
6. Take photo
7. Bird recognition
8. Shot videos
9. Playback for previous
10. View photos or videos took
11. Check out the bird collection
12. Share the device
13. Motion detection(Click to turn on/off)
14. Device Volume
15. One-Way Talk
16. Siren
17. Notification for motion detection
18. Cloud storage service
19. History for bird recognition
20. Back to all function interface

TOP COVER INSTALLATION

1.Align the top cover with the groove of the birdhouse and press down.



2.Connect the battery charging cable to the top cover.



3.Twist and snap the top cover.



HOW TO INSTALL

1. Stick the sticker on the tree or wall and drill holes within the range marked on the sticker.



2. Insert the green plastic screw spacers into the hole.



3. Fix the bracket with long screws.

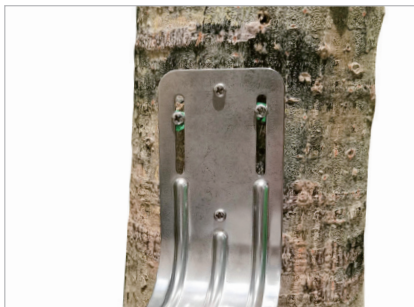

4. Install the bird feeder and align the three holes underneath.

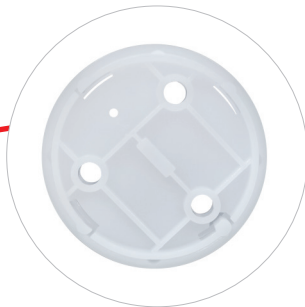

5. Fix bird feeder with three short screws.



6. Install the perch with the two screws in the package.



7.The bird house can rotate left and right.



HOW TO CHARGE THE CAMERA

- ① Rotate the camera down.
- ② Connect the solar charging cable.
- ③ Or remove the camera and charge it with the charging cable.



①



②



③

