

MCombo®

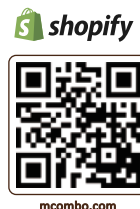

Newacme LLC, 2808 Vail Ave, Commerce, CA, 90040  
sales@mcombo.com  
1-323-597-1109 [8:00 a.m. - 4:00 p.m. (Monday - Friday) TIME ZONE: PST]



OWNER'S MANUAL

# POWER ZERO GRAVITY RECLINER CHAIR

Hello,  
Thank you for choosing MCombo®  
Let's get started

PURCHASER’S AGREEMENT

By accepting delivery of this product, you promise that you will not change, alter, or modify this product or remove or render inoperable or unsafe any guards, shields or other safety features of this product.  
You will not refuse or neglect any retrofit kits that MCombo may provide to enhance and preserve the safe use of this product.

CONTENTS

<b>I</b>	<b>SAFETY GUIDELINES</b> • Mandatory • Danger • Warning • Symbols Information • Disclaimer	- 01	<b>VI</b>	<b>DISASSEMBLY INSTRUCTION</b> • Disconnect all Connections • Disassemble Armrests • Disassemble Backrest	- 16
<b>II</b>	<b>ASSEMBLY INSTRUCTIONS</b> • Product Parameters • Part List • Assembly Steps	- 04	<b>VII</b>	<b>WARRANTY</b>	- 18
<b>III</b>	<b>OPERATING INSTRUCTIONS</b> • Operation Precautions • Operation Instruction	- 10	<b>VIII</b>	<b>RETURN / REPLACEMENT POLICY</b>	- 19
<b>IV</b>	<b>CARE AND MAINTENANCE</b> • Fabric Care • Faux Leather Care • Electronics Care • Disposal & Recycling	- 13	<b>IX</b>	<b>MCOMBO CUSTOMER SUPPORT</b>	- 20
<b>V</b>	<b>TROUBLESHOOTING</b>	- 14			

# I. SAFETY GUIDELINES

## 1. Mandatory

Read the safety and other instructions thoroughly before using your MCombo® product. Failure to follow the guidelines, warnings in this manual and those located on your product can result in personal injury or product damage and will void the product warranty. Keep this manual for future reference.

## 2. Danger

- To prevent suffocation, keep plastic bags away from children.
- Do not allow children play on or near the chair when in use. Serious injury or death could occur if a child is under the chair when the chair is in motion.
- Keep cord out of reach of small children, and do not use where it may be a trip hazard.
- Plug directly into a wall outlet. Do not use an extension cord or adapter.
- Do not use this product if it is wet, in water, around water or any liquid.
- Always leave in an upright and closed position. Keep hands and feet clear of mechanism and all moving parts. Footrest must be completely closed before getting in or out of the chair. Only the occupant should operate the chair.
- Before moving or troubleshooting, unplug power cords from outlet and secure the mechanism to prevent unexpected movement of the chair.

## 3. Warning

- Weight Capacity: 320 lbs.
- Do not use outdoors. INDOOR USE ONLY.
- To avoid tip over, do not put your weight against the back of the chair.
- Do not stand, sit, or place extra weight on the arms, back or open footrest.
- Do not use this product if it is damaged. Do not use attachments or substitute parts.
- Avoid exposing upholstered chair to burning cigarettes or cigars, open flames, and high temperatures.

- Do not operate the unit until the back is installed and locked.
- Do not attempt to disassemble or repair the actuator or pump; no serviceable parts are inside.
- Do not allow electrical cord to be pinched between moving parts or between the frame and the floor. Do not place cord under carpet or in a location where it could become worn.
- Do not attempt to disconnect the power plug by pulling the power cord. Always hold the power plug and pull it out.
- Closely supervise children and disabled persons using this product.
- To reduce the risk of head entrapment and other injuries, keep children and pets away from openings and moving parts in and around furniture.
- This product has many moving parts, serious injury can occur if not used properly. Keep hands, fingers, and body parts away from the mechanism.
- To exit the unit safely and prevent a tripping hazard, bring the back upright and close the footrest.
- Place tables and area rugs at a distance to allow the footrest to fully extend without rubbing or interference.
- Check the condition of the power supplies, electrical cords, plugs, and connectors often. Keep the power supplies and electrical cords away from heat sources. Never operate the unit with a damaged power supply, electrical cord, plug or connector.
- Do not charge your device into the USB charge ports over 24hours.
- Do not charge any devices over 5V/2A with the USB charge ports.
- Do not overlay the USB charge ports with other heat-dissipating electronic products. This may prevent heat dissipation and cause overheating or melting.
- Unplug the power cord immediately if you detect strange odors or fumes coming from the chair. Contact your MCombo Customer Support.
- The chair is intended for a single occupant, not exceeding 320 lbs. Do not operate the chair with more than one occupant in or on any part of the chair.
- If you give this product to someone else, must include this owner's manual.

4. Symbols Information

The symbols below represent labels used on the product to identify warnings, mandatory actions, and prohibited actions. It is especially important for you to read and understand these symbols completely. Do not remove these labels from your product. Please note that not all the symbols may be used on your chair.



Read and follow the information in the owner's manual



Weight Capacity: 320 lbs



Do not connect an extension cord to the AC/DC converter or the battery charger



Do not place objects under the footrest when recliner chair is in fully reclined position



Do not cover or place the external transformer and other objects under recliner chair



Pinch/Crush Points Hazard



Electrical Hazard



Class II Equipment



Indoor Use Only

5. Disclaimer

Make sure you read and understand this manual completely before using your MCombo Product. We are not and cannot be held responsible for any damage or injury incurred due to improper or unsafe use of the MCombo Product. We specifically disclaim responsibility for any bodily injury or property damage that may occur during any use that does not comply with applicable federal, state, or local laws or ordinances.

II. ASSEMBLY INSTRUCTIONS

- Notice
- Please read these instructions thoroughly before using.
  - Do not plug the power supply in until assembly complete.
  - Choose a location for the recliner chair that is close to an electrical outlet (1 power outlet required).

1. Product Parameters

Specification		Description
Model No		6160-ZG334
Rated Voltage		100~240V
Rated Current		2A
Output Voltage		29V
Overall Dimension		35.4"(W)×37.4"(D)×44.1"(H)
Reclining Angle		110°
Weight Capacity		320lbs
Package Quantity		3
USB Power Specifications	Voltage	5V
	Power ( Single )	7.5W

2. Part List

- Notice
- Use MCombo parts only for all replacements.

Box 1 of 3

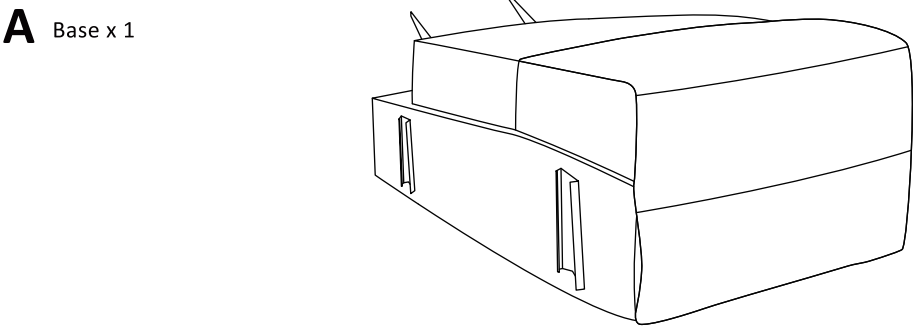

Box 2 of 3

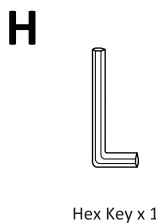
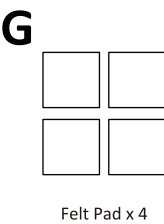
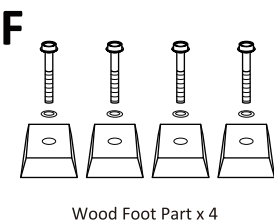
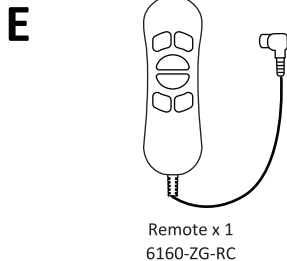
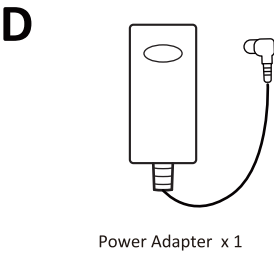
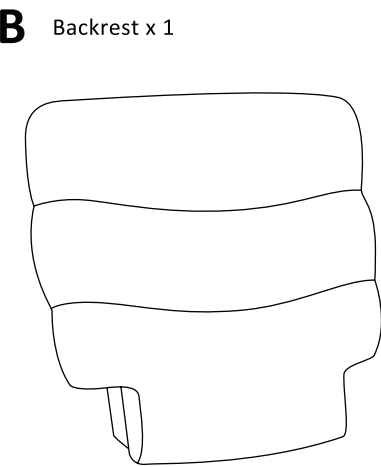

Box 3 of 3

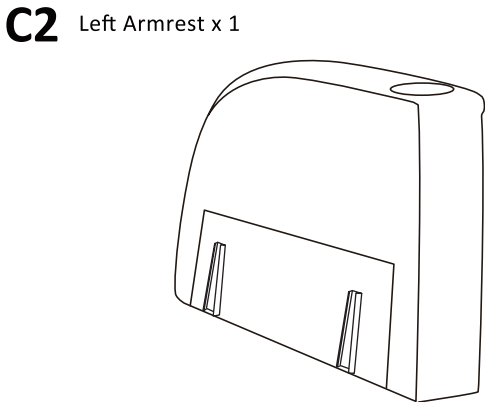
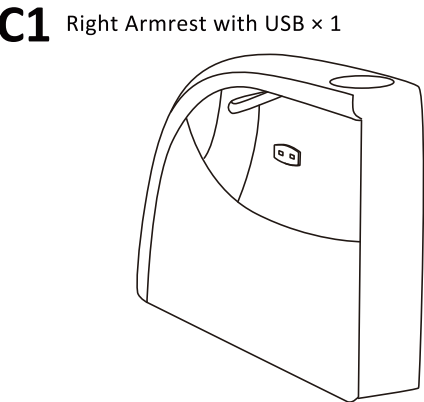

3. Assembly Steps

Step1 - Wood Foot Screw and Washer Assembly

1. Insert the screw and washer into the pre-drilled at the bottom of the armrest.
2. Make sure the screw is properly screwed in and tighten it.
3. Ensure the wood foot does not move.
4. Attach the felt pads onto the feet.
5. Repeat the above 4 steps for the other armrest

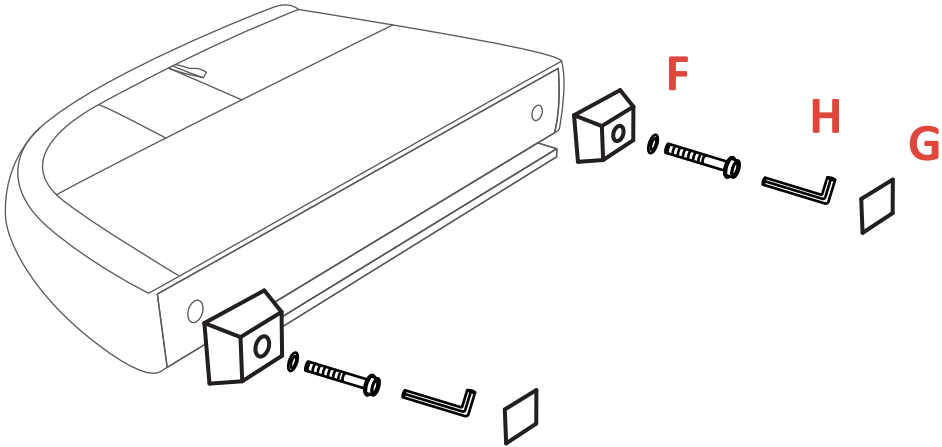

Step2 - Armrest Assembly

1. Flip the base onto one side, ensuring the left armrest brackets align with the base brackets. Slide the left armrest parallel to the base. Then flip the base to the other side and repeat the same step for right armrest.

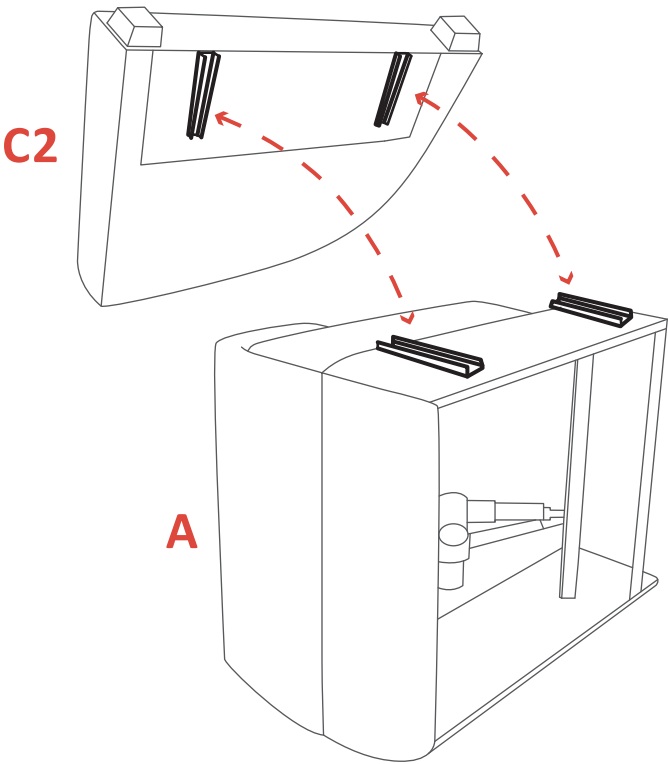

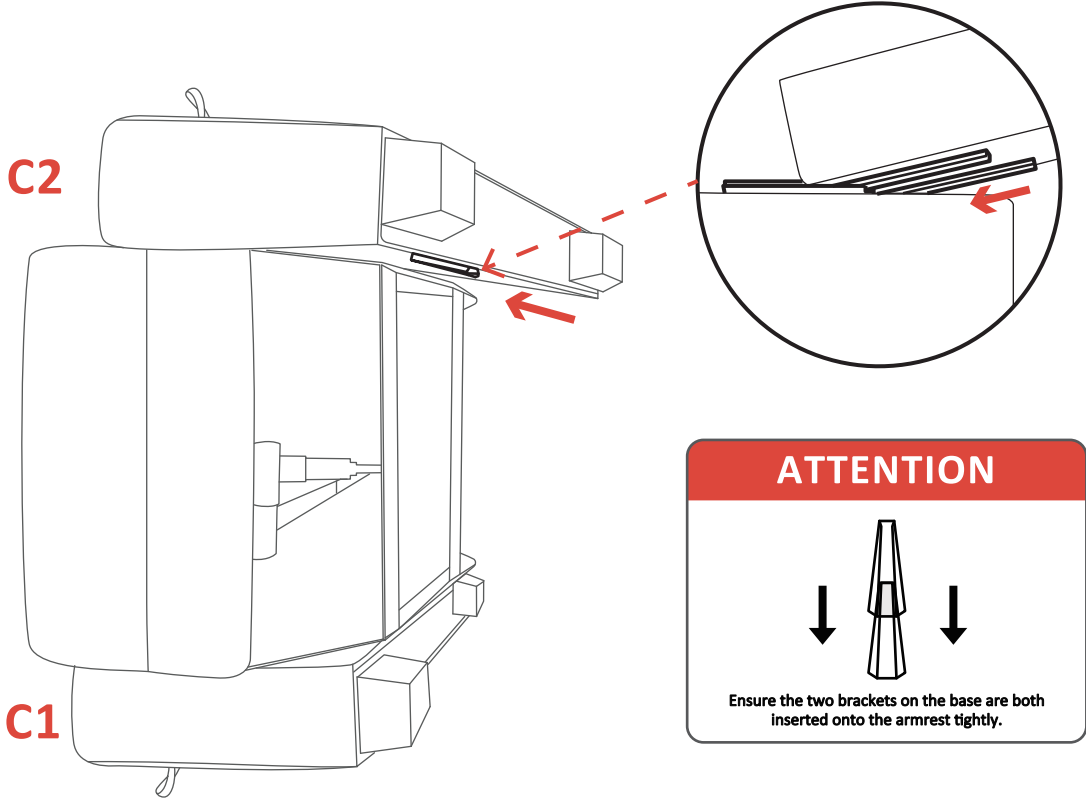

2. Turn the recliner upright and press the base to ensure 4 brackets are fully inserted.

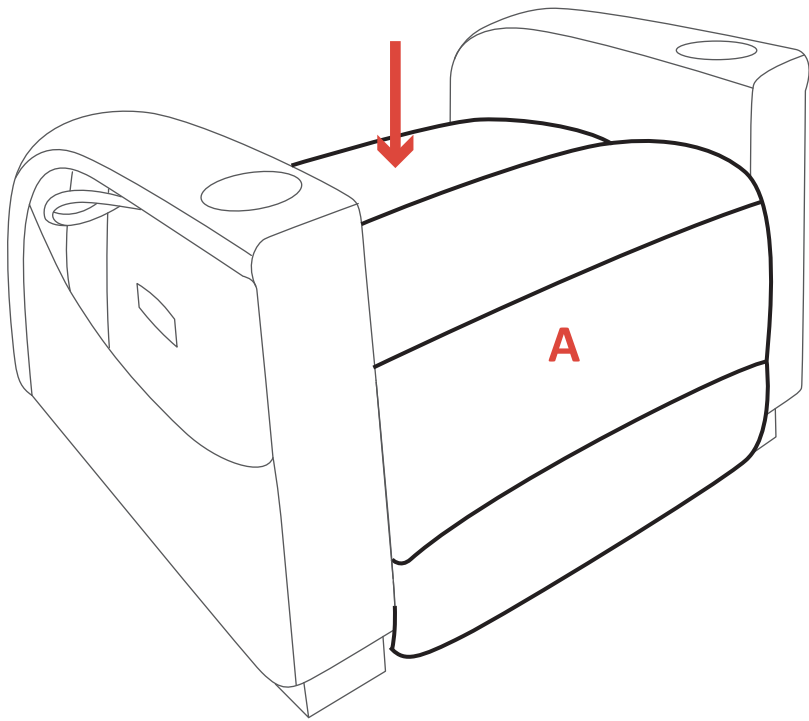

### Step3 - Backrest Assembly

1. Align the brackets of the backrest at the clips of the base-back (Figure).
2. Push firmly the brackets into the base-back. Listen for a "click" on each side to ensure the backrest is locked in properly.

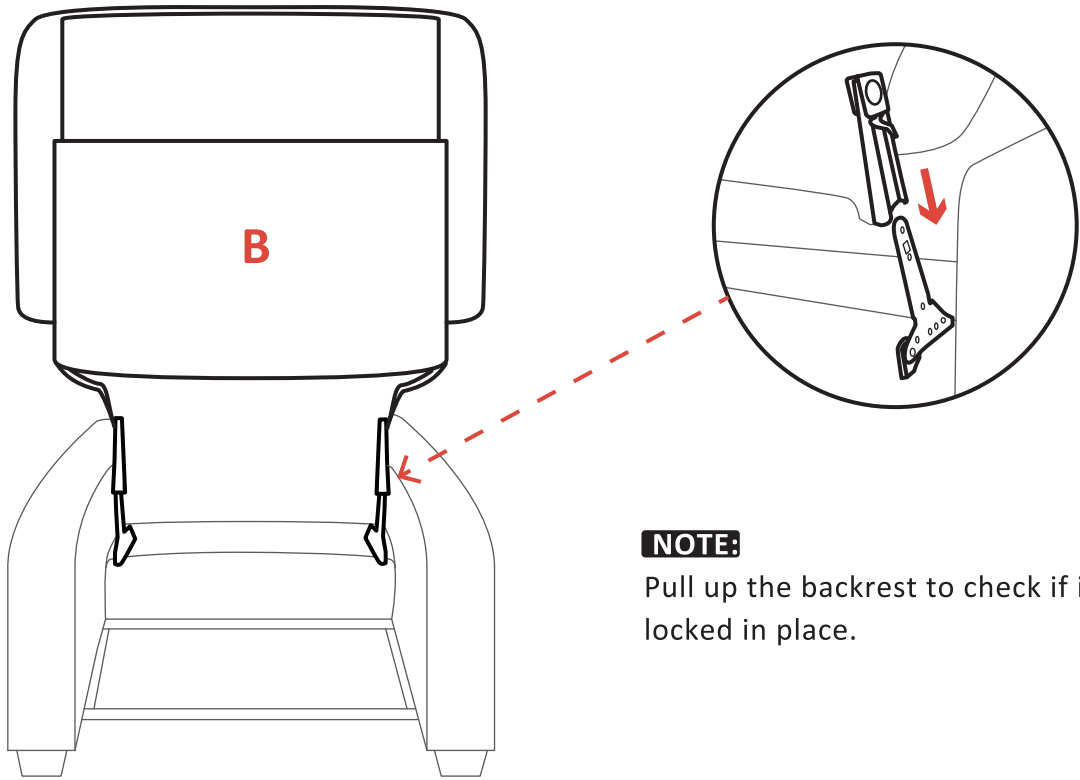

### Step4 - Wire Connections

Before attaching the lift remote to the base, please get the wire through the side loop of either armrest according to the user's preference.

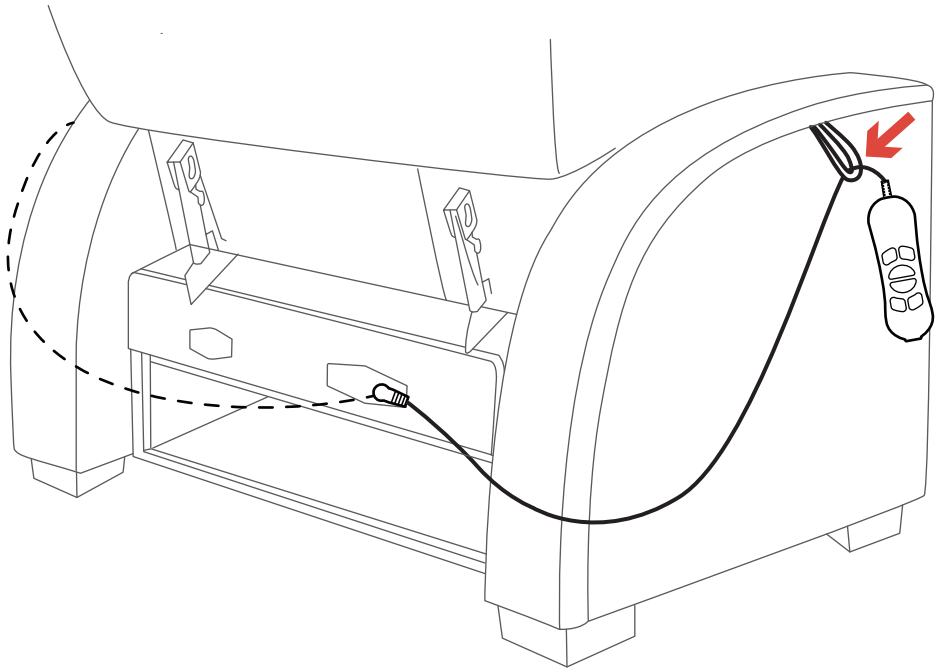

## III. OPERATING INSTRUCTIONS

### 1. Operation Precautions

- Do not use an extension cord.
- Do not exceed recommended weight limit.
- Do not use outdoors. INDOOR USE ONLY.
- Keep dry. Do not operate in a wet or moist environment.
- Keep all cords away from heated surfaces and pinch points.
- Do not use attachments not recommended by the manufacturer.
- Periodically check the control and all power cords for visible damage.
- Always leave the chair in an upright and closed position when not in use.
- Do not use the footrest as a seat, or for purposes outside its intended use.
- Do not lean or apply downward force to the chair-back while in recline position.

#### NOTE:

If you discover a problem at any point during the setup and positioning of your power recliner chair, stop and contact MCombo Customer Support immediately. To avoid personal injury or product damage, do not plug the unit into the electrical outlet until the problem is corrected, and do not attempt to fix electrical problems by yourself.

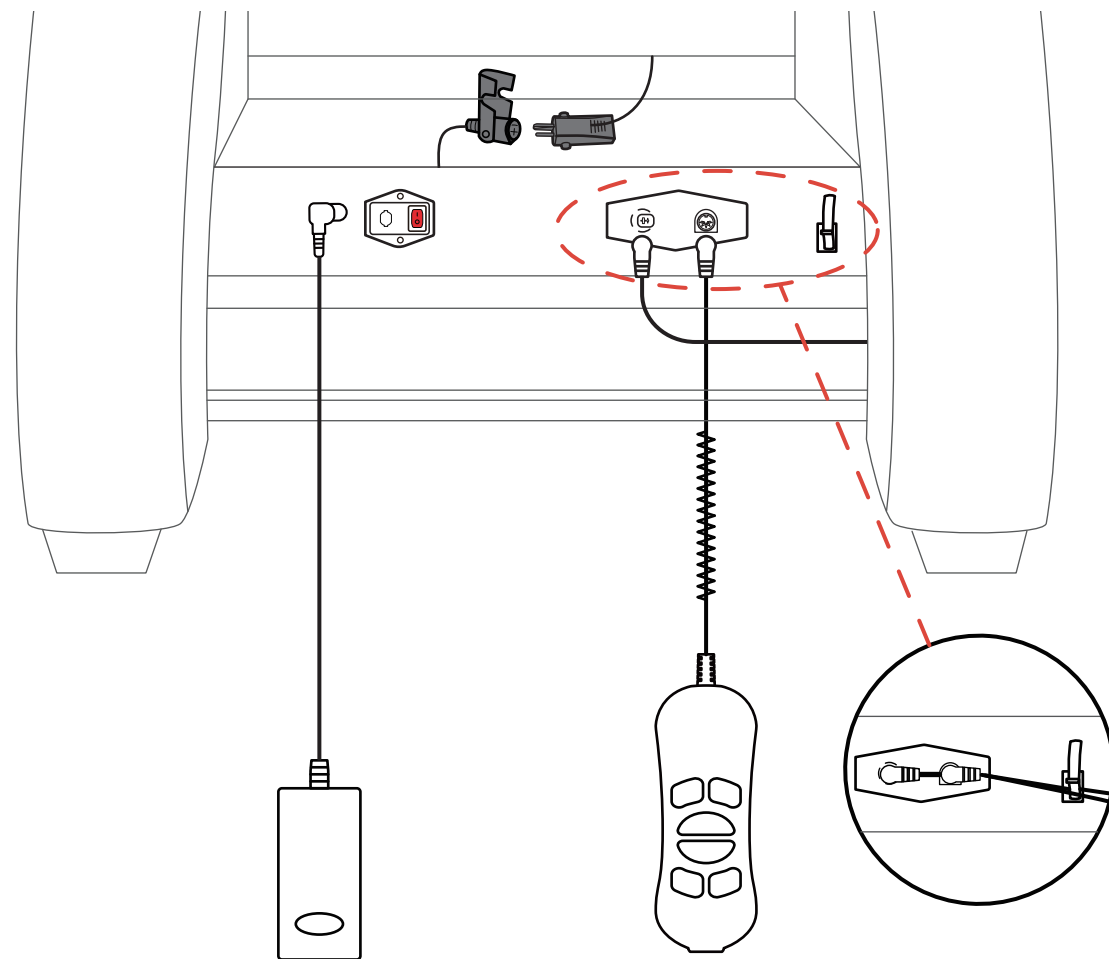

### Step5 - Final Check

1. Ensure both metal brackets on each armrest are securely mounted on the base.

**NOTE:** Each side of the base features two metal brackets. Inserting the armrest into only one bracket might give the appearance of completion, but all pressure should be evenly distributed across both brackets. Failure to do so could result in the armrest detaching from the base.

2. Make sure that the screws on the four wood feet are properly tightened.
3. Verify that the backrest inserts are securely locked to the base.
4. Double-check that all wires are firmly connected.
5. Make sure all wires are not placed at the bottom of the frame and will not be pressed.

**NOTE:** If wires are pressed by the frame, there's a risk of damage, potentially causing the chair to malfunction.



2. Remote Operation Instruction

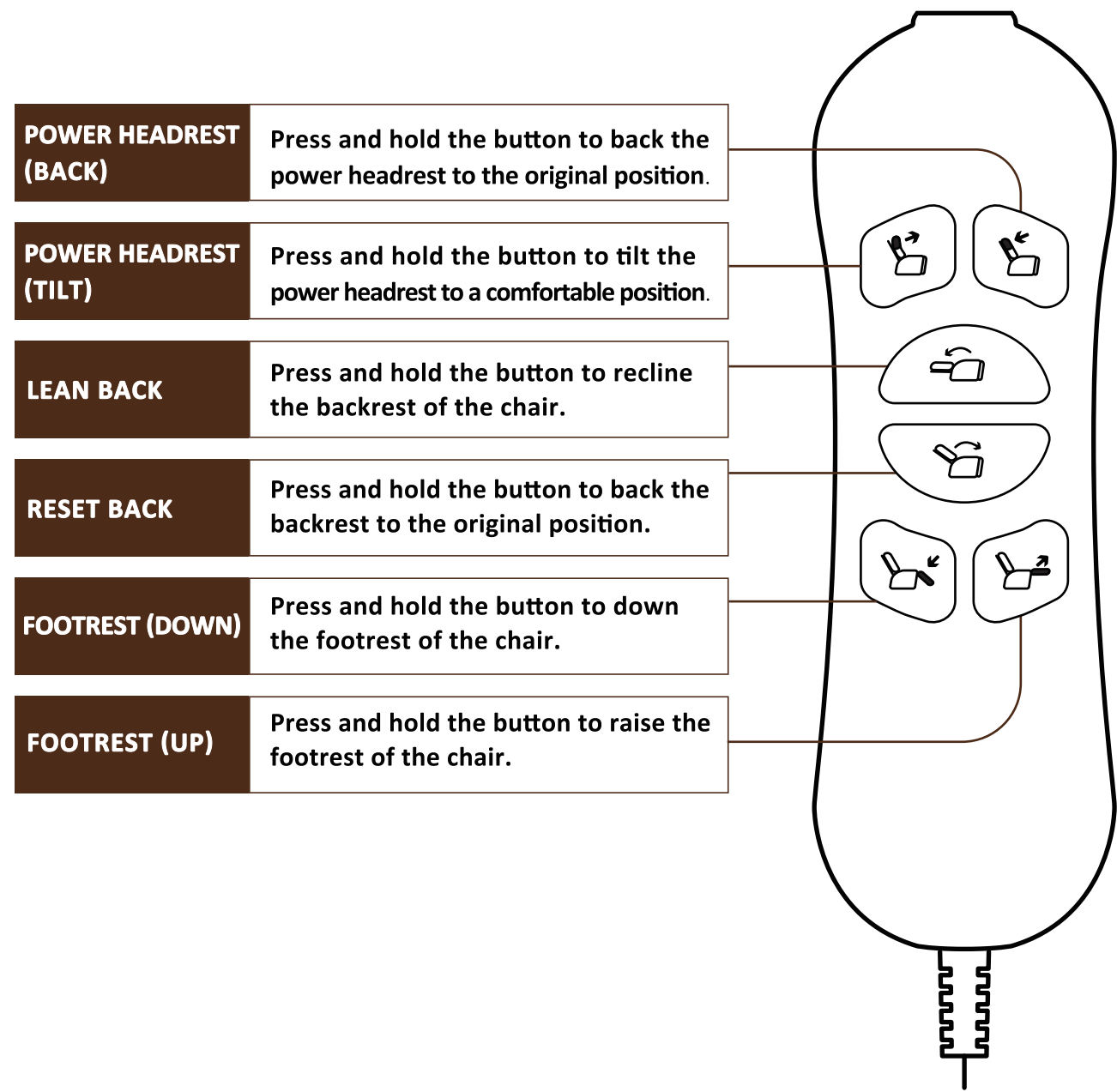

3. Operation Instruction

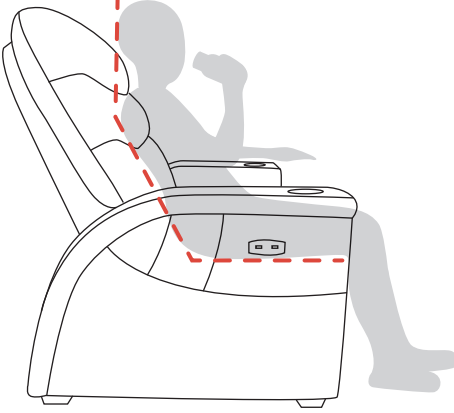

**Seating Position**

When you want to take a short break, there is no need to operate the recliner you will get a immediate comfort experience.

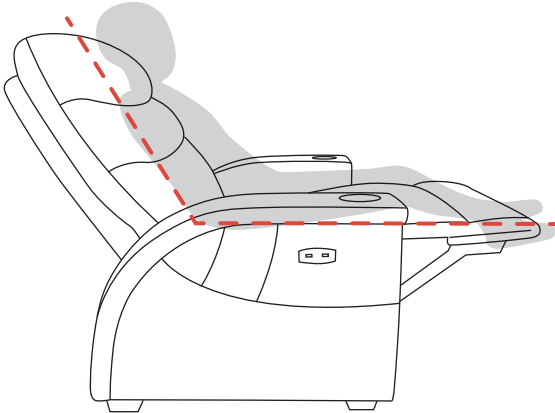

**TV Position**

When you want to relax, adjust the footrest and headrest to maintain the optimal viewing angle.

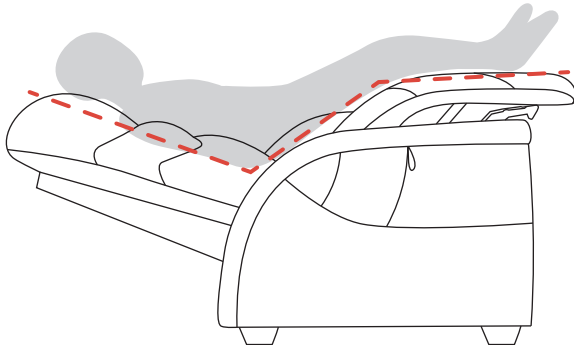

**Zero Gravity Position**

When you want to have a deep relaxation and fatigue relief, elevate the footrest higher to achieve it.

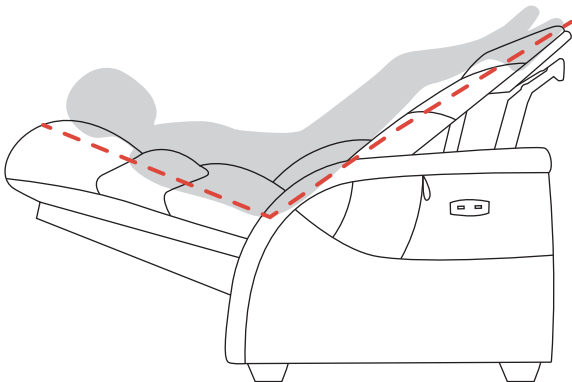

**Anti-Gravity Position**

When you want to get enhanced support and decompression, keep raising the footrest to a desired position.

**NOTE:**

The Anti-Gravity Position must be used with caution, as excessive tilt may cause dizziness and discomfort. It is recommended to consult a professional physician before use.



# IV. CARE AND MAINTENANCE

Your MCombo product will provide years of superior performance and satisfaction with regular care and maintenance. To maintain the finish quality of your "assistant", please follow the guidelines and cleaning procedures provided below.

■ Notice

- Do not place your chair in direct sunlight, as sunlight causes fading.
- Do not smoke cigarettes while seated in or using your chair.
- Avoid extreme changes in temperature by arranging chair away from radiators, heat and air vents.
- Do not use solvent-type cleaners to spot clean.
- Do not saturate fabric.
- Please be careful that pet scratch may cause fabric or leather break.

## 1. Fabric Care

- Inspect the fabric on a regular basis for any pulls, tears, or gaps.
- Frequent vacuuming or light brushing with a nonmetallic, stiff bristle brush to remove dust and grime is recommended.
- When liquid spills onto the fabric, please immediately wipe off liquid spills with a dry or lightly dampened clean white cloth, sponge, or paper towel.

## 2. Faux Leather Care

- Wipe leather down regularly with a clean, dry microfiber cloth.
- For more stubborn dust, dampen the cloth with distilled water. Make sure that the cloth is not soaking wet. Never let water soak into leather.
- Always be sure to use a soft cloth and never use an abrasive brush or scrubber as this can scratch and damage the leather.

## 3. Electronics Care

- Inspect all wiring harnesses to make sure they are not damaged or stuck under chair.
- Keep all the electronics free from moisture and temperature extremes.
- Check electrical components frequently for signs of corrosion and replace as necessary.
- Contact MCombo Customer Support if damage is present, do not fix it by yourself.

## 4. Disposal & Recycling

Your power recliner must be disposed of according to applicable local and national statutory disposal regulations. Contact your local waste disposal agency for information on proper disposal of recliner packaging, metal/wood frame components, fabric, electronic components.

# V. TROUBLESHOOTING

The following troubleshooting FAQs should summarize what you need to know about your power recliner. If at any time you do not feel comfortable performing the troubleshooting steps listed in this manual, please contact MCombo Customer Support for service.

Questions	Answers
What if my power recliner chair does not operate at all?	<ul style="list-style-type: none"><li>• Make sure all the connections at the bottom of the chair are secured; refer to the Assembly Instructions.</li><li>• Check all the electrical cords are not crimped or pinched.</li><li>• Check if the <b>GREEN</b> light on the power adapter is on.</li><li>• Check if the light of the <b>RED</b> button at the back of the base is on.</li><li>• Make sure the <b>GREEN</b> light of the lift remote is on.</li></ul>
What if the reclining function doesn't work?	<ul style="list-style-type: none"><li>• Make sure the <b>GREEN</b> light of the lift remote is on.</li><li>• Check the electrical cords of the motor on the base are not crimped or pinched.</li><li>• Check the rack frame of the recliner chair is not broken.</li><li>• Check if the light of the <b>RED</b> button at the back of the base is on.</li></ul>

Questions	Answers
What if the headrest function doesn't work?	<ul style="list-style-type: none"><li>• Make sure the <b>GREEN</b> light of the lift remote is on.</li><li>• Check the electrical cords of the motor on the backrest are not crimped or pinched.</li><li>• Check the motor of the backrest are not broken.</li><li>• Check if the light of the <b>RED</b> button at the back of the base is on.</li></ul>
What if the USB charge ports do not work?	<ul style="list-style-type: none"><li>• Make sure the <b>GREEN</b> light of the lift remote is on.</li><li>• Check all the electrical cords are not crimped or pinched.</li><li>• Make sure all the connections at the bottom of the chair are secured; refer to the Assembly Instructions.</li><li>• Check if the light of the <b>RED</b> button at the back of the base is on.</li></ul>
What if the armrest falls apart from base?	<ul style="list-style-type: none"><li>• Ensure the two connections on each armrest are all inserted onto the base tightly.</li><li>• Check the brackets of armrest and base to ensure there is no defects.</li></ul>
What if my recliner chair makes a clicking noise?	<ul style="list-style-type: none"><li>• Check the motor and make sure the end of motor at the center of pivot point.</li><li>• Make sure the weight capacity of 320 lbs has not been exceeded.</li></ul>
What if my recliner tilted to one side?	<ul style="list-style-type: none"><li>• Make sure the rack of recliner chair is in a good condition without any distortion.</li></ul>

**NOTE:**

If the recliner chair does not operate properly, please contact the MCombo Customer Support for help and never attempt to make any repairs or adjustments yourself.

# VI. DISASSEMBLY INSTRUCTION

**Notice**

- Ensure the chair is in upright position and its footrest and headrest return to original position.
- Please unplug the power adapter before disassembling.
- Please dismantle the power recliner chair in strict accordance with the order in which they were dismantled.

## Step1 - Disconnect all Connections

Please disconnect all connections on the chair base and backrest before disassembling.

## Step2 - Disassemble Backrest

1. Pushing the metal ears of the backrest inserts outward (Refer to arrow direction).
2. After unlocking the metal lugs on both sides of the backrest, hold the bottom part of the backrest marked in the picture below and pull it vertically upward.

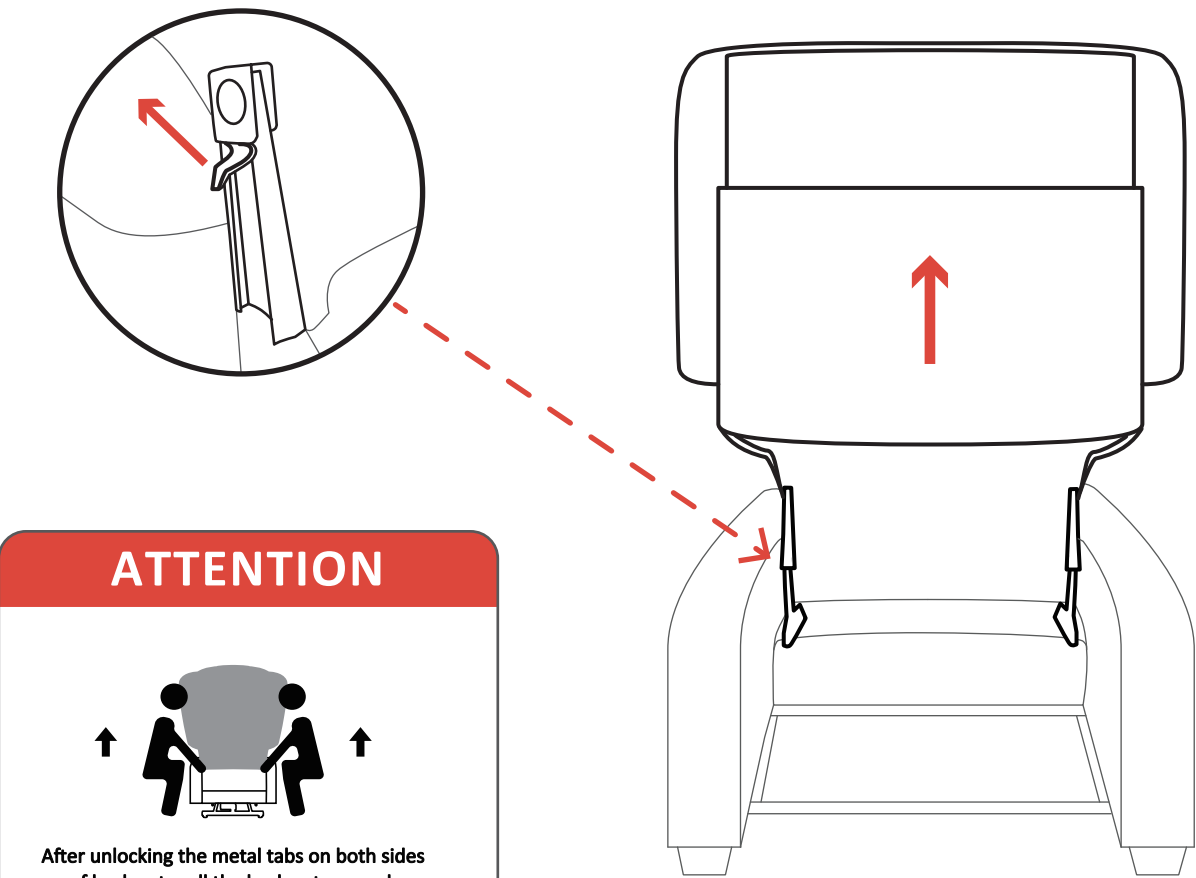

Step3 - Disassemble Armrest

- 1. Turn the base on its side.
- 2. Both hands to hold two feet, and use your foot against the metal rack as shown in the figure and gently.
- 3. shake the armrest to pull it out parallel.

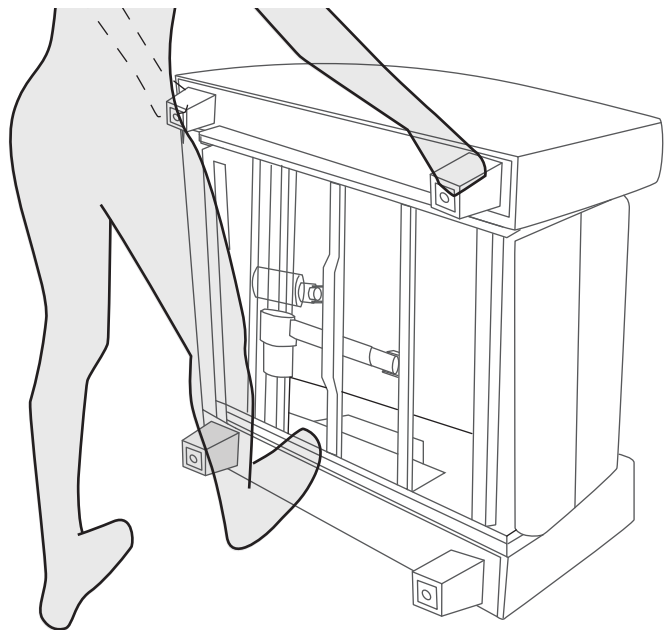

Step4 - Disassemble the Wood foot

Please use the hex key to remove all feet.

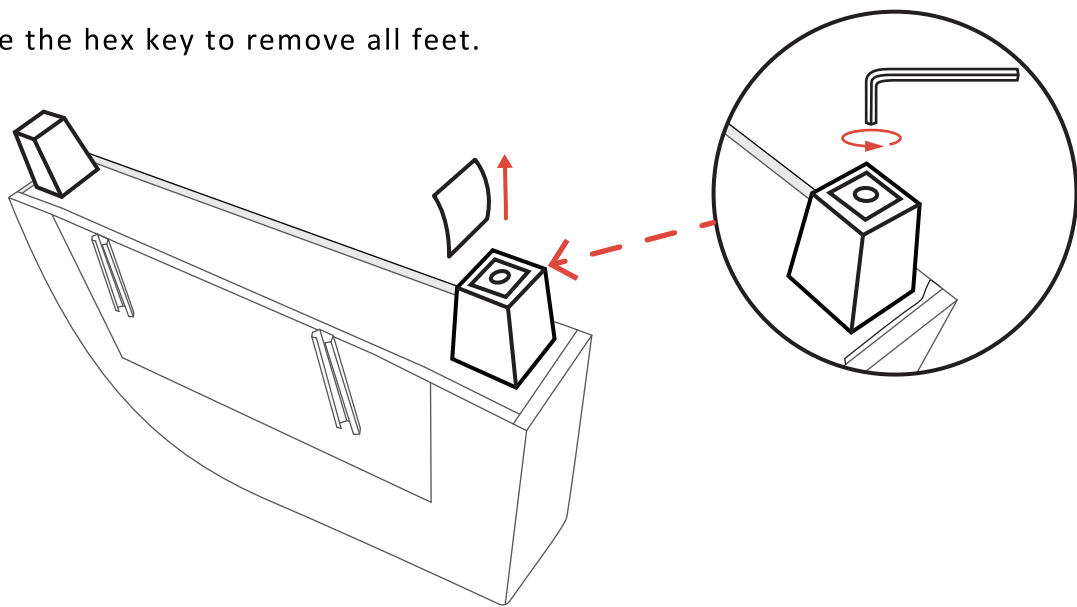

NOTE:

- If the chair needs to be returned, please pack all screws, feet, power supply and other accessories into the box.
- Please refer to the 5-page part list and 19-page return for other packing methods.

VII. WARRANTY

■ Notice

- For product beyond the limited manufacturer warranty period and scope, MCombo® can also provide replacement service, but a basic charge will be charged according to the circumstances.
- The warranty only applies to MCombo® products and does not include any accessories or enhancements.
- Warranties are only valid in the 48 contiguous United States and are contingent upon the consumer operating the product according to the corresponding instruction manual.

Reclining Mechanism	★ 1 Year
Upholstery Material	★ 1 Year
Metal/ Wood Chair Frame	★ 1 Year
Electronic Parts	★ 1 Year

CONSUMER WARRANTY LIMITATIONS AND EXCLUSIONS

All warranties begin on the date of delivery.  
All warranties are to the original purchaser from MCOMBO® ONLY.

- MCOMBO® will replace the defective parts or send replacement product provided that the warranty parts have not been subjected to misuse, abuse or improper service by the consumer, for example, damaged wire arising in consequence of negligence or improper operation.
- Exclusions also include components with damage caused by:
  - Contamination
  - Abuse, misuse, accident, or negligence
  - Commercial use, or use other than normal
  - Improper operation, maintenance, or storage

NOTE:

MCOMBO® will pay standard shipping rates on all warranted parts for the first year. We can also sell you replacement part for a discount price when your product is out of warranty policy.

# VIII. RETURN/ REPLACEMENT POLICY

■ Notice

Why don't we recommend returning the item by yourself?

- Huge cost- UPS/FedEx oversize fee.
- Need you to take the box to UPS/FedEx facility.

## Return/ Replacement Policy

**MCOMBO®**

You have 30 days from the date of purchase to return any item purchased from our store. Please securely pack the item in its original packaging, including any accessories or manuals that came with the product. To initiate a return, please contact our customer service team at [sales@mcombo.com](mailto:sales@mcombo.com)/ 323-597-1109 for any help.







**Return Conditions**

We accept the return of items that are in new, unused condition, with original tags attached and all original packaging and other components included. Refunds will be issued in the original form of payment for the price of the item, including taxes.

- NOTE:**
  - Please keep the original packaging in case the product needs to be returned. If the original packaging is not available, the newly found packaging needs to meet the following size standard:  
UPS/FedEx packaging size standard: ( width+ height ) \* 2+ length< 128 inch.
  - Please disassemble the product before you return it, otherwise there will be a huge cost as oversized and it could even exceed your order amount.
  - Please do not purchase return label for a damaged/defective product by yourself.
  - If you have any problem to return the product, please contact us immediately, we will do our best to help you with a reasonable solution.

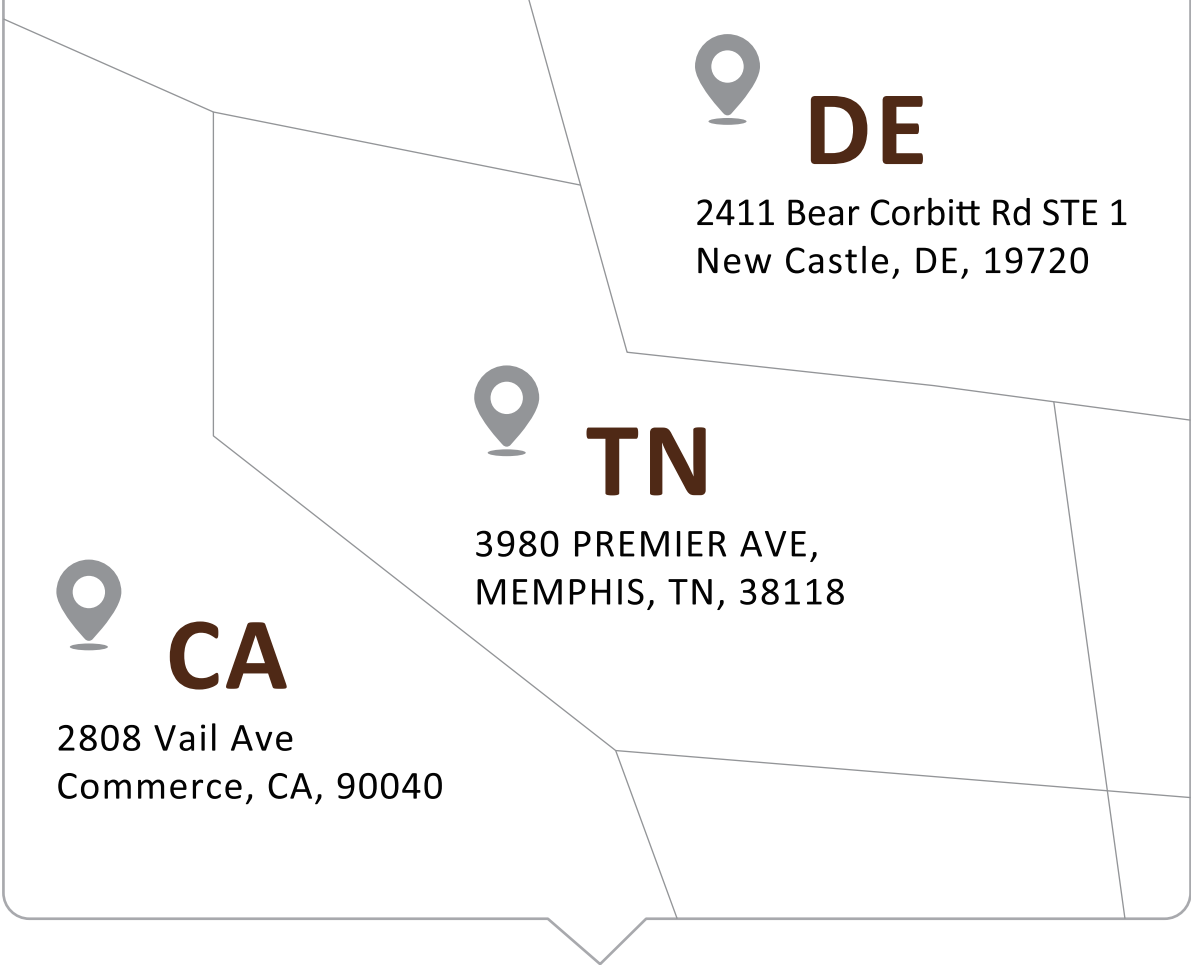
# IX. MCOMBO CUSTOMER SUPPORT

If for any reason, we have fallen short of your expectations, or if you have any questions and suggests, please refer to the following contact information, we will do our best to work with you to make sure you are entirely satisfied.

	<p><a href="mailto:sales@mcombo.com">sales@mcombo.com</a> (Respond within 24 hours)</p>
	<p>1-323-597-1109 8:00 a.m. -- 4:00 p.m. (Monday--Friday) TIME ZONE: PST</p>
 <div><div><b>CA</b><p>2808 Vail Ave Commerce, CA, 90040</p></div><div><b>TN</b><p>3980 PREMIER AVE, MEMPHIS, TN, 38118</p></div><div><b>DE</b><p>2411 Bear Corbitt Rd STE 1 New Castle, DE, 19720</p></div></div>	