



Owner's Manual

Side-Mounted Attachable Bidet with Adjustable Spray Wand

MODELS SMB-15/SMB-25

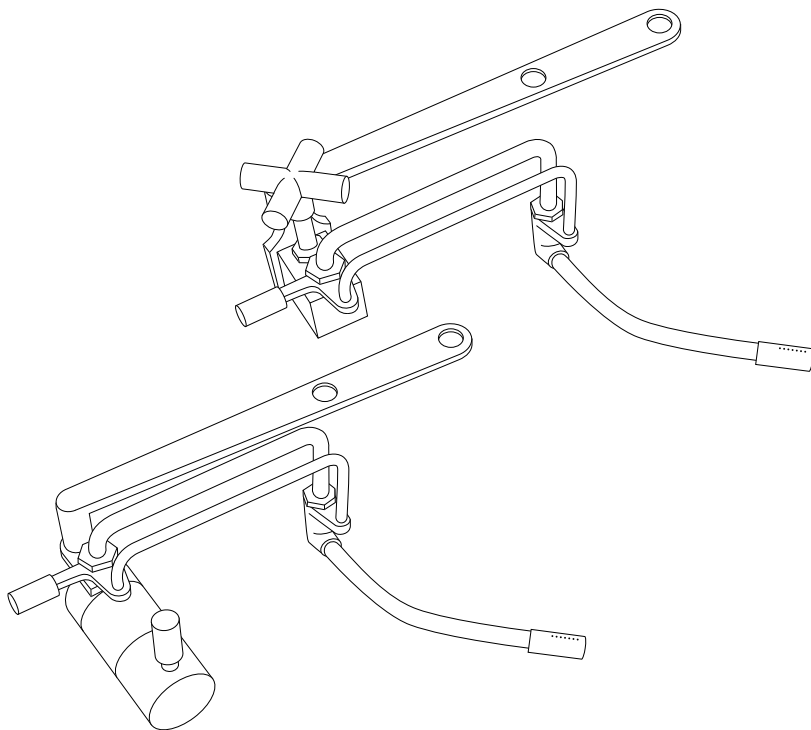

Table of Contents

This manual contains important safety information. Before operating your Side-Mounted Attachable Bidet with Adjustable Spray Wand, please read this manual thoroughly and retain it for future reference.

GENERAL INFORMATION

- 01 PRODUCT INFORMATION
- 01 Product Features
- 02 Product Dimensions
- 03 Product Parts

TECHNICAL INFORMATION

- 11 MAINTENANCE
- 12 PRODUCT SPECIFICATIONS
- 13 WARRANTY
- 14 CONTACT

PRODUCT INSTALLATION

- 04 PRODUCT INSTALLATION
- 04 Before Installation
- 05 Installation
- 06 Connecting the Hot Water Supply
- 07 Installing the Bidet Attachment

TRANSLATIONS

- 01 ENGLISH
- 15 SPANISH
- 30 FRENCH

PRODUCT OPERATION

- 09 PRODUCT OPERATION
- 09 Using the Side-Mounted Attachable Bidet with Adjustable Spray Wand

Product Features

SMB-15 Ambient Temperature Features

Durable Zinc Plated, All-Brass Construction

Swing-Action Spray Wand

Adjustable Water Pressure

Ceramic-Core Internal Valve

High-Quality Metal $\frac{7}{8}$ " T-Valve

Durable Braided Metal Cold Water Hose

No Electricity Or Batteries Required

Easy Installation And Adjustable Toilet Fit

All Accessories Included For Standard Installation

One-Year Warranty

SMB-25 Dual Temperature Features Only

Warm And Cool Water Bidet Washes

Adjustable Water Temperature

Durable High-Temperature Hot Water Flex Tubing

High-Quality Metal $\frac{3}{8}$ " T-Valve

One-Year Warranty

PRODUCT INFORMATION

Product Dimensions

SMB-15 Ambient Temperature

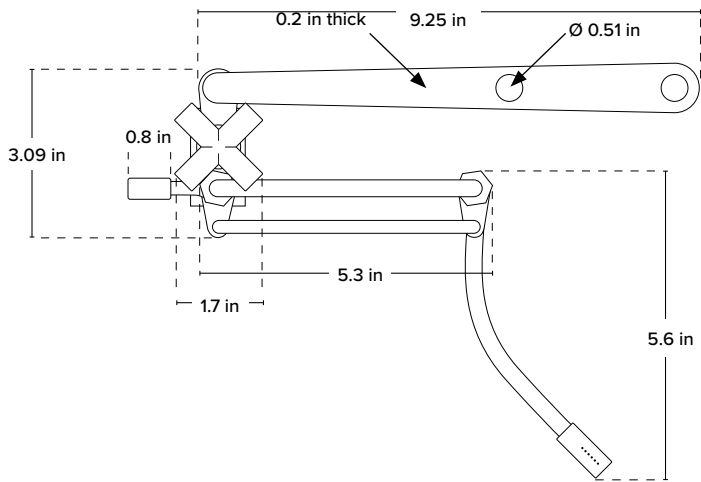

SMB-25 Dual Temperature

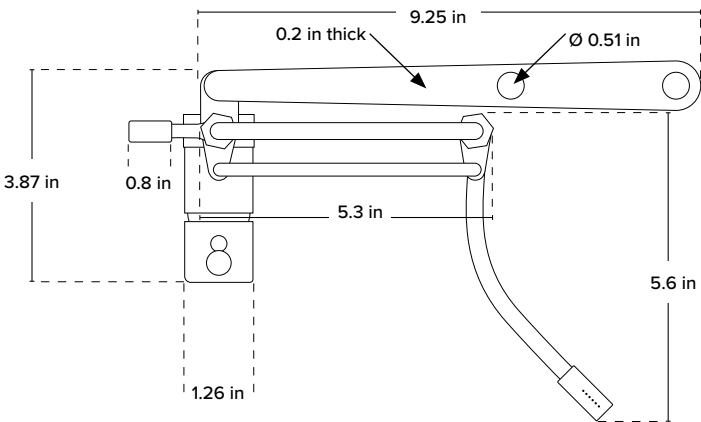

PRODUCT INFORMATION

Product Parts

1. Bidet Attachment
2. Mounting Guide Bolt
3. Small Rubber Washer
4. Metal Washer
5. Metal Nut
6. Cold Water T-Valve Connector
($\frac{1}{8}$ " x $\frac{7}{8}$ " x $\frac{3}{8}$ ")
7. Large Rubber Washer
8. Cold Water Braided Metal Hose
($\frac{1}{2}$ " for Ambient or $\frac{3}{8}$ " for Hot & Cold
Version) Hose length = 15.75"
9. Mounting Washer

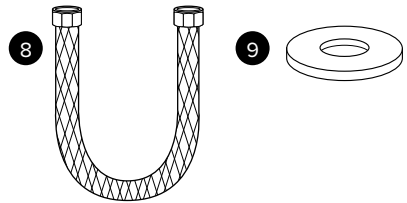
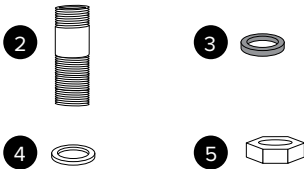
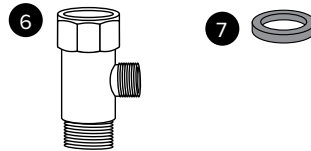
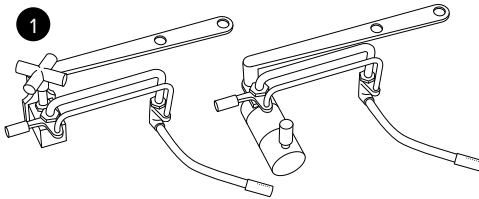

SMB-25 Dual Temperature Only

1. Hot Water $\frac{3}{8}$ " T-Valve with
 $\frac{1}{4}$ " Pressure Connector
and Pressure Cap
2. Hot Water Tubing Pressure
Connector with Pressure Cap
3. $\frac{1}{4}$ " Hot Water Flex Tubing,
Hose Length 78.75"
4. Small Rubber Washers (2)
5. Hot Water Supply Cap

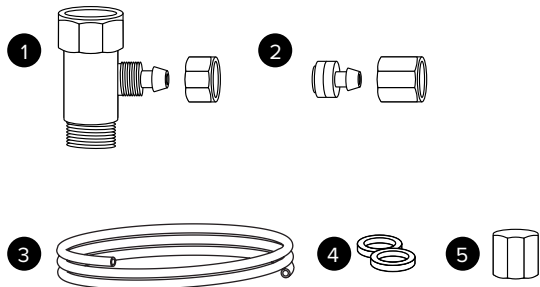

PRODUCT INSTALLATION

Before Installation

IMPORTANT:

Please be advised that the provided cold water T-Valve should be installed at the fill valve under the toilet tank, and NOT at the cold water supply coming from the wall.

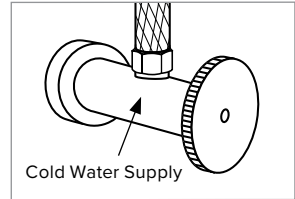

INCORRECT

For SMB-25 Dual Temperature Model Only: Check the size of the hot water supply connection (most likely under the sink/wash basin). This should be a $\frac{3}{8}$ " connection to properly fit and install enclosed T-valve.

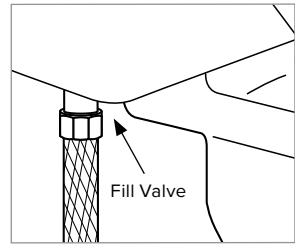

CORRECT

NOTE: If the connection is a $\frac{1}{2}$ " connection, you will need to purchase the following reducing adapter available online and at many plumbing hardware stores: **Reducing Adapter, $\frac{1}{2}$ " Female NPT x $\frac{3}{8}$ " Male Compression**

Check Water Supply Line

Check the water supply line that connects the toilet tank fill valve to the water shutoff valve at the wall. If it is a rigid pipe, you will need to purchase a flexible water supply hose to replace it before installing the Side-Mounted Attachable Bidet with Adjustable Spray Wand. The length of the hose may vary, and the top connection size should be $\frac{7}{8}$ " ballcock to connect to the T-valve that you will install under the toilet tank. The bottom connection will vary (most common are $\frac{3}{8}$ " and $\frac{1}{2}$ " female compression).

Installation

Please read these instructions carefully before installing your Side-Mounted Bidet. Failure to do so could result in flooding, leaking or damage to the product.

1. Existing Toilet Seat Removal.

- Lift hinge covers and use flathead or Phillips head screwdriver to remove the mounting bolts. Alternatively, you may need to loosen mounting bolts underneath the seat.
- Remove the toilet seat and set the seat, mounting bolts and hardware aside.

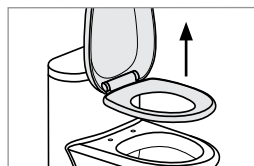

Step 1b

2. Turn Off Water Supply Valve And Flush Toilet.

- Turn water supply valve off to stop the flow of water.
- Flush toilet and hold down handle to completely empty tank.
- Disconnect water supply hose from toilet tank. Do not disconnect from the water supply valve.

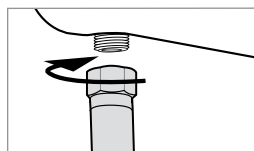

Step 2c

3. Connect Cold Water T-Valve To The Toilet Tank Fill Valve.

- Install the 7/8" cold water T-valve with one or both of the large rubber washers to the incoming water connection on the bottom of your toilet tank.
- Connect the cold water supply line coming from the wall to the bottom of the T-valve.

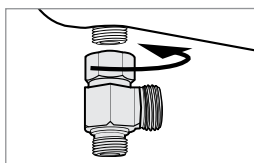

Step 3a

4. Connect Bidet Hose To T-Valve.

Connect one end of the braided metal cold water bidet hose to the remaining open side of the installed T-valve.

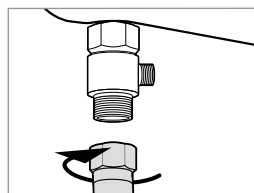

Step 3b

FOR AMBIENT TEMPERATURE MODEL, STOP HERE AND PROCEED TO "INSTALLING THE BIDET ATTACHMENT" ON PAGE 7. FOR DUAL TEMPERATURE MODEL, CONTINUE.

5. Install The Hot Water Supply Cap.

- If you are only connecting the cold water supply, then you must install the hot water supply cap (provided - see Page 3) over the hot water connection on your bidet (see diagram).
- After installing hot water cap, proceed to "Installing the Bidet Attachment" on Page 7. If you wish to also connect your hot water supply, proceed to "Connecting the Hot Water Supply".

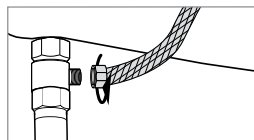

Step 4

IMPORTANT: Failure to connect or cap the hot water supply will result in leaking during use.

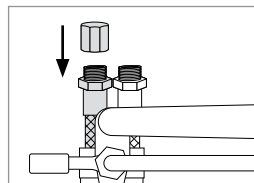

Step 5a

Connecting the Hot Water Supply

1. Connect The Hot Water Supply.

- Locate the hot water supply line in your bathroom under your sink/washbasin and turn the water supply valve all the way off.
- Drain the hot water line by turning the sink tap on the hot setting until no more water comes out.
- Disconnect hot water supply hose to sink from shut off valve. You may have to use a $\frac{3}{8}$ " compatible wrench or a similar tool (not supplied).

NOTE: There may be some residual water in the hose; use a small container or towel to catch any residual water.

2. Install the Hot Water $\frac{3}{8}$ " T-Valve and the small rubber washers as needed onto the hot water shut off valve under the sink.

3. Reconnect hot water supply line to open end (top) of T-valve.

4. If not already removed, unscrew the pressure cap covering the pressure connector on the T-valve.

- Slide the pressure cap over the open end of the of hot water flex tubing with the inside threads facing towards the open end.
- Push the hot water flex tubing over the pressure connector.

IMPORTANT: Be sure to slide the hot water flex tubing over the pressure connector until the tubing slides past the "lip" of the pressure connector and it cannot go any further.

- Slide the pressure cap down until the cap meets the pressure connector. Screw the cap onto the T-valve until secure and tight.

CAUTION: Do not over-tighten the pressure cap. You will risk damaging the tubing.

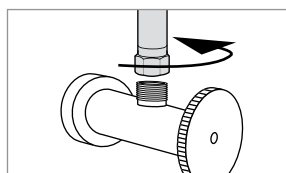

Step 1c

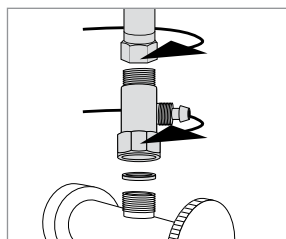

Steps 2-3

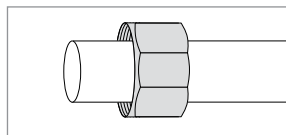

Step 4a

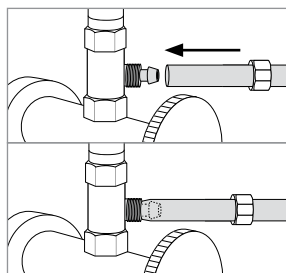

Step 4b

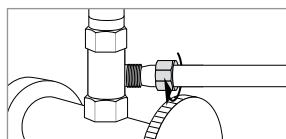

Step 4c

Installing the Bidet Attachment

1. Install mounting guide bolt into middle opening (1a) of bidet attachment bracket. For one-piece or skirted toilets, install mounting guide bolt into outside opening (1b) of bidet attachment bracket.

2. Install Bidet Attachment On Toilet.

- Place bidet attachment on the toilet, making sure to insert mounting guide bolt into toilet bolt opening.
- Secure bidet attachment to toilet bowl using small rubber washer, metal washer, and metal nut.
- Before tightening nut completely, use the nozzle control handle to move spray wand to full extension. Adjust bracket and control valve body until the spray wand head is positioned in the center of the toilet bowl, or in an alternative desired position. Gently retract spray wand to ensure it sits just beneath toilet bowl rim. Hand-tighten the metal nut until fully secured.

CAUTION: Avoid over-tightening, as damage may occur.

- Place mounting washer over opposite toilet bolt opening.
- Replace the toilet seat on top of bidet attachment and secure using original toilet seat hardware.

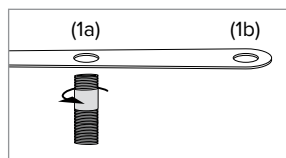
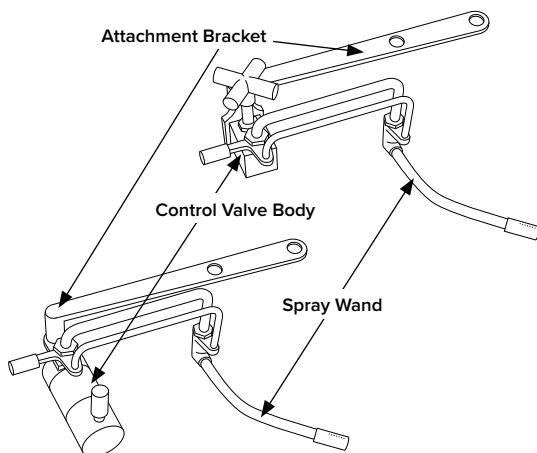

Step 1

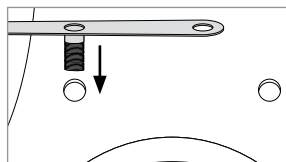

Step 2a

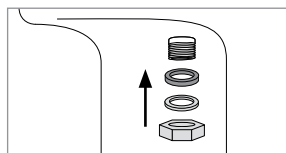

Step 2b

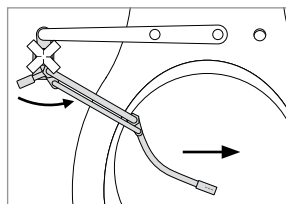

Step 2c

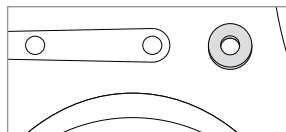

Step 2d



Step 2e

Installing the Bidet Attachment (contd.)

3. Connect Bidet Hose To Bidet Attachment.

Connect the open end of bidet hose to the cold connection behind the bidet attachment.

NOTE: If you have already installed the hot water supply cap over the hot water supply on your SMB-25 Dual Temperature model, skip to step 5.

4. Connect Hot Water Tube To Bidet Attachment

(For SMB-25 Dual Temperature Model Only).

- Take the hot water tubing pressure connector and remove the pressure cap.
- Slide the pressure cap over the open end of the of hot water flex tubing with the inside threads facing towards the open end.
- Push the pressure connector into the open end of the of hot water flex tubing with the washer facing out.

IMPORTANT: Be sure to slide the hot water flex tubing over the pressure connector until the tubing slides past the "lip" of the pressure connector and it cannot go any further.

- Hold the pressure connector up against the hot water inlet on the bidet attachment. Slide the pressure cap along the tubing and screw the cap onto the hot water inlet until the pressure connector is secure.

5. Turn On Water Supply & Check For Leaks.

- Open the main water supply valve slowly and check for leaks.
- Wait 5-10 minutes, check again, and if there are no leaks, continue.

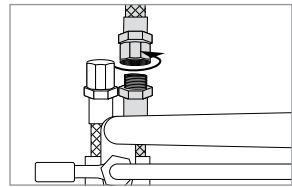

Step 3

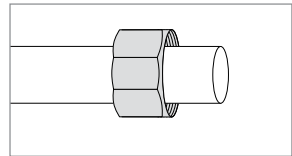

Step 4b

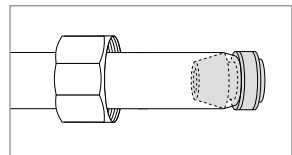

Step 4c

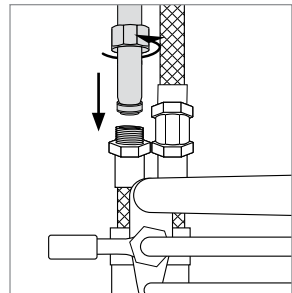

Step 4d

NOTE: If there is any leaking, check all rubber washers and make sure all water connections are tight and secure. If necessary, you can use plumbers tape for any leaking connections.

TIP: If spray direction is off-center after installation or does not rest properly under toilet bowl rim, loosen mounting nut, reposition the control valve body, and secure back in place. Depending on your preferences or body composition, the perfect position may require some readjustment.

Using the Side-Mounted Bidet

Extend spray wand to desired location using nozzle control handle.

To engage a wash on SMB-15, slowly turn control knob clockwise to ON position.

To engage a wash on SMB-25, very gently push water pressure control handle forward to ON position.

- The further forward the handle is pushed, the higher the water pressure will be. Take care not to initiate water at full pressure, as discomfort or injury can occur.
- Note, if hot water supply is not connected, turn pressure control handle to “COOL” (indicated by blue dash) to increase water pressure as needed.

Readjust spray wand as necessary or use control handle to create an oscillating motion for wider cleaning range.

Once finished, pull water pressure control handle back to OFF position and retract nozzle using nozzle control handle. (For SMB-15, turn control knob counterclockwise to OFF position).

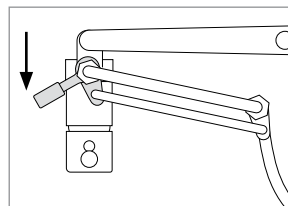

Extend Wand

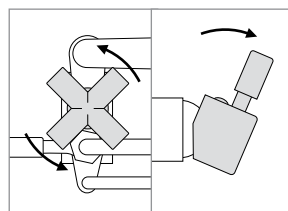

Turn On Water

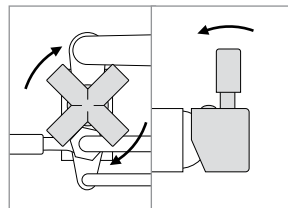

Turn Off Water

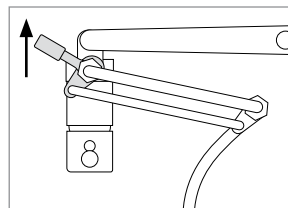

Retract Wand

Using the Side-Mounted Bidet



WARNING: Risk of scalding. High water temperature can cause severe burns.



Be sure to set the water temperature for your hot water heater at or below 120 °F (49 °C) and use extreme caution when mixing hot and cold water during use. Brondell is not liable for any misuse of product or failure to use caution when connecting to hot water.

Side-Mounted Bidet Dual Temperature (SMB-25) Only:

To adjust water temperature (when both hot and cold water are connected), slowly push pressure control handle forward and incrementally turn handle clockwise towards “WARM” (indicated by red dash) until the desired temperature is reached.

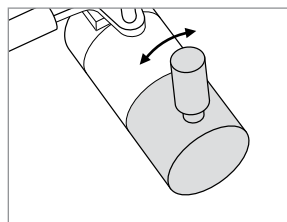

NOTES: There may be a delay in the warm water reaching the bidet attachment as the cold water in your pipes clears and is replaced with hot water (similar to the delay when you turn your faucet on).

If only connected to cold water, make sure that the temperature dial on the bidet attachment is turned as far as it can go towards the “COOL” setting for best pressure adjustability.

Maintenance

To clean the nozzle, extend spray wand and use a toothbrush or soft cloth and mild detergent (such as dish soap).

To clean the Side-Mounted Attachable Bidet with Adjustable Spray Wand, use a mild cleaner such as dish soap or a diluted mix of vinegar and water. Do not scrub or use harsh, abrasive products to clean the Side-Mounted Bidet as they may scratch or tarnish the finish of the product.

After cleaning, it is suggested to wipe spray wand with mineral oil or baby oil to help protect and sustain polished chrome finish.

Short Term Non-Use

If the product will not be used for more than a few weeks, you may consider shutting the water supply off at the wall for extra precaution.

TECHNICAL INFORMATION

Product Specifications

SIDE-MOUNTED BIDET WITH ADJUSTABLE SPRAY WAND	
Models	SMB-15, SMB-25
Supply Water Pressure	14.5 psi–116.03 psi / 0.1 MPa–0.8 MPa
Product Dimension	SMB-15: 11.02 in x 4.33 in x 3.15 in / 28 cm x 11 cm x 8 cm SMB-25: 11.02 in x 6.3 in x 3.15 in / 28 cm x 16 cm x 8 cm
Product Weight	SMB-15: 1.87 lbs / 0.85 kg SMB-25: 2.27 lbs / 1.03 kg
Product Thickness	0.2 in / 0.5 cm
Incoming Water Temperature Range	32 °F–158 °F / 0 °C–70 °C
Flow Rate	2.0 g/min / 7.57 l/min

NOTE: The specifications listed above are subject to change without prior notice for reasons of improving the product performance.

Warranty

Brondell products are backed by some of the most comprehensive warranties in the industry. Brondell warrants that all products (excluding consumable items) shall be free from defects in material and workmanship under normal use and service.

SMB-15 & SMB-25 RESIDENTIAL ONE-YEAR LIMITED WARRANTY

100% Coverage of all parts and labor for the entire product for the first year from original date of purchase.

SMB-15 & SMB-25 COMMERCIAL WARRANTY

Warranty period 1 year from original purchase date for all Brondell products. Warranties may not apply to products that are used for heavy commercial, hospital, or other high use non-residential applications.

EXCLUSIONS AND LIMITATIONS

1. Brondell warrants its products to be free from manufacturing defects under normal use and service. This warranty is extended only to the **ORIGINAL PURCHASER**.
2. Brondell's obligations under this warranty are limited to repairs or replacement, at Brondell's option, of products or parts found to be defective, provided that such products were properly installed and used in accordance with instructions. Brondell reserves the right to make such inspections as may be necessary in order to determine the cause of the defect.
3. Brondell is not responsible for the cost of removal, return (shipping) and/or re-installation of products.

This warranty does NOT apply to:

- Damage or loss which occurs during shipment.
 - Damage or loss sustained through any natural or man-made causes beyond the control of Brondell, including but not limited to fire, earthquake, floods, etc.
 - Damage or loss resulting from sediments or foreign matter contained in a water system.
 - Damage or loss resulting from negligent or improper installation including installation of a unit in a harsh or hazardous environment.
 - Damage or loss resulting from removal, improper repair, modification of the product, or improper maintenance including damage caused by chlorine or chlorine related products.
4. This warranty gives you specific legal rights. You may have other rights which vary from state to state.

THIS WRITTEN WARRANTY IS THE ONLY WARRANTY MADE BY BRONDELL. REPAIR OR REPLACEMENT AS PROVIDED UNDER THIS WARRANTY SHALL BE THE EXCLUSIVE REMEDY AVAILABLE TO THE PURCHASER. BRONDELL SHALL NOT BE RESPONSIBLE FOR LOSS OF USE OF THE PRODUCT OR FOR OTHER INCIDENTAL, SPECIAL, OR CONSEQUENTIAL DAMAGES OR EXPENSES INCURRED BY THE PURCHASER OR FOR LABOR OR OTHER COSTS DUE TO INSTALLATION OR REMOVAL OR COSTS OF REPAIRS BY OTHERS, OR FOR ANY OTHER EXPENSE NOT SPECIFICALLY STATED ABOVE. EXCEPT TO THE EXTENT PROHIBITED BY APPLICABLE LAW. ANY IMPLIED WARRANTIES, INCLUDING THAT OF MERCHANTABILITY, ARE EXPRESSLY LIMITED TO THE DURATION OF THIS WARRANTY. SOME STATES DO NOT ALLOW LIMITATIONS, SO THE ABOVE LIMITATION AND EXCLUSION MAY NOT APPLY TO YOU.

HOW TO OBTAIN SERVICE

To obtain repair service under this warranty, you must contact an authorized Brondell Service Center to obtain an RMA (Return Merchandise Authorization) number. Proof of purchase in the form of a copy of the original receipt must accompany the returned unit for the warranty to be valid. Take or ship the unit prepaid to the closest Brondell authorized service center along with the RMA number and proof of purchase.