

Read all instructions BEFORE assembly and USE of product.
KEEP INSTRUCTIONS FOR FUTURE USE.

Expedition 2-in-1 Stroller Wagon Plus



Instruction Manual

WG01XXEU/UK

Baby Trend, Inc.
13048 Valley Blvd.
Fontana CA 92335

Imported by:
Amazon Services Europe
38 avenue J.F. Kennedy,
L-1855 Luxembourg



IMPORTANT ! To ensure safe operation of your product, please follow these instructions carefully. Please keep these instructions for future reference.

IMPORTANT ! Before assembly and each use, inspect this product for damaged hardware, loose joints, missing parts or sharp edges. **NEVER** use if any parts are missing or broken.

IMPORTANT ! Adult assembly is required. Keep child away during unpacking and assembly.

This product conforms to EN 1888-2:2018+A1:2022 Standard.

 **WARNING:** Ensure that all locking devices are engaged before use.

 **WARNING:** Never leave children unattended.

 **WARNING:** To avoid injury, ensure that the child is not near the product when unfolding and folding this product.

 **WARNING:** Do not let child play with this product.

 **WARNING:** Care must be taken when unfolding the stroller to prevent finger entrapment.

CAUTION: Do not allow children near stroller while unfolding.

 **WARNING:** Care must be taken when folding and unfolding the stroller to prevent finger entrapment.

- **CAUTION: NEVER** run or jog with this stroller. This stroller is designed for up to 2 children only. Use with more than 2 children may cause an unbalanced condition which can injure/harm your child. Children must be at least 6 month old and be able to sit upright unassisted.
- Purses, shopping bags, parcels, diaper bags or accessory items may change the balance of the stroller and cause a hazardous, unstable condition.
- Be certain the stroller is completely opened and locked in place before allowing a child near the stroller.
- The maximum weight that can be carried in the child tray is 5 lbs (2.26 kg).
- The maximum weight that can be carried in the soft parent organizer is 2 lbs (0.90 kg).
- The maximum weight capacity is 22kg (48.5 lbs) for the front seat and 22kg (48.5 lbs) for the rear seat. The maximum weight capacity of the stroller in combination with any accessories is a total of 44 kg (97 lbs). Exceeding the weight limit will cause excessive wear and stress on the stroller and may cause a hazardous unstable condition to exist.
- **NEVER** use the stroller on stairways or escalators.
- **NEVER** use the stroller with roller skates, in-line skates, skateboards or bicycles.
- **NEVER** allow your stroller to be used as a toy.
- To clean use only mild household soap or detergent and warm water on a sponge or clean cloth.
- Check your stroller for loose screws, worn parts, torn material or stitching on a regular basis. Replace or repair parts as needed.
- Discontinue use of stroller should it malfunction or become damaged.

 **WARNING:** Any load attached to the handle bar or on the backrest or on the sides of the stroller will affect the stability of the stroller.

 **WARNING:** Any accessories which are not approved by the manufacturer shall not be used.

PARTS

- No additional mattress shall be added
- **Always** engage parking device when placing and removing the children from the product.
- The stroller does not replace a cot or bed. Do not allow child to sleep inside this product. Only replacement parts supplied or recommended by the manufacturer/ distributor shall be used.
- **Always** keep this product away from fire, open flame or high heat source

Check that you have all the parts for this model before assembling the stroller.

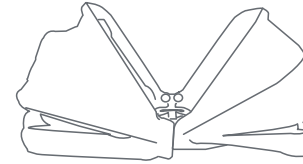

Double Canopy

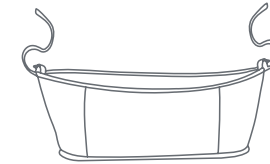

Soft Parent Organizer



Child Tray

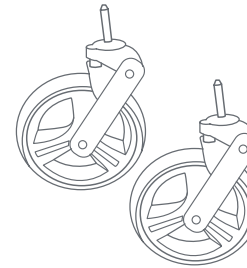

Front Wheels

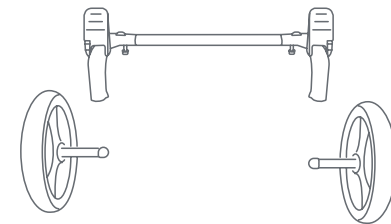

Rear Axle and (2) Wheels

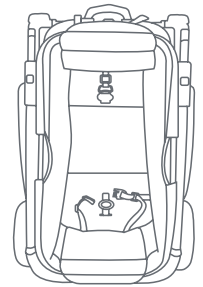

Wagon Frame

FRAME SETUP

To attach the wheels, unfold stroller as described in the following section:

- 1) • Release the fold latch (Fig. 1a).
- Unfold the stroller frame by pulling the stroller handle upward until it clicks into locked position (Fig. 1b).
- The **RED** indicator on the handle will not be visible when stroller is fully open. If **RED** indicator are visible check open position lock is engaged before continuing. (Fig. 1c).

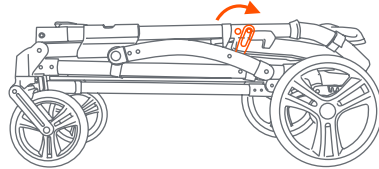

Fig. 1a

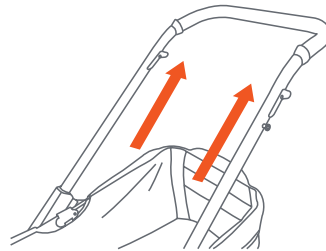

Fig. 1b

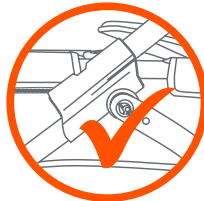
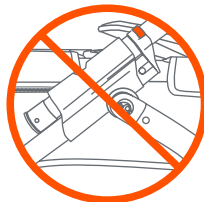

Fig. 1c

FRONT WHEELS

- 2) • Insert front wheel axle pin into the wheel hub until the wheel locks firmly into place. Repeat on other side. (Fig. 2a).
- NOTE:** Pull on the wheel assembly to ensure that it is securely attached to the stroller.

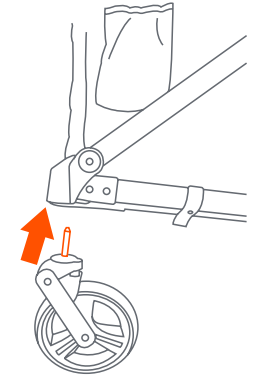

Fig. 2a

REAR AXLE-WHEELS

Attach the rear axle assembly and wheels as follows:

- 3) • Position stroller with rear leg tubes facing upward. Place the rear axle with wheels over the rear legs and apply downward pressure on both sides. Ensure both sides lock into place (Fig. 3a).

NOTE: NEVER use stroller if wheels do not lock into place. If you need assistance, please contact our customer service department at customerservice@babytrend.com.

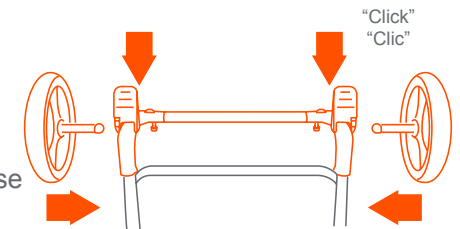

Always push in each rear wheel into position

Fig. 3

SOFT PARENT ORGANIZER

⚠ WARNING: Do not place hot liquids or more than 2 lb. (0.90kg) pounds in the parent tray. Serious burns or unstable conditions can result.

- 4) • **Strap In The Soft Parent Organizer:** Use the hook and loop to hang the soft parent organizer onto the stroller handle. Follow illustrations 1-3 (Fig. 4a). Be sure to fasten tightly.

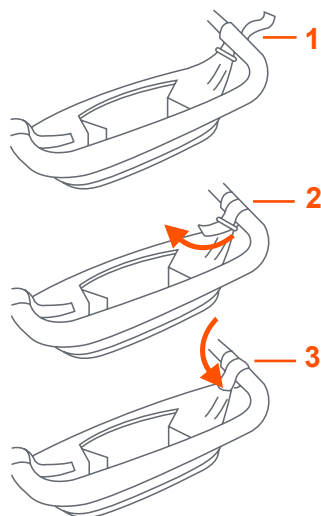

Fig. 4a

CHILD TRAY

⚠ WARNING: Do not place hot liquids or more than 5 pounds in the child tray. Serious burns or unstable conditions could result.

- 5) • **Attach child tray** by lining up the corresponding slots located on stroller frame. Slide down into position until locked into place (Fig. 5a).
NOTE: Check to make sure the child tray is secure before using.

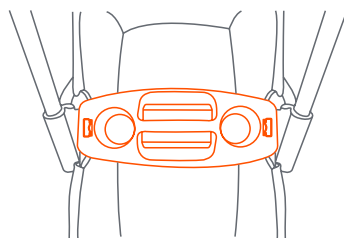

Fig. 5a

CANOPY

- 6) • **To install the canopy:** Add the canopy frame into the designated slots located on the child tray (Fig. 6a).

- **To open the canopy:** Behind the main fold mechanism use the strap and snap closure to anchor the canopy. Firmly spread out both sides of the canopy (Fig. 6b).

- **To secure canopy:** Fasten the canopy to the front and back circle tabs. Then, stitch each hook and loop to the wagon (Fig. 6c).

- **To loosen canopy:** Unhook the canopy

from both front and back circle tabs. Then, detach all hook and loops from the canopy. (Fig. 6d).

- **To remove the canopy:** Press the tab on each end of the canopy, and lift up the entire canopy from the bottom ends slots of the child tray (Fig. 6e).

- **To remove the child tray:** push the tabs outward and pull out the child tray (Fig. 6f). **NOTE:** The canopy may also be installed without the child tray. Insert the ends into holes.

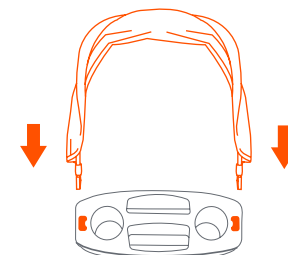

Fig. 6a

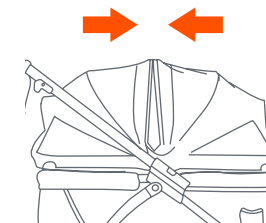
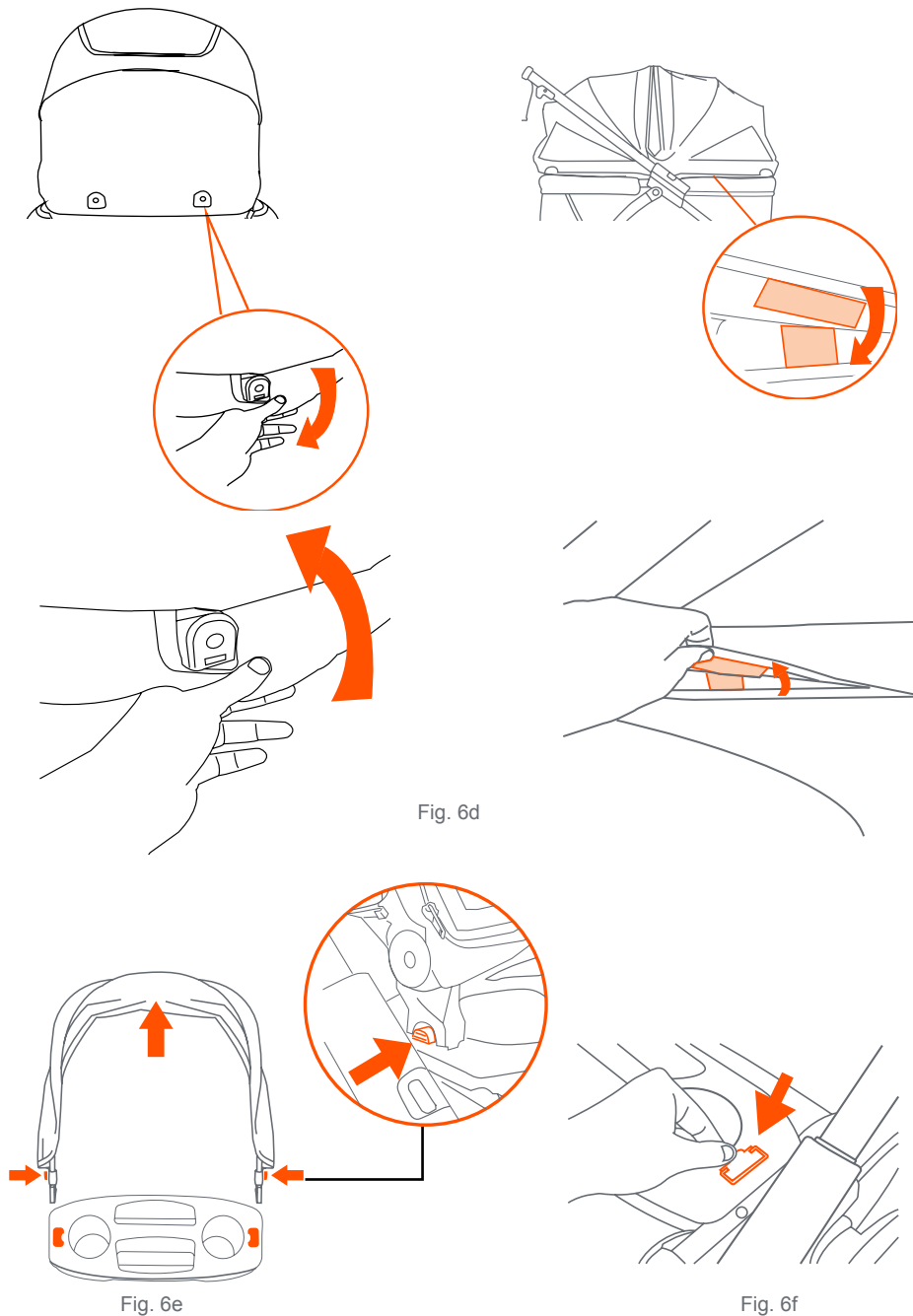

Fig. 6b



PULL HANDLE STORAGE

7) • **TO USE THE HANDLE:** Locate the handle underneath the frame and press the release button to unlatch. Pull the bar completely out of the frame (Fig. 7a). Rotate up to desired position (Fig. 7b).

• **TO PUT IT AWAY:** Reverse step (Fig. 7a) ensure to push the handle completely in until it clicks into position.
NOTE: Ensure the handle is resting on the storage hooks (Fig. 7c).

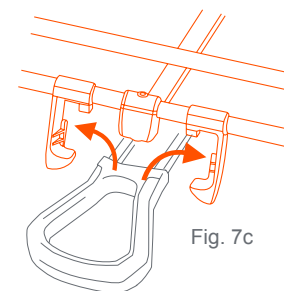
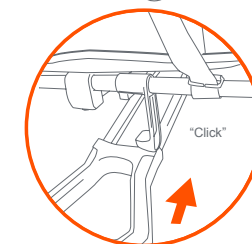
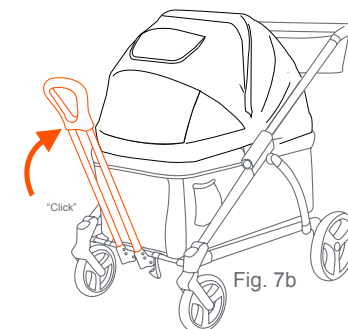
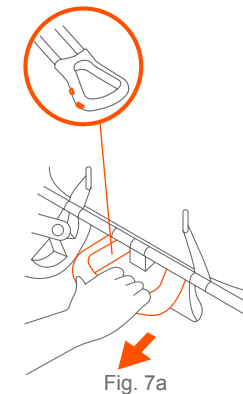

TO FOLD STROLLER

- ⚠ WARNING:** Care must be taken when folding the stroller to prevent finger entrapment.
- CAUTION:** Do not allow children near stroller while folding.

- 8)** • Close the canopy by reversing (Fig. 6b).
- To use the double lock feature: (1) push the safety lock up. (2) Lift up the trigger to hold the safety lock into place. (3) Pull both triggers together (Fig. 8a).
 - Push down on the stroller handle until the stroller is completely folded. Ensure the fold latch clicks and secures the stroller closed (Fig. 8b).

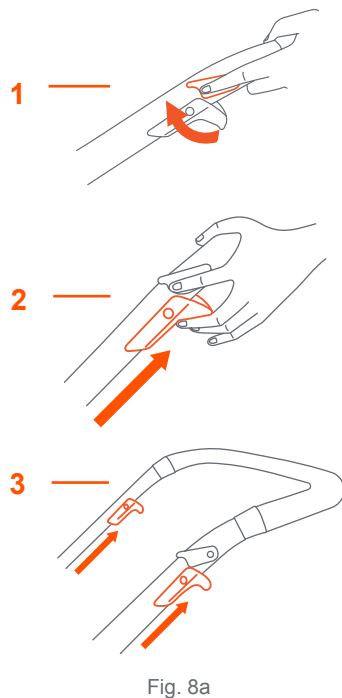

Fig. 8a

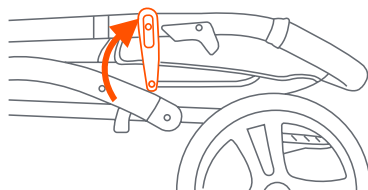

Fig. 8b

TO UNFOLD STROLLER

- 9)** • Release the fold latch (Fig. 9a). Unfold the stroller frame by pulling the stroller handle upward until it clicks into locked position (Fig. 9b). The **RED** indicator on the handle will not be visible when stroller is fully open. If **RED** indicator are visible check open position lock is engaged before continuing.

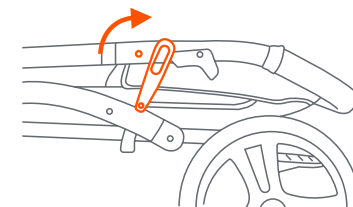

Fig. 9a

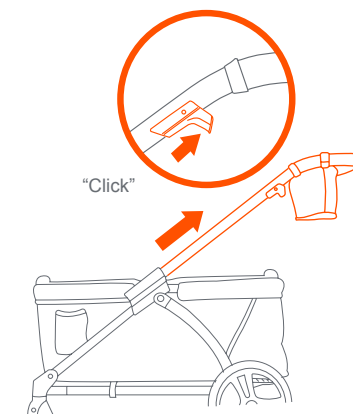
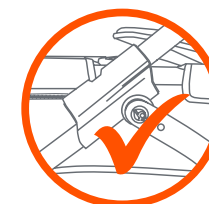
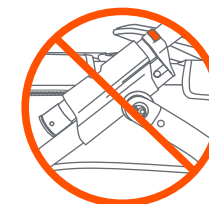

Fig. 9b



TO USE THE SAFETY HARNESS

⚠ WARNING: Avoid serious injury from falling or sliding out. Always use the safety harness.

⚠ STRANGULATION HAZARD: Child can strangle in loose straps. Never leave child in seat when straps are loose or undone.

10) • The child tray is not designed to hold the child in the stroller. Stay near and watch child during use. **NEVER** leave child unattended.

- Place the crotch strap between your child's legs. Insert the Harness Buckles into the Center Clasp with the Button.
- Adjust waist straps for your child's comfort and safety by sliding buckles in either direction. Safety straps are to fit snug around your child (Fig. 10).

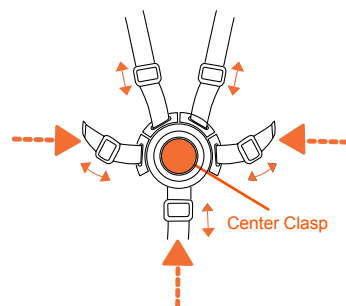

Fig. 10

TO RELEASE SAFETY BELT

11) • Push Button on Center Clasp, the four Harness Buckles will pop free (Fig. 11).

BRAKES

⚠ WARNING: Always set brakes when the stroller is not being pushed so that the stroller will not roll away. **NEVER** leave stroller unattended on a hill or incline as the stroller may slide down the hill.

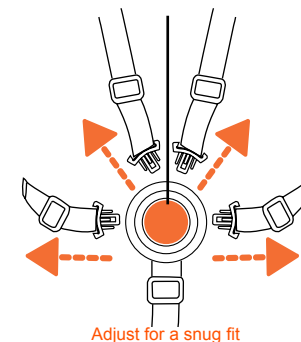

Fig. 11

12) • To engage brakes, apply light downward pressure to the brake lever located on each rear wheel. The stroller may require slight forward or rearward movement in order to line up the teeth on the brake with each wheel brake cluster (Fig. 12a).

NOTE: Check that the stroller will not move and that both brakes are properly applied.

- To release, gently lift up on the brake lever.

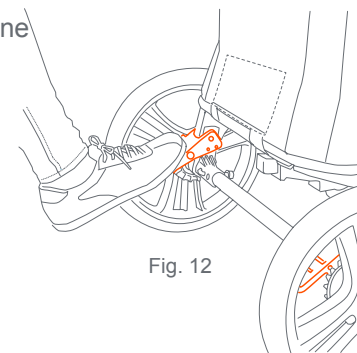

Fig. 12

BASKET

- 16) • To install:** Attach the basket from the outside frame of the wagon. Ensure both latches are straight, facing the frame. Insert by pushing in and sliding down the latches until it locks (Fig. 16a). **IMPORTANT: DO NOT put child in the basket.**
- **To flip basket into the wagon:** From the bottom of the basket, push it upward and over into the wagon, until the basket is entirely inside (Fig. 16b). Push down into basket to ensure its secure (Fig. 16c).

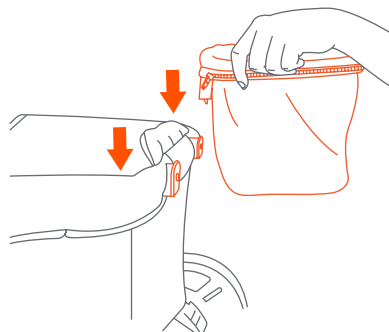

Fig. 16a

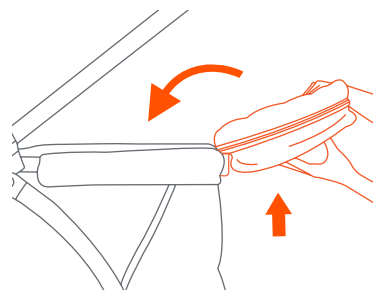

Fig. 16b

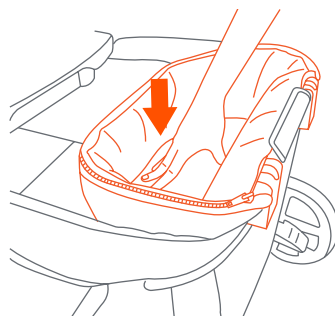

Fig. 16c

TO REMOVE BASKET

- 17) • To detach:** Flip the basket over the wagon frame. Pull the latch levers forward and lift up, until the basket comes off completely (Fig. 17).

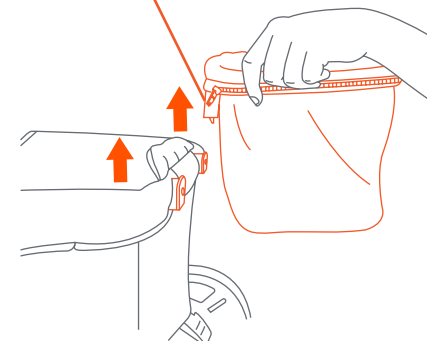
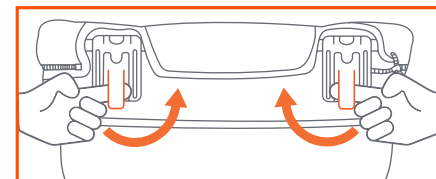

Fig. 17

SEAT 2 MAT

18) • Option 1 Mat(s): Lay flat in stroller (Fig. 18a). **IMPORTANT:** Only use the harness in the lowest position, and place mat(s) with round edge towards the back seating position as shown in (Fig. 18b).

- Option 2 Seat(s): To use as seat(s) thread the crotch buckle through the folded or unfolded mat(s).

IMPORTANT: Only use the lowest position for the unfolded mat and the highest position for folded mat (Fig. 18c) (Fig 18d). Always buckle the harness to use as a stroller. Refer to step 10 for harness instructions.

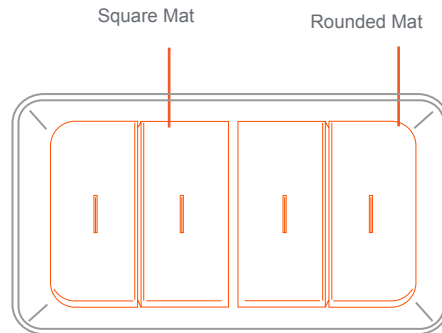

Fig. 18a

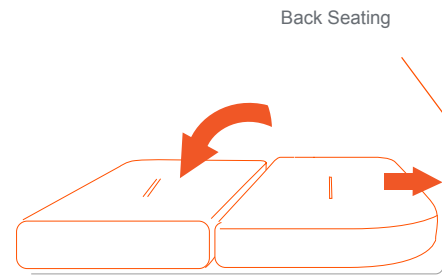

Fig. 18b

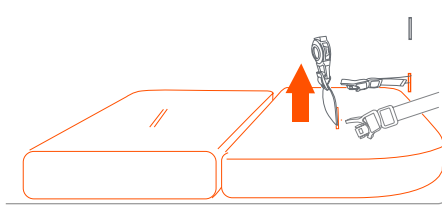

Fig. 18c

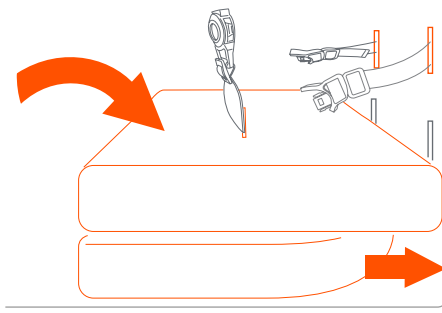

Fig. 18d

WAGON FABRIC

19) • To detach the fabric: for cleaning or replacement, unzip from the front and rear of the wagon frame (Fig. 19a).

- Through the pocket opening, remove the D-Rings straps from the fabric near the bottom front and rear frames to unthread the harness straps (Fig. 19b). Remove the screws on the underside of the frame (Fig. 19c).

- **To reattach the fabric:** ensure that the fabric is realigned to the corresponding front and rear end frames.

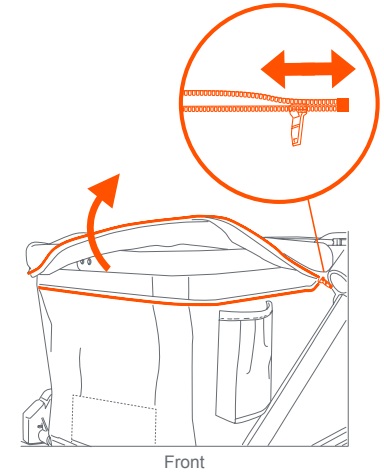

Front

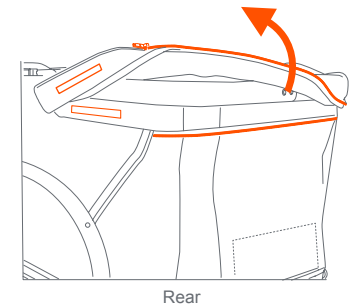

Rear

Fig. 19a

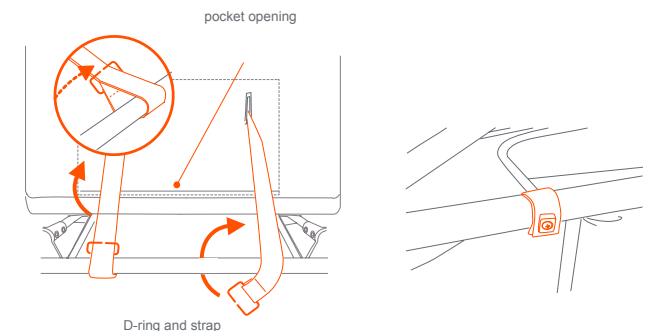

D-ring and strap

Fig. 19b

REAR AXLE WHEEL REMOVAL

Attach the rear axle assembly and wheels as follows:

- 20)** • To release the entire rear wheel assembly, push in the rear wheel release. The wheel easily detaches from the bushing (Fig. 20a).

- If replacing the rear axle, press the pin on each side behind the wheel hub.

Pull the rear axle out from the hub (Fig. 20b).

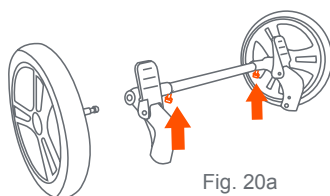

Fig. 20a

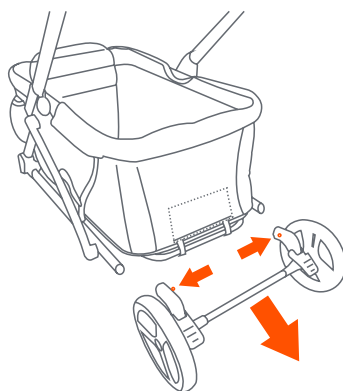

Fig. 20b

NOTE: NEVER use stroller if wheels do not lock into place. If you need assistance, please contact our customer service department at customerservice@babytrendcom.

CARE AND MAINTENANCE

- **Cleaning Seat Pad:** Spot clean only - Surface wash small spots with mild solution of soap and water. Rinse with water to remove soap solution. Wipe or air dry.
- **Cleaning Stroller:** Surface wash stroller frame, plastic parts and fabric with mild solution of soap and water. Wipe surfaces with water to remove soap solution. Wipe or air dry.
- Check your stroller for loose screws, worn parts, torn material or stitching on a regular basis. Replace or repair parts as needed.
- **SEAT 2 MAT WASHING INSTRUCTIONS:** Remove the foam and wash the cover separately. Do not wash it with other fabrics. Machine wash on gentle / delicate cycle with cold water. Do not bleach. Do not tumble dry. Hang dry. Do not iron. Do not dry clean.





BABY TREND® CUSTOMER SERVICE

The Customer Service Department can be contacted at customerservice@babytrend.com. (PST). Return Authorizations are required prior to returning product(s) to Baby Trend®.