

# anko

## Grooming Pack

### Instruction Manual



**Model no.: RFC-319 & MS-011**

## SAFETY GUIDE - PLEASE READ CAREFULLY BEFORE USING THIS APPLIANCE

Please follow all the precautions listed below for safety and to reduce the risk of injury or electric shock.



**WARNING: READ ALL INSTRUCTION. FAILURE TO FOLLOW ALL INSTRUCTIONS LISTED BELOW MAY RESULT IN ELECTRIC SHOCK, OR SERIOUS PERSONAL INJURY.**

### SAVE THIS INSTRUCTION

1. Only use the appliance as described in this manual.
2. Do not immerse the appliance in water or any other liquid.  
**Warning: Keep the appliance dry**
3. Do not allow the appliance to be exposed to rain or moisture during use or storage.
4. Always check the appliance for damage prior to use. If any damage is observed, do not use the appliance.
5. The appliance is intended for indoor use only.
6. Always switch the appliance OFF after use.
7. This appliance has no user serviceable parts.
8. This appliance is for personal use only, not designed for commercial use.
9. **Do not** use it outdoors.
10. **Do not** use the appliance if it is not working properly, if it has been dropped or if it has been immersed in any liquid.
11. Before using the appliance, ensure that the clipper head/ trimmer head are securely fitted.
12. Do not use the appliance on children.
13. The appliance is not to be used by persons (including children) with reduced physical, sensory or mental capabilities, or lack of experience and knowledge, unless they have been given supervision or instructions concerning use of the appliance by a person responsible for their safety.
14. Children being supervised to ensure that they do not play with the appliance.
15. Do not operate the AC charger if it has a damaged cord or plug, if it is not working properly, if it has been dropped or damaged or dropped into water.
16. Use only the original AC charger supplied with the appliance.
17. Check that your supply voltage is the same as that stated on the charger.
18. When charging the appliance, the power switch must be set to OFF.
19. It is normal for the charger to become warm to touch when charging.
20. Use only attachments provided.
21. This product contains sharp blades, please take the utmost care in handling and use.
22. Do not stretch, twist and curl the cable around the appliance.
23. Keep the cable away from hot surfaces.

24. Rechargeable battery is installed in the hair clipper. Do not replace the batteries with non-rechargeable batteries.
25. **To avoid personal injury, do not use the hair clipper if it has a damaged blade or trimming head.**
26. Detach the attachment heads for cleaning. Only the attachments can be washed under tap water.
27. Do not submerge the appliance, nor make it flow under water-tap.
28. Do not use salt water or boiling water when cleaning. Also, do not use cleaning products that are designed for toilets, bathrooms or kitchen appliances
29. The hair clipper must be used only with provided battery charger KH6-030060AU



**WARNING: Do not recharge non-rechargeable batteries.**



**WARNING: Before charging the product, please make sure your hands are dry.**



**WARNING: Please use the AC charger supplied with the product. Other AC chargers may cause electrical failure and/or fire.**

## **PARTS**

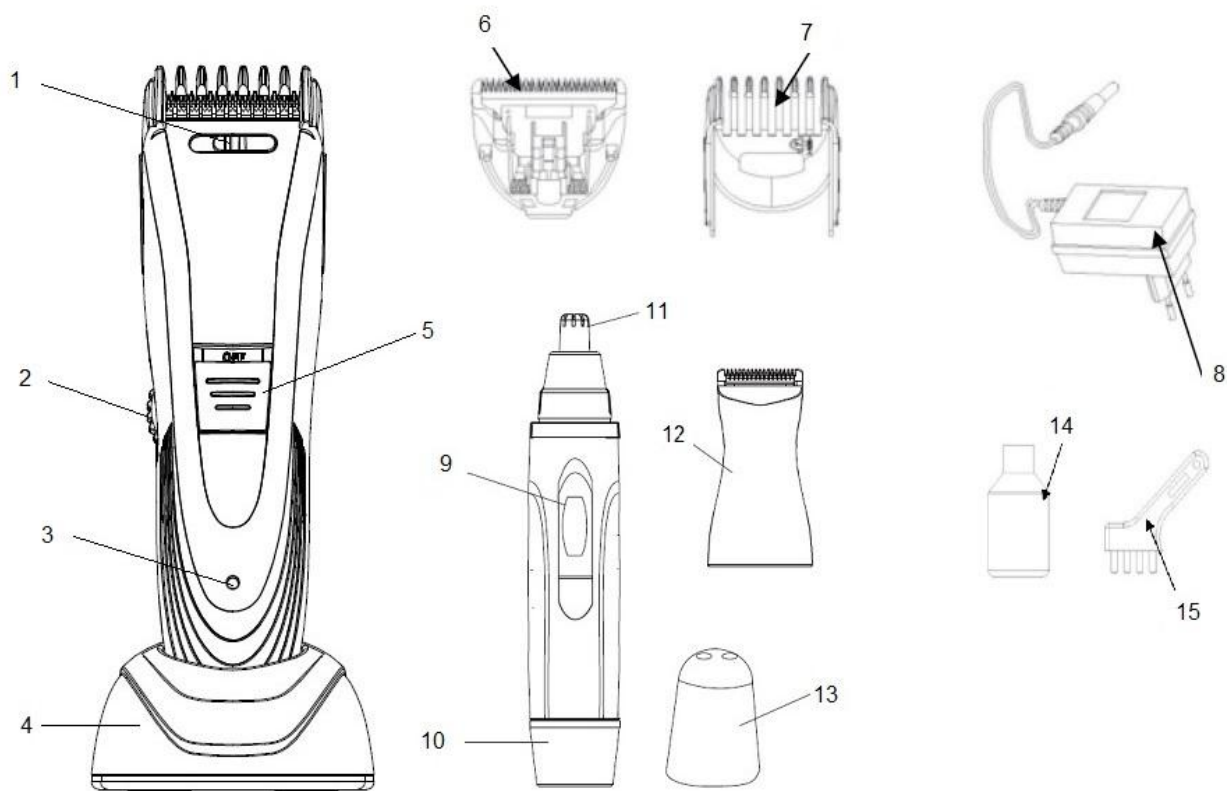

### **Cordless Hair Clipper**

- 1 Thin out adjustor
- 2 Comb length adjustor
- 3 Power/ Charging indicator
- 4 Charging base

- 5 On/Off Switch
- 6 Removable Blade
- 7 3-15mm Comb attachment guide
- 8 Charger KH6-030060AU

### **Ear and Nose Trimmer**

- 9 On/Off switch
- 10 Battery cover
- 11 Nose trimmer attachment

- 12 Hair trimmer attachment
- 13 Nose trimmer cap

### **Accessories**

- 14 Lubricant oil
- 15 Cleaning brush

## BEFORE FIRST USE

### Hair clipper

- Before using your hair clipper for the first time, charge for 12 hours.
- Ensure the product is switched OFF before charging.
- Connect the charging adaptor to the product and then connect to mains power.
- RED indicator light will illuminate to indicate the product is charging.

**IMPORTANT! The RED battery charge indicator light will remain ON after the battery is fully charged. To prevent damage to the battery never charge the hair clipper for more than 24 hours.**

- This appliance can be charged directly or rest on the charging base when charging.
- It will take 8 hours to fully charge the batteries in the hair clipper.

**IMPORTANT! Use only the provided charger KH6-030060AU.**

### BATTERY CARE

To ensure maximum life from the batteries in your rechargeable hair clipper, follow these guidelines:

- Do not recharge the hair clipper between sessions. Wait until the batteries are exhausted before recharging.
- Discharge the batteries completely twice a year (switch ON and run until the shaver stops).
- **IMPORTANT! Do not use the hair clipper while charging.**
- Do not charge the hair clipper when the temperature is below 0°C or above 40°C
- Avoid recharging the hair clipper in direct sunlight or near a radiating heat source.

### Ear and Nose Trimmer

- Require 1x 1.5V AA battery (included)
- Remove battery cover by lightly turning it in anti-clockwise direction.
- Insert battery and ensure battery polarity is correct. Insert positive (+) side first as shown below.

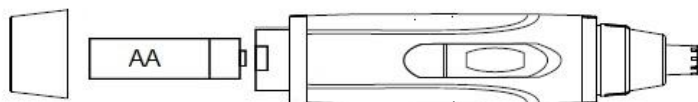

- Replace the battery cover and turn it in clockwise direction until it clicks into place.
- For the best results, use alkaline battery.
- Remove the battery if the trimmer is not used for a prolonged period.

## OPERATING INSTRUCTIONS

### Hair Clipper



#### WARNING:

Switch off the device before replacing or changing the attachments



#### NOTES:

The hair to be dressed must be dry.



#### NOTES:

The cutting length may deviate depending on the cutting angle. Please start with a comb attachment with a longer cutting length and then, in the course of cutting process, use shorter cutting lengths step by step.

1. Ensure the hair clipper is switch OFF.
2. Insert comb attachment. Line the comb rails up with the vertical channels on both sides of the clipper, slide the comb all the way until it stops. (Fig. 1)

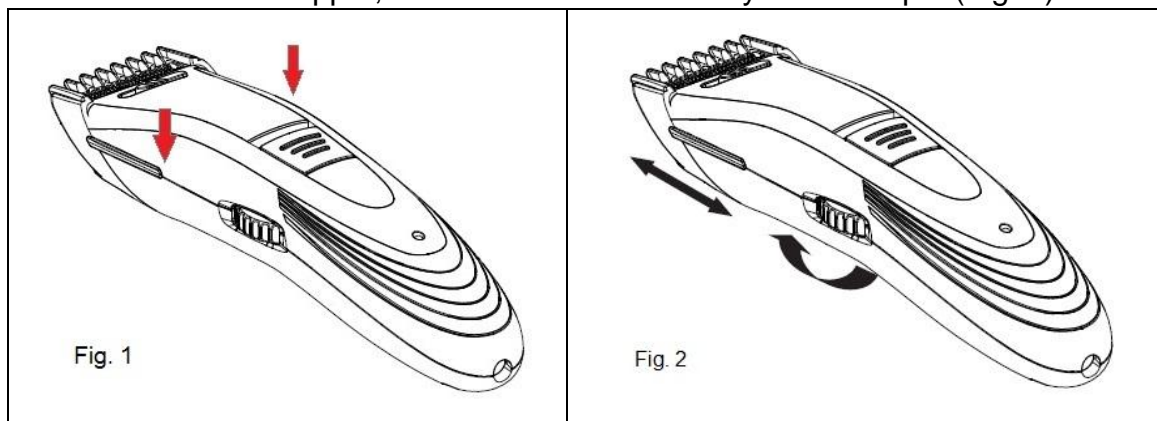

3. Adjust the trim length. Rotate the comb length adjuster and the comb will move up and down.(Fig. 2). There are 9 different comb position to adjust trim length from 3mm - 15mm.

Comb Position	Comb length
1	3mm
2	4.5mm
3	6mm
4	7.5mm
5	9mm
6	10.5mm
7	12mm
8	13.5mm
9	15mm

4. 0.5mm is achieved without any combs and holding the blades perpendicular to the skin.
5. Hold the device so the the comb attachment rests flat on the head. Move the device evenly throught the hair.

**NOTE:** For even cutting, allow the comb attachment to cut is way through the hair. Do not force it through quickly. If you are cutting for the frist time, start with the longest comb length.

### **Nose/Ear Trimmer**

1. Attach the required grooming head on the main unit by turning the attachment head clockwise.
2. Push the switch up to turn on the unit.
3. Put the blade head in your nose or ear, gently move and trim hair.
4. Push the switch down to turn off the unit when finished.

## **CLEANING AND MAINTENANCE**

### **Hair clipper**

Turn off your hair clipper and wait until it is completely cool.

Before cleaning, remove the accessory and the used blade and make cleaning with the aid of the cleaning brush that was equipped in the product.

The cutting blades should be lightly oiled with the oil provided once every few haircuts.

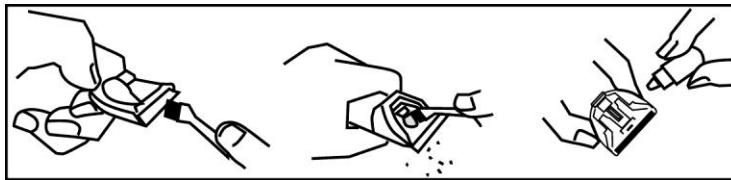

Clean your hair clipper using a damp cloth and then dry it. After each use, follow the instructions to retire the blades of your hair clipper.

### **Nose and Ear Trimmer**

Turn off the trimmer.

Remove nose/ hair trimmer attachment from the main unit. Clean the blade head with the small brush provided or rinse under running water. Wiped clean with a dry cloth.

Clean the main unit by wiping it with a damp cloth. Do not use detergents of any kind.

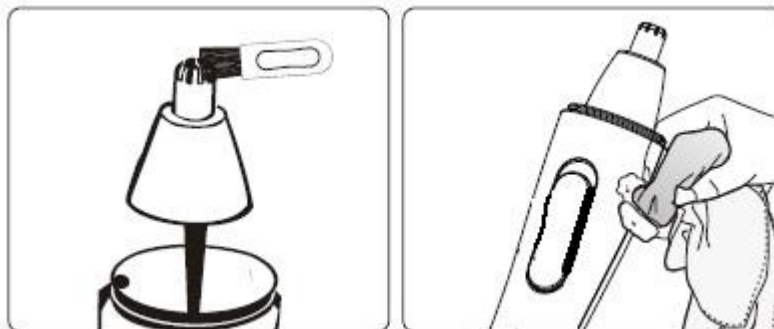

**IMPORTANT! This product is not water resistant. Don't wash it with water. Allow to dry completely after cleaning and before storing.**

## **BATTERY DISPOSAL**

If the hair clipper is to be disposed of the batteries should be removed from the appliance before it is scrapped. The hair clipper must be disconnected from the mains power before removing the battery. The battery is to be disposed safely. Used batteries should be taken to a recycling station and not disposed of with normal household waste.

**IMPORTANT: Always fully discharge the batteries before removal and ensure the charger is disconnected from mains power.**

## **TECHNICAL SPECIFICATIONS**

<b>Cordless Hair Clipper</b>	
Model no.	<b>RFC-319</b>
Working time	Approximately 45 minutes
Charging time	8hr
Battery Charger	<b>KH6-030060AU</b>
Input voltage	100-240V~50/60Hz
Output voltage	DC 3V, 600mA
Battery type	Ni-MH, 600mAh, 1.2V x2 cell
<b>Nose &amp; Ear Trimmer</b>	
Model no.	MS-011
Battery Type:	1.5V 1x AA (included)



## **12 Month Warranty**

Thank you for your purchase from Kmart.

Kmart Australia Ltd warrants your new product to be free from defects in materials and workmanship for the period stated above, from the date of purchase, provided that the product is used in accordance with accompanying recommendations or instructions where provided. This warranty is in addition to your rights under the Australian Consumer Law.

Kmart will provide you with your choice of a refund, repair or exchange (where possible) for this product if it becomes defective within the warranty period. Kmart will bear the reasonable expense of claiming the warranty. This warranty will no longer apply where the defect is a result of alteration, accident, misuse, abuse or neglect.

Please retain your receipt as proof of purchase and contact our Customer Service Centre on 1800 124 125 (Australia) or 0800 945 995 (New Zealand) or alternatively, via Customer Help at [Kmart.com.au](http://Kmart.com.au) for any difficulties with your product. Warranty claims and claims for expense incurred in returning this product can be addressed to our Customer Service Centre at 690 Springvale Rd, Mulgrave Vic 3170.

Our goods come with guarantees that cannot be excluded under the Australian Consumer Law. You are entitled to a replacement or refund for a major failure and compensation for any other reasonably foreseeable loss or damage. You are also entitled to have the goods repaired or replaced if the goods fail to be of acceptable quality and the failure does not amount to a major failure.

For New Zealand customers, this warranty is in addition to statutory rights observed under New Zealand legislation.